

INSTITUTE FOR FISHERIES RESEARCH
 DIVISION OF FISHERIES MICHIGAN CONSERVATION DEPT.
 LAKE INVENTORY MAP
COCHRAN LAKE
 AREA 27.5 ACRES
 MARGINAL SURVEY AND SOUNDINGS INVENTORY 7/3-4/45
 7/7-9/45
 CHEBOYGAN COUNTY T. 35 N., R. 2 W., SEC. 21

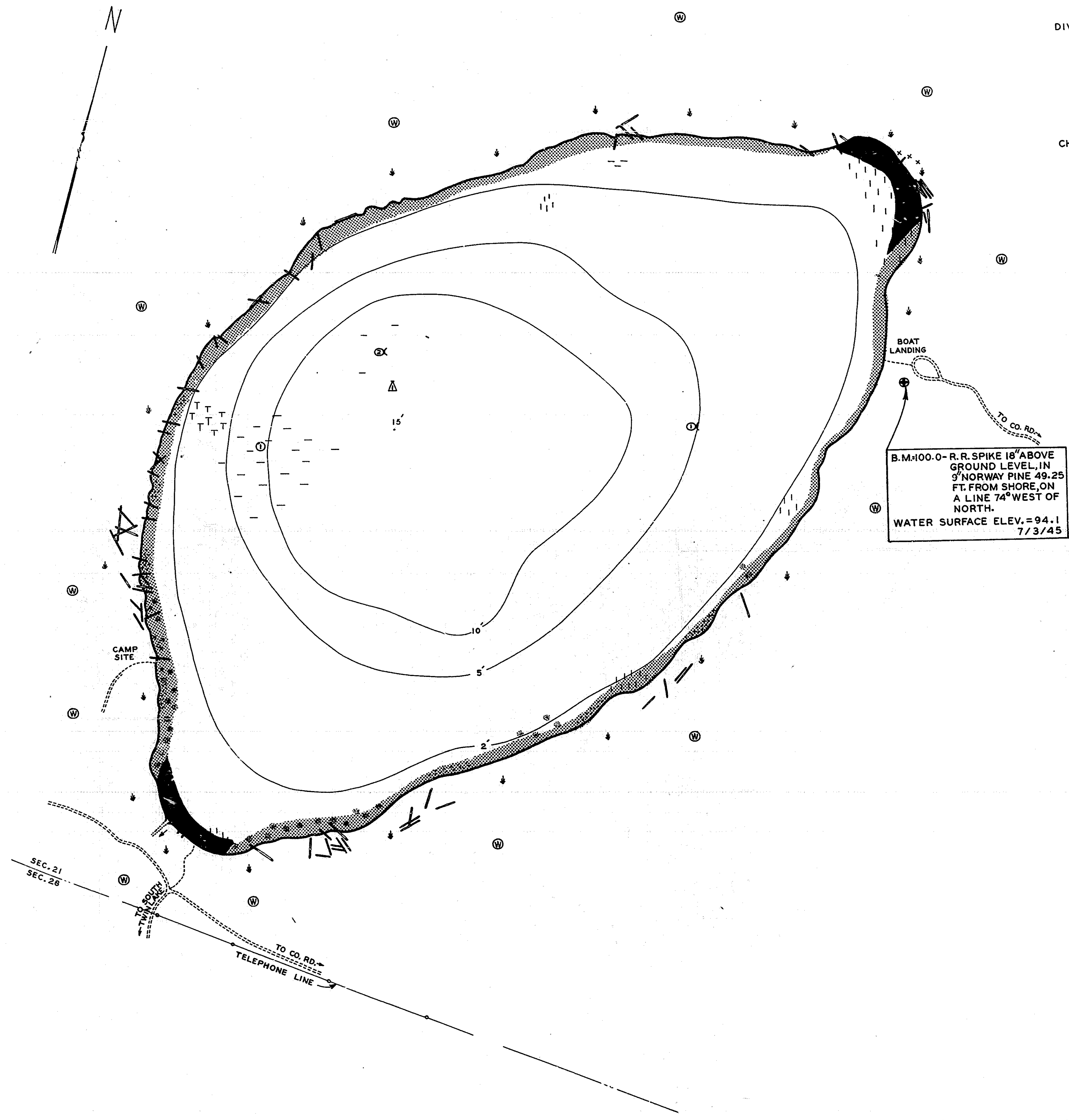

B.M. 100.0- R. R. SPIKE 18" ABOVE GROUND LEVEL, IN 9' NORWAY PINE 49.25 FT. FROM SHORE, ON A LINE 74° WEST OF NORTH.
 WATER SURFACE ELEV. = 94.1
 7/3/45

LEGEND

- BOTTOM**
- ▨ Sand
 - Pulpy peat
 - Fibrous peat
 - ⊙ Gravel
 - x Trash
 - ⊙ Spawning beds
 - Deadheads
- OUTLINE & CONTOURS**
- Shoreline
 - Contours
- SHORE FEATURES**
- ⋯ Unimproved road
 - Trail
 - ↓ Brush
 - ⊙ Intermittent outlet
 - ⊙ Wooded
- VEGETATION**
- T Floating
 - I Emergent
 - Submergent
- STATIONS**
- ⊙ Vegetation
 - △ Temp, chem, plankton
 - ⊙ Fish sample

