

INSTITUTE FOR FISHERIES RESEARCH  
 DIVISION OF FISHERIES MICHIGAN CONSERVATION DEPT.

LAKE INVENTORY MAP  
**MURRAY LAKE**  
 AREA 320 ACRES

MARGINAL SURVEY AND SOUNDINGS 4/20,21,22/54  
 SHORE OUTLINE BASED ON U.S. DEPT. AGRIC. AERIAL PHOTO OF 7/3/38  
 INVENTORY 7/20-26/55  
 KENT COUNTY T. 7-8 N., R. 9 W. SEC'S. 4, 33, 34

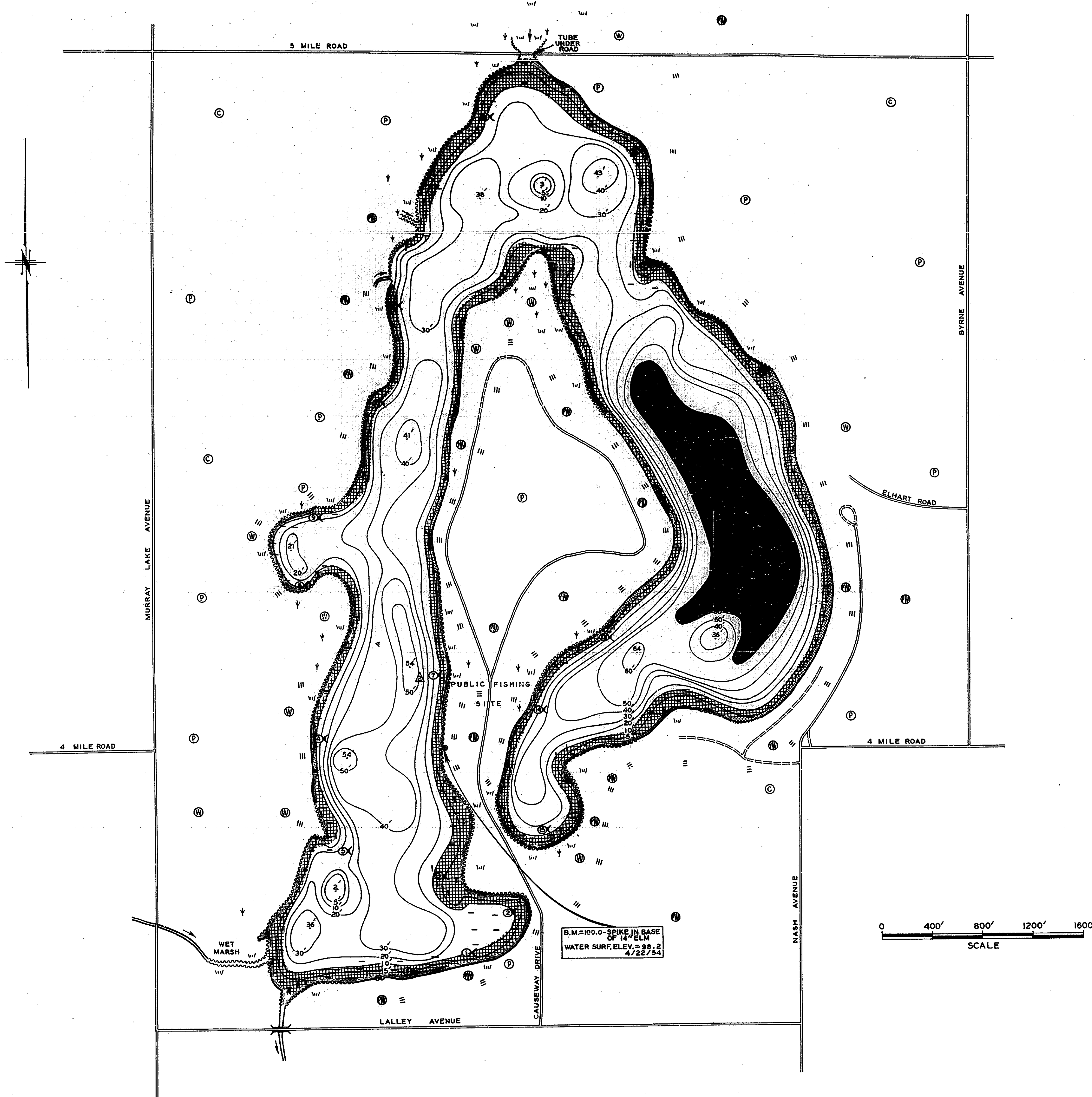

LEGEND

BOTTOM

- Sand
- Marl
- Pulpy peat
- Fibrous peat
- Muck
- Gravel

OUTLINE & CONTOURS

- Shoreline
- Contours

SHORE FEATURES

- Slope
- Improved road
- Unimproved road
- Encroaching shore
- Breakwater
- Marsh
- Brush
- Wooded
- Partly wooded
- Pasture
- Cultivated
- Inlet
- Outlet
- Bridge

VEGETATION

- Emergent
- Submergent
- Floating

STATIONS

- Temp. chem. analysis
- Fish sample

B.M. = 100.0 - SPIKE IN BASE  
 OF 14" ELM.  
 WATER SURF. ELEV. = 98.2  
 4/22/54

