



B.M. No. 1 = 100.0 - SPIKE IN BASE  
OF 16" NORWAY PINE  
WATER SURFACE ELEVATION = 97.2  
1/30/67

B.M. No. 2 = 99.5 - SPIKE IN BASE  
OF 20" OAK  
WATER SURFACE ELEVATION = 97.2  
1/30/67

LEGEND

BOTTOM

□ Organic

SHORE FEATURES

⋯ Encroaching shore

≡ Steep slope

⊙ Wooded

⊙ Partly wooded

† Brush

== Improved road

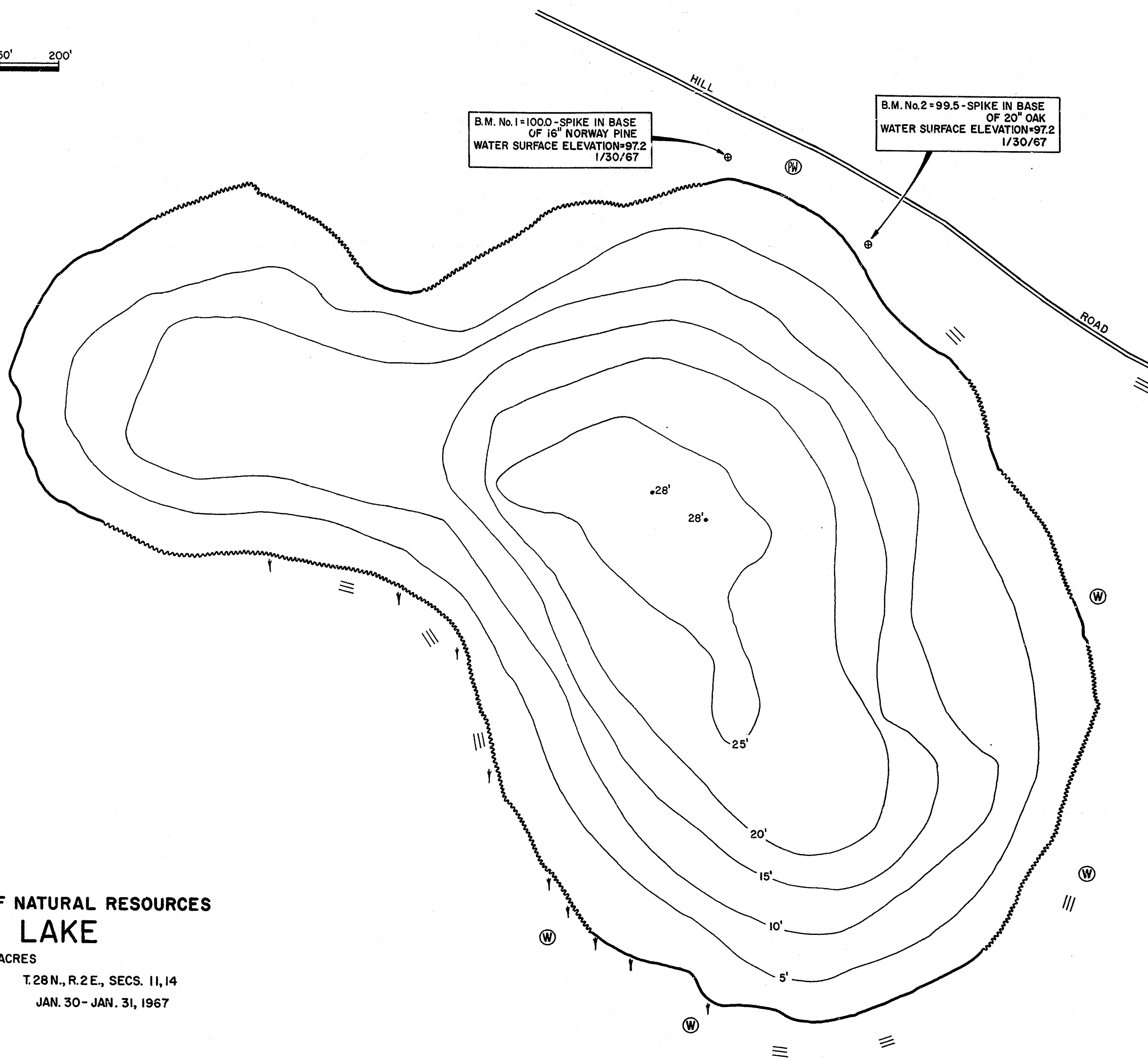

MICHIGAN DEPARTMENT OF NATURAL RESOURCES  
SECOND LAKE

AREA 7 ACRES

OSCODA COUNTY

T.28N., R.2E., SECS. 11, 14

SURVEY AND SOUNDINGS

JAN. 30 - JAN. 31, 1967

