

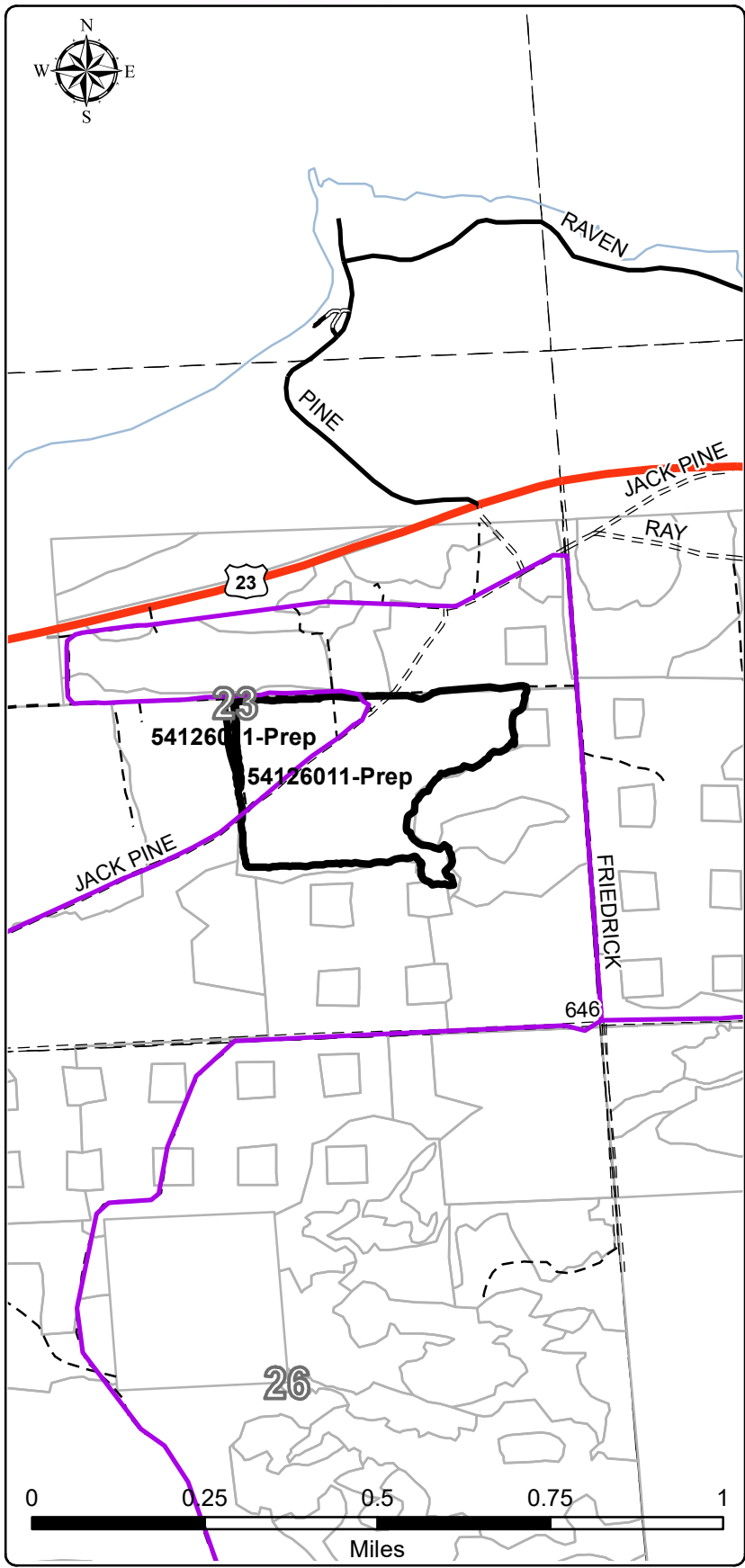

# C54-1130



County Presque Isle	Town 36N	Range 03E	Subdivision Section 23: S1/2NE,SW,N1/2SE	YOE 2016	Compartment(s) 126	Stand(s) 11
------------------------	-------------	--------------	---	-------------	-----------------------	----------------



Cover Type Objective:	PLANTED RP	Acres:	<b>51.7</b>
Approved Methods:	Trench & plant RP. Site prep & release treatments may include chopping, herbicide & pre-commercial thinning.		
Treatment Number(s):	54126011-Prep		
Timber Sale Number:	54-040-16		
Sale Admin Staff:	Zimmerman		
Contract TCR Date:	8/6/2019		
Comments:	Herbicide then trench Don't trench or plant on any roads or trails as mapped.		

Proofing Comments	
Recreation:	Snowmobile trail within treatment area.
Water:	Lake Huron less than 1 mile NW of treatment area.
HAL:	Archeology hit within treatment area.
MNFI:	No hits on MNFI
Other Comments:	Squatter Pine 54-040-16 Chopping completed 10/23/20

- Legend**
- C54-1130
  - Stand Boundaries
  - DNR - Primary Forest Road
  - DNR - Secondary Forest Road
  - DNR - Forest Access Route
  - Federal / State Highway
  - Federal / State / County - Paved Road
  - Federal / State - Dirt / Gravel Road
  - County - Gravel Road
  - County - Dirt Road (Seasonal)
  - Private - Paved Road
  - Private - Dirt / Gravel Road
  - Designated Snowmobile Trails
  - Lakes and Rivers All
  - Sections
- Section Number