

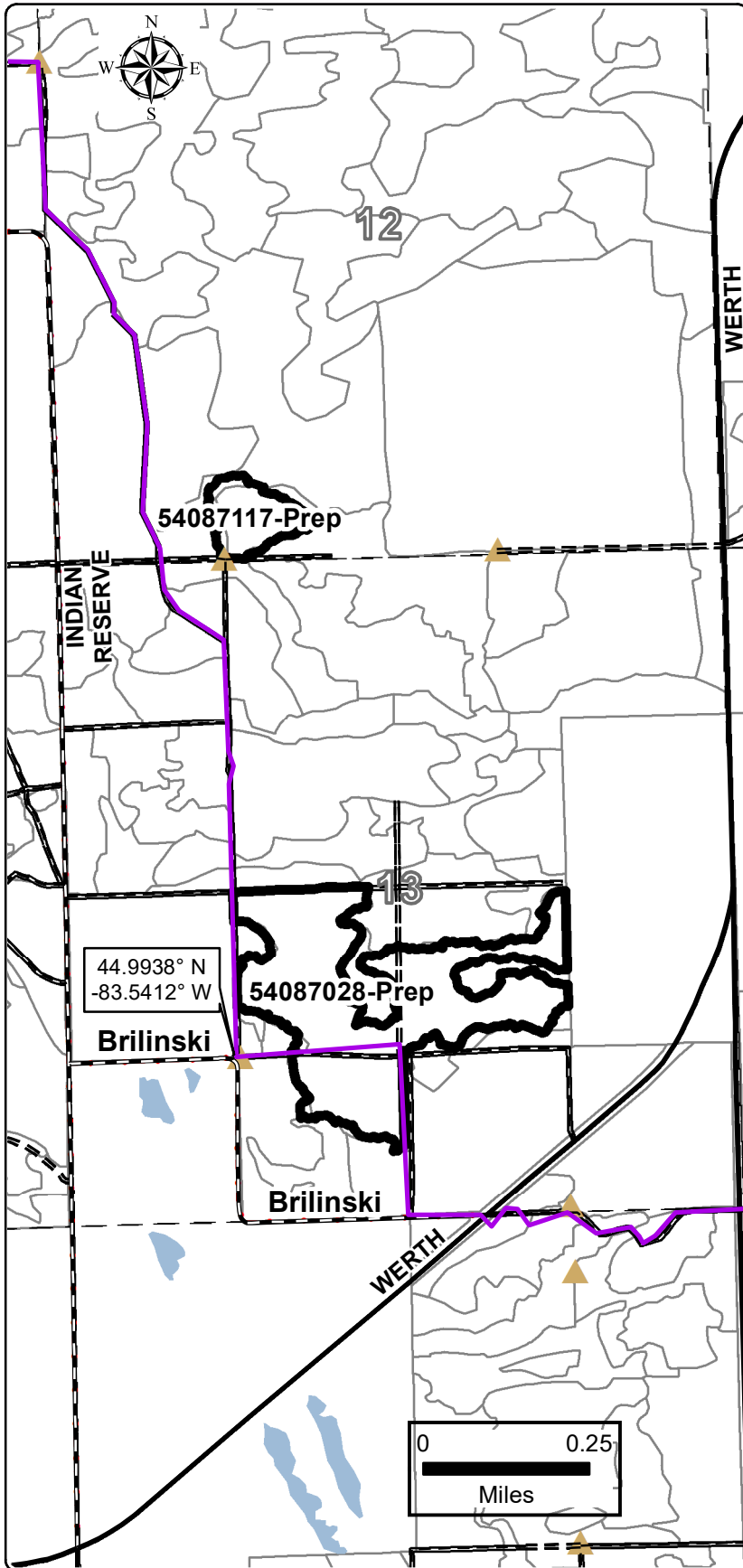

C54-1155 Brilinski Red Pine



County Alpena	Town 30N	Range 07E	Subdivision Sec 12 S2SW Sec 13 W2SW, NWSE	YOE 2021	Compartment(s) 87	Stand(s) 28, 117
------------------	-------------	--------------	---	-------------	----------------------	---------------------



Cover Type Objective:	Planted Red Pine	Acres:	66.5
Approved Methods:	Trench & plant RP. Site prep & release treatments may include chopping, herbicide & pre-commercial thinning.		
Treatment Number(s):	54087028, 54087117		
Timber Sale Number:	54-027-17-01		
Sale Admin Staff:	D. Parris		
Contract TCR Date:	7/7/2021		
Comments:	Both stands are flat. There is a possibility of trenches filling up with water due to a high water table. Stand 28 to the south had a dense understory of sapling red maple that was removed with the harvest.		

Proofing Comments	
Recreation:	Snowmobile trail runs along the south edge of stand 117 to the north and through Stand 28 to the south
Water:	No water w/in 500-ft
HAL:	No hits w/in Rx areas
MNFI:	No hits on MNFI
Other Comments:	

Legend	
Treatments	Federal / State / County - Paved Road
Stand Boundary	County - Gravel Road
DNR - Secondary Forest Road	Berms
DNR - Forest Access Route	Lakes and Rivers
	All
	Sections