

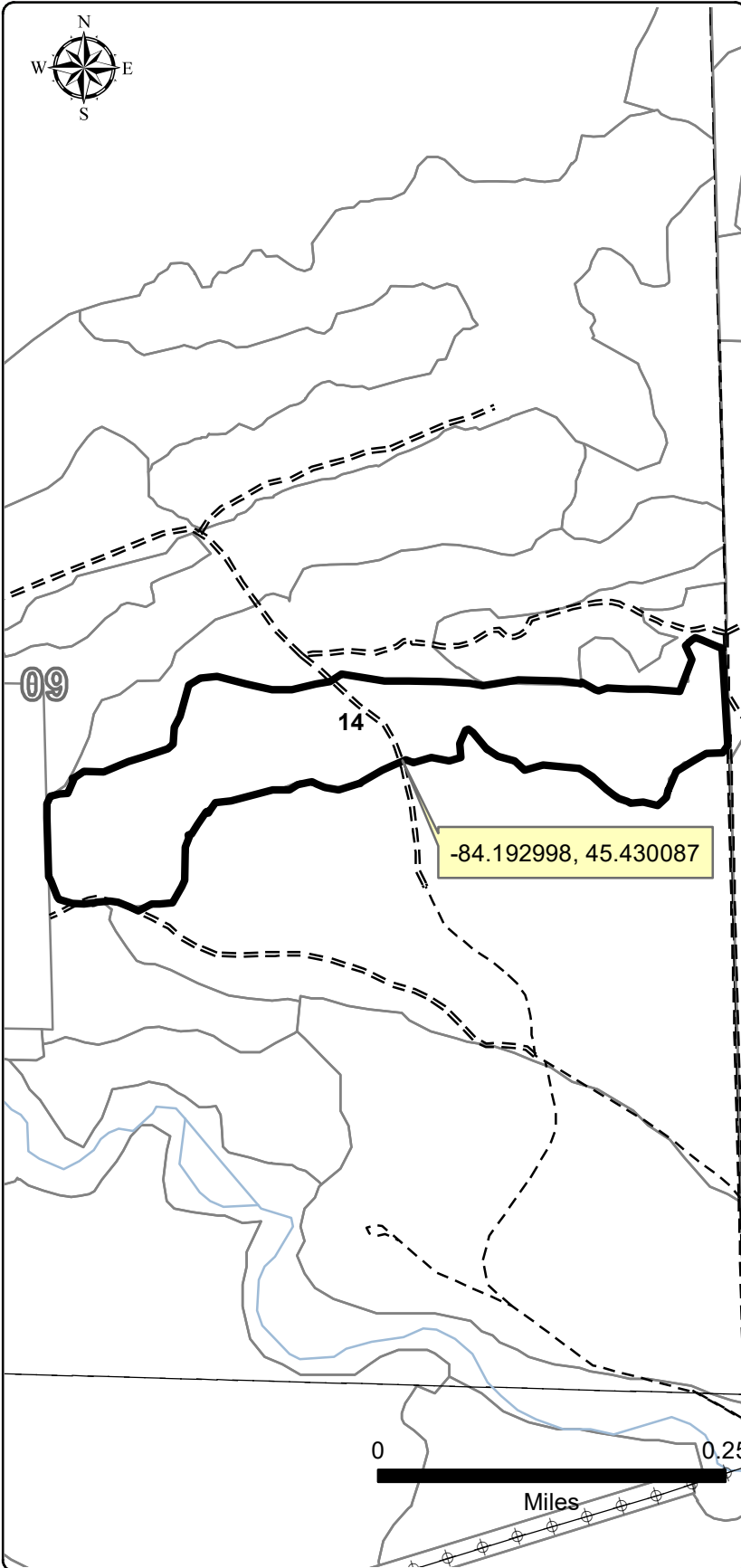

C54-1158



| | | | | | | |
|------------------------|-------------|--------------|--------------------------------------|-------------|-----------------------|----------------|
| County Presque Isle | Town 35N | Range 02E | Subdivision Section 9: NWSE, NESE | YOE 2021 | Compartment(s) 145 | Stand(s) 14 |
|------------------------|-------------|--------------|--------------------------------------|-------------|-----------------------|----------------|



| | | | |
|-----------------------|--|--------|-------------|
| Cover Type Objective: | PLANTED RP | Acres: | 23.6 |
| Approved Methods: | Trench & plant RP. Site prep & release treatments may include chopping, herbicide & pre-commercial thinning. | | |
| Treatment Number(s): | 54145014 | | |
| Timber Sale Number: | 54-006-17-01 | | |
| Sale Admin Staff: | Zimmerman | | |
| Contract TCR Date: | 9/14/2020 | | |
| Comments: | Flat area. Parent stand was large red pine with a lower density. Had large tops and chipping was not used due to no markets. Had very little understory before harvesting. | | |

| Proofing Comments | |
|-------------------|---|
| Recreation: | No ORV Route & Snowmobile trail w/in 500-ft |
| Water: | No water w/in 500-ft |
| HAL: | No hits w/in Rx areas |
| MNFI: | No hits on MNFI |
| Other Comments: | |

- Legend**
- Designated ATV Trails
 - C54-1158 Boundary
 - Stand Boundary
 - DNR - Primary Forest Road
 - DNR - Secondary Forest Road
 - DNR - Forest Access Route
 - Federal / State Highway
 - Federal / State / County - Paved Road
 - Federal / State - Dirt / Gravel Road
 - County - Gravel Road
 - County - Dirt Road (Seasonal)
 - Private - Paved Road
 - Private - Dirt / Gravel Road
 - Lakes and Rivers All
 - Pipeline
 - Powerline
 - Sections