

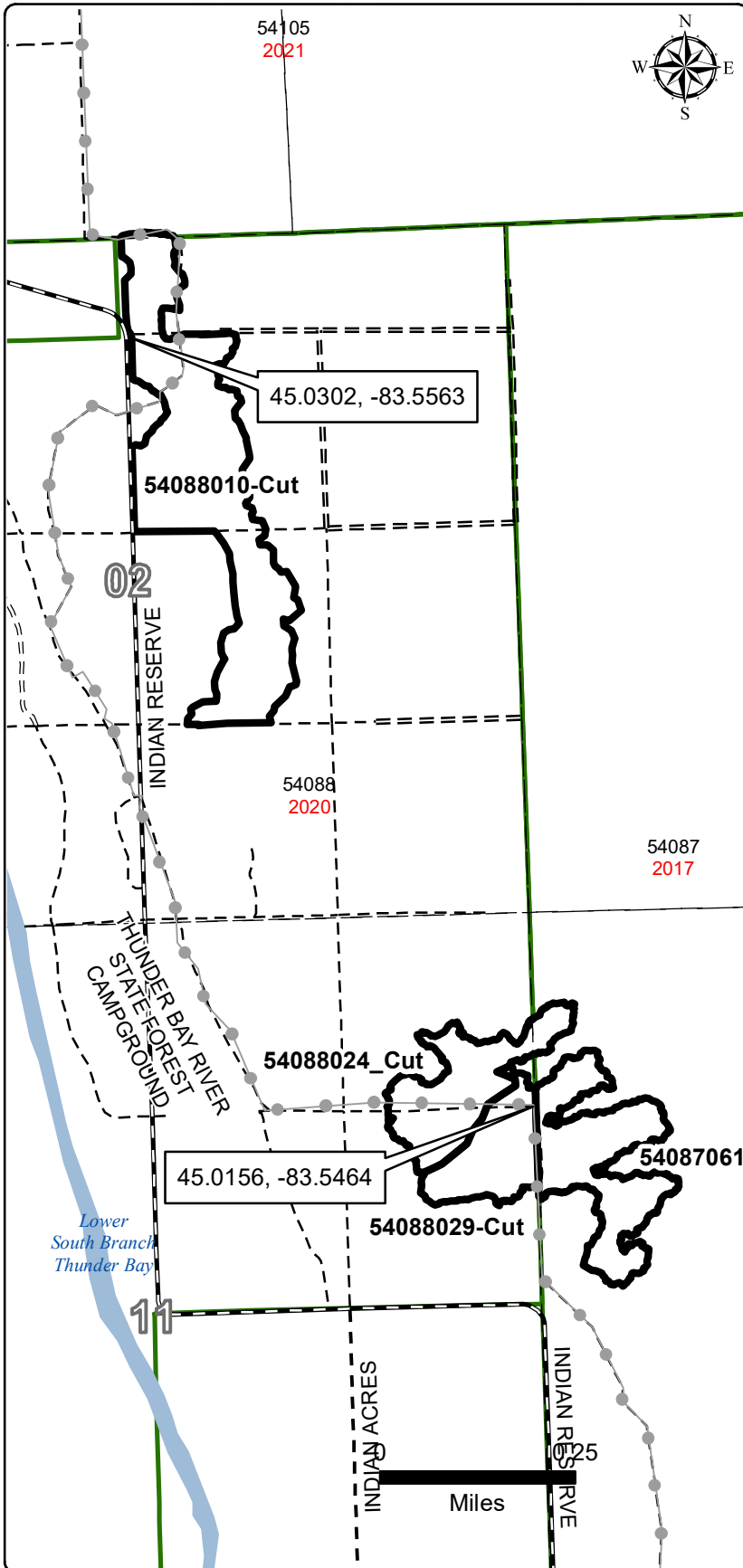

C54-1171

| | | | | | | |
|------------------|-------------|--------------|---------------------------------------|---------------------|----------------------------|--------------------------------|
| County Alpena | Town 30N | Range 07E | Subdivision Sections 2, 11, and 12 | YOE 2020 2017 | Compartment(s) 88 87 | Stand(s) :10, 24, 29 :61 |
|------------------|-------------|--------------|---------------------------------------|---------------------|----------------------------|--------------------------------|



| | |
|--|-----------------------------|
| Cover Type Objective: Planted Red Pine | Acres: 77.6 |
| Approved Methods: Use mechanical and herbicide site prep as needed, based on site specific conditions, for the planting of red pine as determined by the TMS and forestry field staff. Monitor after 1st and 3rd year. Release herbicide/PCT as needed. | |
| Treatment Number(s): 54088010, 54088024, 54088029, and 54087061 | |
| Timber Sale Number: | 54-035-020 |
| Sale Admin Staff: | D. Parris |
| Contract TCR Date: | TBD; Reserved Red Pine Sale |
| Comments: 54088010 is planned for trenched planting and 54088024, 54088029, 54087061 are planned for flat/unfurrowed planting due to a high water table. | |

| Proofing Comments | |
|-------------------|--|
| Recreation: | Snowmobile trail is present in all stands |
| Water: | No water w/in 500-ft |
| HAL: | Archaeological HIt in Section 11 not within treatments per Compartment Review. |
| MNFI: | No hits on MNFI |
| Other Comments: | Protect recreation trails and roads as mapped. |

| Legend | |
|--------|--------------------------------------|
| | C54-1171_Treatments |
| | Designated Snowmobile Trails |
| | DNR - Secondary Forest Road |
| | DNR - Forest Access Route |
| | Federal / State - Dirt / Gravel Road |
| | County - Gravel Road |
| | County - Dirt Road (Seasonal) |
| | Lakes and Rivers All |

