

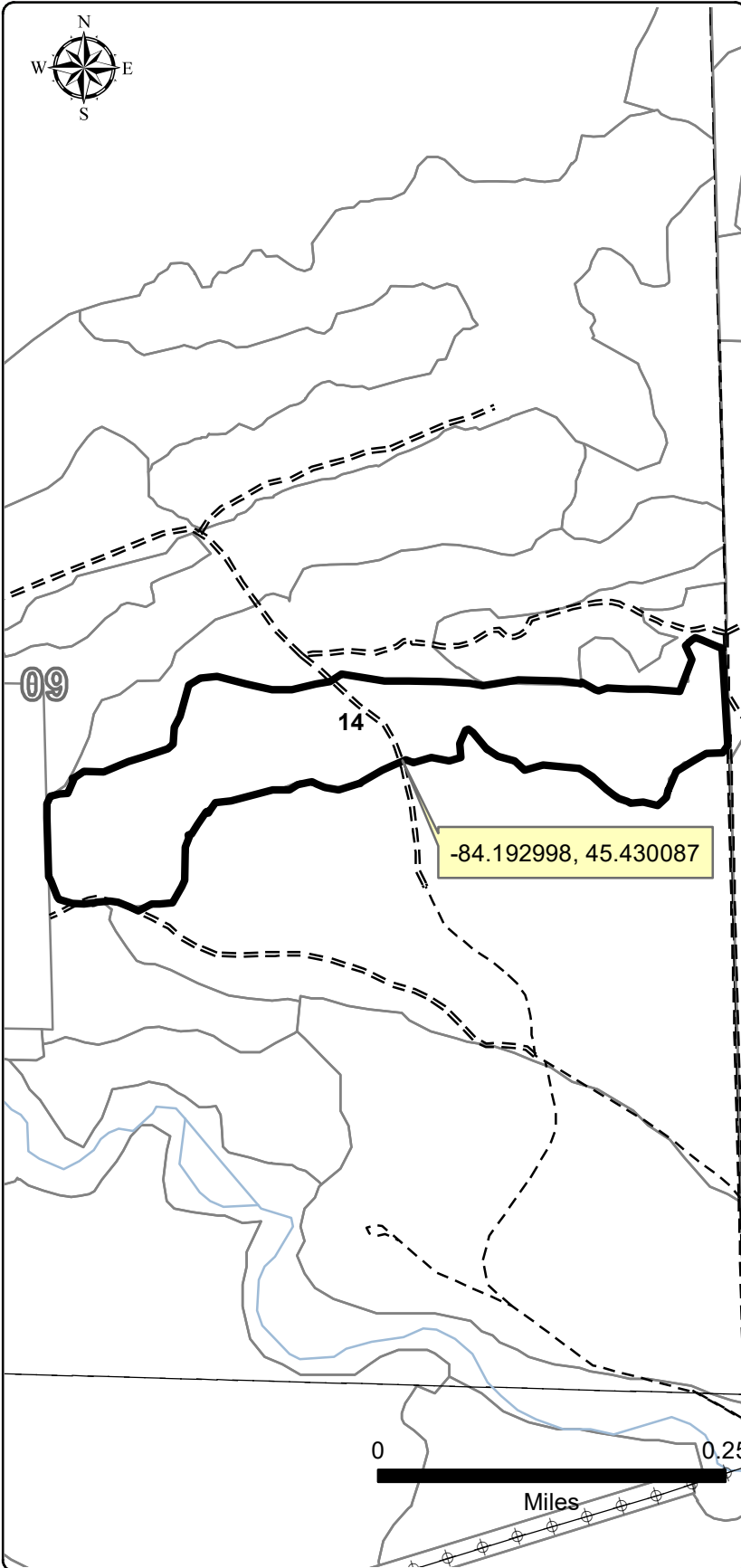

# C54-1158



County Presque Isle	Town 35N	Range 02E	Subdivision Section 9: NWSE, NESE	YOE 2021	Compartment(s) 145	Stand(s) 14
------------------------	-------------	--------------	--------------------------------------	-------------	-----------------------	----------------



Cover Type Objective:	PLANTED RP	Acres:	<b>23.6</b>
Approved Methods:	Trench & plant RP. Site prep & release treatments may include chopping, herbicide & pre-commercial thinning.		
Treatment Number(s):	54145014		
Timber Sale Number:	54-006-17-01		
Sale Admin Staff:	Zimmerman		
Contract TCR Date:	9/14/2020		
Comments:	Flat area. Parent stand was large red pine with a lower density. Had large tops and chipping was not used due to no markets. Had very little understory before harvesting.		

Proofing Comments	
Recreation:	No ORV Route & Snowmobile trail w/in 500-ft
Water:	No water w/in 500-ft
HAL:	No hits w/in Rx areas
MNFI:	No hits on MNFI
Other Comments:	

- Legend**
- Designated ATV Trails
  - C54-1158 Boundary
  - Stand Boundary
  - DNR - Primary Forest Road
  - DNR - Secondary Forest Road
  - DNR - Forest Access Route
  - Federal / State Highway
  - Federal / State / County - Paved Road
  - Federal / State - Dirt / Gravel Road
  - County - Gravel Road
  - County - Dirt Road (Seasonal)
  - Private - Paved Road
  - Private - Dirt / Gravel Road
  - Lakes and Rivers All
  - Pipeline
  - Powerline
  - Sections