



TIMBER SALE MAP

This information provided by authority of Part 525, 1994 PA 451, as amended.

Sale Number 54-026-24	Date 07/17/2024
Scale 1:7,920	Page 1
	Of 1

Forest Management Unit Atlanta Mgt Unit	County Montmorency	Mapped By:
		Cruised By:

Township 31N	Range 04E	Section(s) and Subdivision(s) Sec. 17 E1/2SW,SWSE;
------------------------	---------------------	--

Cover Type			
A = Aspen	J = Jack Pine	O = Oak	U = Upland Brush
B = Paper Birch	K = Rock	P = Lowland Poplar	UM = Upland Mix Forest
C = Cedar	L = Lowland Brush	Q = Mixed Swamp Conifer	V = Bog or Marsh
D = Treed Bog	LM = Lowland Mix Forest	R = Red Pine	W = White Pine
E = Swamp Hardwoods	M = Maple, Beech, Birch	S = Black Spruce	X = Non Stocked
F = Spruce/Fir	MC = Mixed Conifer	T = Tamarack	Y = Sand
G = Grass	MD = Mixed Deciduous	Z = Water	
H = Hemlock	N = Marsh		

Density	
0 = Non Stocked	5 = Pole Timber Medium
1 = Seedling Sapling Poor	6 = Pole Timber Well
2 = Seedling Sapling Medium	7 = Saw Timber Poor
3 = Seedling Sapling Well	8 = Saw Timber Medium
4 = Pole Timber Poor	9 = Saw Timber Well

PU #	Acres
1	12.8
2	13.3
3	14

Blueberry Red Pine

40.2 Acres

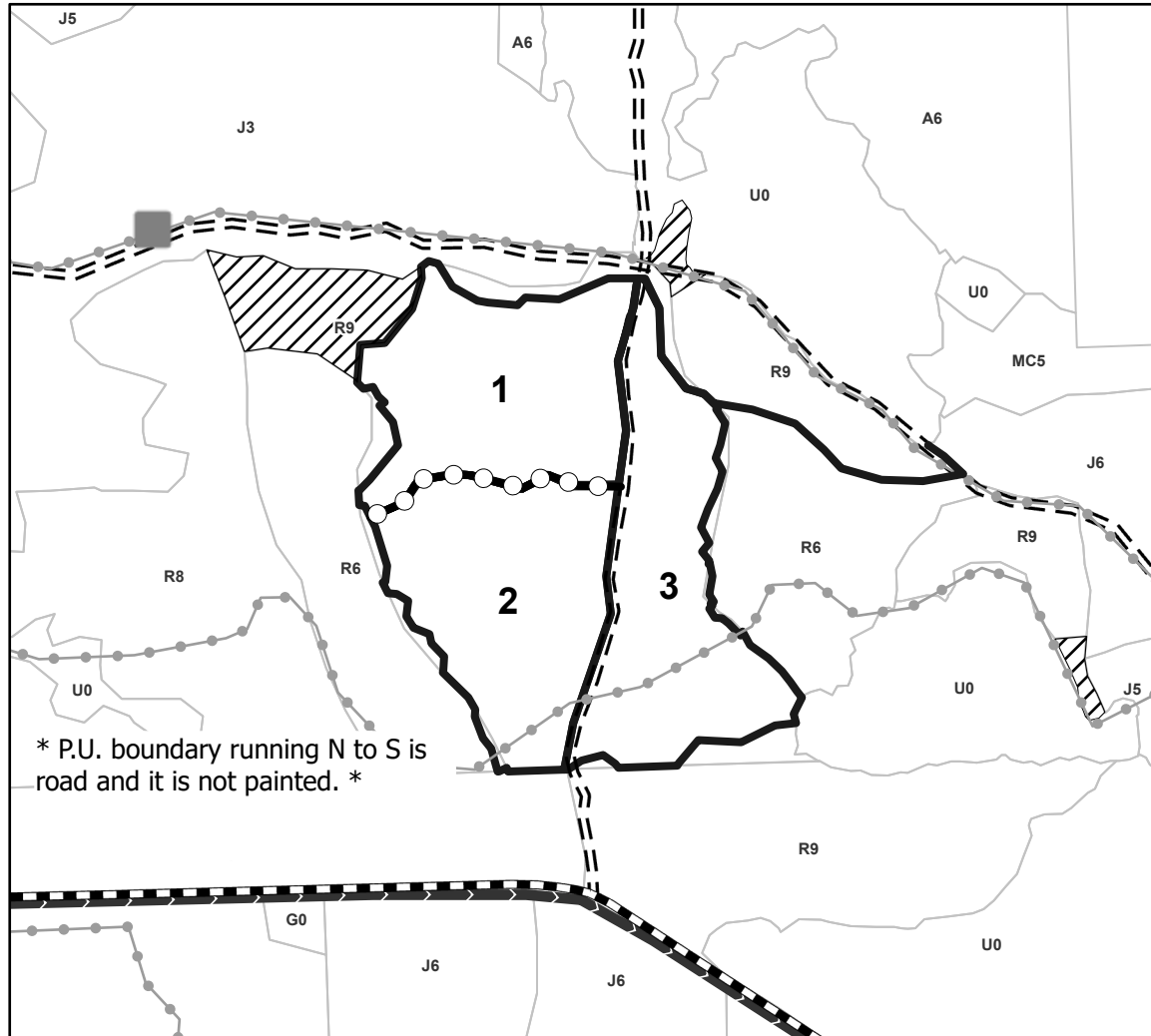
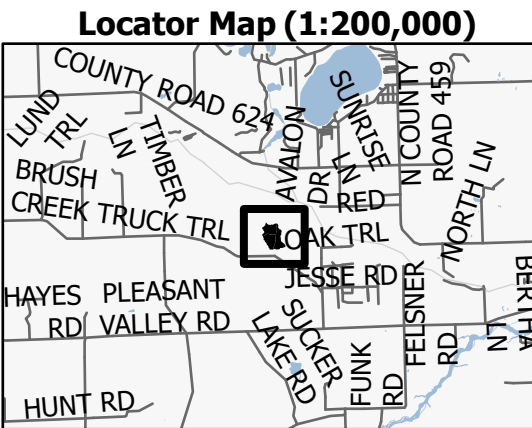

Legend

- Sale Boundary - Red Paint
- Stand
- Retention Areas
- Against State (Yellow)
- Payment Unit (Yellow)
- Recreational Trail
- Pipeline
- Primary Forest Road
- Forest Access Route
- Administrative Access Only
- Paved Road
- Government Gravel/Dirt
- Private Gravel/Dirt

* P.U. boundary running N to S is road and it is not painted. *

Use QR Code to open Map in App

