



TIMBER SALE MAP

This information provided by authority of Part 525, 1994 PA 451, as amended.

Forest Management Unit Baraga		County Iron	Mapped By Brodeur	Date 05/25/2022	Page 3	of 3
Township 46N	Range 36W	Section(s) and Subdivision(s) See Map		Scale 1:15,840		
Cruised By Baraga Staff						

Cover Type

A = Aspen	H = Hemlock	N = Marsh	U = Upland Brush
B = Paper Birch	J = Jack Pine	O = Oak	UM = Upland Mixed
C = Cedar	L = Lowland Brush	P = Lowland Poplar	V = Bog or Marsh
D = Treed Bog	LM = Lowland Mixed	Q = Mixed Swamp Conifer	W = White Pine
E = Swamp Hdwoods	M = Mpl, Bch, Brch	R = Red Pine	X = Non Stocked
F = Spruce Fir	MC = Mixed Conifer	S = Black Spruce	Z = Water
G = Grass	MD = Mixed Deciduous	T = Tamarack	

Density

0 = Non Stocked	5 = Pole Timber Medium
1 = Seedling Sapling Poor	6 = Pole Timber Well
2 = Seedling Sapling Medium	7 = Saw Timber Poor
3 = Seedling Sapling Well	8 = Saw Timber Medium
4 = Pole Timber Poor	9 = Saw Timber Well

Legend

- Ottawa Survey Corners
- Ottawa Access Roads
- Private
- Recreational Trail
- Perennial River
- Lakes and Rivers
- Against USFS (Orange)
- Private Line (Orange & Red)
- Nearby Timber Sales

GPS Location
46°23.973'N
88°47.67'W

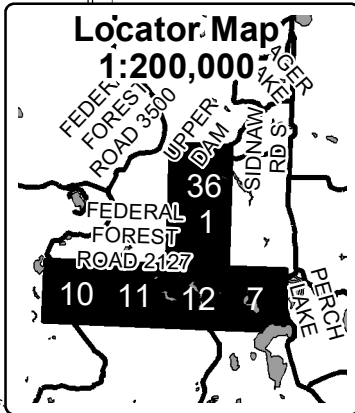
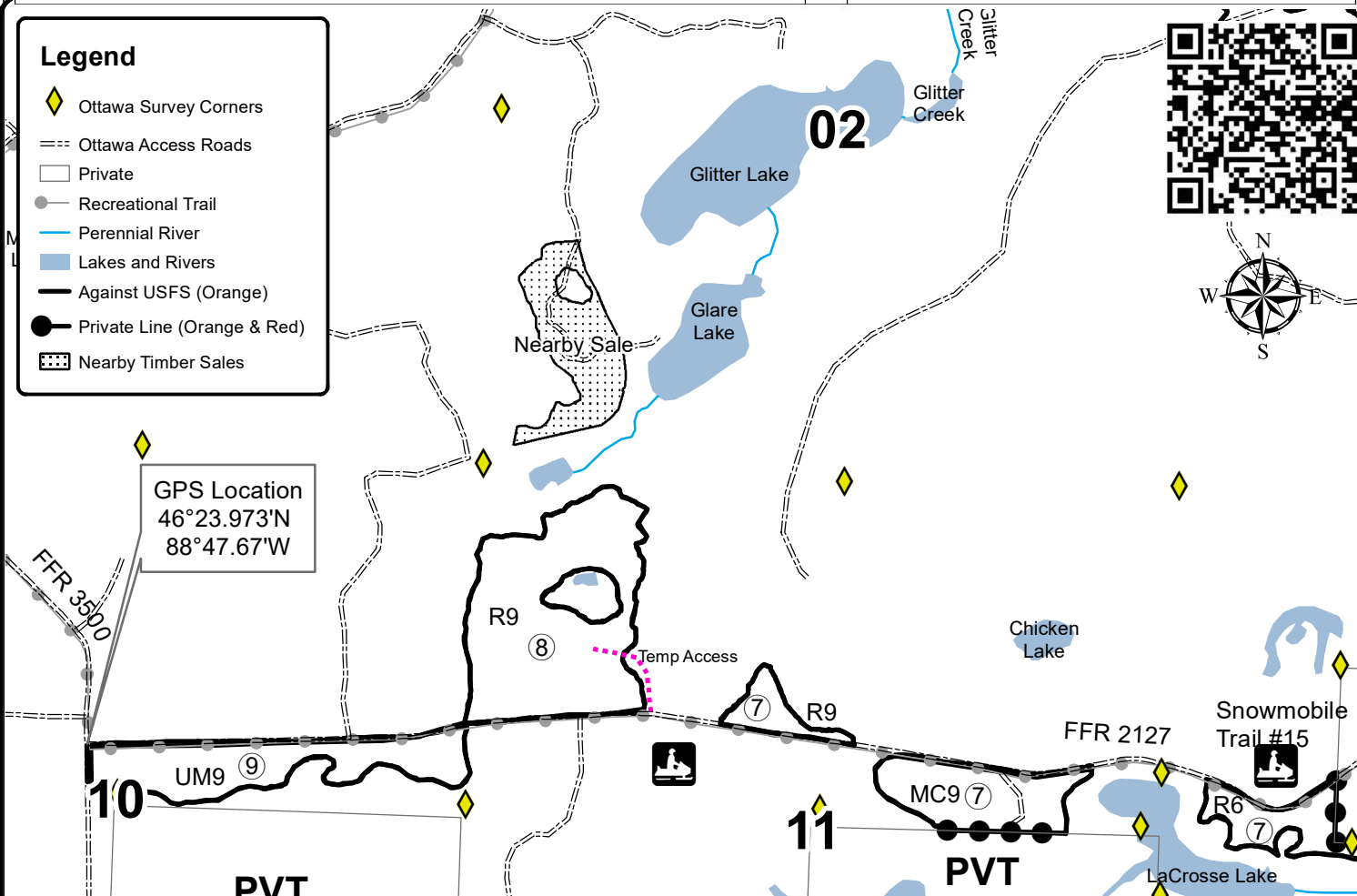
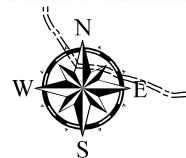

GNA2 Gosling												
Houghton & Iron County, Compartments 159, 160, 161, 182, 183 & 184												
UNIT	1	2	3	4	5	6	7	8	9	10	11 TOTALS	
ACRES	48.3	21.8	36.2	25.6	34.6	32.8	28.4	40.4	20.8	40.3	19.5	348.7
Sawlogs MBF												
Paper Birch			5.1				3.7			2.0		10.8
Red Maple			10.8			6.5				17.9		35.2
Red Pine	6.9	153.8	6.0		329.2	25.4	190.3	199.8				911.4
Sugar Maple									5.1			5.1
TOTAL	6.9	153.8	21.9	0.0	329.2	31.9	194.0	199.8	5.1	19.9	0.0	962.5
Pulpwood Cords												
Balsam Fir	31		23		31	5	6			12		108
Jack Pine	123		40	92	10		13	117			61	456
Mixed Aspen	434	109	768		89	882	57	40	192	883	365	3819
Mixed Hardwood	158	145	474		39	339	64	13	318	426	56	2032
Red Pine	21	92	19	279	113	95	205	103		26		953
White Pine	304		26		44	50			315	119	14	872
White Spruce	13											13
TOTAL	1084	346	1350	371	326	1371	345	273	825	1466	496	8253

