



### TIMBER SALE MAP

This information provided by authority of Part 525, 1994 PA 451, as amended.

Sale Number <b>11-012-24</b>	Date <b>04/22/2024</b>	
Scale <b>1:15,840</b>	Page <b>1</b>	Of <b>1</b>

Forest Management Unit <b>Baraga Mgt Unit</b>	County <b>Houghton</b>	Mapped By: <b>Ryan Mattila</b>
		Cruised By: <b>Ryan Mattila</b>

Township <b>51N</b>	Range <b>36W</b>	Section(s) and Subdivision(s) <b>Sec. 25 SWNE,NWSE;</b>
------------------------	---------------------	--

#### Cover Type

A = Aspen	J = Jack Pine	O = Oak	U = Upland Brush
B = Paper Birch	K = Rock	P = Lowland Poplar	UM = Upland Mix Forest
C = Cedar	L = Lowland Brush	Q = Mixed Swamp Conifer	V = Bog or Marsh
D = Treed Bog	LM = Lowland Mix Forest	R = Red Pine	W = White Pine
E = Swamp Hardwoods	M = Maple, Beech, Birch	S = Black Spruce	X = Non Stocked
F = Spruce/Fir	MC = Mixed Conifer	T = Tamarack	Y = Sand
G = Grass	MD = Mixed Deciduous	Z = Water	
H = Hemlock	N = Marsh		

#### Density

0 = Non Stocked	5 = Pole Timber Medium
1 = Seedling Sapling Poor	6 = Pole Timber Well
2 = Seedling Sapling Medium	7 = Saw Timber Poor
3 = Seedling Sapling Well	8 = Saw Timber Medium
4 = Pole Timber Poor	9 = Saw Timber Well

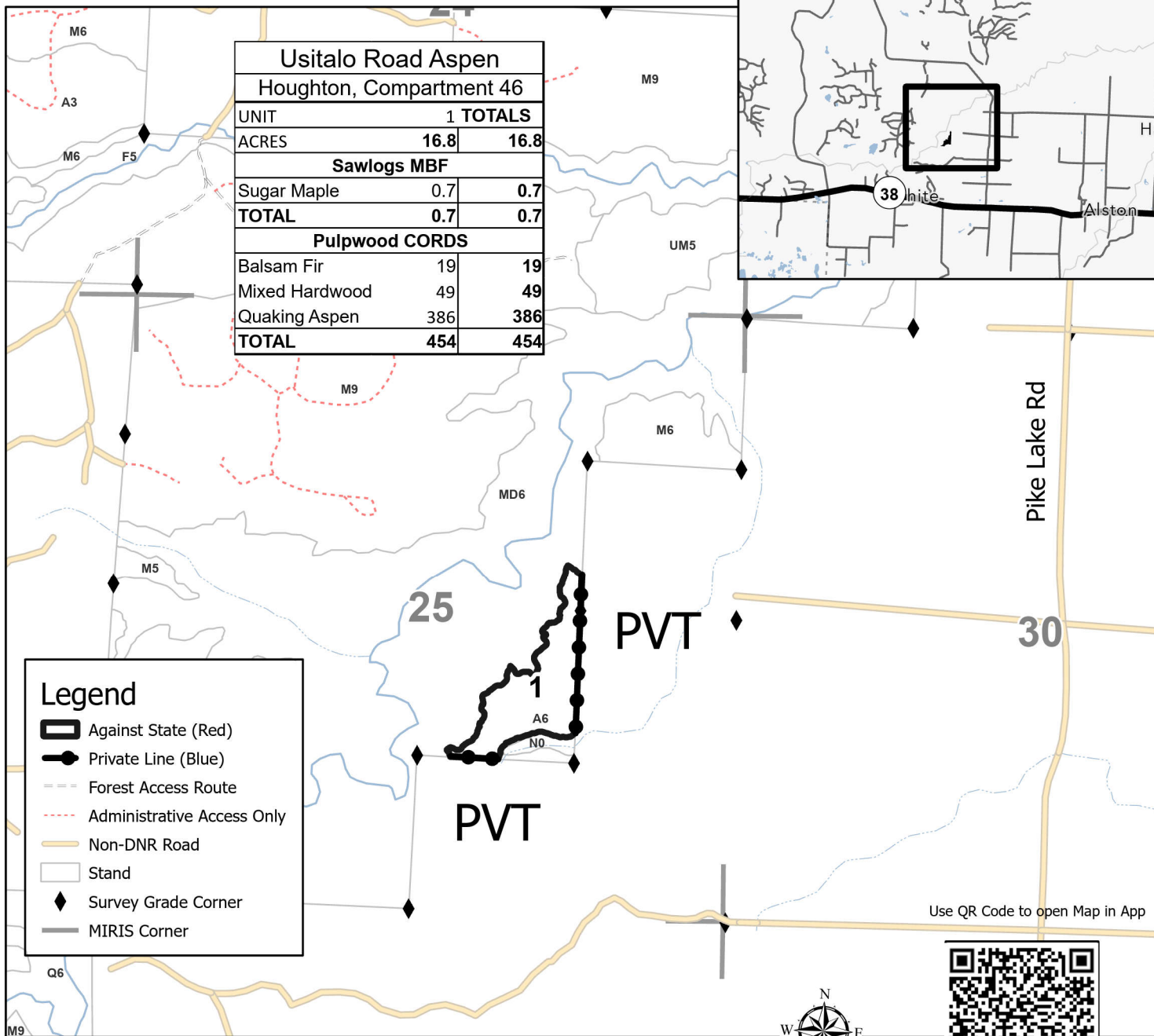
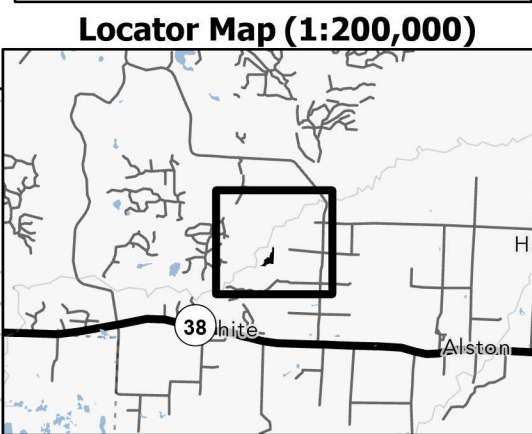

Usitalo Road Aspen		
Houghton, Compartment 46		
UNIT	1	TOTALS
ACRES	16.8	16.8
Sawlogs MBF		
Sugar Maple	0.7	0.7
<b>TOTAL</b>	<b>0.7</b>	<b>0.7</b>
Pulpwood CORDS		
Balsam Fir	19	19
Mixed Hardwood	49	49
Quaking Aspen	386	386
<b>TOTAL</b>	<b>454</b>	<b>454</b>

#### Legend

- Against State (Red)
- Private Line (Blue)
- Forest Access Route
- Administrative Access Only
- Non-DNR Road
- Stand
- Survey Grade Corner
- MIRIS Corner

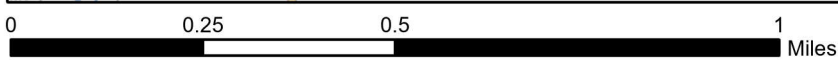

Use QR Code to open Map in App

