



TIMBER SALE MAP

This information provided by authority of Part 525, 1994 PA 451, as amended.

Forest Management Unit Escanaba FMU		County Dickinson	Mapped By Andy Church	Date 09/22/2023	Page 1	of 1
Township 43N	Range 27W	Section(s) and Subdivision(s) Sec 15: W1/2SW Sec 16: SENW,S1/2NE,N1/2SE,SESE		Scale 1:15,840		

Cover Type				Density	
A = Aspen	H = Hemlock	N = Marsh	U = Upland Brush	0 = Non Stocked	5 = Pole Timber Medium
B = Paper Birch	J = Jack Pine	O = Oak	UM = Upland Mixed	1 = Seedling Sapling Poor	6 = Pole Timber Well
C = Cedar	L = Lowland Brush	P = Lowland Poplar	V = Bog or Marsh	2 = Seedling Sapling Medium	7 = Saw Timber Poor
D = Treed Bog	LM = Lowland Mixed	Q = Mixed Swamp Conifer	W = White Pine	3 = Seedling Sapling Well	8 = Saw Timber Medium
E = Swamp Hdwoods	M = Mpl, Bch, Brch	R = Red Pine	X = Non Stocked	4 = Pole Timber Poor	9 = Saw Timber Well
F = Spruce Fir	MC = Mixed Conifer	S = Black Spruce	Z = Water		
G = Grass	MD = Mixed Deciduous	T = Tamarack			

PU	Acres	PU	Acres
1	8.2	4	24.5
2	31.8	5	43.2
3	14.7		

Popplesky
Compartment 27
122.4 Acres



QR code for GeoRef PDF

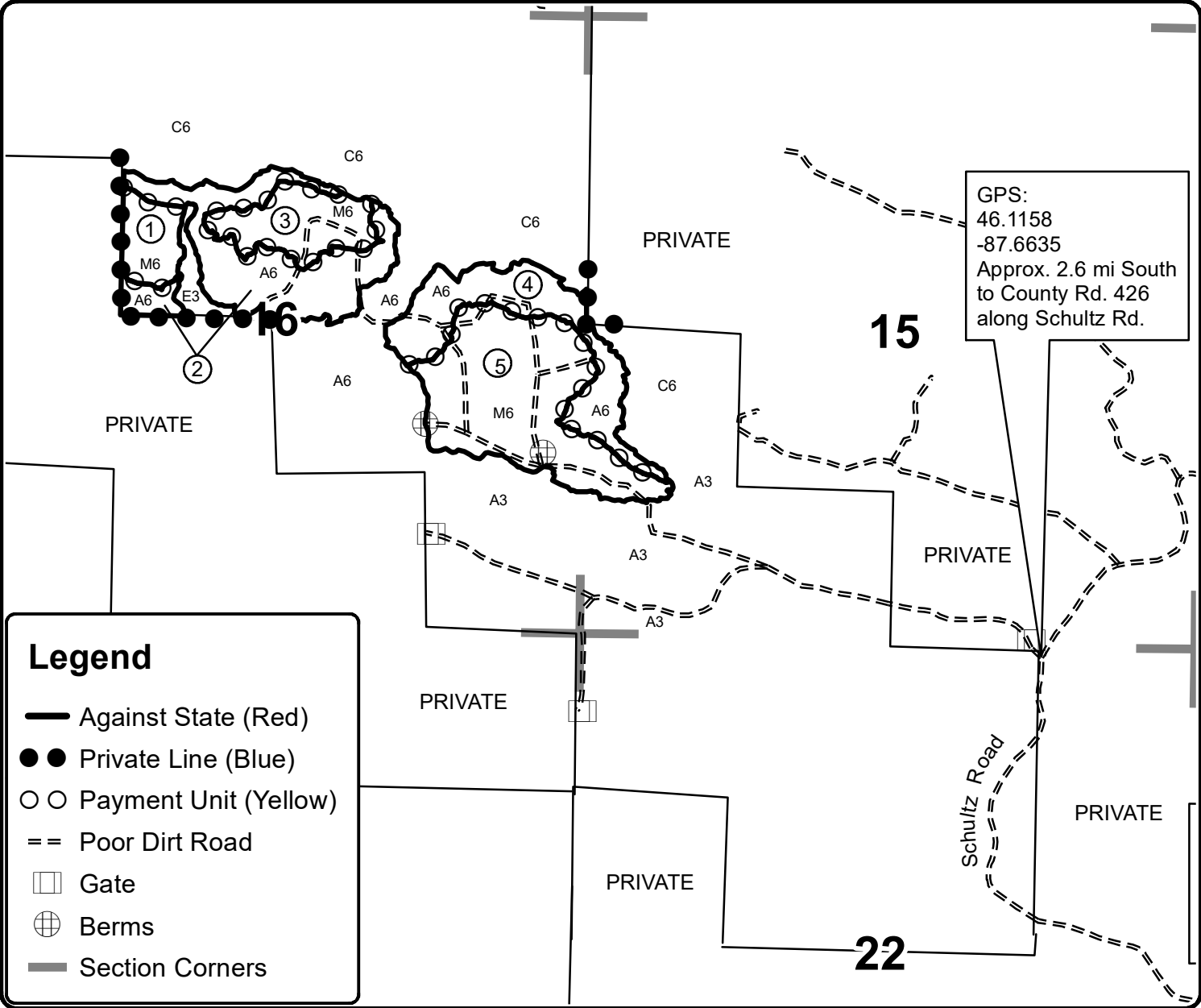

Legend

- Against State (Red)
- Private Line (Blue)
- Payment Unit (Yellow)
- == Poor Dirt Road
- Gate
- ⊕ Berms
- Section Corners

