



TIMBER SALE MAP

This information provided by authority of Part 525, 1994 PA 451, as amended.

| | | | | | | |
|------------------------------------|--------------|-------------------------------|----------------------------|----------------------------|-----------|---------|
| Forest Management Unit Escanaba | | County Dickinson | Mapped By Scott Sebero | Date 08/28/2023 | Page 2 | of 2 |
| Township 42N and 43N | Range 29W | Section(s) and Subdivision(s) | Cruised By Scott Sebero | Scale 4 inches = 1 mile | | |

| Cover Type | | | | Density | |
|-------------------|----------------------|-------------------------|-------------------|-----------------------------|------------------------|
| A = Aspen | H = Hemlock | N = Marsh | U = Upland Brush | 0 = Non Stocked | 5 = Pole Timber Medium |
| B = Paper Birch | J = Jack Pine | O = Oak | UM = Upland Mixed | 1 = Seedling Sapling Poor | 6 = Pole Timber Well |
| C = Cedar | L = Lowland Brush | P = Lowland Poplar | V = Bog or Marsh | 2 = Seedling Sapling Medium | 7 = Saw Timber Poor |
| D = Treed Bog | LM = Lowland Mixed | Q = Mixed Swamp Conifer | W = White Pine | 3 = Seedling Sapling Well | 8 = Saw Timber Medium |
| E = Swamp Hdwoods | M = Mpl, Bch, Brch | R = Red Pine | X = Non Stocked | 4 = Pole Timber Poor | 9 = Saw Timber Well |
| F = Spruce Fir | MC = Mixed Conifer | S = Black Spruce | Z = Water | | |
| G = Grass | MD = Mixed Deciduous | T = Tamarack | | | |

Wells Grade Mix

| | |
|--------------------------|--------------------|
| Unit 1 96.8 acres | Unit 7 90.9 acres |
| Unit 2 78.3 acres | Unit 8 55.5 acres |
| Unit 3 47.8 acres | Unit 9 45.9 acres |
| Unit 4 46.1 acres | Unit 10 46.5 acres |
| Unit 5 41.8 acres | Unit 11 35.5 acres |
| Unit 6 34.8 acres | Unit 12 30.7 acres |
| Total 650.6 acres | |

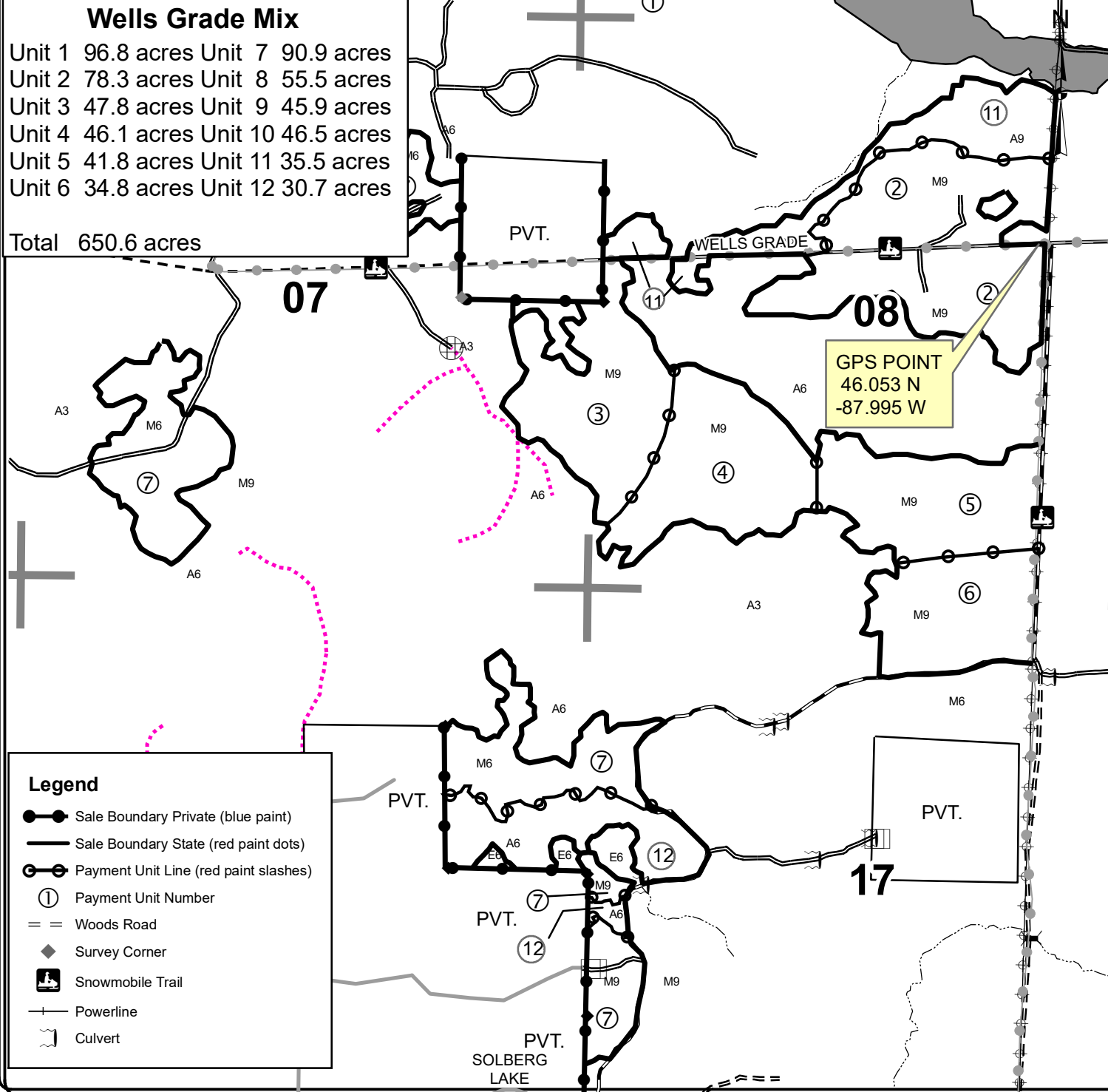

Legend

- Sale Boundary Private (blue paint)
- Sale Boundary State (red paint dots)
- Payment Unit Line (red paint slashes)
- Payment Unit Number
- Woods Road
- Survey Corner
- Snowmobile Trail
- Powerline
- Culvert