



TIMBER SALE MAP

This information provided by authority of Part 525, 1994 PA 451, as amended.

Forest Management Unit Escanaba Management Unit		County Menominee County	Mapped By Beaudo	Date 8/13/2019	Page 1	of 1
Township 36N 37N	Range 27W	Section(s) and Subdivision(s) T36N R27W Sec 5 - W1/2NW, Sec 6 - N1/2NE, SENE; T37N R27W Sec 32 - SWSW.		Scale 1:15,840		

Cover Type

A = Aspen	H = Hemlock	N = Marsh	U = Upland Brush
B = Paper Birch	J = Jack Pine	O = Oak	UM = Upland Mixed
C = Cedar	L = Lowland Brush	P = Lowland Poplar	V = Bog or Marsh
D = Treed Bog	LM = Lowland Mixed	Q = Mixed Swamp Conifer	W = White Pine
E = Swamp Hdwoods	M = Mpl, Bch, Brch	R = Red Pine	X = Non Stocked
F = Spruce Fir	MC = Mixed Conifer	S = Black Spruce	Z = Water
G = Grass	MD = Mixed Deciduous	T = Tamarack	

Density

0 = Non Stocked	5 = Pole Timber Medium
1 = Seedling Sapling Poor	6 = Pole Timber Well
2 = Seedling Sapling Medium	7 = Saw Timber Poor
3 = Seedling Sapling Well	8 = Saw Timber Medium
4 = Pole Timber Poor	9 = Saw Timber Well

PU	Acres
1	11.8
2	12.6
3	14.3
4	8.6

What's Left
Compartment 13
47.3 Acres

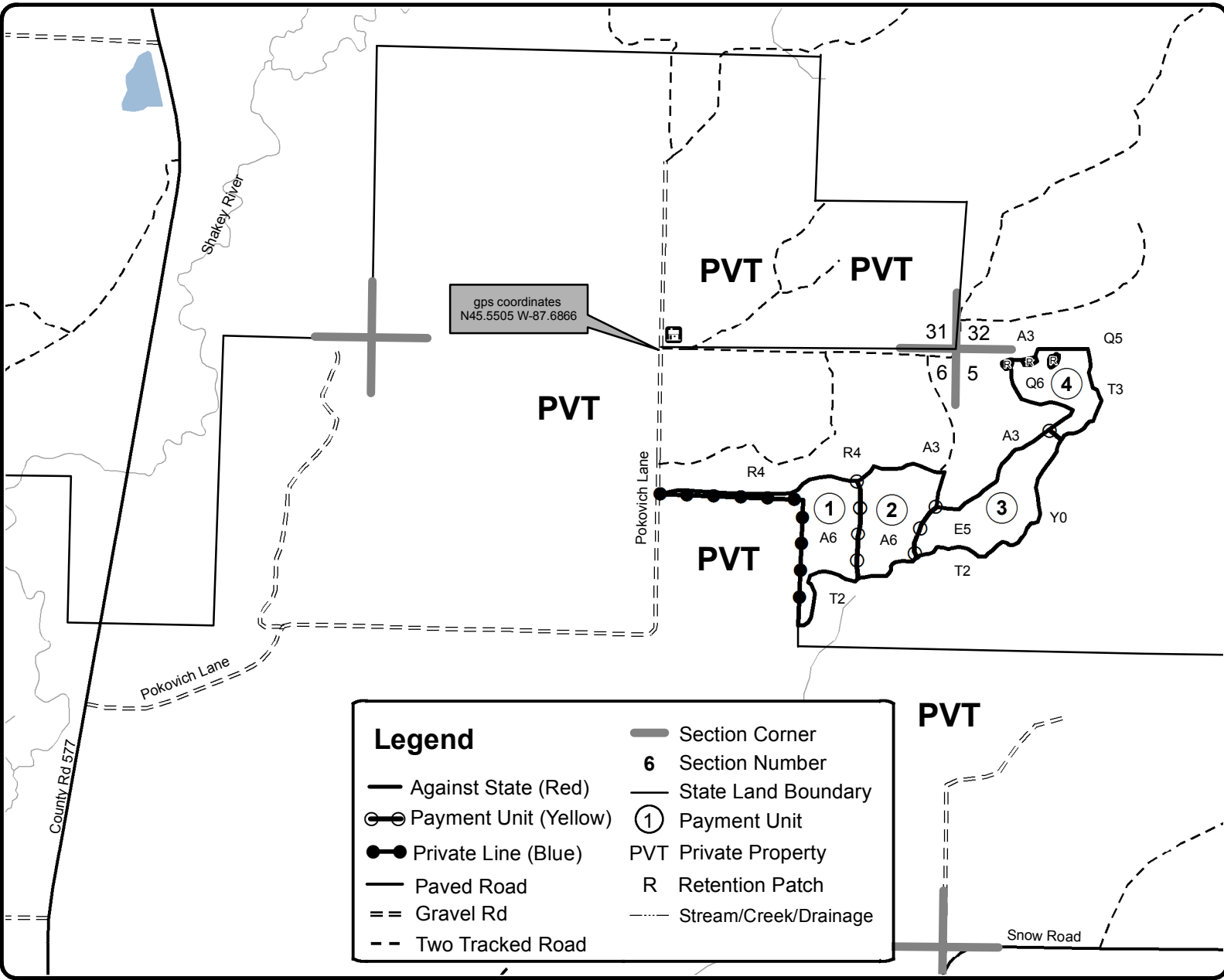

Legend	
	Against State (Red)
	Payment Unit (Yellow)
	Private Line (Blue)
	Paved Road
	Gravel Rd
	Two Tracked Road
	Section Corner
	6 Section Number
	State Land Boundary
	1 Payment Unit
	PVT Private Property
	R Retention Patch
	Stream/Creek/Drainage

