



TIMBER SALE MAP

This information provided by authority of Part 525, 1994 PA 451, as amended.

Forest Management Unit Escanaba Management Unit		County Menominee County	Mapped By Beaudo	Date 9/21/2019	Page 1	of 1
Township 37N	Range 27W	Section(s) and Subdivision(s) Sec 5 - E1/2SW, W1/2SE; Sec 8 - N1/2SW, SESW, NWSE, NENW, S1/2NW, N1/2NE, SWNE; Sec 9 - NWNW.		Scale 1:15,840		

Cover Type				Density	
A = Aspen	H = Hemlock	N = Marsh	U = Upland Brush	0 = Non Stocked	5 = Pole Timber Medium
B = Paper Birch	J = Jack Pine	O = Oak	UM = Upland Mixed	1 = Seedling Sapling Poor	6 = Pole Timber Well
C = Cedar	L = Lowland Brush	P = Lowland Poplar	V = Bog or Marsh	2 = Seedling Sapling Medium	7 = Saw Timber Poor
D = Treed Bog	LM = Lowland Mixed	Q = Mixed Swamp Conifer	W = White Pine	3 = Seedling Sapling Well	8 = Saw Timber Medium
E = Swamp Hdwoods	M = Mpl, Bch, Brch	R = Red Pine	X = Non Stocked	4 = Pole Timber Poor	9 = Saw Timber Well
F = Spruce Fir	MC = Mixed Conifer	S = Black Spruce	Z = Water		
G = Grass	MD = Mixed Deciduous	T = Tamarack			

PU	Acres	PU	Acres
1	11.9	7	9.4
2	5.8	8	14.4
3	16.4	9	11.8
4	12.5	10	15.1
5	9.5	11	20.5
6	8.8	12	7.8

Roadside Bud
Compartment 2
143.9 Acres

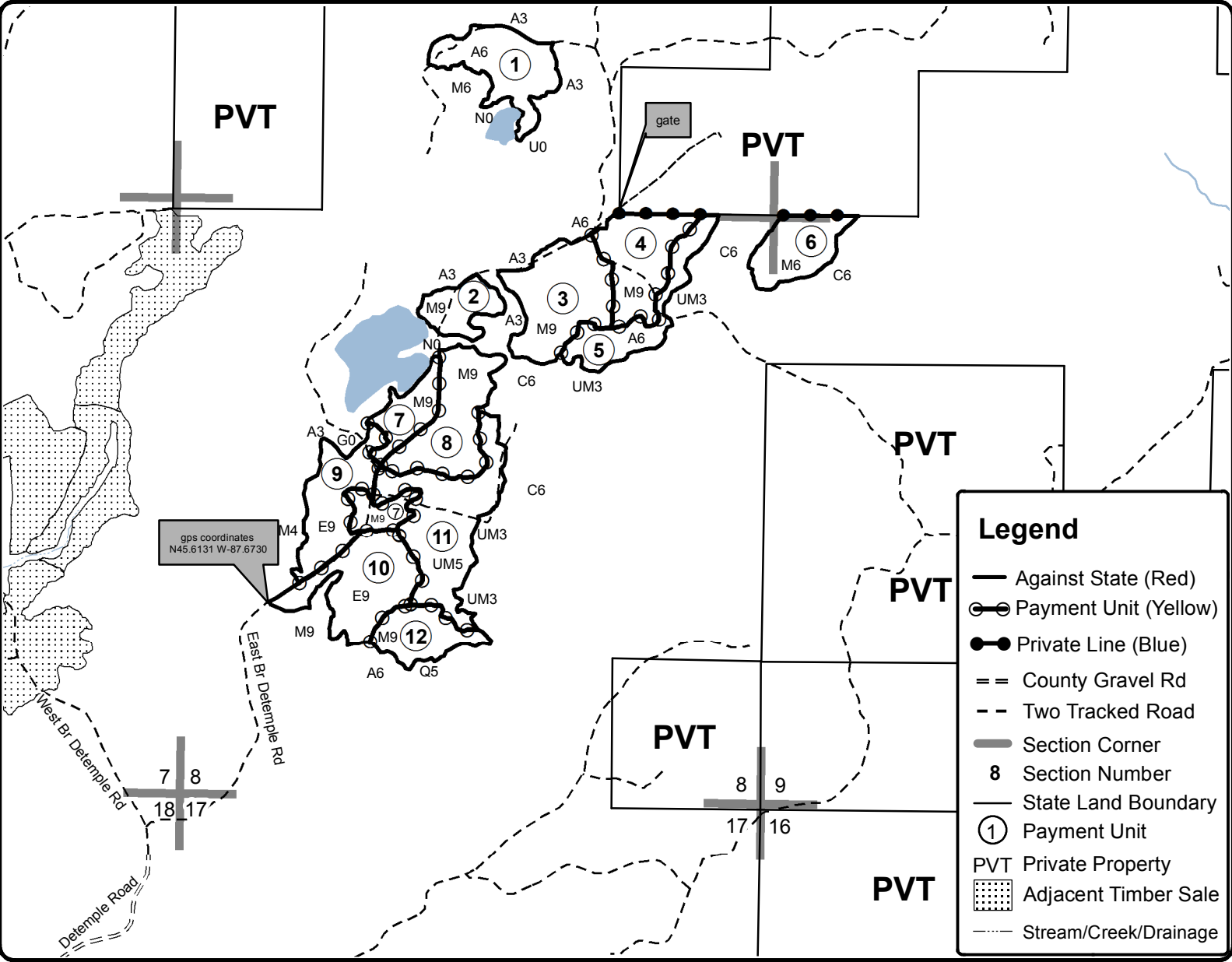

gps coordinates
N45.6131 W-87.6730

Legend

- Against State (Red)
- Payment Unit (Yellow)
- Private Line (Blue)
- == County Gravel Rd
- - Two Tracked Road
- Section Corner
- 8 Section Number
- State Land Boundary
- ① Payment Unit
- PVT Private Property
- ▨ Adjacent Timber Sale
- Stream/Creek/Drainage

