



TIMBER SALE MAP

This information provided by authority of Part 525, 1994 PA 451, as amended.

Forest Management Unit Escanaba Management Unit		County Delta County	Mapped By Urlich	Date 10/12/2020	Page 1	of 1
Township 41N	Range 22W	Section(s) and Subdivision(s) E1/2SE1/4 Sec22, SW1/4SW1/4 Sec23		Scale 1:4,976		
Cover Type				Density		
A = Aspen	H = Hemlock	N = Marsh	U = Upland Brush	0 = Non Stocked	5 = Pole Timber Medium	
B = Paper Birch	J = Jack Pine	O = Oak	UM = Upland Mixed	1 = Seedling Sapling Poor	6 = Pole Timber Well	
C = Cedar	L = Lowland Brush	P = Lowland Poplar	V = Bog or Marsh	2 = Seedling Sapling Medium	7 = Saw Timber Poor	
D = Treed Bog	LM = Lowland Mixed	Q = Mixed Swamp Conifer	W = White Pine	3 = Seedling Sapling Well	8 = Saw Timber Medium	
E = Swamp Hdwoods	M = Mpl, Bch, Brch	R = Red Pine	X = Non Stocked	4 = Pole Timber Poor	9 = Saw Timber Well	
F = Spruce Fir	MC = Mixed Conifer	S = Black Spruce	Z = Water			
G = Grass	MD = Mixed Deciduous	T = Tamarack				

PU	Acres
10A	10.7
10B	12

North of Days Stand 10

Compartment 106
22.7 Acres



Legend

- ◆ Survey Corners
 - Lakes and Rivers
 - State Boundary
 - ▨ Retention Area
 - Section Corners
- ### Streams
- Type
- Perennial River
 - Against State (Red)
 - Payment Unit (Yellow)
 - Private Line (Blue)

GPS Location
45.931002,-87.035160

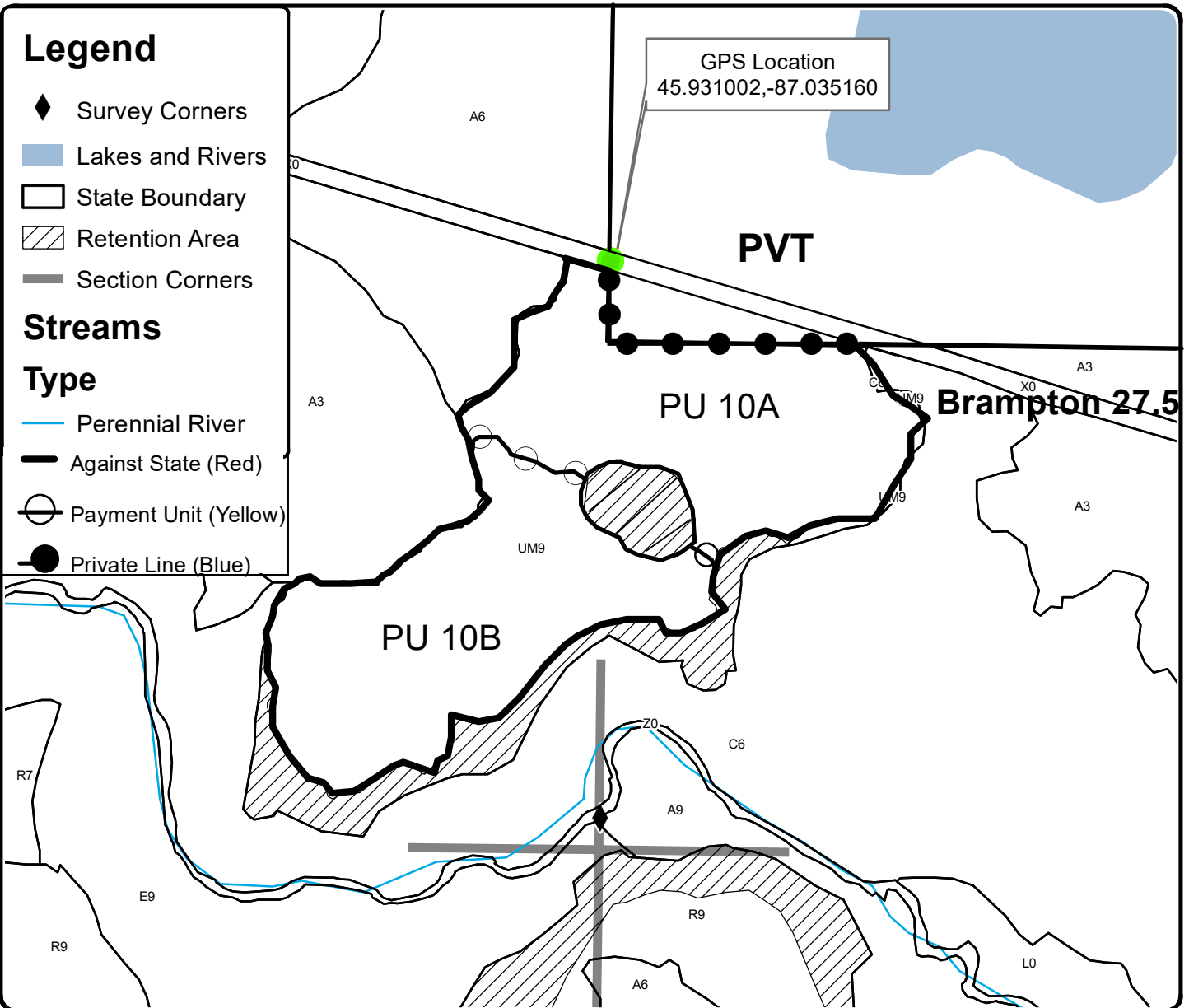

Brampton 27.5

