



# TIMBER SALE MAP

This information provided by authority of Part 525, 1994 PA 451, as amended.

Forest Management Unit Escanaba Management Unit		County Menominee County	Mapped By Beaudo	Date 2/21/2020	Page 1	of 1
Township 36N	Range 25W	Section(s) and Subdivision(s) Sec 11 - NE, N1/2SE, SESE; Sec 12 - NW		Scale 1:15,840		

### Cover Type

A = Aspen	H = Hemlock	N = Marsh	U = Upland Brush
B = Paper Birch	J = Jack Pine	O = Oak	UM = Upland Mixed
C = Cedar	L = Lowland Brush	P = Lowland Poplar	V = Bog or Marsh
D = Treed Bog	LM = Lowland Mixed	Q = Mixed Swamp Conifer	W = White Pine
E = Swamp Hdwoods	M = Mpl, Bch, Brch	R = Red Pine	X = Non Stocked
F = Spruce Fir	MC = Mixed Conifer	S = Black Spruce	Z = Water
G = Grass	MD = Mixed Deciduous	T = Tamarack	

### Density

0 = Non Stocked	5 = Pole Timber Medium
1 = Seedling Sapling Poor	6 = Pole Timber Well
2 = Seedling Sapling Medium	7 = Saw Timber Poor
3 = Seedling Sapling Well	8 = Saw Timber Medium
4 = Pole Timber Poor	9 = Saw Timber Well

## Snowy North Branch

### Compartment 40

#### 105.8 Acres

PU	Acres	PU	Acres
1	5.9	5	8.7
2	20.0	6	11.9
3	17.8	7	19.1
4	10.8	8	11.6

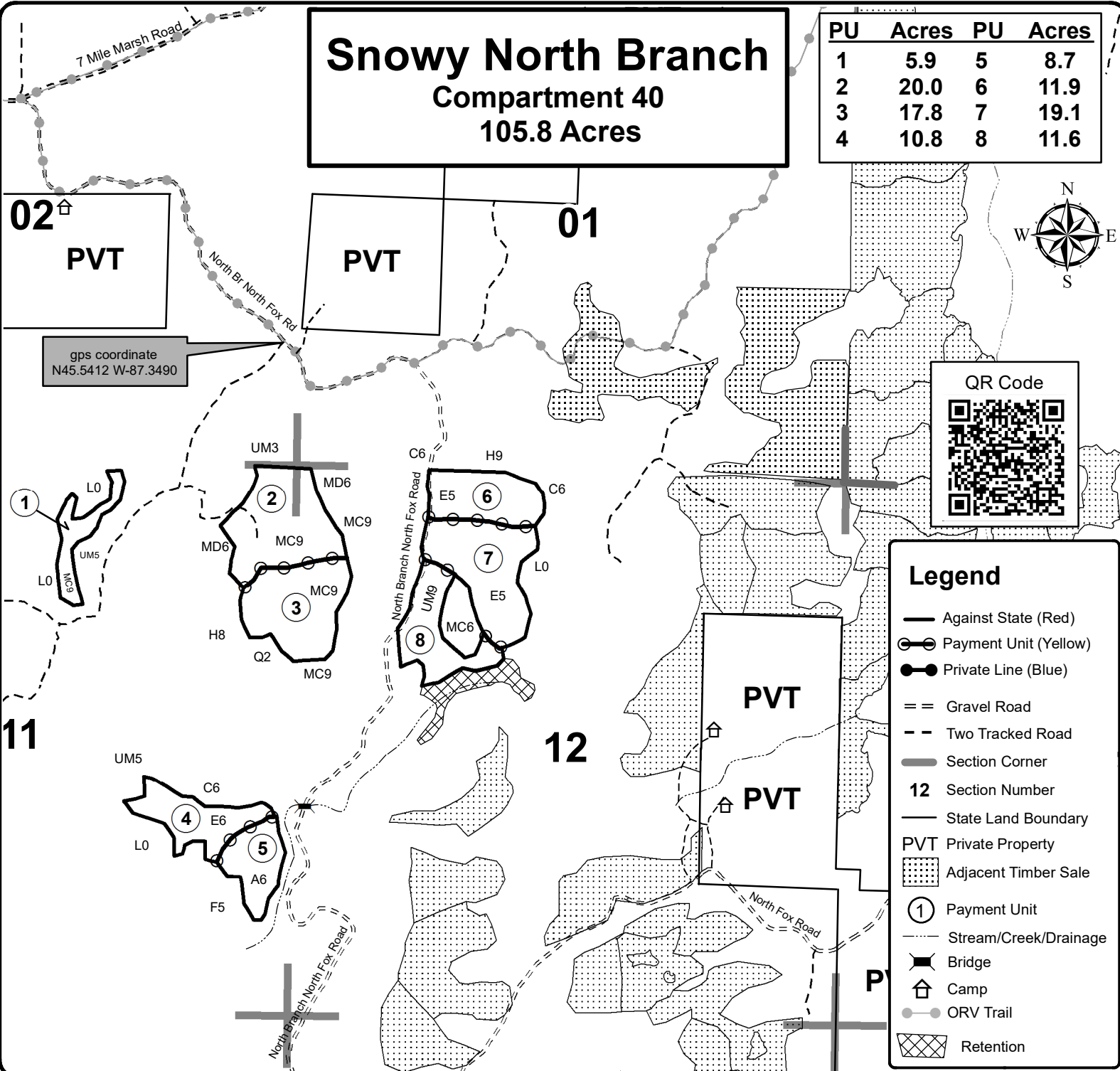

### Legend

- Against State (Red)
- Payment Unit (Yellow)
- Private Line (Blue)
- Gravel Road
- Two Tracked Road
- Section Corner
- 12** Section Number
- State Land Boundary
- PVT** Private Property
- Adjacent Timber Sale
- Payment Unit
- Stream/Creek/Drainage
- Bridge
- Camp
- ORV Trail
- Retention

