



TIMBER SALE MAP

This information provided by authority of Part 525, 1994 PA 451, as amended.

Forest Management Unit Escanaba Management Unit		County Menominee County	Mapped By Beaudo	Date 11/10/2020	Page 1	of 1
Township 35N	Range 25W	Section(s) and Subdivision(s) Sec 12 - SWSW; Sec 13 - NW, W1/2NE, N1/2SW, SESW; Sec 14 - NESE.		Scale 1:15,840		
Cover Type				Density		
A = Aspen	H = Hemlock	N = Marsh	U = Upland Brush	0 = Non Stocked	5 = Pole Timber Medium	
B = Paper Birch	J = Jack Pine	O = Oak	UM = Upland Mixed	1 = Seedling Sapling Poor	6 = Pole Timber Well	
C = Cedar	L = Lowland Brush	P = Lowland Poplar	V = Bog or Marsh	2 = Seedling Sapling Medium	7 = Saw Timber Poor	
D = Treed Bog	LM = Lowland Mixed	Q = Mixed Swamp Conifer	W = White Pine	3 = Seedling Sapling Well	8 = Saw Timber Medium	
E = Swamp Hdwoods	M = Mpl, Bch, Brch	R = Red Pine	X = Non Stocked	4 = Pole Timber Poor	9 = Saw Timber Well	
F = Spruce Fir	MC = Mixed Conifer	S = Black Spruce	Z = Water			
G = Grass	MD = Mixed Deciduous	T = Tamarack				

Old Mill Mix Compartment 50 194.1 Acres

PU	Acres	PU	Acres
1	8.2	7	6.2
2	13.2	8	9.4
3	30.3	9	23.9
4	23.2	10	28.3
5	18.8	11	25.8
6	6.8		

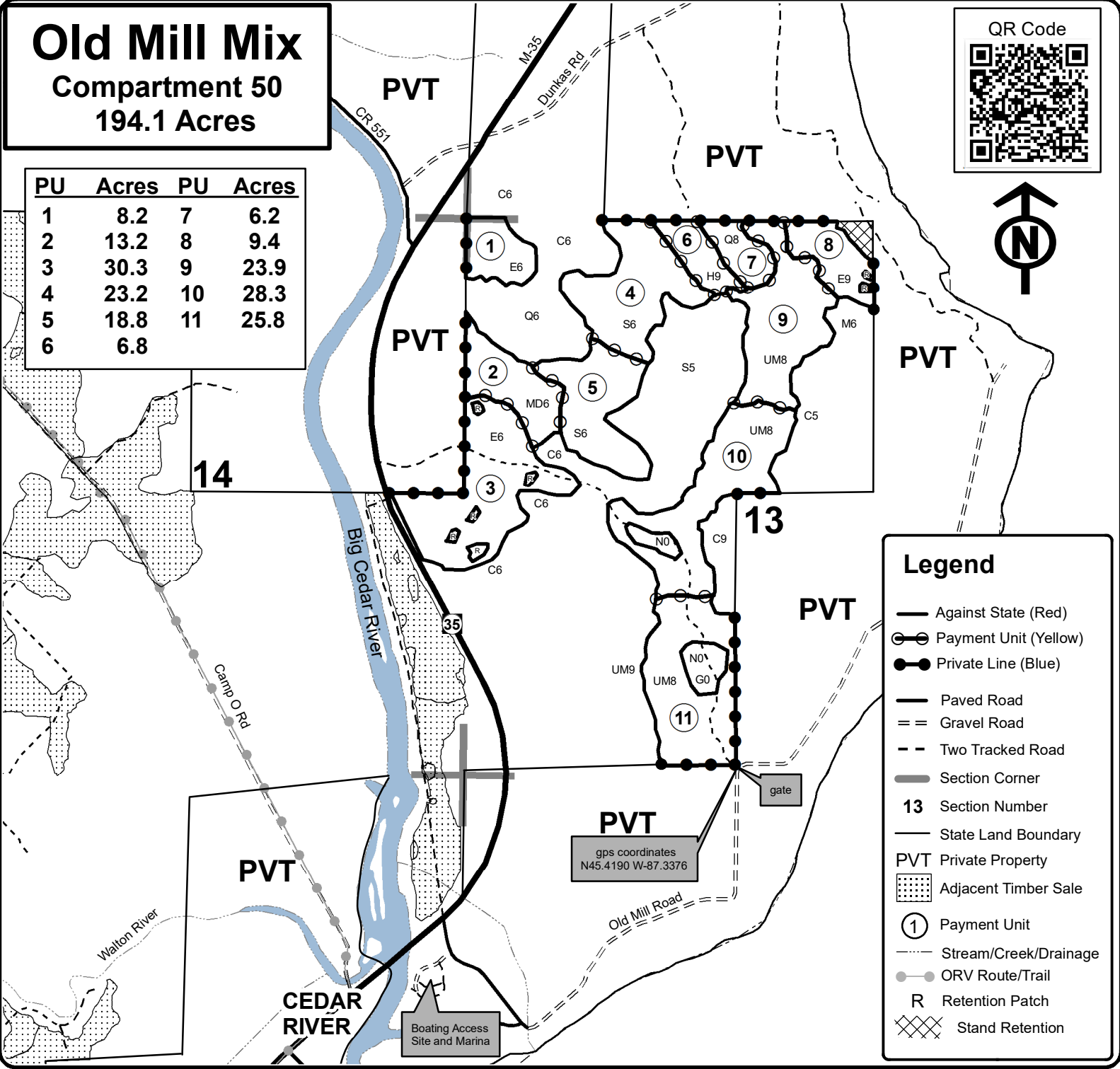
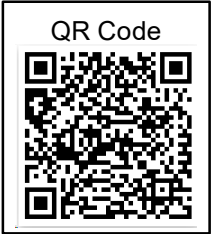

Legend

- Against State (Red)
- Payment Unit (Yellow)
- Private Line (Blue)
- Paved Road
- Gravel Road
- Two Tracked Road
- Section Corner
- 13** Section Number
- State Land Boundary
- PVT** Private Property
- Adjacent Timber Sale
- Payment Unit
- Stream/Creek/Drainage
- ORV Route/Trail
- R** Retention Patch
- Stand Retention

