



TIMBER SALE MAP

This information provided by authority of Part 525, 1994 PA 451, as amended.

Forest Management Unit Escanaba Management Unit	County Menominee County	Mapped By Beudo	Date 5/19/2021	Page 1	of 1
Township 34N	Range 28W	Section(s) and Subdivision(s) Sec 6 - S1/2NW, S1/2NE, N1/2SW, N1/2SE; Sec 7 - S1/2NE, NWSE.	Scale 1:15,840		

Cover Type				Density	
A = Aspen	H = Hemlock	N = Marsh	U = Upland Brush	0 = Non Stocked	5 = Pole Timber Medium
B = Paper Birch	J = Jack Pine	O = Oak	UM = Upland Mixed	1 = Seedling Sapling Poor	6 = Pole Timber Well
C = Cedar	L = Lowland Brush	P = Lowland Poplar	V = Bog or Marsh	2 = Seedling Sapling Medium	7 = Saw Timber Poor
D = Treed Bog	LM = Lowland Mixed	Q = Mixed Swamp Conifer	W = White Pine	3 = Seedling Sapling Well	8 = Saw Timber Medium
E = Swamp Hdwoods	M = Mpl, Bch, Brch	R = Red Pine	X = Non Stocked	4 = Pole Timber Poor	9 = Saw Timber Well
F = Spruce Fir	MC = Mixed Conifer	S = Black Spruce	Z = Water		
G = Grass	MD = Mixed Deciduous	T = Tamarack			

PU	Acres	PU	Acres
1	10.3	4	11.2
2	13.3	5	30.0
3	10.7		

Sturgeon Pine
Compartment 29
75.5 Acres

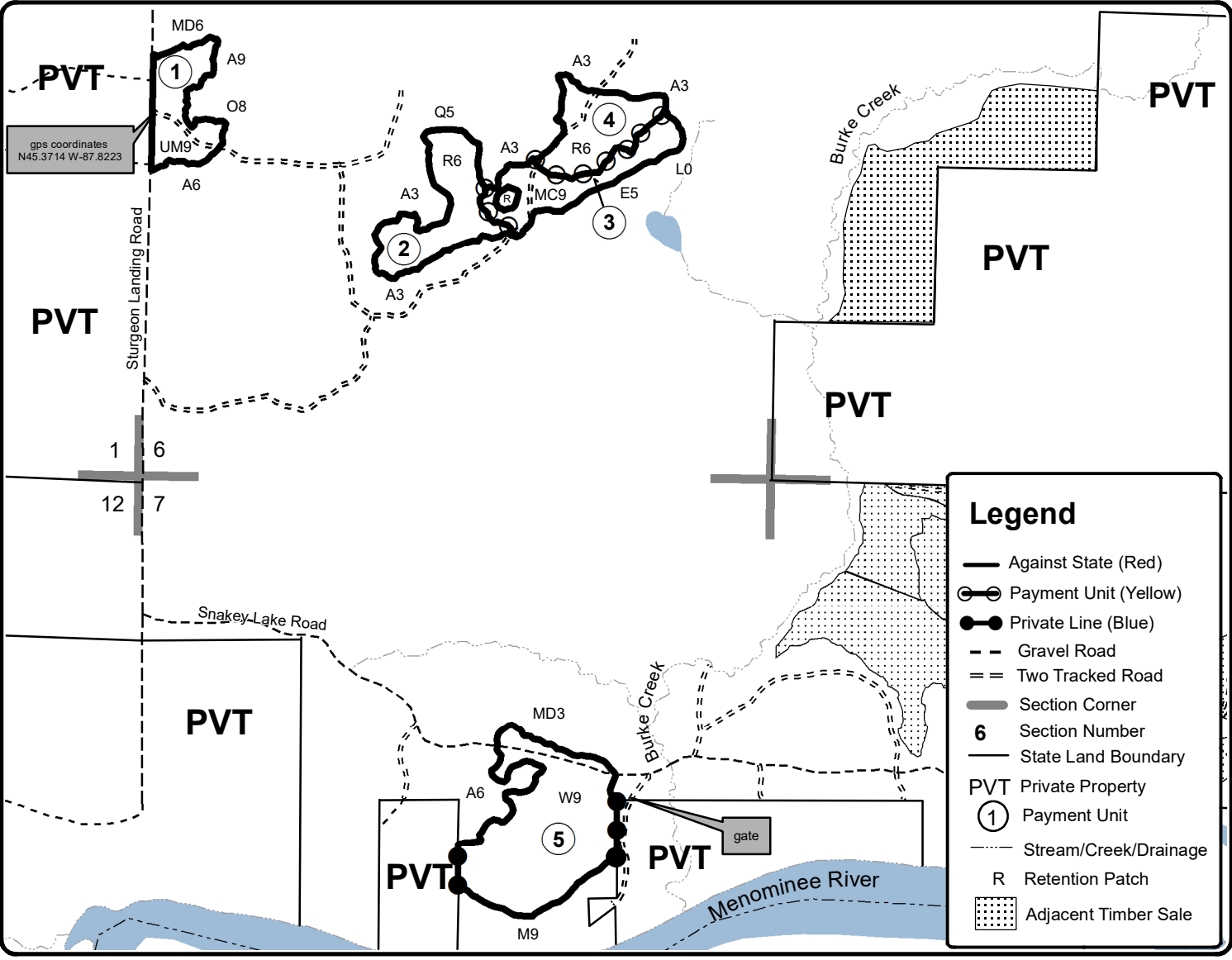
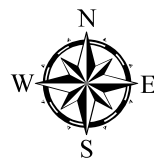

Legend

- Against State (Red)
- Payment Unit (Yellow)
- Private Line (Blue)
- Gravel Road
- Two Tracked Road
- Section Corner
- 6** Section Number
- State Land Boundary
- PVT Private Property
- 1** Payment Unit
- Stream/Creek/Drainage
- R Retention Patch
- Adjacent Timber Sale

