



TIMBER SALE MAP

33-023

23

This information provided by authority of Part 525, 1994 PA 451, as amended.

| | | | | | | |
|--|--------------|--|---------------------|--------------------|-----------|---------|
| Forest Management Unit Escanaba Management Unit | | County Menominee County | Mapped By Beaudo | Date 12/14/2022 | Page 1 | of 1 |
| Township 36N | Range 25W | Section(s) and Subdivision(s) Sec 21 - SESE; Sec 28 - N1/2NW, SWNW, NE, NWSW, S1/2SW, NESE; Sec 29 - SENE, SESE; Sec 33 - N1/2NW. | | Scale 1:15,840 | | |

Cover Type

- | | | | |
|-------------------|----------------------|-------------------------|-------------------|
| A = Aspen | H = Hemlock | N = Marsh | U = Upland Brush |
| B = Paper Birch | J = Jack Pine | O = Oak | UM = Upland Mixed |
| C = Cedar | L = Lowland Brush | P = Lowland Poplar | V = Bog or Marsh |
| D = Treed Bog | LM = Lowland Mixed | Q = Mixed Swamp Conifer | W = White Pine |
| E = Swamp Hdwoods | M = Mpl, Bch, Brch | R = Red Pine | X = Non Stocked |
| F = Spruce Fir | MC = Mixed Conifer | S = Black Spruce | Z = Water |
| G = Grass | MD = Mixed Deciduous | T = Tamarack | |

Density

- | | |
|-----------------------------|------------------------|
| 0 = Non Stocked | 5 = Pole Timber Medium |
| 1 = Seedling Sapling Poor | 6 = Pole Timber Well |
| 2 = Seedling Sapling Medium | 7 = Saw Timber Poor |
| 3 = Seedling Sapling Well | 8 = Saw Timber Medium |
| 4 = Pole Timber Poor | 9 = Saw Timber Well |

Legend

- Against State (Red)
- Payment Unit (Yellow)
- Private Line (Blue)
- County Road
- Gravel Road
- Two Tracked Road
- State Land Boundary
- Section Corner
- 21** Section Number
- Payment Unit
- PVT Private Property
- Stand Retention
- R Retention Patch
- ORV Route
- G** Gate

Schuster Split
Compartment 47
85.6 Acres
Supplement 6/6/23

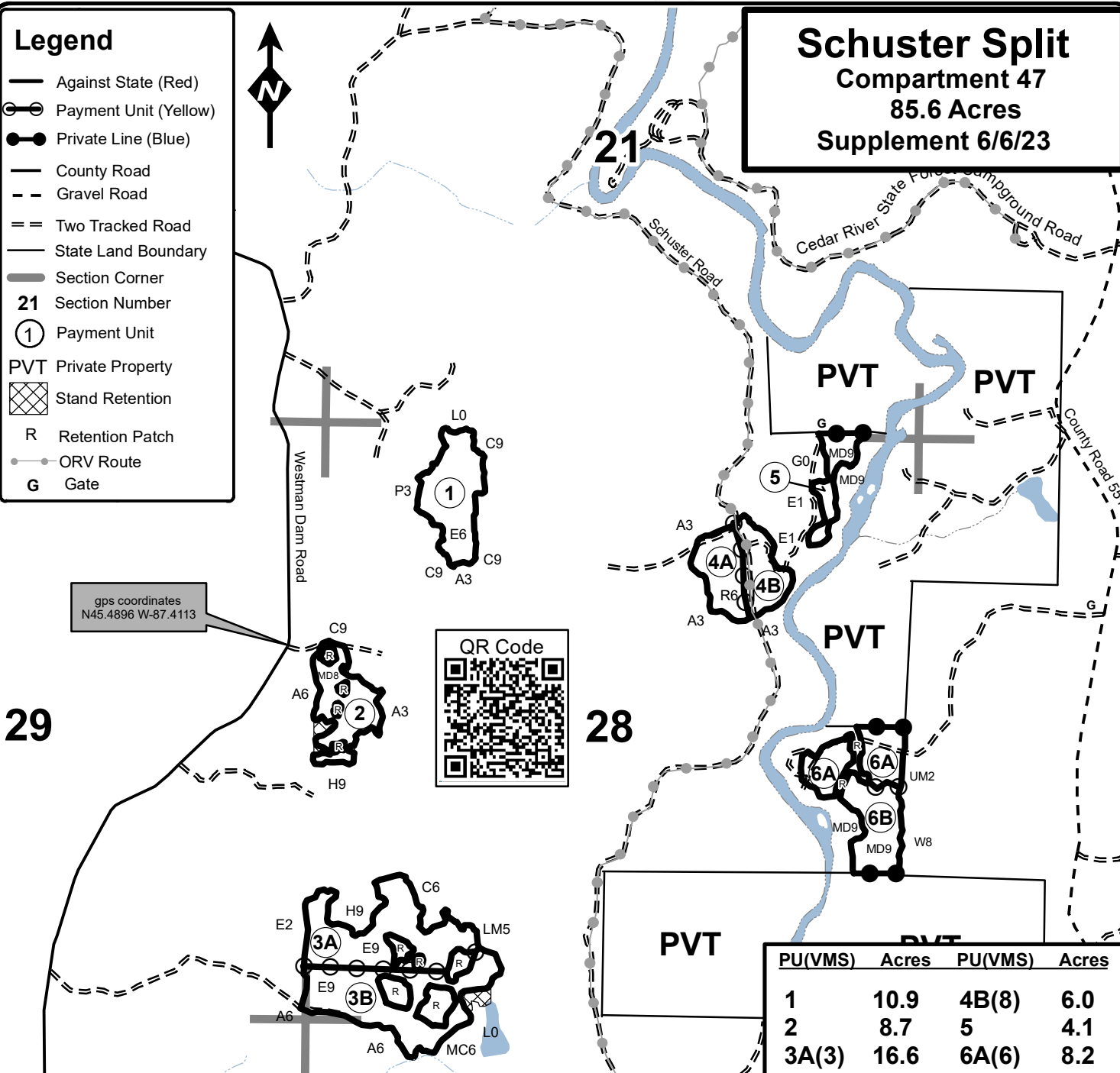

gps coordinates
 N45.4896 W-87.4113



| PU(VMS) | Acres | PU(VMS) | Acres |
|---------|-------|---------|-------|
| 1 | 10.9 | 4B(8) | 6.0 |
| 2 | 8.7 | 5 | 4.1 |
| 3A(3) | 16.6 | 6A(6) | 8.2 |
| 3B(7) | 16.5 | 6B(9) | 8.1 |
| 4A(4) | 6.5 | | |

