



TIMBER SALE MAP

This information provided by authority of Part 525, 1994 PA 451, as amended.

Forest Management Unit Grayling		County Oscoda	Mapped By Ehlert	Date 07/28/2020	Page 1	of 1
Township 27N	Range 02E	Section(s) and Subdivision(s) Sec 18- NWNW Sec 7-NENW, S1/2NW, NWNE, S1/2NE, SW, SE		Scale 1:15,840		

Cover Type

A = Aspen	H = Hemlock	N = Marsh	U = Upland Brush
B = Paper Birch	J = Jack Pine	O = Oak	UM = Upland Mixed
C = Cedar	L = Lowland Brush	P = Lowland Poplar	V = Bog or Marsh
D = Treed Bog	LM = Lowland Mixed	Q = Mixed Swamp Conifer	W = White Pine
E = Swamp Hdwoods	M = Mpl, Bch, Brch	R = Red Pine	X = Non Stocked
F = Spruce Fir	MC = Mixed Conifer	S = Black Spruce	Z = Water
G = Grass	MD = Mixed Deciduous	T = Tamarack	

Density

0 = Non Stocked	5 = Pole Timber Medium
1 = Seedling Sapling Poor	6 = Pole Timber Well
2 = Seedling Sapling Medium	7 = Saw Timber Poor
3 = Seedling Sapling Well	8 = Saw Timber Medium
4 = Pole Timber Poor	9 = Saw Timber Well

PU	Acres	PU	Acres
1	41	6	12.2
2	39.9	7	40.6
3	45.9	8	34.8
4	6.2	9	31.5
5	24.4	10	35.8

Muskrat KW
Compartment 009
336.4 Acres

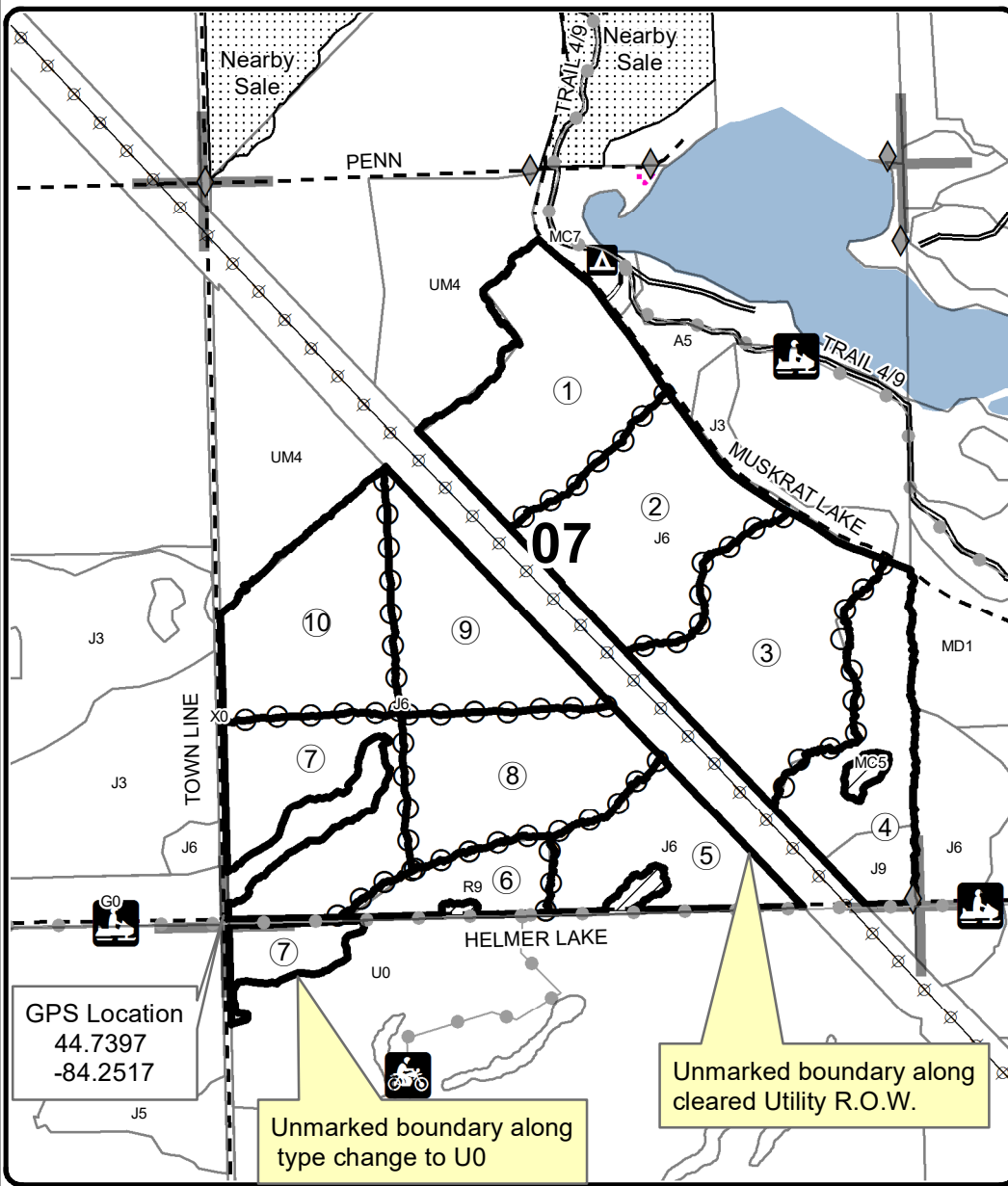
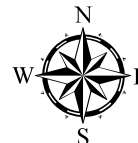

Legend

- Against State (Red/Designated)
- Payment Unit (Yellow)
- ▨ Retention Area (Red)
- Stand Boundaries
- ▤ Nearby Timber Sales
- Recreational Trail
- Primary Forest Road
- == Secondary Forest Road
- - Gravel Road
- - - Temporary Management Access
- Lakes and Rivers
- ◆ Field Grade Corners
- Section Corners
- ⊕ Powerline
- ▲ State Forest Campgrounds

Locator Map
1:200,000

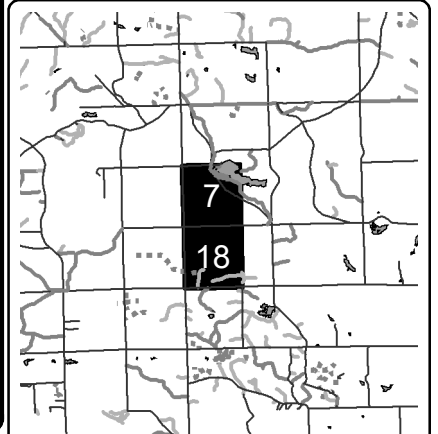

GPS Location
44.7397
-84.2517

