



TIMBER SALE MAP

This information provided by authority of Part 525, 1994 PA 451, as amended.

Forest Management Unit Graying		County Oscoda	Mapped By Scott McClarren	Date 09/28/2020	Page 1	of 2
Township 27N	Range 01E	Section(s) and Subdivision(s) Sec. 25: NWNW, SENE, SE		Scale 1:7,920		

Cover Type				Density	
A = Aspen	H = Hemlock	N = Marsh	U = Upland Brush	0 = Non Stocked	5 = Pole Timber Medium
B = Paper Birch	J = Jack Pine	O = Oak	UM = Upland Mixed	1 = Seedling Sapling Poor	6 = Pole Timber Well
C = Cedar	L = Lowland Brush	P = Lowland Poplar	V = Bog or Marsh	2 = Seedling Sapling Medium	7 = Saw Timber Poor
D = Treed Bog	LM = Lowland Mixed	Q = Mixed Swamp Conifer	W = White Pine	3 = Seedling Sapling Well	8 = Saw Timber Medium
E = Swamp Hdwoods	M = Mpl, Bch, Brch	R = Red Pine	X = Non Stocked	4 = Pole Timber Poor	9 = Saw Timber Well
F = Spruce Fir	MC = Mixed Conifer	S = Black Spruce	Z = Water		
G = Grass	MD = Mixed Deciduous	T = Tamarack			

PU	Acres	PU	Acres
1	5	4	16.6
2	26.2	5	8.1
3	22.1		

Surveyor's Stone Mix

Compartment 02

78 Acres

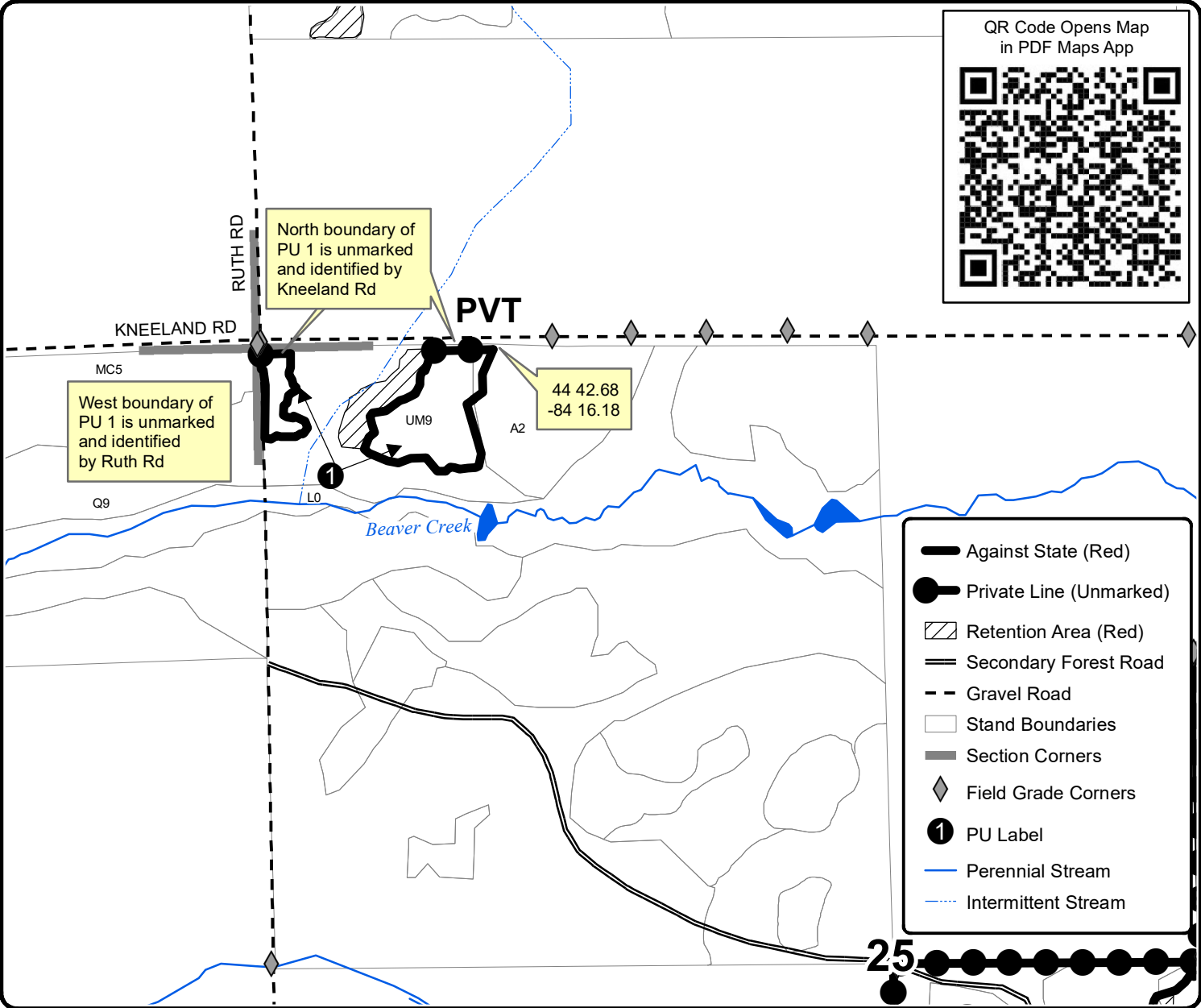

- Against State (Red)
- Private Line (Unmarked)
- ▨ Retention Area (Red)
- Secondary Forest Road
- - Gravel Road
- Stand Boundaries
- Section Corners
- ◆ Field Grade Corners
- ① PU Label
- Perennial Stream
- ⋯ Intermittent Stream

