



TIMBER SALE MAP

This information provided by authority of Part 525, 1994 PA 451, as amended.

| | | | |
|------------------------|--------|----------------------|----------|
| Sale Number | | Date | |
| | | 07/16/2024 | |
| Forest Management Unit | County | Mapped By: Behrmann | Scale |
| | | Cruised By: Behrmann | 1:10,000 |
| | | | Page |
| | | | 1 |
| | | | Of |
| | | | 1 |

| | | |
|----------|-------|-------------------------------|
| Township | Range | Section(s) and Subdivision(s) |
| | | |

| Cover Type | | | |
|---------------------|-------------------------|-------------------------|------------------------|
| A = Aspen | J = Jack Pine | O = Oak | U = Upland Brush |
| B = Paper Birch | K = Rock | P = Lowland Poplar | UM = Upland Mix Forest |
| C = Cedar | L = Lowland Brush | Q = Mixed Swamp Conifer | V = Bog or Marsh |
| D = Treed Bog | LM = Lowland Mix Forest | R = Red Pine | W = White Pine |
| E = Swamp Hardwoods | M = Maple, Beech, Birch | S = Black Spruce | X = Non Stocked |
| F = Spruce/Fir | MC = Mixed Conifer | T = Tamarack | Y = Sand |
| G = Grass | MD = Mixed Deciduous | | Z = Water |
| H = Hemlock | N = Marsh | | |

| Density | |
|-----------------------------|------------------------|
| 0 = Non Stocked | 5 = Pole Timber Medium |
| 1 = Seedling Sapling Poor | 6 = Pole Timber Well |
| 2 = Seedling Sapling Medium | 7 = Saw Timber Poor |
| 3 = Seedling Sapling Well | 8 = Saw Timber Medium |
| 4 = Pole Timber Poor | 9 = Saw Timber Well |

| PU # | Acres |
|------|-------|
| 1 | 39.2 |
| 2 | 57 |

Acres

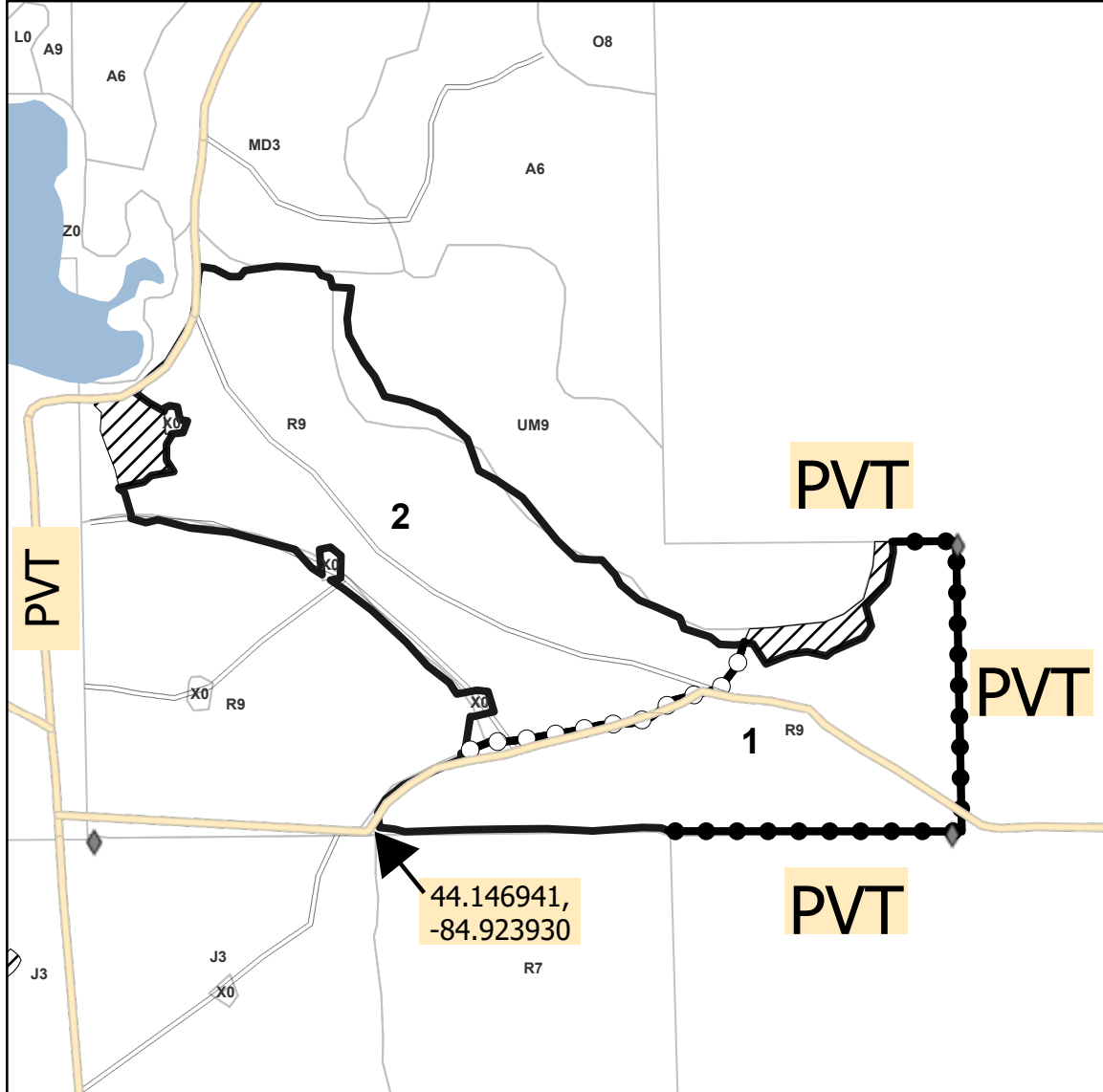
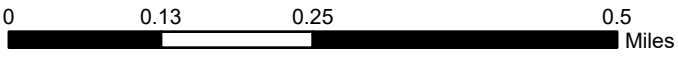

| Legend | |
|--------|----------------------------|
| | Against State (Red) |
| | Stand |
| | Retention Areas |
| | Payment Unit (Yellow) |
| | Private Line (Blue) |
| | Primary Forest Road |
| | Secondary Forest Road |
| | Forest Access Route |
| | Administrative Access Only |
| | Non-DNR Road |
| | Survey Grade Corner |

Use QR Code to open Map in App

