



TIMBER SALE MAP

This information provided by authority of Part 525, 1994 PA 451, as amended.

Forest Management Unit Grayling		County Oscoda	Mapped By Price	Date 10/06/2022	Page 1	of 1
Township 28N	Range 03E	Section(s) and Subdivision(s) S5 SWSW, S6 SESE, S7 E1/2NE, S8 W1/2NW		Scale 1:7,920		
Cover Type			Density			
A = Aspen	H = Hemlock	N = Marsh	U = Upland Brush	0 = Non Stocked	5 = Pole Timber Medium	
B = Paper Birch	J = Jack Pine	O = Oak	UM = Upland Mixed	1 = Seedling Sapling Poor	6 = Pole Timber Well	
C = Cedar	L = Lowland Brush	P = Lowland Poplar	V = Bog or Marsh	2 = Seedling Sapling Medium	7 = Saw Timber Poor	
D = Treed Bog	LM = Lowland Mixed	Q = Mixed Swamp Conifer	W = White Pine	3 = Seedling Sapling Well	8 = Saw Timber Medium	
E = Swamp Hdwoods	M = Mpl, Bch, Brch	R = Red Pine	X = Non Stocked	4 = Pole Timber Poor	9 = Saw Timber Well	
F = Spruce Fir	MC = Mixed Conifer	S = Black Spruce	Z = Water			
G = Grass	MD = Mixed Deciduous	T = Tamarack				

PU Acres PU Acres **Fistfull of Dollars Pine Mix**

1 32.8

2 25.5

Compartment 026

58.3 Acres

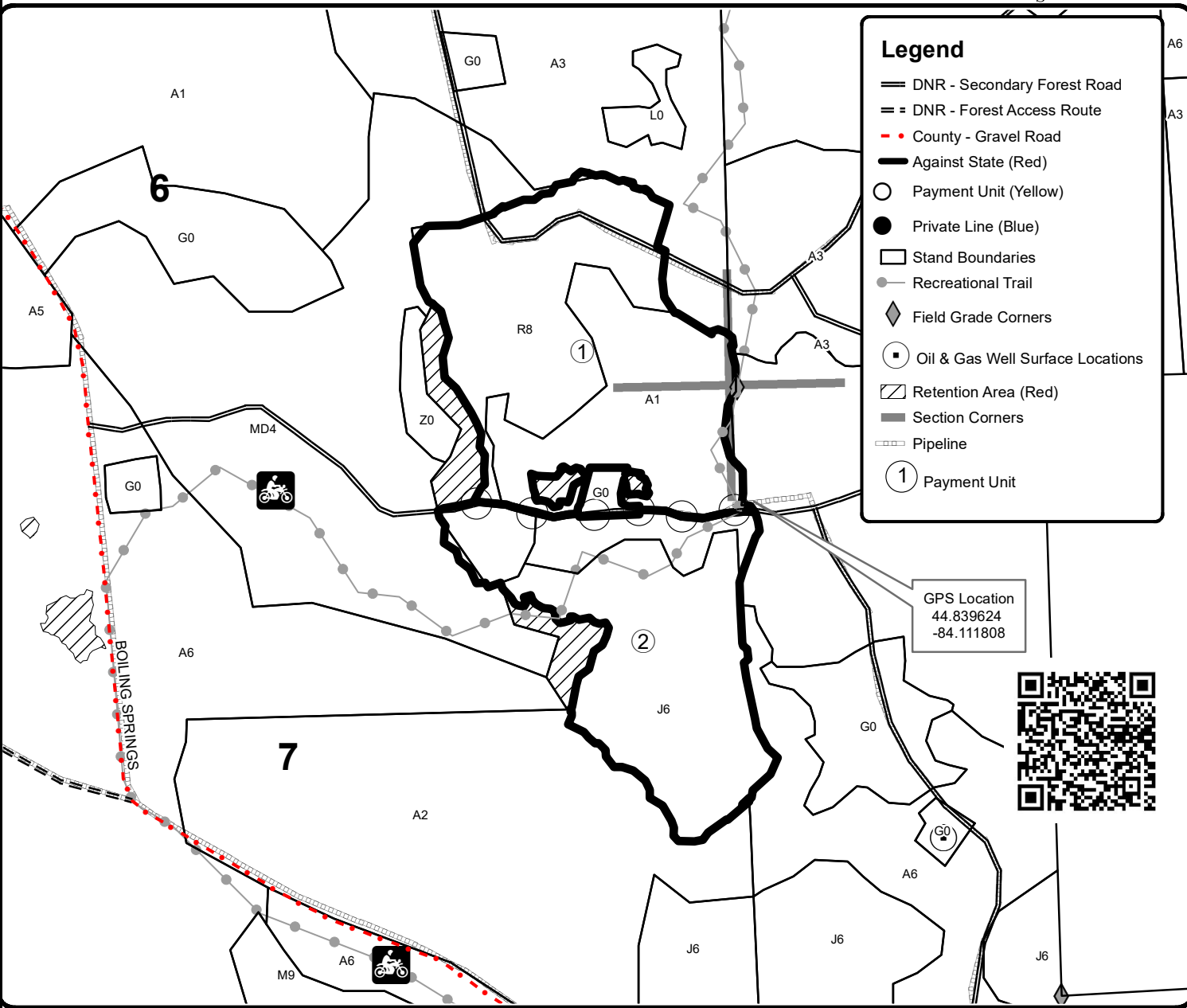
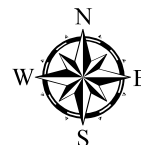

Legend

- DNR - Secondary Forest Road
- DNR - Forest Access Route
- County - Gravel Road
- Against State (Red)
- Payment Unit (Yellow)
- Private Line (Blue)
- Stand Boundaries
- Recreational Trail
- Field Grade Corners
- Oil & Gas Well Surface Locations
- Retention Area (Red)
- Section Corners
- Pipeline
- Payment Unit

GPS Location
44.839624
-84.111808

