



TIMBER SALE MAP

This information provided by authority of Part 525, 1994 PA 451, as amended.

Forest Management Unit Gaylord		County Cheboygan	Mapped By TSP	Date 09/19/2023	Page 1	of 1
Township 38N	Range 03W	Section(s) and Subdivision(s) 13: SWSW; 14: SESE; 23: NESE; 24: N1/2NW, SWNW			Scale 1:15,840	
Cover Type				Density		
A = Aspen	H = Hemlock	N = Marsh	U = Upland Brush	0 = Non Stocked	5 = Pole Timber Medium	
B = Paper Birch	J = Jack Pine	O = Oak	UM = Upland Mixed	1 = Seedling Sapling Poor	6 = Pole Timber Well	
C = Cedar	L = Lowland Brush	P = Lowland Poplar	V = Bog or Marsh	2 = Seedling Sapling Medium	7 = Saw Timber Poor	
D = Treed Bog	LM = Lowland Mixed	Q = Mixed Swamp Conifer	W = White Pine	3 = Seedling Sapling Well	8 = Saw Timber Medium	
E = Swamp Hdwoods	M = Mpl, Bch, Brch	R = Red Pine	X = Non Stocked	4 = Pole Timber Poor	9 = Saw Timber Well	
F = Spruce Fir	MC = Mixed Conifer	S = Black Spruce	Z = Water			
G = Grass	MD = Mixed Deciduous	T = Tamarack				

PU	Acres
1	6.8
2	26.4
3	5.0

Back Again Mix

Compartment 162 & 163

38.2 Acres

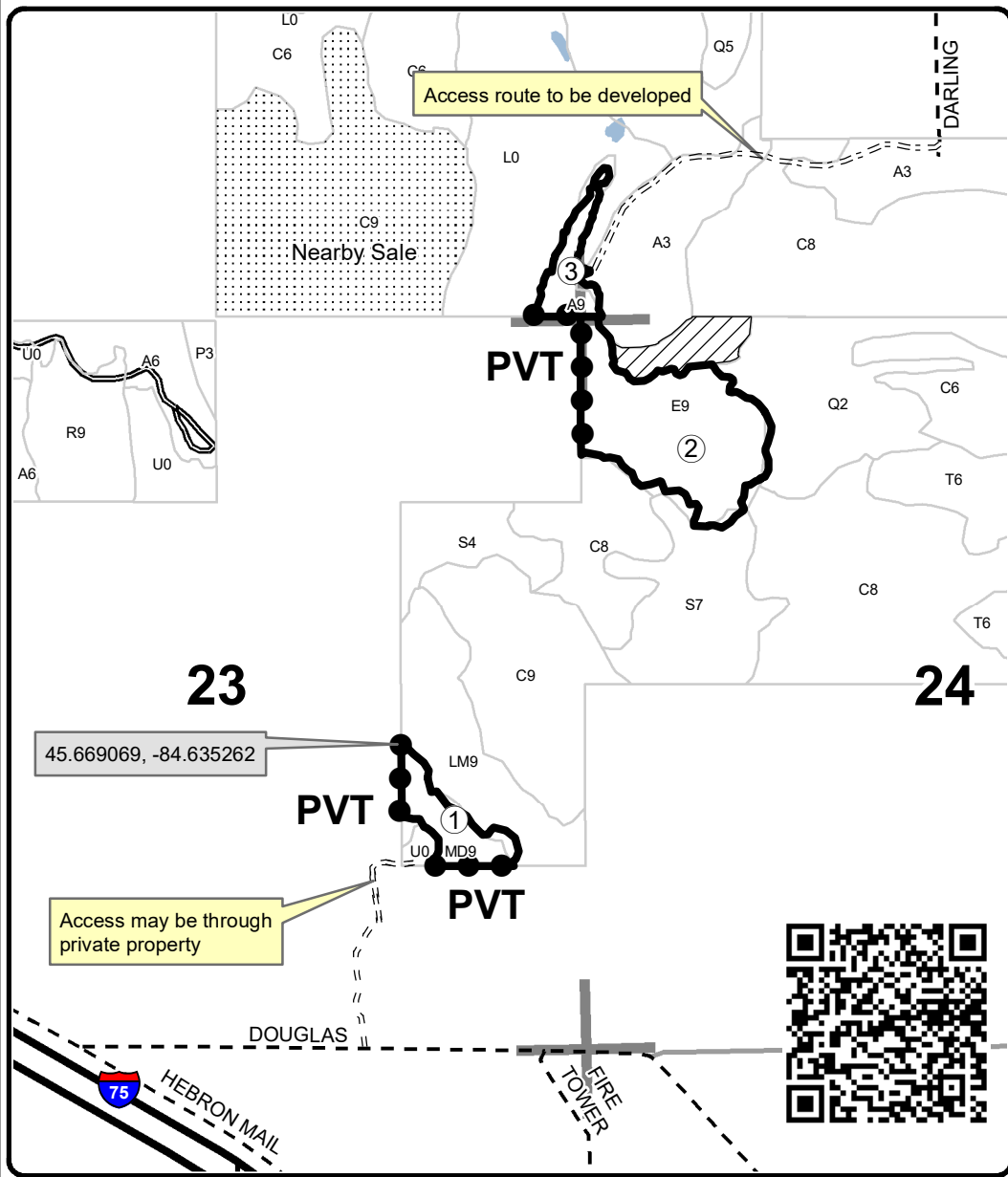

Legend

- Against State (Red)
- Private Line (Blue)
- ▨ Retention Area
- ▤ Nearby Timber Sales
- Stand Boundaries
- Highways
- Secondary Forest Road
- Paved Road
- - Gravel Road
- Private
- Lakes and Rivers
- Section Corners

