



TIMBER SALE MAP

This information provided by authority of Part 525, 1994 PA 451, as amended.

Forest Management Unit Gaylord FMU		County Cheboygan	Mapped By TSP	Date 07/20/2023	Page 1	of 1
Township 33N	Range 03W	Section(s) and Subdivision(s) Sec 14: NESW, W1/2SE		Scale 1:7,920		
Cover Type				Density		
A = Aspen	H = Hemlock	N = Marsh	U = Upland Brush	0 = Non Stocked	5 = Pole Timber Medium	
B = Paper Birch	J = Jack Pine	O = Oak	UM = Upland Mixed	1 = Seedling Sapling Poor	6 = Pole Timber Well	
C = Cedar	L = Lowland Brush	P = Lowland Poplar	V = Bog or Marsh	2 = Seedling Sapling Medium	7 = Saw Timber Poor	
D = Treed Bog	LM = Lowland Mixed	Q = Mixed Swamp Conifer	W = White Pine	3 = Seedling Sapling Well	8 = Saw Timber Medium	
E = Swamp Hdwoods	M = Mpl, Bch, Brch	R = Red Pine	X = Non Stocked	4 = Pole Timber Poor	9 = Saw Timber Well	
F = Spruce Fir	MC = Mixed Conifer	S = Black Spruce	Z = Water			
G = Grass	MD = Mixed Deciduous	T = Tamarack				

PU Acres
1 12.3

Dollars and Sense Mix
Compartment 156
12.3 Acres

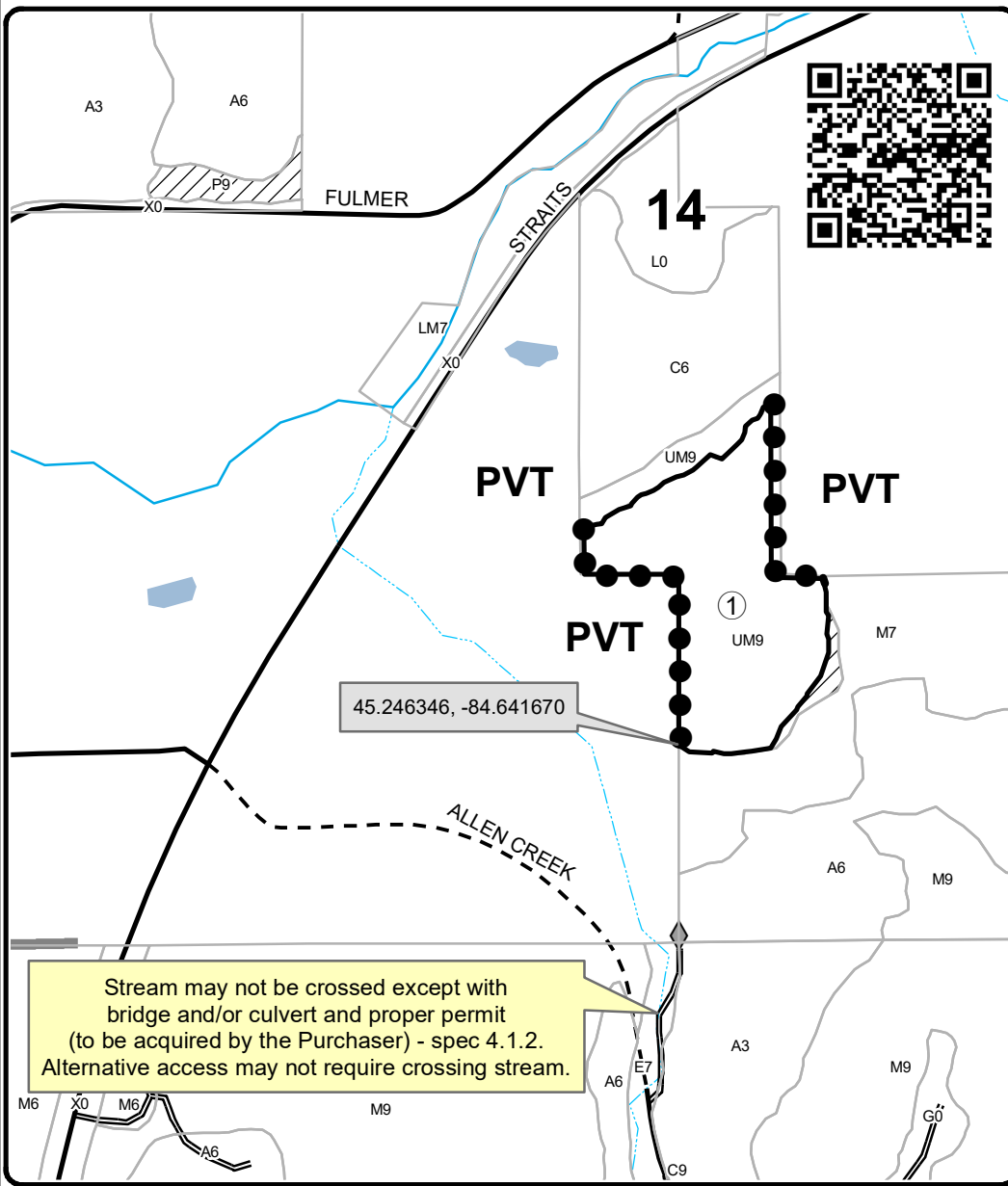

Legend

- Against State (Red)
- Private Line (Blue)
- Stand Boundaries
- ◆ Field Grade Corners
- Secondary Forest Road
- Paved Road
- - Gravel Road
- ⋯ Intermittent Stream
- Perennial River
- Lakes and Rivers
- ▨ Retention Area
- Section Corners

Locator Map
1:200,000

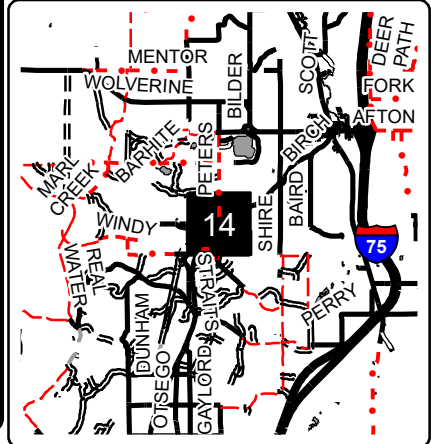

Stream may not be crossed except with bridge and/or culvert and proper permit (to be acquired by the Purchaser) - spec 4.1.2. Alternative access may not require crossing stream.

