



# TIMBER SALE MAP

This information provided by authority of Part 525, 1994 PA 451, as amended.

Forest Management Unit Sault Ste Marie Mgt Unit		County Mackinac	Mapped By Flatt	Date 09/26/2022	Page 1	of 1
Township 43N	Range 07W	Section(s) and Subdivision(s) 20: S1/2SW 29: NW,SWNE,SW 30: NENE		Scale 1:15,840		

### Cover Type

A = Aspen	H = Hemlock	N = Marsh	U = Upland Brush
B = Paper Birch	J = Jack Pine	O = Oak	UM = Upland Mixed
C = Cedar	L = Lowland Brush	P = Lowland Poplar	V = Bog or Marsh
D = Treed Bog	LM = Lowland Mixed	Q = Mixed Swamp Conifer	W = White Pine
E = Swamp Hdwoods	M = Mpl, Bch, Brch	R = Red Pine	X = Non Stocked
F = Spruce Fir	MC = Mixed Conifer	S = Black Spruce	Z = Water
G = Grass	MD = Mixed Deciduous	T = Tamarack	

### Density

0 = Non Stocked	5 = Pole Timber Medium
1 = Seedling Sapling Poor	6 = Pole Timber Well
2 = Seedling Sapling Medium	7 = Saw Timber Poor
3 = Seedling Sapling Well	8 = Saw Timber Medium
4 = Pole Timber Poor	9 = Saw Timber Well

PU	Acres	PU	Acres
1	39.0	4	24.1
2	34.4		
3	16.7		

**Mixed Bag**  
**Compartment 140**  
**114.2 Acres**

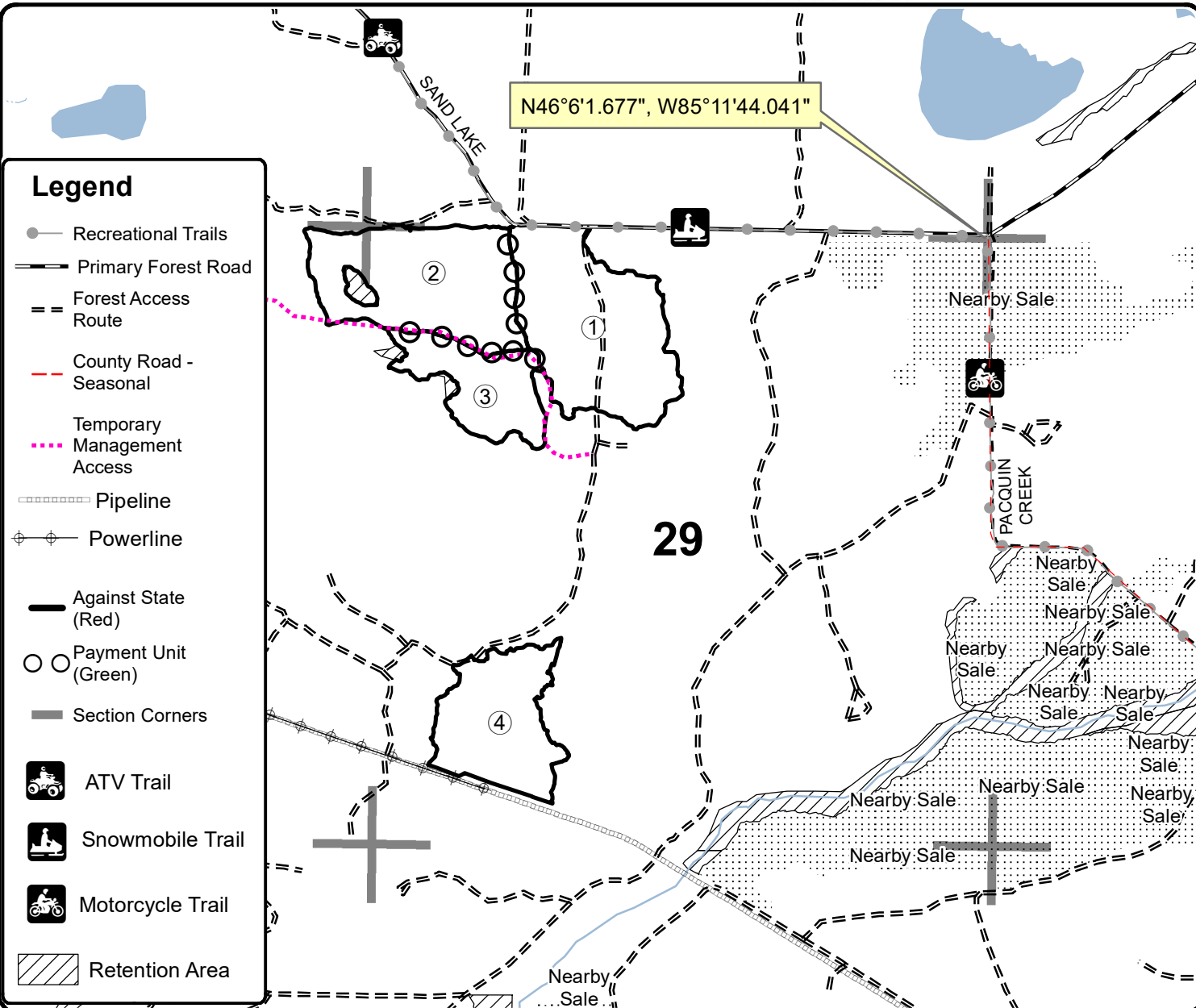

### Legend

- Recreational Trails
- Primary Forest Road
- Forest Access Route
- County Road - Seasonal
- Temporary Management Access
- Pipeline
- Powerline
- Against State (Red)
- Payment Unit (Green)
- Section Corners
- ATV Trail
- Snowmobile Trail
- Motorcycle Trail
- Retention Area

