



# TIMBER SALE MAP

This information provided by authority of Part 525, 1994 PA 451, as amended.

Forest Management Unit Newberry Management Unit		County	Mapped By Douglass		Date	Page 1 of 2	
Township 49N		County Name	Cruised By Newberry/Naubinway Staff		10/05/2018		
Range 12W	23 - N1/2NE, SENE, NESE; 26 - E/12NE, SENE, N1/2SW, SWSW, SE1/4; 27 - E1/2NE; 35 - N1/2NE, SENE			Scale 1:15,840			

### Cover Type

A = Aspen	H = Hemlock	N = Marsh	U = Upland Brush
B = Paper Birch	J = Jack Pine	O = Oak	UM = Upland Mixed
C = Cedar	L = Lowland Brush	P = Lowland Poplar	V = Bog or Marsh
D = Treed Bog	LM = Lowland Mixed	Q = Mixed Swamp Conifer	W = White Pine
E = Swamp Hdwoods	M = Mpl, Bch, Brch	R = Red Pine	X = Non Stocked
F = Spruce Fir	MC = Mixed Conifer	S = Black Spruce	Z = Water
G = Grass	MD = Mixed Deciduous	T = Tamarack	

### Density

0 = Non Stocked	5 = Pole Timber Medium
1 = Seedling Sapling Poor	6 = Pole Timber Well
2 = Seedling Sapling Medium	7 = Saw Timber Poor
3 = Seedling Sapling Well	8 = Saw Timber Medium
4 = Pole Timber Poor	9 = Saw Timber Well

PU	Acres	PU	Acres	PU	Acres
1	12.1	4	15.3	7	78.5
2	8.1	5	35.2	8	22.8
3	18.2	6	40.7		

**Easy Does It**  
**Compartment 007**  
**230.9 Acres**

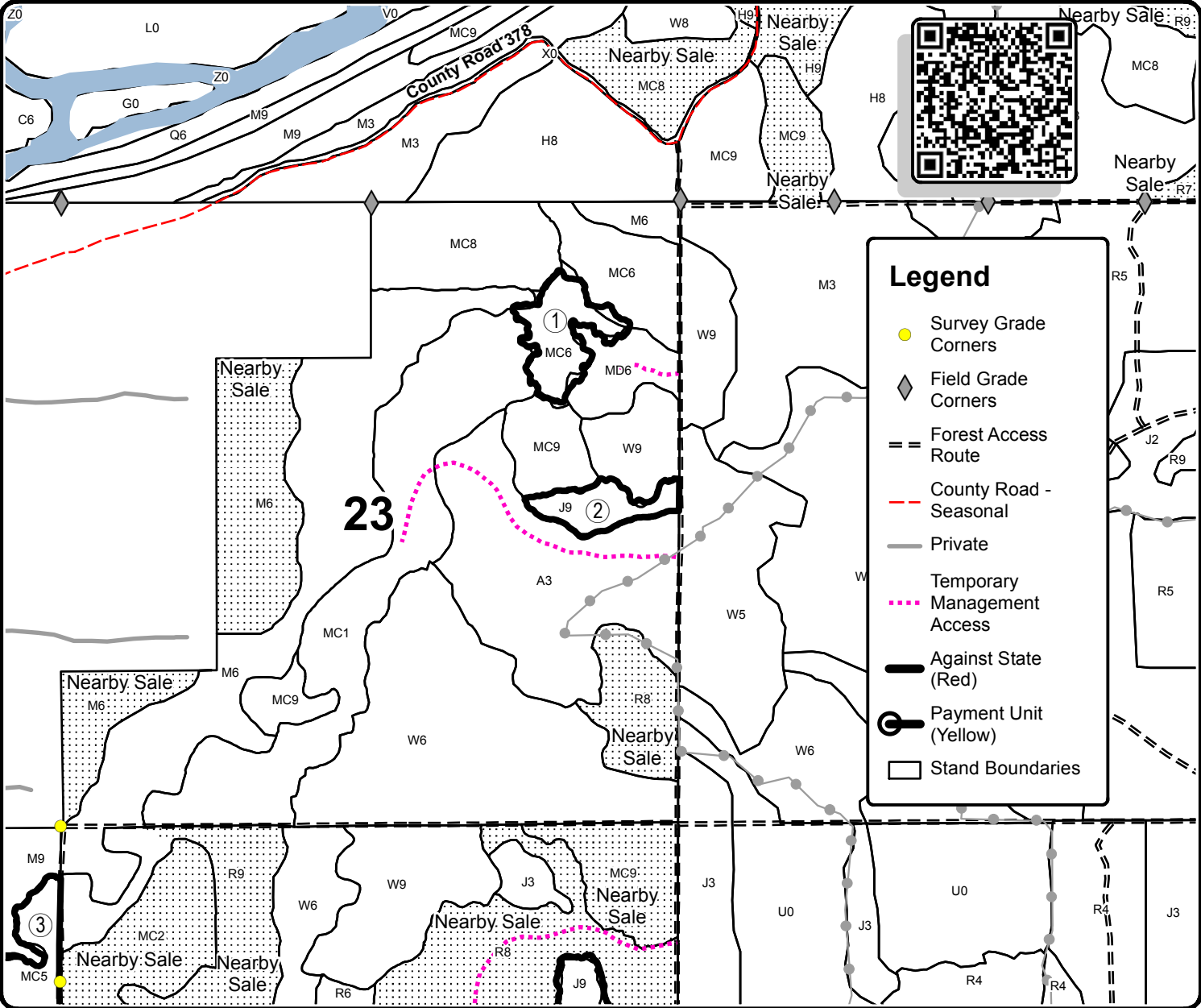

### Legend

- Survey Grade Corners
- ◆ Field Grade Corners
- == Forest Access Route
- County Road - Seasonal
- Private
- Temporary Management Access
- Against State (Red)
- Payment Unit (Yellow)
- Stand Boundaries

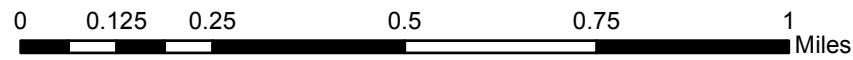



# TIMBER SALE MAP

This information provided by authority of Part 525, 1994 PA 451, as amended.

Forest Management Unit Newberry Management Unit		County	Mapped By Douglass	Date	Page	of
Township 49N		County Name	Cruised By Newberry/Naubinway Staff	10/05/2018	2	2
Range 12W	23 - N1/2NE, SENE, NESE; 26 - E/12NE, SENE, N1/2SW, SWSW, SE1/4; 27 - E1/2NE; 35 - N1/2NE, SENE			Scale 1:15,840		

Cover Type				Density	
A = Aspen	H = Hemlock	N = Marsh	U = Upland Brush	0 = Non Stocked	5 = Pole Timber Medium
B = Paper Birch	J = Jack Pine	O = Oak	UM = Upland Mixed	1 = Seedling Sapling Poor	6 = Pole Timber Well
C = Cedar	L = Lowland Brush	P = Lowland Poplar	V = Bog or Marsh	2 = Seedling Sapling Medium	7 = Saw Timber Poor
D = Treed Bog	LM = Lowland Mixed	Q = Mixed Swamp Conifer	W = White Pine	3 = Seedling Sapling Well	8 = Saw Timber Medium
E = Swamp Hdwoods	M = Mpl, Bch, Brch	R = Red Pine	X = Non Stocked	4 = Pole Timber Poor	9 = Saw Timber Well
F = Spruce Fir	MC = Mixed Conifer	S = Black Spruce	Z = Water		
G = Grass	MD = Mixed Deciduous	T = Tamarack			

PU	Acres	PU	Acres	PU	Acres
1	12.1	4	15.3	7	78.5
2	8.1	5	35.2	8	22.8
3	18.2	6	40.7		

**Easy Does It**  
**Compartment 007**  
**230.9 Acres**

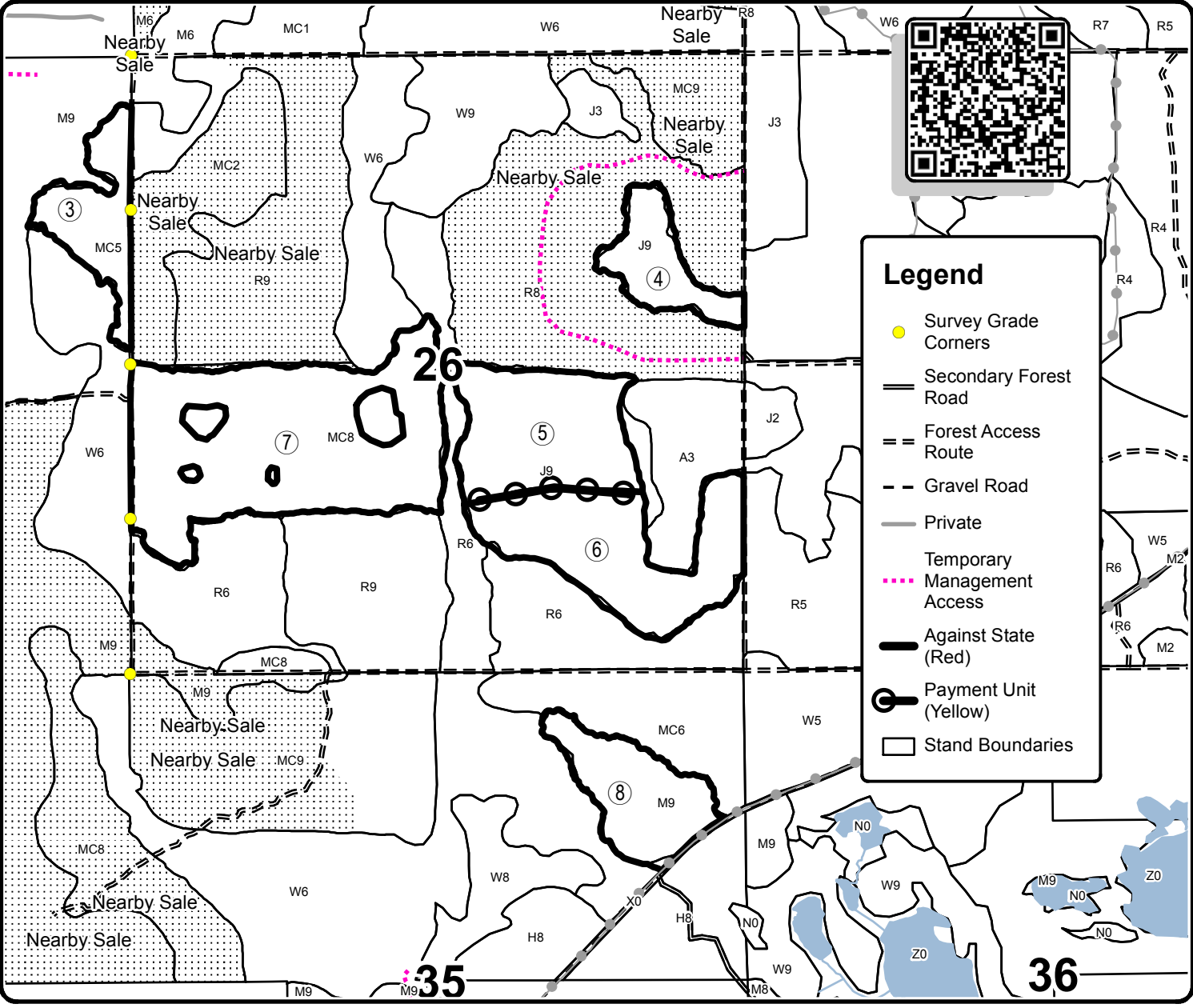

### Legend

- Survey Grade Corners
- Secondary Forest Road
- Forest Access Route
- Gravel Road
- Private
- Temporary Management Access
- Against State (Red)
- Payment Unit (Yellow)
- Stand Boundaries

