



TIMBER SALE MAP

This information provided by authority of Part 525, 1994 PA 451, as amended.

Sale Number	Date
42-006-24	04/24/2024

Forest Management Unit	County	Mapped By: A. Ciaramitaro
Newberry Mgt Unit	Luce	Cruised By: Newberry Unit Staff

Scale	Page	Of
1:7,920	1	2

Township	Range	Section(s) and Subdivision(s)	Sec. 25 SESE; Sec. 29 S1/2NW,SW; Sec. 30 NESW,S1/2SW,E1/2SE;
50N	08W / 09W		

Cover Type			
A = Aspen	J = Jack Pine	O = Oak	U = Upland Brush
B = Paper Birch	K = Rock	P = Lowland Poplar	UM = Upland Mix Forest
C = Cedar	L = Lowland Brush	Q = Mixed Swamp Conifer	V = Bog or Marsh
D = Treed Bog	LM = Lowland Mix Forest	R = Red Pine	W = White Pine
E = Swamp Hardwoods	M = Maple, Beech, Birch	S = Black Spruce	X = Non Stocked
F = Spruce/Fir	MC = Mixed Conifer	T = Tamarack	Y = Sand
G = Grass	MD = Mixed Deciduous	Z = Water	
H = Hemlock	N = Marsh		

Density	
0 = Non Stocked	5 = Pole Timber Medium
1 = Seedling Sapling Poor	6 = Pole Timber Well
2 = Seedling Sapling Medium	7 = Saw Timber Poor
3 = Seedling Sapling Well	8 = Saw Timber Medium
4 = Pole Timber Poor	9 = Saw Timber Well

Camp Cushman Pine
 Compartment: 42043 Acres: 107.7



PU #	Acres	PU #	Acres
1	21.5	4	28.2
2	23.9	5	9.3
3	24.7		

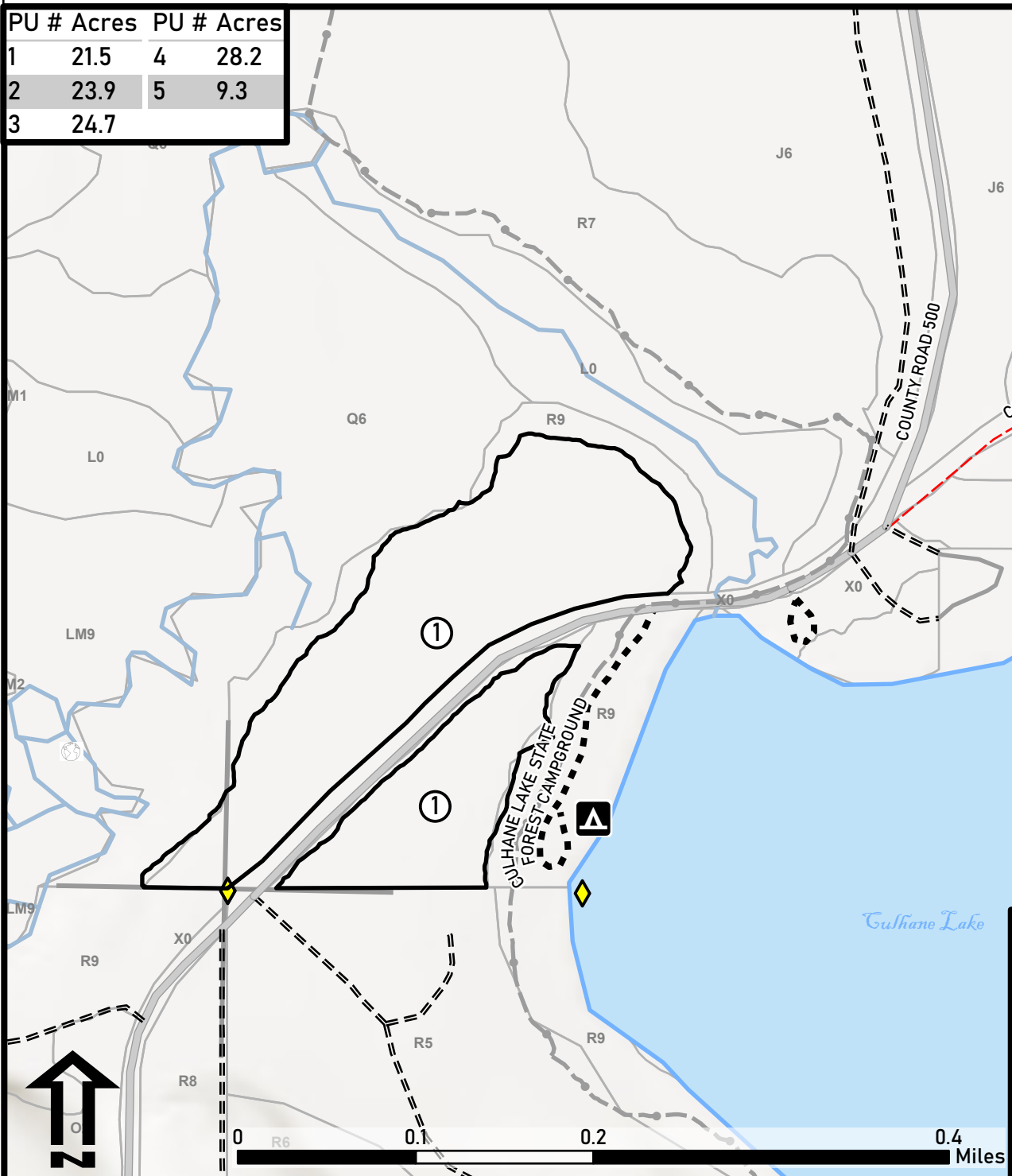

Legend

- Payment Unit
- Against State (Red)
- Payment Unit (Yellow)
- Private Boundary (Blue)
- Clear Cut Gap
- DNR - Management Access
- Survey Grade Corner
- MIRIS Section Corner
- Lakes and Rivers
- Recreational Trail
- Primary Forest Road
- Secondary Forest Road
- Forest Access Route
- Paved Road
- Gravel Road
- County Road - Seasonal
- Private Road
- Campground

