



TIMBER SALE MAP

This information provided by authority of Part 525, 1994 PA 451, as amended.

Sale Number	Year
45-010-22	2022

Forest Management Unit Sault Ste. Marie	County Chippewa	Mapped By Brinks	Date 09/19/22	Page 1	of 1
Township T42N	Range R06E	Section(s) and Subdivision(s) See below	Scale 1:15,840 1 inch= 1/4 mile		

Cover Type				Density			
A = Aspen	H = Hemlock	N = Marsh	U = Upland Brush	0 = Non Stocked	5 = Pole Timber Medium		
B = Paper Birch	J = Jack Pine	O = Oak	UM = Upland Mixed	1 = Seedling Sapling Poor	6 = Pole Timber Well		
C = Cedar	L = Lowland Brush	P = Lowland Poplar	V = Bog or Marsh	2 = Seedling Sapling Medium	7 = Saw Timber Poor		
D = Treed Bog	LM = Lowland Mixed	Q = Mixed Swamp Conifer	W = White Pine	3 = Seedling Sapling Well	8 = Saw Timber Medium		
E = Swamp Hdwoods	M = Mpl. Bch. Brch	R = Red Pine	X = Non Stocked	4 = Pole Timber Poor	9 = Saw Timber Well		
F = Spruce Fir	MC = Mixed Conifer	S = Black Spruce	Z = Water				
G = Grass	MD = Mixed Deciduous	T = Tamarack					

D.I. GEMS Redo
184.9 Acres
4773 Cords



Legend

- Sale Boundary (Red)
- Sale Boundary (no paint)
- Two Track Road
- Areas Recently Harvested

Sec. 1- S1/2NE, SESW, NESE, SWSE
 Sec. 11- SENW, S1/2NE, SW1/4, SE1/4
 Sec. 12- SENW, W1/2NE, NESW, NWSE

- Unit 1- 24 ac
- Unit 2- 32.9 ac
- Unit 3- 17.2 ac
- Unit 4- 24.7 ac
- Unit 5- 23.9 ac
- Unit 6- 16.5 ac
- Unit 7- 45.7 ac

46° 3.291' N
83° 38.502' W

← To Maxton Road

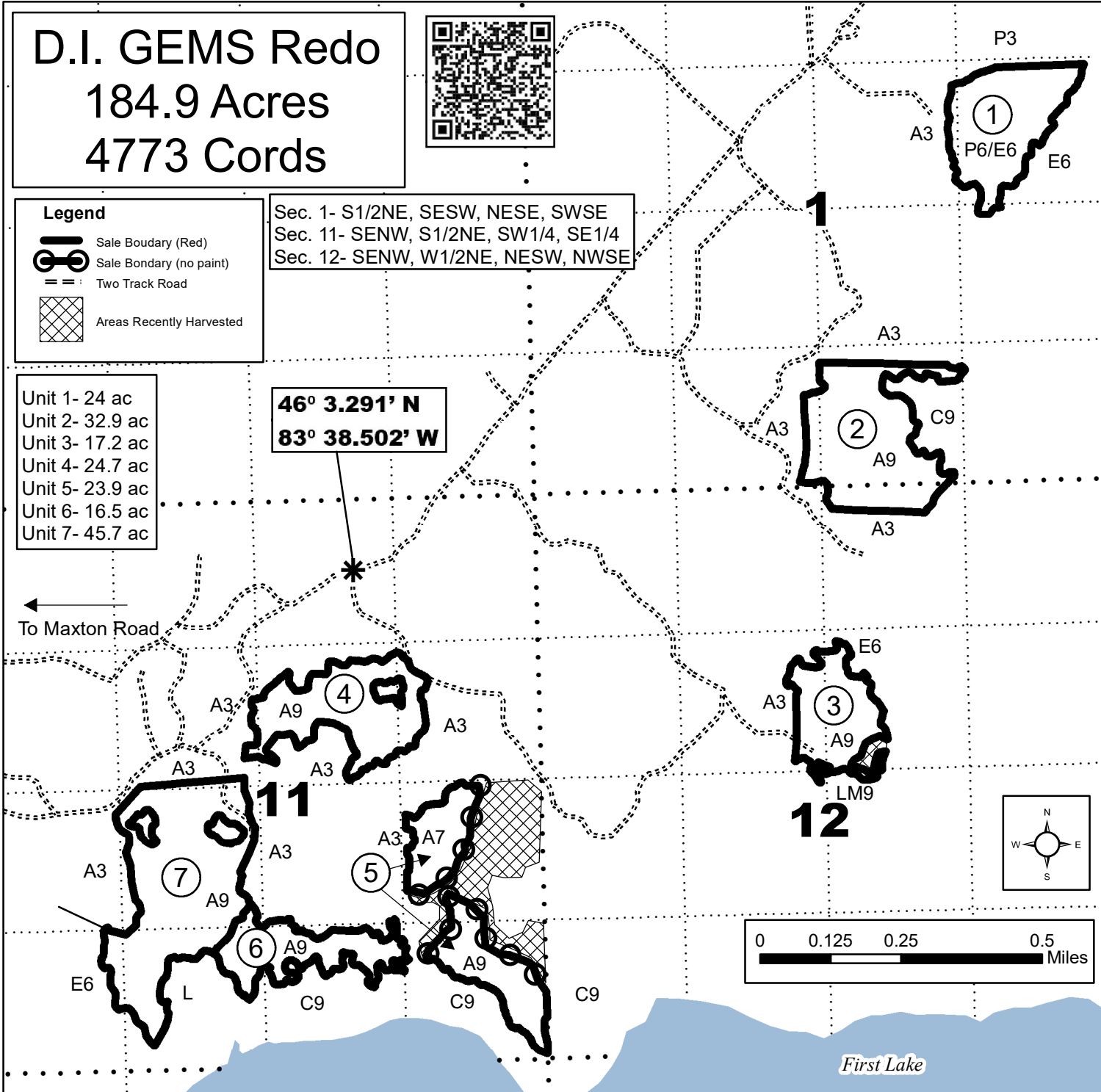

First Lake