



TIMBER SALE MAP

This information provided by authority of Part 525, 1994 PA 451, as amended.

Sale Number 45-003-24	Date 03/08/2024	
Scale 1:15,840	Page 1	Of 2

Forest Management Unit Sault Ste Marie Mgt Unit	County Chippewa	Mapped By: Brinks/Fanelli
		Cruised By: Fanelli

Township 45N	Range 01E / 02E	Section(s) and Subdivision(s) Sec. 25 SESW,SE; Sec. 26 SESE; Sec. 30 NWSW; Sec. 35 NENE; Sec. 36 N1/2NW,NWNE;
------------------------	---------------------------	----------------------------------------------------------------------------------------------------------------------------

Cover Type			
A = Aspen	J = Jack Pine	O = Oak	U = Upland Brush
B = Paper Birch	K = Rock	P = Lowland Poplar	UM = Upland Mix Forest
C = Cedar	L = Lowland Brush	Q = Mixed Swamp Conifer	V = Bog or Marsh
D = Treed Bog	LM = Lowland Mix Forest	R = Red Pine	W = White Pine
E = Swamp Hardwoods	M = Maple, Beech, Birch	S = Black Spruce	X = Non Stocked
F = Spruce/Fir	MC = Mixed Conifer	T = Tamarack	Y = Sand
G = Grass	MD = Mixed Deciduous	Z = Water	
H = Hemlock	N = Marsh		

Density	
0 = Non Stocked	5 = Pole Timber Medium
1 = Seedling Sapling Poor	6 = Pole Timber Well
2 = Seedling Sapling Medium	7 = Saw Timber Poor
3 = Seedling Sapling Well	8 = Saw Timber Medium
4 = Pole Timber Poor	9 = Saw Timber Well

Brian's Blind Aspen

125.0 Acres

PU #	Acres	PU #	Acres
1	17.9	5	6.5
2	32.7	6	3.2
3	29.8	7	11.9
4	22.9		

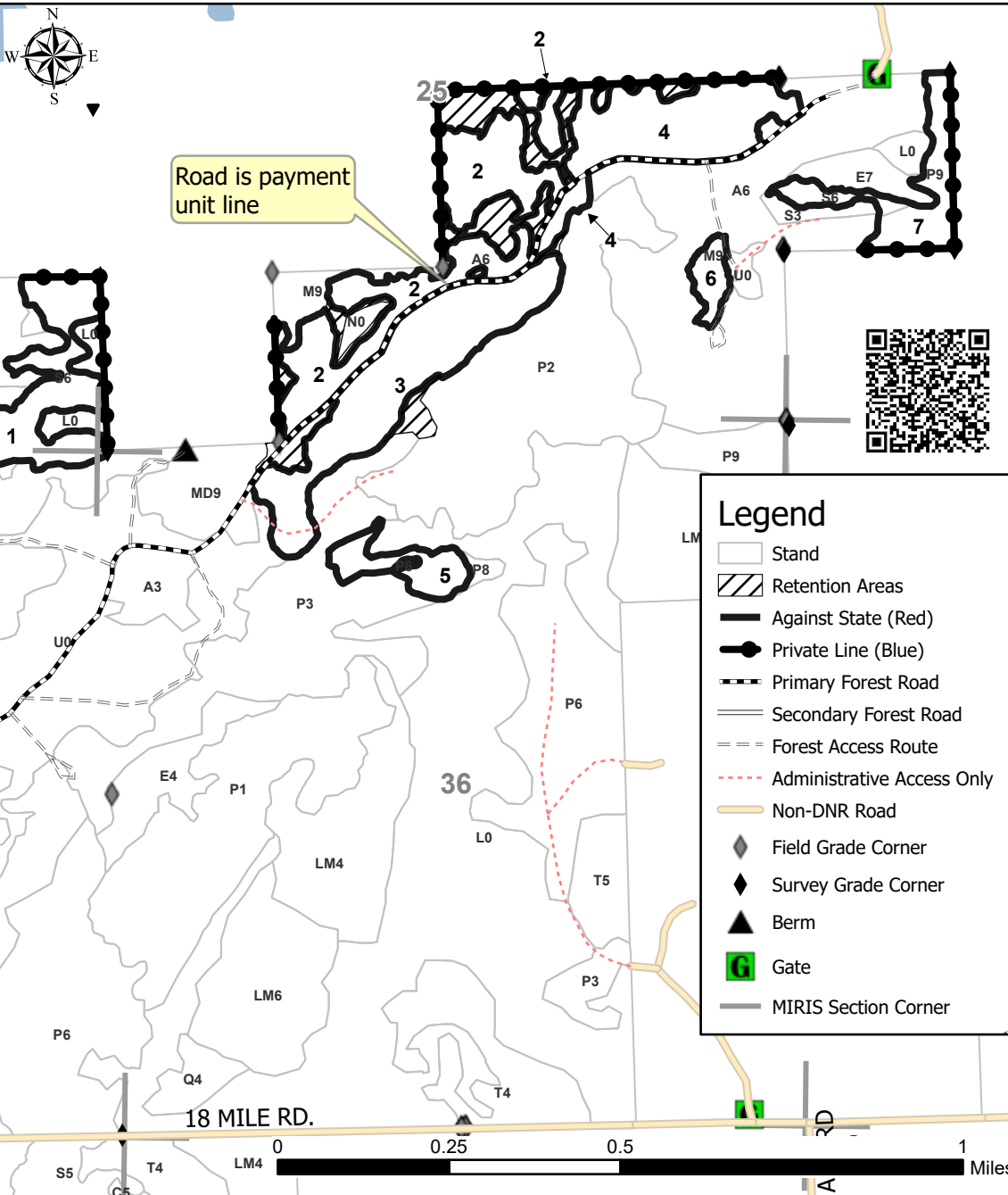

Legend	
	Stand
	Retention Areas
	Against State (Red)
	Private Line (Blue)
	Primary Forest Road
	Secondary Forest Road
	Forest Access Route
	Administrative Access Only
	Non-DNR Road
	Field Grade Corner
	Survey Grade Corner
	Berm
	Gate
	MIRIS Section Corner