

Re-Survey  
Township N<sup>o</sup> 26 N Range N<sup>o</sup> 2 W

Mer. Michigan

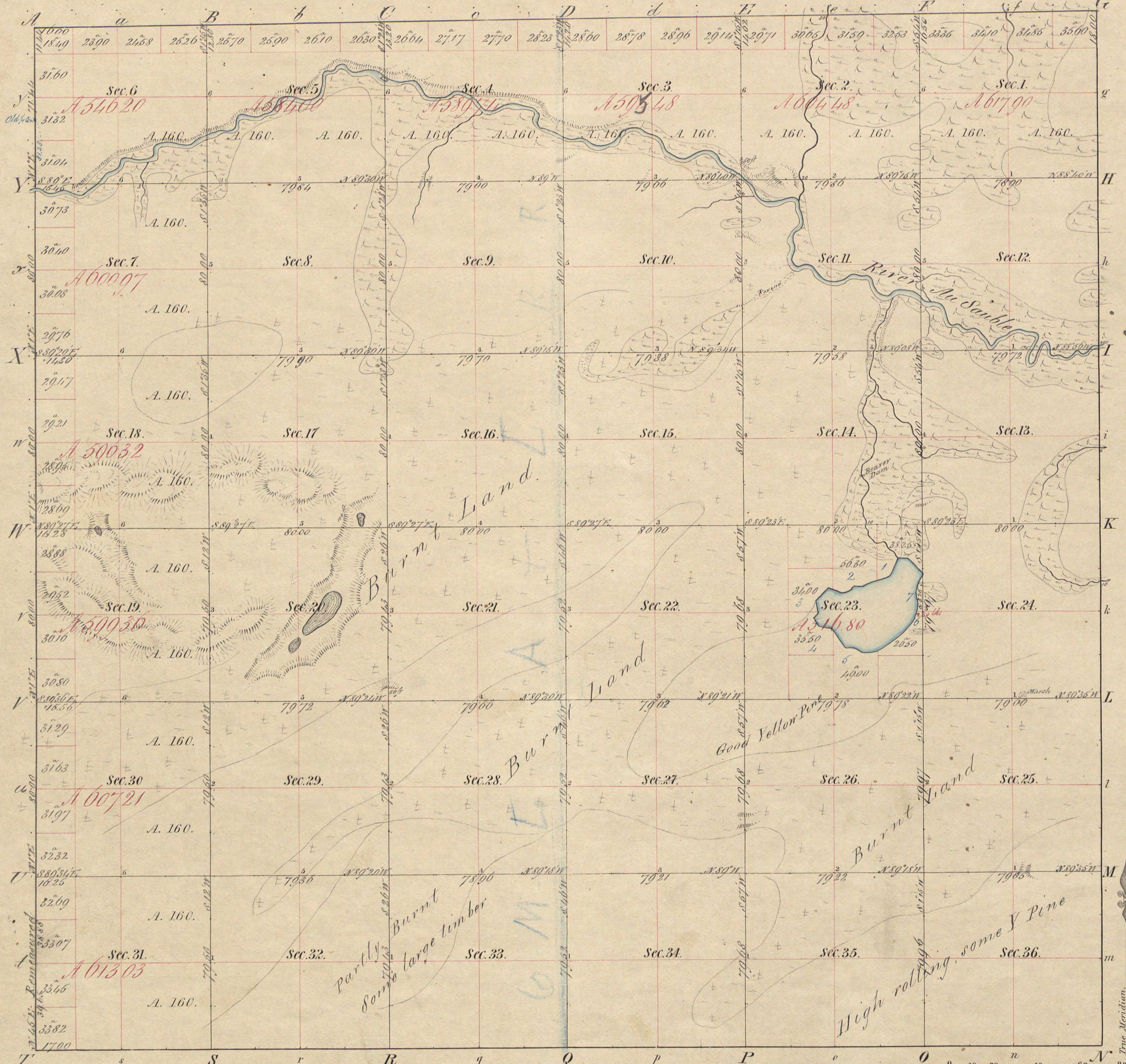

Meanders of			
Posts	Courses	Ch. Lk.	Ch. Lk.
Meanders of Lake in Sec. 23. from quarter post on line of sec. 23 & 24 thence West 2.80 to Lake thence			
N. 11 E.		5.00	
N. 2 W.		6.00	
N. 19 E.		7.50	
N. 55 W.		2.47	
N. 39 W.		7.00	
N. 38 W.		5.00	
S. 19 W.		8.75	
S. 60 W.		2.00	
S. 73 W.		9.00	
S. 75 W.		6.00	
S. 65 W.		6.00	
N. 77 W.		7.00	
S. 32 W.		18.00	
S. 6 E.		4.00	
S. 51 W.		4.00	
S. 53 E.		5.00	
S. 71 E.		5.00	
S. 31 E.		4.00	
S. 44 E.		7.00	
S. 80 E.		3.50	
S. 64 E.		5.00	
N. 80 E.		6.00	
N. 59 E.		15.00	
N. 32 E.		4.50	
N. 45 E.		3.07	

14859  
168.56  
in ch. lk.

POOR COPY

Total number of Acres. 22,430.49

Surveys Designated	By Whom Surveyed	Date of Contract	Amount of Surveys	When Surveyed	When paid for and ch <sup>d</sup> in the Sur. Gen <sup>l</sup> acc <sup>t</sup> ?
Township lines	Brerort & Mullett	Feb 18 & Dec 13 1839	W. Ch. 50	2 <sup>nd</sup> Quar. 1839	
Subdivisions	Dominic Pettibone	April 13. 1852	61. 01. 42	2 <sup>nd</sup> Quar 1852	

Resurveying paid for per Gen<sup>l</sup> Land Office Report N<sup>o</sup> 2693 of Dec 8. 1852

The above Map of Township N<sup>o</sup> 26 North of Range N<sup>o</sup> 2 West of the Principal Meridian Michigan is strictly conformable to the field notes of the survey thereof on file in this Office, which have been examined and approved.

Surveyor General's Office,  
Detroit November 20 1852

Charles Noble Sur. Gen<sup>l</sup>

POOR COPY