

SURVEY & REMONUMENTATION

MAR 16 2005



LINDA M. LANDHEER
NEWAYGO COUNTY REGISTER OF DEEDS
RECEIVED & RECORDED
02/25/2005 9:26:27 AM

SECTION

2004 Newaygo County Remonumentation Project

LAND CORNER RECORDATION CERTIFICATE
Filing Requirement of Act 74, Mich. P.A. 1970

For corners in
Newaygo
(County)

Located in: _____ Corner Code # _____

1. Public Land Survey

T 15 N R 11 W

M-6

VOL. 4 273

2. Property Controlling in Section _____ S _____
3. Miscellaneous Property in Sec. _____ S _____

4. Lot No. _____ Recorded Plat _____
5. Private Claims _____

Register of Deeds Stamp & File Number

A	B	C	D	E	F	G	H	I	J	K	L	M
2	6	5	4	3	2	1						
3												
4	7	8	9	10	11	12						
5												
6	18	17	16	15	14	13						
7												
8	19	20	21	22	23	24						
9												
10	30	29	28	27	26	25						
11												
12	31	32	33	34	35	36						
13												

I, Norman L. Ochs, in a field survey on June 24, 2004, do hereby certify that under requirements of P.A. 74, Michigan P.A. of 1970, the corner points mentioned in lines 1 and 2 above were in conformance with regulations and rules therefore as required in the current manual of survey instructions of the United States Department of the Interior, Bureau of Land Management or by a decree of a Court of Law and/or that the corner points mentioned in lines 2, 4 and 5 above were in conformance with the rules of the Michigan Board of Land Surveyors or by a Decree of a Court of Law; established, re-established, monumented, re-monumented, recovered, found as expressed below:

Note: Not more than 2 corners, all in the same town and range, may be Recorded on this certificate.

East One Quarter corner of Section 13, Norwich Township, Newaygo County

A. DESCRIPTION OF ORIGINAL MONUMENT AND ACCESSORIES AND/OR SUBSEQUENT RESTORATION:

GLO John Hodgson
3rd Quarter 1838
Set quarter section post
#1 14" Pine S31°W 10 links (6.6')
#2 8" Pine N48°W 10 links (6.6')

Norman L Ochs RLS # 22439, Found NO GLO witnesses
Drawing # 73143B November 4, 1976
Set concrete monument half way and on line between NE & SE Corners of Section 13
#3 6"-6" Twin White Oak S12°E 18.89' spike in West side
#4 6" White Oak S49°E 18.27' spike in North side
#5 10" Red Oak N04°E 11.58' spike in West side
OVER

B. DESCRIPTION OF CORNER EVIDENCE FOUND AND/OR METHOD APPLIED IN RESTORING OR REESTABLISHING CORNER:

I found a concrete monument at ±.5 above grade. The corner is on remnants of fence, running North and South. The condition of the witnesses are as follows: #1 and #2 are gone, #3 thru #5 are in good condition.

C. DESCRIPTION OF MONUMENT FOR CORNER AND ACCESSORIES ESTABLISHED TO PERPETUATE LOCATING THE POSITION OF THE CORNER:

I accepted the concrete monument at ±.5 above grade as a substantial marker for the quarter corner and is accepted as a careful and faithful reestablishment of the position of the original quarter corner.

#3 10" 10" Twin White Oak S12°E 18.90'
#4 10" White Oak S49°E 18.27'
#5 16" Red Oak N04°E 11.37'
10" Black Oak N70°E 8.18'

Found spike in West side
Found spike in North side
Reset 40d spike with tag in West side
Found double head nail in NW side

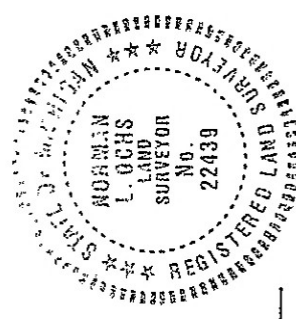

Signed by Norman L. Ochs
Norman L. Ochs

Date September 24, 2004

Surveyor's Michigan License No. 22439

Form approved by Michigan State Board of Land Surveyors, Jan. 28, 1971
Revised May 14, 1975
Revised Jan., 1983

Approved by Peer Review Group on September 15, 2004
Norman L. Ochs, County Representative.

N.L.O.