

**SURVEY &  
REMONUMENTATION**

MAR 02 2009

DELIVERED TO NEWAYGO CO  
02/05/2009 3:11:56 PM



**SECTION 2008 Newaygo County Remonumentation Project**

**LAND CORNER RECORDATION CERTIFICATE**  
Filing Requirement of Act 74, Mich. P.A. 1970

For corners in  
Newaygo  
(County)

Located in: Corner Code #

1. Public Land Survey

T13N R11W  
T N R W  
T N R W  
T N R W  
T N R W  
T N R W  
T N R W  
T N R W

1-5  
\_\_\_\_\_

**VOL. 6** **140**

2. Property Controlling  
in Section S  
3. Miscellaneous S  
Property in Sec. S

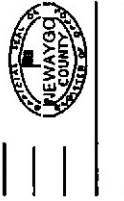

LINDA M. LANDHEER  
NEWAYGO COUNTY REGISTER OF DEEDS  
RECEIVED AND RECORDED  
02/05/2009 3:19:08 PM

4. Lot No. \_\_\_\_\_ Recorded Plat \_\_\_\_\_  
5. Private Claims \_\_\_\_\_

Register of Deeds Stamp & File Number

A	B	C	D	E	F	G	H	I	J	K	L	M
2	6	5	4	3	2	1						
3												
4	7	8	9	10	11	12						
5												
6	18	17	16	15	14	13						
7												
8	19	20	21	22	23	24						
9												
10	30	29	28	27	26	25						
11												
12	31	32	33	34	35	36						
13												

I, Norman L. Ochs, in a field survey on January 4, 2008 do hereby certify that under requirements of P.A. 74, Michigan P.A. of 1970, the corner points mentioned in lines 1 and 2 above were in conformance with regulations and rules therefore as required in the current manual of survey instructions of the United States Department of the Interior, Bureau of Land Management or by a decree of a Court of Law and/or that the corner points mentioned in lines 2, 4 and 5 above were in conformance with the rules of the Michigan Board of Land Surveyors or by a Decree of a Court of Law, established, re-established, monumented, re-monumented, recovered, found as expressed below:

**Note: Not more than 2 corners, all in the same town and range, may be Recorded on this certificate.**

Section Corner common to Sections 10, 11, 14 and 15, T13N R11W, Big Prairie Township.

**A. DESCRIPTION OF ORIGINAL MONUMENT AND ACCESSORIES AND/OR SUBSEQUENT RESTORATION:**

GLO - James H. Mullett  
4<sup>th</sup> quarter 1837 Set post corners  
#1 12" White Oak N50°E 48 links (31.68')  
#2 6" White Oak N33°W 19 links (12.54')

Lyle S. Shepherd, R.L.S. # 503  
Book 59A, Page 3 October 15, 1925  
Found plow point glass around it At intersection of East and West and North and South roads Old witnesses gone. No trees near.  
#3 24" Black Oak N80°W 266 links (175.56')  
#4 Fence Posts S47°W 50.3 links (33.20')  
#5 Fence Posts N46°W 59 links (38.94')

OVER%

**B. DESCRIPTION OF CORNER EVIDENCE FOUND AND/OR METHOD APPLIED IN RESTORING OR REESTABLISHING CORNER:**

I found a ½" by 12" Rerod on top of tile. The centerline of East and West bituminous road is 1.0' North of corner. The centerline of a gravel road South is 12.0' West of the corner. The condition of the witnesses are as follows: #1 and #2 gone, #3 good condition, #4 and #5 gone, #6 good condition, #7 found 10" Maple S10°E 47.40' to center, #8 set 40d spike in SW side of 18" Maple N55°W 45.16', #9 thru #11 good condition.

**C. DESCRIPTION OF MONUMENT FOR CORNER AND ACCESSORIES ESTABLISHED TO PERPETUATE LOCATING THE POSITION OF THE CORNER:**

I removed the ½" by 12" Rerod and set 2 ¼" diameter Harrison Cast Iron Monument 12" long marked "County Surveyor" grouted on top of tile at the location of the Rerod, as a substantial marker for the corner and is accepted as a careful and faithful perpetuation of the position of the original Section corner.

- #3 36" Black Oak N80°W 175.61'
  - #6 5' X 3" Concrete Well S75°W 266.50' to center.
  - #9 16" - 16" Twin Maple S05°E 50.11'
  - #10 12" Apple N27°E 47.77'
  - #11 26" White Pine S45°W 89.33'
- Set 40d spike with tag # 22439 in South side  
Found spike in West side  
Found spike in West side  
Set 40d spike with tag # 22439 in Southeast side

Signed by Norman L. Ochs Date January 22, 2009

Norman L. Ochs

Surveyor's Michigan License No. 22439 Form approved by Michigan State Board of Land Surveyors, Jan 28, 1971  
Revised May 14, 1975  
Revised Jan , 1983

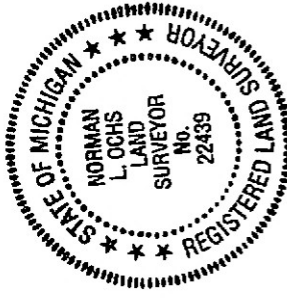

Approved by Peer Review Group on July 16, 2008

Norman L. Ochs, County Representative.

*N.L.O.*