



LIBER R17

PAGE 183



RECEIVED FOR RECORD
KAREN L BREWSTER, CLERK/REGISTER
CHEBOYGAN COUNTY, MICHIGAN
11/28/2022 11:04:19 AM

\$30.00 RECEIPT# 6138, STATION 2
REMON CORNER

REMONUMENTATION CORNER

Land Corner Recordation Certificate 2022 Annual Grant Agreement

Authority: MCL 54.205 and R54.202

Filing Requirement: MCL 54.268(2)(a), 54.268(2)(d), 54.201 – 54.210d and 2022 State Survey and Remonumentation Grant Agreement

Notes:

- No more than two Original Public Land Survey Corners can be recorded on this certificate
- If a corner reported hereon is common to two or more survey townships, each Town, Range and Corner Code for the corner may be identified on this certificate
- If a corner reported hereon is common to two or more counties, each county may be identified on this certificate and a copy of this certificate filed with the Register of Deeds in each county

For corner(s) in: CHEBOYGAN County

MACKINAW Township

Corner Type

Survey Township

Corner Code

Original Public Land Survey Corner

- MCL 54.202(g)
- MCL 54.262(g)

T	39N	R	3W
T		R	
T		R	
T		R	

PC334 #7
NE claim
corner

Property Controlling Corner

- MCL 54.202(i)
- MCL 54.262(h)

S	T	R
S	T	R
S	T	R
S	T	R

Protracted Public Land Survey Corner

Beaugrand TWP

- MCL 54.202(k)
- MCL 54.262(i)

T	R
T	R
T	R
T	R

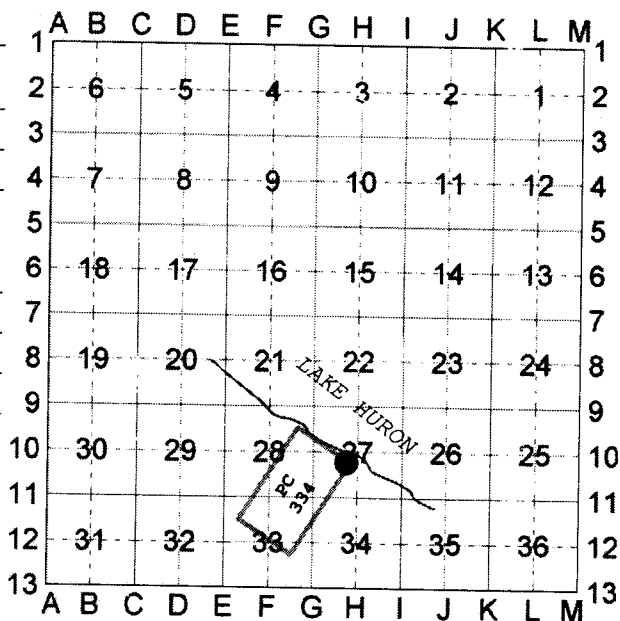

Part A: Corner(s) History:

Abstract:

- * In 1810 GLO surveyor Aaron Greely performs original survey of PC 334.
- * In 1856 GLO surveyor Harvey Mellon retraces PC 334 and finds the 1810 post.
- * In 1961 Kenneth Ostling, PS No 10068 performs a boundary survey of PC 334 and set a 1" pipe and brass cap at Lake Huron for the NE corner of PC 334 and takes two witnesses.
- * In 1963 Kenneth Ostling removes the corner set in 1961 and moves it 40 feet SWly along the border of PC 334 to conform with GLO measurement and establishes two new witnesses.
- * In 1984 Carl Johnson, PS No 30083 performs a survey on the NWly side of PC 334 and updates Ostling's 1961 map to include the 1984 data.
Map shows the 1963 revised position of the 1" pipe and brass cap set by Ostling at Lake Huron for the NE corner of PC 334.

* See attached sheet for corner history



REMONUMENTATION CORNER

Part B: Surveyor's Report on Perpetuation or Monumentation of Corner(s)

Found no evidence of corner.

Found 5" sq concrete pillar marked "State Park Boundary" near the shore of Lake Huron also found two other 5" sq pillars SW'ly and near the claim border but, none line up to make a satisfactory boundary line.

- (1) No evidence
- (2) No evidence

Set a 5/8" x 36" rebar with a standard 4" round Cheboygan County Remon. Cap at the NE corner of private claim 334 as a restoration of the 1961 DNR survey by pushing the GLO distance of 6956.4 feet from the SE claim corner extended through the closing corner between sections 33 and 34 and further through the closing corner between sections 27 and 34.

Commencing at a 5/8"x36" rebar capped with a 4" round Cheboygan County Remon. Disk marking the NE corner of private claim no 334 on the shore of Lake Huron thence S37°16'07"W along claim line:

- 3513.45' 1" Pipe with 4" round brass disk marked "Michigan Conservation Forestry Division", being the closing corner between section 27 & 34.
- 3962.10' 1" Pipe with 4" round brass disk marked "Michigan Conservation Forestry Division", being the closing corner of Claim No 334
- 6956.40' 1" Pipe with 4" round brass disk marked "Michigan Conservation Forestry Division", being the SE corner of Claim No 334

Part C: Field Evidence of Perpetuation or Monumentation of Corner(s)

5/8" x 36" rebar with a standard 4" round Cheboygan County Remon. Cap

- (3) 3' x 5' Boulder, N27W, 55.94', drilled and set iron bar in high point.
- (4) 11" Cedar, S60W, 57.30', set N&T #58752
- (5) 12" Cedar, S52E, 81.95', set N&T #58752
- (6) 14" Spruce, S82E, 73.85', set N&T #58752

Date of Observation	Latitude (N)	Longitude (W)	Datum and Adjustment Year	Epoch Date
September 27, 2022	45°44'37.44"	84°39'40.49"	NAD_83 (2011)	2010.0000

Coordinates established utilizing RTK vector to NGS CORS.

The values shown hereon have an estimated accuracy of 1 foot.

The above latitude and longitudinal coordinates should not be used to establish or reestablish any corner. The above position is for general reference only and no land survey or property description should rely on these coordinates.

I, Jeffery L. Ecker, in a field survey on September 27, 2022, certify under the requirements of the State Survey and Remonumentation Act, 1990 PA 345, MCL 54.261 to 54.279, and the Corner Recordation Act, 1970 PA 74, MCL 54.201, to 54.210d, that the corner(s) identified and described hereon has been perpetuated or monumented as described in Parts A, B, and C above, pursuant to the laws and rules of the State of Michigan.



 Jeffery L. Ecker 11/11/2022
 Date

Professional Surveyor's License No.: 4001058752

Ecker Surveying Inc., Cheboygan, MI 49721

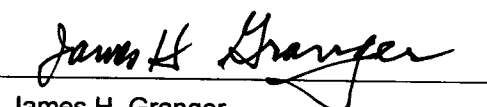

I, James H. Granger, state that the corner(s) identified and described hereon and perpetuated or monumented as described in Parts A, B, and C above was presented to and reviewed by the Peer Review Group on September 22, 2022 and is accepted for filing in the Cheboygan County Remonumentation Program.

 James H. Granger 11-23-22
 Date

Professional Surveyor's License No.: 4001016041





REMONUMENTATION CORNER

Cheboygan County Remonumentation Program

Corner History Part A for:

**PC 334 #7 NE claim corner - T39N, R3W, Mackinaw Township, Cheboygan County
NE corner of Private Claim 334 on the shore of Lake Huron, T39N, R3W**

<u>Date</u>	<u>Surveyor</u>	<u>Found / Set</u>	<u>Recording info</u>
1810	GLO, Aaron Greeley	Post standing on the border of Lake Huron.	Original Survey of Private Claim 334.
1856	GLO, Harvey Mellon	Finds the 1810 post.	Original Survey, 1856 (Subdivisions)
1961	Kenneth Ostling PS No. 10068	1" Pipe and 4" Aluminum cap. 5" Spruce, S39 1/2W, 74.3' Center of 2'x2' boulder, S82W, 49.7'	1961 Survey Map of Private Claim No. 334. And Corner Record.
<i>*The above 1961 Ostling corner was moved 40' along the claim border and witnessed as noted in the below 1963 record.</i>			
1963	Kenneth Ostling PS No. 10068	1" Pipe and 4" Aluminum cap. (1) 5" Spruce, S40W, 34.3' (2) 8" Spruce, N77W, 92.6'	Interoffice Communication and Corner Record
1984	Carl Johnson PS No. 30083	Michigan DNR Survey of a portion of PC 334 shows Ostling's reestablished 1963 monument.	Updated 1961 Survey Map of Private Claim No. 334 to include the 1984 survey.