

LAND CORNER RECORDATION CERTIFICATE
Filing Requirement of Act 74, Mich. P.A. 1970

Instrument 200700006295 DR Liber Page 5 67

For corners in

Antrim

(County)

1. Public Land Survey

Located In: Corner Code #
T 31 N R 5 W E-9
T 31 N R 5 W F-9

2. Property Controlling in Section

S T R
S T R

3. Miscellaneous Property in Sec.

S T R
S T R

4. Lot No. , Recorded Plat

5. Private Claims

200700006295
Filed for Record in
ANTRIM COUNTY MICHIGAN
PATTY NIEPOTH - 268
06-28-2007 At 11:18 am
LAND CORNER 14.00
DR Liber 5 Page 67 - 67

Register of Deeds Stamp & File Number

	A	B	C	D	E	F	G	H	I	J	K	L	M
1													
2		8		5		4		3		2		1	
3													
4		7		8		9		10		11		12	
5													
6		18		17		16		15		14		13	
7													
8		19		20		21		22		23		24	
9													
10		30		29		28		27		26		25	
11													
12		31		32		33		34		35		36	
13													

I, Ronald C. Brand, in a field survey on June 20, 2007 do hereby state that under requirements of P.A. 74, Michigan P.A. of 1970, the corner points mentioned in lines 1 and 2 above were in conformance with regulations and rules therefore as required in the current manual of survey instructions of the United States Department of the Interior, Bureau of Land Management or by a decree of a Court of Law and /or that the corner points mentioned in lines 3, 4 and 5 above were in conformance with the rules of the Michigan Board of Land Surveyors or by a Decree of a Court of Law; established, re-established, monumented, recovered, found as expressed below:

NOTE: Not more than 2 corners, all in the same town and range, may be recorded on this certificate.

A. Description of original monument and accessories and/or subsequent restoration:

E-9 Corner common to Sections 20, 21, 28 and 29, T31N, R5W
1850 - GLO subdivision of township. Set post at section corner. Cedar 7" S4°W 13 lks. Cedar 12" N35°E 23 lks.
1998 - Survey recorded at Liber 481, Page 260. Corner shown as "not set"

F-9 Corner common to Sections 21 and 28, T31N, R5W
1850 - GLO subdivision of township. Set ¼ section post. Cedar 10" S41°W 12 lks. Cedar 8" N57°E 32 lks.
1998 - Survey recorded at Liber 481, Page 260. Set ½ rod & cap # 26466 @ fence corner.
Fencepost East 0.62' 10" Tamarack S50°E 24.68' 5" Elm N63°W 21.58'

B. Description of corner evidence found and/or method applied in restoring or reestablishing corner:

E-9 Corner common to Sections 20, 21, 28 and 29, T31N, R5W
The Southwest corner of Section 21 was set using a three point control method. Due to the lack of any corner records, since the GLO survey, for 2+ miles to the West this method is believed to be appropriate in this instance. The latitude of the corner position was determined proportionally between Corner E-5 and corner E-11, T31N, R5W. The change in departure between corners G-9 and F-9 was used determine the East-West position of the corner. A 1"x3" pipe with cap # 43046 was set at the corner which falls approximately 100 feet South and 100 feet West of the southerly bank of the Jordan River. The river runs through wide flat bottom lands and likely has shifted course over the years. Consequently it was not felt acceptable to place the corner from GLO calls to the river. The GLO calls out the river 2.36 chains(155.8') East and on the random line 1 chain North. The corner was corrected approximately 36 feet West by the GLO surveyor and consequently the actual distance to the river North was likely more than 1 chain.

F-9 Corner common to Sections 21 and 28, T31N, R5W
Found ½" iron with cap (unreadable) which has been moved from position shown on recorded survey. Reset ½"x18" iron with cap # 43046 by witnesses of record. Spike in 10" Tamarack S50°E 24.68' Spike in 6" Elm S63°W 21.58'
Record bearing to Elm is apparently in error.

C. Description of monument for corner and accessories established to perpetuate locating the position of the corner:

E-9 Corner common to Sections 20, 21, 28 and 29, T31N, R5W
1" x 3' pipe with surveyors cap # 43046
Set Nail & Tag 3" Tamarack N31°E 45.93' Set Nail & Tag 2" Tamarack N73°E 30.22'
Set Nail & Tag 3" Tag-Alder S05°W 18.28' Set Nail & Tag 6" Elm (blazed) N86°W 52.78'

F-9 Corner common to Sections 21 and 28, T31N, R5W
½"x18" iron with surveyors cap # 43046
Fence post East 0.50' Set Nail & Tag 5" Cherry N26°E 7.89' Found Spike 10" Tamarack (dead) S50°E 24.68'
Found Spike 6" Elm S63°W 21.58' Set Nail & Tag in tree N48°W 30.14' ½" iron with surveyors cap West 5.16'

Signed by _____
Surveyor's Michigan License No. 43046

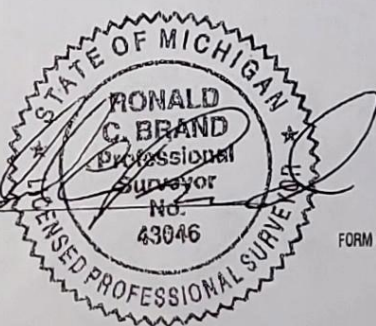

Date 6/26/2007
7/26/2007

LAND CORNER RECORDATION CERTIFICATE
Filing Requirement of Act 74, Mich. P.A. 1970

For corners in

Antrim

(County)

Located in:

Corner Code #

WARNER

1. Public Land Survey	<u>93</u>	<u>T4N R5W</u>	<u>E-11, G-11</u>
		T___R___	_____
		T___R___	_____
		T___R___	_____
2. Property Controlling In Section	S___	T___R___	_____
	S___	T___R___	_____
3. Miscellaneous Property In Sec.	S___	T___R___	_____
	S___	T___R___	_____

L 2 pg. 164

Register of Deeds Stamp & File Number

4. Lot No. _____, Recorded Plat _____
5. Private Claims _____

I, Arthur Lennox, in a field survey on Aug 3, 1998 do hereby state that under requirements of P.A. 74, Michigan P.A. of 1970, the corner points mentioned in lines 1 and 2 above were in conformance with regulations and rules therefore as required in the current manual of survey instructions of the United States Department of the Interior, Bureau of Land Management or by a decree of a Court of Law and/or that the corner points mentioned in lines 3, 4 and 5 above were in conformance with the rules of the Michigan Board of Land Surveyors or by a Decree of a Court of Law; established, re-established, monumented, recovered, found as expressed below:

NOTE: Not more than 2 corners, all in the same town and range, may be recorded on this certificate.

1	A	B	C	D	E	F	G	H	I	J	K	L	M
2		6		5		4		3		2		1	
3													
4		7		0		9		10		11		12	
5													
6		18		17		16		15		14		13	
7													
8		19		20		21		22		23		24	
9													
10		30		29		28		27		26		25	
11													
12		31		32		33		34		35		36	
13													

A. Description of original monument and accessories and/or subsequent restoration:

1) GLO set wood posts - 2.00 ch. from top of Hill

(G-11) GLO - wood post

B. Description of corner evidence found and/or method applied in restoring or reestablishing corner:

E-11 No evidence found for corner - set 1/2" bar & cap 2.00 ch west from top of hill being best evidence.

G-11 Found 1/2" iron in ROAD - Tree line to south per survey by LS #21594

C. Description of monument for corner and accessories established to perpetuate localizing the position of the corner:

E-11 set 1/2" bar & cap 10" R. Pine N45E 19.10 8" Spruce N25W 16.10 8" Spruce S30W 26.5

G-11 1/2" iron 8" R. Pine South 48.50 8" R. Pine S40E 34.00 Cable box N45W 45.80 1/2" steel bar South 33.00

Signed by Arthur Lennox
Surveyor's Michigan License No. 20357



Date Aug 3, 1998