

SURVEY MAP

SECTION 27, T32N, R03E, E. CENTRAL PART OF MONTMORENCY TWP., MONTMORENCY CO., MI

MICHIGAN STATE PLANE COORDINATES CENTRAL
ZONE-NAD83(2011) - UNITS ARE IN
INTERNATIONAL GRID FEET

| POINT# | NORTHING | EASTING |
|--------|-----------|-------------|
| 2701 | 665521.86 | 19768745.17 |
| 2702 | 665544.15 | 19767454.25 |
| 2703 | 665566.44 | 19766163.33 |
| 2704 | 665588.73 | 19764872.41 |
| 2705 | 665611.01 | 19763581.49 |
| 2706 | 664259.00 | 19763565.53 |
| 2707 | 664245.14 | 19764860.92 |
| 2709 | 664217.02 | 19767452.99 |
| 2710 | 664202.76 | 19768749.54 |
| 2711 | 662883.66 | 19768753.91 |
| 2712 | 662890.46 | 19767451.72 |
| 2713 | 662896.11 | 19766149.30 |
| 2714 | 662901.55 | 19764849.44 |
| 2715 | 662906.98 | 19763549.58 |
| 2721 | 660251.60 | 19768755.51 |
| 2722 | 660239.44 | 19767446.05 |
| 2723 | 660227.28 | 19766136.59 |
| 2724 | 660215.11 | 19764827.13 |
| 2725 | 660202.95 | 19763517.67 |

COMBINED SCALE FACTOR: 0.99988160

LEGEND

- GLO = GENERAL LAND OFFICE
 MGNR = MI DEPT. OF NATURAL RESOURCES
 DDC = DEPARTMENT OF CONSERVATION
 FNS = FRANK N. SMITH-PS#754
 DCD = DEAN C. DeLAMATER-PS#5778
 JLS = JAMES L. SCOTT-PS#8318
 DEM = DONALD E. MARLATT-PS#18660
 MVH = MARK V. HERMAN-PS#50438
 MSD = MATTHEW S. DONTZ-PS#56128
- * = Corner not recorded this survey
- Location of roads, trails, rivers etc.
 are approximate only from 2010
 Flashearth Imagery and field ties.
- = SECTION CORNER
 ⊕ = QUARTER CORNER
 ● = CENTER OF SECTION
 ⊙ = SIXTEENTH OR MISC. CORNER
 ——— = GRAVEL COUNTY RD. <66'>
 - - - - - = 2-Track Trall Rd.

DCP = ORANGE CARSONITE POST
 BCP = BLUE CARSONITE POST
 LT = LOCATION TAG
 2' AC = 2" DIA. ALUM. CAP ON 5/8"x3/4" REBAR
 CIR = CAPPED IRON ROD
 CIP = CAPPED IRON PIPE
 X-X-X = FENCE OR FENCE REMAINS
 SP = SINGLE PROPORTION TO GLO
 DP = DOUBLE PROPORTION TO GLO
 S.C. = STANDARD CORNER
 C.C. = CLOSING CORNER

GLO = GENERAL LAND OFFICE
 MGNR = MI DEPT. OF NATURAL RESOURCES
 DDC = DEPARTMENT OF CONSERVATION
 FNS = FRANK N. SMITH-PS#754
 DCD = DEAN C. DeLAMATER-PS#5778
 JLS = JAMES L. SCOTT-PS#8318
 DEM = DONALD E. MARLATT-PS#18660
 MVH = MARK V. HERMAN-PS#50438
 MSD = MATTHEW S. DONTZ-PS#56128

SHEET: 1 of 1

MICHIGAN
DEPARTMENT OF NATURAL RESOURCES

FOREST RESOURCE DIVISION - SURVEY SECTION

TYPE OF SURVEY AND LOCATION: BOUNDARY AND RETRACEMENT

SURVEY FOR SECTION 27, T32N, R03E, E. CENTRAL PART OF MONTMORENCY

TOWNSHIP, MONTMORENCY COUNTY, MICHIGAN.

DIVISION: FOREST RESOURCE SURVEY PROJ. NO.: FM-2211

SURVEY BY: MATTHEW S. DONTZ P.S.#56128 DATE: OCTOBER 2012

FIELD WORK BY: MATT DONTZ/ETHAN RICHMOND DATE: OCTOBER 2012

DRAWN BY: MATT DONTZ, P.S. DATE: OCTOBER 2012

CAD FILE: S:\OPM\SurveyData\PROJECTS\2011\FM2211\dwg\FM2211.dwg

NW COR. SEC. 27
 FD. 1/2"x18" CIR #18660 IN
 YARD OF OLD SCHOOL HOUSE
 BLDG. (NOW HUNTING CABIN).
 FITS MEASUREMENTS TO
 CORNERS OF BLDG. PER
 L.C.R.C. L.1, p.322.
 REPLACED WITH STANDARD
 DNR MONUMENT.

N 1/4 COR. SEC. 27
 SET DNR MON. PER
 BLM PROCEDURE. PREV.
 COR. USED BY OTHERS
 (L.1, p.322) IS S75°E 48.31'.

E 1/4 COR.
 SET 2" AC.
 PREV. COR. USED
 BY OTHERS (L.1, p.321)
 IS S74°E 72.65'.

NE COR. SEC. 27
 SET DNR MON. FROM
 BOTH ORIGINAL B.T.'S.
 PREV. COR. USED BY
 OTHERS (L.1, p.321) IS
 S74°E 97.27'.

N 1/4 COR.
 SET 2" AC.
 FD. 1/2" CIR #18660
 S74°37'51"E 48.00' &
 FD. CONC. MON
 S60°09'32"E 62.31'
 FROM SET COR.

Cert. of Survey by
 Donald E. Marlatt,
 P.S.#18660 - the W 1/2
 of the NE 1/4 of
 sec.27, T32N, R03E.

Cert. of Survey by
 Donald E. Marlatt,
 P.S.#18660 - L.1006,
 p.32 of the SW 1/4 of
 the NW 1/4 of sec.26,
 T32N, R03E.

Cert. of Survey by
 James L. Scott,
 P.S.#8318 in 1964
 W.O.No. - 60-84.

Cert. of Survey by
 Donald E. Marlatt,
 P.S.#18660 - the SE 1/4
 of the SE 1/4 of sec.27,
 T32N, R03E.

Cert. of Survey by
 Mark V. Herman, P.S.#50438
 L.1006, p.419 of the NW 1/4
 of the of sec.34, T32N, R03E.

S 1/4 COR. SEC. 27
 SET DNR MON. PER BLM
 PROCEDURE. SEARCHED FOR
 GLO EVIDENCE BUT NOTHING
 RECOVERED. FD. 1/2" BAR
 PER L.C.R.C. L.1, p.321
 S88°W 48.50'.

SE COR. SEC. 27
 FD. ENTIRE GLO CEDAR POST
 IN CREEK BOTTOM
 W/REMAINS OF CEDAR B.T.
 PREV. COR. USED BY
 OTHERS (L.1, p.321) IS
 S58°W 141.07'. REPLACED
 FD. GLO POST WITH DNR CAP
 ON 1 1/2" x 9" GALV. PIPE.

NOTE:
 NE 1/4 COR.
 SET 2" AC.
 FD. 1/2" CIR #18660
 S74°25'09"E 36.14' &
 FD. BROKEN CONC.
 MON N79°55'22"E
 34.88' FROM SET COR.

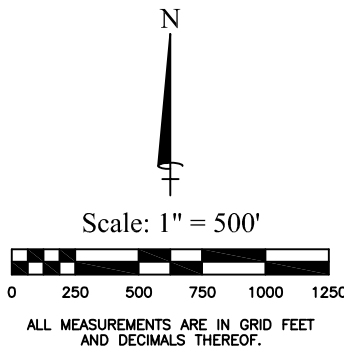

PLAN NO: R-60-BM