



DEPARTMENT OF NATURAL RESOURCES
STATE OF MICHIGAN

TIMBER SALE PROSPECTUS

Notice is hereby given that bids will be received by the Unit Manager,
GWINN MANAGEMENT UNIT, for certain timber on the following described lands:

DEER CREEK PONDS SALE / T49N, R27W, SEC. 16, SE1/4.
T49N, R27W, SEC. 21, E1/2NE.
MARQUETTE COUNTY (Appr. \$31,932.88)

MT. HARLOW SALE / T49N, R26W, SEC. 21, SE1/4.
MARQUETTE COUNTY (Appr. \$27,724.92)

////////////////////

SALE DATE AND TIME: 3:00 p.m. on June 08, 2009.

GWINN

BID INSTRUCTIONS (Ver. 06/23/2008):

1. Bid Location, Date, and Time: Bids must be received by the Unit Manager, Gwinn Management Unit, 410 West M-35, Gwinn, MI 49841, no later than 3:00 p.m. on June 8, 2009. For further information concerning this sale, contact the Unit Manager at 906-346-9201.
2. Bidder's Qualifications: Purchaser shall obtain workers compensation insurance to cover claims under Michigan's Worker's Disability Compensation Act of 1969 or similar employee benefit act of any other state applicable to an employee. If all or part of a timber sale was prepared by a private contractor, that contractor and that contractor's company are not permitted to bid on the timber sale contract. Bids will not be accepted from individuals or companies appearing on the DNR/FMFM No-Bid List. This list contains the names of purchasers who previously failed to execute a contract within 21-days or who have a history of poor performance.
3. Preparation of Sealed Bids: Bids shall be manually signed in ink; bid prices must be entered for each species and product in the Bid Price column for all material subject to bidding; and all fill-in blanks must be completed. If erasures or other changes appear on the forms, each erasure or change must be initialed by the person signing the bid.
4. Submission of Sealed Bids: Bid forms may be obtained from the Unit Manager. All bids must be submitted on the bid form and in an envelope clearly identified as described in this section. NOTE: Only one bid form per bid envelope. Sealed bids must be submitted to the Unit office designated in the prospectus and must be submitted at or prior to the time established in the prospectus. The envelope should show on the outside (a) that it is a "Bid for Timber," and (b) the sale name or number, and (c) the date and time of bid opening as shown in the prospectus. Bids received after the time specified in the sale prospectus are late bids and will be rejected.
5. Public Opening of Sealed Bids: If conditions permit, the sealed bids will be publicly opened and posted at the time and place set in the prospectus.
6. Award of Contract: Award of the contract will be made to the Bidder whose bid, conforming to the prospectus, is most advantageous to the State of Michigan on the basis of total value at rates bid for the estimated quantities. The State reserves the right to reject any bid or waive any minor irregularity in bids received. A written award mailed (or otherwise furnished) to the successful Bidder shall be deemed to result in a binding contract without further action by either party.
7. Down Payment: The Bidder to whom award is made must make a down payment within 21 days of the sale award. The amount of the down payment will be calculated as shown in the Bond and Payment Schedule of this prospectus. Only cash may be used to meet this requirement.
8. Performance Security: As guarantee of faithful performance, a cash bond, certificate of deposit, surety bond or irrevocable letter of credit (LOC) is required within 21 days of the sale award. The amount of the performance security is shown in the Bond and Payment Schedule of this prospectus. If an LOC or surety is used, the coverage must extend for at least 6 months beyond the contract expiration.
9. Timber Sale Contract: Additional conditions and requirements common to all timber sales are listed on the timber sale contract (R4031) and are available on line at www.michigan.gov/dnr. Contact the Unit Manager for additional information or a sample contract. Within 21 days of the date of the award letter, the bidder must sign the contract and provide the required down payment, performance security, and verification of worker's disability compensation. The down payment and performance security shall be in accordance with the provisions of the timber sale contract, in the sums stated in this prospectus. If these actions are not taken, then the Bidder, the Bidder's corporation, and the corporation's principals may not be permitted to bid on State timber sales for a period of 1 year. In addition, the Bidder certifies that if awarded this contract, the Bidder will complete the timber sale contract in accordance with its terms and any modifications thereof including requirements to purchase, cut, and remove the included timber by the termination date.

10. Disclaimer of Estimates and Bidder's Warranty of Inspection: Before submitting this bid, the Bidder is advised and cautioned to inspect the sale area, review the requirements of the sale contract, and take other steps as may be reasonably necessary to ascertain the location, estimated volumes, construction estimates, and operating costs of the proposed sale. Failure to do so will not relieve the Bidder from responsibility for completing the contract.

The Bidder warrants that this bid is submitted solely on the basis of the Bidder's examination and inspection of the quality and quantity of the timber offered for sale and the Bidder's opinion of the value thereof and the costs of recovery. No reliance should be placed on the State of Michigan's estimates of timber quality, quantity or costs of recovery. Bidder further acknowledges that the State of Michigan: (i) expressly disclaims any warranty of fitness of timber for any purpose; (ii) offers this timber as is without any warranty of quality (merchantability) or quantity and (iii) expressly disclaims any warranty as to the quantity or quality of timber sold.

11. Certification and Chain-of-Custody: Unless otherwise indicated in the contract under section 7 - Other Conditions of the Sale Specific Conditions & Requirements, the area encompassed by this timber sale is certified to the standards of the Forest Stewardship Council (FSC) - Certificate #SCS-FM/COC-090N and the Sustainable Forestry Initiative (SFI) - Certificate # NSF-SFIS-5Y031-S1. Forest products from this sale may be delivered to the mill as "FSC and / or SFI certified" as long as the contractor hauling the forest products is chain-of-custody (COC) certified or covered under a COC certificate from the destination mill. The purchaser is responsible for maintaining COC after leaving the sale area.

REBECCA A. HUMPHRIES
Director

DEER CREEK PONDS SALE (128-08-01)

A timber sale contract for this LUMP SUM SEALED timber sale will be awarded the responsible bidder offering the highest sealed bid price. Bids must be at or above the following appraised price for each species:

<u>SPECIES</u>	<u>ESTIMATED VOLUME*</u>	<u>APPRAISED PRICE</u>
PULPWOOD		
B. SPRUCE	377.00 CORDS	\$ 23.70/CORD
JACK PINE	542.00 CORDS	\$ 35.00/CORD

In addition, the successful bidder agrees to purchase the following species at the indicated appraised price:

<u>SPECIES</u>	<u>ESTIMATED VOLUME*</u>	<u>APPRAISED PRICE</u>
SAWLOGS		
P. BIRCH	.50 MBF	\$ 72.75/MBF
PULPWOOD		
P. BIRCH	64.00 CORDS	\$ 18.00/CORD
Q. ASPEN	76.00 CORDS	\$ 22.10/CORD
BALSAM FIR	31.00 CORDS	\$ 20.00/CORD
MIX HARDWD	30.00 CORDS	\$ 18.00/CORD

*The volumes are statistically estimated within plus (+) or minus (-) 16.05 percent. These estimated volumes are final and not subject to adjustment. Prospective bidders are urged to examine this timber and to make their own estimates of quantity and quality.

BOND AND PAYMENT SCHEDULE:

1. A bond in the amount of \$1,612.00 to insure faithful performance of the conditions of the contract, will be deposited by the successful bidder within 21 days of the sale award.
2. Cutting in any sale or unit without the required advance payment would be considered a trespass.
3. Total payment may be paid in advance or according to the following schedule:
 - (a) Ten percent (10%) of the sale value must be paid within 21 days of the sale award.
 - (b) The 10% down payment will be credited towards the first unit cut.
 - (c) Payment for each of the following units must be made before cutting begins in that unit:

<u>PAYMENT UNIT NUMBER</u>	<u>PERCENT OF TOTAL SALE VALUE</u>
1	22%
2	78%

4. If no cutting takes place, the 10% down payment will not be refunded.
5. Operations on the contract issued will terminate on November 30, 2011.



TIMBER SALE MAP

This information provided by authority of Part 525 of Act 451, PA 1994, as amended.

Sale Number	Year
32-128-08-01	08

Forest Management Unit Gwinn FMU	County Marquette	Mapped By Tom Seablom	Date 09/08/08	Page 1	of 1
		Cruised By Tom Seablom			

Township 49N	Range 27W	Section(s) and Subdivision(s) Sec. 16: SE; Sec. 21: E1/2 NE
------------------------	---------------------	-----------------------------------------------------------------------

Cover Type				Density	
A = Aspen	G = Grass	O = Oak	U = Upland Brush	0 = Non Stocked	5 = Pole Timber Medium
B = Paper Birch	H = Hemlock	P = Lowland Poplar	V = Bog or Marsh	1 = Seedling Sapling Poor	6 = Pole Timber Well
C = Cedar	J = Jack Pine	Q = Mixed Swamp Cnfr	W = White Pine	2 = Seedling Sapling Medium	7 = Saw Timber Poor
D = Treed Bog	L = Lowland Brush	R = Red Pine	X = Non Stocked	3 = Seedling Sapling Well	8 = Saw Timber Medium
E = Swamp Hdwoods	M = Mpl, Bch, Brch	S = Black Spruce	Z = Water	4 = Pole Timber Poor	9 = Saw Timber Well
F = Spruce Fir	N = Marsh	T = Tamarack			

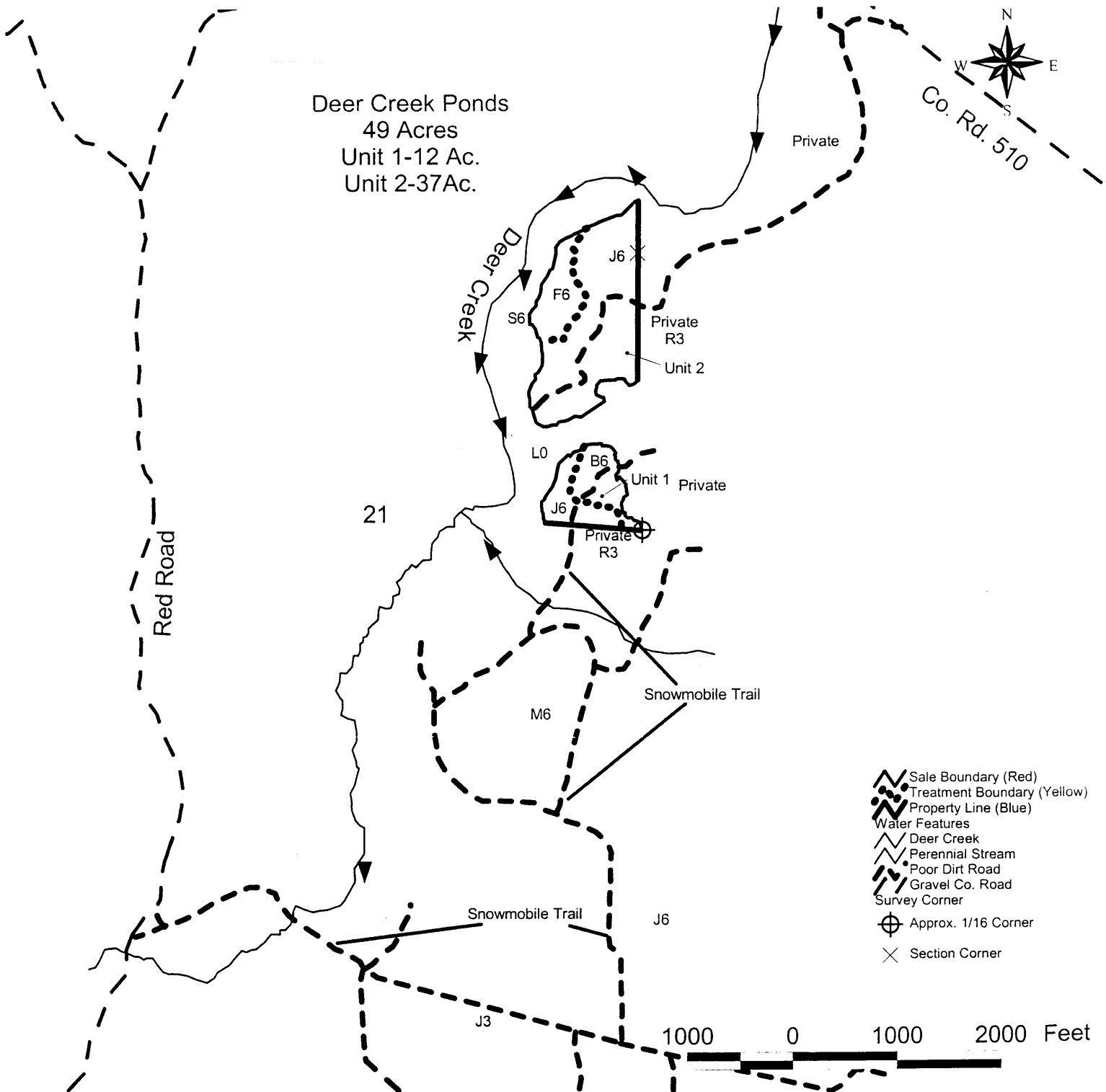

Sale Specific Conditions & Requirements

Sale Name: Deer Creek Ponds Sale Sale Number: 32-128-08-01

1 - Sale Area

1.2 - Boundaries

1.2.1 - Painted boundaries (6/05)

The sale boundary is marked and identified by blue, and red paint. Exterior sale boundary lines against private property are marked with blue paint. Exterior sale boundary lines against state are marked with red paint. Interior timber stand boundaries are marked with yellow paint. These yellow lines delineate treatment areas. Do not cut painted boundary line trees.

2 - Timber Specifications

2.1 - Included Timber

2.1.2 - Clearcut unit(s) w/o unmerchantable trees (5/07)

Within Payment Unit(s) 1 and 2 where scheduled treatment is final harvest, cut all jack pine, spruce, balsam fir, aspen, paper birch, and maple trees which meet minimum piece specifications in 2.2 Utilization. These areas are labeled J6 on the map. No other species of tree will be cut.

2.1.7 - Leave tree marked unit(s) (8/04)

Within Payment Unit(s) 1 and 2 that are scheduled for seed tree treatment (F6 and B6 on the map), all spruce, balsam fir, paper birch, aspen, jack pine and maple trees, which meet minimum piece specifications in 2.2 Utilization, are designated for cutting except trees marked with yellow or green paint. All trees that have paint on them will not be cut. All species of trees not designated will not be cut.

2.2 - Utilization

2.2.3 - Stump heights (4/07)

Stump heights within the Sale Area shall not exceed 6 inches for all trees. This is in order to facilitate planting operations.

2.2.4 - Skidding length (2/04)

Skidding of unlimbed tops or lengths over 17 feet is not permissible .

3 - Payments

3.3 - Pre-measured Sales

3.3.4 - Dividing payment units (7/05)

Payment unit(s) 2 may be divided at the request of the purchaser and upon approval of the Unit Manager. Dividing payment units is a contract modification which requires a Timber Sale Contract Supplement.

4 - Transportation

4.1 - Construction

4.1.3 - Slash and earthen piles (8/04)

Piles or windrows of earth along roads and landings that have been widened or constructed shall be leveled. Slash from road maintenance or construction, including stumps, shall be dispersed.

4.1.12 - No new roads (5/07)

No new roads will be permitted. All operations are limited to existing roads.

4.4 - Access

4.4.1 - Private property access (8/04)

Permission for access across private land is the responsibility of the successful bidder.

5 - Operations

5.1 - Notification

5.1.1 - Pre-sale conference (2/08)

A pre-sale conference on site between the Purchaser and sale administrator is required prior to beginning any operations.

5.2 - Conduct of Operations

5.2.1 - Slash

5.2.1.1 - Slash within sale area (2/04)

No trees are to be felled outside the sale area and all slash is to be kept at least 10 feet back from the blue paint line.

5.2.1.7 - Slash must be scattered (2/04)

Unless otherwise directed, slash and logging debris shall be uniformly scattered over the sale area and not left in piles or windrows. Slash shall not be allowed to accumulate at the landings. All slash work shall be done concurrently with harvesting.

5.2.3 - Operating Restrictions

5.2.3.5 - Operating restrictions (3/07)

Within Payment Unit(s) 1, unless changed by written agreement, cutting, skidding, and hauling are limited to the period of May 1 to November 1. This restriction is to prevent conflict with the snowmobile trail.

MT. HARLOW SALE (129-08-01)

A timber sale contract for this LUMP SUM SEALED timber sale will be awarded the responsible bidder offering the highest sealed bid price. Bids must be at or above the following appraised price for each species:

<u>SPECIES</u>	<u>ESTIMATED VOLUME*</u>	<u>APPRAISED PRICE</u>
SAWLOGS		
SUG. MAPLE	28.90 MBF	\$ 369.60/MBF
PULPWOOD		
MIX ASPEN	345.00 CORDS	\$ 24.00/CORD
MIX HARDWD	464.00 CORDS	\$ 15.00/CORD

In addition, the successful bidder agrees to purchase the following species at the indicated appraised price:

<u>SPECIES</u>	<u>ESTIMATED VOLUME*</u>	<u>APPRAISED PRICE</u>
SAWLOGS		
MIX HARDWD	11.30 MBF	\$ 159.60/MBF

*The volumes are statistically estimated within plus (+) or minus (-) 12.98 percent. These estimated volumes are final and not subject to adjustment. Prospective bidders are urged to examine this timber and to make their own estimates of quantity and quality.

BOND AND PAYMENT SCHEDULE:

1. A bond in the amount of \$1,456.00 to insure faithful performance of the conditions of the contract, will be deposited by the successful bidder within 21 days of the sale award.
2. Cutting in any sale or unit without the required advance payment would be considered a trespass.
3. Total payment may be paid in advance or according to the following schedule:
 - (a) Ten percent (10%) of the sale value must be paid within 21 days of the sale award.
 - (b) The 10% down payment will be credited towards the first unit cut.
 - (c) Payment for each of the following units must be made before cutting begins in that unit:

<u>PAYMENT UNIT NUMBER</u>	<u>PERCENT OF TOTAL SALE VALUE</u>
1	60%
2	30%
3	10%
4. If no cutting takes place, the 10% down payment will not be refunded.
5. Operations on the contract issued will terminate on May 31, 2011.



TIMBER SALE MAP

This information provided by authority of Part 525 of Act 451, PA 1994, as amended.

SALE NUMBER	YEAR
32-129-08-01	2008

FOREST MANAGEMENT UNIT: Gwin	COUNTY Marquette	MAPPED BY D. Wilson	DATE 3/6/08	PAGE OF
CRUISED BY				

TOWNSHIP T49N	RANGE R26W	SECTION(S) AND SUBDIVISION(S) 21: SE1/4	Scale: 4 inches..... = 1 mile
------------------	---------------	--------------------------------------------	--------------------------------------

Cover Type				Density	
A = Aspen	H = Hemlock	P = Lowland Poplar	V = Bog or Marsh	0 = Non Stocked	5 = Pole Timber Medium
B = Paper Birch	J = Jack Pine	Q = Mixed Swamp Cnfr	W = White Pine	1 = Seedling Sapling Poor	6 = Pole Timber Well
C = Cedar	L = Lowland Brush	R = Red Pine	X = Non Stocked	2 = Seedling Sapling Medium	7 = Saw Timber Poor
E = Swamp Hdwoods	M = Mpl, Bch, Brch	S = Black Spruce	Z = Water	3 = Seedling Sapling Well	8 = Saw Timber Medium
F = Spruce Fir	N = Marsh	T = Tamarack		4 = Pole Timber Poor	9 = Saw Timber Well
G = Grass	O = Oak	U = Upland Brush			

Mt. Harlow Sale

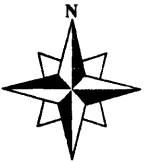

- ⊗ Select Cut, 40.3a, 6.3a
- ⊗ Clearcut, 11.5a, 2.5a

21

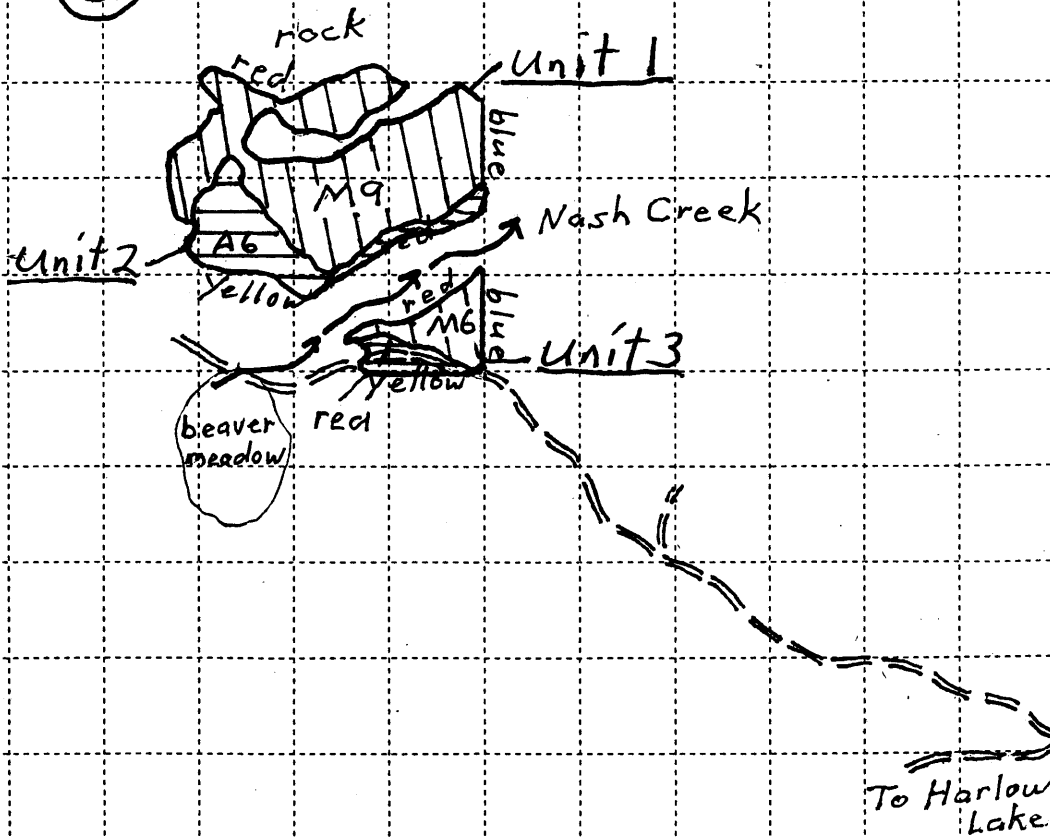

Sale Specific Conditions & Requirements

Sale Name: Mt. Harlow Sale Sale Number: 32-129-08-01

1 - Sale Area

1.2 - Boundaries

1.2.1 - Painted boundaries (6/05)

The sale boundary and Payment Unit boundaries are marked and identified by blue, red and yellow paint. Exterior sale boundary lines against private property are marked with blue paint. Exterior sale boundary lines against state are marked with red and yellow paint. Interior Payment Unit boundaries are marked with yellow and red paint. Do not cut painted boundary line trees.

2 - Timber Specifications

2.1 - Included Timber

2.1.2 - Clearcut unit(s) w/o unmerchantable trees (5/07)

Within Payment Unit(s) 2, and 3 (clearcut portion), cut all aspen and maple trees which meet minimum piece specifications in 2.2 Utilization. No other species of tree or trees marked with paint (any color) will be cut.

2.1.3 - Cut tree marked unit(s) (8/04)

Within Payment Unit(s) 1 and 3 (marked portion) all trees are designated for cutting when marked with orange paint above and below stump height, regardless of merchantability. Evidence or the painted stump mark will be preserved when cutting.

2.2 - Utilization

2.2.4 - Skidding length (2/04)

Skidding of unlimbed tops or lengths over 17 feet is not permissible.

2.2.9 - No chipping permitted (4/08)

Within Payment Unit(s) with marked hardwoods, no chipping is permitted.

3 - Payments

3.4 - Damaged Timber

Sale Name: Mt. Harlow Sale Sale Number: 32-129-08-01

3.4.1 - Damaged timber (6/05)

General Condition and Requirement 3.4 Damaged Timber, defines liquidated damages for undesignated live merchantable trees which are cut or injured. In addition, extreme care should be taken to avoid damage to tree seedlings and saplings. Damage to residual trees (defined as breaking of the cambium layer, broken tops or bending of trees from their natural position) is not acceptable.

Within the sale area, if more than 40% of the tree seedlings or saplings (1/4" to 4.5" DBH) within a specified portion of the sale area are damaged, liquidated damages will be assessed at \$200.00 per acre for all acreage within that specified portion of the sale area that was damaged. No damage is acceptable to merchantable trees. Within the sale area, if more than 5% of trees (> 4.5" DBH) within a specified area of the sale are damaged, liquidated damages will be assessed for all trees damaged. Rates will be in accordance with General Condition and Requirement 3.4 Damaged Timber, or at a rate of \$50.00 per sawtimber tree and \$10.00 per pole sized tree, whichever is greater.

4 - Transportation

4.1 - Construction

4.1.2 - Stream crossings, specific (2/04)

The Nash Creek crossing will require the installation of a portable bridge which may be borrowed from the DNR. This installation will be performed in accordance with the specifications on the appropriate permits which shall be provided by the DNR.

4.1.3 - Slash and earthen piles (8/04)

Piles or windrows of earth along roads and landings that have been widened or constructed shall be leveled. Slash from road maintenance or construction, including stumps, shall be dispersed throughout the sale.

4.1.6 - Road construction (6/07)

Construction of new roads or improvements of existing roads shall be done in such a way as to minimize the environmental and visual impacts. Merchantable trees shall be cut and utilized unless otherwise directed. Non-merchantable trees shall be severed and laid flat on the ground. Slash shall be scattered, and not left in windrows and kept a minimum of 10 feet back from the road edge. Stumps shall be set upright, not left on edge, and be moved at least 5 feet away from the road edge. Disturbed soil shall be feathered into the woods and not left in berms or windrows.

4.2 - Maintenance

4.2.1 - Hauling restriction (3/07)

Hauling may be restricted on forest roads by the Unit Manager or their representative. The restriction may occur during wet weather conditions.

5 - Operations

5.1 - Notification

Sale Name: Mt. Harlow Sale Sale Number: 32-129-08-01

5.1.1 - Pre-sale conference (2/08)

A pre-sale conference on site between the Purchaser and sale administrator is required prior to beginning any operations.

5.2 - Conduct of Operations

5.2.1 - Slash

5.2.1.1 - Slash within sale area (2/04)

No trees are to be felled outside the sale area and all slash is to be kept at least 10 feet back from the blue paint line.

5.2.1.7 - Slash must be scattered (2/04)

Unless otherwise directed, slash and logging debris shall be uniformly scattered over the sale area and not left in piles or windrows. Slash shall not be allowed to accumulate at the landings. All slash work shall be done concurrently with harvesting.

5.2.3 - Operating Restrictions

5.2.3.4 - Operating restrictions (3/07)

Within Payment Unit(s) 1, 2 and 3, unless changed by written agreement, cutting, skidding, and hauling are limited to the period of July 20 to March 31. This restriction is to protect the residual timber.

5.4 - Soil Protection

5.4.1 - Rutting restriction, general (5/08)

Operations are to cease immediately if equipment and weather conditions result in rutting of roads which is 4 inches or greater in depth and 50 feet in length. In addition, operations are to cease immediately if equipment and weather conditions result in rutting on skid trails which is 6 inches or greater in depth and 20 feet in length. The Unit Manager or their representative may restrict hauling and/or skidding if ruts exceed the specified depth. With the Unit Manager or their representative's approval, the Purchaser may return to the area when the weather conditions have changed and/or the risk of rutting has decreased.

TIMBER SALE / SEALED BID
STATE OF MICHIGAN / DNR

GWINN MANAGEMENT UNIT
GWINN

DEER CREEK PONDS SALE (128-08-01)
T49N, R27W, SEC. 16, SE1/4.
T49N, R27W, SEC. 21, E1/2NE.
MARQUETTE COUNTY

In response to the notice of sale to be held 3:00 p.m. on June 08, 2009, I am hereby submitting my sealed bid (firm offer) for the following forest products to be cut. Bids for individual species and total bid value must be at or above the appraised price. All non-responsive bid forms may be rejected.

<u>SPECIES</u>	<u>APPRAISED PRICE</u>	<u>BID PRICE</u>	<u>ESTIMATED VOLUME*</u>	<u>= VALUE</u>
PULPWOOD				
B. SPRUCE	\$ 23.70/CORD	\$ _____ X	377.00 CORDS	= \$ _____
JACK PINE	\$ 35.00/CORD	\$ _____ X	542.00 CORDS	= \$ _____
			SUBTOTAL 1	\$ _____

In addition, the successful bidder agrees to purchase the following species at the appraised price:

<u>SPECIES</u>	<u>APPRAISED PRICE</u>	<u>ESTIMATED VOLUME*</u>	<u>VALUE</u>	
SAWLOGS				
P. BIRCH	\$ 72.75/MBF	.50 MBF	= \$ 36.38	
PULPWOOD				
P. BIRCH	\$ 18.00/CORD	64.00 CORDS	= \$ 1,152.00	
Q. ASPEN	\$ 22.10/CORD	76.00 CORDS	= \$ 1,679.60	
BALSAM FIR	\$ 20.00/CORD	31.00 CORDS	= \$ 620.00	
MIX HARDWD	\$ 18.00/CORD	30.00 CORDS	= \$ 540.00	
			SUBTOTAL 2	\$ <u>4,027.98</u>
			SUBTOTAL 1 + SUBTOTAL 2 =	TOTAL BID VALUE \$ _____

*These volumes are statistically estimated within plus (+) or minus (-) 16.05%. These estimated volumes are final and not subject to adjustment. Prospective bidders are urged to examine this timber and to make their own estimates of quantity and quality.

I understand that any or all bids may be rejected, and that the individual unit bid price will be the basis to determine total bid value. All bids must be signed and all bid items must be bid or the bid form may be rejected. I also understand that consideration and awarding a contract will be based upon my past performance and ability to complete the contract based upon equipment and manpower subject to my control.

(bidder's printed name)

(bidder's signature)

Address/Telephone _____

THE WINNING BIDDER MUST COMPLETE THE FORM ON THE REVERSE SIDE
WITHIN 21 DAYS OF SALE AWARD



FOR DEPARTMENT USE ONLY

**TIMBER SALE
VERIFICATION OF WORKER'S DISABILITY
COMPENSATION ACT COMPLIANCE**

*As required by Act 317, P.A. 1969 (Worker's Compensation) and Part 525
of Act 451 of 1994, as amended.*

Sale or Permit No	
Year:	Type:
Forest Area:	

VERIFICATION OF WORKER'S DISABILITY COMPENSATION ACT COMPLIANCE

- This verification must be completed and submitted within 21 days of contract award and prior to the issuance of the timber sale contract.
- In addition, if boxes 2B or 2C are checked, then Notice of Exclusion or Certificate of Insurance must be submitted within 21 days of the contract award and prior to the issuance of the timber sale contract.
- All Information must be typed or printed except for written signatures.

Please Check Appropriate Categories:

1. My business is organized as (you **must** check one of the boxes below):
 - A. Sole Proprietorship (individual)
 - B. Partnership
 - C. Corporation
2. You **must** check one of the boxes below:
 - A. I certify that my business is a sole proprietorship and it has no employees but the sole proprietor. I am not subject to the Worker's Compensation Laws.
 - B. I certify that my business has satisfied its obligation to the Worker's Compensation Act through the use of an approved Notice of Exclusion (BWC-337, Rev. 5/96). I will provide a copy of the Notice of Exclusion within 21 days of the contract award. (For questions or a copy of the BWC-337, please call the Worker's Compensation Bureau at 517-322-1195).
 - C. I certify that my business has a Worker's Compensation Policy. I will provide an original Certificate of Insurance within 21 days of the contract award.
3. If you have checked item 2(A) or 2(B), you **must** indicate the number of **both** full and part time employees other than yourself including family members and active partners (if none, you must enter "0").

_____ Full Time Employees

_____ Part Time Employees

Name of Business		Federal ID (or) Social Security No.	
Address		Telephone No. ()	
City	State	Zip + 4	

I hereby certify that the above information is true and correct. I agree to notify the DNR of any changes that occur in factors affecting my coverage during any of my present and future operations.

Signature of Owner or Authorized Representative

Title

Date

TIMBER SALE / SEALED BID
STATE OF MICHIGAN / DNR

GWINN MANAGEMENT UNIT
GWINN

MT. HARLOW SALE (129-08-01)
T49N, R26W, SEC. 21, SE1/4.
MARQUETTE COUNTY

In response to the notice of sale to be held 3:00 p.m. on June 08, 2009, I am hereby submitting my sealed bid (firm offer) for the following forest products to be cut. Bids for individual species and total bid value must be at or above the appraised price. All non-responsive bid forms may be rejected.

<u>SPECIES</u>	<u>APPRAISED PRICE</u>	<u>BID PRICE</u>	<u>ESTIMATED VOLUME*</u>	<u>= VALUE</u>
SAWLOGS				
SUG. MAPLE	\$ 369.60/MBF	\$ _____ X	28.90 MBF	= \$ _____
PULPWOOD				
MIX ASPEN	\$ 24.00/CORD	\$ _____ X	345.00 CORDS	= \$ _____
MIX HARDWD	\$ 15.00/CORD	\$ _____ X	464.00 CORDS	= \$ _____
			SUBTOTAL 1	\$ _____

In addition, the successful bidder agrees to purchase the following species at the appraised price:

<u>SPECIES</u>	<u>APPRAISED PRICE</u>	<u>ESTIMATED VOLUME*</u>	<u>VALUE</u>	
SAWLOGS				
MIX HARDWD	\$ 159.60/MBF	11.30 MBF	= \$ 1,803.48	
			SUBTOTAL 2	\$ 1,803.48
SUBTOTAL 1 + SUBTOTAL 2 = TOTAL BID VALUE \$ _____				

*These volumes are statistically estimated within plus (+) or minus (-) 12.98%. These estimated volumes are final and not subject to adjustment. Prospective bidders are urged to examine this timber and to make their own estimates of quantity and quality.

I understand that any or all bids may be rejected, and that the individual unit bid price will be the basis to determine total bid value. All bids must be signed and all bid items must be bid or the bid form may be rejected. I also understand that consideration and awarding a contract will be based upon my past performance and ability to complete the contract based upon equipment and manpower subject to my control.

(bidder's printed name)

(bidder's signature)

Address/Telephone _____

THE WINNING BIDDER MUST COMPLETE THE FORM ON THE REVERSE SIDE
WITHIN 21 DAYS OF SALE AWARD



FOR DEPARTMENT USE ONLY	
Sale or Permit No	
Year:	Type:
Forest Area:	

**TIMBER SALE
VERIFICATION OF WORKER'S DISABILITY
COMPENSATION ACT COMPLIANCE**

As required by Act 317, P.A. 1969 (Worker's Compensation) and Part 525 of Act 451 of 1994, as amended.

VERIFICATION OF WORKER'S DISABILITY COMPENSATION ACT COMPLIANCE

- This verification must be completed and submitted within 21 days of contract award and prior to the issuance of the timber sale contract.
- In addition, if boxes 2B or 2C are checked, then Notice of Exclusion or Certificate of Insurance must be submitted within 21 days of the contract award and prior to the issuance of the timber sale contract.
- All information must be typed or printed except for written signatures.

Please Check Appropriate Categories:

1. My business is organized as (you must check one of the boxes below):
 - A. Sole Proprietorship (individual)
 - B. Partnership
 - C. Corporation
2. You must check one of the boxes below:
 - A. I certify that my business is a sole proprietorship and it has no employees but the sole proprietor. I am not subject to the Worker's Compensation Laws.
 - B. I certify that my business has satisfied its obligation to the Worker's Compensation Act through the use of an approved Notice of Exclusion (BWC-337, Rev. 5/96). I will provide a copy of the Notice of Exclusion within 21 days of the contract award. (For questions or a copy of the BWC-337, please call the Worker's Compensation Bureau at 517-322-1195).
 - C. I certify that my business has a Worker's Compensation Policy. I will provide an original Certificate of Insurance within 21 days of the contract award.
3. If you have checked item 2(A) or 2(B), you must indicate the number of both full and part time employees other than yourself including family members and active partners (if none, you must enter "0").

_____ Full Time Employees

_____ Part Time Employees

Name of Business		Federal ID (or) Social Security No.	
Address		Telephone No. ()	
City	State	Zip + 4	

I hereby certify that the above information is true and correct. I agree to notify the DNR of any changes that occur in factors affecting my coverage during any of my present and future operations.

Signature of Owner or Authorized Representative

Title

Date