



DEPARTMENT OF NATURAL RESOURCES  
STATE OF MICHIGAN

TIMBER SALE PROSPECTUS

Notice is hereby given that bids will be received by the Unit Manager,  
TRAVERSE CITY MANAGEMENT UNIT, for certain timber on the following described lands:

SPRING CREEK CLEARCUTS / T25N, R08W, SEC. 27, SENE SE.  
T25N, R08W, SEC. 34, E1/2NW N1/2NE.  
T26N, R08W, SEC. 26, NWSW.  
KALKASKA COUNTY (Appr. \$9,330.05)

RIVER SIDE ASPEN / T25N, R08W, SEC. 33, S1/2.  
KALKASKA COUNTY (Appr. \$15,900.10)

CRANBERRY LAKE ASPEN / T27N, R05W, SEC. 31, NWSE.  
T27N, R05W, SEC. 31, SWNW, SW1/4, S1/2SE.  
KALKASKA COUNTY (Appr. \$9,247.85)

FLOWING WELL RED-JACK / T27N, R06W, SEC. 26, S1/2SE.  
T27N, R06W, SEC. 36, N1/2NW, SWNW, W1/2SW.  
KALKASKA COUNTY (Appr. \$46,435.55)

GRAVEL PIT HARDWOODS / T27N, R05W, SEC. 30, S1/2SW1/4.  
T27N, R05W, SEC. 31, S1/2NW1/4, NENW, W1/2NE1/4.  
KALKASKA COUNTY (Appr. \$8,567.80)

////////////////////

SALE DATE AND TIME: 3:00 p.m. on May 04, 2009.

**KALKASKA**



**BID INSTRUCTIONS (Ver. 06/23/2008):**

1. **Bid Location, Date, and Time:** Bids must be received by the Unit Manager, Traverse City Management Unit, Kalkaska Field Office, 2089 N Birch St., Kalkaska, MI 49646, no later than 3:00 p.m. on May 4, 2009. For further information concerning this sale, contact the Unit Manager at 231-258-2711.
2. **Bidder's Qualifications:** Purchaser shall obtain workers compensation insurance to cover claims under Michigan's Worker's Disability Compensation Act of 1969 or similar employee benefit act of any other state applicable to an employee. If all or part of a timber sale was prepared by a private contractor, that contractor and that contractor's company are not permitted to bid on the timber sale contract. Bids will not be accepted from individuals or companies appearing on the DNR/FMFM No-Bid List. This list contains the names of purchasers who previously failed to execute a contract within 21-days or who have a history of poor performance.
3. **Preparation of Sealed Bids:** Bids shall be manually signed in ink; bid prices must be entered for each species and product in the Bid Price column for all material subject to bidding; and all fill-in blanks must be completed. If erasures or other changes appear on the forms, each erasure or change must be initialed by the person signing the bid.
4. **Submission of Sealed Bids:** Bid forms may be obtained from the Unit Manager. All bids must be submitted on the bid form and in an envelope clearly identified as described in this section. NOTE: Only one bid form per bid envelope. Sealed bids must be submitted to the Unit office designated in the prospectus and must be submitted at or prior to the time established in the prospectus. The envelope should show on the outside (a) that it is a "Bid for Timber," and (b) the sale name or number, and (c) the date and time of bid opening as shown in the prospectus. Bids received after the time specified in the sale prospectus are late bids and will be rejected.
5. **Public Opening of Sealed Bids:** If conditions permit, the sealed bids will be publicly opened and posted at the time and place set in the prospectus.
6. **Award of Contract:** Award of the contract will be made to the Bidder whose bid, conforming to the prospectus, is most advantageous to the State of Michigan on the basis of total value at rates bid for the estimated quantities. The State reserves the right to reject any bid or waive any minor irregularity in bids received. A written award mailed (or otherwise furnished) to the successful Bidder shall be deemed to result in a binding contract without further action by either party.
7. **Down Payment:** The Bidder to whom award is made must make a down payment within 21 days of the sale award. The amount of the down payment will be calculated as shown in the Bond and Payment Schedule of this prospectus. Only cash may be used to meet this requirement.
8. **Performance Security:** As guarantee of faithful performance, a cash bond, certificate of deposit, surety bond or irrevocable letter of credit (LOC) is required within 21 days of the sale award. The amount of the performance security is shown in the Bond and Payment Schedule of this prospectus. If an LOC or surety is used, the coverage must extend for at least 6 months beyond the contract expiration.
9. **Timber Sale Contract:** Additional conditions and requirements common to all timber sales are listed on the timber sale contract (R4031) and are available on line at [www.michigan.gov/dnr](http://www.michigan.gov/dnr). Contact the Unit Manager for additional information or a sample contract. Within 21 days of the date of the award letter, the bidder must sign the contract and provide the required down payment, performance security, and verification of worker's disability compensation. The down payment and performance security shall be in accordance with the provisions of the timber sale contract, in the sums stated in this prospectus. If these actions are not taken, then the Bidder, the Bidder's corporation, and the corporation's principals may not be permitted to bid on State timber sales for a period of 1 year. In addition, the Bidder certifies that if awarded this contract, the Bidder will complete the timber sale contract in accordance with its terms and any modifications thereof including requirements to purchase, cut, and remove the included timber by the termination date.

10. Disclaimer of Estimates and Bidder's Warranty of Inspection: Before submitting this bid, the Bidder is advised and cautioned to inspect the sale area, review the requirements of the sale contract, and take other steps as may be reasonably necessary to ascertain the location, estimated volumes, construction estimates, and operating costs of the proposed sale. Failure to do so will not relieve the Bidder from responsibility for completing the contract.

The Bidder warrants that this bid is submitted solely on the basis of the Bidder's examination and inspection of the quality and quantity of the timber offered for sale and the Bidder's opinion of the value thereof and the costs of recovery. No reliance should be placed on the State of Michigan's estimates of timber quality, quantity or costs of recovery. Bidder further acknowledges that the State of Michigan: (i) expressly disclaims any warranty of fitness of timber for any purpose; (ii) offers this timber as is without any warranty of quality (merchantability) or quantity and (iii) expressly disclaims any warranty as to the quantity or quality of timber sold.

11. Certification and Chain-of-Custody: Unless otherwise indicated in the contract under section 7 - Other Conditions of the Sale Specific Conditions & Requirements, the area encompassed by this timber sale is certified to the standards of the Forest Stewardship Council (FSC) - Certificate #SCS-FM/COC-090N and the Sustainable Forestry Initiative (SFI) - Certificate # NSF-SFIS-5Y031-S1. Forest products from this sale may be delivered to the mill as "FSC and / or SFI certified" as long as the contractor hauling the forest products is chain-of-custody (COC) certified or covered under a COC certificate from the destination mill. The purchaser is responsible for maintaining COC after leaving the sale area.

REBECCA A. HUMPHRIES  
Director

SPRING CREEK CLEARCUTS (027-08-01)

A timber sale contract for this LUMP SUM SEALED timber sale will be awarded the responsible bidder offering the highest sealed bid price. Bids must be at or above the following appraised price for each species:

<u>SPECIES</u>	<u>ESTIMATED VOLUME*</u>	<u>APPRAISED PRICE</u>
PULPWOOD		
MIX ASPEN	404.00 CORDS	\$ 15.80/CORD
MIX HARDWD	115.00 CORDS	\$ 8.20/CORD

In addition, the successful bidder agrees to purchase the following species at the indicated appraised price:

<u>SPECIES</u>	<u>ESTIMATED VOLUME*</u>	<u>APPRAISED PRICE</u>
SAWLOGS		
SUG. MAPLE	.50 MBF	\$ 277.00/MBF
RED MAPLE	11.00 MBF	\$ 80.00/MBF
WHITE PINE	2.40 MBF	\$ 33.00/MBF
PULPWOOD		
BALSAM FIR	91.00 CORDS	\$ 8.40/CORD
WHITE PINE	35.00 CORDS	\$ 4.05/CORD

\*The volumes are statistically estimated within plus (+) or minus (-) 14.45 percent. These estimated volumes are final and not subject to adjustment. Prospective bidders are urged to examine this timber and to make their own estimates of quantity and quality.

BOND AND PAYMENT SCHEDULE:

1. A bond in the amount of \$470.00 to insure faithful performance of the conditions of the contract, will be deposited by the successful bidder within 21 days of the sale award.
2. Cutting in any sale or unit without the required advance payment would be considered a trespass.
3. Total payment may be paid in advance or according to the following schedule:
  - (a) Ten percent (10%) of the sale value must be paid within 21 days of the sale award.
  - (b) The 10% down payment will be credited towards the first unit cut.
  - (c) Payment for each of the following units must be made before cutting begins in that unit:

<u>PAYMENT UNIT NUMBER</u>	<u>PERCENT OF TOTAL SALE VALUE</u>
1	45%
2	25%
3	30%
4. If no cutting takes place, the 10% down payment will not be refunded.
5. Operations on the contract issued will terminate on June 30, 2011.

Michigan Department of Natural Resources-Forest Management Division  
**TIMBER SALE MAP**

*This information provided under authority of Part 525, Act 451 of 1994, as amended.*

Sale No.	Year	Sale Type
61-027-08-01	08	01

State Forest and Forest Management Unit:  
**Traverse City**

Mapped By/ Cruised By:  
**R. Mattila**

Comp. 246 YOE 2010 Stand **14**  
 Comp. 247 YOE 2008 Stands 4, 18, 35

Township	Range	Section(s)	Subdivisor
25 N	8W	26, 27, 34	NWSW sec 26 SENE SE sec 27 E1/2NW N1/2NE sec 34

Scale: 1:15840

Cover Type				Density
A=Aspen	H=Hemlock	P=Lowland Poplar	V=Bog or Marsh	1=Non Stocked
B=Paper Birch	J=Jack Pine	Q=Mixed Swamp Cnfr	W=White Pine	2=Seedling Sapling Poor
C=Cedar	L=Lowland Brush	R=Red Pine	X=Non Stocked	3=Seedling Sapling Well
E=Swamp Hdwoods	M=Mpl, Bch, Brch	S=Black Spruce	Z=Water	4=Pole Timber Poor
F=Spruce Fir	N=Marsh	T=Tamarack		5=Pole Timber Medium
G=Grass	O=Oak	U=Upland Brush		6=Pole Timber Well
				7=Saw Timber Poor
				8=Saw Timber Medium
				9=Saw Timber Well

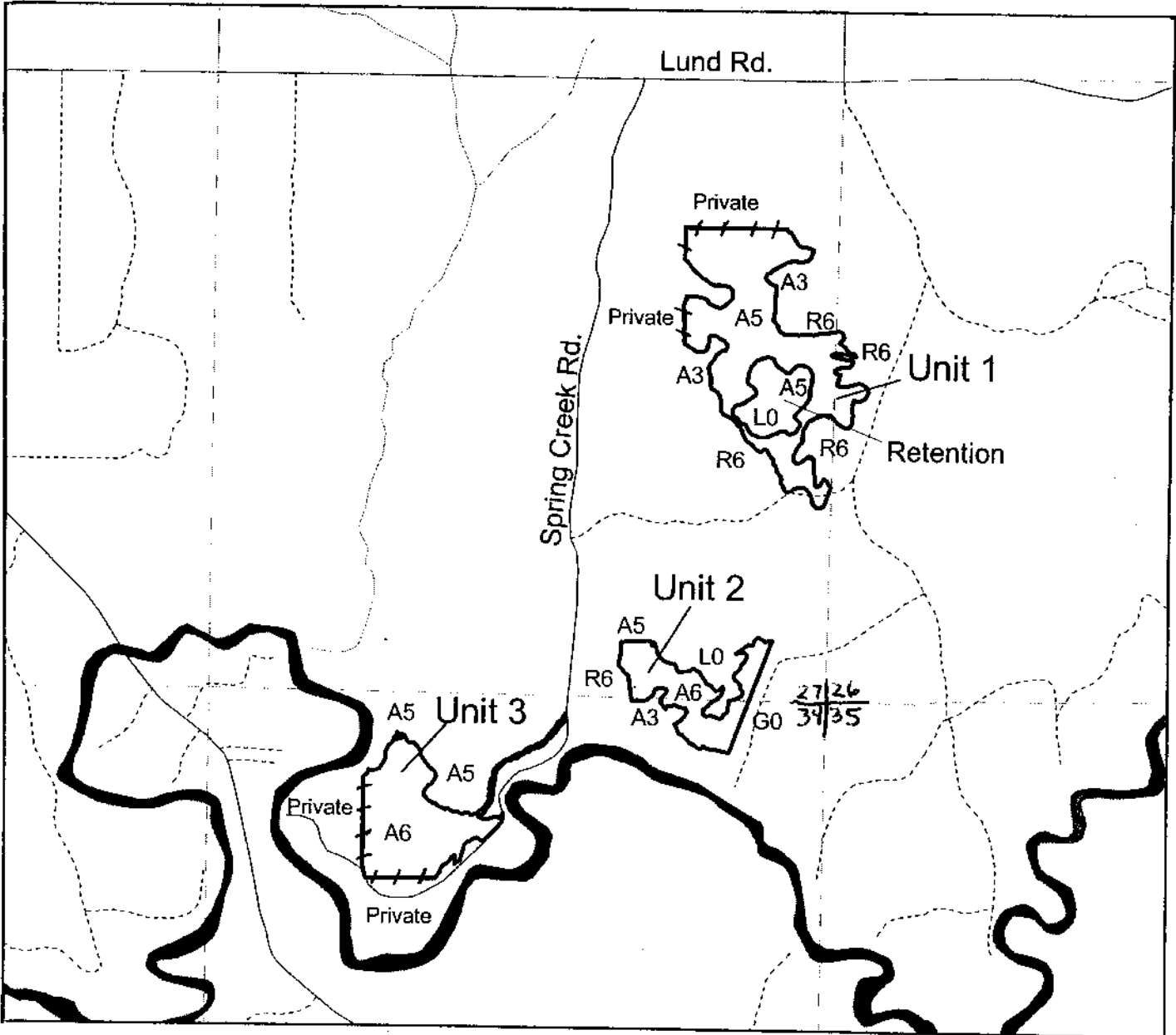

**LEGEND**

- Unit Boundary (Red Line)
- Unit Boundary (Blue Line)
- Road
- Forest Road

Spring Creek Clearcuts  
 Kalkaska Co.  
 68 ac.

UNIT 1	37 ac.
UNIT 2	12 ac.
UNIT 3	18 ac.
<b>TOTAL</b>	<b>68 ac.</b>

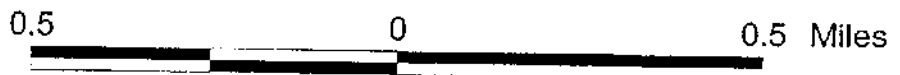

## Sale Specific Conditions & Requirements

Sale Name: Spring Creek Clearcuts    Sale Number: 61-027-08-01

### 1 - Sale Area

#### 1.2 - Boundaries

##### 1.2.1 - Painted boundaries (6/05)

The sale boundary and Payment Unit boundaries are marked and identified by blue and red paint. Exterior sale boundary lines against private property are marked with blue paint. Exterior sale boundary lines against state are marked with red paint.

### 2 - Timber Specifications

#### 2.1 - Included Timber

##### 2.1.1 - Clearcut unit(s) with unmerchantable trees (2/04)

Within Payment Unit(s) #'s 1, 2 & 3, cut all trees that are two (2) inches or more in diameter measured at a point of four and one-half (4-1/2) feet above ground level regardless of merchantability. Exception: Do NOT cut any Hemlock, Cedar, Oak, Red Pine and White Pine in Units 2 and 3.

##### 2.1.1.1 - Description of timber note (2/04)

Note that Mixed Hardwood Pulpwood consists of Sugar Maple, Red Maple, Black Ash, Black Cherry, and Ironwood.

### 4 - Transportation

#### 4.2 - Maintenance

##### 4.2.5 - Two wheel drive condition (2/04)

All existing trail roads on and adjacent to the sale area must be passable by two-wheel drive traffic for the duration of the sale.

### 5 - Operations

#### 5.2 - Conduct of Operations

##### 5.2.1 - Slash

###### 5.2.1.1 - Slash within sale area (2/04)

No trees are to be felled outside the sale area and all slash is to be kept at least 10 feet back from the blue paint line.

###### 5.2.1.7 - Slash must be scattered (2/04)

Unless otherwise directed, slash and logging debris shall be uniformly scattered over the sale area and not left in piles or windrows. Slash shall not be allowed to accumulate at the landings. All slash work shall be done concurrently with harvesting.

#### **5.2.4 - Dead and Down Creation**

##### 5.2.4.4 - Dead and down creation, grouse (9/05)

To encourage grouse use and other wildlife, in unit(s) 1, 2, & 3 leave two, 12" diameter or larger tree for every acre. The tree is to be cut at a height of about 4.5 feet above the ground and left. These will be evenly scattered throughout the cut unit. Each tree must be clearly identified by a piece of blue flagging.

##### 5.2.28 - Coppice regeneration protection (2/04)

To promote better aspen regeneration, this stand needs to be harvested from December 1 through March 31st. Timber harvest on any Payment Unit must be completed within twelve months of beginning operations on that unit in order to minimize damage to the new regeneration. Any post harvest operations, such as chipping, must be completed before sprouting of regeneration occurs. If it is anticipated that chipping will be delayed, then tops shall be carried to one central location or left unchipped. The Unit Manager or their representative may cease such operations if sprouting occurs before the operation is complete.

##### 5.2.29 - Shrub protection (9/07)

Do not cut or damage hawthorn, witch-hazel, dogwood or juneberry. These woody-shrub plants are highly beneficial to various wildlife species.

#### **5.4 - Soil Protection**

##### 5.4.1 - Rutting restriction, general (5/08)

Operations are to cease immediately if equipment and weather conditions result in rutting of roads which is 8 inches or greater in depth and 30 feet in length. In addition, operations are to cease immediately if equipment and weather conditions result in rutting on skid trails which is 6 inches or greater in depth and 25 feet in length. The Unit Manager or their representative may restrict hauling and/or skidding if ruts exceed the specified depth. With the Unit Manager or their representative's approval, the Purchaser may return to the area when the weather conditions have changed and/or the risk of rutting has decreased.

#### **6 - Safety and Fire Prevention**

##### **6.2 - Signing**

##### 6.2.1 - Road posting (9/08)

The purchaser is responsible for posting and maintaining caution signs on Spring Creek Road prior to beginning operations. The road must be posted at appropriate distances from the sale area to warn of logging activity and truck traffic. Signs must be removed when harvest operations are suspended or completed. The Purchaser will provide these signs for use on State-owned land.

#### **7 - Other Conditions**

##### **7.3 - Contract Modifications**



**Sale Name: Spring Creek Clearcuts    Sale Number: 61-027-08-01**

7.3.1.2 - Emerald ash borer, ash or firewood on sale (2/05)

There is ash and/or "firewood" in this sale and it is located within an emerald ash borer quarantined area. The Director of the Michigan Department of Agriculture (MDA) by the authority of Act No. 72 of the Public Acts of 1945, as amended, and Quarantine Regulation No. 620, has promulgated this quarantine to prevent the further spread of this pest and sets forth: definitions, regulated articles, regulated areas, conditions of movement, violations and penalties, and special exemptions. The purchaser must comply with this quarantine. Contact the MDA for further information.



RIVER SIDE ASPEN (028-08-01)

A timber sale contract for this LUMP SUM SEALED timber sale will be awarded the responsible bidder offering the highest sealed bid price. Bids must be at or above the following appraised price for each species:

<u>SPECIES</u>	<u>ESTIMATED VOLUME*</u>	<u>APPRAISED PRICE</u>
PULPWOOD		
MIX ASPEN	723.00 CORDS	\$ 17.75/CORD

In addition, the successful bidder agrees to purchase the following species at the indicated appraised price:

<u>SPECIES</u>	<u>ESTIMATED VOLUME*</u>	<u>APPRAISED PRICE</u>
SAWLOGS		
RED MAPLE	10.60 MBF	\$ 89.00/MBF
WHITE PINE	1.40 MBF	\$ 32.00/MBF
MIX ASPEN	12.50 MBF	\$ 54.00/MBF
PULPWOOD		
RED MAPLE	97.00 CORDS	\$ 12.95/CORD
P. BIRCH	5.00 CORDS	\$ 8.40/CORD
BALSAM FIR	9.00 CORDS	\$ 6.50/CORD
B. SPRUCE	4.00 CORDS	\$ 6.50/CORD
WHITE PINE	6.00 CORDS	\$ 3.50/CORD

\*The volumes are statistically estimated within plus (+) or minus (-) 11.20 percent. These estimated volumes are final and not subject to adjustment. Prospective bidders are urged to examine this timber and to make their own estimates of quantity and quality.

BOND AND PAYMENT SCHEDULE:

1. A bond in the amount of \$800.00 to insure faithful performance of the conditions of the contract, will be deposited by the successful bidder within 21 days of the sale award.
2. Cutting in any sale or unit without the required advance payment would be considered a trespass.
3. Total payment may be paid in advance or according to the following schedule:
  - (a) Ten percent (10%) of the sale value must be paid within 21 days of the sale award.
  - (b) The remainder is due before cutting begins.
4. If no cutting takes place, the 10% down payment will not be refunded.
5. Operations on the contract issued will terminate on June 30, 2011.

Michigan Department of Natural Resources-Forest Management Division

TIMBER SALE MAP

This information provided under authority of Part 525, Act 451 of 1994, as amended.

Sale No.	Year	Sale Type
61-028-08-01	08	01

State Forest and Forest Management Unit:

Mapped By/ Cruised By:

Traverse City

R. Mattila

Comp. 247 YEO 2008  
Stands 67, 92

Township	Range	Section(s)	Subdivision
25 N	8W	33	S1/2 sec 33

Scale: 1:15840

A=Aspen  
B=Paper Birch  
C=Cedar  
E=Swamp Hdwoods  
F=Spruce Fir  
G=Grass

H=Hemlock  
J=Jack Pine  
L=Lowland Brush  
M=Mpl, Bch, Brch  
N=Marsh  
O=Oak

P=Lowland Poplar  
Q=Mixed Swamp Cnfr  
R=Red Pine  
S=Black Spruce  
T=Tamarack  
U=Upland Brush

V=Bog or Marsh  
W=White Pine  
X=Non Stocked  
Z=Water

Density  
1=Non Stocked  
2=Seedling Sapling Poor  
3=Seedling Sapling Well  
4=Pole Timber Poor  
5=Pole Timber Medium  
6=Pole Timber Well

7=Saw Timber Poor  
8=Saw Timber Medium  
9=Saw Timber Well

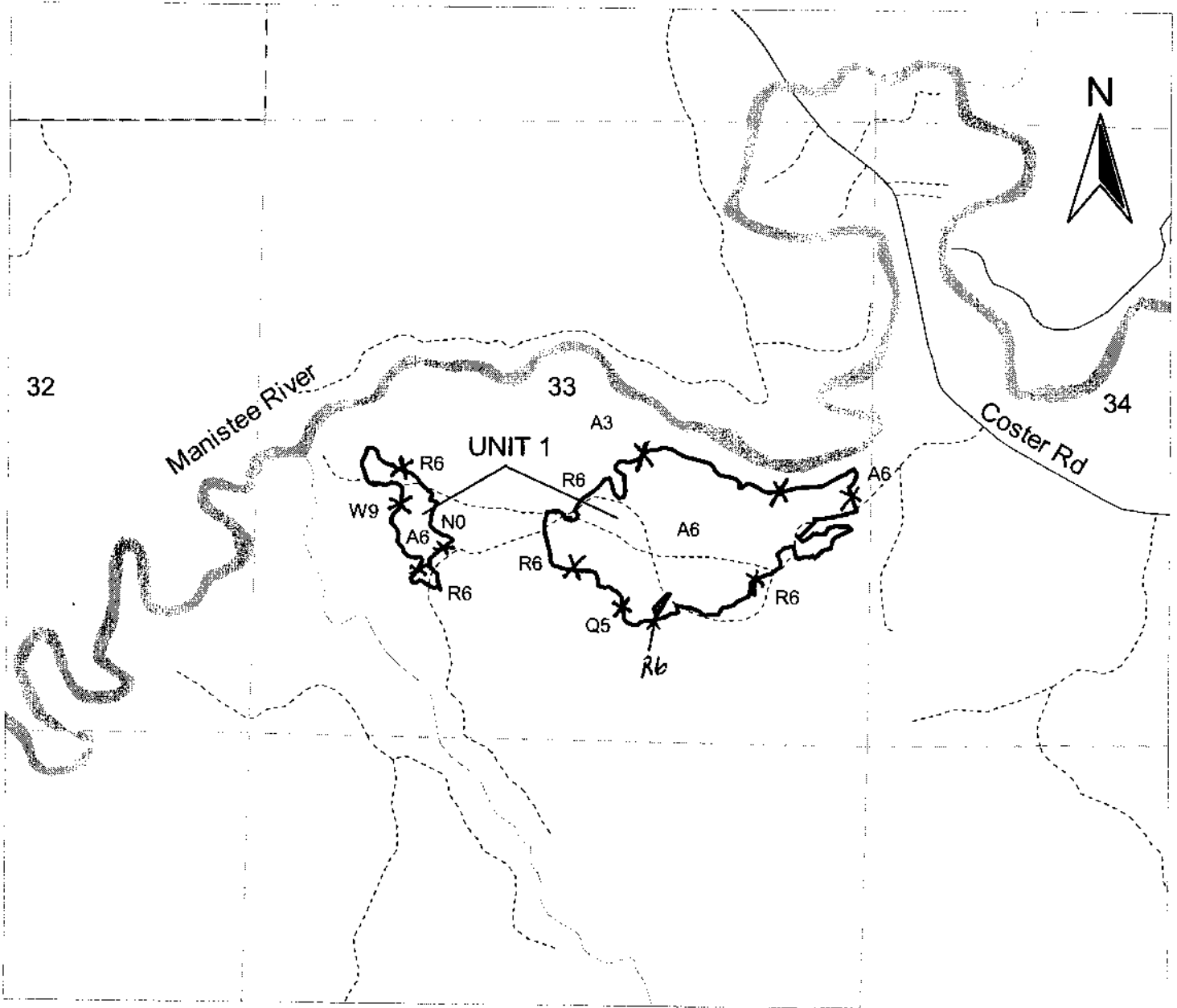

LEGEND

Unit Boundary (Red Line)  
Road  
Forest Road



River Side Aspen  
Kalkaska Co.  
61 ac.

UNIT 1 61 ac.  
TOTAL 61 ac.



## Sale Specific Conditions & Requirements

Sale Name: River Side Aspen Sale Number: 61-028-08-01

### 1 - Sale Area

#### 1.2 - Boundaries

##### 1.2.1 - Painted boundaries (6/05)

The sale boundary is marked and identified by red paint. Exterior sale boundary lines against state are marked with red paint. Do not cut painted boundary line trees.

### 2 - Timber Specifications

#### 2.1 - Included Timber

##### 2.1.1 - Clearcut unit(s) with unmerchantable trees (2/04)

Within Payment Unit(s) # 1, cut all trees that are two (2) inches or more in diameter measured at a point of four and one-half (4-1/2) feet above ground level regardless of merchantability. Exception: Do NOT cut any Red Pine or Oak.

### 4 - Transportation

#### 4.2 - Maintenance

##### 4.2.5 - Two wheel drive condition (2/04)

All existing trail roads on and adjacent to the sale area must be passable by two-wheel drive traffic for the duration of the sale.

### 5 - Operations

#### 5.2 - Conduct of Operations

##### 5.2.1 - Slash

##### 5.2.1.7 - Slash must be scattered (2/04)

Unless otherwise directed, slash and logging debris shall be uniformly scattered over the sale area and not left in piles or windrows. Slash shall not be allowed to accumulate at the landings. All slash work shall be done concurrently with harvesting.

##### 5.2.4 - Dead and Down Creation

##### 5.2.4.4 - Dead and down creation, grouse (9/05)

To encourage grouse use and other wildlife, in unit(s) # 1, leave 1-2, 12" diameter or larger trees cut at 4.5 feet above ground level every acre. These will be evenly scattered throughout the cut unit. Each tree must be clearly identified by a piece of blue flagging.

**Sale Name: River Side Aspen    Sale Number: 61-028-08-01**

**5.2.28 - Coppice regeneration protection (2/04)**

To promote better aspen regeneration, this stand needs to be harvested from November 1 through March 31st. Timber harvest on any Payment Unit must be completed within twelve months of beginning operations on that unit in order to minimize damage to the new regeneration. Any post harvest operations, such as chipping, must be completed before sprouting of regeneration occurs. If it is anticipated that chipping will be delayed, then tops shall be carried to one central location or left unchipped. The Unit Manager or their representative may cease such operations if sprouting occurs before the operation is complete.

**5.2.29 - Shrub protection (9/07)**

Do not cut or damage hawthorn, witch-hazel, dogwood or juneberry. These woody-shrub plants are highly beneficial to various wildlife species.

**6 - Safety and Fire Prevention**

**6.2 - Signing**

**6.2.1 - Road posting (9/08)**

The purchaser is responsible for posting and maintaining caution signs on Coster Rd. prior to beginning operations. The road must be posted at appropriate distances to warn of logging activity and truck traffic. Signs must be removed when harvest operations are suspended or completed. The Purchaser will provide these signs for use on State-owned land.

**7 - Other Conditions**

**7.3 - Contract Modifications**

**7.3.1.2 - Emerald ash borer, ash or firewood on sale (2/05)**

There is ash and/or "firewood" in this sale and it is located within an emerald ash borer quarantined area. The Director of the Michigan Department of Agriculture (MDA) by the authority of Act No. 72 of the Public Acts of 1945, as amended, and Quarantine Regulation No. 620, has promulgated this quarantine to prevent the further spread of this pest and sets forth: definitions, regulated articles, regulated areas, conditions of movement, violations and penalties, and special exemptions. The purchaser must comply with this quarantine. Contact the MDA for further information.

CRANBERRY LAKE ASPEN (051-08-01)

A timber sale contract for this LUMP SUM SEALED timber sale will be awarded the responsible bidder offering the highest sealed bid price. Bids must be at or above the following appraised price for each species:

<u>SPECIES</u>	<u>ESTIMATED VOLUME*</u>	<u>APPRAISED PRICE</u>
SAWLOGS		
MIX ASPEN	22.00 MBF	\$ 47.00/MBF
MIX HARDWD	28.00 MBF	\$ 75.00/MBF
PULPWOOD		
MIX ASPEN	297.00 CORDS	\$ 14.50/CORD
MIX HARDWD	189.00 CORDS	\$ 6.75/CORD

In addition, the successful bidder agrees to purchase the following species at the indicated appraised price:

<u>SPECIES</u>	<u>ESTIMATED VOLUME*</u>	<u>APPRAISED PRICE</u>
PULPWOOD		
BASSWOOD	85.00 CORDS	\$ 5.20/CORD
WHITE PINE	32.00 CORDS	\$ 2.80/CORD

\*These estimated volumes are final and not subject to adjustment. Prospective bidders are urged to examine this timber and to make their own estimates of quantity and quality.

BOND AND PAYMENT SCHEDULE:

1. A bond in the amount of \$500.00 to insure faithful performance of the conditions of the contract, will be deposited by the successful bidder within 21 days of the sale award.
2. Cutting in any sale or unit without the required advance payment would be considered a trespass.
3. Total payment may be paid in advance or according to the following schedule:
  - (a) Ten percent (10%) of the sale value must be paid within 21 days of the sale award.
  - (b) The 10% down payment will be credited towards the first unit cut.
  - (c) Payment for each of the following units must be made before cutting begins in that unit:

<u>PAYMENT UNIT NUMBER</u>	<u>PERCENT OF TOTAL SALE VALUE</u>
1	35%
2	15%
3	15%
4	35%

4. If no cutting takes place, the 10% down payment will not be refunded.
5. Operations on the contract issued will terminate on June 30, 2011.



Michigan Department of Natural Resources-Forest Management Division  
**TIMBER SALE MAP**

*This information provided under authority of Part 525, Act 451 of 1994, as amended.*

Sale No.	Year	Sale Type
61-051	08	01

State Forest and Forest Management Unit: <b>Pere Marquette/Traverse City MU</b>		Mapped and Cruised By: <b>Donna Hagan</b>		Date: <b>September 29, 2008</b>
Township <b>27 N</b>	Range <b>05 W</b>	Section(s) <b>31</b>	Subdivision <b>SWNW, SW1/4, S1/2SE, NWSE</b>	Scale: <b>1:15840</b>

Cover Type				Density		
A=Aspen	H=Hemlock	P=Lowland Poplar	V=Bog or Marsh	1=Non Stocked	7=Saw Timber Poor	
B=Paper Birch	J=Jack Pine	Q=Mixed Swamp Cntr	W=White Pine	2=Seedling Sapling Poor	8=Saw Timber Medium	
C=Cedar	L=Lowland Brush	R=Red Pine	X=Non Stocked	3=Seedling Sapling Well	9=Saw Timber Well	
E=Swamp Hdwoods	M=Mpl, Bch, Brch	S=Black Spruce	Z=Water	4=Pole Timber Poor		
F=Spruce Fir	N=Marsh	T=Tamarack		5=Pole Timber Medium		
G=Grass	O=Oak	U=Upland Brush		6=Pole Timber Well		

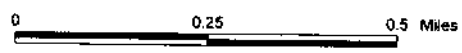
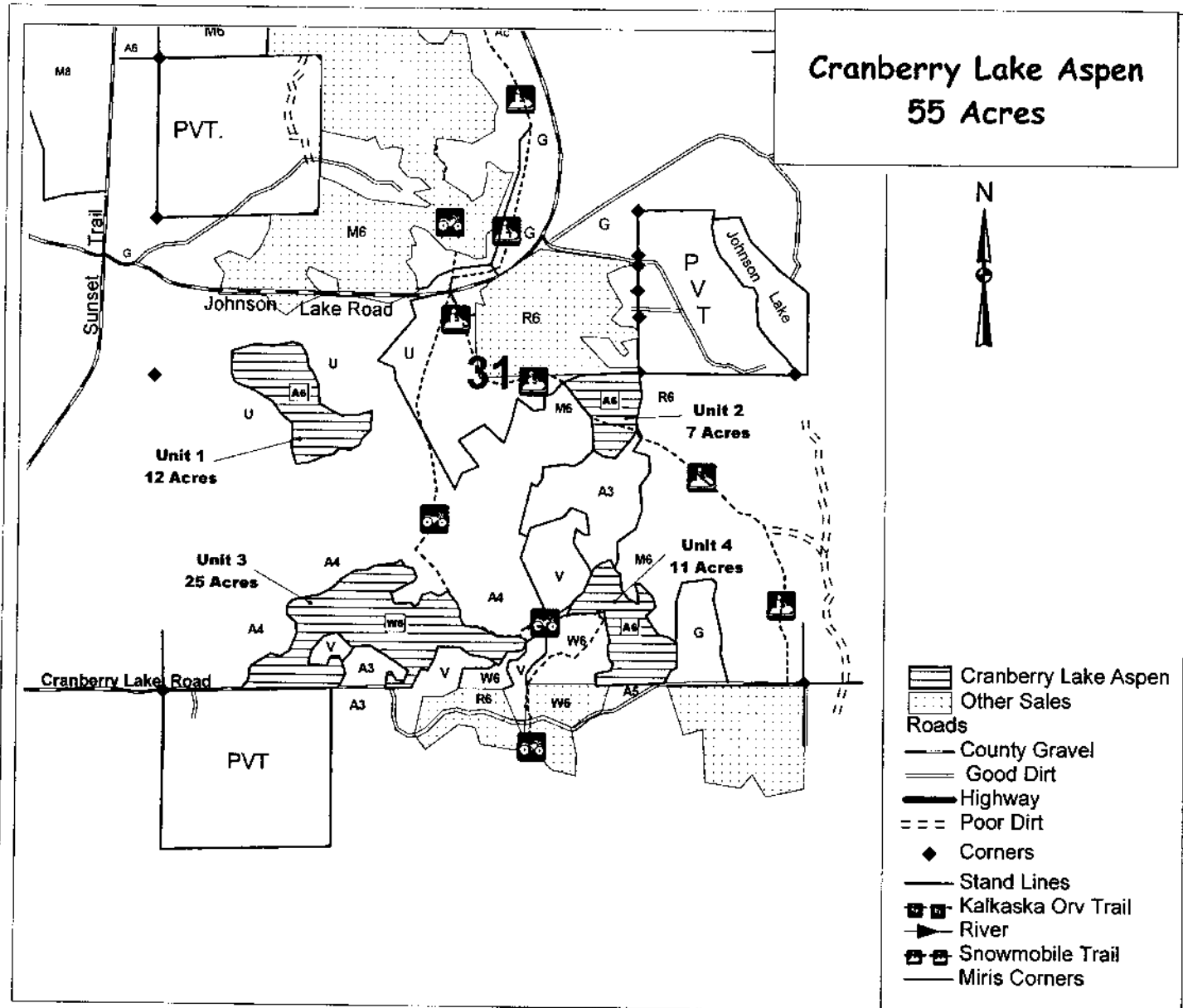



## Sale Specific Conditions & Requirements

Sale Name: Cranberry Lake Aspen Sale Number: 61-051-08-01

### 1 - Sale Area

#### 1.2 - Boundaries

##### 1.2.1 - Painted boundaries (6/05)

The sale boundary is marked and identified by red paint.

### 2 - Timber Specifications

#### 2.1 - Included Timber

##### 2.1.1 - Clearcut unit(s) with unmerchantable trees (2/04)

Within Payment Unit(s) 1, 2 and 4, cut all trees that are two (2) inches or more in diameter measured at a point of four and one-half (4-1/2) feet above ground level regardless of merchantability except: Unit 1 - do not cut black cherry; Unit 2 - do not cut white pine greater than 12" DBH; Unit 4 - do not cut oak, white pine or red pine.

##### 2.1.4 - Species designation unit(s) (5/07)

Within Payment Unit(s) 3 all aspen and red maple trees are designated for cutting regardless of merchantability. Also cut all trees marked with orange paint.

### 4 - Transportation

#### 4.1 - Construction

##### 4.1.3 - Slash and earthen piles (8/04)

Piles or windrows of earth along roads and landings that have been widened or constructed shall be leveled. Slash from road maintenance or construction, including stumps, shall be dispersed throughout the sale.

##### 4.1.6 - Road construction (6/07)

Construction of new roads or improvements of existing roads shall be done in such a way as to minimize the environmental and visual impacts. Merchantable trees shall be cut and utilized unless otherwise directed. Non-merchantable trees shall be severed and laid flat on the ground. Slash shall be scattered, and not left in windrows and kept a minimum of 10 feet back from the road edge. Stumps shall be set upright, not left on edge, and be moved at least 10 feet away from the road edge. Disturbed soil shall be feathered into the woods and not left in berms or windrows.

**Sale Name: Cranberry Lake Aspen    Sale Number: 61-051-08-01**

**4.1.7 - Road closure (4/07)**

All new roads built into the sale must be blocked to vehicle traffic upon completion of the sale. Overgrown roads that are reopened shall be considered new roads. In general, this will require constructing a four (4) foot high berm constructed of stumps and logs covered with earth. Stumps and brush must be placed along the remainder of the trail. These roads must be rendered impassable to cars and trucks. All stumps from road building and landing construction must be reserved to block any newly constructed roads upon completion of the sale. These stumps must be scattered along the road system to prohibit vehicular movement. Contact the sale administrator for specific details of design and placement.

**5 - Operations**

**5.1 - Notification**

**5.1.1 - Pre-sale conference (2/08)**

A pre-sale conference on site between the Purchaser and sale administrator is required prior to beginning any operations to determine landing and road locations.

**5.2 - Conduct of Operations**

**5.2.4 - Dead and Down Creation**

**5.2.4.4 - Dead and down creation, grouse (9/05)**

To encourage grouse use and other wildlife, in unit(s) 1, leave one, 12" diameter or larger log-length (8 foot minimum) piece on the ground for every 2 acres. These trees must be left standing until all merchantable trees are moved to the landing, at which time they are to be cut, felled and left on the ground. They must be cut at least 4 feet above the ground level leaving a snag. The felled portion of the tree must be within 3 feet of the snag. These will be evenly scattered throughout the cut unit.

**5.2.39 - ORV trail protection (9/07)**

The ORV trail is shown on the Timber Sale Map. Do not cut trees or damage posts with orange ORV markers. Maintain a 20 foot wide slash, debris, and rut free zone daily using the ORV trail as the centerline. Do not run equipment down the ORV trail.

**5.2.41 - Snowmobile trail protection (4/07)**

The snowmobile trail is shown on the Timber Sale Map. If the trail is used, it must be maintained throughout the sale and restored to a condition equal to or better than before the sale. Do not cut or damage posts with orange trail markers or traffic control signs. Maintain a [20] foot wide slash, debris, and rut free zone daily using the snowmobile trail as the centerline. If the trail is used for hauling, it must be graded to the satisfaction of the Unit Manager or their representative prior to December 1st. The snowmobile trail may not be used for any timber sale operations from December 1 to March 31. The snowmobile trail may only be crossed at right angles.

**6 - Safety and Fire Prevention**

**6.2 - Signing**

**Sale Name: Cranberry Lake Aspen    Sale Number: 61-051-08-01**

**6.2.3 - Recreational trail posting (9/08)**

The purchaser is responsible for posting and maintaining caution signs on the ORV trail prior to beginning operations. The trail must be posted at appropriate distances from the sale area to warn of logging activity and truck traffic at both ends of the trail. The purchaser must maintain the signs during the trail use season. The Purchaser will provide these signs for use on State-owned land.



FLOWING WELL RED-JACK (078-08-01)

A timber sale contract for this LUMP SUM SEALED timber sale will be awarded the responsible bidder offering the highest sealed bid price. Bids must be at or above the following appraised price for each species:

<u>SPECIES</u>	<u>ESTIMATED VOLUME*</u>	<u>APPRAISED PRICE</u>
SAWLOGS		
RED PINE	139.00 MBF	\$ 108.00/MBF
PULPWOOD		
RED PINE	697.00 CORDS	\$ 34.70/CORD
JACK PINE	745.00 CORDS	\$ 6.55/CORD

In addition, the successful bidder agrees to purchase the following species at the indicated appraised price:

<u>SPECIES</u>	<u>ESTIMATED VOLUME*</u>	<u>APPRAISED PRICE</u>
PULPWOOD		
WHITE PINE	281.00 CORDS	\$ 2.50/CORD
MIX ASPEN	106.00 CORDS	\$ 12.50/CORD
MIX HARDWD	59.00 CORDS	\$ 5.60/CORD

\*The volumes are statistically estimated within plus (+) or minus (-) 14.38 percent. These estimated volumes are final and not subject to adjustment. Prospective bidders are urged to examine this timber and to make their own estimates of quantity and quality.

BOND AND PAYMENT SCHEDULE:

1. A bond in the amount of \$2,500.00 to insure faithful performance of the conditions of the contract, will be deposited by the successful bidder within 21 days of the sale award.
2. Cutting in any sale or unit without the required advance payment would be considered a trespass.
3. Total payment may be paid in advance or according to the following schedule:
  - (a) Ten percent (10%) of the sale value must be paid within 21 days of the sale award.
  - (b) The 10% down payment will be credited towards the first unit cut.
  - (c) Payment for each of the following units must be made before cutting begins in that unit:

<u>PAYMENT UNIT NUMBER</u>	<u>PERCENT OF TOTAL SALE VALUE</u>
1	18%
2	22%
3	47%
4	13%
4. If no cutting takes place, the 10% down payment will not be refunded.
5. Operations on the contract issued will terminate on June 30, 2011.



Michigan Department of Natural Resources-Forest Management Division  
**TIMBER SALE MAP**

*This information provided under authority of Part 525, Act 451 of 1994, as amended.*

Sale No.	Year	Sale Type
61-078	08	01

State Forest and Forest Management Unit:		Mapped and Cruised By:		Date:	
Pere Marquette/Traverse City MU		Donna Hagan		September 29, 2008	
Township	Range	Section(s) /Subdivision		Scale:	
27 N	06 W	26 - S1/2SE 36 - N1/2NW, SWNW, W1/2SW		1:15840	

Cover Type				Density		
A=Aspen	H=Hemlock	P=Lowland Poplar	V=Bog or Marsh	1=Non Stocked	7=Saw Timber Poor	
B=Paper Birch	J=Jack Pine	Q=Mixed Swamp Cnfr	W=White Pine	2=Seedling Sapling Poor	8=Saw Timber Medium	
C=Cedar	L=Lowland Brush	R=Red Pine	X=Non Stocked	3=Seedling Sapling Well	9=Saw Timber Well	
E=Swamp Hdwoods	M=Mpl, Bch, Brch	S=Black Spruce	Z=Water	4=Pole Timber Poor		
F=Spruce Fir	N=Marsh	T=Tamarack		5=Pole Timber Medium		
G=Grass	O=Oak	U=Upland Brush		6=Pole Timber Well		

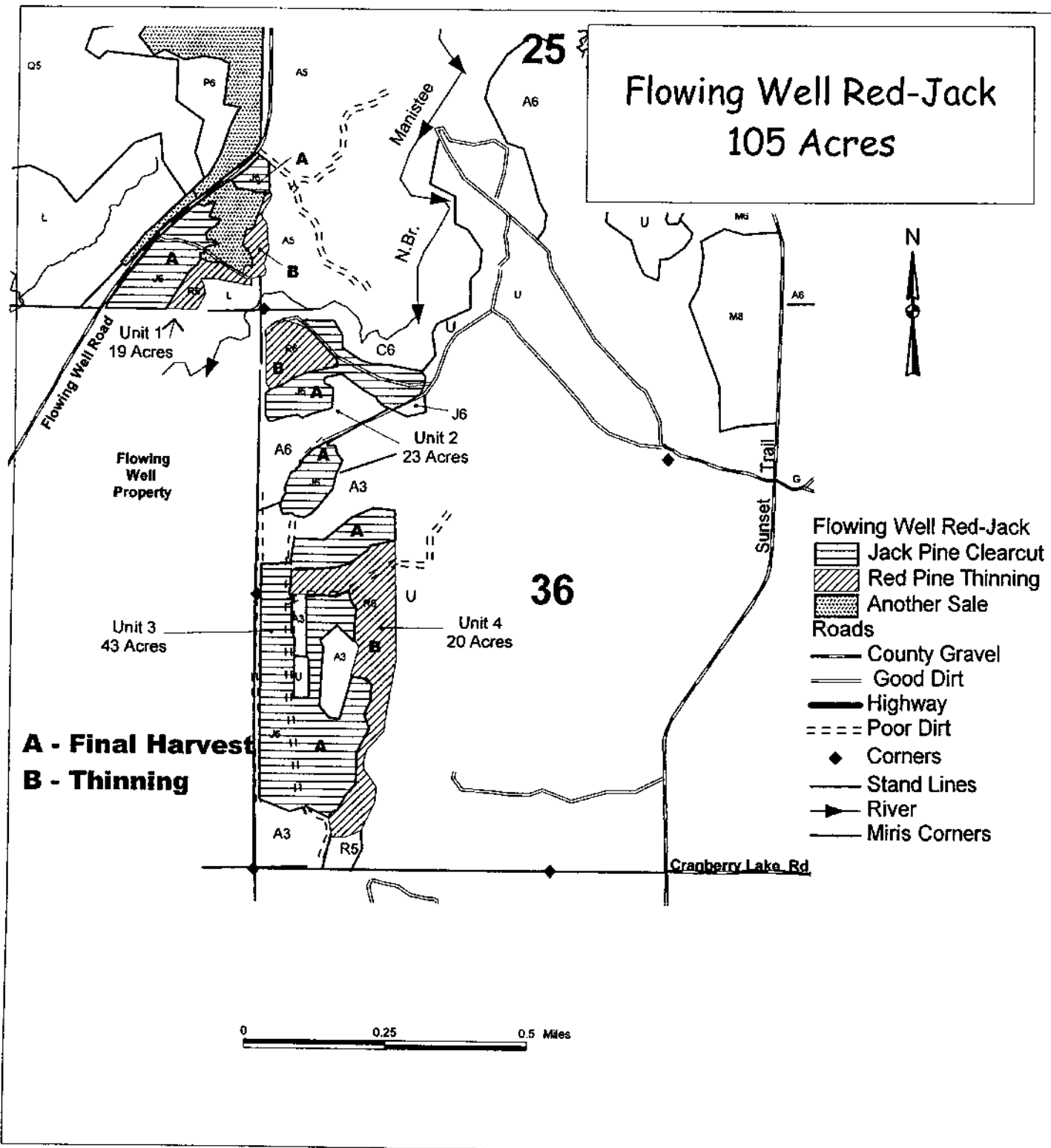

## Sale Specific Conditions & Requirements

Sale Name: Flowing Well Red-jack Sale Number: 61-078-08-01

### 1 - Sale Area

#### 1.2 - Boundaries

##### 1.2.1 - Painted boundaries (6/05)

The sale boundary is marked and identified by red paint. NOTE: Flowing Well Property will be State Land by 10/31/08.

### 2 - Timber Specifications

#### 2.1 - Included Timber

##### 2.1.1 - Clearcut unit(s) with unmerchantable trees (2/04)

Within Payment Unit(s) 1 and 2, marked "A" on the map, and Unit 3, cut all trees that are two (2) inches or more in diameter measured at a point of four and one-half (4-1/2) feet above ground level regardless of merchantability except black cherry in Unit 3.

##### 2.1.8 - Designated plantation row unit(s) (3/07)

Within Payment Unit(s) 1 and 2, marked "B" on the map, and Unit 4, all trees which meet minimum piece specifications in 2.2 Utilization, within designated plantation rows are designated for cutting. Plantation rows designated for cutting begin with the third row in from the outside of the plantation, then continue every third row. Because of the variability of row direction, it shall be the responsibility of the producer to maintain the third row sequence. Do not cut black cherry in Unit 4.

### 3 - Payments

#### 3.3 - Pre-measured Sales

##### 3.3.4 - Dividing payment units (7/05)

Payment unit(s) 3 may be divided at the request of the purchaser and upon approval of the Unit Manager. Dividing payment units is a contract modification which requires a Timber Sale Contract Supplement.

### 4 - Transportation

#### 4.1 - Construction

##### 4.1.3 - Slash and earthen piles (8/04)

Piles or windrows of earth along roads and landings that have been widened or constructed shall be leveled. Slash from road maintenance or construction, including stumps, shall be dispersed throughout the sale.

**Sale Name: Flowing Well Red-jack Sale Number: 61-078-08-01**

**4.1.6 - Road construction (6/07)**

Construction of new roads or improvements of existing roads shall be done in such a way as to minimize the environmental and visual impacts. Merchantable trees shall be cut and utilized unless otherwise directed. Non-merchantable trees shall be severed and laid flat on the ground. Slash shall be scattered, and not left in windrows and kept a minimum of 10 feet back from the road edge. Stumps shall be set upright, not left on edge, and be moved at least 10 feet away from the road edge. Disturbed soil shall be feathered into the woods and not left in berms or windrows.

**4.1.7 - Road closure (4/07)**

All new roads built into the sale must be blocked to vehicle traffic upon completion of the sale. Overgrown roads that are reopened shall be considered new roads. In general, this will require constructing a four (4') foot high berm constructed of stumps and logs covered with earth. Stumps and brush must be placed along the remainder of the trail. These roads must be rendered impassable to cars and trucks. All stumps from road building and landing construction must be reserved to block any newly constructed roads upon completion of the sale. These stumps must be scattered along the road system to prohibit vehicular movement. Contact the sale administrator for specific details of design and placement.

**5 - Operations**

**5.1 - Notification**

**5.1.1 - Pre-sale conference (2/08)**

A pre-sale conference on site between the Purchaser and sale administrator is required prior to beginning any operations to determine landing and road locations.

**5.2 - Conduct of Operations**

**5.2.1 - Slash**

**5.2.1.11 - Slash for reforestation (5/07)**

To facilitate reforestation, Payment Unit(s) 1 and 2, marked "A" on the map, and Unit 3 shall be left with slash evenly distributed. Bunched tops within the cutting area shall be broken up and scattered. Stumps shall be cut low to the ground. Processing sites shall not be left with a compacted layer of slash; tops from these sites shall be hauled back into the cut area and scattered.

**5.2.15 - Bark beetle restriction (2/04)**

In the event drought creates a high risk of pine bark beetle infestation, pine is not to be cut during the period March 1 through July 1, unless all portions of trees greater than two inches in diameter are removed from the sale area, reduced to chips, or treated to the satisfaction of the Unit Manager or their representative, within fifteen days of being severed from the stump. Pine logs, pulpwood piles and treetop piles for chipping that are decked in the fall or winter within a 1/4 mile of susceptible sites must be removed before March 15. Residual slash must not be placed in piles or rows and must be spread over the site for quick drying. The Department of Natural Resources will exercise this option if the risk of damage warrants.



GRAVEL PIT HARDWOODS (086-08-01)

A timber sale contract for this LUMP SUM SEALED timber sale will be awarded the responsible bidder offering the highest sealed bid price. Bids must be at or above the following appraised price for each species:

<u>SPECIES</u>	<u>ESTIMATED VOLUME*</u>	<u>APPRAISED PRICE</u>
SAWLOGS		
SUG. MAPLE	16.00 MBF	\$ 231.00/MBF
BASSWOOD	47.00 MBF	\$ 32.00/MBF
MIX ASPEN	24.00 MBF	\$ 37.00/MBF
PULPWOOD		
BASSWOOD	239.00 CORDS	\$ 3.90/CORD
MIX ASPEN	105.00 CORDS	\$ 11.85/CORD

In addition, the successful bidder agrees to purchase the following species at the indicated appraised price:

<u>SPECIES</u>	<u>ESTIMATED VOLUME*</u>	<u>APPRAISED PRICE</u>
PULPWOOD		
SUG. MAPLE	51.00 CORDS	\$ 5.95/CORD

\*These estimated volumes are final and not subject to adjustment. Prospective bidders are urged to examine this timber and to make their own estimates of quantity and quality.

BOND AND PAYMENT SCHEDULE:

1. A bond in the amount of \$450.00 to insure faithful performance of the conditions of the contract, will be deposited by the successful bidder within 21 days of the sale award.
2. Cutting in any sale or unit without the required advance payment would be considered a trespass.
3. Total payment may be paid in advance or according to the following schedule:
  - (a) Ten percent (10%) of the sale value must be paid within 21 days of the sale award.
  - (b) The 10% down payment will be credited towards the first unit cut.
  - (c) Payment for each of the following units must be made before cutting begins in that unit:

<u>PAYMENT UNIT NUMBER</u>	<u>PERCENT OF TOTAL SALE VALUE</u>
1	60%
2	40%
4. If no cutting takes place, the 10% down payment will not be refunded.
5. Operations on the contract issued will terminate on June 30, 2011.



Michigan Department of Natural Resources-Forest Management Division  
**TIMBER SALE MAP**

This information provided under authority of Part 525, Act 451 of 1994, as amended.

Sale No.	Year	Sale Type
61-086	08	01

State Forest and Forest Management Unit: <b>Pere Marquette State Forest/Traverse City MU</b>			Mapped and Cruised By: <b>Donna Hagan</b>	Date: <b>September 30, 2008</b>
Township <b>27 N</b>	Range <b>05 W</b>	Section(s) <b>30 - S1/2SW1/4, 31 - S1/2NW, NENW, W1/2NE</b>	Scale: 1:15840	

Cover Type				Density		
A=Aspen	H=Hemlock	P=Lowland Poplar	V=Bog or Marsh	1=Non Stocked	7=Saw Timber Poor	
B=Paper Birch	J=Jack Pine	Q=Mixed Swamp Cnfr	W=White Pine	2=Seedling Sapling Poor	8=Saw Timber Medium	
C=Cedar	L=Lowland Brush	R=Red Pine	X=Non Stocked	3=Seedling Sapling Well	9=Saw Timber Well	
E=Swamp Hdwoods	M=Mpl. Bch, Brch	S=Black Spruce	Z=Water	4=Pole Timber Poor		
F=Spruce Fir	N=Marsh	T=Tamarack		5=Pole Timber Medium		
G=Grass	O=Oak	U=Upland Brush		6=Pole Timber Well		

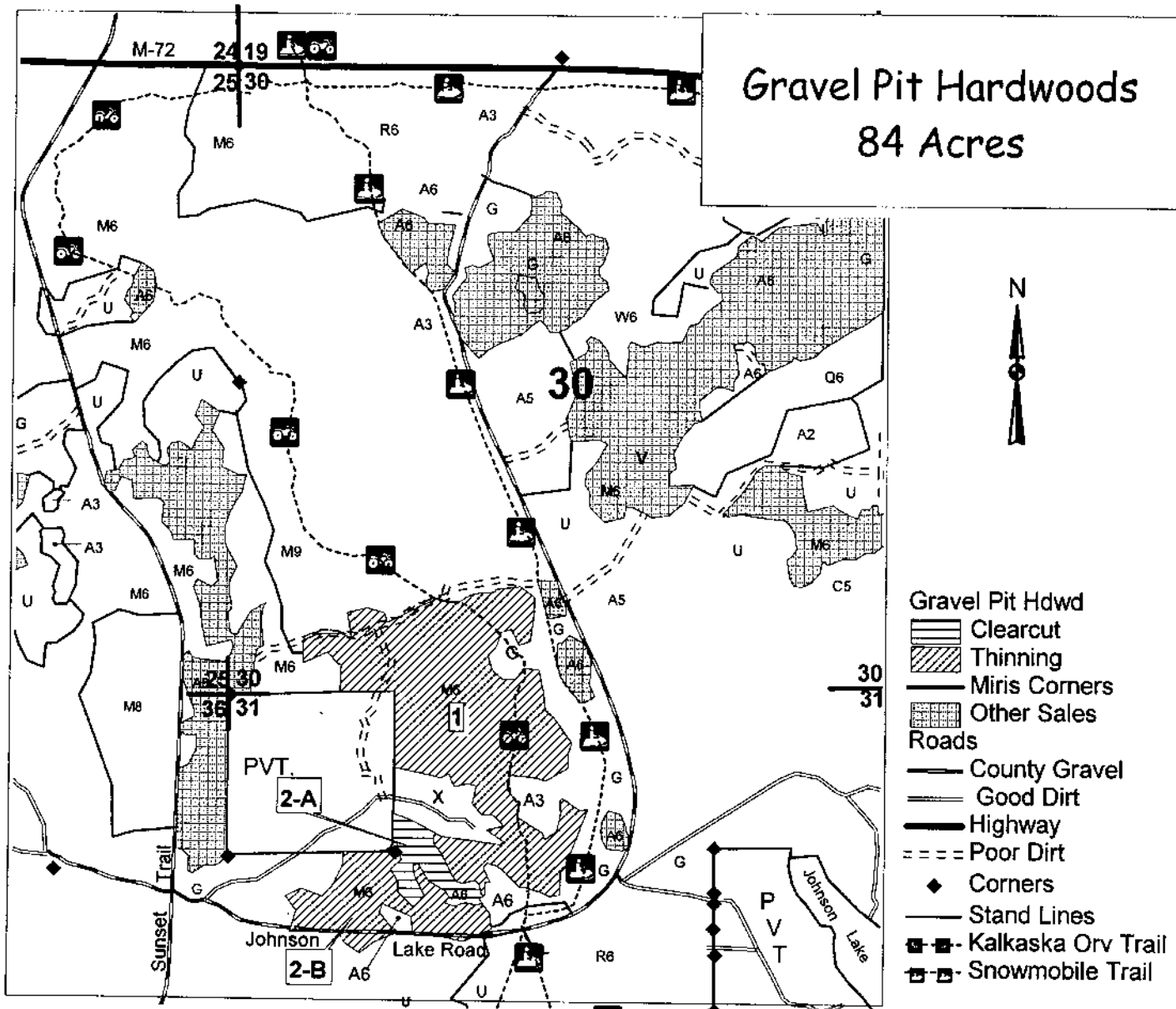

**Gravel Pit Hardwoods**  
**84 Acres**

- 1** = Unit 1 - 62 Acres
- 2-A** = Unit 2 - 6 Acres
- 2-B** = Unit 2 - 16 Acres

## Sale Specific Conditions & Requirements

Sale Name: Gravel Pit Hardwoods Sale Number: 61-086-08-01

### 1 - Sale Area

#### 1.2 - Boundaries

##### 1.2.1 - Painted boundaries (6/05)

The sale boundary is and Payment Unit boundaries are marked and identified by blue, red and yellow paint. Exterior sale boundary lines against private property are marked with blue paint. Exterior sale boundary lines against state are marked with red paint. Interior Payment Unit boundaries are marked with yellow paint. Do not cut painted boundary line trees unless also marked with orange paint. Yellow painted trees designating an interior Payment Unit boundary are NOT to be cut.

### 2 - Timber Specifications

#### 2.1 - Included Timber

##### 2.1.1 - Clearcut unit(s) with unmerchantable trees (2/04)

Within Payment Unit(s) 2-A, cut all trees that are two (2) inches or more in diameter measured at a point of four and one-half (4-1/2) feet above ground level regardless of merchantability except oak.

##### 2.1.3 - Cut tree marked unit(s) (8/04)

Within Payment Unit(s) 1 and 2-B all trees are designated for cutting when marked with orange paint above and below stump height, regardless of merchantability. NOTE: Any aspen to be cut in these units will be marked with orange paint.

### 3 - Payments

#### 3.3 - Pre-measured Sales

##### 3.3.4 - Dividing payment units (7/05)

Payment unit(s) 1 may be divided at the request of the purchaser and upon approval of the Unit Manager. Dividing payment units is a contract modification which requires a Timber Sale Contract Supplement.

### 4 - Transportation

#### 4.1 - Construction

##### 4.1.3 - Slash and earthen piles (8/04)

Piles or windrows of earth along roads and landings that have been widened or constructed shall be leveled. Slash from road maintenance or construction, including stumps, shall be dispersed throughout the sale.

**Sale Name: Gravel Pit Hardwoods    Sale Number: 61-086-08-01**

**4.1.6 - Road construction (6/07)**

Construction of new roads or improvements of existing roads shall be done in such a way as to minimize the environmental and visual impacts. Merchantable trees shall be cut and utilized unless otherwise directed. Non-merchantable trees shall be severed and laid flat on the ground. Slash shall be scattered, and not left in windrows and kept a minimum of 10 feet back from the road edge. Stumps shall be set upright, not left on edge, and be moved at least 10 feet away from the road edge. Disturbed soil shall be feathered into the woods and not left in berms or windrows.

**4.1.7 - Road closure (4/07)**

All new roads built into the sale must be blocked to vehicle traffic upon completion of the sale. Overgrown roads that are reopened shall be considered new roads. In general, this will require constructing a four (4') foot high berm constructed of stumps and logs covered with earth. Stumps and brush must be placed along the remainder of the trail. Berms must also be placed at intervals of not over 50 feet and at all junctions. These roads must be rendered impassable to cars and trucks. All stumps from road building and landing construction must be reserved to block any newly constructed roads upon completion of the sale. These stumps must be scattered along the road system to prohibit vehicular movement.

**5 - Operations**

**5.1 - Notification**

**5.1.1 - Pre-sale conference (2/08)**

A pre-sale conference on site between the Purchaser and sale administrator is required prior to beginning any operations to determine landing and road locations.

**5.2 - Conduct of Operations**

**5.2.1 - Slash**

**5.2.1.7 - Slash must be scattered (2/04)**

Unless otherwise directed, slash and logging debris shall be uniformly scattered over the sale area and not left in piles or windrows. Slash shall not be allowed to accumulate at the landings. All slash work shall be done concurrently with harvesting.

**5.2.12 - Bark slippage restriction (3/07)**

Within Payment Unit(s) 1 and 2-B, unless changed by written agreement, cutting and skidding are not permitted during the period of April 15 to July 15. This restriction is because of bark slippage.

**5.2.39 - ORV trail protection (10/08)**

The ORV trail is shown on the Timber Sale Map. Do not cut trees or damage posts with orange ORV markers. Maintain a 20 foot wide slash, debris, and rut free zone daily using the ORV trail as the centerline. Do not run equipment down the ORV trail. Skidding across the trail may only occur in locations approved by the sale administrator.

**Sale Name: Gravel Pit Hardwoods    Sale Number: 61-086-08-01**

**5.2.41 - Snowmobile trail protection (4/07)**

The snowmobile trail is shown on the Timber Sale Map. If the trail is used, it must be maintained throughout the sale and restored to a condition equal to or better than before the sale. Do not cut or damage posts with orange trail markers or traffic control signs. If the trail is used for hauling, it must be graded to the satisfaction of the Unit Manager or their representative prior to December 1st. The snowmobile trail may not be used for any timber sale operations from December 1 to March 31.

**6 - Safety and Fire Prevention**

**6.2 - Signing**

**6.2.3 - Recreational trail posting (9/08)**

The purchaser is responsible for posting and maintaining caution signs on the ORV and snowmobile trail prior to beginning operations. The trail must be posted at appropriate distances from the sale area to warn of logging activity and truck traffic at both ends of the trail. The purchaser must maintain the signs during the trail use seasons. The Purchaser will provide these signs for use on State-owned land.



SPRING CREEK CLEARCUTS (027-08-01)  
T25N, R08W, SEC. 27, SENE SE.  
T25N, R08W, SEC. 34, E1/2NW N1/2NE.  
T26N, R08W, SEC. 26, NWSW.  
KALKASKA COUNTY

In response to the notice of sale to be held 3:00 p.m. on May 04, 2009, I am hereby submitting my sealed bid (firm offer) for the following forest products to be cut. Bids for individual species and total bid value must be at or above the appraised price. All non-responsive bid forms may be rejected.

<u>SPECIES</u>	<u>APPRAISED PRICE</u>	<u>BID PRICE</u>	<u>ESTIMATED VOLUME* = VALUE</u>
<u>PULPWOOD</u>			
MIX ASPEN	\$ 15.80/CORD	\$ _____ X	404.00 CORDS = \$ _____
MIX HARDWD	\$ 8.20/CORD	\$ _____ X	115.00 CORDS = \$ _____
			SUBTOTAL 1 \$ _____

In addition, the successful bidder agrees to purchase the following species at the appraised price:

<u>SPECIES</u>	<u>APPRAISED PRICE</u>	<u>ESTIMATED VOLUME*</u>	<u>VALUE</u>
<u>SAWLOGS</u>			
SUG. MAPLE	\$ 277.00/MBF	.50 MBF	= \$ 138.50
RED MAPLE	\$ 80.00/MBF	11.00 MBF	= \$ 880.00
WHITE PINE	\$ 33.00/MBF	2.40 MBF	= \$ 79.20
<u>PULPWOOD</u>			
BALSAM FIR	\$ 8.40/CORD	91.00 CORDS	= \$ 764.40
WHITE PINE	\$ 4.05/CORD	35.00 CORDS	= \$ 141.75
			SUBTOTAL 2 \$ <u>2,003.85</u>

SUBTOTAL 1 + SUBTOTAL 2 = TOTAL BID VALUE \$ \_\_\_\_\_

\*These volumes are statistically estimated within plus (+) or minus (-) 14.45%. These estimated volumes are final and not subject to adjustment. Prospective bidders are urged to examine this timber and to make their own estimates of quantity and quality.

I understand that any or all bids may be rejected, and that the individual unit bid price will be the basis to determine total bid value. All bids must be signed and all bid items must be bid or the bid form may be rejected. I also understand that consideration and awarding a contract will be based upon my past performance and ability to complete the contract based upon equipment and manpower subject to my control.

\_\_\_\_\_  
(bidder's printed name)

\_\_\_\_\_  
(bidder's signature)

Address/Telephone \_\_\_\_\_

THE WINNING BIDDER MUST COMPLETE THE FORM ON THE REVERSE SIDE  
WITHIN 21 DAYS OF SALE AWARD



FOR DEPARTMENT USE ONLY	
Sale or Permit No	
Year:	Type:
Forest Area:	

**TIMBER SALE  
VERIFICATION OF WORKER'S DISABILITY  
COMPENSATION ACT COMPLIANCE**

*As required by Act 317, P.A. 1969 (Worker's Compensation) and Part 525 of Act 451 of 1994, as amended.*

**VERIFICATION OF WORKER'S DISABILITY COMPENSATION ACT COMPLIANCE**

- This verification must be completed and submitted within 21 days of contract award and prior to the issuance of the timber sale contract.
- In addition, if boxes 2B or 2C are checked, then Notice of Exclusion or Certificate of Insurance must be submitted within 21 days of the contract award and prior to the issuance of the timber sale contract.
- All information must be typed or printed except for written signatures.

Please Check Appropriate Categories:

1. My business is organized as (you must check one of the boxes below):
  - A.  Sole Proprietorship (individual)
  - B.  Partnership
  - C.  Corporation
2. You must check one of the boxes below:
  - A.  I certify that my business is a sole proprietorship and it has no employees but the sole proprietor. I am not subject to the Worker's Compensation Laws.
  - B.  I certify that my business has satisfied its obligation to the Worker's Compensation Act through the use of an approved Notice of Exclusion (BWC-337, Rev. 5/96). I will provide a copy of the Notice of Exclusion within 21 days of the contract award. (For questions or a copy of the BWC-337, please call the Worker's Compensation Bureau at 517-322-1195).
  - C.  I certify that my business has a Worker's Compensation Policy. I will provide an original Certificate of Insurance within 21 days of the contract award.
3. If you have checked item 2(A) or 2(B), you must indicate the number of **both** full and part time employees other than yourself including family members and active partners (if none, you must enter "0").

\_\_\_\_\_ Full Time Employees

\_\_\_\_\_ Part Time Employees

Name of Business		Federal ID (or) Social Security No.	
Address		Telephone No. (       )	
City	State	Zip + 4	

I hereby certify that the above information is true and correct. I agree to notify the DNR of any changes that occur in factors affecting my coverage during any of my present and future operations.

\_\_\_\_\_  
Signature of Owner or Authorized Representative

\_\_\_\_\_  
Title

\_\_\_\_\_  
Date



RIVER SIDE ASPEN (028-08-01)  
T25N, R08W, SEC. 33, S1/2.  
KALKASKA COUNTY

In response to the notice of sale to be held 3:00 p.m. on May 04, 2009, I am hereby submitting my sealed bid (firm offer) for the following forest products to be cut. Bids for individual species and total bid value must be at or above the appraised price. All non-responsive bid forms may be rejected.

<u>SPECIES</u>	<u>APPRAISED PRICE</u>	<u>BID PRICE</u>	<u>ESTIMATED VOLUME* = VALUE</u>
PULPWOOD			
MIX ASPEN	\$ 17.75/CORD	\$ _____ X	723.00 CORDS = \$ _____
			SUBTOTAL 1 \$ _____

In addition, the successful bidder agrees to purchase the following species at the appraised price:

<u>SPECIES</u>	<u>APPRAISED PRICE</u>	<u>ESTIMATED VOLUME*</u>	<u>VALUE</u>
SAWLOGS			
RED MAPLE	\$ 89.00/MBF	10.60 MBF	= \$ 943.40
WHITE PINE	\$ 32.00/MBF	1.40 MBF	= \$ 44.80
MIX ASPEN	\$ 54.00/MBF	12.50 MBF	= \$ 675.00
PULPWOOD			
RED MAPLE	\$ 12.95/CORD	97.00 CORDS	= \$ 1,256.15
P. BIRCH	\$ 8.40/CORD	5.00 CORDS	= \$ 42.00
BALSAM FIR	\$ 6.50/CORD	9.00 CORDS	= \$ 58.50
B. SPRUCE	\$ 6.50/CORD	4.00 CORDS	= \$ 26.00
WHITE PINE	\$ 3.50/CORD	6.00 CORDS	= \$ 21.00
			SUBTOTAL 2 \$ <u>3,066.85</u>

SUBTOTAL 1 + SUBTOTAL 2 = TOTAL BID VALUE \$ \_\_\_\_\_

\*These volumes are statistically estimated within plus (+) or minus (-) 11.20%. These estimated volumes are final and not subject to adjustment. Prospective bidders are urged to examine this timber and to make their own estimates of quantity and quality.

I understand that any or all bids may be rejected, and that the individual unit bid price will be the basis to determine total bid value. All bids must be signed and all bid items must be bid or the bid form may be rejected. I also understand that consideration and awarding a contract will be based upon my past performance and ability to complete the contract based upon equipment and manpower subject to my control.

\_\_\_\_\_  
(bidder's printed name)

\_\_\_\_\_  
(bidder's signature)

Address/Telephone \_\_\_\_\_

THE WINNING BIDDER MUST COMPLETE THE FORM ON THE REVERSE SIDE  
WITHIN 21 DAYS OF SALE AWARD



**FOR DEPARTMENT USE ONLY**

**TIMBER SALE  
VERIFICATION OF WORKER'S DISABILITY  
COMPENSATION ACT COMPLIANCE**

*As required by Act 317, P.A. 1969 (Worker's Compensation) and Part 525  
of Act 451 of 1994, as amended.*

Sale or Permit No

Year:

Type:

Forest Area:

**VERIFICATION OF WORKER'S DISABILITY COMPENSATION ACT COMPLIANCE**

- This verification must be completed and submitted within 21 days of contract award and prior to the issuance of the timber sale contract.
- In addition, if boxes 2B or 2C are checked, then Notice of Exclusion or Certificate of Insurance must be submitted within 21 days of the contract award and prior to the issuance of the timber sale contract.
- All information must be typed or printed except for written signatures.

Please Check Appropriate Categories:

1. My business is organized as (you must check one of the boxes below):
  - A.  Sole Proprietorship (individual)
  - B.  Partnership
  - C.  Corporation
2. You must check one of the boxes below:
  - A.  I certify that my business is a sole proprietorship and it has no employees but the sole proprietor. I am not subject to the Worker's Compensation Laws.
  - B.  I certify that my business has satisfied its obligation to the Worker's Compensation Act through the use of an approved Notice of Exclusion (BWC-337, Rev. 5/96). I will provide a copy of the Notice of Exclusion within 21 days of the contract award. (For questions or a copy of the BWC-337, please call the Worker's Compensation Bureau at 517-322-1195).
  - C.  I certify that my business has a Worker's Compensation Policy. I will provide an original Certificate of Insurance within 21 days of the contract award.
3. If you have checked item 2(A) or 2(B), you must indicate the number of both full and part time employees other than yourself including family members and active partners (if none, you must enter "0").

\_\_\_\_\_ Full Time Employees

\_\_\_\_\_ Part Time Employees

Name of Business		Federal ID (or) Social Security No.	
Address		Telephone No. (      )	
City	State	Zip + 4	

I hereby certify that the above information is true and correct. I agree to notify the DNR of any changes that occur in factors affecting my coverage during any of my present and future operations.

\_\_\_\_\_  
Signature of Owner or Authorized Representative

\_\_\_\_\_  
Title

\_\_\_\_\_  
Date

CRANBERRY LAKE ASPEN (051-08-01)  
T27N, R05W, SEC. 31, NWSE.  
T27N, R05W, SEC. 31, SWNW, SW1/4, S1/2SE.  
KALKASKA COUNTY

In response to the notice of sale to be held 3:00 p.m. on May 04, 2009, I am hereby submitting my sealed bid (firm offer) for the following forest products to be cut. Bids for individual species and total bid value must be at or above the appraised price. All non-responsive bid forms may be rejected.

<u>SPECIES</u>	<u>APPRAISED PRICE</u>	<u>BID PRICE</u>	<u>ESTIMATED VOLUME* = VALUE</u>
<u>SAWLOGS</u>			
MIX ASPEN	\$ 47.00/MBF	\$ _____ X	22.00 MBF = \$ _____
MIX HARDWD	\$ 75.00/MBF	\$ _____ X	28.00 MBF = \$ _____
<u>PULPWOOD</u>			
MIX ASPEN	\$ 14.50/CORD	\$ _____ X	297.00 CORDS = \$ _____
MIX HARDWD	\$ 6.75/CORD	\$ _____ X	189.00 CORDS = \$ _____
SUBTOTAL 1			\$ _____

In addition, the successful bidder agrees to purchase the following species at the appraised price:

<u>SPECIES</u>	<u>APPRAISED PRICE</u>	<u>ESTIMATED VOLUME*</u>	<u>VALUE</u>
<u>PULPWOOD</u>			
BASSWOOD	\$ 5.20/CORD	85.00 CORDS	= \$ 442.00
WHITE PINE	\$ 2.80/CORD	32.00 CORDS	= \$ 89.60
SUBTOTAL 2			\$ 531.60
SUBTOTAL 1 + SUBTOTAL 2 = TOTAL BID VALUE \$ _____			

\*These estimated volumes are final and not subject to adjustment. Prospective bidders are urged to examine this timber and to make their own estimates of quantity and quality.

I understand that any or all bids may be rejected, and that the individual unit bid price will be the basis to determine total bid value. All bids must be signed and all bid items must be bid or the bid form may be rejected. I also understand that consideration and awarding a contract will be based upon my past performance and ability to complete the contract based upon equipment and manpower subject to my control.

\_\_\_\_\_  
(bidder's printed name)

\_\_\_\_\_  
(bidder's signature)

Address/Telephone \_\_\_\_\_

THE WINNING BIDDER MUST COMPLETE THE FORM ON THE REVERSE SIDE  
WITHIN 21 DAYS OF SALE AWARD



**FOR DEPARTMENT USE ONLY**

**TIMBER SALE  
VERIFICATION OF WORKER'S DISABILITY  
COMPENSATION ACT COMPLIANCE**

*As required by Act 317, P.A. 1969 (Worker's Compensation) and Part 525  
of Act 451 of 1994, as amended.*

Sale or Permit No

Year:

Type:

Forest Area:

**VERIFICATION OF WORKER'S DISABILITY COMPENSATION ACT COMPLIANCE**

- This verification must be completed and submitted within 21 days of contract award and prior to the issuance of the timber sale contract.
- In addition, if boxes 2B or 2C are checked, then Notice of Exclusion or Certificate of Insurance must be submitted within 21 days of the contract award and prior to the issuance of the timber sale contract.
- All Information must be typed or printed except for written signatures.

Please Check Appropriate Categories:

1. My business is organized as (you must check one of the boxes below):

- A.  Sole Proprietorship (individual)
- B.  Partnership
- C.  Corporation

2. You must check one of the boxes below:

- A.  I certify that my business is a sole proprietorship and it has no employees but the sole proprietor. I am not subject to the Worker's Compensation Laws.
- B.  I certify that my business has satisfied its obligation to the Worker's Compensation Act through the use of an approved Notice of Exclusion (BWC-337, Rev. 5/96). I will provide a copy of the Notice of Exclusion within 21 days of the contract award. (For questions or a copy of the BWC-337, please call the Worker's Compensation Bureau at 517-322-1195).
- C.  I certify that my business has a Worker's Compensation Policy. I will provide an original Certificate of Insurance within 21 days of the contract award.

3. If you have checked item 2(A) or 2(B), you must indicate the number of both full and part time employees other than yourself including family members and active partners (if none, you must enter "0").

\_\_\_\_\_ Full Time Employees

\_\_\_\_\_ Part Time Employees

Name of Business		Federal ID (or) Social Security No.	
Address		Telephone No. (      )	
City	State	Zip + 4	

I hereby certify that the above information is true and correct. I agree to notify the DNR of any changes that occur in factors affecting my coverage during any of my present and future operations.

\_\_\_\_\_  
Signature of Owner or Authorized Representative

\_\_\_\_\_  
Title

\_\_\_\_\_  
Date

FLOWING WELL RED-JACK (078-08-01)  
T27N, R06W, SEC. 26, S1/2SE.  
T27N, R06W, SEC. 36, N1/2NW, SWNW, W1/2SW.  
KALKASKA COUNTY

In response to the notice of sale to be held 3:00 p.m. on May 04, 2009, I am hereby submitting my sealed bid (firm offer) for the following forest products to be cut. Bids for individual species and total bid value must be at or above the appraised price. All non-responsive bid forms may be rejected.

<u>SPECIES</u>	<u>APPRAISED PRICE</u>	<u>BID PRICE</u>	<u>ESTIMATED VOLUME* = VALUE</u>
SAWLOGS			
RED PINE	\$ 108.00/MBF	\$ _____ X	139.00 MBF = \$ _____
PULPWOOD			
RED PINE	\$ 34.70/CORD	\$ _____ X	697.00 CORDS = \$ _____
JACK PINE	\$ 6.55/CORD	\$ _____ X	745.00 CORDS = \$ _____
SUBTOTAL 1			\$ _____

In addition, the successful bidder agrees to purchase the following species at the appraised price:

<u>SPECIES</u>	<u>APPRAISED PRICE</u>	<u>ESTIMATED VOLUME*</u>	<u>VALUE</u>
PULPWOOD			
WHITE PINE	\$ 2.50/CORD	281.00 CORDS	= \$ 702.50
MIX ASPEN	\$ 12.50/CORD	106.00 CORDS	= \$ 1,325.00
MIX HARDWD	\$ 5.60/CORD	59.00 CORDS	= \$ 330.40
SUBTOTAL 2			\$ <u>2,357.90</u>

SUBTOTAL 1 + SUBTOTAL 2 = TOTAL BID VALUE \$ \_\_\_\_\_

\*These volumes are statistically estimated within plus (+) or minus (-) 14.38%. These estimated volumes are final and not subject to adjustment. Prospective bidders are urged to examine this timber and to make their own estimates of quantity and quality.

I understand that any or all bids may be rejected, and that the individual unit bid price will be the basis to determine total bid value. All bids must be signed and all bid items must be bid or the bid form may be rejected. I also understand that consideration and awarding a contract will be based upon my past performance and ability to complete the contract based upon equipment and manpower subject to my control.

\_\_\_\_\_  
(bidder's printed name)

\_\_\_\_\_  
(bidder's signature)

Address/Telephone \_\_\_\_\_

THE WINNING BIDDER MUST COMPLETE THE FORM ON THE REVERSE SIDE  
WITHIN 21 DAYS OF SALE AWARD



**FOR DEPARTMENT USE ONLY**

**TIMBER SALE  
VERIFICATION OF WORKER'S DISABILITY  
COMPENSATION ACT COMPLIANCE**

*As required by Act 317, P.A. 1969 (Worker's Compensation) and Part 525  
of Act 451 of 1994, as amended.*

Sale or Permit No

Year:

Type:

Forest Area:

**VERIFICATION OF WORKER'S DISABILITY COMPENSATION ACT COMPLIANCE**

- This verification must be completed and submitted within 21 days of contract award and prior to the issuance of the timber sale contract.
- In addition, if boxes 2B or 2C are checked, then Notice of Exclusion or Certificate of Insurance must be submitted within 21 days of the contract award and prior to the issuance of the timber sale contract.
- All information must be typed or printed except for written signatures.

Please Check Appropriate Categories:

1. My business is organized as (you must check one of the boxes below):

- A.  Sole Proprietorship (individual)
- B.  Partnership
- C.  Corporation

2. You must check one of the boxes below:

- A.  I certify that my business is a sole proprietorship and it has no employees but the sole proprietor. I am not subject to the Worker's Compensation Laws.
- B.  I certify that my business has satisfied its obligation to the Worker's Compensation Act through the use of an approved Notice of Exclusion (BWC-337, Rev. 5/96). I will provide a copy of the Notice of Exclusion within 21 days of the contract award. (For questions or a copy of the BWC-337, please call the Worker's Compensation Bureau at 517-322-1195).
- C.  I certify that my business has a Worker's Compensation Policy. I will provide an original Certificate of Insurance within 21 days of the contract award.

3. If you have checked item 2(A) or 2(B), you must indicate the number of both full and part time employees other than yourself including family members and active partners (if none, you must enter "0").

\_\_\_\_\_ Full Time Employees

\_\_\_\_\_ Part Time Employees

Name of Business

Federal ID (or) Social Security No.

Address

Telephone No.  
(       )

City

State

Zip + 4

I hereby certify that the above information is true and correct. I agree to notify the DNR of any changes that occur in factors affecting my coverage during any of my present and future operations.

\_\_\_\_\_  
Signature of Owner or Authorized Representative

\_\_\_\_\_  
Title

\_\_\_\_\_  
Date

GRAVEL PIT HARDWOODS (086-08-01)  
 T27N, R05W, SEC. 30, S1/2SW1/4.  
 T27N, R05W, SEC. 31, S1/2NW1/4, NENW, W1/2NE1/4.  
 KALKASKA COUNTY

In response to the notice of sale to be held 3:00 p.m. on May 04, 2009, I am hereby submitting my sealed bid (firm offer) for the following forest products to be cut. Bids for individual species and total bid value must be at or above the appraised price. All non-responsive bid forms may be rejected.

<u>SPECIES</u>	<u>APPRAISED PRICE</u>	<u>BID PRICE</u>	<u>ESTIMATED VOLUME*</u>	<u>= VALUE</u>
<b>SAWLOGS</b>				
SUG. MAPLE	\$ 231.00/MBF	\$ _____ X	16.00 MBF	= \$ _____
BASSWOOD	\$ 32.00/MBF	\$ _____ X	47.00 MBF	= \$ _____
MIX ASPEN	\$ 37.00/MBF	\$ _____ X	24.00 MBF	= \$ _____
<b>PULPWOOD</b>				
BASSWOOD	\$ 3.90/CORD	\$ _____ X	239.00 CORDS	= \$ _____
MIX ASPEN	\$ 11.85/CORD	\$ _____ X	105.00 CORDS	= \$ _____
			SUBTOTAL 1	\$ _____

In addition, the successful bidder agrees to purchase the following species at the appraised price:

<u>SPECIES</u>	<u>APPRAISED PRICE</u>	<u>ESTIMATED VOLUME*</u>	<u>VALUE</u>
<b>PULPWOOD</b>			
SUG. MAPLE	\$ 5.95/CORD	51.00 CORDS	= \$ 303.45
			SUBTOTAL 2 \$ 303.45
SUBTOTAL 1 + SUBTOTAL 2 = TOTAL BID VALUE \$ _____			

\*These estimated volumes are final and not subject to adjustment. Prospective bidders are urged to examine this timber and to make their own estimates of quantity and quality.

I understand that any or all bids may be rejected, and that the individual unit bid price will be the basis to determine total bid value. All bids must be signed and all bid items must be bid or the bid form may be rejected. I also understand that consideration and awarding a contract will be based upon my past performance and ability to complete the contract based upon equipment and manpower subject to my control.

\_\_\_\_\_  
 (bidder's printed name)

\_\_\_\_\_  
 (bidder's signature)

Address/Telephone \_\_\_\_\_

THE WINNING BIDDER MUST COMPLETE THE FORM ON THE REVERSE SIDE  
 WITHIN 21 DAYS OF SALE AWARD



**FOR DEPARTMENT USE ONLY**

**TIMBER SALE  
VERIFICATION OF WORKER'S DISABILITY  
COMPENSATION ACT COMPLIANCE**

*As required by Act 317, P.A. 1969 (Worker's Compensation) and Part 525  
of Act 451 of 1994, as amended.*

Sale or Permit No

Year:

Type:

Forest Area:

**VERIFICATION OF WORKER'S DISABILITY COMPENSATION ACT COMPLIANCE**

- This verification must be completed and submitted within 21 days of contract award and prior to the issuance of the timber sale contract.
- In addition, if boxes 2B or 2C are checked, then Notice of Exclusion or Certificate of Insurance must be submitted within 21 days of the contract award and prior to the issuance of the timber sale contract.
- All information must be typed or printed except for written signatures.

Please Check Appropriate Categories:

1. My business is organized as (you must check one of the boxes below):

- A.  Sole Proprietorship (individual)
- B.  Partnership
- C.  Corporation

2. You **must** check one of the boxes below:

- A.  I certify that my business is a sole proprietorship and it has no employees but the sole proprietor. I am not subject to the Worker's Compensation Laws.
- B.  I certify that my business has satisfied its obligation to the Worker's Compensation Act through the use of an approved Notice of Exclusion (BWC-337, Rev. 5/96). I will provide a copy of the Notice of Exclusion within 21 days of the contract award. (For questions or a copy of the BWC-337, please call the Worker's Compensation Bureau at 517-322-1195).
- C.  I certify that my business has a Worker's Compensation Policy. I will provide an original Certificate of Insurance within 21 days of the contract award.

3. If you have checked item 2(A) or 2(B), you **must** indicate the number of **both** full and part time employees other than yourself including family members and active partners (if none, you must enter "0").

\_\_\_\_\_ Full Time Employees

\_\_\_\_\_ Part Time Employees

Name of Business		Federal ID (or) Social Security No.	
Address		Telephone No. (      )	
City	State	Zip + 4	

I hereby certify that the above information is true and correct. I agree to notify the DNR of any changes that occur in factors affecting my coverage during any of my present and future operations.

\_\_\_\_\_  
Signature of Owner or Authorized Representative

\_\_\_\_\_  
Title

\_\_\_\_\_  
Date