



DEPARTMENT OF NATURAL RESOURCES
STATE OF MICHIGAN

TIMBER SALE PROSPECTUS

Notice is hereby given that bids will be received by the Unit Manager,
SAULT STE. MARIE MANAGEMENT UN, for certain timber on the following described lands:

14 MILE ASPEN / T45N, R01W, SEC. 10, SE1/4, SENE.
T45N, R01W, SEC. 11, SW1/4, S1/2NW, W1/2SE.
CHIPPEWA COUNTY (Appr. \$68,548.25)

SPIKE HORN ASPEN / T41N, R07E, SEC. 04, W1/2NW, W1/2SW.
T41N, R07E, SEC. 09, W1/2NW, NWSW.
CHIPPEWA COUNTY (Appr. \$36,886.70)

SMURF HARDWOODS / T42N, R07E, SEC. 32, SW1/4.
T42N, R07E, SEC. 30, S1/2SW, SWSE, NENE.
T42N, R07E, SEC. 29, SWNE, NW1/4.
T42N, R07E, SEC. 31, NW1/4, NWNE.
CHIPPEWA COUNTY (Appr. \$13,170.25)

////////////////////

SALE DATE AND TIME: 10:00 a.m. on October 13, 2008.

SAULT STE MARIE

BID INSTRUCTIONS (Ver. 06/23/2008):

1. Bid Location, Date, and Time: Bids must be received by the Unit Manager, Sault Ste Marie Management Unit, Box 798, 2001 Ashmun, Sault Ste Marie, MI 49783, no later than 10:00 a.m. on October 13, 2008. For further information concerning this sale, contact the Unit Manager at 906-635-5281.
2. Bidder's Qualifications: Purchaser shall obtain workers compensation insurance to cover claims under Michigan's Worker's Disability Compensation Act of 1969 or similar employee benefit act of any other state applicable to an employee. If all or part of a timber sale was prepared by a private contractor, that contractor and that contractor's company are not permitted to bid on the timber sale contract. Bids will not be accepted from individuals or companies appearing on the DNR/FMFM No-Bid List. This list contains the names of purchasers who previously failed to execute a contract within 21-days or who have a history of poor performance.
3. Preparation of Sealed Bids: Bids shall be manually signed in ink; bid prices must be entered for each species and product in the Bid Price column for all material subject to bidding; and all fill-in blanks must be completed. If erasures or other changes appear on the forms, each erasure or change must be initialed by the person signing the bid.
4. Submission of Sealed Bids: Bid forms may be obtained from the Unit Manager. All bids must be submitted on the bid form and in an envelope clearly identified as described in this section. NOTE: Only one bid form per bid envelope. Sealed bids must be submitted to the Unit office designated in the prospectus and must be submitted at or prior to the time established in the prospectus. The envelope should show on the outside (a) that it is a "Bid for Timber," and (b) the sale name or number, and (c) the date and time of bid opening as shown in the prospectus. Bids received after the time specified in the sale prospectus are late bids and will be rejected.
5. Public Opening of Sealed Bids: If conditions permit, the sealed bids will be publicly opened and posted at the time and place set in the prospectus.
6. Award of Contract: Award of the contract will be made to the Bidder whose bid, conforming to the prospectus, is most advantageous to the State of Michigan on the basis of total value at rates bid for the estimated quantities. The State reserves the right to reject any bid or waive any minor irregularity in bids received. A written award mailed (or otherwise furnished) to the successful Bidder shall be deemed to result in a binding contract without further action by either party.
7. Down Payment: The Bidder to whom award is made must make a down payment within 21 days of the sale award. The amount of the down payment will be calculated as shown in the Bond and Payment Schedule of this prospectus. Only cash may be used to meet this requirement.
8. Performance Security: As guarantee of faithful performance, a cash bond, certificate of deposit, surety bond or irrevocable letter of credit (LOC) is required within 21 days of the sale award. The amount of the performance security is shown in the Bond and Payment Schedule of this prospectus. If an LOC or surety is used, the coverage must extend for at least 6 months beyond the contract expiration.
9. Timber Sale Contract: Additional conditions and requirements common to all timber sales are listed on the timber sale contract (R4031) and are available on line at www.michigan.gov/dnr. Contact the Unit Manager for additional information or a sample contract. Within 21 days of the date of the award letter, the bidder must sign the contract and provide the required down payment, performance security, and verification of worker's disability compensation. The down payment and performance security shall be in accordance with the provisions of the timber sale contract, in the sums stated in this prospectus. If these actions are not taken, then the Bidder, the Bidder's corporation, and the corporation's principals may not be permitted to bid on State timber sales for a period of 1 year. In addition, the Bidder certifies that if awarded this contract, the Bidder will complete the timber sale contract in accordance with its terms and any modifications thereof including requirements to purchase, cut, and remove the included timber by the termination date.

10. Disclaimer of Estimates and Bidder's Warranty of Inspection: Before submitting this bid, the Bidder is advised and cautioned to inspect the sale area, review the requirements of the sale contract, and take other steps as may be reasonably necessary to ascertain the location, estimated volumes, construction estimates, and operating costs of the proposed sale. Failure to do so will not relieve the Bidder from responsibility for completing the contract.

The Bidder warrants that this bid is submitted solely on the basis of the Bidder's examination and inspection of the quality and quantity of the timber offered for sale and the Bidder's opinion of the value thereof and the costs of recovery. No reliance should be placed on the State of Michigan's estimates of timber quality, quantity or costs of recovery. Bidder further acknowledges that the State of Michigan: (i) expressly disclaims any warranty of fitness of timber for any purpose; (ii) offers this timber as is without any warranty of quality (merchantability) or quantity and (iii) expressly disclaims any warranty as to the quantity or quality of timber sold.

11. Certification and Chain-of-Custody: Unless otherwise indicated in the contract under section 7 - Other Conditions of the Sale Specific Conditions & Requirements, the area encompassed by this timber sale is certified to the standards of the Forest Stewardship Council (FSC) - Certificate #SCS-FM/COC-090N and the Sustainable Forestry Initiative (SFI) - Certificate # NSF-SFIS-5Y031-S1. Forest products from this sale may be delivered to the mill as "FSC and / or SFI certified" as long as the contractor hauling the forest products is chain-of-custody (COC) certified or covered under a COC certificate from the destination mill. The purchaser is responsible for maintaining COC after leaving the sale area.

REBECCA A. HUMPHRIES
Director

14 MILE ASPEN (011-07-01)

A timber sale contract for this LUMP SUM SEALED timber sale will be awarded the responsible bidder offering the highest sealed bid price. Bids must be at or above the following appraised price for each species:

<u>SPECIES</u>	<u>ESTIMATED VOLUME*</u>	<u>APPRAISED PRICE</u>
PULPWOOD		
BALSAM FIR	623.00 CORDS	\$ 12.20/CORD
MIX ASPEN	1402.00 CORDS	\$ 17.35/CORD
MIX HARDWD	1048.00 CORDS	\$ 17.00/CORD

In addition, the successful bidder agrees to purchase the following species at the indicated appraised price:

<u>SPECIES</u>	<u>ESTIMATED VOLUME*</u>	<u>APPRAISED PRICE</u>
SAWLOGS		
P. BIRCH	10.50 MBF	\$ 215.00/MBF
W. SPRUCE	23.30 MBF	\$ 46.00/MBF
MIX ASPEN	52.80 MBF	\$ 60.00/MBF
MIX HARDWD	8.80 MBF	\$ 171.00/MBF
PULPWOOD		
P. BIRCH	147.00 CORDS	\$ 12.20/CORD
B. POPLAR	58.00 CORDS	\$ 5.95/CORD
W. SPRUCE	331.00 CORDS	\$ 19.85/CORD
B. SPRUCE	131.00 CORDS	\$ 16.00/CORD

*The volumes are statistically estimated within plus (+) or minus (-) 8.87 percent. These estimated volumes are final and not subject to adjustment. Prospective bidders are urged to examine this timber and to make their own estimates of quantity and quality.

BOND AND PAYMENT SCHEDULE:

1. A bond in the amount of \$3,600.00 to insure faithful performance of the conditions of the contract, will be deposited by the successful bidder within 21 days of the sale award.
2. Cutting in any sale or unit without the required advance payment would be considered a trespass.
3. Total payment may be paid in advance or according to the following schedule:
 - (a) Ten percent (10%) of the sale value must be paid within 21 days of the sale award.
 - (b) The 10% down payment will be credited towards the first unit cut.
 - (c) Payment for each of the following units must be made before cutting begins in that unit:

<u>PAYMENT UNIT NUMBER</u>	<u>PERCENT OF TOTAL SALE VALUE</u>
1	20%
2	06%
3	19%
4	12%
5	19%
6	11%
7	13%

4. If no cutting takes place, the 10% down payment will not be refunded.
5. Operations on the contract issued will terminate on July 31, 2011.

STATE OF MICHIGAN
DEPARTMENT OF NATURAL RESOURCES
TIMBER SALE MAP

SALE NO. 45,011,1107,01 YEAR SALE TYPE

STATE FOREST AND FOREST AREA
LAKE SUPERIOR STATE, SAULT STE. MARIE
T 45N R 1W Section(s) 10, 11 SW 1/4, W 1/2 SE Sub. S 1/2 NW, SE NE, SE 1/4
MAPPED BY J. Caron DATE 9-1-07
Scale: 1 inch = 1/4 mile

COVER TYPE				DENSITY			
A - Aspen	M - Hemlock	F - Lowland Poplar	V - Bog or Marsh	1 - Non Stocked	7 - Saw Timber Poor		
B - Paper Birch	J - Jack Pine	W - White Pine	W - White Pine	2 - Seedling Sapling Poor	8 - Saw Timber Medium		
C - Cedar	L - Lowland Brush	R - Red Pine	X - Non Stocked	3 - Seedling Sapling Well	9 - Saw Timber Well		
E - Swamp Hdwds	M - Mpl. Bch. Birch	S - Black Spruce	W - Water	4 - Pole Timber Poor			
F - Spruce Fir	N - Marsh	T - Tamarack		5 - Pole Timber Medium			
G - Grass	O - Oak	U - Upland Brush		6 - Pole Timber Well			

14 MILE ASPEN
230 ACRES
CHIPPEWA COUNTY

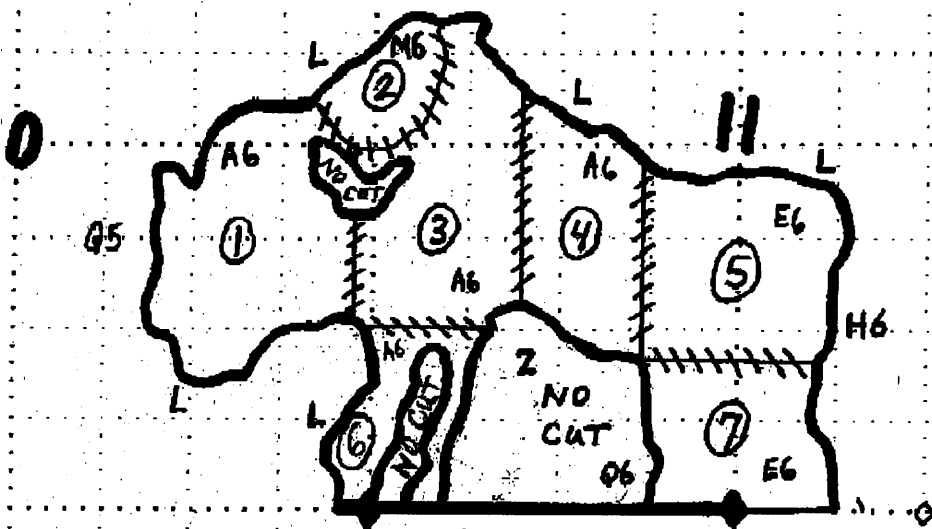

- TWO TRACK
- ~ RED LINE
- /// GREEN LINE
- ◆ SURVEY CORNER
- BLUE LINE
- ① UNIT #

Sale Specific Conditions & Requirements

Sale Name: 14 Mile Aspen Sale Number: 45-011-07-01

1 - Sale Area

1.2 - Boundaries

1.2.1 - Painted boundaries (6/05)

The sale boundary marked and identified by red and blue paint. Exterior sale boundary lines against state are marked with red paint. Exterior sale boundary lines against private are marked with blue paint. Payment Unit boundaries are marked with green paint. Green painted trees designating an interior Payment Unit boundary are only to be cut when all surrounding Payment Units have been paid unless they are a reserved species.

2 - Timber Specifications

2.1 - Included Timber

2.1.1 - Clearcut unit(s) with unmerchantable trees (2/04)

Within Payment Unit(s) 1,3,4,5,6,7, cut all trees that are four (4), inches or more in diameter measured at a point of four and one-half (4-1/2) feet above ground level regardless of merchantability DO NOT CUT cedar, oak, hemlock, pine, yellow birch, basswood, elm, sugar maple. DO NOT CUT aspen marked with orange paint.

2.1.3 - Cut tree marked unit(s) (8/04)

Within Payment Unit(s) 2 all trees are designated for cutting when marked with yellow paint above and below stump height, regardless of merchantability.

2.2 - Utilization

2.2.4 - Skidding length (2/04)

Skidding of unlimbed tops, or lengths over 17 feet is not permissible unless approved by the unit manager. This spec. applies to U2 only.

2.2.7 - Uncut designated trees (2/04)

Liquidated damages of \$5.00 per tree will be assessed for every marked tree not cut.

3 - Payments

3.3 - Pre-measured Sales

3.3.2 - One active unit (2/04)

Each Payment Unit must be completed to the satisfaction of the Unit Manager or their representative before the next unit may be opened. The Purchaser must give a one week notice before finishing a unit to allow for inspection.

Sale Name: 14 Mile Aspen Sale Number: 45-011-07-01

3.3.4 - Dividing payment units (7/05)

Payment unit(s) may be divided at the request of the purchaser and upon approval of the Unit Manager. Dividing payment units is a contract modification which requires a Timber Sale Contract Supplement.

3.4 - Damaged Timber

3.4.1 - Damaged timber (6/05)

General Condition and Requirement 3.4 Damaged Timber, defines liquidated damages for undesignated live merchantable trees which are cut or injured. Damage to residual trees (defined as breaking of the cambium layer, broken tops or bending of trees from their natural position) is not acceptable.

Within the sale area, if more than 25% of the tree seedlings or saplings (1/4" to 4.5" DBH) within a specified portion of the sale area are damaged, liquidated damages will be assessed at \$300.00 per acre for all acreage within that specified portion of the sale area that was damaged.

No damage is acceptable to merchantable trees. Within the sale area, if more than 5% of trees (> 4.5" DBH) within a specified area of the sale are damaged, liquidated damages will be assessed for all trees damaged. Rates will be in accordance with General Condition and Requirement 3.4 Damaged Timber.

4 - Transportation

4.1 - Construction

4.1.4 - Timber removed for construction (2/04)

Trees cut or damaged in the process of a pre-approved road, landing or skid trail construction will be decked in an area separate from wood removed from the timber sale until such time as it is scaled and paid for.

4.1.6 - Road construction (6/07)

Construction of new roads or improvements of existing roads shall be done in such a way as to minimize the environmental and visual impacts. Merchantable trees shall be cut and utilized unless otherwise directed. Non-merchantable trees shall be severed and laid flat on the ground. Slash shall be scattered, and not left in windrows and kept a minimum of 10 feet back from the road edge. Stumps shall be set upright, not left on edge, and be moved at least 10 feet away from the road edge. Disturbed soil shall be feathered into the woods and not left in berms or windrows.

4.1.7 - Road closure (4/07)

All new roads built into the sale must be blocked to vehicle traffic upon completion of the sale. Overgrown roads that are reopened shall be considered new roads. In general, this will require berms, stumps, slash and brush to be placed along the entire length of road. These roads must be rendered impassable to cars and trucks. All stumps from road building and landing construction must be reserved to block any newly constructed roads upon completion of the sale. Contact the sale administrator for specific details of design and placement.

4.2 - Maintenance

Sale Name: 14 Mile Aspen Sale Number: 45-011-07-01

4.2.1 - Hauling restriction (3/07)

Hauling may be restricted on forest roads by the Unit Manager or their representative. The restriction may occur during spring breakup or during wet weather conditions.

4.2.2 - Fill material (4/07)

To maintain roads, fill material may be needed in areas where "holes" exist or may be expected to develop. This fill material should be placed before trucking begins. Contact the sale administrator regarding the availability of onsite sand or gravel from adjacent State-owned lands.

4.2.5 - Two wheel drive condition (2/04)

All existing trail roads on and adjacent to the sale area must be passable by two-wheel drive traffic for the duration of the sale.

5 - Operations

5.1 - Notification

5.1.1 - Pre-sale conference (2/08)

A pre-sale conference on site between the Purchaser and sale administrator is required prior to beginning any operations. The Unit Manager or their representative must be contacted at least 5 days in advance to schedule the conference.

5.1.4 - Post-sale conference (2/04)

A post-sale conference on site between the Purchaser and sale administrator is required 5 days prior to the completion of active logging operations to determine clean-up and repair of landings, road edges, and the fulfillment of other contract specifications.

5.2 - Conduct of Operations

5.2.1 - Slash

5.2.1.1 - Slash within sale area (2/04)

No trees are to be felled outside the sale area and all slash is to be kept at least 10 feet back from the blue and red paint line.

5.2.2 - Snags

5.2.2.1 - Den trees (2/04)

Obvious hollow and/or den trees shall be protected and left standing unless they are a safety hazard.

5.2.4 - Dead and Down Creation

5.2.4.3 - Dead and down creation, dead trees (6/07)

Except as provided for in General Condition and Requirement 5.2.2, no dead trees, standing or down, are to be cut, skidded, or processed.

Sale Name: 14 Mile Aspen Sale Number: 45-011-07-01

5.2.38 - No decking against live trees (2/04)

Cut products may not be decked against unmarked or designated leave trees.

5.4 - Soil Protection

5.4.1 - Rutting restriction, general (5/08)

Operations are to cease immediately if equipment and weather conditions result in rutting of roads which is not passable by a 2-wheel drive vehicle. In addition, operations are to cease immediately if equipment and weather conditions result in rutting on skid trails which is 8 inches or greater in depth and 50 feet in length. The Unit Manager or their representative may restrict hauling and/or skidding if ruts exceed the specified depth. With the Unit Manager or their representative's approval, the Purchaser may return to the area when the weather conditions have changed and/or the risk of rutting has decreased.

5.8 - Protection of Habitat of Endangered Species

5.8.5 - Protection of raptor nests (9/05)

All trees with raptor nests will be protected if found during harvesting operations. Notification will be made to the Unit Manager and Wildlife Biologist so an on-site evaluation and recommendation can be made, if necessary.

SPIKE HORN ASPEN (012-07-01)

A timber sale contract for this LUMP SUM SEALED timber sale will be awarded the responsible bidder offering the highest sealed bid price. Bids must be at or above the following appraised price for each species:

<u>SPECIES</u>	<u>ESTIMATED VOLUME*</u>	<u>APPRAISED PRICE</u>
PULPWOOD		
W. SPRUCE	609.00 CORDS	\$ 16.50/CORD
MIX ASPEN	1237.00 CORDS	\$ 12.00/CORD

In addition, the successful bidder agrees to purchase the following species at the indicated appraised price:

<u>SPECIES</u>	<u>ESTIMATED VOLUME*</u>	<u>APPRAISED PRICE</u>
SAWLOGS		
P. BIRCH	6.70 MBF	\$ 120.00/MBF
W. SPRUCE	61.70 MBF	\$ 45.00/MBF
MIX ASPEN	51.30 MBF	\$ 47.00/MBF
PULPWOOD		
P. BIRCH	503.00 CORDS	\$ 6.20/CORD
B. POPLAR	505.00 CORDS	\$ 4.30/CORD
BALSAM FIR	75.00 CORDS	\$ 9.50/CORD

*The volumes are statistically estimated within plus (+) or minus (-) 8.90 percent. These estimated volumes are final and not subject to adjustment. Prospective bidders are urged to examine this timber and to make their own estimates of quantity and quality.

BOND AND PAYMENT SCHEDULE:

1. A bond in the amount of \$1,900.00 to insure faithful performance of the conditions of the contract, will be deposited by the successful bidder within 21 days of the sale award.
2. Cutting in any sale or unit without the required advance payment would be considered a trespass.
3. Total payment may be paid in advance or according to the following schedule:
 - (a) Ten percent (10%) of the sale value must be paid within 21 days of the sale award.
 - (b) The 10% down payment will be credited towards the first unit cut.
 - (c) Payment for each of the following units must be made before cutting begins in that unit:

<u>PAYMENT UNIT NUMBER</u>	<u>PERCENT OF TOTAL SALE VALUE</u>
1	25%
2	25%
3	25%
4	25%
4. If no cutting takes place, the 10% down payment will not be refunded.
5. Operations on the contract issued will terminate on July 31, 2011.

STATE OF MINNESOTA
DEPARTMENT OF NATURAL RESOURCES
TIMBER SALE MAP

SALE NO. 45 012 07 01
YEAR
SALE TYPE

STATE FOREST AND FOREST AREA LAKE SUPERIOR STATE - SAULT STE MARIE	MAPPED BY J. WISE J. CARON GARMIN GPS	DATE 9-26-07
T 41N R 7E Section(s) 4, 9	4 - W 1/2 NW W 1/2 SW Sub. 9 - W 1/2 SW N 1/2 SW	Scale: 1 inch = 1/4 mile

COVER TYPE

DENSITY

- | | | | | | |
|--|---|---|--|---|---|
| <ul style="list-style-type: none"> A - Aspen B - Paper Birch C - Cedar E - Swamp Hdws F - Spruce Fir G - Grass | <ul style="list-style-type: none"> H - Hemlock J - Jack Pine L - Lowland Brush M - Mpl, Bch, Brch N - Marsh O - Oak | <ul style="list-style-type: none"> P - Lowland Poplar Q - Mx Swamp Cnpr R - Red Pine S - Black Spruce T - Tamarack U - Upland Brush | <ul style="list-style-type: none"> V - Bog or Marsh W - White Pine X - Non Stocked Z - Water | <ul style="list-style-type: none"> 1 - Non Stocked 2 - Seedling Sapling Poor 3 - Seedling Sapling Well 4 - Pole Timber Poor 5 - Pole Timber Medium 6 - Pole Timber Well | <ul style="list-style-type: none"> 7 - Saw Timber Poor 8 - Saw Timber Medium 9 - Saw Timber Well |
|--|---|---|--|---|---|

SPIKE HORN ASPEN
CHIPPEWA COUNTY
204 ACRES

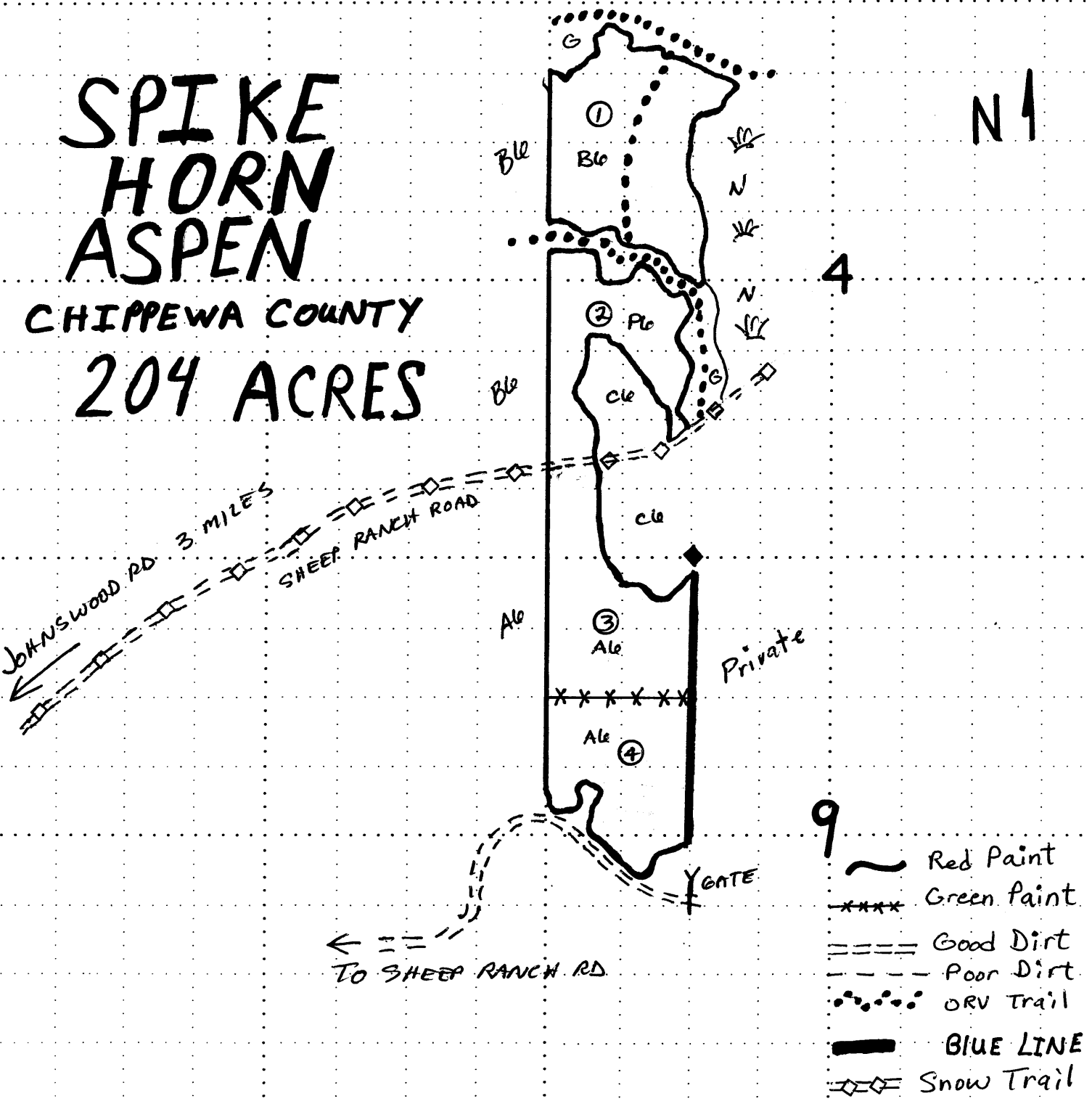

Sale Specific Conditions & Requirements

Sale Name: Spike Horn Aspen Sale Number: 45-012-07-01

1 - Sale Area

1.2 - Boundaries

1.2.1 - Painted boundaries (6/05)

The sale boundary and Payment Unit boundaries are marked and identified by red and blue paint. Exterior sale boundary lines against state are marked with red paint. Exterior sale boundary lines against private are marked with blue paint. Do not cut painted boundary line trees. Unit boundary trees may be cut when all surrounding Payment Units have been paid unless they are reserve trees.

2 - Timber Specifications

2.1 - Included Timber

2.1.1 - Clearcut unit(s) with unmerchantable trees (2/04)

Within Payment Unit(s) 1 - 4, cut all trees that are four inches or more in diameter measured at a point of four and one-half (4-1/2) feet above ground level regardless of merchantability, except: Do not cut any Cedar, Hemlock, Pine, and any mixed hardwood group that has NOT been paid for in the contract.

3 - Payments

3.3 - Pre-measured Sales

3.3.2 - One active unit (2/04)

Each Payment Unit must be completed to the satisfaction of the Unit Manager or their representative before the next unit may be opened. The Purchaser must give a one week notice before finishing a unit to allow for inspection.

3.3.4 - Dividing payment units (7/05)

Payment unit(s) may be divided at the request of the purchaser and upon approval of the Unit Manager. Dividing payment units is a contract modification which requires a Timber Sale Contract Supplement.

3.4 - Damaged Timber

Sale Name: Spike Horn Aspen Sale Number: 45-012-07-01

3.4.1 - Damaged timber (6/05)

General Condition and Requirement 3.4 Damaged Timber, defines liquidated damages for undesignated live merchantable trees which are cut or injured. In addition, extreme care should be taken to avoid damage to tree seedlings and saplings. Damage to residual trees (defined as breaking of the cambium layer, broken tops or bending of trees from their natural position) is not acceptable.

Within the sale area, if more than 25% of the tree seedlings or saplings (1/4" to 4.5" DBH) within a specified portion of the sale area are damaged, liquidated damages will be assessed at \$300.00 per acre for all acreage within that specified portion of the sale area that was damaged.

No damage is acceptable to merchantable trees. Within the sale area, if more than 5% of trees (> 4.5" DBH) within a specified area of the sale are damaged, liquidated damages will be assessed for all trees damaged. Rates will be in accordance with General Condition and Requirement 3.4 Damaged Timber.

4 - Transportation

4.1 - Construction

4.1.4 - Timber removed for construction (2/04)

Trees cut or damaged in the process of a pre-approved road, landing or skid trail construction will be decked in an area separate from wood removed from the timber sale until such time as it is scaled and paid for.

4.1.6 - Road construction (6/07)

Construction of new roads or improvements of existing roads shall be done in such a way as to minimize the environmental and visual impacts. Merchantable trees shall be cut and utilized unless otherwise directed. Non-merchantable trees shall be severed and laid flat on the ground. Slash shall be scattered, and not left in windrows and kept a minimum of 10 feet back from the road edge. Stumps shall be set upright, not left on edge, and be moved at least 10 feet away from the road edge. Disturbed soil shall be feathered into the woods and not left in berms or windrows.

4.1.7 - Road closure (4/07)

All new roads built into the sale must be blocked to vehicle traffic within 30 days of completion of hauling. Overgrown roads that are reopened shall be considered new roads. Some existing roads may also need to be closed, see the timber sale map for locations. In general, this will require berms at the beginning and at all junctions. All stumps from road building and landing construction must be reserved to block any newly constructed roads upon completion of hauling. These stumps, along with slash must be scattered along the road system to prohibit vehicular movement. Contact the sale administrator for specific details of design and placement.

4.2 - Maintenance

4.2.1 - Hauling restriction (3/07)

Hauling may be restricted on forest roads by the Unit Manager or their representative. The restriction may occur during spring breakup or during wet weather conditions.

Sale Name: Spike Horn Aspen Sale Number: 45-012-07-01

4.2.2 - Fill material (4/07)

To maintain roads, fill material may be needed in areas where "holes" exist or may be expected to develop. This fill material should be placed before trucking begins. Contact the sale administrator regarding the availability of onsite sand or gravel from adjacent State-owned lands.

5 - Operations

5.1 - Notification

5.1.1 - Pre-sale conference (6/04)

A pre-sale conference on site between the Purchaser and sale administrator is required prior to beginning any operations. The Unit Manager or their representative must be contacted at least 5 days in advance to schedule the conference.

5.1.4 - Post-sale conference (2/04)

A post-sale conference on site between the Purchaser and sale administrator is required 5 days prior to the completion of active logging operations to determine clean-up and repair of landings, road edges, and the fulfillment of other contract specifications.

5.2 - Conduct of Operations

5.2.1 - Slash

5.2.1.1 - Slash within sale area (2/04)

No trees are to be felled outside the sale area and all slash is to be kept at least 50 feet back from the the Sheep Ranch Road and 10 feet back from the blue and red paint line.

5.2.2 - Snags

5.2.2.1 - Den trees (2/04)

Obvious hollow and/or den trees shall be protected and left standing unless they are a safety hazard.

5.2.3 - Operating Restrictions

5.2.3.1 - Operating restrictions (3/07)

Within Payment Unit(s) 1, unless changed by written agreement, cutting, skidding, and hauling is not permitted from May 31 to June 30. This restriction is because of the proximity to wetlands during the peak breeding time for reptiles and amphibians.

5.2.4 - Dead and Down Creation

5.2.4.3 - Dead and down creation, dead trees (6/07)

Except as provided for in General Condition and Requirement 5.2.2, no dead trees, standing or down, are to be cut, skidded, or processed.

5.2.37 - No decking areas (10/04)

No decking is allowed along the Sheep Ranch Road. Contact the sale administrator for landing placement.

Sale Name: Spike Horn Aspen Sale Number: 45-012-07-01

5.2.38 - No decking against live trees (2/04)

Cut products may not be decked against unmarked or designated leave trees.

5.2.39 - ORV trail protection (9/07)

A ORV trail is identified on the Timber Sale Map. Do not cut trees or damage posts with orange ORV markers. Maintain a 20 foot wide slash, debris, and rut free zone daily using the ORV trail as the centerline. Do not run equipment down the ORV trail.

5.4 - Soil Protection

5.4.1 - Rutting restriction, general (8/07)

Operations are to cease immediately if equipment and weather conditions result in rutting of roads which is not passable by a four wheel drive vehicle. In addition, operations are to cease immediately if equipment and weather conditions result in rutting on skid trails which is 8 inches or greater in depth and 50 feet in length. The Unit Manager or their representative may restrict hauling and/or skidding if ruts exceed the specified depth. With the Unit Manager or their representative's approval, the Purchaser may return to the area when the weather conditions have changed and/or the risk of rutting has decreased.

5.8 - Protection of Habitat of Endangered Species

5.8.5 - Protection of raptor nests (9/05)

All trees with raptor nests will be protected if found during harvesting operations. Notification will be made to the Unit Manager and Wildlife Biologist so an on-site evaluation and recommendation can be made, if necessary.

6 - Safety and Fire Prevention

6.2 - Signing

6.2.3 - Recreational trail posting (7/04)

The purchaser is responsible for posting and maintaining caution signs on the ORV trail prior to beginning operations. The trail must be posted to warn of logging activity and truck traffic at both ends of the trail. The purchaser must maintain the signs at all times while operations are in progress. Contact the snowmobile and ORV club to coordinate placement of signs.

SMURF HARDWOODS (013-07-01)

A timber sale contract for this LUMP SUM SEALED timber sale will be awarded the responsible bidder offering the highest sealed bid price. Bids must be at or above the following appraised price for each species:

<u>SPECIES</u>	<u>ESTIMATED VOLUME*</u>	<u>APPRAISED PRICE</u>
SAWLOGS		
SUG. MAPLE	19.20 MBF	\$ 519.00/MBF
PULPWOOD		
MIX HARDWD	514.00 CORDS	\$ 2.60/CORD

In addition, the successful bidder agrees to purchase the following species at the indicated appraised price:

<u>SPECIES</u>	<u>ESTIMATED VOLUME*</u>	<u>APPRAISED PRICE</u>
SAWLOGS		
WHITE ASH	1.40 MBF	\$ 105.00/MBF
BEECH	.20 MBF	\$ 52.00/MBF
P. BIRCH	4.30 MBF	\$ 105.00/MBF
W. SPRUCE	.30 MBF	\$ 33.00/MBF
N.W. CEDAR	.30 MBF	\$ 60.00/MBF
MIX ASPEN	22.70 MBF	\$ 42.00/MBF
PULPWOOD		
P. BIRCH	3.00 CORDS	\$ 2.85/CORD
N.W. CEDAR	1.00 CORDS	\$ 9.90/CORD
MIX ASPEN	56.00 CORDS	\$ 4.65/CORD

*These estimated volumes are final and not subject to adjustment. Prospective bidders are urged to examine this timber and to make their own estimates of quantity and quality.

BOND AND PAYMENT SCHEDULE:

1. A bond in the amount of \$700.00 to insure faithful performance of the conditions of the contract, will be deposited by the successful bidder within 21 days of the sale award.
2. Cutting in any sale or unit without the required advance payment would be considered a trespass.
3. Total payment may be paid in advance or according to the following schedule:
 - (a) Ten percent (10%) of the sale value must be paid within 21 days of the sale award.
 - (b) The 10% down payment will be credited towards the first unit cut.
 - (c) Payment for each of the following units must be made before cutting begins in that unit:

<u>PAYMENT</u>	<u>UNIT NUMBER</u>	<u>PERCENT OF TOTAL SALE VALUE</u>
	1	05%
	2	15%
	3	09%
	4	25%
	5	23%
	6	23%

4. If no cutting takes place, the 10% down payment will not be refunded.
5. Operations on the contract issued will terminate on July 31, 2011.



TIMBER SALE MAP

This information provided by authority of Part 525 of Act 451, PA 1994, as amended.

Sale Number	Year
45-013-07-01	2007

Forest Management Unit Sault Ste. Marie - Drummond	County Chippewa	Mapped By S. Clark	Date 9-24-2007	Page 1	of 1
Township 41N	Range 7E	Section(s) and Subdivision(s) 29SWNE, NW1/4, 30S1/2SW, SWSE, NENE, 31NW1/4, NWNE, 32SW1/4		Scale: [...4".....] = 1 mile	

Cover Type				Density	
A = Aspen	G = Grass	O = Oak	U = Upland Brush	0 = Non Stocked	5 = Pole Timber Medium
B = Paper Birch	H = Hemlock	P = Lowland Poplar	V = Bog or Marsh	1 = Seedling Sapling Poor	6 = Pole Timber Well
C = Cedar	J = Jack Pine	Q = Mixed Swamp Cnfr	W = White Pine	2 = Seedling Sapling Medium	7 = Saw Timber Poor
D = Tread Bog	L = Lowland Brush	R = Red Pine	X = Non Stocked	3 = Seedling Sapling Well	8 = Saw Timber Medium
E = Swamp Hdwoods	(M) = Mpl, Bch, Brch	S = Black Spruce	Z = Water	4 = Pole Timber Poor	9 = Saw Timber Well
F = Spruce Fir	N = Marsh	T = Tamarack			

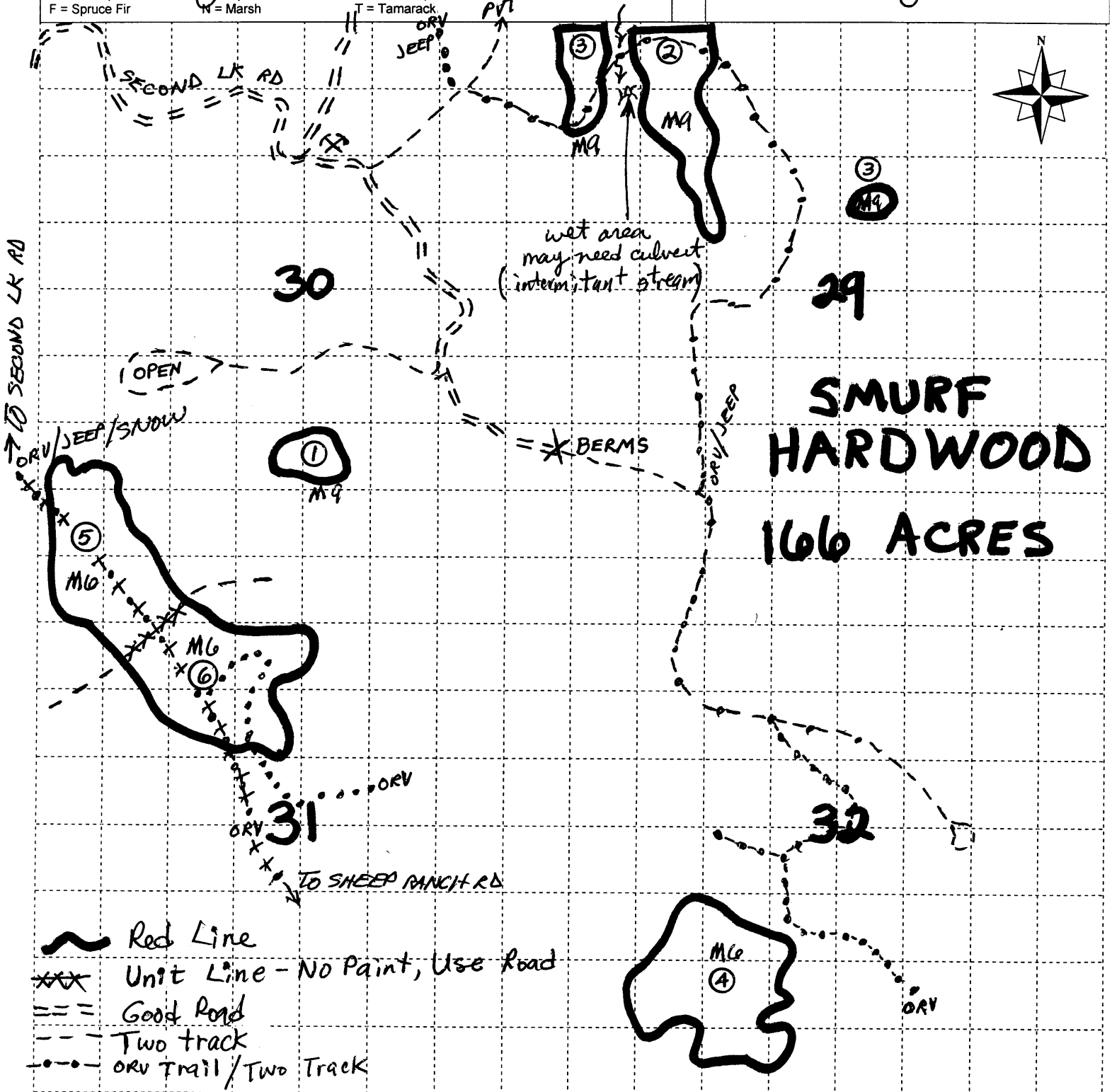

- Red Line
- Unit Line - No Paint, Use Road
- Good Road
- Two track
- ORV trail/Two Track
- Snowmobile Trail

Sale Specific Conditions & Requirements

Sale Name: Smurf Hardwoods Sale Number: 45-013-07-01

1 - Sale Area

1.2 - Boundaries

1.2.1 - Painted boundaries (6/05)

The sale boundary is marked and identified by red paint. Do not cut painted boundary line trees. Payment Units 5 & 6 are separated by the road that bisects the stand east-west. There is no paint line.

2 - Timber Specifications

2.1 - Included Timber

2.1.3 - Cut tree marked unit(s) (8/04)

Within Payment Unit(s) all trees are designated for cutting when marked with blue paint above and below stump height, regardless of merchantability.

2.2 - Utilization

2.2.4 - Skidding length (2/04)

Skidding of unlimbed tops or lengths over 17 feet is not permissible unless approved by the Unit Manager or their representative.

2.2.7 - Uncut designated trees (2/04)

Liquidated damages of \$5.00 per tree will be assessed for every marked tree not cut.

3 - Payments

3.3 - Pre-measured Sales

3.3.2 - One active unit (2/04)

Each Payment Unit must be completed to the satisfaction of the Unit Manager or their representative before the next unit may be opened. The Purchaser must give a five day notice before finishing a unit to allow for inspection.

3.3.3 - Cutting schedule (2/04)

Unless changed by written agreement, only two Payment Units may be operated at any one time. All contractual requirements on a Payment Unit shall be completed and accepted by the Unit Manager or their representative prior to the opening of an additional Payment Unit.

3.4 - Damaged Timber

Sale Name: Smurf Hardwoods Sale Number: 45-013-07-01

3.4.1 - Damaged timber (6/05)

General Condition and Requirement 3.4 Damaged Timber, defines liquidated damages for undesignted live merchantable trees which are cut or injured. In addition, extreme care should be taken to avoid damage to tree seedlings and saplings. Damage to residual trees (defined as breaking of the cambium layer, broken tops or bending of trees from their natural position) is not acceptable.

Within the sale area, if more than 25% of the tree seedlings or saplings (1/4" to 4.5" DBH) within a specified portion of the sale area are damaged, liquidated damages will be assessed at \$300.00 per acre for all acreage within that specified portion of the sale area that was damaged.

No damage is acceptable to merchantable trees. Within the sale area, if more than 5% of trees (> 4.5" DBH) within a specified area of the sale are damaged, liquidated damages will be assessed for all trees damaged. Rates will be in accordance with General Condition and Requirement 3.4 Damaged Timber.

4 - Transportation

4.1 - Construction

4.1.4 - Timber removed for construction (2/04)

Trees cut or damaged in the process of a pre-approved road, landing or skid trail construction will be decked in an area separate from wood removed from the timber sale until such time as it is scaled and paid for.

4.1.6 - Road construction (6/07)

Construction of new roads or improvements of existing roads shall be done in such a way as to minimize the environmental and visual impacts. Merchantable trees shall be cut and utilized unless otherwise directed. Non-merchantable trees shall be severed and laid flat on the ground. Slash shall be scattered, and not left in windrows and kept a minimum of 10 feet back from the road edge. Stumps shall be set upright, not left on edge, and be moved at least 10 feet away from the road edge. Disturbed soil shall be feathered into the woods and not left in berms or windrows.

4.1.7 - Road closure (4/07)

All new roads built into the sale must be blocked to vehicle traffic upon completion of the sale. Overgrown roads that are reopened shall be considered new roads. Some existing roads may also need to be closed, see the timber sale map for locations. In general, this will require constructing a four (4') foot high berm constructed of stumps and logs covered with earth. Stumps and brush must be placed along the remainder of the trail. These roads must be rendered impassable to cars and trucks. Contact the sale administrator for details.

4.1.11 - Permits (5/07)

The Purchaser will secure any necessary stream crossing permits that may be required.

4.2 - Maintenance

4.2.1 - Hauling restriction (3/07)

Hauling may be restricted on forest roads by the Unit Manager or their representative. The restriction may occur during spring breakup or wet weather conditions.

Sale Name: Smurf Hardwoods Sale Number: 45-013-07-01

4.2.2 - Fill material (4/07)

To maintain roads, fill material may be needed in areas where "holes" exist or may be expected to develop. This fill material should be placed before trucking begins. Contact the sale administrator regarding the availability of onsite sand or gravel from adjacent State-owned lands.

5 - Operations

5.1 - Notification

5.1.1 - Pre-sale conference (6/04)

A pre-sale conference on site between the Purchaser and sale administrator is required prior to beginning any operations to determine landing and road locations. The Unit Manager or their representative must be contacted at least 5 days in advance to schedule the conference.

5.1.4 - Post-sale conference (2/04)

A post-sale conference on site between the Purchaser and sale administrator is required 5 days prior to the completion of active logging operations to determine clean-up and repair of landings, road edges, and the fulfillment of other contract specifications.

5.2 - Conduct of Operations

5.2.1 - Slash

5.2.1.1 - Slash within sale area (2/04)

No trees are to be felled outside the sale area and all slash is to be kept at least 10 feet back from the red paint line.

5.2.2 - Snags

5.2.2.1 - Den trees (2/04)

Obvious hollow and/or den trees shall be protected and left standing unless they are a safety hazard.

5.2.4 - Dead and Down Creation

5.2.4.3 - Dead and down creation, dead trees (6/07)

Except as provided for in General Condition and Requirement 5.2.2, no dead trees, standing or down, are to be cut, skidded, or processed.

5.2.12 - Bark slippage restriction (3/07)

Within Payment Unit(s) , unless changed by written agreement, cutting, skidding, and hauling are not permitted during the period of April 15 to July 15. This restriction is because of bark slippage.

5.2.38 - No decking against live trees (2/04)

Cut products may not be decked against unmarked or designated leave trees.

Sale Name: Smurf Hardwoods Sale Number: 45-013-07-01

5.2.39 - ORV trail protection (9/07)

Within the sale there are ORV trails and are shown on the Timber Sale Map. Do not cut trees or damage posts with orange or white ORV markers. Maintain a 10 foot wide slash, debris, and rut free zone daily using the ORV trail as the centerline. Do not run equipment down the ORV trail.

5.2.41 - Snowmobile trail protection (4/07)

Part of the haul road in Units 5 & 6 is a snowmobile trail and is shown on the Timber Sale Map. If the trail is used, it must be maintained throughout the sale and restored to a condition equal to or better than before the sale. Do not cut or damage posts with orange trail markers or traffic control signs. Maintain a 20 foot wide slash, debris, and rut free zone daily using the snowmobile trail as the centerline. If the trail road is to be used for hauling during the snowmobile season, then a snow covered base must be left on the trail. No decking of forest products will be permitted along the snowmobile trail.

5.4 - Soil Protection

5.4.1 - Rutting restriction, general (8/07)

Operations are to cease immediately if equipment and weather conditions result in rutting of roads which is making them impossible to traverse with four wheel drive vehicles. In addition, operations are to cease immediately if equipment and weather conditions result in rutting on skid trails which is 8 inches or greater in depth and 50 feet in length. The Unit Manager or their representative may restrict hauling and/or skidding if ruts exceed the specified depth. With the Unit Manager or their representative's approval, the Purchaser may return to the area when the weather conditions have changed and/or the risk of rutting has decreased.

5.8 - Protection of Habitat of Endangered Species

5.8.5 - Protection of raptor nests (9/05)

All trees with raptor nests will be protected if found during harvesting operations. Notification will be made to the Unit Manager and Wildlife Biologist so an on-site evaluation and recommendation can be made, if necessary.

6 - Safety and Fire Prevention

6.2 - Signing

6.2.3 - Recreational trail posting (7/04)

The purchaser is responsible for posting and maintaining caution signs on the snowmobile and orv trail prior to beginning operations. The trail must be posted to warn of logging activity and truck traffic at both ends of the trail. The purchaser must maintain the signs year round.

14 MILE ASPEN (011-07-01)
T45N, R01W, SEC. 10, SE1/4, SENE.
T45N, R01W, SEC. 11, SW1/4, S1/2NW, W1/2SE.
CHIPPEWA COUNTY

In response to the notice of sale to be held 10:00 a.m. on October 13, 2008, I am hereby submitting my sealed bid (firm offer) for the following forest products to be cut. Bids for individual species and total bid value must be at or above the appraised price. All non-responsive bid forms may be rejected.

<u>SPECIES</u>	<u>APPRAISED PRICE</u>	<u>BID PRICE</u>	<u>ESTIMATED VOLUME* = VALUE</u>
PULPWOOD			
BALSAM FIR	\$ 12.20/CORD	\$ _____ X	623.00 CORDS = \$ _____
MIX ASPEN	\$ 17.35/CORD	\$ _____ X	1402.00 CORDS = \$ _____
MIX HARDWD	\$ 17.00/CORD	\$ _____ X	1048.00 CORDS = \$ _____
			SUBTOTAL 1 \$ _____

In addition, the successful bidder agrees to purchase the following species at the appraised price:

<u>SPECIES</u>	<u>APPRAISED PRICE</u>	<u>ESTIMATED VOLUME*</u>	<u>VALUE</u>
SAWLOGS			
P. BIRCH	\$ 215.00/MBF	10.50 MBF	= \$ 2,257.50
W. SPRUCE	\$ 46.00/MBF	23.30 MBF	= \$ 1,071.80
MIX ASPEN	\$ 60.00/MBF	52.80 MBF	= \$ 3,168.00
MIX HARDWD	\$ 171.00/MBF	8.80 MBF	= \$ 1,504.80
PULPWOOD			
P. BIRCH	\$ 12.20/CORD	147.00 CORDS	= \$ 1,793.40
B. POPLAR	\$ 5.95/CORD	58.00 CORDS	= \$ 345.10
W. SPRUCE	\$ 19.85/CORD	331.00 CORDS	= \$ 6,570.35
B. SPRUCE	\$ 16.00/CORD	131.00 CORDS	= \$ 2,096.00
			SUBTOTAL 2 \$ <u>18,806.95</u>

SUBTOTAL 1 + SUBTOTAL 2 = TOTAL BID VALUE \$ _____

*These volumes are statistically estimated within plus (+) or minus (-) 8.87%. These estimated volumes are final and not subject to adjustment. Prospective bidders are urged to examine this timber and to make their own estimates of quantity and quality.

I understand that any or all bids may be rejected, and that the individual unit bid price will be the basis to determine total bid value. All bids must be signed and all bid items must be bid or the bid form may be rejected. I also understand that consideration and awarding a contract will be based upon my past performance and ability to complete the contract based upon equipment and manpower subject to my control.

(bidder's printed name)

(bidder's signature)

Address/Telephone _____

THE WINNING BIDDER MUST COMPLETE THE FORM ON THE REVERSE SIDE
WITHIN 21 DAYS OF SALE AWARD



FOR DEPARTMENT USE ONLY	
Sale or Permit No	
Year:	Type:
Forest Area:	

**TIMBER SALE
VERIFICATION OF WORKER'S DISABILITY
COMPENSATION ACT COMPLIANCE**

As required by Act 317, P.A. 1969 (Worker's Compensation) and Part 525 of Act 451 of 1994, as amended.

VERIFICATION OF WORKER'S DISABILITY COMPENSATION ACT COMPLIANCE

- This verification must be completed and submitted within 21 days of contract award and prior to the issuance of the timber sale contract.
- In addition, if boxes 2B or 2C are checked, then Notice of Exclusion or Certificate of Insurance must be submitted within 21 days of the contract award and prior to the issuance of the timber sale contract.
- All Information must be typed or printed except for written signatures.

Please Check Appropriate Categories:

1. My business is organized as (you **must** check one of the boxes below):
 - A. Sole Proprietorship (individual)
 - B. Partnership
 - C. Corporation
2. You **must** check one of the boxes below:
 - A. I certify that my business is a sole proprietorship and it has no employees but the sole proprietor. I am not subject to the Worker's Compensation Laws.
 - B. I certify that my business has satisfied its obligation to the Worker's Compensation Act through the use of an approved Notice of Exclusion (BWC-337, Rev. 5/96). I will provide a copy of the Notice of Exclusion within 21 days of the contract award. (For questions or a copy of the BWC-337, please call the Worker's Compensation Bureau at 517-322-1195).
 - C. I certify that my business has a Worker's Compensation Policy. I will provide an original Certificate of Insurance within 21 days of the contract award.
3. If you have checked item 2(A) or 2(B), you **must** indicate the number of **both** full and part time employees other than yourself including family members and active partners (if none, you must enter "0").

_____ Full Time Employees

_____ Part Time Employees

Name of Business		Federal ID (or) Social Security No.	
Address		Telephone No. ()	
City	State	Zip + 4	

I hereby certify that the above information is true and correct. I agree to notify the DNR of any changes that occur in factors affecting my coverage during any of my present and future operations.

Signature of Owner or Authorized Representative

Title

Date

SPIKE HORN ASPEN (012-07-01)
T41N, R07E, SEC. 04, W1/2NW, W1/2SW.
T41N, R07E, SEC. 09, W1/2NW, NWSW.
CHIPPEWA COUNTY

In response to the notice of sale to be held 10:00 a.m. on October 13, 2008, I am hereby submitting my sealed bid (firm offer) for the following forest products to be cut. Bids for individual species and total bid value must be at or above the appraised price. All non-responsive bid forms may be rejected.

<u>SPECIES</u>	<u>APPRAISED PRICE</u>	<u>BID PRICE</u>	<u>ESTIMATED VOLUME*</u>	<u>= VALUE</u>
<u>PULPWOOD</u>				
W. SPRUCE	\$ 16.50/CORD	\$ _____ X	609.00 CORDS	= \$ _____
MIX ASPEN	\$ 12.00/CORD	\$ _____ X	1237.00 CORDS	= \$ _____
SUBTOTAL 1				\$ _____

In addition, the successful bidder agrees to purchase the following species at the appraised price:

<u>SPECIES</u>	<u>APPRAISED PRICE</u>	<u>ESTIMATED VOLUME*</u>	<u>VALUE</u>
<u>SAWLOGS</u>			
P. BIRCH	\$ 120.00/MBF	6.70 MBF	= \$ 804.00
W. SPRUCE	\$ 45.00/MBF	61.70 MBF	= \$ 2,776.50
MIX ASPEN	\$ 47.00/MBF	51.30 MBF	= \$ 2,411.10
<u>PULPWOOD</u>			
P. BIRCH	\$ 6.20/CORD	503.00 CORDS	= \$ 3,118.60
B. POPLAR	\$ 4.30/CORD	505.00 CORDS	= \$ 2,171.50
BALSAM FIR	\$ 9.50/CORD	75.00 CORDS	= \$ 712.50
SUBTOTAL 2			\$ <u>11,994.20</u>

SUBTOTAL 1 + SUBTOTAL 2 = TOTAL BID VALUE \$ _____

*These volumes are statistically estimated within plus (+) or minus (-) 8.90%. These estimated volumes are final and not subject to adjustment. Prospective bidders are urged to examine this timber and to make their own estimates of quantity and quality.

I understand that any or all bids may be rejected, and that the individual unit bid price will be the basis to determine total bid value. All bids must be signed and all bid items must be bid or the bid form may be rejected. I also understand that consideration and awarding a contract will be based upon my past performance and ability to complete the contract based upon equipment and manpower subject to my control.

(bidder's printed name)

(bidder's signature)

Address/Telephone _____

THE WINNING BIDDER MUST COMPLETE THE FORM ON THE REVERSE SIDE
WITHIN 21 DAYS OF SALE AWARD



Michigan Department of Natural Resources
Forest, Mineral and Fire Management

FOR DEPARTMENT USE ONLY	
Sale or Permit No	
Year:	Type:
Forest Area:	

**TIMBER SALE
VERIFICATION OF WORKER'S DISABILITY
COMPENSATION ACT COMPLIANCE**

As required by Act 317, P.A. 1969 (Worker's Compensation) and Part 525 of Act 451 of 1994, as amended.

VERIFICATION OF WORKER'S DISABILITY COMPENSATION ACT COMPLIANCE

- This verification must be completed and submitted within 21 days of contract award and prior to the issuance of the timber sale contract.
- In addition, if boxes 2B or 2C are checked, then Notice of Exclusion or Certificate of Insurance must be submitted within 21 days of the contract award and prior to the issuance of the timber sale contract.
- All Information must be typed or printed except for written signatures.

Please Check Appropriate Categories:

1. My business is organized as (you must check one of the boxes below):
 - A. Sole Proprietorship (individual)
 - B. Partnership
 - C. Corporation
2. You must check one of the boxes below:
 - A. I certify that my business is a sole proprietorship and it has no employees but the sole proprietor. I am not subject to the Worker's Compensation Laws.
 - B. I certify that my business has satisfied its obligation to the Worker's Compensation Act through the use of an approved Notice of Exclusion (BWC-337, Rev. 5/96). I will provide a copy of the Notice of Exclusion within 21 days of the contract award. (For questions or a copy of the BWC-337, please call the Worker's Compensation Bureau at 517-322-1195).
 - C. I certify that my business has a Worker's Compensation Policy. I will provide an original Certificate of Insurance within 21 days of the contract award.
3. If you have checked item 2(A) or 2(B), you must indicate the number of **both** full and part time employees other than yourself including family members and active partners (if none, you must enter "0").

_____ Full Time Employees

_____ Part Time Employees

Name of Business		Federal ID (or) Social Security No.	
Address		Telephone No. ()	
City	State	Zip + 4	

I hereby certify that the above information is true and correct. I agree to notify the DNR of any changes that occur in factors affecting my coverage during any of my present and future operations.

Signature of Owner or Authorized Representative

Title

Date

SMURF HARDWOODS (013-07-01)
T42N, R07E, SEC. 32, SW1/4.
T42N, R07E, SEC. 30, S1/2SW, SWSE, NENE.
T42N, R07E, SEC. 29, SWNE, NW1/4.
T42N, R07E, SEC. 31, NW1/4, NWNE.
CHIPPEWA COUNTY

In response to the notice of sale to be held 10:00 a.m. on October 13, 2008, I am hereby submitting my sealed bid (firm offer) for the following forest products to be cut. Bids for individual species and total bid value must be at or above the appraised price. All non-responsive bid forms may be rejected.

<u>SPECIES</u>	<u>APPRAISED PRICE</u>	<u>BID PRICE</u>	<u>ESTIMATED VOLUME*</u>	<u>= VALUE</u>
SAWLOGS				
SUG. MAPLE	\$ 519.00/MBF	\$ _____ X	19.20 MBF	= \$ _____
PULPWOOD				
MIX HARDWD	\$ 2.60/CORD	\$ _____ X	514.00 CORDS	= \$ _____
			SUBTOTAL 1	\$ _____

In addition, the successful bidder agrees to purchase the following species at the appraised price:

<u>SPECIES</u>	<u>APPRAISED PRICE</u>	<u>ESTIMATED VOLUME*</u>	<u>VALUE</u>
SAWLOGS			
WHITE ASH	\$ 105.00/MBF	1.40 MBF	= \$ 147.00
BEECH	\$ 52.00/MBF	.20 MBF	= \$ 10.40
P. BIRCH	\$ 105.00/MBF	4.30 MBF	= \$ 451.50
W. SPRUCE	\$ 33.00/MBF	.30 MBF	= \$ 9.90
N.W. CEDAR	\$ 60.00/MBF	.30 MBF	= \$ 18.00
MIX ASPEN	\$ 42.00/MBF	22.70 MBF	= \$ 953.40
PULPWOOD			
P. BIRCH	\$ 2.85/CORD	3.00 CORDS	= \$ 8.55
N.W. CEDAR	\$ 9.90/CORD	1.00 CORDS	= \$ 9.90
MIX ASPEN	\$ 4.65/CORD	56.00 CORDS	= \$ 260.40
			SUBTOTAL 2 \$ <u>1,869.05</u>

SUBTOTAL 1 + SUBTOTAL 2 = TOTAL BID VALUE \$ _____

*These estimated volumes are final and not subject to adjustment. Prospective bidders are urged to examine this timber and to make their own estimates of quantity and quality.

I understand that any or all bids may be rejected, and that the individual unit bid price will be the basis to determine total bid value. All bids must be signed and all bid items must be bid or the bid form may be rejected. I also understand that consideration and awarding a contract will be based upon my past performance and ability to complete the contract based upon equipment and manpower subject to my control.

(bidder's printed name)

(bidder's signature)

Address/Telephone _____

THE WINNING BIDDER MUST COMPLETE THE FORM ON THE REVERSE SIDE
WITHIN 21 DAYS OF SALE AWARD



FOR DEPARTMENT USE ONLY

**TIMBER SALE
VERIFICATION OF WORKER'S DISABILITY
COMPENSATION ACT COMPLIANCE**

*As required by Act 317, P.A. 1969 (Worker's Compensation) and Part 525
of Act 451 of 1994, as amended.*

Sale or Permit No	
Year:	Type:
Forest Area:	

VERIFICATION OF WORKER'S DISABILITY COMPENSATION ACT COMPLIANCE

- This verification must be completed and submitted within 21 days of contract award and prior to the issuance of the timber sale contract.
- In addition, if boxes 2B or 2C are checked, then Notice of Exclusion or Certificate of Insurance must be submitted within 21 days of the contract award and prior to the issuance of the timber sale contract.
- All Information must be typed or printed except for written signatures.

Please Check Appropriate Categories:

1. My business is organized as (you **must** check one of the boxes below):
 - A. Sole Proprietorship (individual)
 - B. Partnership
 - C. Corporation
2. You **must** check one of the boxes below:
 - A. I certify that my business is a sole proprietorship and it has no employees but the sole proprietor. I am not subject to the Worker's Compensation Laws.
 - B. I certify that my business has satisfied its obligation to the Worker's Compensation Act through the use of an approved Notice of Exclusion (BWC-337, Rev. 5/96). I will provide a copy of the Notice of Exclusion within 21 days of the contract award. (For questions or a copy of the BWC-337, please call the Worker's Compensation Bureau at 517-322-1195).
 - C. I certify that my business has a Worker's Compensation Policy. I will provide an original Certificate of Insurance within 21 days of the contract award.
3. If you have checked item 2(A) or 2(B), you **must** indicate the number of **both** full and part time employees other than yourself including family members and active partners (if none, you must enter "0").

_____ Full Time Employees

_____ Part Time Employees

Name of Business		Federal ID (or) Social Security No.	
Address		Telephone No. ()	
City	State	Zip + 4	

I hereby certify that the above information is true and correct. I agree to notify the DNR of any changes that occur in factors affecting my coverage during any of my present and future operations.

Signature of Owner or Authorized Representative

Title

Date