



DEPARTMENT OF NATURAL RESOURCES
STATE OF MICHIGAN

TIMBER SALE PROSPECTUS

Notice is hereby given that bids will be received by the Unit Manager,
SHINGLETON MANAGEMENT UNIT, for certain timber on the following described lands:

BULLOCK PINE / T46N, R14W, SEC. 33, W1/2NW, SENW, SWNE, W1/2SE, E1/2S.
T46N, R14W, SEC. 33, NESE.
T46N, R14W, SEC. 34, NWSW.
SCHOOLCRAFT COUNTY (Appr. \$22,964.45)

NO MORE HARDWOOD / T47N, R16W, SEC. 17, SWSW.
T47N, R16W, SEC. 18, E1/2NE, SE1/4.
T47N, R16W, SEC. 19, N1/2NE, SEC.20 NWNW.
T47N, R16W, SEC. 04, SESW. SEC.9 NENW.
SCHOOLCRAFT COUNTY (Appr. \$32,028.45)

////////////////////

SALE DATE AND TIME: 10:00 a.m. on May 14, 2009.

SHINGLETON

BID INSTRUCTIONS (Ver. 06/23/2008):

1. **Bid Location, Date, and Time:** Bids must be received by the Unit Manager, Shingleton Management Unit, M-28 West, PO Box 67, Shingleton, MI 49884, no later than 10:00 a.m. on May 14, 2009. For further information concerning this sale, contact the Unit Manager at 906-452-6227.
2. **Bidder's Qualifications:** Purchaser shall obtain workers compensation insurance to cover claims under Michigan's Worker's Disability Compensation Act of 1969 or similar employee benefit act of any other state applicable to an employee. If all or part of a timber sale was prepared by a private contractor, that contractor and that contractor's company are not permitted to bid on the timber sale contract. Bids will not be accepted from individuals or companies appearing on the DNR/FMFM No-Bid List. This list contains the names of purchasers who previously failed to execute a contract within 21-days or who have a history of poor performance.
3. **Preparation of Sealed Bids:** Bids shall be manually signed in ink; bid prices must be entered for each species and product in the Bid Price column for all material subject to bidding; and all fill-in blanks must be completed. If erasures or other changes appear on the forms, each erasure or change must be initialed by the person signing the bid.
4. **Submission of Sealed Bids:** Bid forms may be obtained from the Unit Manager. All bids must be submitted on the bid form and in an envelope clearly identified as described in this section. NOTE: Only one bid form per bid envelope. Sealed bids must be submitted to the Unit office designated in the prospectus and must be submitted at or prior to the time established in the prospectus. The envelope should show on the outside (a) that it is a "Bid for Timber," and (b) the sale name or number, and (c) the date and time of bid opening as shown in the prospectus. Bids received after the time specified in the sale prospectus are late bids and will be rejected.
5. **Public Opening of Sealed Bids:** If conditions permit, the sealed bids will be publicly opened and posted at the time and place set in the prospectus.
6. **Award of Contract:** Award of the contract will be made to the Bidder whose bid, conforming to the prospectus, is most advantageous to the State of Michigan on the basis of total value at rates bid for the estimated quantities. The State reserves the right to reject any bid or waive any minor irregularity in bids received. A written award mailed (or otherwise furnished) to the successful Bidder shall be deemed to result in a binding contract without further action by either party.
7. **Down Payment:** The Bidder to whom award is made must make a down payment within 21 days of the sale award. The amount of the down payment will be calculated as shown in the Bond and Payment Schedule of this prospectus. Only cash may be used to meet this requirement.
8. **Performance Security:** As guarantee of faithful performance, a cash bond, certificate of deposit, surety bond or irrevocable letter of credit (LOC) is required within 21 days of the sale award. The amount of the performance security is shown in the Bond and Payment Schedule of this prospectus. If an LOC or surety is used, the coverage must extend for at least 6 months beyond the contract expiration.
9. **Timber Sale Contract:** Additional conditions and requirements common to all timber sales are listed on the timber sale contract (R4031) and are available on line at www.michigan.gov/dnr. Contact the Unit Manager for additional information or a sample contract. Within 21 days of the date of the award letter, the bidder must sign the contract and provide the required down payment, performance security, and verification of worker's disability compensation. The down payment and performance security shall be in accordance with the provisions of the timber sale contract, in the sums stated in this prospectus. If these actions are not taken, then the Bidder, the Bidder's corporation, and the corporation's principals may not be permitted to bid on State timber sales for a period of 1 year. In addition, the Bidder certifies that if awarded this contract, the Bidder will complete the timber sale contract in accordance with its terms and any modifications thereof including requirements to purchase, cut, and remove the included timber by the termination date.

10. Disclaimer of Estimates and Bidder's Warranty of Inspection: Before submitting this bid, the Bidder is advised and cautioned to inspect the sale area, review the requirements of the sale contract, and take other steps as may be reasonably necessary to ascertain the location, estimated volumes, construction estimates, and operating costs of the proposed sale. Failure to do so will not relieve the Bidder from responsibility for completing the contract.

The Bidder warrants that this bid is submitted solely on the basis of the Bidder's examination and inspection of the quality and quantity of the timber offered for sale and the Bidder's opinion of the value thereof and the costs of recovery. No reliance should be placed on the State of Michigan's estimates of timber quality, quantity or costs of recovery. Bidder further acknowledges that the State of Michigan: (i) expressly disclaims any warranty of fitness of timber for any purpose; (ii) offers this timber as is without any warranty of quality (merchantability) or quantity and (iii) expressly disclaims any warranty as to the quantity or quality of timber sold.

11. Certification and Chain-of-Custody: Unless otherwise indicated in the contract under section 7 - Other Conditions of the Sale Specific Conditions & Requirements, the area encompassed by this timber sale is certified to the standards of the Forest Stewardship Council (FSC) - Certificate #SCS-FM/COC-090N and the Sustainable Forestry Initiative (SFI) - Certificate # NSF-SFIS-5Y031-S1. Forest products from this sale may be delivered to the mill as "FSC and / or SFI certified" as long as the contractor hauling the forest products is chain-of-custody (COC) certified or covered under a COC certificate from the destination mill. The purchaser is responsible for maintaining COC after leaving the sale area.

REBECCA A. HUMPHRIES
Director

BULLOCK PINE (036-08-01)

A timber sale contract for this LUMP SUM SEALED timber sale will be awarded the responsible bidder offering the highest sealed bid price. Bids must be at or above the following appraised price for each species:

<u>SPECIES</u>	<u>ESTIMATED VOLUME*</u>	<u>APPRAISED PRICE</u>
SAWLOGS		
RED PINE	60.10 MBF	\$ 157.00/MBF
PULPWOOD		
RED PINE	282.00 CORDS	\$ 28.90/CORD
MIX ASPEN	254.00 CORDS	\$ 15.35/CORD

In addition, the successful bidder agrees to purchase the following species at the indicated appraised price:

<u>SPECIES</u>	<u>ESTIMATED VOLUME*</u>	<u>APPRAISED PRICE</u>
SAWLOGS		
WHITE PINE	2.10 MBF	\$ 62.00/MBF
PULPWOOD		
WHITE PINE	79.00 CORDS	\$ 11.40/CORD
JACK PINE	14.00 CORDS	\$ 26.50/CORD
MIX SOFTWD	5.00 CORDS	\$ 15.65/CORD

*The volumes are statistically estimated within plus (+) or minus (-) 15.50 percent. These estimated volumes are final and not subject to adjustment. Prospective bidders are urged to examine this timber and to make their own estimates of quantity and quality.

BOND AND PAYMENT SCHEDULE:

1. A bond in the amount of \$1,148.00 to insure faithful performance of the conditions of the contract, will be deposited by the successful bidder within 21 days of the sale award.
2. Cutting in any sale or unit without the required advance payment would be considered a trespass.
3. Total payment may be paid in advance or according to the following schedule:
 - (a) Ten percent (10%) of the sale value must be paid within 21 days of the sale award.
 - (b) The 10% down payment will be credited towards the first unit cut.
 - (c) Payment for each of the following units must be made before cutting begins in that unit:

<u>PAYMENT UNIT NUMBER</u>	<u>PERCENT OF TOTAL SALE VALUE</u>
1	14%
2	38%
3	48%
4. If no cutting takes place, the 10% down payment will not be refunded.
5. Operations on the contract issued will terminate on June 30, 2011.



TIMBER SALE MAP

This information provided by authority of Part 525 of Act 451, PA 1994, as amended.

Sale Number	Year
41-036-08-01	08

Forest Management Unit Shingleton	County Schoolcraft	Mapped By R. Matson	Date March 17, 2008	Page 1	of 1
Township 46 N	Range 14 W	Section(s) and Subdivision(s) 33 W¹/₂NW, SWNE, SWNE, W¹/₂SE, E¹/₂SW, NESE	Cruised By Matson		
Scale: ... 4" = 1 mile					

Cover Type				Density	
A = Aspen	G = Grass	O = Oak	U = Upland Brush	0 = Non Stocked	5 = Pole Timber Medium
B = Paper Birch	H = Hemlock	P = Lowland Poplar	V = Bog or Marsh	1 = Seedling Sapling Poor	6 = Pole Timber Well
C = Cedar	J = Jack Pine	Q = Mixed Swamp Cnfr	W = White Pine	2 = Seedling Sapling Medium	7 = Saw Timber Poor
D = Treed Bog	L = Lowland Brush	R = Red Pine	X = Non Stocked	3 = Seedling Sapling Well	8 = Saw Timber Medium
E = Swamp Hdwoods	M = Mpl, Bch, Brch	S = Black Spruce	Z = Water	4 = Pole Timber Poor	9 = Saw Timber Well
F = Spruce Fir	N = Marsh	T = Tamarack			

Bullock Pine

69 acres

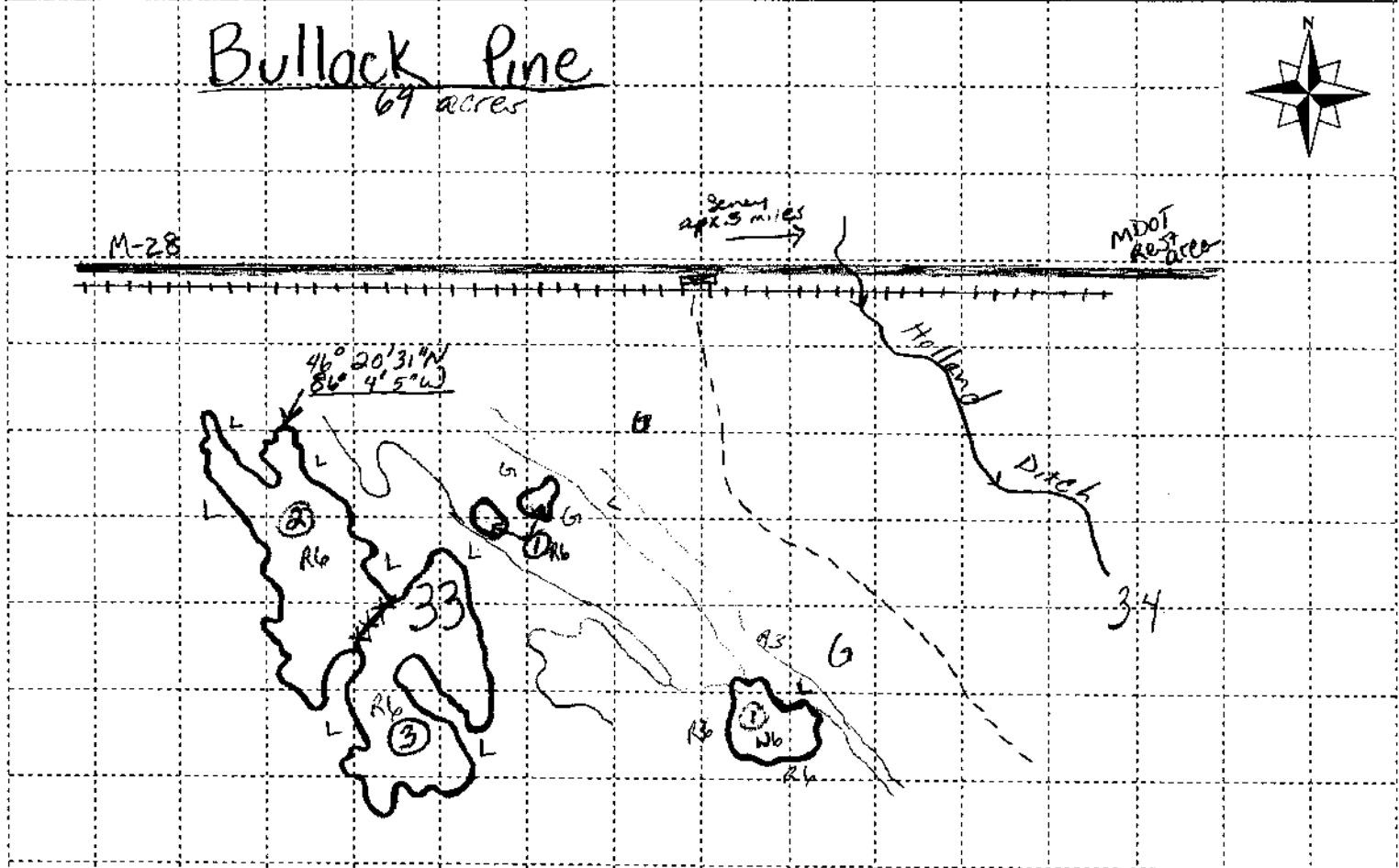

Legend:

- Sale Boundary - Red paint
- Unit Boundary - Green paint
- dirt two-track road
- Railroad - private property
- Gate - must be kept closed
- Payment Unit Number

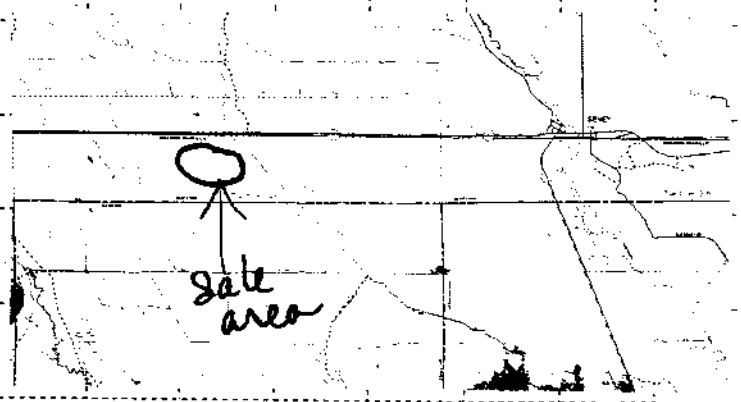

Sale Specific Conditions & Requirements

Sale Name: Bullock Pine Sale Number: 41-036-08-01

1 - Sale Area

1.2 - Boundaries

1.2.1 - Painted boundaries (6/05)

The sale boundary and Payment Unit boundaries are marked and identified by red and green paint. Exterior sale boundary lines against state are marked with red paint. Interior Payment Unit boundaries are marked with green paint. Do not cut painted boundary line trees unless also marked with orange paint.

2 - Timber Specifications

2.1 - Included Timber

2.1.3 - Cut tree marked unit(s) (8/04)

Within Payment Unit(s) 1 through 3, all red and white pine trees are designated for cutting when marked with orange paint above and below stump height, regardless of merchantability. In addition, cut all other trees which meet the minimum piece specifications in 2.2 Utilization, except reserve trees listed in 2.1.12.

2.1.12 - Reserve trees (2/04)

The Purchaser shall not cut live or dead reserve trees within cutting units or clearings. Reserve trees are all Oak and Hemlock. The Purchaser shall protect reserve trees from damage by the Purchaser's operations. If the Purchaser's operations have cut or damaged reserve trees through carelessness, the Purchaser shall pay \$50 as fixed, agreed and liquidated damages for each reserve tree cut or damaged. Such payment does not constitute ownership of the undesigned timber.

4 - Transportation

4.1 - Construction

4.1.5 - Culverts (3/08)

Roads may require the installation of culverts at cross drainages on wet soils, or across natural drainage-ways. Culverts shall be placed in locations specified by the sale administrator and shall be new, corrugated metal, and the appropriate size for the crossing. Culverts shall be installed prior to use of the road. If culverts are removed, fill shall be removed from wetland soils as specified. Soils shall be maintained and left in a non-erodible condition, with water bars, seed, fertilizer, mulch, and slash installed as directed by the sale administrator and as specified in the BMP manual. Stream crossing permits, if needed, will be obtained by the DNR.

Sale Name: Bullock Pine Sale Number: 41-036-08-01

4.1.6 - Road construction (6/07)

Construction of new roads or improvements of existing roads shall be done in such a way as to minimize the environmental and visual impacts. Merchantable trees shall be cut and utilized unless otherwise directed. Non-merchantable trees shall be severed and laid flat on the ground. Slash shall be scattered, and not left in windrows and kept a minimum of 10 feet back from the road edge. Stumps shall be set upright, not left on edge, and be moved at least 10 feet away from the road edge. Disturbed soil shall be feathered into the woods and not left in berms or windrows.

4.2 - Maintenance

4.2.3 - Road maintenance (9/08)

The following road maintenance may be needed: Any new roads across the G types will need to be floated off level with the adjacent ground when the sale is complete.

4.2.5 - Two wheel drive condition (2/04)

All existing trail roads on and adjacent to the sale area must be passable by two-wheel drive traffic for the duration of the sale.

4.4 - Access

4.4.1 - Private property access (8/04)

Permission for access across private land (railroad tracks) has been obtained by the DNR. Any work required to cross the tracks, such as gravel for between the tracks, is the responsibility of the purchaser.

4.4.3 - Access gate (10/06)

The access gate must be locked at the completion of each day unless otherwise approved by the Unit Manager or their representative. The access gate must be kept closed at all times.

5 - Operations

5.1 - Notification

5.1.1 - Pre-sale conference (2/08)

A pre-sale conference on site between the Purchaser and sale administrator is required prior to beginning any operations. The Unit Manager or their representative must be contacted at least 5 days in advance to schedule the conference.

5.1.4 - Post-sale conference (2/04)

A post-sale conference on site between the Purchaser and sale administrator is required 5 days prior to the completion of active logging operations to determine clean-up and repair of landings, road edges, and the fulfillment of other contract specifications.

5.2 - Conduct of Operations

5.2.1 - Slash

5.2.1.2 - Slash Removal

5.2.1.2.6 - Slash removal (7/05)

Sale Name: Bullock Pine Sale Number: 41-036-08-01

All slash must be removed from any drainage ditches encountered. This only applies to slash that is a result of harvesting operations.

5.2.1.7 - Slash must be scattered (2/04)

Unless otherwise directed, slash and logging debris shall be uniformly scattered over the sale area and not left in piles or windrows. Slash shall not be allowed to accumulate at the landings. All slash work shall be done concurrently with harvesting.

5.2.2 - Snags

5.2.2.1 - Den trees (2/04)

Obvious hollow and/or den trees shall be protected and left standing unless they are a safety hazard.

5.2.3 - Operating Restrictions

5.2.3.1 - Operating restrictions (3/07)

Within Payment Unit(s) 1, unless changed by written agreement, cutting, skidding, and hauling are not permitted from March 15 to July 15. This restriction is because of potential breeding and nesting sharp-tailed grouse.

5.2.15 - Bark beetle restriction (2/04)

In the event drought creates a high risk of pine bark beetle infestation, pine is not to be cut during the period March 1 through July 1, unless all portions of trees greater than two inches in diameter are removed from the sale area, reduced to chips, or treated to the satisfaction of the Unit Manager or their representative, within fifteen days of being severed from the stump. Pine logs, pulpwood piles and treetop piles for chipping that are decked in the fall or winter within a 1/4 mile of susceptible sites must be removed before March 15. Residual slash must not be placed in piles or rows and must be spread over the site for quick drying. The Department of Natural Resources will exercise this option if the risk of damage warrants.

5.2.38 - No decking against live trees (2/04)

Cut products may not be decked against unmarked or designated leave trees.

5.4 - Soil Protection

5.4.1 - Rutting restriction, general (5/08)

Operations are to cease immediately if equipment and weather conditions result in rutting of roads which is 12 inches or greater in depth and 50 feet in length. In addition, operations are to cease immediately if equipment and weather conditions result in rutting on skid trails which is 12 inches or greater in depth and 50 feet in length. The Unit Manager or their representative may restrict hauling and/or skidding if ruts exceed the specified depth. With the Unit Manager or their representative's approval, the Purchaser may return to the area when the weather conditions have changed and/or the risk of rutting has decreased.

5.8 - Protection of Habitat of Endangered Species

5.8.5 - Protection of raptor nests (9/05)

All trees with raptor nests will be protected if found during harvesting operations. Notification will be made to the Unit Manager and Wildlife Biologist so an on-site evaluation and recommendation can be made, if necessary.

NO MORE HARDWOOD (037-08-01)

A timber sale contract for this LUMP SUM SEALED timber sale will be awarded the responsible bidder offering the highest sealed bid price. Bids must be at or above the following appraised price for each species:

<u>SPECIES</u>	<u>ESTIMATED VOLUME*</u>	<u>APPRAISED PRICE</u>
PULPWOOD		
MIX HARDWD	1153.00 CORDS	\$ 22.50/CORD

In addition, the successful bidder agrees to purchase the following species at the indicated appraised price:

<u>SPECIES</u>	<u>ESTIMATED VOLUME*</u>	<u>APPRAISED PRICE</u>
SAWLOGS		
RED MAPLE	16.40 MBF	\$ 130.00/MBF
WHITE PINE	4.30 MBF	\$ 59.00/MBF
BLK CHERRY	2.60 MBF	\$ 123.00/MBF
PULPWOOD		
P. BIRCH	8.00 CORDS	\$ 16.90/CORD
BALSAM FIR	79.00 CORDS	\$ 8.80/CORD
B. SPRUCE	131.00 CORDS	\$ 18.70/CORD
WHITE PINE	9.00 CORDS	\$ 11.15/CORD

*The volumes are statistically estimated within plus (+) or minus (-) 11.00 percent. These estimated volumes are final and not subject to adjustment. Prospective bidders are urged to examine this timber and to make their own estimates of quantity and quality.

BOND AND PAYMENT SCHEDULE:

1. A bond in the amount of \$1,601.00 to insure faithful performance of the conditions of the contract, will be deposited by the successful bidder within 21 days of the sale award.
2. Cutting in any sale or unit without the required advance payment would be considered a trespass.
3. Total payment may be paid in advance or according to the following schedule:
 - (a) Ten percent (10%) of the sale value must be paid within 21 days of the sale award.
 - (b) The 10% down payment will be credited towards the first unit cut.
 - (c) Payment for each of the following units must be made before cutting begins in that unit:

<u>PAYMENT UNIT NUMBER</u>	<u>PERCENT OF TOTAL SALE VALUE</u>
1	58%
2	42%
4. If no cutting takes place, the 10% down payment will not be refunded.
5. Operations on the contract issued will terminate on December 31, 2011.



Sale Number	Year
41-037-08-01	08

Forest Management Unit LSSF - SHINGLETON FO	County SCHOOLCRAFT	Mapped By J. BURNHAM	Date 9/19/08	Page 1	of 1
Township 47N	Range 16W	Section(s) and Subdivision(s) SE	Cruised By DOVER, J. BURNHAM		

Cover Type				Density	
A = Aspen	G = Grass	O = Oak	U = Upland Brush	0 = Non Stocked	5 = Pole Timber Medium
B = Paper Birch	H = Hemlock	P = Lowland Poplar	V = Bog or Marsh	1 = Seedling Sapling Poor	6 = Pole Timber Well
C = Cedar	J = Jack Pine	Q = Mixed Swamp Cnfr	W = White Pine	2 = Seedling Sapling Medium	7 = Saw Timber Poor
D = Treed Bog	L = Lowland Brush	R = Red Pine	X = Non Stocked	3 = Seedling Sapling Well	8 = Saw Timber Medium
E = Swamp Hdwoods	M = Mpl, Bch, Brch	S = Black Spruce	Z = Water	4 = Pole Timber Poor	9 = Saw Timber Well
F = Spruce Fir	N = Marsh	T = Tamarack			

NO MORE
Hardwoods
 88 Acres - Schoolcraft Co.

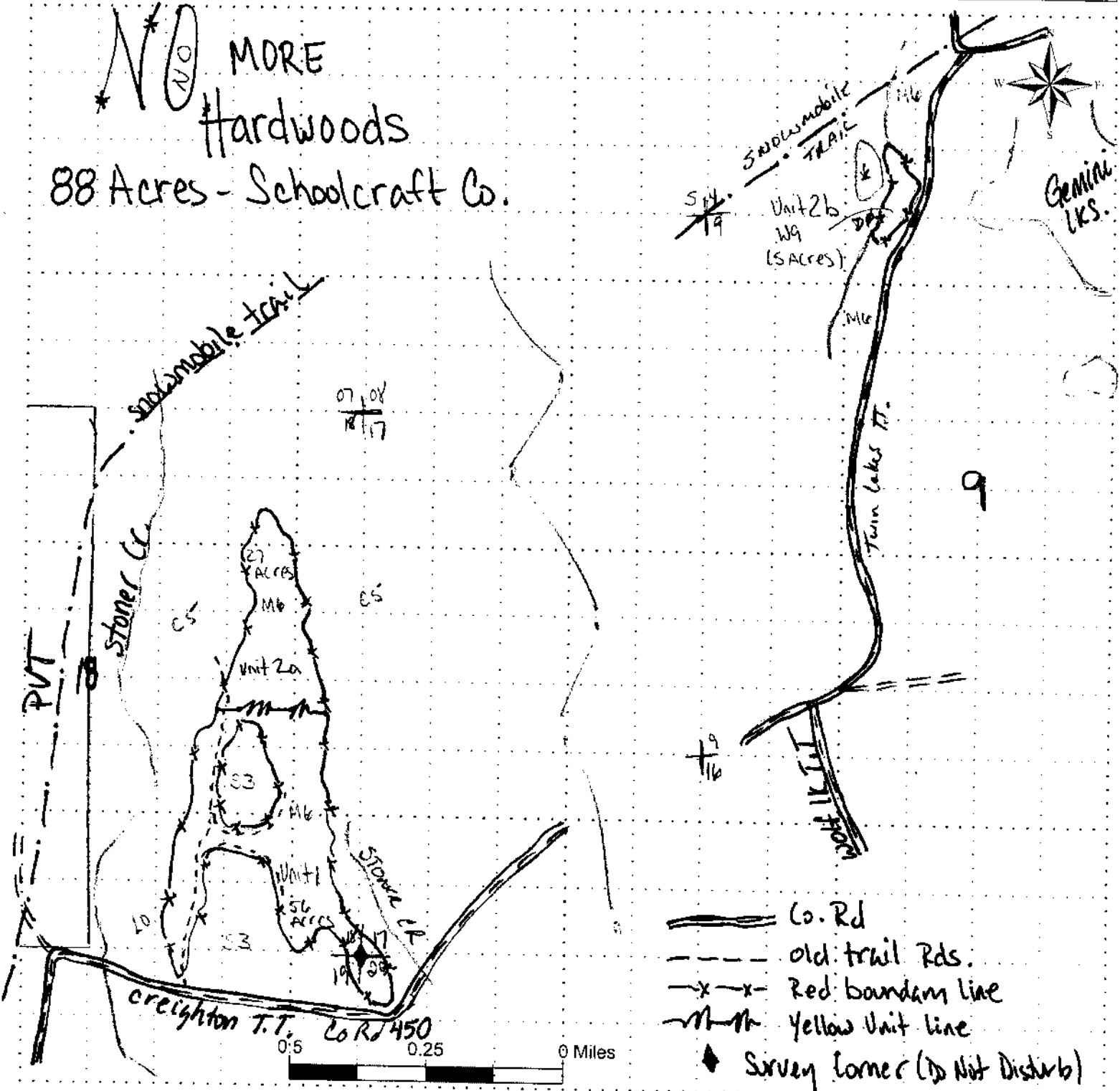

- Co. Rd
- - - old trail Rds.
- x-x- Red boundary line
- m-m- Yellow Unit line
- ◆ Survey Corner (Do Not Disturb)

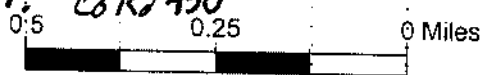

Sale Specific Conditions & Requirements

Sale Name: No More Hardwood Sale Number: 41-037-08-01

1 - Sale Area

1.2 - Boundaries

1.2.1 - Painted boundaries (6/05)

The sale boundary and Payment Unit boundaries are marked and identified by red and yellow paint. Exterior sale boundary lines against state are marked with red paint. Interior Payment Unit boundaries are marked with yellow paint. Do not cut painted boundary line trees.

2 - Timber Specifications

2.1 - Included Timber

2.1.2 - Clearcut unit(s) w/o unmerchantable trees (5/07)

Within Payment Unit(s) 1 and 2a, cut all trees which meet minimum piece specifications in 2.2 Utilization except Hemlock, White Pine, Yellow Birch, Cedar and trees marked with GREEN paint.

2.1.3 - Cut tree marked unit(s) (8/04)

Within Payment Unit(s) 2b, White Pine trees are designated for cutting when marked with orange paint above and below stump height, regardless of merchantability. In addition, cut all trees which meet minimum piece specifications in 2.2 Utilization EXCEPT hemlock, yellow birch and cedar.

4 - Transportation

4.1 - Construction

4.1.1 - Stream crossings, general (2/04)

All stream crossing structures will be temporary and therefore, shall be provided by the purchaser, and must be removed upon completion of the sale. All permits for stream crossings will be provided by the DNR.

4.1.6 - Road construction (6/07)

Construction of new roads or improvements of existing roads shall be done in such a way as to minimize the environmental and visual impacts. Merchantable trees shall be cut and utilized unless otherwise directed. Non-merchantable trees shall be severed and laid flat on the ground. Slash shall be scattered, and not left in windrows and kept a minimum of 10 feet back from the road edge. Stumps shall be set upright, not left on edge, and be moved at least 10 feet away from the road edge. Disturbed soil shall be feathered into the woods and not left in berms or windrows.

4.1.7 - Road closure (4/07)

All new roads built into the sale must be blocked to vehicle traffic upon completion of the sale. Overgrown roads that are reopened shall be considered new roads. In general, this will require constructing a four (4') foot high berm constructed of stumps and logs covered with earth. These roads must be rendered impassable to cars and trucks.

4.3 - Public Right-of-Way

4.3.2 - County R-O-W (12/06)

The county must be contacted prior to harvesting along the county road R-O-W.

5 - Operations

5.1 - Notification

5.1.1 - Pre-sale conference (2/08)

A pre-sale conference on site between the Purchaser and sale administrator is required prior to beginning any operations. The Unit Manager or their representative must be contacted at least 5 days in advance to schedule the conference.

5.1.4 - Post-sale conference (2/04)

A post-sale conference on site between the Purchaser and sale administrator is required 5 days prior to the completion of active logging operations to determine clean-up and repair of landings, road edges, and the fulfillment of other contract specifications.

5.2 - Conduct of Operations

5.2.1 - Slash

5.2.1.2 - Slash Removal

5.2.1.2.1 - Slash removal (12/04)

All slash must be removed at least 10 feet from the cleared right-of-way of forest roads.

5.2.1.7 - Slash must be scattered (2/04)

Unless otherwise directed, slash and logging debris shall be uniformly scattered over the sale area and not left in piles or windrows. Slash shall not be allowed to accumulate at the landings. All slash work shall be done concurrently with harvesting.

5.2.2 - Snags

5.2.2.1 - Den trees (2/04)

Obvious hollow and/or den trees shall be protected and left standing unless they are a safety hazard.

5.2.3 - Operating Restrictions

5.2.3.1 - Operating restrictions (3/07)

Within Payment Unit(s) # 2b, unless changed by written agreement, cutting, skidding, and hauling are not permitted during the period of April 15th to July 15th. This restriction is because of Loons found on adjacent lakes.

5.2.3.9 - Beech hauling restriction (9/08)

American beech wood products with bark still attached, other than chips, are not to be transported from stands infested with beech bark disease to or through uninfested beech areas from July 15 to November 15. Beech

Sale Name: No More Hardwood Sale Number: 41-037-08-01

scale is mobile at this time of year and can move from infested wood to live beech. (See Map of current beech scale distribution on the DNR FMFM Forest Health Website.)

5.2.22 - Operating Caution

5.2.22.1 - Operating caution (12/04)

It is recommended, but not required, that within Payment Unit(s) 1 and 2A, cutting, skidding, and hauling occur during dry summer or frozen winter conditions. This restriction is because wet conditions can cause soil rutting.

5.2.32 - Decking/landing restoration (2/04)

All decking and landing areas must have the surface area restored to a condition equal to or better than before. This is to insure the proper regeneration of the stand.

5.2.37 - No decking areas (10/04)

No decking is allowed within 50 feet of county road without permission from the Schoolcraft County Road Commission and the Unit Manager.

5.2.38 - No decking against live trees (2/04)

Cut products may not be decked against unmarked or designated leave trees.

5.4 - Soil Protection

5.4.1 - Rutting restriction, general (5/08)

Operations are to cease immediately if equipment and weather conditions result in rutting of roads which is 12 inches or greater in depth and 50 feet in length. In addition, operations are to cease immediately if equipment and weather conditions result in rutting on skid trails which is 12 inches or greater in depth and 50 feet in length. The Unit Manager or their representative may restrict hauling and/or skidding if ruts exceed the specified depth. With the Unit Manager or their representative's approval, the Purchaser may return to the area when the weather conditions have changed and/or the risk of rutting has decreased.

5.8 - Protection of Habitat of Endangered Species

5.8.5 - Protection of raptor nests (9/05)

All trees with raptor nests will be protected if found during harvesting operations. Notification will be made to the Unit Manager and Wildlife Biologist so an on-site evaluation and recommendation can be made, if necessary.

TIMBER SALE / SEALED BID
STATE OF MICHIGAN / DNR

SHINGLETON MANAGEMENT UNIT
SHINGLETON

BULLOCK PINE (036-08-01)
T46N, R14W, SEC. 33, W1/2NW, SENW, SWNE, W1/2SE, E1/2S.
T46N, R14W, SEC. 33, NESE.
T46N, R14W, SEC. 34, NWSW.
SCHOOLCRAFT COUNTY

In response to the notice of sale to be held 10:00 a.m. on May 14, 2009, I am hereby submitting my sealed bid (firm offer) for the following forest products to be cut. Bids for individual species and total bid value must be at or above the appraised price. All non-responsive bid forms may be rejected.

<u>SPECIES</u>	<u>APPRAISED PRICE</u>	<u>BID PRICE</u>	<u>ESTIMATED VOLUME*</u>	<u>= VALUE</u>
SAWLOGS				
RED PINE	\$ 157.00/MBF	\$ _____ X	60.10 MBF	= \$ _____
PULPWOOD				
RED PINE	\$ 28.90/CORD	\$ _____ X	282.00 CORDS	= \$ _____
MIX ASPEN	\$ 15.35/CORD	\$ _____ X	254.00 CORDS	= \$ _____
			SUBTOTAL 1	\$ _____

In addition, the successful bidder agrees to purchase the following species at the appraised price:

<u>SPECIES</u>	<u>APPRAISED PRICE</u>	<u>ESTIMATED VOLUME*</u>	<u>VALUE</u>
SAWLOGS			
WHITE PINE	\$ 62.00/MBF	2.10 MBF	= \$ 130.20
PULPWOOD			
WHITE PINE	\$ 11.40/CORD	79.00 CORDS	= \$ 900.60
JACK PINE	\$ 26.50/CORD	14.00 CORDS	= \$ 371.00
MIX SOFTWD	\$ 15.65/CORD	5.00 CORDS	= \$ 78.25
			SUBTOTAL 2 \$ 1,480.05
			SUBTOTAL 1 + SUBTOTAL 2 = TOTAL BID VALUE \$ _____

*These volumes are statistically estimated within plus (+) or minus (-) 15.50%. These estimated volumes are final and not subject to adjustment. Prospective bidders are urged to examine this timber and to make their own estimates of quantity and quality.

I understand that any or all bids may be rejected, and that the individual unit bid price will be the basis to determine total bid value. All bids must be signed and all bid items must be bid or the bid form may be rejected. I also understand that consideration and awarding a contract will be based upon my past performance and ability to complete the contract based upon equipment and manpower subject to my control.

(bidder's printed name)

(bidder's signature)

Address/Telephone _____

THE WINNING BIDDER MUST COMPLETE THE FORM ON THE REVERSE SIDE
WITHIN 21 DAYS OF SALE AWARD



**TIMBER SALE
VERIFICATION OF WORKER'S DISABILITY
COMPENSATION ACT COMPLIANCE**

*As required by Act 317, P.A. 1969 (Worker's Compensation) and Part 525
of Act 451 of 1994, as amended.*

FOR DEPARTMENT USE ONLY

Sale or Permit No

Year:

Type:

Forest Area:

VERIFICATION OF WORKER'S DISABILITY COMPENSATION ACT COMPLIANCE

- This verification must be completed and submitted within 21 days of contract award and prior to the issuance of the timber sale contract.
- In addition, if boxes 2B or 2C are checked, then Notice of Exclusion or Certificate of Insurance must be submitted within 21 days of the contract award and prior to the issuance of the timber sale contract.
- All Information must be typed or printed except for written signatures.

Please Check Appropriate Categories:

1. My business is organized as (you must check one of the boxes below):

- A. Sole Proprietorship (individual)
- B. Partnership
- C. Corporation

2. You must check one of the boxes below:

- A. I certify that my business is a sole proprietorship and it has no employees but the sole proprietor. I am not subject to the Worker's Compensation Laws.
- B. I certify that my business has satisfied its obligation to the Worker's Compensation Act through the use of an approved Notice of Exclusion (BWC-337, Rev. 5/96). I will provide a copy of the Notice of Exclusion within 21 days of the contract award. (For questions or a copy of the BWC-337, please call the Worker's Compensation Bureau at 517-322-1195).
- C. I certify that my business has a Worker's Compensation Policy. I will provide an original Certificate of Insurance within 21 days of the contract award.

3. If you have checked item 2(A) or 2(B), you must indicate the number of **both** full and part time employees other than yourself including family members and active partners (if none, you must enter "0").

_____ Full Time Employees

_____ Part Time Employees

Name of Business		Federal ID (or) Social Security No.	
Address		Telephone No. ()	
City	State	Zip + 4	

I hereby certify that the above information is true and correct. I agree to notify the DNR of any changes that occur in factors affecting my coverage during any of my present and future operations.

Signature of Owner or Authorized Representative

Title

Date

NO MORE HARDWOOD (037-08-01)

T47N, R16W, SEC. 17, SWSW.
T47N, R16W, SEC. 18, E1/2NE, SE1/4.
T47N, R16W, SEC. 19, N1/2NE, SEC.20 NWNW.
T47N, R16W, SEC. 04, SESW. SEC.9 NENW.
SCHOOLCRAFT COUNTY

In response to the notice of sale to be held 10:00 a.m. on May 14, 2009, I am hereby submitting my sealed bid (firm offer) for the following forest products to be cut. Bids for individual species and total bid value must be at or above the appraised price. All non-responsive bid forms may be rejected.

<u>SPECIES</u>	<u>APPRAISED PRICE</u>	<u>BID PRICE</u>	<u>ESTIMATED VOLUME* = VALUE</u>
PULPWOOD			
MIX HARDWD	\$ 22.50/CORD	\$ _____ X	1153.00 CORDS = \$ _____
			SUBTOTAL 1 \$ _____

In addition, the successful bidder agrees to purchase the following species at the appraised price:

<u>SPECIES</u>	<u>APPRAISED PRICE</u>	<u>ESTIMATED VOLUME*</u>	<u>VALUE</u>
SAWLOGS			
RED MAPLE	\$ 130.00/MBF	16.40 MBF	= \$ 2,132.00
WHITE PINE	\$ 59.00/MBF	4.30 MBF	= \$ 253.70
BLK CHERRY	\$ 123.00/MBF	2.60 MBF	= \$ 319.80
PULPWOOD			
P. BIRCH	\$ 16.90/CORD	8.00 CORDS	= \$ 135.20
BALSAM FIR	\$ 8.80/CORD	79.00 CORDS	= \$ 695.20
B. SPRUCE	\$ 18.70/CORD	131.00 CORDS	= \$ 2,449.70
WHITE PINE	\$ 11.15/CORD	9.00 CORDS	= \$ 100.35
			SUBTOTAL 2 \$ 6,085.95

SUBTOTAL 1 + SUBTOTAL 2 = TOTAL BID VALUE \$ _____

*These volumes are statistically estimated within plus (+) or minus (-) 11.00%. These estimated volumes are final and not subject to adjustment. Prospective bidders are urged to examine this timber and to make their own estimates of quantity and quality.

I understand that any or all bids may be rejected, and that the individual unit bid price will be the basis to determine total bid value. All bids must be signed and all bid items must be bid or the bid form may be rejected. I also understand that consideration and awarding a contract will be based upon my past performance and ability to complete the contract based upon equipment and manpower subject to my control.

(bidder's printed name)

(bidder's signature)

Address/Telephone _____

THE WINNING BIDDER MUST COMPLETE THE FORM ON THE REVERSE SIDE
WITHIN 21 DAYS OF SALE AWARD



FOR DEPARTMENT USE ONLY	
Sale or Permit No	
Year:	Type:
Forest Area:	

**TIMBER SALE
VERIFICATION OF WORKER'S DISABILITY
COMPENSATION ACT COMPLIANCE**

As required by Act 317, P.A. 1969 (Worker's Compensation) and Part 525 of Act 451 of 1994, as amended.

VERIFICATION OF WORKER'S DISABILITY COMPENSATION ACT COMPLIANCE

- This verification must be completed and submitted within 21 days of contract award and prior to the issuance of the timber sale contract.
- In addition, if boxes 2B or 2C are checked, then Notice of Exclusion or Certificate of Insurance must be submitted within 21 days of the contract award and prior to the issuance of the timber sale contract.
- All Information must be typed or printed except for written signatures.

Please Check Appropriate Categories:

1. My business is organized as (you **must** check one of the boxes below):
 - A. Sole Proprietorship (individual)
 - B. Partnership
 - C. Corporation
2. You **must** check one of the boxes below:
 - A. I certify that my business is a sole proprietorship and it has no employees but the sole proprietor. I am not subject to the Worker's Compensation Laws.
 - B. I certify that my business has satisfied its obligation to the Worker's Compensation Act through the use of an approved Notice of Exclusion (BWC-337, Rev. 5/96). I will provide a copy of the Notice of Exclusion within 21 days of the contract award. (For questions or a copy of the BWC-337, please call the Worker's Compensation Bureau at 517-322-1195).
 - C. I certify that my business has a Worker's Compensation Policy. I will provide an original Certificate of Insurance within 21 days of the contract award.
3. If you have checked item 2(A) or 2(B), you **must** indicate the number of **both** full and part time employees other than yourself including family members and active partners (if none, you must enter "0").

_____ Full Time Employees

_____ Part Time Employees

Name of Business		Federal ID (or) Social Security No.	
Address		Telephone No. ()	
City	State	Zip + 4	

I hereby certify that the above information is true and correct. I agree to notify the DNR of any changes that occur in factors affecting my coverage during any of my present and future operations.

Signature of Owner or Authorized Representative

Title

Date