



DEPARTMENT OF NATURAL RESOURCES
STATE OF MICHIGAN

TIMBER SALE PROSPECTUS

Notice is hereby given that bids will be received by the Unit Manager, GAYLORD MANAGEMENT UNIT, for certain timber on the following described lands:

FOUR SEASONS HARDWOOD / T33N, R04W, SEC. 13, NE1/4, E1/2NW1/4, N1/2SE & SESE.
CHARLEVOIX COUNTY (Appr. \$17,859.00)

HENDRIX HARDWOODS / T33N, R04W, SEC. 13, N1/2SE, N1/2SW, SENW.
CHARLEVOIX COUNTY (Appr. \$29,881.40)

SALE DATE AND TIME: 3:00 p.m. on December 16, 2009.

GAYLORD

BID INSTRUCTIONS (Ver. 06/23/2008):

1. Bid Location, Date, and Time: Bids must be received by the Unit Manager, Gaylord Management Unit, 1732 West M-32, Gaylord, MI 49735, no later than 3:00 p.m. on December 16, 2009. For further information concerning this sale, contact the Unit Manager at 989-732-3541.
2. Bidder's Qualifications: Purchaser shall obtain workers compensation insurance to cover claims under Michigan's Worker's Disability Compensation Act of 1969 or similar employee benefit act of any other state applicable to an employee. If all or part of a timber sale was prepared by a private contractor, that contractor and that contractor's company are not permitted to bid on the timber sale contract. Bids will not be accepted from individuals or companies appearing on the DNR/FMFM No-Bid List. This list contains the names of purchasers who previously failed to execute a contract within 21-days or who have a history of poor performance.
3. Preparation of Sealed Bids: Bids shall be manually signed in ink; bid prices must be entered for each species and product in the Bid Price column for all material subject to bidding; and all fill-in blanks must be completed. If erasures or other changes appear on the forms, each erasure or change must be initialed by the person signing the bid.
4. Submission of Sealed Bids: Bid forms may be obtained from the Unit Manager. All bids must be submitted on the bid form and in an envelope clearly identified as described in this section. NOTE: Only one bid form per bid envelope. Sealed bids must be submitted to the Unit office designated in the prospectus and must be submitted at or prior to the time established in the prospectus. The envelope should show on the outside (a) that it is a "Bid for Timber," and (b) the sale name or number, and (c) the date and time of bid opening as shown in the prospectus. Bids received after the time specified in the sale prospectus are late bids and will be rejected.
5. Public Opening of Sealed Bids: If conditions permit, the sealed bids will be publicly opened and posted at the time and place set in the prospectus.
6. Award of Contract: Award of the contract will be made to the Bidder whose bid, conforming to the prospectus, is most advantageous to the State of Michigan on the basis of total value at rates bid for the estimated quantities. The State reserves the right to reject any bid or waive any minor irregularity in bids received. A written award mailed (or otherwise furnished) to the successful Bidder shall be deemed to result in a binding contract without further action by either party.
7. Down Payment: The Bidder to whom award is made must make a down payment within 21 days of the sale award. The amount of the down payment will be calculated as shown in the Bond and Payment Schedule of this prospectus. Only cash may be used to meet this requirement.
8. Performance Security: As guarantee of faithful performance, a cash bond, certificate of deposit, surety bond or irrevocable letter of credit (LOC) is required within 21 days of the sale award. The amount of the performance security is shown in the Bond and Payment Schedule of this prospectus. If an LOC or surety is used, the coverage must extend for at least 6 months beyond the contract expiration.
9. Timber Sale Contract: Additional conditions and requirements common to all timber sales are listed on the timber sale contract (R4031) and are available on line at www.michigan.gov/dnr. Contact the Unit Manager for additional information or a sample contract. Within 21 days of the date of the award letter, the bidder must sign the contract and provide the required down payment, performance security, and verification of worker's disability compensation. The down payment and performance security shall be in accordance with the provisions of the timber sale contract, in the sums stated in this prospectus. If these actions are not taken, then the Bidder, the Bidder's corporation, and the corporation's principals may not be permitted to bid on State timber sales for a period of 1 year. In addition, the Bidder certifies that if awarded this contract, the Bidder will complete the timber sale contract in accordance with its terms and any modifications thereof including requirements to purchase, cut, and remove the included timber by the termination date.

10. Disclaimer of Estimates and Bidder's Warranty of Inspection: Before submitting this bid, the Bidder is advised and cautioned to inspect the sale area, review the requirements of the sale contract, and take other steps as may be reasonably necessary to ascertain the location, estimated volumes, construction estimates, and operating costs of the proposed sale. Failure to do so will not relieve the Bidder from responsibility for completing the contract.

The Bidder warrants that this bid is submitted solely on the basis of the Bidder's examination and inspection of the quality and quantity of the timber offered for sale and the Bidder's opinion of the value thereof and the costs of recovery. No reliance should be placed on the State of Michigan's estimates of timber quality, quantity or costs of recovery. Bidder further acknowledges that the State of Michigan: (i) expressly disclaims any warranty of fitness of timber for any purpose; (ii) offers this timber as is without any warranty of quality (merchantability) or quantity and (iii) expressly disclaims any warranty as to the quantity or quality of timber sold.

11. Certification and Chain-of-Custody: Unless otherwise indicated in the contract under section 7 - Other Conditions of the Sale Specific Conditions & Requirements, the area encompassed by this timber sale is certified to the standards of the Forest Stewardship Council (FSC) - Certificate #SCS-FM/COC-090N and the Sustainable Forestry Initiative (SFI) - Certificate # NSF-SFIS-5Y031-S1. Forest products from this sale may be delivered to the mill as "FSC and / or SFI certified" as long as the contractor hauling the forest products is chain-of-custody (COC) certified or covered under a COC certificate from the destination mill. The purchaser is responsible for maintaining COC after leaving the sale area.

REBECCA A. HUMPHRIES
Director

FOUR SEASONS HARDWOOD (002-09-01)

A timber sale contract for this LUMP SUM SEALED timber sale will be awarded the responsible bidder offering the highest sealed bid price. Bids must be at or above the following appraised price for each species:

<u>SPECIES</u>	<u>ESTIMATED VOLUME*</u>	<u>APPRAISED PRICE</u>
SAWLOGS		
SUG. MAPLE	18.00 MBF	\$ 200.00/MBF
WHITE ASH	34.00 MBF	\$ 93.00/MBF
PULPWOOD		
BASSWOOD	702.00 CORDS	\$ 5.50/CORD
MIX HARDWD	630.00 CORDS	\$ 6.15/CORD

In addition, the successful bidder agrees to purchase the following species at the indicated appraised price:

<u>SPECIES</u>	<u>ESTIMATED VOLUME*</u>	<u>APPRAISED PRICE</u>
SAWLOGS		
BASSWOOD	38.00 MBF	\$ 45.00/MBF
BEECH	3.00 MBF	\$ 25.00/MBF
MIX ASPEN	18.00 MBF	\$ 60.00/MBF
PULPWOOD		
MIX ASPEN	30.00 CORDS	\$ 16.55/CORD

*The volumes are statistically estimated within plus (+) or minus (-) 21.12 percent. These estimated volumes are final and not subject to adjustment. Prospective bidders are urged to examine this timber and to make their own estimates of quantity and quality.

BOND AND PAYMENT SCHEDULE:

1. A bond in the amount of \$900.00, to insure faithful performance of the conditions of the contract, will be deposited by the successful bidder within 21 days of the sale award.
2. Cutting in any sale or unit without the required advance payment would be considered a trespass.
3. Total payment may be paid in advance or according to the following schedule:
 - (a) Ten percent (10%) of the sale value must be paid within 21 days of the sale award.
 - (b) The 10% down payment will be credited towards the first unit cut.
 - (c) Payment for each of the following units must be made before cutting begins in that unit:

<u>PAYMENT UNIT NUMBER</u>	<u>PERCENT OF TOTAL SALE VALUE</u>
1	25%
2	25%
3	25%
4	25%
4. If no cutting takes place, the 10% down payment will not be refunded.
5. Operations on the contract issued will terminate on June 30, 2012.



Sale Number	Year
52-002-09-01	2009

Forest Management Unit GAYLORD		County CHARLEVOIX	Mapped By GATESY	Date 12/29/2008	Page 1	of 1
Township 33N	Range 04W	Section(s) and Subdivision(s) 13 NE1/4, E1/2NW1/4 & SESE		Scale ... 4... = 1 mile		

Cover Type				Density	
A = Aspen	G = Grass	O = Oak	U = Upland Brush	0 = Non Stocked	5 = Pole Timber Medium
B = Paper Birch	H = Hemlock	P = Lowland Poplar	V = Bog or Marsh	1 = Seedling Sapling Poor	6 = Pole Timber Well
C = Cedar	J = Jack Pine	Q = Mixed Swamp Cnfr	W = White Pine	2 = Seedling Sapling Medium	7 = Saw Timber Poor
D = Treed Bog	L = Lowland Brush	R = Red Pine	X = Non Stocked	3 = Seedling Sapling Well	8 = Saw Timber Medium
E = Swamp Hdwoods	M = Mpl, Bch, Brch	S = Black Spruce	Z = Water	4 = Pole Timber Poor	9 = Saw Timber Well
F = Spruce Fir	N = Marsh	T = Tamarack			

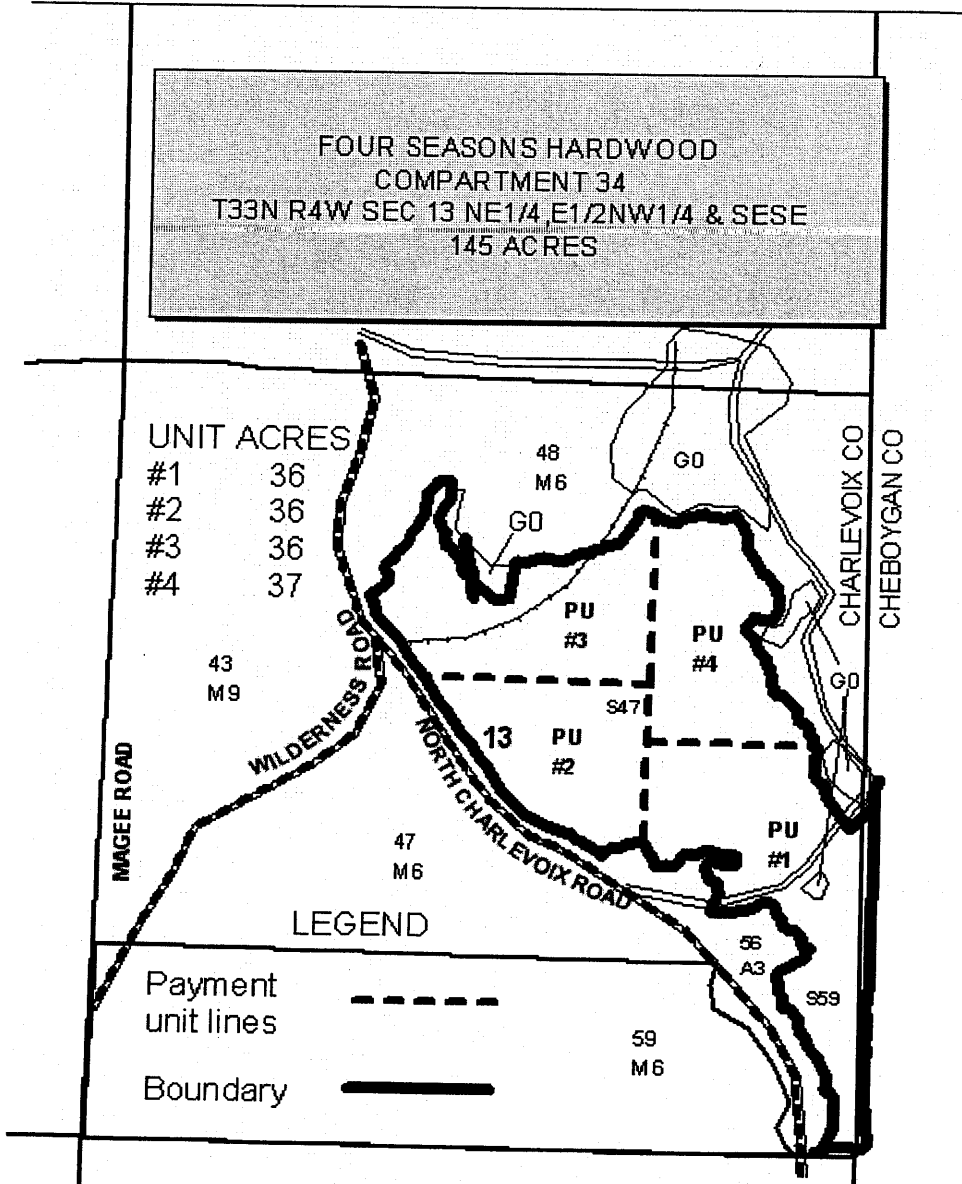
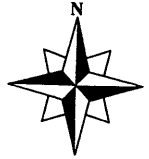

Sale Specific Conditions & Requirements

Sale Name: Four Seasons Hardwood Sale Number: 52-002-09-01

1 - Sale Area

1.2 - Boundaries

1.2.1 - Painted boundaries (6/05)

The sale boundary and Payment Unit boundaries are marked and identified by red and yellow paint. Exterior sale boundary lines against state are marked with red paint. Interior Payment Unit boundaries are marked with yellow paint. Do not cut painted boundary line trees unless also marked with orange paint.

2 - Timber Specifications

2.1 - Included Timber

2.1.3 - Cut tree marked unit(s) (8/04)

Within Payment Unit(s) 1 through 4, all trees are designated for cutting when marked with orange paint above and below stump height, regardless of merchantability.

2.2 - Utilization

2.2.4 - Skidding length (2/04)

Skidding of lengths over 17 feet is not permissible unless approved by the Unit Manager or their representative.

2.2.7 - Uncut designated trees (2/04)

Liquidated damages of \$5.00 per tree will be assessed for every marked tree not cut.

3 - Payments

3.3 - Pre-measured Sales

3.3.1 - Order of cutting (6/04)

Payment Units shall be cut in numerical order unless the sale is paid in full or unless approved by the Unit Manager or their representative.

3.3.2 - One active unit (2/04)

Each Payment Unit must be completed to the satisfaction of the Unit Manager or their representative before the next unit may be opened.

3.3.4 - Dividing payment units (7/05)

Payment unit(s) 1-4 may be divided at the request of the purchaser and upon approval of the Unit Manager. Dividing payment units is a contract modification which requires a Timber Sale Contract Supplement.

3.4 - Damaged Timber

3.4.1 - Damaged timber (6/05)

General Condition and Requirement 3.4 Damaged Timber, defines liquidated damages for undesignated live merchantable trees which are cut or injured. Damage to residual trees (defined as breaking of the cambium layer, broken tops or bending of trees from their natural position) is not acceptable.

No damage is acceptable to merchantable trees. Within the sale area, if more than 5 % of trees (> 4.5" DBH) within a specified area of the sale are damaged, liquidated damages will be assessed for all trees damaged. Rates will be in accordance with General Condition and Requirement 3.4 Damaged Timber.

4 - Transportation

4.1 - Construction

4.1.3 - Slash and earthen piles (8/04)

Piles or windrows of earth along roads and landings that have been widened or constructed shall be leveled. Slash from road maintenance or construction, including stumps, shall be dispersed throughout the sale.

4.1.6 - Road construction (6/07)

Construction of new roads or improvements of existing roads shall be done in such a way as to minimize the environmental and visual impacts. Merchantable trees shall be cut and utilized unless otherwise directed. Non-merchantable trees shall be severed and laid flat on the ground. Slash shall be scattered, and not left in windrows and kept a minimum of 10 feet back from the road edge. Stumps shall be set upright, not left on edge, and be moved at least 10 feet away from the road edge. Disturbed soil shall be feathered into the woods and not left in berms or windrows.

4.1.7 - Road closure (4/07)

All new roads built into the sale must be blocked to vehicle traffic upon completion of the sale. Overgrown roads that are reopened shall be considered new roads. In general, this will require constructing a four (4') foot high berm constructed of stumps and logs covered with earth.

4.2 - Maintenance

4.2.1 - Hauling restriction (3/07)

Hauling may be restricted on forest roads by the Unit Manager or their representative. The restriction may occur during spring breakup or may occur during wet weather conditions.

4.2.5 - Two wheel drive condition (2/04)

All existing trail roads on and adjacent to the sale area must be passable by two-wheel drive traffic for the duration of the sale.

5 - Operations

5.1 - Notification

5.1.1 - Pre-sale conference (2/08)

A pre-sale conference on site between the Purchaser and sale administrator is required prior to beginning any operations to determine landing and road locations. The Unit Manager or their representative must be contacted at least 10 days in advance to schedule the conference.

5.1.4 - Post-sale conference (2/04)

A post-sale conference on site between the Purchaser and sale administrator is required 5 days prior to the completion of active logging operations to determine clean-up and repair of landings, road edges, and the fulfillment of other contract specifications.

5.2 - Conduct of Operations

5.2.1 - Slash

5.2.1.7 - Slash must be scattered (2/04)

Unless otherwise directed, slash and logging debris shall be uniformly scattered over the sale area and not left in piles or windrows. Slash shall not be allowed to accumulate at the landings. All slash work shall be done concurrently with harvesting.

5.2.1.8 - Slash height (2/04)

No slash or tree tops may exceed 24 inches in height. One top over 24 inches in height per acre may be left for migratory song bird perches.

5.2.1.10 - No slash in openings (7/07)

No brush or logging debris is to be left in any opening. Any damage to the opening shall be repaired according to specifications of the Unit Manager or their representative.

5.2.2 - Hazard Trees/Snags

5.2.2.1 - Den trees (2/04)

Obvious hollow and/or den trees shall be protected and left standing unless they are a safety hazard.

5.2.3 - Operating Restrictions

5.2.3.9 - Beech hauling restriction (9/08)

American beech wood products with bark still attached, other than chips, are not to be transported from stands infested with beech bark disease to or through uninfested beech areas from July 15 to November 15. Beech scale is mobile at this time of year and can move from infested wood to live beech. (See Map of current beech scale distribution on the DNR Forest Health Website, www.michigan.gov/dnr.)

5.2.12 - Bark slippage restriction (3/07)

Within Payment Unit(s) 1 through 4, unless changed by written agreement, cutting, skidding, and hauling are not permitted during the period of April 15 to July 15. This restriction is because of bark slippage.

5.2.30 - Landing/road top soil protection (5/04)

Top soil at landings and new roads must be stockpiled and saved. Upon completion of the timber sale, soil must be evenly distributed over the area to be re-vegetated. In addition, the area must be seeded and mulched per instructions of the sale administrator.

5.2.32 - Decking/landing restoration (2/04)

All decking and landing areas must have the surface area restored to a condition equal to or better than before. This is to insure the proper regeneration of the stand.

5.2.38 - No decking against live trees (2/04)

Cut products may not be decked against unmarked or designated leave trees.

5.2.43 - Opening protection (5/04)

No activities are permitted in openings marked on the timber sale map with the letter "G". Any damage to the openings shall be repaired according to specifications of the Unit Manager or their representative.

5.4 - Soil Protection

5.4.1 - Rutting restriction, general (12/08)

Operations are to cease immediately if equipment and weather conditions result in rutting of roads which is 12 inches or greater in depth and 50 feet in length. In addition, operations are to cease immediately if equipment and weather conditions result in rutting on skid trails which is 12 inches or greater in depth and 50 feet in length. The Unit Manager or their representative may restrict hauling and/or skidding if ruts exceed the specified depth. With the Unit Manager or their representative's approval, the Purchaser may return to the area when the weather conditions have changed and/or the risk of rutting has decreased.

5.4.2 - Skid trails (2/04)

Skid trails up and down slopes should be avoided. If however this is unavoidable, these trails will be left in a non-erodible condition using water bars, logs, and slash. Placing of slash on these skid trails while logging is ongoing may alleviate need for any further action. At the direction of the sale administrator, seed, fertilizer, and mulch may also be required.

5.8 - Protection of Endangered Species

5.8.3 - Red shoulder hawk (1) (3/07)

In the event that an active red shoulder hawk nest is found, the contract may be amended to protect the nest site. The harvesting time may be altered or reduced. Harvest operations may be limited to September 1 to March 1. This limitation may be selectively imposed on a specific portion of the sale, or it could apply to the entire sale. In addition, an area surrounding the nest tree could be designated as a "no-cut" zone with appropriate adjustments made to the timber sale value.

6 - Safety and Fire Prevention

6.2 - Signing

6.2.1 - Road posting (9/08)

The purchaser is responsible for posting and maintaining caution signs on Wilderness and North Charlevoix Roads prior to beginning operations. The road must be posted at appropriate distances from the sale area to warn of logging activity and truck traffic. Signs must be removed when harvest operations are suspended or completed. The Purchaser will provide these signs for use on State-owned land.

HENDRIX HARDWOODS (040-08-01)

A timber sale contract for this LUMP SUM SEALED timber sale will be awarded the responsible bidder offering the highest sealed bid price. Bids must be at or above the following appraised price for each species:

<u>SPECIES</u>	<u>ESTIMATED VOLUME*</u>	<u>APPRAISED PRICE</u>
SAWLOGS		
SUG. MAPLE	61.00 MBF	\$ 275.00/MBF
WHITE ASH	37.00 MBF	\$ 122.00/MBF
PULPWOOD		
MIX HARDWD	798.00 CORDS	\$ 8.20/CORD

In addition, the successful bidder agrees to purchase the following species at the indicated appraised price:

<u>SPECIES</u>	<u>ESTIMATED VOLUME*</u>	<u>APPRAISED PRICE</u>
SAWLOGS		
BASSWOOD	20.00 MBF	\$ 53.00/MBF
PULPWOOD		
BASSWOOD	192.00 CORDS	\$ 5.15/CORD

*The volumes are statistically estimated within plus (+) or minus (-) 12.94 percent. These estimated volumes are final and not subject to adjustment. Prospective bidders are urged to examine this timber and to make their own estimates of quantity and quality.

BOND AND PAYMENT SCHEDULE:

1. A bond in the amount of \$1,500.00, to insure faithful performance of the conditions of the contract, will be deposited by the successful bidder within 21 days of the sale award.
2. Cutting in any sale or unit without the required advance payment would be considered a trespass.
3. Total payment may be paid in advance or according to the following schedule:
 - (a) Ten percent (10%) of the sale value must be paid within 21 days of the sale award.
 - (b) The 10% down payment will be credited towards the first unit cut.
 - (c) Payment for each of the following units must be made before cutting begins in that unit:

<u>PAYMENT UNIT NUMBER</u>	<u>PERCENT OF TOTAL SALE VALUE</u>
1	40%
2	60%

4. If no cutting takes place, the 10% down payment will not be refunded.
5. Operations on the contract issued will terminate on June 30, 2013.



Forest Management Unit GAYLORD		County CHARLEVOIX	Mapped By BIELECKI	Date 9/30/08	Page 1	of 1
Township 33N	Range 4W	Section(s) and Subdivision(s) 13 N¹/₂SE, N¹/₂SW, SENW				

Cover Type				Density	
A = Aspen	G = Grass	O = Oak	U = Upland Brush	0 = Non Stocked	5 = Pole Timber Medium
B = Paper Birch	H = Hemlock	P = Lowland Poplar	V = Bog or Marsh	1 = Seedling Sapling Poor	6 = Pole Timber Well
C = Cedar	J = Jack Pine	Q = Mixed Swamp Cnfr	W = White Pine	2 = Seedling Sapling Medium	7 = Saw Timber Poor
D = Treed Bog	L = Lowland Brush	R = Red Pine	X = Non Stocked	3 = Seedling Sapling Well	8 = Saw Timber Medium
E = Swamp Hdwoods	M = Mpl, Bch, Brch	S = Black Spruce	Z = Water	4 = Pole Timber Poor	9 = Saw Timber Well
F = Spruce Fir	N = Marsh	T = Tamarack			

"HENDRIX HARDWOODS"

8.6 ACRES

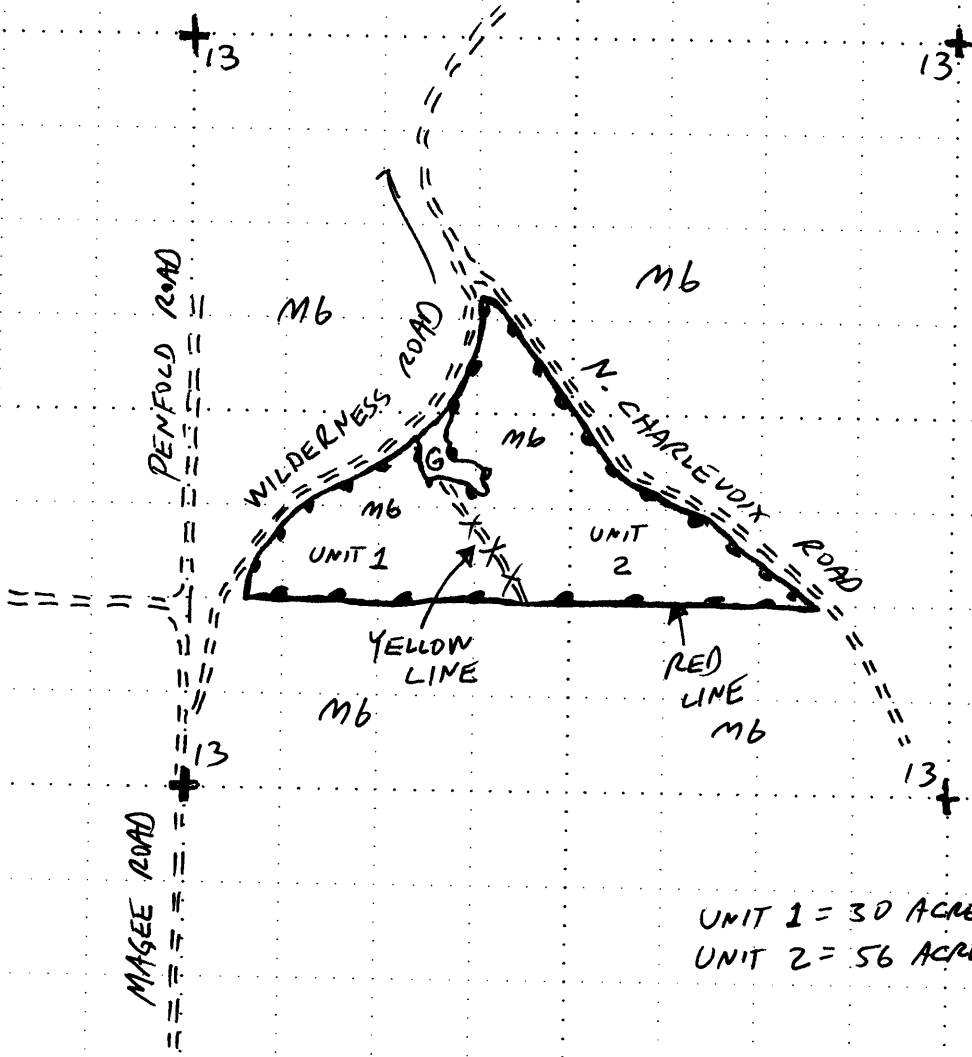

UNIT 1 = 30 ACRES
 UNIT 2 = 56 ACRES

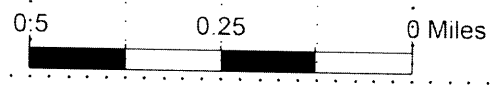

Sale Specific Conditions & Requirements

Sale Name: Hendrix Hardwoods Sale Number: 52-040-08-01

1 - Sale Area

1.2 - Boundaries

1.2.1 - Painted boundaries (12/08)

The sale boundary and Payment Unit boundaries are marked and identified by red and yellow paint. Exterior sale boundary lines against state are marked with red paint. Interior Payment Unit boundaries are marked with yellow paint. Do not cut painted boundary line trees unless also marked with orange paint.

2 - Timber Specifications

2.1 - Included Timber

2.1.3 - Cut tree marked unit(s) (8/04)

Within Payment Unit(s) 1 and 2, all trees are designated for cutting when marked with orange paint above and below stump height, regardless of merchantability.

2.2 - Utilization

2.2.6 - Roundwood operation required (5/07)

The skidding of whole trees or tree segments with limbs attached is prohibited. All products must be produced as roundwood and forwarded to existing roads or landing areas in final product length.

3 - Payments

3.3 - Pre-measured Sales

3.3.4 - Dividing payment units (7/05)

Payment unit(s) 1 and 2, may be divided at the request of the purchaser and upon approval of the Unit Manager. Dividing payment units is a contract modification which requires a Timber Sale Contract Supplement.

3.4 - Damaged Timber

3.4.1 - Damaged timber (6/05)

General Condition and Requirement 3.4 Damaged Timber, defines liquidated damages for undesignated live merchantable trees which are cut or injured. Damage to residual trees (defined as breaking of the cambium layer, broken tops or bending of trees from their natural position) is not acceptable.

4 - Transportation

4.1 - Construction

4.1.4 - Timber removed for construction (2/04)

Trees cut or damaged in the process of a pre-approved road, landing or skid trail construction will be decked in an area separate from wood removed from the timber sale until such time as it is scaled and paid for.

4.1.6 - Road construction (6/07)

Construction of new roads or improvements of existing roads shall be done in such a way as to minimize the environmental and visual impacts. Merchantable trees shall be cut and utilized unless otherwise directed.

Non-merchantable trees shall be severed and laid flat on the ground. Slash shall be scattered, and not left in windrows and kept a minimum of 10 feet back from the road edge. Stumps shall be set upright, not left on edge, and be moved at least 10 feet away from the road edge. Disturbed soil shall be feathered into the woods and not left in berms or windrows.

4.1.7 - Road closure (4/07)

All new roads built into the sale must be blocked to vehicle traffic upon completion of the sale. Overgrown roads that are reopened shall be considered new roads. In general, this will require constructing a four (4') foot high berm constructed of stumps and logs covered with earth.

4.2 - Maintenance

4.2.1 - Hauling restriction (3/07)

Hauling may be restricted on forest roads by the Unit Manager or their representative. The restriction may occur during spring breakup, or during wet weather conditions.

4.2.5 - Two wheel drive condition (2/04)

All existing trail roads on and adjacent to the sale area must be passable by two-wheel drive traffic for the duration of the sale.

5 - Operations

5.1 - Notification

5.1.1 - Pre-sale conference (2/08)

A pre-sale conference on site between the Purchaser and sale administrator is required prior to beginning any operations to determine landing and road locations.

5.1.4 - Post-sale conference (2/04)

A post-sale conference on site between the Purchaser and sale administrator is required 5 days prior to the completion of active logging operations to determine clean-up and repair of landings, road edges, and the fulfillment of other contract specifications.

5.2 - Conduct of Operations

5.2.1 - Slash

5.2.1.2 - Slash Removal

All slash must be removed at least 50 feet from the cleared right-of-way of Wilderness and North Charlevoix roads.

5.2.1.7 - Slash must be scattered (2/04)

Unless otherwise directed, slash and logging debris shall be uniformly scattered over the sale area and not left in piles or windrows. Slash shall not be allowed to accumulate at the landings. All slash work shall be done concurrently with harvesting.

5.2.1.10 - No slash in openings (7/07)

No brush or logging debris is to be left in the wildlife opening. Any damage to the opening shall be repaired according to specifications of the Unit Manager or their representative.

5.2.2 - Hazard Trees/Snags

5.2.2.1 - Den trees (2/04)

Obvious hollow and/or den trees shall be protected and left standing unless they are a safety hazard.

5.2.12 - Bark slippage restriction (3/07)

Within Payment Unit(s) 1 and 2, unless changed by written agreement, cutting, skidding, and hauling are not permitted during the period of April 15 to July 15. This restriction is because of bark slippage.

5.2.38 - No decking against live trees (2/04)

Cut products may not be decked against unmarked or designated leave trees.

5.2.43 - Opening protection (5/04)

No activities are permitted in openings marked on the timber sale map with the letter "G". Any damage to the openings shall be repaired according to specifications of the Unit Manager or their representative.

5.4 - Soil Protection

5.4.1 - Rutting restriction, general (5/08)

Operations are to cease immediately if equipment and weather conditions result in rutting of roads which is 12 inches or greater in depth and 50 feet in length. In addition, operations are to cease immediately if equipment and weather conditions result in rutting on skid trails which is 12 inches or greater in depth and 50 feet in length. The Unit Manager or their representative may restrict hauling and/or skidding if ruts exceed the specified depth. With the Unit Manager or their representative's approval, the Purchaser may return to the area when the weather conditions have changed and/or the risk of rutting has decreased.

5.8 - Protection of Endangered Species

5.8.3 - Red shoulder hawk (1) (3/07)

In the event that an active red shoulder hawk nest is found, the contract may be amended to protect the nest site. The harvesting time may be altered or reduced. Harvest operations may be limited to September 1 to March 1. This limitation may be selectively imposed on a specific portion of the sale, or it could apply to the entire sale. In addition, an area surrounding the nest tree could be designated as a "no-cut" zone with appropriate adjustments made to the timber sale value.

5.8.5 - Protection of raptor nests (9/05)

All trees with raptor nests will be protected if found during harvesting operations. Notification will be made to the Unit Manager and Wildlife Biologist so an on-site evaluation and recommendation can be made, if necessary.

6 - Safety and Fire Prevention

6.2 - Signing

6.2.1 - Road posting (9/08)

The purchaser is responsible for posting and maintaining caution signs on both Wilderness and North Charlevoix roads prior to beginning operations. The road must be posted at appropriate distances from the sale area to warn of logging activity and truck traffic. Signs must be removed when harvest operations are suspended or completed. The Purchaser will provide these signs for use on State-owned land.

7 - Other Conditions

7.3 - Contract Modifications

7.3.1 - Emerald Ash Borer

7.3.1.2 - Emerald ash borer, ash or firewood on sale (2/05)

There is ash and/or "firewood" in this sale and it is located within an emerald ash borer quarantined area. The Director of the Michigan Department of Agriculture (MDA) by the authority of Act No. 72 of the Public Acts of 1945, as amended, and Quarantine Regulation No. 620, has promulgated this quarantine to prevent the further spread of this pest and sets forth: definitions, regulated articles, regulated areas, conditions of movement, violations and penalties, and special exemptions. The purchaser must comply with this quarantine. Contact the MDA for further information.

FOUR SEASONS HARDWOOD (002-09-01)
 T33N, R04W, SEC. 13, NE1/4, E1/2NW1/4, N1/2SE & SESE.
 CHARLEVOIX COUNTY

In response to the notice of sale to be held 3:00 p.m. on December 16, 2009, I am hereby submitting my sealed bid (firm offer) for the following forest products to be cut. Bids for individual species and total bid value must be at or above the appraised price. All non-responsive bid forms may be rejected.

<u>SPECIES</u>	<u>APPRAISED PRICE</u>	<u>BID PRICE</u>	<u>ESTIMATED VOLUME*</u>	<u>= VALUE</u>
<u>SAWLOGS</u>				
SUG. MAPLE	\$ 200.00/MBF	\$ _____ X	18.00 MBF	= \$ _____
WHITE ASH	\$ 93.00/MBF	\$ _____ X	34.00 MBF	= \$ _____
<u>PULPWOOD</u>				
BASSWOOD	\$ 5.50/CORD	\$ _____ X	702.00 CORDS	= \$ _____
MIX HARDWD	\$ 6.15/CORD	\$ _____ X	630.00 CORDS	= \$ _____
SUBTOTAL 1				\$ _____

In addition, the successful bidder agrees to purchase the following species at the appraised price:

<u>SPECIES</u>	<u>APPRAISED PRICE</u>	<u>ESTIMATED VOLUME*</u>	<u>VALUE</u>
<u>SAWLOGS</u>			
BASSWOOD	\$ 45.00/MBF	38.00 MBF	= \$ 1,710.00
BEECH	\$ 25.00/MBF	3.00 MBF	= \$ 75.00
MIX ASPEN	\$ 60.00/MBF	18.00 MBF	= \$ 1,080.00
<u>PULPWOOD</u>			
MIX ASPEN	\$ 16.55/CORD	30.00 CORDS	= \$ 496.50
SUBTOTAL 2			\$ <u>3,361.50</u>
SUBTOTAL 1 + SUBTOTAL 2 = TOTAL BID VALUE \$ _____			

*These volumes are statistically estimated within plus (+) or minus (-) 21.12%. These estimated volumes are final and not subject to adjustment. Prospective bidders are urged to examine this timber and to make their own estimates of quantity and quality.

I understand that any or all bids may be rejected, and that the individual unit bid price will be the basis to determine total bid value. All bids must be signed and all bid items must be bid or the bid form may be rejected. I also understand that consideration and awarding a contract will be based upon my past performance and ability to complete the contract based upon equipment and manpower subject to my control.

 (bidder's printed name)

 (bidder's signature)

Address/Telephone _____

THE WINNING BIDDER MUST COMPLETE THE FORM ON THE REVERSE SIDE
 WITHIN 21 DAYS OF SALE AWARD



FOR DEPARTMENT USE ONLY

**TIMBER SALE
VERIFICATION OF WORKER'S DISABILITY
COMPENSATION ACT COMPLIANCE**

*As required by Act 317, P.A. 1969 (Worker's Compensation) and Part 525
of Act 451 of 1994, as amended.*

Sale or Permit No

Year:

Type:

Forest Area:

VERIFICATION OF WORKER'S DISABILITY COMPENSATION ACT COMPLIANCE

- This verification must be completed and submitted within 21 days of contract award and prior to the issuance of the timber sale contract.
- In addition, if boxes 2B or 2C are checked, then Notice of Exclusion or Certificate of Insurance must be submitted within 21 days of the contract award and prior to the issuance of the timber sale contract.
- All Information must be typed or printed except for written signatures.

Please Check Appropriate Categories:

1. My business is organized as (you **must** check one of the boxes below):

- A. Sole Proprietorship (individual)
- B. Partnership
- C. Corporation

2. You **must** check one of the boxes below:

- A. I certify that my business is a sole proprietorship and it has no employees but the sole proprietor. I am not subject to the Worker's Compensation Laws.
- B. I certify that my business has satisfied its obligation to the Worker's Compensation Act through the use of an approved Notice of Exclusion (BWC-337, Rev. 5/96). I will provide a copy of the Notice of Exclusion within 21 days of the contract award. (For questions or a copy of the BWC-337, please call the Worker's Compensation Bureau at 517-322-1195).
- C. I certify that my business has a Worker's Compensation Policy. I will provide an original Certificate of Insurance within 21 days of the contract award.

3. If you have checked item 2(A) or 2(B), you **must** indicate the number of **both** full and part time employees other than yourself including family members and active partners (if none, you must enter "0").

_____ Full Time Employees

_____ Part Time Employees

Name of Business		Federal ID (or) Social Security No.	
Address		Telephone No. ()	
City	State	Zip + 4	

I hereby certify that the above information is true and correct. I agree to notify the DNR of any changes that occur in factors affecting my coverage during any of my present and future operations.

Signature of Owner or Authorized Representative

Title

Date

HENDRIX HARDWOODS (040-08-01)
 T33N, R04W, SEC. 13, N1/2SE, N1/2SW, SENW.
 CHARLEVOIX COUNTY

In response to the notice of sale to be held 3:00 p.m. on December 16, 2009, I am hereby submitting my sealed bid (firm offer) for the following forest products to be cut. Bids for individual species and total bid value must be at or above the appraised price. All non-responsive bid forms may be rejected.

<u>SPECIES</u>	<u>APPRAISED PRICE</u>	<u>BID PRICE</u>	<u>ESTIMATED VOLUME*</u>	<u>= VALUE</u>
<u>SAWLOGS</u>				
SUG. MAPLE	\$ 275.00/MBF	\$ _____ X	61.00 MBF	= \$ _____
WHITE ASH	\$ 122.00/MBF	\$ _____ X	37.00 MBF	= \$ _____
<u>PULPWOOD</u>				
MIX HARDWD	\$ 8.20/CORD	\$ _____ X	798.00 CORDS	= \$ _____
SUBTOTAL 1				\$ _____

In addition, the successful bidder agrees to purchase the following species at the appraised price:

<u>SPECIES</u>	<u>APPRAISED PRICE</u>	<u>ESTIMATED VOLUME*</u>	<u>VALUE</u>
<u>SAWLOGS</u>			
BASSWOOD	\$ 53.00/MBF	20.00 MBF	= \$ 1,060.00
<u>PULPWOOD</u>			
BASSWOOD	\$ 5.15/CORD	192.00 CORDS	= \$ 988.80
SUBTOTAL 2			\$ 2,048.80
SUBTOTAL 1 + SUBTOTAL 2 = TOTAL BID VALUE \$ _____			

*These volumes are statistically estimated within plus (+) or minus (-) 12.94%. These estimated volumes are final and not subject to adjustment. Prospective bidders are urged to examine this timber and to make their own estimates of quantity and quality.

I understand that any or all bids may be rejected, and that the individual unit bid price will be the basis to determine total bid value. All bids must be signed and all bid items must be bid or the bid form may be rejected. I also understand that consideration and awarding a contract will be based upon my past performance and ability to complete the contract based upon equipment and manpower subject to my control.

 (bidder's printed name)

 (bidder's signature)

Address/Telephone _____

THE WINNING BIDDER MUST COMPLETE THE FORM ON THE REVERSE SIDE
 WITHIN 21 DAYS OF SALE AWARD



**TIMBER SALE
VERIFICATION OF WORKER'S DISABILITY
COMPENSATION ACT COMPLIANCE**

*As required by Act 317, P.A. 1969 (Worker's Compensation) and Part 525
of Act 451 of 1994, as amended.*

FOR DEPARTMENT USE ONLY	
Sale or Permit No	
Year:	Type:
Forest Area:	

VERIFICATION OF WORKER'S DISABILITY COMPENSATION ACT COMPLIANCE

- This verification must be completed and submitted within 21 days of contract award and prior to the issuance of the timber sale contract.
- In addition, if boxes 2B or 2C are checked, then Notice of Exclusion or Certificate of Insurance must be submitted within 21 days of the contract award and prior to the issuance of the timber sale contract.
- All information must be typed or printed except for written signatures.

Please Check Appropriate Categories:

1. My business is organized as (you **must** check one of the boxes below):

- A. Sole Proprietorship (individual)
- B. Partnership
- C. Corporation

2. You **must** check one of the boxes below:

- A. I certify that my business is a sole proprietorship and it has no employees but the sole proprietor. I am not subject to the Worker's Compensation Laws.
- B. I certify that my business has satisfied its obligation to the Worker's Compensation Act through the use of an approved Notice of Exclusion (BWC-337, Rev. 5/96). I will provide a copy of the Notice of Exclusion within 21 days of the contract award. (For questions or a copy of the BWC-337, please call the Worker's Compensation Bureau at 517-322-1195).
- C. I certify that my business has a Worker's Compensation Policy. I will provide an original Certificate of Insurance within 21 days of the contract award.

3. If you have checked item 2(A) or 2(B), you **must** indicate the number of **both** full and part time employees other than yourself including family members and active partners (if none, you must enter "0").

_____ Full Time Employees

_____ Part Time Employees

Name of Business		Federal ID (or) Social Security No.	
Address		Telephone No. ()	
City	State	Zip + 4	

I hereby certify that the above information is true and correct. I agree to notify the DNR of any changes that occur in factors affecting my coverage during any of my present and future operations.

Signature of Owner or Authorized Representative

Title

Date