



DEPARTMENT OF NATURAL RESOURCES  
STATE OF MICHIGAN

TIMBER SALE PROSPECTUS

Notice is hereby given that bids will be received by the Unit Manager, GLADWIN MANAGEMENT UNIT, for certain timber on the following described lands:

HARRISON AVE HARVEST / T20N, R04W, SEC. 31, NE1/4, NWSE, SWSE, NESW, SENW, NENW.  
T20N, R04W, SEC. 32, SWNW, NWSW.  
CLARE COUNTY (Appr. \$31,334.70)

HASKEL LAKE HARVEST / T20N, R05W, SEC. 24, NENW, SENW, SWNE.  
CLARE COUNTY (Appr. \$19,533.60)

-----

SALE DATE AND TIME: 2:00 p.m. on January 20, 2010.

**GLADWIN**



BID INSTRUCTIONS (Ver. 06/23/2008):

1. Bid Location, Date, and Time: Bids must be received by the Unit Manager, Gladwin Management Unit, 801 N. Silverleaf, Gladwin, MI 48624, no later than 2:00 p.m. on January 20, 2010. For further information concerning this sale, contact the Unit Manager at 989-426-9205
2. Bidder's Qualifications: Purchaser shall obtain workers compensation insurance to cover claims under Michigan's Worker's Disability Compensation Act of 1969 or similar employee benefit act of any other state applicable to an employee. If all or part of a timber sale was prepared by a private contractor, that contractor and that contractor's company are not permitted to bid on the timber sale contract. Bids will not be accepted from individuals or companies appearing on the DNR/FMFM No-Bid List. This list contains the names of purchasers who previously failed to execute a contract within 21-days or who have a history of poor performance.
3. Preparation of Sealed Bids: Bids shall be manually signed in ink; bid prices must be entered for each species and product in the Bid Price column for all material subject to bidding; and all fill-in blanks must be completed. If erasures or other changes appear on the forms, each erasure or change must be initialed by the person signing the bid.
4. Submission of Sealed Bids: Bid forms may be obtained from the Unit Manager. All bids must be submitted on the bid form and in an envelope clearly identified as described in this section. NOTE: Only one bid form per bid envelope. Sealed bids must be submitted to the Unit office designated in the prospectus and must be submitted at or prior to the time established in the prospectus. The envelope should show on the outside (a) that it is a "Bid for Timber," and (b) the sale name or number, and (c) the date and time of bid opening as shown in the prospectus. Bids received after the time specified in the sale prospectus are late bids and will be rejected.
5. Public Opening of Sealed Bids: If conditions permit, the sealed bids will be publicly opened and posted at the time and place set in the prospectus.
6. Award of Contract: Award of the contract will be made to the Bidder whose bid, conforming to the prospectus, is most advantageous to the State of Michigan on the basis of total value at rates bid for the estimated quantities. The State reserves the right to reject any bid or waive any minor irregularity in bids received. A written award mailed (or otherwise furnished) to the successful Bidder shall be deemed to result in a binding contract without further action by either party.
7. Down Payment: The Bidder to whom award is made must make a down payment within 21 days of the sale award. The amount of the down payment will be calculated as shown in the Bond and Payment Schedule of this prospectus. Only cash may be used to meet this requirement.
8. Performance Security: As guarantee of faithful performance, a cash bond, certificate of deposit, surety bond or irrevocable letter of credit (LOC) is required within 21 days of the sale award. The amount of the performance security is shown in the Bond and Payment Schedule of this prospectus. If an LOC or surety is used, the coverage must extend for at least 6 months beyond the contract expiration.
9. Timber Sale Contract: Additional conditions and requirements common to all timber sales are listed on the timber sale contract (R4031) and are available on line at [www.michigan.gov/dnr](http://www.michigan.gov/dnr). Contact the Unit Manager for additional information or a sample contract. Within 21 days of the date of the award letter, the bidder must sign the contract and provide the required down payment, performance security, and verification of worker's disability compensation. The down payment and performance security shall be in accordance with the provisions of the timber sale contract, in the sums stated in this prospectus. If these actions are not taken, then the Bidder, the Bidder's corporation, and the corporation's principals may not be permitted to bid on State timber sales for a period of 1 year. In addition, the Bidder certifies that if awarded this contract, the Bidder will complete the timber sale contract in accordance with its terms and any modifications thereof including requirements to purchase, cut, and remove the included timber by the termination date.

10. Disclaimer of Estimates and Bidder's Warranty of Inspection: Before submitting this bid, the Bidder is advised and cautioned to inspect the sale area, review the requirements of the sale contract, and take other steps as may be reasonably necessary to ascertain the location, estimated volumes, construction estimates, and operating costs of the proposed sale. Failure to do so will not relieve the Bidder from responsibility for completing the contract.

The Bidder warrants that this bid is submitted solely on the basis of the Bidder's examination and inspection of the quality and quantity of the timber offered for sale and the Bidder's opinion of the value thereof and the costs of recovery. No reliance should be placed on the State of Michigan's estimates of timber quality, quantity or costs of recovery. Bidder further acknowledges that the State of Michigan: (i) expressly disclaims any warranty of fitness of timber for any purpose; (ii) offers this timber as is without any warranty of quality (merchantability) or quantity and (iii) expressly disclaims any warranty as to the quantity or quality of timber sold.

11. Certification and Chain-of-Custody: Unless otherwise indicated in the contract under section 7 - Other Conditions of the Sale Specific Conditions & Requirements, the area encompassed by this timber sale is certified to the standards of the Forest Stewardship Council (FSC) - Certificate #SCS-FM/COC-090N and the Sustainable Forestry Initiative (SFI) - Certificate # NSF-SFIS-5Y031-S1. Forest products from this sale may be delivered to the mill as "FSC and / or SFI certified" as long as the contractor hauling the forest products is chain-of-custody (COC) certified or covered under a COC certificate from the destination mill. The purchaser is responsible for maintaining COC after leaving the sale area.

REBECCA A. HUMPHRIES  
Director

HARRISON AVE HARVEST (028-08-01)

A timber sale contract for this LUMP SUM SEALED timber sale will be awarded the responsible bidder offering the highest sealed bid price. Bids must be at or above the following appraised price for each species:

<u>SPECIES</u>	<u>ESTIMATED VOLUME*</u>	<u>APPRAISED PRICE</u>
SAWLOGS		
RED PINE	26.00 MBF	\$ 132.00/MBF
JACK PINE	119.00 MBF	\$ 47.00/MBF
MIXED OAK	41.50 MBF	\$ 95.00/MBF
PULPWOOD		
JACK PINE	1,338.00 CORDS	\$ 10.00/CORD

In addition, the successful bidder agrees to purchase the following species at the indicated appraised price:

<u>SPECIES</u>	<u>ESTIMATED VOLUME*</u>	<u>APPRAISED PRICE</u>
SAWLOGS		
RED MAPLE	2.50 MBF	\$ 101.00/MBF
BLK CHERRY	11.00 MBF	\$ 61.00/MBF
MIX ASPEN	17.00 MBF	\$ 39.00/MBF
PULPWOOD		
RED MAPLE	23.00 CORDS	\$ 7.30/CORD
RED PINE	21.00 CORDS	\$ 30.70/CORD
BLK CHERRY	72.00 CORDS	\$ 5.00/CORD
MIXED OAK	133.00 CORDS	\$ 10.20/CORD
MIX ASPEN	83.00 CORDS	\$ 10.50/CORD

\*The volumes are statistically estimated within plus (+) or minus (-) 8.04 percent. These estimated volumes are final and not subject to adjustment. Prospective bidders are urged to examine this timber and to make their own estimates of quantity and quality.

BOND AND PAYMENT SCHEDULE:

1. A bond in the amount of \$2,000.00, to insure faithful performance of the conditions of the contract, will be deposited by the successful bidder within 21 days of the sale award.
2. Cutting in any sale or unit without the required advance payment would be considered a trespass.
3. Total payment may be paid in advance or according to the following schedule:
  - (a) Ten percent (10%) of the sale value must be paid within 21 days of the sale award.
  - (b) The 10% down payment will be credited towards the first unit cut.
  - (c) Payment for each of the following units must be made before cutting begins in that unit:

<u>PAYMENT UNIT NUMBER</u>	<u>PERCENT OF TOTAL SALE VALUE</u>
1	05%
2	17%
3	22%
4	16%
5	15%
6	25%

4. If no cutting takes place, the 10% down payment will not be refunded.
5. Operations on the contract issued will terminate on March 31, 2013.



## Sale Specific Conditions & Requirements

**Sale Name: Harrison Ave Harvest    Sale Number: 73-028-08-01**

### 1 - Sale Area

#### 1.2 - Boundaries

##### 1.2.1 - Painted boundaries (6/05)

The sale boundary and Payment Unit boundaries are marked and identified by blue, red and yellow paint. Exterior sale boundary lines against private property are marked with blue paint. Exterior sale boundary lines against state are marked with red paint. Interior Payment Unit boundaries are marked with yellow paint.

### 2 - Timber Specifications

#### 2.1 - Included Timber

##### 2.1.1 - Clearcut unit(s) with unmerchantable trees (2/04)

Within Payment Unit(s) 1 - 6, cut all trees that are two (2) inches or more in diameter measured at a point of four and one-half (4-1/2) feet above ground level regardless of merchantability.

EXCEPTION: Within All Units, do not cut or damage any green painted trees.

EXCEPTION: Within Unit 1, do not cut or damage any red pine trees that are ten (10") inches or less in diameter measured at a point four and one-half (4-1/2) feet above ground level.

EXCEPTION: Within Units 2 and 6, do not cut or damage any white pine or oak trees that are six (6") inches or less in diameter measured at a point four and one-half (4-1/2) feet above ground level.

EXCEPTION: Within Unit 3, do not cut or damage any white oak, white pine, red pine or jack pine trees that are ten (10") inches or less in diameter measured at a point four and one-half (4-1/2) feet above ground level.

EXCEPTION: Within Units 4 and 5, do not cut or damage any white pine, red pine or oak trees that are six (6") inches or less in diameter measured at a point four and one-half (4-1/2) feet above ground level.

### 3 - Payments

#### 3.4 - Damaged Timber

**3.4.1 - Damaged timber (6/05)**

General Condition and Requirement 3.4 Damaged Timber, defines liquidated damages for undesignated live merchantable trees which are cut or injured. In addition, extreme care should be taken to avoid damage to tree seedlings and saplings. Damage to residual trees (defined as breaking of the cambium layer, broken tops or bending of trees from their natural position) is not acceptable.

Within the sale area, if more than 25% of the tree seedlings or saplings (1/4" to 4.5" DBH) within a specified portion of the sale area are damaged, liquidated damages will be assessed at \$300.00 dollars per acre for all acreage within that specified portion of the sale area that was damaged.

No damage is acceptable to merchantable trees. Within the sale area, if more than 5% of trees (> 4.5" DBH) within a specified area of the sale are damaged, liquidated damages will be assessed for all trees damaged. Rates will be in accordance with General Condition and Requirement 3.4 Damaged Timber.

**4 - Transportation**

**4.1 - Construction**

**4.1.7 - Road closure (4/07)**

All new roads built into the sale must be blocked to vehicle traffic upon completion of the sale. One existing road is to be closed, see the timber sale map for location. Overgrown roads that are reopened shall be considered new roads. In general, this will require constructing double earthen berms at strategic locations. Berms are to be four (4') foot high and constructed of stumps and logs covered with earth. Stumps and brush must be placed along the remainder of the trail. Contact the sale administrator for specific details of design and placement.

**5 - Operations**

**5.2 - Conduct of Operations**

**5.2.1 - Slash**

**5.2.1.1 - Slash within sale area (2/04)**

No trees are to be felled outside the sale area and all slash is to be kept at least 20 feet back from the blue paint line.

**5.2.1.2 - Slash Removal**

**5.2.1.2.1 - Slash removal, right-of-way (12/04)**

All slash must be removed at least 50 feet from the cleared right-of-way of Harrison Ave, Canter Trail, Forest Road and the Fur Farm Snowmobile Trail.

**5.2.1.11 - Slash for reforestation (5/07)**

To facilitate reforestation, the entire sale area shall be left with slash evenly distributed. Bunched tops within the cutting area shall be broken up and scattered. Stumps shall be cut low to the ground. Processing sites shall not be left with a compacted layer of slash; tops from these sites shall be hauled back into the cut area and scattered.



**5.2.2 - Hazard Trees/Snags**

5.2.2.1 - Den trees (2/04)

Obvious hollow and/or den trees shall be protected and left standing unless they are a safety hazard.

**5.2.4 - Dead and Down Creation**

5.2.4.3 - Dead and down creation, dead trees (6/07)

Except as provided for in General Condition and Requirement 5.2.2, no dead trees, standing or down, are to be cut, skidded, or processed.

EXCEPTION: All dead trees within 50' of Harrison Ave. and the Fur Farm Snowmobile Trail can be harvested.

5.2.13 - Oak wilt restriction (9/08)

Within Payment Unit(s) 3, unless changed by written agreement, cutting, skidding, and hauling are not permitted during the period of April 15 to July 15. This is necessary to reduce the spread of oak wilt. For more information, contact the Unit Manager or their representative.

5.2.41 - Snowmobile trail protection (4/07)

The Fur Farm snowmobile trail may be used for hauling. See Timber Sale for location. If the trail is used, it must be maintained throughout the sale and restored to a condition equal to or better than before the sale. Do not cut or damage posts with orange trail markers or traffic control signs. If the snowmobile trail road is to be used for hauling during the snowmobile season, then a snow covered base must be left on the trail. If the trail is used for hauling, it must be graded to the satisfaction of the Unit Manager or their representative prior to December 1st. The Purchaser will be responsible for placing and maintaining warning signs on the snowmobile trail during the snowmobile season (approximately December 1 to March 31). The required location will be approximately 200 feet from where the trail enters the sale boundary as indicated on sale map. The Purchaser will provide these signs.

**5.4 - Soil Protection**

5.4.1 - Rutting restriction, general (5/08)

Operations are to cease immediately if equipment and weather conditions result in rutting of roads which is 12 inches or greater in depth and 50 feet in length. In addition, operations are to cease immediately if equipment and weather conditions result in rutting on skid trails which is 12 inches or greater in depth and 50 feet in length. The Unit Manager or their representative may restrict hauling and/or skidding if ruts exceed the specified depth. With the Unit Manager or their representative's approval, the Purchaser may return to the area when the weather conditions have changed and/or the risk of rutting has decreased.



HASKEL LAKE HARVEST (029-08-01)

A timber sale contract for this LUMP SUM SEALED timber sale will be awarded the responsible bidder offering the highest sealed bid price. Bids must be at or above the following appraised price for each species:

<u>SPECIES</u>	<u>ESTIMATED VOLUME*</u>	<u>APPRAISED PRICE</u>
SAWLOGS		
RED OAK	10.00 MBF	\$ 208.00/MBF
PULPWOOD		
RED MAPLE	232.00 CORDS	\$ 7.30/CORD
MIX ASPEN	1,056.00 CORDS	\$ 10.00/CORD

In addition, the successful bidder agrees to purchase the following species at the indicated appraised price:

<u>SPECIES</u>	<u>ESTIMATED VOLUME*</u>	<u>APPRAISED PRICE</u>
SAWLOGS		
RED MAPLE	8.00 MBF	\$ 101.00/MBF
MIXED OAK	13.00 MBF	\$ 95.00/MBF
MIX ASPEN	41.00 MBF	\$ 39.00/MBF
PULPWOOD		
RED OAK	46.00 CORDS	\$ 9.00/CORD
MIXED OAK	90.00 CORDS	\$ 11.00/CORD
MIX SOFTWD	28.00 CORDS	\$ 5.50/CORD

\*The volumes are statistically estimated within plus (+) or minus (-) 11.67 percent. These estimated volumes are final and not subject to adjustment. Prospective bidders are urged to examine this timber and to make their own estimates of quantity and quality.

BOND AND PAYMENT SCHEDULE:

1. A bond in the amount of \$2,000.00, to insure faithful performance of the conditions of the contract, will be deposited by the successful bidder within 21 days of the sale award.
2. Cutting in any sale or unit without the required advance payment would be considered a trespass.
3. Total payment may be paid in advance or according to the following schedule:
  - (a) Ten percent (10%) of the sale value must be paid within 21 days of the sale award.
  - (b) The 10% down payment will be credited towards the first unit cut.
  - (c) Payment for each of the following units must be made before cutting begins in that unit:

<u>PAYMENT UNIT NUMBER</u>	<u>PERCENT OF TOTAL SALE VALUE</u>
1	68%
2	32%
4. If no cutting takes place, the 10% down payment will not be refunded.
5. Operations on the contract issued will terminate on March 31, 2013.



### TIMBER SALE MAP

This information provided by authority of Part 525 of Act 451, PA 1994, as amended.

Sale Number	Year
73-029-08-01	2008
Date	Page of
09/30/2008	1 1

Forest Management Unit <b>GLADWIN UNIT</b>	County <b>CLARE</b>	Mapped By <b>GALLAGHER</b> Cruised By <b>HANLEY</b>
Township <b>T20N</b>	Range <b>R05W</b>	Section(s) and Subdivision(s) <b>SECTION 24, NENW: SENW: SWNE:</b>

Scale: [...1 inch.....] = 1/4 mile

Cover Type				Density			
A = Aspen	G = Grass	O = Oak	U = Upland Brush	0 = Non Stocked	5 = Pole Timber Medium		
B = Paper Birch	H = Hemlock	P = Lowland Poplar	V = Bog or Marsh	1 = Seedling Sapling Poor	6 = Pole Timber Well		
C = Cedar	J = Jack Pine	Q = Mixed Swamp Cnfr	W = White Pine	2 = Seedling Sapling Medium	7 = Saw Timber Poor		
D = Treed Bog	L = Lowland Brush	R = Red Pine	X = Non Stocked	3 = Seedling Sapling Well	8 = Saw Timber Medium		
E = Swamp Hdwoods	M = Mpl, Bch, Brch	S = Black Spruce	Z = Water	4 = Pole Timber Poor	9 = Saw Timber Well		
F = Spruce Fir	N = Marsh	T = Tamarack					

## HASKEL LAKE HARVEST

Clare County - Acres: 57

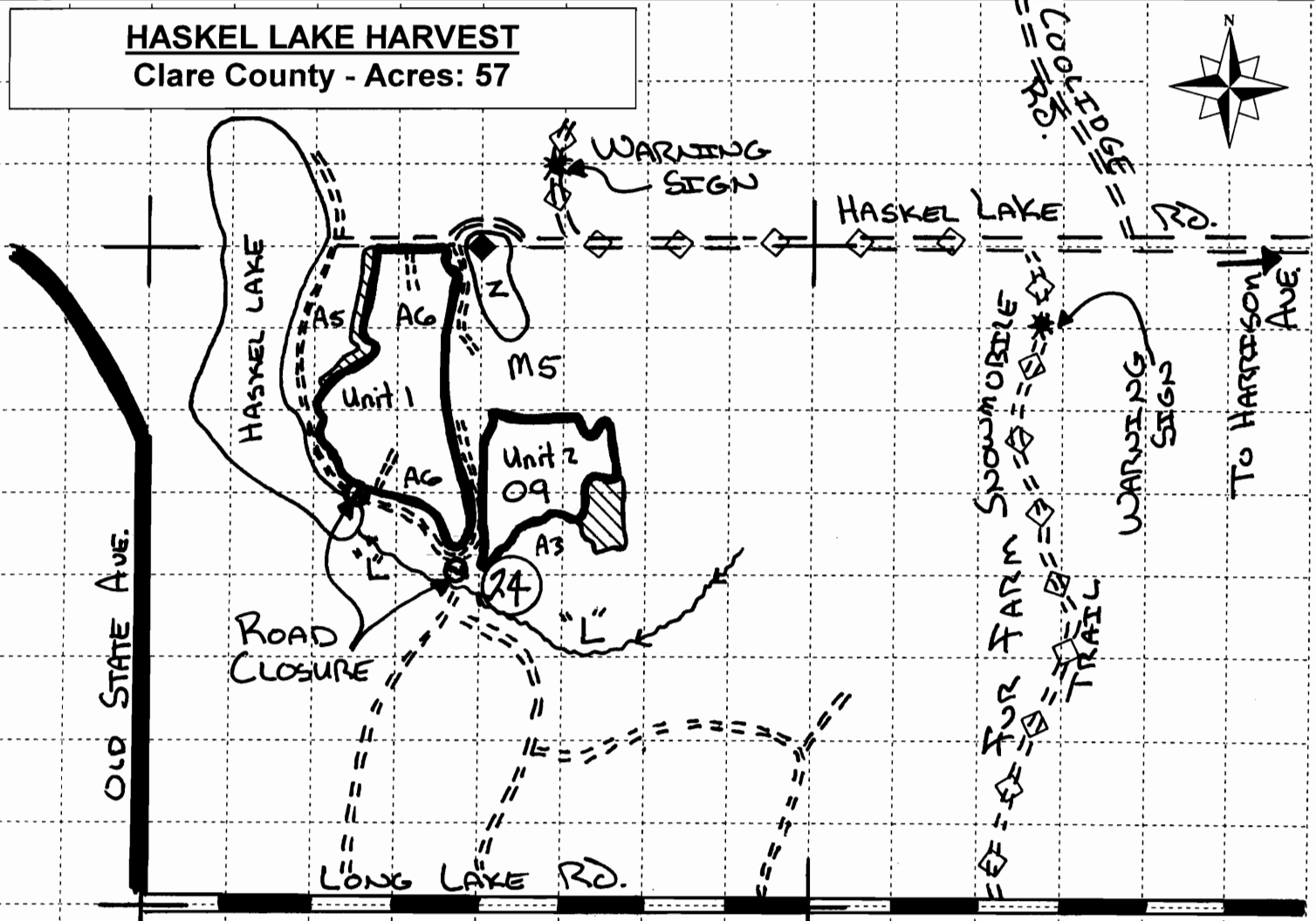

**ACRES:**  
 Unit 1 - 39 acres  
 Unit 2 - 18 acres

KEY:	
	Sale Boundary - Red Paint
	Survey Corner
	Snowmobile Trail
	Retention Areas (No Cut Areas)

## Sale Specific Conditions & Requirements

Sale Name: Haskel Lake Harvest Sale Number: 73-029-08-01

### 1 - Sale Area

#### 1.2 - Boundaries

##### 1.2.1 - Painted boundaries (6/05)

The sale boundary is marked and identified by red paint. Exterior sale boundary lines against state are marked with red paint. Do not cut painted boundary line trees.

### 2 - Timber Specifications

#### 2.1 - Included Timber

##### 2.1.1 - Clearcut unit(s) with unmerchantable trees (2/04)

Within Payment Unit(s) 1, cut all trees that are two (2) inches or more in diameter measured at a point of four and one-half (4-1/2) feet above ground level regardless of merchantability

##### 2.1.3 - Cut tree marked unit(s) (8/04)

Within Payment Unit(s) 2, all trees are designated for cutting when marked with orange paint above and below stump height, regardless of merchantability.

#### 2.2 - Utilization

##### 2.2.6 - Roundwood operation required (5/07)

The skidding of whole trees or tree segments with limbs attached is prohibited unless approved by the Unit Manager or their representative within Payment Unit(s) 2. All products must be produced as roundwood and forwarded to existing roads or landing areas in final product length.

### 3 - Payments

#### 3.4 - Damaged Timber

**3.4.1 - Damaged timber (6/05)**

General Condition and Requirement 3.4 Damaged Timber, defines liquidated damages for undesignated live merchantable trees which are cut or injured. In addition, extreme care should be taken to avoid damage to tree seedlings and saplings. Damage to residual trees (defined as breaking of the cambium layer, broken tops or bending of trees from their natural position) is not acceptable.

Within the sale area, if more than 25% of the tree seedlings or saplings (1/4" to 4.5" DBH) within a specified portion of the sale area are damaged, liquidated damages will be assessed at \$300.00 dollars per acre for all acreage within that specified portion of the sale area that was damaged.

No damage is acceptable to merchantable trees. Within the sale area, if more than 5% of trees (> 4.5" DBH) within a specified area of the sale are damaged, liquidated damages will be assessed for all trees damaged. Rates will be in accordance with General Condition and Requirement 3.4 Damaged Timber.

**4 - Transportation**

**4.1 - Construction**

**4.1.7 - Road closure (4/07)**

All new roads built into the sale must be blocked to vehicle traffic upon completion of the sale. Some existing roads may also need to be closed, see the timber sale map for locations. In general, this will require constructing double earthen berms at strategic locations. Berms are to be four (4') foot high and constructed of stumps and logs covered with earth. Stumps and brush must be placed along the remainder of the trail. Contact the sale administrator for specific details of design and placement.

**5 - Operations**

**5.2 - Conduct of Operations**

**5.2.1 - Slash**

**5.2.1.7 - Slash must be scattered (2/04)**

Unless otherwise directed, slash and logging debris shall be uniformly scattered over the sale area and not left in piles or windrows. Slash shall not be allowed to accumulate at the landings. All slash work shall be done concurrently with harvesting.

**5.2.2 - Hazard Trees/Snags**

**5.2.2.1 - Den trees (2/04)**

Obvious hollow and/or den trees shall be protected and left standing unless they are a safety hazard.

**5.2.4 - Dead and Down Creation**

**5.2.4.3 - Dead and down creation, dead trees (6/07)**

Except as provided for in General Condition and Requirement 5.2.2, no dead trees, standing or down, are to be cut, skidded, or processed.

**5.2.12 - Bark slippage restriction (3/07)**

Within Payment Unit(s) 2, unless changed by written agreement, cutting, skidding, and hauling are not permitted during the period of April 15 to July 15. This restriction is because of bark slippage. This restriction is also necessary to reduce the spread of oak wilt. For more information, contact the Unit Manager.

**5.2.22 - Operating Caution**

**5.2.22.2 - Operating caution (12/04)**

It is recommended, but not required, that within Payment Unit(s) 1 & 2, cutting, skidding, and hauling occur during dry summer or frozen winter conditions. This restriction is necessary to prevent rutting on heavy seasonally wet soils.

**5.2.41 - Snowmobile trail protection (4/07)**

The Fur Farm snowmobile trail may be used for hauling. See Timber Sale Map for trail location. If the trail is used, it must be maintained throughout the sale and restored to a condition equal to or better than before the sale. Do not cut or damage posts with orange trail markers or traffic control signs. If the snowmobile trail road is to be used for hauling during the snowmobile season, then a snow covered base must be left on the trail. If the trail is used for hauling, it must be graded to the satisfaction of the Unit Manager or their representative prior to December 1st. The Purchaser will be responsible for placing and maintaining warning signs on the snowmobile trail during the snowmobile season (approximately December 1 to March 31). The required location will be approximately 200 feet from where the trucks will enter onto the snowmobile trail at each end as indicated on sale map. The Purchaser will provide these signs.

**5.4 - Soil Protection**

**5.4.1 - Rutting restriction, general (5/08)**

Operations are to cease immediately if equipment and weather conditions result in rutting of roads which is 12 inches or greater in depth and 50 feet in length. In addition, operations are to cease immediately if equipment and weather conditions result in rutting on skid trails which is 12 inches or greater in depth and 50 feet in length. The Unit Manager or their representative may restrict hauling and/or skidding if ruts exceed the specified depth. With the Unit Manager or their representative's approval, the Purchaser may return to the area when the weather conditions have changed and/or the risk of rutting has decreased.





HARRISON AVE HARVEST (028-08-01)  
 T20N, R04W, SEC. 31, NE1/4, NWSE, SWSE, NESW, SENW, NENW.  
 T20N, R04W, SEC. 32, SWNW, NWSW.  
 CLARE COUNTY

In response to the notice of sale to be held 2:00 p.m. on January 20, 2010, I am hereby submitting my sealed bid (firm offer) for the following forest products to be cut. Bids for individual species and total bid value must be at or above the appraised price. All non-responsive bid forms may be rejected.

<u>SPECIES</u>	<u>APPRAISED PRICE</u>	<u>BID PRICE</u>	<u>ESTIMATED VOLUME*</u>	<u>= VALUE</u>
<b>SAWLOGS</b>				
RED PINE	\$ 132.00/MBF	\$ _____ X	26.00 MBF	= \$ _____
JACK PINE	\$ 47.00/MBF	\$ _____ X	119.00 MBF	= \$ _____
MIXED OAK	\$ 95.00/MBF	\$ _____ X	41.50 MBF	= \$ _____
<b>PULPWOOD</b>				
JACK PINE	\$ 10.00/CORD	\$ _____ X	1,338.00 CORDS	= \$ _____
SUBTOTAL 1				\$ _____

In addition, the successful bidder agrees to purchase the following species at the appraised price:

<u>SPECIES</u>	<u>APPRAISED PRICE</u>	<u>ESTIMATED VOLUME*</u>	<u>VALUE</u>
<b>SAWLOGS</b>			
RED MAPLE	\$ 101.00/MBF	2.50 MBF	= \$ 252.50
BLK CHERRY	\$ 61.00/MBF	11.00 MBF	= \$ 671.00
MIX ASPEN	\$ 39.00/MBF	17.00 MBF	= \$ 663.00
<b>PULPWOOD</b>			
RED MAPLE	\$ 7.30/CORD	23.00 CORDS	= \$ 167.90
RED PINE	\$ 30.70/CORD	21.00 CORDS	= \$ 644.70
BLK CHERRY	\$ 5.00/CORD	72.00 CORDS	= \$ 360.00
MIXED OAK	\$ 10.20/CORD	133.00 CORDS	= \$ 1,356.60
MIX ASPEN	\$ 10.50/CORD	83.00 CORDS	= \$ 871.50
SUBTOTAL 2			\$ <u>4,987.20</u>

SUBTOTAL 1 + SUBTOTAL 2 = TOTAL BID VALUE \$ \_\_\_\_\_

\*These volumes are statistically estimated within plus (+) or minus (-) 8.04%. These estimated volumes are final and not subject to adjustment. Prospective bidders are urged to examine this timber and to make their own estimates of quantity and quality.

I understand that any or all bids may be rejected, and that the individual unit bid price will be the basis to determine total bid value. All bids must be signed and all bid items must be bid or the bid form may be rejected. I also understand that consideration and awarding a contract will be based upon my past performance and ability to complete the contract based upon equipment and manpower subject to my control.

\_\_\_\_\_  
 (bidder's printed name)

\_\_\_\_\_  
 (bidder's signature)

Address/Telephone \_\_\_\_\_

THE WINNING BIDDER MUST COMPLETE THE FORM ON THE REVERSE SIDE  
 WITHIN 21 DAYS OF SALE AWARD



FOR DEPARTMENT USE ONLY	
Sale or Permit No	
Year:	Type:
Forest Area:	

**TIMBER SALE  
VERIFICATION OF WORKER'S DISABILITY  
COMPENSATION ACT COMPLIANCE**

*As required by Act 317, P.A. 1969 (Worker's Compensation) and Part 525 of Act 451 of 1994, as amended.*

**VERIFICATION OF WORKER'S DISABILITY COMPENSATION ACT COMPLIANCE**

- This verification must be completed and submitted within 21 days of contract award and prior to the issuance of the timber sale contract.
- In addition, if boxes 2B or 2C are checked, then Notice of Exclusion or Certificate of Insurance must be submitted within 21 days of the contract award and prior to the issuance of the timber sale contract.
- All information must be typed or printed except for written signatures.

Please Check Appropriate Categories:

1. My business is organized as (you **must** check one of the boxes below):
  - A.  Sole Proprietorship (individual)
  - B.  Partnership
  - C.  Corporation
2. You **must** check one of the boxes below:
  - A.  I certify that my business is a sole proprietorship and it has no employees but the sole proprietor. I am not subject to the Worker's Compensation Laws.
  - B.  I certify that my business has satisfied its obligation to the Worker's Compensation Act through the use of an approved Notice of Exclusion (BWC-337, Rev. 5/96). I will provide a copy of the Notice of Exclusion within 21 days of the contract award. (For questions or a copy of the BWC-337, please call the Worker's Compensation Bureau at 517-322-1195).
  - C.  I certify that my business has a Worker's Compensation Policy. I will provide an original Certificate of Insurance within 21 days of the contract award.
3. If you have checked item 2(A) or 2(B), you **must** indicate the number of **both** full and part time employees other than yourself including family members and active partners (if none, you must enter "0").

\_\_\_\_\_ Full Time Employees

\_\_\_\_\_ Part Time Employees

Name of Business		Federal ID (or) Social Security No.	
Address		Telephone No. (      )	
City	State	Zip + 4	

I hereby certify that the above information is true and correct. I agree to notify the DNR of any changes that occur in factors affecting my coverage during any of my present and future operations.

\_\_\_\_\_  
Signature of Owner or Authorized Representative

\_\_\_\_\_  
Title

\_\_\_\_\_  
Date

HASKEL LAKE HARVEST (029-08-01)  
T20N, R05W, SEC. 24, NENW, SENW, SWNE.  
CLARE COUNTY

In response to the notice of sale to be held 2:00 p.m. on January 20, 2010, I am hereby submitting my sealed bid (firm offer) for the following forest products to be cut. Bids for individual species and total bid value must be at or above the appraised price. All non-responsive bid forms may be rejected.

<u>SPECIES</u>	<u>APPRAISED PRICE</u>	<u>BID PRICE</u>	<u>ESTIMATED VOLUME*</u>	<u>= VALUE</u>
<u>SAWLOGS</u>				
RED OAK	\$ 208.00/MBF	\$ _____ X	10.00 MBF	= \$ _____
<u>PULPWOOD</u>				
RED MAPLE	\$ 7.30/CORD	\$ _____ X	232.00 CORDS	= \$ _____
MIX ASPEN	\$ 10.00/CORD	\$ _____ X	1,056.00 CORDS	= \$ _____
SUBTOTAL 1				\$ _____

In addition, the successful bidder agrees to purchase the following species at the appraised price:

<u>SPECIES</u>	<u>APPRAISED PRICE</u>	<u>ESTIMATED VOLUME*</u>	<u>VALUE</u>
<u>SAWLOGS</u>			
RED MAPLE	\$ 101.00/MBF	8.00 MBF	= \$ 808.00
MIXED OAK	\$ 95.00/MBF	13.00 MBF	= \$ 1,235.00
MIX ASPEN	\$ 39.00/MBF	41.00 MBF	= \$ 1,599.00
<u>PULPWOOD</u>			
RED OAK	\$ 9.00/CORD	46.00 CORDS	= \$ 414.00
MIXED OAK	\$ 11.00/CORD	90.00 CORDS	= \$ 990.00
MIX SOFTWD	\$ 5.50/CORD	28.00 CORDS	= \$ 154.00
SUBTOTAL 2			\$ <u>5,200.00</u>

SUBTOTAL 1 + SUBTOTAL 2 = TOTAL BID VALUE \$ \_\_\_\_\_

\*These volumes are statistically estimated within plus (+) or minus (-) 11.67%. These estimated volumes are final and not subject to adjustment. Prospective bidders are urged to examine this timber and to make their own estimates of quantity and quality.

I understand that any or all bids may be rejected, and that the individual unit bid price will be the basis to determine total bid value. All bids must be signed and all bid items must be bid or the bid form may be rejected. I also understand that consideration and awarding a contract will be based upon my past performance and ability to complete the contract based upon equipment and manpower subject to my control.

\_\_\_\_\_  
(bidder's printed name)

\_\_\_\_\_  
(bidder's signature)

Address/Telephone \_\_\_\_\_

THE WINNING BIDDER MUST COMPLETE THE FORM ON THE REVERSE SIDE  
WITHIN 21 DAYS OF SALE AWARD



FOR DEPARTMENT USE ONLY

**TIMBER SALE  
VERIFICATION OF WORKER'S DISABILITY  
COMPENSATION ACT COMPLIANCE**

*As required by Act 317, P.A. 1969 (Worker's Compensation) and Part 525  
of Act 451 of 1994, as amended.*

Sale or Permit No	
Year:	Type:
Forest Area:	

**VERIFICATION OF WORKER'S DISABILITY COMPENSATION ACT COMPLIANCE**

- This verification must be completed and submitted within 21 days of contract award and prior to the issuance of the timber sale contract.
- In addition, if boxes 2B or 2C are checked, then Notice of Exclusion or Certificate of Insurance must be submitted within 21 days of the contract award and prior to the issuance of the timber sale contract.
- All Information must be typed or printed except for written signatures.

Please Check Appropriate Categories:

1. My business is organized as (you **must** check one of the boxes below):
  - A.  Sole Proprietorship (individual)
  - B.  Partnership
  - C.  Corporation
2. You **must** check one of the boxes below:
  - A.  I certify that my business is a sole proprietorship and it has no employees but the sole proprietor. I am not subject to the Worker's Compensation Laws.
  - B.  I certify that my business has satisfied its obligation to the Worker's Compensation Act through the use of an approved Notice of Exclusion (BWC-337, Rev. 5/96). I will provide a copy of the Notice of Exclusion within 21 days of the contract award. (For questions or a copy of the BWC-337, please call the Worker's Compensation Bureau at 517-322-1195).
  - C.  I certify that my business has a Worker's Compensation Policy. I will provide an original Certificate of Insurance within 21 days of the contract award.
3. If you have checked item 2(A) or 2(B), you **must** indicate the number of **both** full and part time employees other than yourself including family members and active partners (if none, you must enter "0").

\_\_\_\_\_ Full Time Employees

\_\_\_\_\_ Part Time Employees

Name of Business		Federal ID (or) Social Security No.	
Address		Telephone No. (       )	
City	State	Zip + 4	

I hereby certify that the above information is true and correct. I agree to notify the DNR of any changes that occur in factors affecting my coverage during any of my present and future operations.

\_\_\_\_\_  
Signature of Owner or Authorized Representative

\_\_\_\_\_  
Title

\_\_\_\_\_  
Date