



DEPARTMENT OF NATURAL RESOURCES  
STATE OF MICHIGAN

TIMBER SALE PROSPECTUS

Notice is hereby given that bids will be received by the Unit Manager, SAULT STE. MARIE MANAGEMENT UNIT, for certain timber on the following described lands:

BORGSTROM NOMAD / T44N, R08W, SEC. 04, SWNW, E1/2NW, NE1/4, W1/2SW, NESW.  
T44N, R08W, SEC. 04, NWSE.  
MACKINAC COUNTY (Appr. \$24,170.35)  
SALE ACRES: 180

ARMCHAIR SPRUCE 2 / T43N, R09W, SEC. 10, E1/2NE.  
MACKINAC COUNTY (Appr. \$8,017.80)  
SALE ACRES: 30

RING AROUND THE ROSY / T44N, R09W, SEC. 02, SE1/4.  
T44N, R09W, SEC. 11, N1/2.  
MACKINAC COUNTY (Appr. \$24,573.75)  
SALE ACRES: 97

PINE STUMP / T43N, R07W, SEC. 17, SESW, SWSE.  
T43N, R07W, SEC. 19, SENE, NESE.  
T43N, R07W, SEC. 20, N1/2N1/2, SWNW, NWSW.  
T43N, R07W, SEC. 21, W1/2NW.  
MACKINAC COUNTY (Appr. \$14,392.90)  
SALE ACRES: 115

-----

SALE DATE AND TIME: 3:30 p.m. on April 20, 2010.

**NAUBINWAY**



BID INSTRUCTIONS (Ver. 06/23/2008):

1. Bid Location, Date, and Time: Bids must be received by the Unit Manager, Sault Ste. Marie Management Unit, Naubinway Field Office, PO Box 287, US 2, Naubinway, MI 49762, no later than 3:30 p.m. on April 20, 2010. For further information concerning this sale, contact the Unit Manager at 906-477-6048.
2. Bidder's Qualifications: Purchaser shall obtain workers compensation insurance to cover claims under Michigan's Worker's Disability Compensation Act of 1969 or similar employee benefit act of any other state applicable to an employee. If all or part of a timber sale was prepared by a private contractor, that contractor and that contractor's company are not permitted to bid on the timber sale contract. Bids will not be accepted from individuals or companies appearing on the DNR/FMFM No-Bid List. This list contains the names of purchasers who previously failed to execute a contract within 21-days or who have a history of poor performance.
3. Preparation of Sealed Bids: Bids shall be manually signed in ink; bid prices must be entered for each species and product in the Bid Price column for all material subject to bidding; and all fill-in blanks must be completed. If erasures or other changes appear on the forms, each erasure or change must be initialed by the person signing the bid.
4. Submission of Sealed Bids: Bid forms may be obtained from the Unit Manager. All bids must be submitted on the bid form and in an envelope clearly identified as described in this section. NOTE: Only one bid form per bid envelope. Sealed bids must be submitted to the Unit office designated in the prospectus and must be submitted at or prior to the time established in the prospectus. The envelope should show on the outside (a) that it is a "Bid for Timber," and (b) the sale name or number, and (c) the date and time of bid opening as shown in the prospectus. Bids received after the time specified in the sale prospectus are late bids and will be rejected.
5. Public Opening of Sealed Bids: If conditions permit, the sealed bids will be publicly opened and posted at the time and place set in the prospectus.
6. Award of Contract: Award of the contract will be made to the Bidder whose bid, conforming to the prospectus, is most advantageous to the State of Michigan on the basis of total value at rates bid for the estimated quantities. The State reserves the right to reject any bid or waive any minor irregularity in bids received. A written award mailed (or otherwise furnished) to the successful Bidder shall be deemed to result in a binding contract without further action by either party.
7. Down Payment: The Bidder to whom award is made must make a down payment within 21 days of the sale award. The amount of the down payment will be calculated as shown in the Bond and Payment Schedule of this prospectus. Only cash may be used to meet this requirement.
8. Performance Security: As guarantee of faithful performance, a cash bond, certificate of deposit, surety bond or irrevocable letter of credit (LOC) is required within 21 days of the sale award. The amount of the performance security is shown in the Bond and Payment Schedule of this prospectus. If an LOC or surety is used, the coverage must extend for at least 6 months beyond the contract expiration.
9. Timber Sale Contract: Additional conditions and requirements common to all timber sales are listed on the timber sale contract (R4031) and are available on line at [www.michigan.gov/dnr](http://www.michigan.gov/dnr). Contact the Unit Manager for additional information or a sample contract. Within 21 days of the date of the award letter, the bidder must sign the contract and provide the required down payment, performance security, and verification of worker's disability compensation. The down payment and performance security shall be in accordance with the provisions of the timber sale contract, in the sums stated in this prospectus. If these actions are not taken, then the Bidder, the Bidder's corporation, and the corporation's principals may not be permitted to bid on State timber sales for a period of 1 year. In addition, the Bidder certifies that if awarded this contract, the Bidder will complete the timber sale contract in accordance with its terms and any modifications thereof including requirements to purchase, cut, and remove the included timber by the termination date.

10. Disclaimer of Estimates and Bidder's Warranty of Inspection: Before submitting this bid, the Bidder is advised and cautioned to inspect the sale area, review the requirements of the sale contract, and take other steps as may be reasonably necessary to ascertain the location, estimated volumes, construction estimates, and operating costs of the proposed sale. Failure to do so will not relieve the Bidder from responsibility for completing the contract.

The Bidder warrants that this bid is submitted solely on the basis of the Bidder's examination and inspection of the quality and quantity of the timber offered for sale and the Bidder's opinion of the value thereof and the costs of recovery. No reliance should be placed on the State of Michigan's estimates of timber quality, quantity or costs of recovery. Bidder further acknowledges that the State of Michigan: (i) expressly disclaims any warranty of fitness of timber for any purpose; (ii) offers this timber as is without any warranty of quality (merchantability) or quantity and (iii) expressly disclaims any warranty as to the quantity or quality of timber sold.

11. Certification and Chain-of-Custody: Unless otherwise indicated in the contract under section 7 - Other Conditions of the Sale Specific Conditions & Requirements, the area encompassed by this timber sale is certified to the standards of the Forest Stewardship Council (FSC) - Certificate #SCS-FM/COC-090N and the Sustainable Forestry Initiative (SFI) - Certificate # NSF-SFIS-5Y031-S1. Forest products from this sale may be delivered to the mill as "FSC and / or SFI certified" as long as the contractor hauling the forest products is chain-of-custody (COC) certified or covered under a COC certificate from the destination mill. The purchaser is responsible for maintaining COC after leaving the sale area.

REBECCA A. HUMPHRIES  
Director

BORGSTROM NOMAD (107-08-01)

A timber sale contract for this LUMP SUM SEALED timber sale will be awarded the responsible bidder offering the highest sealed bid price. Bids must be at or above the following appraised price for each species:

<u>SPECIES</u>	<u>ESTIMATED VOLUME*</u>	<u>APPRAISED PRICE</u>
PULPWOOD		
W. SPRUCE	632.00 CORDS	\$ 14.90/CORD
MIX ASPEN	198.00 CORDS	\$ 17.90/CORD
MISC. SP.	49.00 ACRES	\$ 60.00/ACRES
MIX HARDWD	344.00 CORDS	\$ 19.40/CORD

In addition, the successful bidder agrees to purchase the following species at the indicated appraised price:

<u>SPECIES</u>	<u>ESTIMATED VOLUME*</u>	<u>APPRAISED PRICE</u>
PULPWOOD		
P. BIRCH	53.00 CORDS	\$ 16.25/CORD
BALSAM FIR	65.00 CORDS	\$ 11.30/CORD

\*The volumes are statistically estimated within plus (+) or minus (-) 11.00 percent. These estimated volumes are final and not subject to adjustment. Prospective bidders are urged to examine this timber and to make their own estimates of quantity and quality.

BOND AND PAYMENT SCHEDULE:

1. A bond in the amount of \$2,000.00, to insure faithful performance of the conditions of the contract, will be deposited by the successful bidder within 21 days of the sale award.
2. Cutting in any sale or unit without the required advance payment would be considered a trespass.
3. Total payment may be paid in advance or according to the following schedule:
  - (a) Ten percent (10%) of the sale value must be paid within 21 days of the sale award.
  - (b) The 10% down payment will be credited towards the first unit cut.
  - (c) Payment for each of the following units must be made before cutting begins in that unit:

<u>PAYMENT UNIT NUMBER</u>	<u>PERCENT OF TOTAL SALE VALUE</u>
1	64%
2	18%
3	06%
4	12%
4. If no cutting takes place, the 10% down payment will not be refunded.
5. Operations on the contract issued will terminate on December 31, 2012.



Forest Management Unit Sault M.U. - Naubinway Office	County Mackinac	Mapped By Cory Luoto	Date 9/30/2008	Page 1	of 1
Township 44 N	Range 8 W	Section(s) and Subdivision(s) 4: SWNW, E1/2NW, NE1/4, W1/2SW, NESW, NWSE	Scale: 1:15840 1"=1/4 Mile		

Cover Type				Density	
A = Aspen	G = Grass	O = Oak	U = Upland Brush	0 = Non Stocked	5 = Pole Timber Medium
B = Paper Birch	H = Hemlock	P = Lowland Poplar	V = Bog or Marsh	1 = Seedling Sapling Poor	6 = Pole Timber Well
C = Cedar	J = Jack Pine	Q = Mixed Swamp Cnfr	W = White Pine	2 = Seedling Sapling Medium	7 = Saw Timber Poor
D = Treed Bog	L = Lowland Brush	R = Red Pine	X = Non Stocked	3 = Seedling Sapling Well	8 = Saw Timber Medium
E = Swamp Hdwoods	M = Mpl, Bch, Brch	S = Black Spruce	Z = Water	4 = Pole Timber Poor	9 = Saw Timber Well
F = Spruce Fir	N = Marsh	T = Tamarack			

# Borgstrom Nomad

## 180 Acres



Luce County

Mackinac County

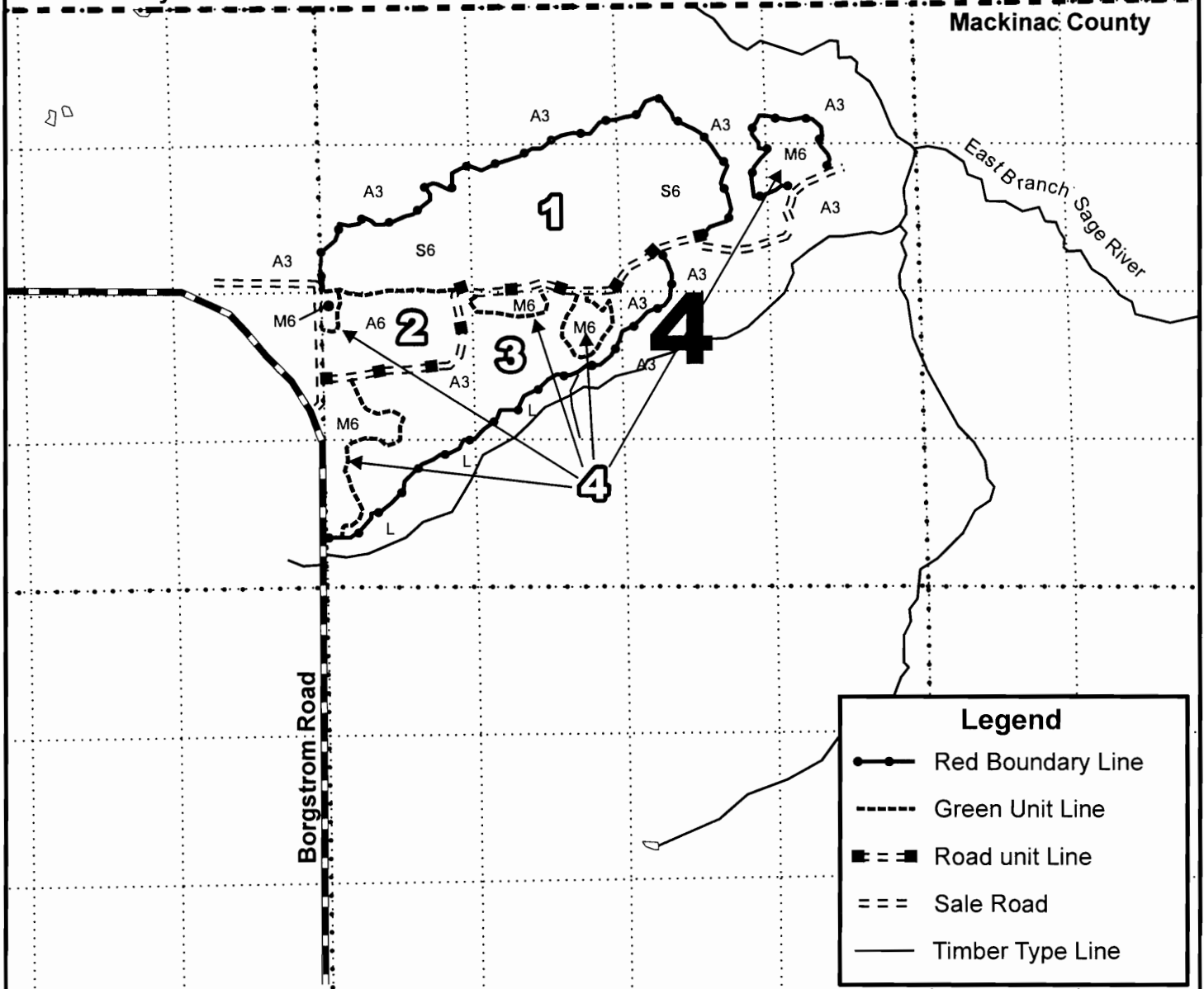

Legend	
	Red Boundary Line
	Green Unit Line
	Road unit Line
	Sale Road
	Timber Type Line

## Sale Specific Conditions & Requirements

**Sale Name: Borgstrom Nomad    Sale Number: 45-107-08-01**

### 1 - Sale Area

#### 1.2 - Boundaries

##### 1.2.1 - Painted boundaries (6/05)

The sale boundary is marked and identified by red paint, Borgstrom Road and a gravel road. Payment units are bounded by green paint and roads within the sale.

### 2 - Timber Specifications

#### 2.1 - Included Timber

##### 2.1.1 - Clearcut unit(s) with unmerchantable trees (2/04)

Within Payment Unit(s) 1, 2 and 3, cut all deciduous trees that are two (2) inches or more in diameter measured at a point of four and one-half (4-1/2) feet above ground level regardless of merchantability. Also, in unit 1, cut all coniferous trees that four (4) inches or more in diameter at four and one half feet above ground level regardless of merchantability. In units 2 and 3 do not cut any spruce, balsam, hemlock or white pine.

##### 2.1.3 - Cut tree marked unit(s) (8/04)

Within Payment Unit(s) 4, trees are designated for cutting when marked with orange paint above and below stump height, regardless of merchantability.

##### 2.1.1.1 - Description of timber note (2/04)

Note that payment unit 3 contains no merchantable timber and is being sold on a per acre basis as miscellaneous pulp.

#### 2.2 - Utilization

##### 2.2.2 - Chipping (5/09)

Payment Unit 3 must be chip harvested. The purchaser has the option to produce sawlogs or pulpwood bolts, but the remaining portion of the trees must be chipped and hauled to meet future silvicultural criteria. In areas that are chipped, retain 15% of tops.

##### 2.2.4 - Skidding length (2/04)

Skidding of lengths over 17 feet is not permissible in unit 4, unless approved by the Unit Manager or their representative.

### 3 - Payments

#### 3.3 - Pre-measured Sales

3.3.4 - Dividing payment units (7/05)

Payment unit(s) 1, 2, and 3 may be divided at the request of the purchaser and upon approval of the Unit Manager. Dividing payment units is a contract modification which requires a Timber Sale Contract Supplement.

**4 - Transportation**

**4.1 - Construction**

4.1.7 - Road closure (4/07)

All new roads built into the sale must be blocked to vehicle traffic upon completion of the sale. In general, this will require constructing a four (4') foot high berm constructed of stumps and logs covered with earth. Contact the sale administrator for specific details of design and placement.

**5 - Operations**

**5.2 - Conduct of Operations**

**5.2.1 - Slash**

5.2.1.1 - Slash within sale area (2/04)

No trees are to be felled outside the sale area and all slash is to be kept at least 10 feet back from the red paint line.

**5.2.2 - Hazard Trees/Snags**

5.2.2.1 - Den trees (2/04)

Obvious hollow and/or den trees shall be protected and left standing unless they are a safety hazard.

**5.2.4 - Dead and Down Creation**

5.2.4.3 - Dead and down creation, dead trees (6/07)

Except as provided for in General Condition and Requirement 5.2.2, no dead trees, standing or down, are to be cut, skidded, or processed.

5.2.12 - Bark slippage restriction (3/07)

Within Payment Unit(s) 4, unless changed by written agreement, cutting and skidding are not permitted during the period of May 1st to June 30th. This restriction is because of bark slippage.

5.2.38 - No decking against live trees (2/04)

Cut products may not be decked against unmarked or designated leave trees.

**5.8 - Protection of Endangered Species**

5.8.5 - Protection of raptor nests (9/05)

All trees with raptor nests will be protected if found during harvesting operations. Notification will be made to the Unit Manager and Wildlife Biologist so an on-site evaluation and recommendation can be made, if necessary.



**7 - Other Conditions**

**7.3 - Contract Modifications**

**7.3.1 - Emerald Ash Borer**

7.3.1.2 - Emerald ash borer, ash or firewood on sale (2/05)

There is ash and/or "firewood" in this sale and it is located within an emerald ash borer quarantined area. The Director of the Michigan Department of Agriculture (MDA) by the authority of Act No. 72 of the Public Acts of 1945, as amended, and Quarantine Regulation No. 620, has promulgated this quarantine to prevent the further spread of this pest and sets forth: definitions, regulated articles, regulated areas, conditions of movement, violations and penalties, and special exemptions. The purchaser must comply with this quarantine. Contact the MDA for further information.



ARMCHAIR SPRUCE 2 (107-09-01)

A timber sale contract for this LUMP SUM SEALED timber sale will be awarded the responsible bidder offering the highest sealed bid price. Bids must be at or above the following appraised price for each species:

<u>SPECIES</u>	<u>ESTIMATED VOLUME*</u>	<u>APPRAISED PRICE</u>
PULPWOOD		
W. SPRUCE	201.00 CORDS	\$ 19.65/CORD
MIX ASPEN	63.00 CORDS	\$ 19.80/CORD
MIX HARDWD	140.00 CORDS	\$ 18.75/CORD

In addition, the successful bidder agrees to purchase the following species at the indicated appraised price:

<u>SPECIES</u>	<u>ESTIMATED VOLUME*</u>	<u>APPRAISED PRICE</u>
PULPWOOD		
BALSAM FIR	15.00 CORDS	\$ 13.05/CORD

\*The volumes are statistically estimated within plus (+) or minus (-) 9.4 percent. These estimated volumes are final and not subject to adjustment. Prospective bidders are urged to examine this timber and to make their own estimates of quantity and quality.

BOND AND PAYMENT SCHEDULE:

1. A bond in the amount of \$600.00, to insure faithful performance of the conditions of the contract, will be deposited by the successful bidder within 21 days of the sale award.
2. Cutting in any sale or unit without the required advance payment would be considered a trespass.
3. Total payment may be paid in advance or according to the following schedule:
  - (a) Ten percent (10%) of the sale value must be paid within 21 days of the sale award.
  - (b) The remainder is due before cutting begins.
4. If no cutting takes place, the 10% down payment will not be refunded.
5. Operations on the contract issued will terminate on December 30, 2012.



TIMBER SALE MAP

This information provided under authority of Part 525, Act 451 of 1994, as amended.

Sale No:

107

Year:

09

Sale Type:

01

State Forest and Forest Management Unit:

L.S.F., Sault Mgt. Unit, Naubinway Area

Mapped By:

Amy Douglass

Date:

3/24/2009

Township

T43N

Range

R09W

Section(s)

10

Subdivision

E1/2NE

Scale: 1 inch = 1/4 mile

Cover Type

Density

A = Aspen  
B = Paper Birch  
C = Cedar  
E = Swamp Hdwoods  
F = Spruce Fir  
G = Grass

H = Hemlock  
J = Jack Pine  
L = Lowland Brush  
M = Mpl. Bch. Brch  
N = Marsh  
O = Oak

P = Lowland Poplar  
Q = Mixed Swamp Cnfr  
R = Red Pine  
S = Black Spruce  
T = Tamarack  
U = Upland Brush

V = Bog or Marsh  
W = White Pine  
X = Non Stocked  
Z = Water

1 = Non Stocked  
2 = Seedling Sapling Poor  
3 = Seedling Sapling Well  
4 = Pole Timber Poor  
5 = Pole Timber Medium  
6 = Pole Timber Well

7 = Saw Timber Poor  
8 = Saw Timber Medium  
9 = Saw Timber Well

Armchair Spruce 2

30 Acres

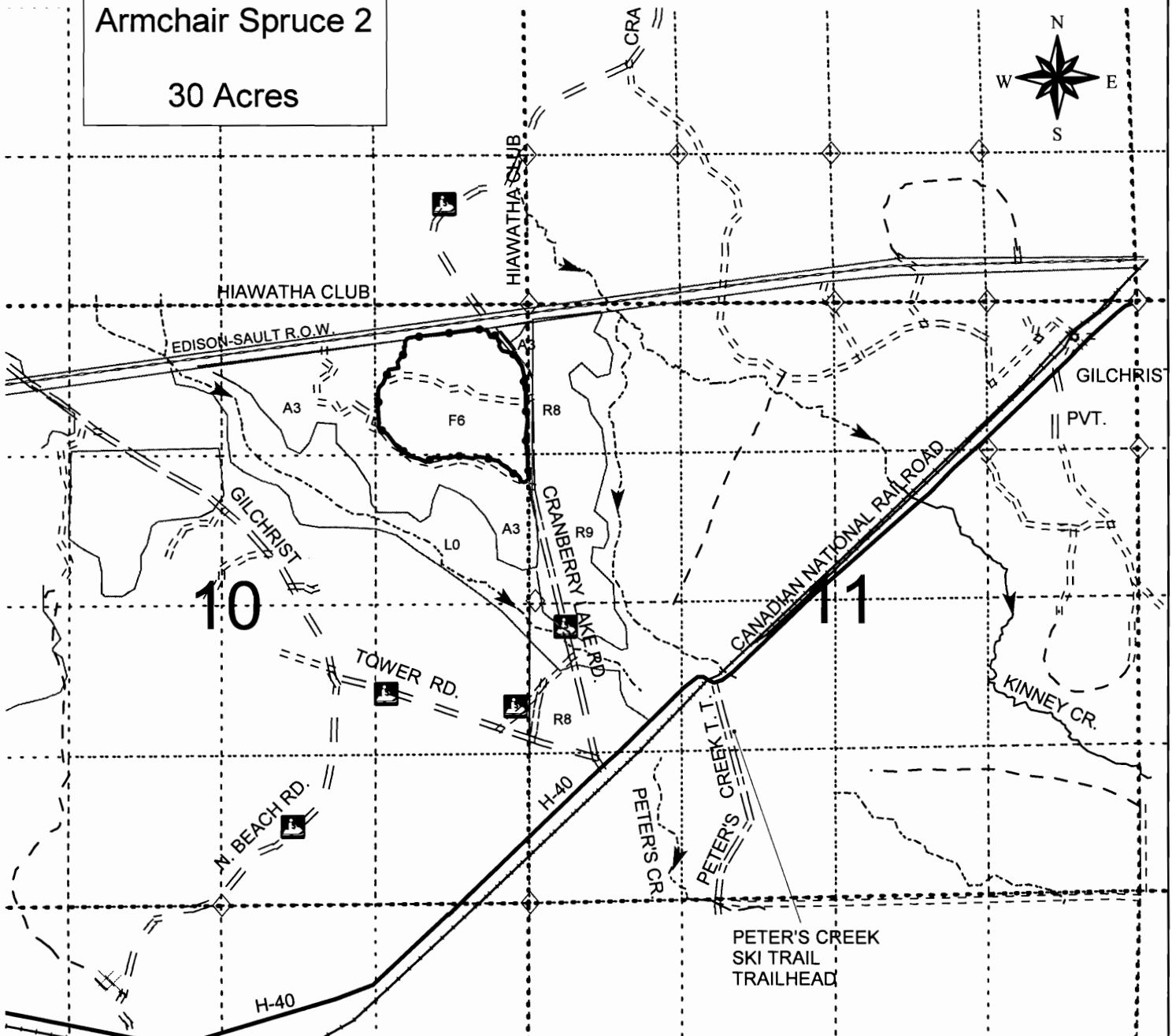

- SALE BOUNDARY - RED PAINT
- RLS CORNER-DNR
- EDISON-SAULT POWER LINE

- PAVED ROADS
- GRAVEL & GOOD DIRT ROADS
- TWO TRACKS
- CLOSED TRAILS
- RIVERS
- INTERMITTENT STREAMS

## Sale Specific Conditions & Requirements

**Sale Name: Armchair Spruce 2    Sale Number: 45-107-09-01**

### 1 - Sale Area

#### 1.2 - Boundaries

##### 1.2.1 - Painted boundaries (12/08)

The sale boundary is marked and identified by red paint.

### 2 - Timber Specifications

#### 2.1 - Included Timber

##### 2.1.1 - Clearcut unit(s) with unmerchantable trees (4/09)

Within Payment Unit(s) 1, cut all trees that are two (2) inches or more in diameter measured at a point four and one-half (4-1/2) feet above ground level regardless of merchantability except white pine and red pine. Two (2) to five (5) submerchantable trees per acre must be dropped and retained on the site.

##### 2.1.1.1 - Description of timber note (2/04)

Note that the majority of mixed hardwood pulpwood is clumpy red maple.

#### 2.2 - Utilization

##### 2.2.2 - Chipping (12/08)

Payment Unit 1 must be chip harvested to facilitate future silvicultural activities. The purchaser has the option to produce sawlogs or pulpwood bolts, but the remaining portion of the trees must be chipped and hauled to meet silvicultural activities, except 15 to 30% of the tops harvested must remain on the site. The retained slash may be scattered or piled which may not exceed four (4) feet in height.

##### 2.2.3 - Stump heights (4/07)

Stump heights within Payment Unit 1 shall not exceed 12 inches for trees greater than 10 inches DBH and 6 inches for trees smaller than 10 inches DBH. This is in order to facilitate possible planting operations.

##### 2.2.8 - Utilization and removal (7/05)

All products meeting standards set forth in 2.2 Utilization must be removed from the sale area.

### 4 - Transportation

#### 4.1 - Construction

##### 4.1.7 - Road closure (4/07)

All new roads built into the sale must be blocked to vehicle traffic upon completion of the sale. In general, this will require the placement of berms, stumps, slash and brush along 30 feet of the new road system. These roads must be rendered impassable to cars and trucks. Contact the sale administrator for specific details of design and placement.

## **5 - Operations**

### **5.1 - Notification**

#### **5.1.1 - Pre-sale conference (12/08)**

A pre-sale conference on site between the Purchaser and sale administrator is required prior to beginning any operations to determine landing and road locations. The Unit Manager or his/her representative must be contacted at least 2 days in advance to schedule the conference.

#### **5.1.4 - Post-sale conference (2/04)**

A post-sale conference on site between the Purchaser and sale administrator is required 5 days prior to the completion of active logging operations to determine clean-up and repair of landings, road edges, and the fulfillment of other contract specifications.

#### **5.1.6 - Utility R.O.W. (10/08)**

It is the responsibility of the purchaser to obtain permission from the utility company to utilize the power line R.O.W. for operations.

### **5.2 - Conduct of Operations**

#### **5.2.3 - Operating Restrictions**

##### **5.2.3.1 - Operating restrictions (12/08)**

Within Payment Unit(s) 1, unless changed by written agreement, cutting, skidding, and hauling are not permitted during the period of December 15 to March 31. This restriction is because of the snowmobile trail and stump height restriction.

#### **5.2.4 - Dead and Down Creation**

##### **5.2.4.3 - Dead and down creation, dead trees (6/07)**

Except as provided for in General Condition and Requirement 5.2.2, no dead trees, standing or down, are to be cut, skidded, or processed.

##### **5.2.37 - No decking areas (12/08)**

No decking is allowed within 50 feet of Cranberry Lake Road without permission of the Unit Manager or his/her representative.

##### **5.2.41 - Snowmobile trail protection (1/09)**

The Cranberry Lake Road is a snowmobile trail and is shown on the Timber Sale Map. If the trail is used, it must be maintained and restored to a condition equal to or better than before the sale. Do not cut or damage posts with orange trail markers or traffic control signs. Maintain a 50 foot wide slash, debris, and rut free zone daily using the cleared right of way of the snowmobile trail as the east boundary. If the trail road is to be used for hauling during the snowmobile season, then a snow covered base must be left on the trail. All stumps within 20 feet of the snowmobile trail must be cut at ground level.

### **5.4 - Soil Protection**

**Sale Name: Armchair Spruce 2    Sale Number: 45-107-09-01**

5.4.1 - Rutting restriction, general (1/09)

Operations are to cease immediately if equipment and weather conditions result in rutting of roads and skid trails 12 inches or greater in depth and 50 feet in length. The Unit Manager or his/her representative may restrict hauling and/or skidding if ruts exceed the specified depth. With the Unit Manager or his/her representative's approval, the Purchaser may return to the area when the risk of rutting has decreased.

**5.8 - Protection of Endangered Species**

5.8.5 - Protection of raptor nests (4/09)

All trees with raptor nests will be protected if found during harvesting operations. Notification will be made to the Unit Manager or his/her representative who will notify the Wildlife Biologist so an on-site evaluation and recommendation can be made, if necessary.

**7 - Other Conditions**

**7.3 - Contract Modifications**

**7.3.1 - Emerald Ash Borer**

7.3.1.2 - Emerald ash borer, ash or firewood on sale (2/05)

There is ash and/or "firewood" in this sale and it is located within an emerald ash borer quarantined area. The Director of the Michigan Department of Agriculture (MDA) by the authority of Act No. 72 of the Public Acts of 1945, as amended, and Quarantine Regulation No. 620, has promulgated this quarantine to prevent the further spread of this pest and sets forth: definitions, regulated articles, regulated areas, conditions of movement, violations and penalties, and special exemptions. The purchaser must comply with this quarantine. Contact the MDA for further information.





RING AROUND THE ROSY (113-08-01)

A timber sale contract for this LUMP SUM SEALED timber sale will be awarded the responsible bidder offering the highest sealed bid price. Bids must be at or above the following appraised price for each species:

<u>SPECIES</u>	<u>ESTIMATED VOLUME*</u>	<u>APPRAISED PRICE</u>
PULPWOOD		
P. BIRCH	338.00 CORDS	\$ 14.30/CORD
W. SPRUCE	469.00 CORDS	\$ 13.10/CORD
MIX HARDWD	499.00 CORDS	\$ 17.05/CORD

In addition, the successful bidder agrees to purchase the following species at the indicated appraised price:

<u>SPECIES</u>	<u>ESTIMATED VOLUME*</u>	<u>APPRAISED PRICE</u>
SAWLOGS		
RED MAPLE	8.00 MBF	\$ 126.00/MBF
P. BIRCH	6.20 MBF	\$ 180.00/MBF
BLK CHERRY	2.40 MBF	\$ 288.00/MBF
PULPWOOD		
BALSAM FIR	203.00 CORDS	\$ 9.80/CORD
MIX ASPEN	17.00 CORDS	\$ 16.70/CORD

\*The volumes are statistically estimated within plus (+) or minus (-) 13.07 percent. These estimated volumes are final and not subject to adjustment. Prospective bidders are urged to examine this timber and to make their own estimates of quantity and quality.

BOND AND PAYMENT SCHEDULE:

1. A bond in the amount of \$2,000.00, to insure faithful performance of the conditions of the contract, will be deposited by the successful bidder within 21 days of the sale award.
2. Cutting in any sale or unit without the required advance payment would be considered a trespass.
3. Total payment may be paid in advance or according to the following schedule:
  - (a) Ten percent (10%) of the sale value must be paid within 21 days of the sale award.
  - (b) The 10% down payment will be credited towards the first unit cut.
  - (c) Payment for each of the following units must be made before cutting begins in that unit:

<u>PAYMENT UNIT NUMBER</u>	<u>PERCENT OF TOTAL SALE VALUE</u>
1	15%
2	14%
3	41%
4	26%
5	04%
4. If no cutting takes place, the 10% down payment will not be refunded.
5. Operations on the contract issued will terminate on June 30, 2013.



TIMBER SALE MAP

This information provided by authority of Part 525 of Act 451, PA 1994, as amended.

Sale Number	Year
45-113	08

Forest Management Unit <b>Sault MU - Naubinway Area</b>		County <b>Mackinac</b>	Mapped By <b>Amy Douglass</b>	Date <b>9/2/08</b>	Page <b>1</b>	of <b>1</b>
Township <b>44N</b>	Range <b>09W</b>	Section(s) and Subdivision(s) <b>2 - SE1/4 11 - N1/2</b>	Cruised By <b>Douglass/Rodock</b>	0.25 0 0.25 Miles		

Cover Type

A = Aspen	G = Grass	O = Oak	U = Upland Brush
B = Paper Birch	H = Hemlock	P = Lowland Poplar	V = Bog or Marsh
C = Cedar	J = Jack Pine	Q = Mixed Swamp Cnfr	W = White Pine
D = Treed Bog	L = Lowland Brush	R = Red Pine	X = Non Stocked
E = Swamp Hdwoods	M = Mpl, Bch, Brch	S = Black Spruce	Z = Water
F = Spruce Fir	N = Marsh	T = Tamarack	

Density

0 = Non Stocked	5 = Pole Timber Medium
1 = Seedling Sapling Poor	6 = Pole Timber Well
2 = Seedling Sapling Medium	7 = Saw Timber Poor
3 = Seedling Sapling Well	8 = Saw Timber Medium
4 = Pole Timber Poor	9 = Saw Timber Well

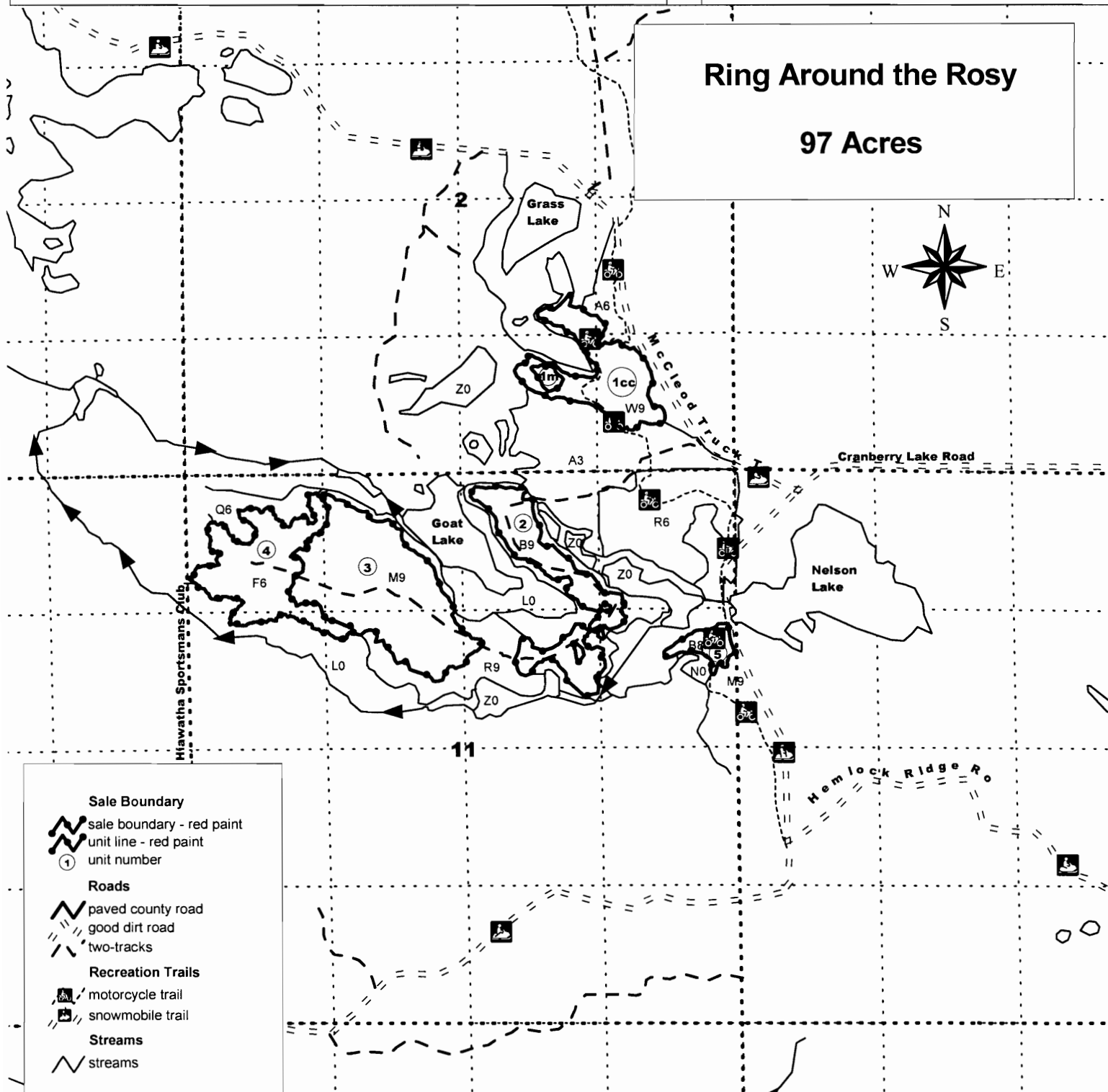

## Sale Specific Conditions & Requirements

**Sale Name: Ring Around The Rosy    Sale Number: 45-113-08-01**

### 1 - Sale Area

#### 1.2 - Boundaries

##### 1.2.1 - Painted boundaries (6/05)

The sale boundary and Payment Unit boundaries are marked and identified by red paint.

### 2 - Timber Specifications

#### 2.1 - Included Timber

##### 2.1.1 - Clearcut unit(s) with unmerchantable trees (2/04)

Within Payment Unit(s) 1cc, 4 and 5, cut all deciduous trees that are two (2) inches or more in diameter measured at a point of four and one-half (4-1/2) feet above ground level regardless of merchantability, and cut all coniferous trees that are four (4) inches or more in diameter measured at a point of four and one-half (4-1/2) feet above ground level regardless of merchantability. Leave trees identified in accordance with 2.1.10 - Leave trees, within clearcutting unit boundaries, are not Included Timber and are to be protected.

##### 2.1.3 - Cut tree marked unit(s) (8/04)

Within Payment Unit(s) 1m, all trees are designated for cutting when marked with orange paint above and below stump height, regardless of merchantability. Within this marked area of Payment Unit 1 (1m), all balsam that are four (4) inches or more in diameter measured at a point of four and one-half (4-1/2) feet above ground level regardless of merchantability may be cut.

##### 2.1.7 - Leave tree marked unit(s) (8/04)

Within Payment Unit(s) 2 and 3, all trees, which meet minimum piece specifications in 2.2 Utilization, are designated for cutting except hemlock, white pine, red pine, cedar and trees marked with green paint above and below stump height. Leave trees identified in accordance with 2.1.10 - Leave trees, within leave tree marked unit boundaries, are not Included Timber and are to be protected.

##### 2.1.10 - Leave trees (2/04)

Within all units, leave all red pine, white pine, hemlock, cedar, juneberry and mountain ash. Within the clearcut portion of Unit 1 (1cc) also leave yellow birch and white spruce > 16 inches measured at a point four and one-half (4-1/2) feet above ground.

##### 2.1.11 - Description of timber note (2/04)

Note that mixed hardwood is mainly red maple, with sugar maple, beech and cherry.

#### 2.2 - Utilization

2.2.4 - Skidding length (2/04)

Skidding of unlimbed tops or lengths over 17 feet is not permissible in Units 1m, 2 and 3 unless approved by the Unit Manager or their representative.

**3 - Payments**

**3.3 - Pre-measured Sales**

3.3.4 - Dividing payment units (7/05)

Payment unit(s) 3 may be divided at the request of the purchaser and upon approval of the Unit Manager. Dividing payment units is a contract modification which requires a Timber Sale Contract Supplement.

**4 - Transportation**

**4.1 - Construction**

4.1.7 - Road closure (4/07)

All new roads built into the sale must be blocked to vehicle traffic upon completion of the sale. Overgrown roads that are reopened shall be considered new roads. In general, this will require the placement of berms, stumps, slash and brush along 20 feet of the new road system. These roads must be rendered impassable to cars and trucks. Contact the sale administrator for specific details of design and placement.

**4.2 - Maintenance**

4.2.1 - Hauling restriction (3/07)

Hauling may be restricted on forest roads by the Unit Manager or their representative. The restriction may occur during wet weather conditions.

**5 - Operations**

**5.1 - Notification**

5.1.1 - Pre-sale conference (2/08)

A pre-sale conference on site between the Purchaser and sale administrator is required prior to beginning any operations. The Unit Manager or their representative must be contacted at least 10 days in advance to schedule the conference.

5.1.4 - Post-sale conference (2/04)

A post-sale conference on site between the Purchaser and sale administrator is required 5 days prior to the completion of active logging operations to determine clean-up and repair of landings, road edges, and the fulfillment of other contract specifications.

**5.2 - Conduct of Operations**

**5.2.2 - Hazard Trees/Snags**

5.2.2.1 - Den trees (2/04)

Obvious hollow and/or den trees shall be protected and left standing unless they are a safety hazard.

**5.2.4 - Dead and Down Creation**

5.2.4.3 - Dead and down creation, dead trees (6/07)

Except as provided for in General Condition and Requirement 5.2.2, no dead trees, standing or down, are to be cut, skidded, or processed.

5.2.12 - Bark slippage restriction (3/07)

Within Payment Unit(s) 1m (marked portion), 2 and 3, unless changed by written agreement, cutting, skidding, and hauling are not permitted during the period of April 15 to July 15. This restriction is because of bark slippage.

**5.2.22 - Operating Caution**

5.2.22.1 - Operating caution (12/04)

It is recommended, but not required, that within Payment Unit(s) 1, 2, 3 and 4, cutting, skidding, and hauling occur during dry summer or frozen winter conditions. This restriction is because of scattered low areas within these units and access roadwork needed.

5.2.38 - No decking against live trees (2/04)

Cut products may not be decked against unmarked or designated leave trees.

5.2.39 - ORV trail protection (10/08)

The Newberry-Rexton is an ORV trail and is shown on the Timber Sale Map. Do not cut trees or damage posts with orange ORV markers. Maintain a 20 foot wide slash, debris, and rut free zone daily using the ORV trail as the centerline. Do not run equipment down the ORV trail. Skidding across the trail may only occur in locations approved by the sale administrator.

5.2.41 - Snowmobile trail protection (4/07)

The Cranberry Lake Road and McCleod Truck Trail are a snowmobile trail and is shown on the Timber Sale Map. If the trail is used, it must be maintained and restored to a condition equal to or better than before the sale. Do not cut or damage posts with orange trail markers or traffic control signs. If the trail road is to be used for hauling during the snowmobile season, then a snow covered base must be left on the trail. No decking of forest products will be permitted along the snowmobile trail.

**5.4 - Soil Protection**

**5.4.1 - Rutting restriction, general (5/08)**

Operations are to cease immediately if equipment and weather conditions result in rutting of roads which is 12 inches or greater in depth and 50 feet in length. In addition, operations are to cease immediately if equipment and weather conditions result in rutting on skid trails which is 12 inches or greater in depth and 50 feet in length. The Unit Manager or their representative may restrict hauling and/or skidding if ruts exceed the specified depth. With the Unit Manager or their representative's approval, the Purchaser may return to the area when the weather conditions have changed and/or the risk of rutting has decreased.

**5.4.6 - Wet area protection (9/05)**

No harvesting operations, including skidding and felling, are to take place within the vernal pond areas or drainages. Care must be taken by the purchaser to identify and avoid operating in these areas of the timber sale.

**5.8 - Protection of Endangered Species**

**5.8.5 - Protection of raptor nests (9/05)**

All trees with raptor nests will be protected if found during harvesting operations. Notification will be made to the Unit Manager and Wildlife Biologist so an on-site evaluation and recommendation can be made, if necessary.

**6 - Safety and Fire Prevention**

**6.2 - Signing**

**6.2.2 - Snowmobile trail posting (8/09)**

The Purchaser is responsible for posting and maintaining caution signs on snowmobile trail #2 prior to beginning operations during the snowmobile season (approximately December 1 to March 31). The trail must be posted at appropriate distances from the sale area to warn of logging activity and truck traffic. Signs must be removed when harvest operations are suspended or completed. The Purchaser will provide these signs.

**6.2.3 - Recreational trail posting (9/08)**

The purchaser is responsible for posting and maintaining caution signs on the Newberry-Rexton motorcycle trail prior to beginning operations. The trail must be posted at appropriate distances from the sale area to warn of logging activity and truck traffic at both ends of the trail. The purchaser must maintain the signs during the trail use season. The Purchaser will provide these signs for use on State-owned land.

**7 - Other Conditions**

**7.3 - Contract Modifications**

**7.3.1 - Emerald Ash Borer**

**7.3.1.2 - Emerald ash borer, ash or firewood on sale (2/05)**

There is ash and/or "firewood" in this sale and it is located within an emerald ash borer quarantined area. The Director of the Michigan Department of Agriculture (MDA) by the authority of Act No. 72 of the Public Acts of 1945, as amended, and Quarantine Regulation No. 620, has promulgated this quarantine to prevent the further spread of this pest and sets forth: definitions, regulated articles, regulated areas, conditions of movement, violations and penalties, and special exemptions. The purchaser must comply with this quarantine. Contact the

**Sale Name: Ring Around The Rosy    Sale Number: 45-113-08-01**

MDA for further information.





PINE STUMP (114-08-01)

A timber sale contract for this LUMP SUM SEALED timber sale will be awarded the responsible bidder offering the highest sealed bid price. Bids must be at or above the following appraised price for each species:

<u>SPECIES</u>	<u>ESTIMATED VOLUME*</u>	<u>APPRAISED PRICE</u>
PULPWOOD		
MIX ASPEN	615.00 CORDS	\$ 11.40/CORD
MIX SOFTWD	250.00 CORDS	\$ 12.25/CORD
MIX HARDWD	357.00 CORDS	\$ 11.20/CORD

In addition, the successful bidder agrees to purchase the following species at the indicated appraised price:

<u>SPECIES</u>	<u>ESTIMATED VOLUME*</u>	<u>APPRAISED PRICE</u>
SAWLOGS		
SUG. MAPLE	1.00 MBF	\$ 321.00/MBF

\*The volumes are statistically estimated within plus (+) or minus (-) 18.19 percent. These estimated volumes are final and not subject to adjustment. Prospective bidders are urged to examine this timber and to make their own estimates of quantity and quality.

BOND AND PAYMENT SCHEDULE:

1. A bond in the amount of \$1,800.00, to insure faithful performance of the conditions of the contract, will be deposited by the successful bidder within 21 days of the sale award.
2. Cutting in any sale or unit without the required advance payment would be considered a trespass.
3. Total payment may be paid in advance or according to the following schedule:
  - (a) Ten percent (10%) of the sale value must be paid within 21 days of the sale award.
  - (b) The 10% down payment will be credited towards the first unit cut.
  - (c) Payment for each of the following units must be made before cutting begins in that unit:

<u>PAYMENT UNIT NUMBER</u>	<u>PERCENT OF TOTAL SALE VALUE</u>
1	24%
2	42%
3	34%

4. If no cutting takes place, the 10% down payment will not be refunded.
5. Operations on the contract issued will terminate on June 30, 2013.



Forest Management Unit <b>Sault MU - Naubinway Area</b>	County <b>Mackinac</b>	Mapped By <b>Douglass</b>	Date <b>9/26/08</b>	Page <b>1</b>	of <b>1</b>
Township <b>43N</b>	Range <b>07W</b>	Section(s) and Subdivision(s) <b>17 - SESW, SWSE; 19 - SENE, NESE; 20 - N1/2N1/2, SWNW, NWSW; 21 - W1/2NW</b>			

**Cover Type**

A = Aspen	G = Grass	O = Oak	U = Upland Brush
B = Paper Birch	H = Hemlock	P = Lowland Poplar	V = Bog or Marsh
C = Cedar	J = Jack Pine	Q = Mixed Swamp Cnfr	W = White Pine
D = Treed Bog	L = Lowland Brush	R = Red Pine	X = Non Stocked
E = Swamp Hdwoods	M = Mpl, Bch, Brch	S = Black Spruce	Z = Water
F = Spruce Fir	N = Marsh	T = Tamarack	

**Density**

0 = Non Stocked	5 = Pole Timber Medium
1 = Seedling Sapling Poor	6 = Pole Timber Well
2 = Seedling Sapling Medium	7 = Saw Timber Poor
3 = Seedling Sapling Well	8 = Saw Timber Medium
4 = Pole Timber Poor	9 = Saw Timber Well

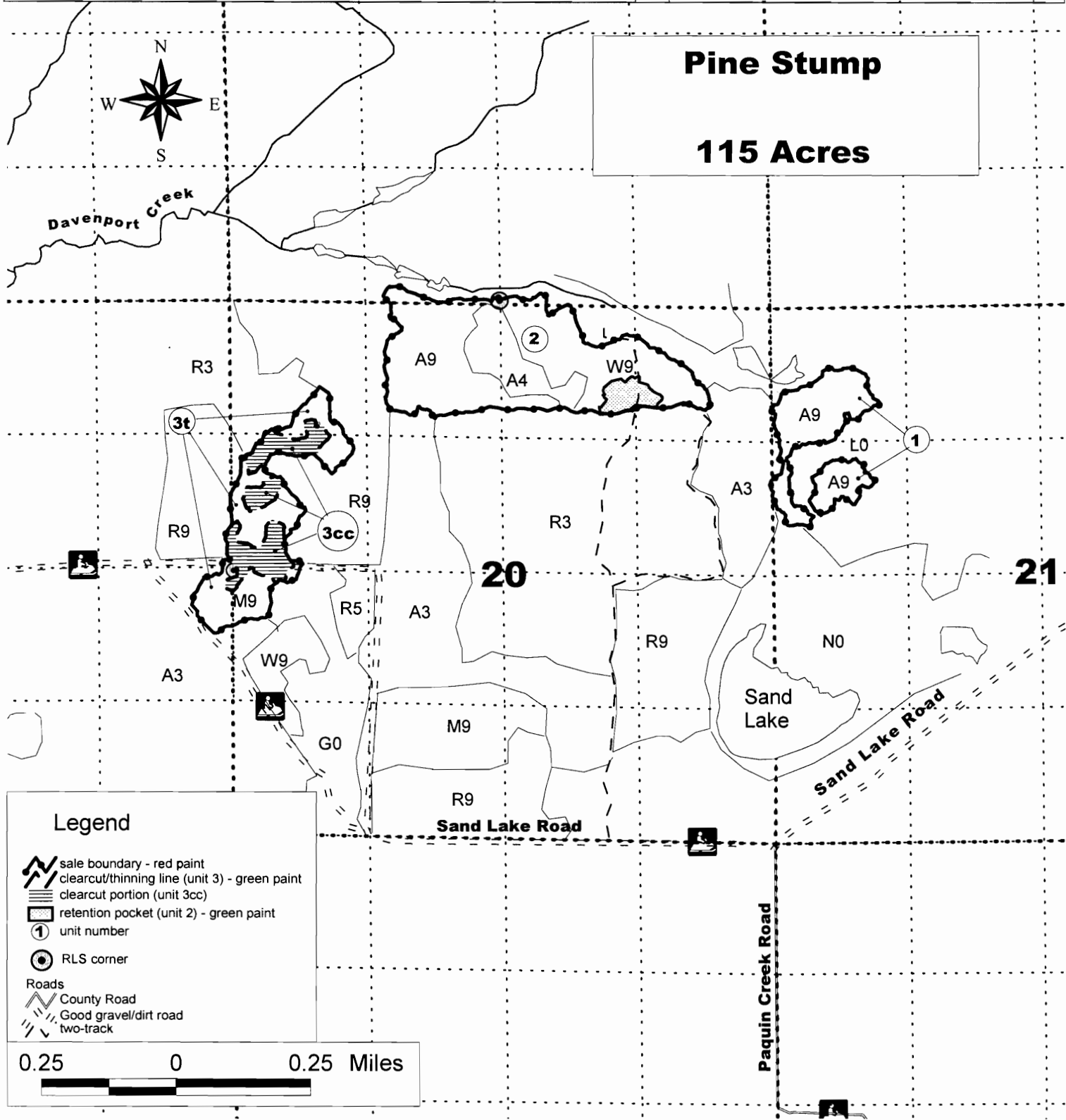

## Sale Specific Conditions & Requirements

**Sale Name: Pine Stump    Sale Number: 45-114-08-01**

### 1 - Sale Area

#### 1.2 - Boundaries

##### 1.2.1 - Painted boundaries (12/08)

The sale boundary and Payment Unit boundaries are marked and identified by red and green paint. Exterior sale boundary lines against state are marked with red paint. Interior Payment Unit boundaries (Unit 3cc/Unit 3t) and reserve areas (Unit 2 retention pocket) are marked with green paint.

### 2 - Timber Specifications

#### 2.1 - Included Timber

##### 2.1.1 - Clearcut unit(s) with unmerchantable trees (2/04)

Within Payment Unit(s) 1, 2 and 3cc, cut all deciduous trees that are two (2) inches or more in diameter measured at a point of four and one-half (4-1/2) feet above ground level regardless of merchantability, and cut all coniferous trees that are four (4) inches or more in diameter measured at a point of four and one-half (4-1/2) feet above ground level regardless of merchantability. Reserve areas identified in accordance with 2.1.13 - Reserve areas, within clearcutting unit boundaries, are not Included Timber and are to be protected. Leave trees identified in accordance with 2.1.10 - Leave trees, within clearcutting unit boundaries, are not Included Timber and are to be protected.

##### 2.1.4 - Species designation unit(s) (5/07)

Within Payment Unit(s) 3t, all aspen and beech trees are designated for cutting which meet minimum piece specifications in 2.2 Utilization. Many beech trees are declining due to Beech Bark Disease. Standing dead beech may be cut and processed. Leave trees identified in accordance with 2.1.10 - Leave trees, within species designation unit boundaries, are not Included Timber and are to be protected.

##### 2.1.10 - Leave trees (2/04)

Within Unit 1, leave all white pine, cedar and yellow birch. Within Unit 2, leave all white pine, red pine and juneberry. Within Unit 3 (3cc and 3t), leave all white pine, red pine; beech marked with red paint; and at least one dead beech/acre where present.

##### 2.1.11 - Description of timber note (2/04)

Note that mixed softwood is mainly white spruce, with some balsam and jack pine.

##### 2.1.13 - Reserve areas (6/07)

The Purchaser shall protect reserve areas from damage by the Purchaser's operations. Reserve areas are marked with a green boundary line (Unit 2 retention pocket). The Purchaser shall not cut live or dead trees within reserve areas.

#### 2.2 - Utilization

**Sale Name: Pine Stump Sale Number: 45-114-08-01**

2.2.4 - Skidding length (2/04)

Skidding of unlimbed tops or lengths over 17 feet is not permissible in Unit 3t unless approved by the Unit Manager or their representative.

### **3 - Payments**

#### **3.3 - Pre-measured Sales**

3.3.4 - Dividing payment units (7/05)

Payment unit(s) 1, 2 & 3 may be divided at the request of the purchaser and upon approval of the Unit Manager. Dividing payment units is a contract modification which requires a Timber Sale Contract Supplement.

### **4 - Transportation**

#### **4.1 - Construction**

4.1.7 - Road closure (4/07)

All new roads built into the sale must be blocked to vehicle traffic upon completion of the sale. Overgrown roads that are reopened shall be considered new roads. In general, this will require the placement of berms, stumps, slash and brush along 30 feet of the new road system. These roads must be rendered impassable to cars and trucks. Contact the sale administrator for specific details of design and placement.

### **5 - Operations**

#### **5.1 - Notification**

5.1.1 - Pre-sale conference (2/08)

A pre-sale conference on site between the Purchaser and sale administrator is required prior to beginning any operations. The Unit Manager or their representative must be contacted at least 10 days in advance to schedule the conference.

5.1.4 - Post-sale conference (2/04)

A post-sale conference on site between the Purchaser and sale administrator is required 5 days prior to the completion of active logging operations to determine clean-up and repair of landings, road edges, and the fulfillment of other contract specifications.

#### **5.2 - Conduct of Operations**

##### **5.2.2 - Hazard Trees/Snags**

5.2.2.1 - Den trees (2/04)

Obvious hollow and/or den trees shall be protected and left standing unless they are a safety hazard.

##### **5.2.3 - Operating Restrictions**

5.2.3.1 - Operating restrictions (12/08)

**Sale Name: Pine Stump Sale Number: 45-114-08-01**

Within Payment Unit(s) 3 (north of east-west road), unless changed by written agreement, cutting, skidding, and hauling are not permitted during the period of March 1 to September 30. This restriction is because of a hawk nest in the area.

**5.2.3.9 - Beech hauling restriction (8/09)**

American beech wood products with bark still attached, other than chips, are not to be transported from stands infested with beech bark disease to the lower peninsula from July 15 to November 15. Beech scale is mobile at this time of year and can move from infested wood to live beech. (See Map of current beech scale distribution on the DNR Forest Health Website, [www.michigan.gov/dnr](http://www.michigan.gov/dnr).)

**5.2.4 - Dead and Down Creation**

**5.2.4.3 - Dead and down creation, dead trees (6/07)**

Except as provided for in General Condition and Requirement 5.2.2, no dead trees, standing or down, are to be cut, skidded, or processed. Exception: Dead beech may be cut and processed within Unit 3 (3cc and 3t).

However, at least one dead beech/acre must be left where present.

**5.2.12 - Bark slippage restriction (3/07)**

Within Payment Unit(s) 3t, unless changed by written agreement, cutting, skidding, and hauling are not permitted during the period of April 15 to July 15. This restriction is because of bark slippage.

**5.2.22 - Operating Caution**

**5.2.22.1 - Operating caution (12/04)**

It is recommended, but not required, that within Payment Unit(s) 1, cutting, skidding, and hauling occur during dry summer or frozen winter conditions. This restriction is because of low ground on the edges of the stand.

**5.2.38 - No decking against live trees (2/04)**

Cut products may not be decked against unmarked or designated leave trees.

**5.2.41 - Snowmobile trail protection (4/07)**

The Paquin Creek Road and Sand Lake Road is a snowmobile trail and is shown on the Timber Sale Map. If the trail is used, it must be maintained and restored to a condition equal to or better than before the sale. Do not cut or damage posts with orange trail markers or traffic control signs. Maintain a 20 foot wide slash, debris, and rut free zone daily using the snowmobile trail as the centerline. If the trail road is to be used for hauling during the snowmobile season, then a snow covered base must be left on the trail. No decking of forest products will be permitted along the snowmobile trail during snowmobile season.

**5.4 - Soil Protection**

**5.4.1 - Rutting restriction, general (5/08)**

Operations are to cease immediately if equipment and weather conditions result in rutting of roads which is 12 inches or greater in depth and 50 feet in length. In addition, operations are to cease immediately if equipment and weather conditions result in rutting on skid trails which is 12 inches or greater in depth and 50 feet in length. The Unit Manager or their representative may restrict hauling and/or skidding if ruts exceed the specified depth. With the Unit Manager or their representative's approval, the Purchaser may return to the area when the weather conditions have changed and/or the risk of rutting has decreased.

## **5.8 - Protection of Endangered Species**

### 5.8.5 - Protection of raptor nests (12/08)

All trees with raptor nests will be protected if found during harvesting operations. Notification will be made to the Unit Manager and Wildlife Biologist so an on-site evaluation and recommendation can be made, if necessary.

## **6 - Safety and Fire Prevention**

### **6.2 - Signing**

#### 6.2.2 - Snowmobile trail posting (8/09)

The Purchaser is responsible for posting and maintaining caution signs on snowmobile trail #473 prior to beginning operations during the snowmobile season (approximately December 1 to March 31). The trail must be posted at appropriate distances from the sale area to warn of logging activity and truck traffic. Signs must be removed when harvest operations are suspended or completed. The Purchaser will provide these signs.

## **7 - Other Conditions**

### **7.3 - Contract Modifications**

#### **7.3.1 - Emerald Ash Borer**

##### 7.3.1.2 - Emerald ash borer, ash or firewood on sale (2/05)

There is ash and/or "firewood" in this sale and it is located within an emerald ash borer quarantined area. The Director of the Michigan Department of Agriculture (MDA) by the authority of Act No. 72 of the Public Acts of 1945, as amended, and Quarantine Regulation No. 620, has promulgated this quarantine to prevent the further spread of this pest and sets forth: definitions, regulated articles, regulated areas, conditions of movement, violations and penalties, and special exemptions. The purchaser must comply with this quarantine. Contact the MDA for further information.

### **7.5 - Loss**

#### 7.5.1 - Deteriorating timber (7/04)

The sale area has received damage from Beech Bark Disease (Unit 3). The purchaser should harvest the wood as soon as possible. The Department of Natural Resources is held free of responsibility of any further damage or deterioration due to delay in harvesting.

BORGSTROM NOMAD (107-08-01)  
T44N, R08W, SEC. 04, SWNW, E1/2NW, NE1/4, W1/2SW, NESW.  
T44N, R08W, SEC. 04, NWSE.  
MACKINAC COUNTY

In response to the notice of sale to be held 3:30 p.m. on April 20, 2010, I am hereby submitting my sealed bid (firm offer) for the following forest products to be cut. Bids for individual species and total bid value must be at or above the appraised price. All non-responsive bid forms may be rejected.

<u>SPECIES</u>	<u>APPRAISED PRICE</u>	<u>BID PRICE</u>	<u>ESTIMATED VOLUME* = VALUE</u>
PULPWOOD			
W. SPRUCE	\$ 14.90/CORD	\$ _____ X	632.00 CORDS = \$ _____
MIX ASPEN	\$ 17.90/CORD	\$ _____ X	198.00 CORDS = \$ _____
MISC. SP.	\$ 60.00/ACRES	\$ _____ X	49.00 ACRES = \$ _____
MIX HARDWD	\$ 19.40/CORD	\$ _____ X	344.00 CORDS = \$ _____
			SUBTOTAL 1 \$ _____

In addition, the successful bidder agrees to purchase the following species at the appraised price:

<u>SPECIES</u>	<u>APPRAISED PRICE</u>	<u>ESTIMATED VOLUME*</u>	<u>VALUE</u>
PULPWOOD			
P. BIRCH	\$ 16.25/CORD	53.00 CORDS	= \$ 861.25
BALSAM FIR	\$ 11.30/CORD	65.00 CORDS	= \$ 734.50
		SUBTOTAL 2	\$ <u>1,595.75</u>
SUBTOTAL 1 + SUBTOTAL 2 = TOTAL BID VALUE \$ _____			

\*These volumes are statistically estimated within plus (+) or minus (-) 11.00%. These estimated volumes are final and not subject to adjustment. Prospective bidders are urged to examine this timber and to make their own estimates of quantity and quality.

I understand that any or all bids may be rejected, and that the individual unit bid price will be the basis to determine total bid value. All bids must be signed and all bid items must be bid or the bid form may be rejected. I also understand that consideration and awarding a contract will be based upon my past performance and ability to complete the contract based upon equipment and manpower subject to my control.

\_\_\_\_\_  
(bidder's printed name)

\_\_\_\_\_  
(bidder's signature)

Address/Telephone \_\_\_\_\_

THE WINNING BIDDER MUST COMPLETE THE FORM ON THE REVERSE SIDE  
WITHIN 21 DAYS OF SALE AWARD



**TIMBER SALE  
VERIFICATION OF WORKER'S DISABILITY  
COMPENSATION ACT COMPLIANCE**

*As required by Act 317, P.A. 1969 (Worker's Compensation) and Part 525  
of Act 451 of 1994, as amended.*

**FOR DEPARTMENT USE ONLY**

Sale or Permit No	
Year:	Type:
Forest Area:	

**VERIFICATION OF WORKER'S DISABILITY COMPENSATION ACT COMPLIANCE**

- This verification must be completed and submitted within 21 days of contract award and prior to the issuance of the timber sale contract.
- In addition, if boxes 2B or 2C are checked, then Notice of Exclusion or Certificate of Insurance must be submitted within 21 days of the contract award and prior to the issuance of the timber sale contract.
- All Information must be typed or printed except for written signatures.

Please Check Appropriate Categories:

1. My business is organized as (you **must** check one of the boxes below):
  - A.  Sole Proprietorship (individual)
  - B.  Partnership
  - C.  Corporation
2. You **must** check one of the boxes below:
  - A.  I certify that my business is a sole proprietorship and it has no employees but the sole proprietor. I am not subject to the Worker's Compensation Laws.
  - B.  I certify that my business has satisfied its obligation to the Worker's Compensation Act through the use of an approved Notice of Exclusion (BWC-337, Rev. 5/96). I will provide a copy of the Notice of Exclusion within 21 days of the contract award. (For questions or a copy of the BWC-337, please call the Worker's Compensation Bureau at 517-322-1195).
  - C.  I certify that my business has a Worker's Compensation Policy. I will provide an original Certificate of Insurance within 21 days of the contract award.
3. If you have checked item 2(A) or 2(B), you **must** indicate the number of **both** full and part time employees other than yourself including family members and active partners (if none, you must enter "0").

\_\_\_\_\_ Full Time Employees

\_\_\_\_\_ Part Time Employees

Name of Business		Federal ID (or) Social Security No.	
Address		Telephone No. (       )	
City	State	Zip + 4	

I hereby certify that the above information is true and correct. I agree to notify the DNR of any changes that occur in factors affecting my coverage during any of my present and future operations.

\_\_\_\_\_  
Signature of Owner or Authorized Representative

\_\_\_\_\_  
Title

\_\_\_\_\_  
Date



TIMBER SALE / SEALED BID  
STATE OF MICHIGAN / DNR

SAULT STE. MARIE MANAGEMENT UNIT  
NAUBINWAY

ARMCHAIR SPRUCE 2 (107-09-01)  
T43N, R09W, SEC. 10, E1/2NE.  
MACKINAC COUNTY

In response to the notice of sale to be held 3:30 p.m. on April 20, 2010, I am hereby submitting my sealed bid (firm offer) for the following forest products to be cut. Bids for individual species and total bid value must be at or above the appraised price. All non-responsive bid forms may be rejected.

<u>SPECIES</u>	<u>APPRAISED PRICE</u>	<u>BID PRICE</u>	<u>ESTIMATED VOLUME* = VALUE</u>
PULPWOOD			
W. SPRUCE	\$ 19.65/CORD	\$ _____ X	201.00 CORDS = \$ _____
MIX ASPEN	\$ 19.80/CORD	\$ _____ X	63.00 CORDS = \$ _____
MIX HARDWD	\$ 18.75/CORD	\$ _____ X	140.00 CORDS = \$ _____
			SUBTOTAL 1 \$ _____

In addition, the successful bidder agrees to purchase the following species at the appraised price:

<u>SPECIES</u>	<u>APPRAISED PRICE</u>	<u>ESTIMATED VOLUME*</u>	<u>VALUE</u>
PULPWOOD			
BALSAM FIR	\$ 13.05/CORD	15.00 CORDS	= \$ 195.75
			SUBTOTAL 2 \$ 195.75
			SUBTOTAL 1 + SUBTOTAL 2 = TOTAL BID VALUE \$ _____

\*These volumes are statistically estimated within plus (+) or minus (-) 9.4%. These estimated volumes are final and not subject to adjustment. Prospective bidders are urged to examine this timber and to make their own estimates of quantity and quality.

I understand that any or all bids may be rejected, and that the individual unit bid price will be the basis to determine total bid value. All bids must be signed and all bid items must be bid or the bid form may be rejected. I also understand that consideration and awarding a contract will be based upon my past performance and ability to complete the contract based upon equipment and manpower subject to my control.

\_\_\_\_\_  
(bidder's printed name)

\_\_\_\_\_  
(bidder's signature)

Address/Telephone \_\_\_\_\_

THE WINNING BIDDER MUST COMPLETE THE FORM ON THE REVERSE SIDE  
WITHIN 21 DAYS OF SALE AWARD



**TIMBER SALE  
VERIFICATION OF WORKER'S DISABILITY  
COMPENSATION ACT COMPLIANCE**

*As required by Act 317, P.A. 1969 (Worker's Compensation) and Part 525  
of Act 451 of 1994, as amended.*

FOR DEPARTMENT USE ONLY	
Sale or Permit No	
Year:	Type:
Forest Area:	

**VERIFICATION OF WORKER'S DISABILITY COMPENSATION ACT COMPLIANCE**

- This verification must be completed and submitted within 21 days of contract award and prior to the issuance of the timber sale contract.
- In addition, if boxes 2B or 2C are checked, then Notice of Exclusion or Certificate of Insurance must be submitted within 21 days of the contract award and prior to the issuance of the timber sale contract.
- All Information must be typed or printed except for written signatures.

Please Check Appropriate Categories:

1. My business is organized as (you **must** check one of the boxes below):
  - A.  Sole Proprietorship (individual)
  - B.  Partnership
  - C.  Corporation
2. You **must** check one of the boxes below:
  - A.  I certify that my business is a sole proprietorship and it has no employees but the sole proprietor. I am not subject to the Worker's Compensation Laws.
  - B.  I certify that my business has satisfied its obligation to the Worker's Compensation Act through the use of an approved Notice of Exclusion (BWC-337, Rev. 5/96). I will provide a copy of the Notice of Exclusion within 21 days of the contract award. (For questions or a copy of the BWC-337, please call the Worker's Compensation Bureau at 517-322-1195).
  - C.  I certify that my business has a Worker's Compensation Policy. I will provide an original Certificate of Insurance within 21 days of the contract award.
3. If you have checked item 2(A) or 2(B), you **must** indicate the number of **both** full and part time employees other than yourself including family members and active partners (if none, you must enter "0").

\_\_\_\_\_ Full Time Employees

\_\_\_\_\_ Part Time Employees

Name of Business		Federal ID (or) Social Security No.	
Address		Telephone No. (       )	
City	State	Zip + 4	

I hereby certify that the above information is true and correct. I agree to notify the DNR of any changes that occur in factors affecting my coverage during any of my present and future operations.

\_\_\_\_\_  
Signature of Owner or Authorized Representative

\_\_\_\_\_  
Title

\_\_\_\_\_  
Date

RING AROUND THE ROSY (113-08-01)  
 T44N, R09W, SEC. 02, SE1/4.  
 T44N, R09W, SEC. 11, N1/2.  
 MACKINAC COUNTY

In response to the notice of sale to be held 3:30 p.m. on April 20, 2010, I am hereby submitting my sealed bid (firm offer) for the following forest products to be cut. Bids for individual species and total bid value must be at or above the appraised price. All non-responsive bid forms may be rejected.

<u>SPECIES</u>	<u>APPRAISED PRICE</u>	<u>BID PRICE</u>	<u>ESTIMATED VOLUME* = VALUE</u>
<u>PULPWOOD</u>			
P. BIRCH	\$ 14.30/CORD	\$ _____ X	338.00 CORDS = \$ _____
W. SPRUCE	\$ 13.10/CORD	\$ _____ X	469.00 CORDS = \$ _____
MIX HARDWD	\$ 17.05/CORD	\$ _____ X	499.00 CORDS = \$ _____
			SUBTOTAL 1 \$ _____

In addition, the successful bidder agrees to purchase the following species at the appraised price:

<u>SPECIES</u>	<u>APPRAISED PRICE</u>	<u>ESTIMATED VOLUME*</u>	<u>VALUE</u>
<u>SAWLOGS</u>			
RED MAPLE	\$ 126.00/MBF	8.00 MBF	= \$ 1,008.00
P. BIRCH	\$ 180.00/MBF	6.20 MBF	= \$ 1,116.00
BLK CHERRY	\$ 288.00/MBF	2.40 MBF	= \$ 691.20
<u>PULPWOOD</u>			
BALSAM FIR	\$ 9.80/CORD	203.00 CORDS	= \$ 1,989.40
MIX ASPEN	\$ 16.70/CORD	17.00 CORDS	= \$ 283.90
			SUBTOTAL 2 \$ <u>5,088.50</u>

SUBTOTAL 1 + SUBTOTAL 2 = TOTAL BID VALUE \$ \_\_\_\_\_

\*These volumes are statistically estimated within plus (+) or minus (-) 13.07%. These estimated volumes are final and not subject to adjustment. Prospective bidders are urged to examine this timber and to make their own estimates of quantity and quality.

I understand that any or all bids may be rejected, and that the individual unit bid price will be the basis to determine total bid value. All bids must be signed and all bid items must be bid or the bid form may be rejected. I also understand that consideration and awarding a contract will be based upon my past performance and ability to complete the contract based upon equipment and manpower subject to my control.

\_\_\_\_\_  
 (bidder's printed name)

\_\_\_\_\_  
 (bidder's signature)

Address/Telephone \_\_\_\_\_

THE WINNING BIDDER MUST COMPLETE THE FORM ON THE REVERSE SIDE  
 WITHIN 21 DAYS OF SALE AWARD



**FOR DEPARTMENT USE ONLY**

**TIMBER SALE  
VERIFICATION OF WORKER'S DISABILITY  
COMPENSATION ACT COMPLIANCE**

*As required by Act 317, P.A. 1969 (Worker's Compensation) and Part 525  
of Act 451 of 1994, as amended.*

Sale or Permit No

Year:

Type:

Forest Area:

**VERIFICATION OF WORKER'S DISABILITY COMPENSATION ACT COMPLIANCE**

- This verification must be completed and submitted within 21 days of contract award and prior to the issuance of the timber sale contract.
- In addition, if boxes 2B or 2C are checked, then Notice of Exclusion or Certificate of Insurance must be submitted within 21 days of the contract award and prior to the issuance of the timber sale contract.
- All Information must be typed or printed except for written signatures.

Please Check Appropriate Categories:

1. My business is organized as (you **must** check one of the boxes below):

- A.  Sole Proprietorship (individual)
- B.  Partnership
- C.  Corporation

2. You **must** check one of the boxes below:

- A.  I certify that my business is a sole proprietorship and it has no employees but the sole proprietor. I am not subject to the Worker's Compensation Laws.
- B.  I certify that my business has satisfied its obligation to the Worker's Compensation Act through the use of an approved Notice of Exclusion (BWC-337, Rev. 5/96). I will provide a copy of the Notice of Exclusion within 21 days of the contract award. (For questions or a copy of the BWC-337, please call the Worker's Compensation Bureau at 517-322-1195).
- C.  I certify that my business has a Worker's Compensation Policy. I will provide an original Certificate of Insurance within 21 days of the contract award.

3. If you have checked item 2(A) or 2(B), you **must** indicate the number of **both** full and part time employees other than yourself including family members and active partners (if none, you must enter "0").

\_\_\_\_\_ Full Time Employees

\_\_\_\_\_ Part Time Employees

Name of Business

Federal ID (or) Social Security No.

Address

Telephone No.  
(       )

City

State

Zip + 4

I hereby certify that the above information is true and correct. I agree to notify the DNR of any changes that occur in factors affecting my coverage during any of my present and future operations.

\_\_\_\_\_  
Signature of Owner or Authorized Representative

\_\_\_\_\_  
Title

\_\_\_\_\_  
Date

PINE STUMP (114-08-01)  
 T43N, R07W, SEC. 17, SESW, SWSE.  
 T43N, R07W, SEC. 19, SENE, NESE.  
 T43N, R07W, SEC. 20, N1/2N1/2, SWNW, NWSW.  
 T43N, R07W, SEC. 21, W1/2NW.  
 MACKINAC COUNTY

In response to the notice of sale to be held 3:30 p.m. on April 20, 2010, I am hereby submitting my sealed bid (firm offer) for the following forest products to be cut. Bids for individual species and total bid value must be at or above the appraised price. All non-responsive bid forms may be rejected.

<u>SPECIES</u>	<u>APPRAISED PRICE</u>	<u>BID PRICE</u>	<u>ESTIMATED VOLUME* = VALUE</u>
<u>PULPWOOD</u>			
MIX ASPEN	\$ 11.40/CORD	\$ _____ X	615.00 CORDS = \$ _____
MIX SOFTWD	\$ 12.25/CORD	\$ _____ X	250.00 CORDS = \$ _____
MIX HARDWD	\$ 11.20/CORD	\$ _____ X	357.00 CORDS = \$ _____
SUBTOTAL 1			\$ _____

In addition, the successful bidder agrees to purchase the following species at the appraised price:

<u>SPECIES</u>	<u>APPRAISED PRICE</u>	<u>ESTIMATED VOLUME*</u>	<u>VALUE</u>
<u>SAWLOGS</u>			
SUG. MAPLE	\$ 321.00/MBF	1.00 MBF	= \$ 321.00
SUBTOTAL 2			\$ 321.00
SUBTOTAL 1 + SUBTOTAL 2 = TOTAL BID VALUE \$ _____			

\*These volumes are statistically estimated within plus (+) or minus (-) 18.19%. These estimated volumes are final and not subject to adjustment. Prospective bidders are urged to examine this timber and to make their own estimates of quantity and quality.

I understand that any or all bids may be rejected, and that the individual unit bid price will be the basis to determine total bid value. All bids must be signed and all bid items must be bid or the bid form may be rejected. I also understand that consideration and awarding a contract will be based upon my past performance and ability to complete the contract based upon equipment and manpower subject to my control.

\_\_\_\_\_  
 (bidder's printed name)

\_\_\_\_\_  
 (bidder's signature)

Address/Telephone \_\_\_\_\_

THE WINNING BIDDER MUST COMPLETE THE FORM ON THE REVERSE SIDE  
 WITHIN 21 DAYS OF SALE AWARD



**TIMBER SALE  
VERIFICATION OF WORKER'S DISABILITY  
COMPENSATION ACT COMPLIANCE**

*As required by Act 317, P.A. 1969 (Worker's Compensation) and Part 525 of Act 451 of 1994, as amended.*

Sale or Permit No

Year:

Type:

Forest Area:

**VERIFICATION OF WORKER'S DISABILITY COMPENSATION ACT COMPLIANCE**

- This verification must be completed and submitted within 21 days of contract award and prior to the issuance of the timber sale contract.
- In addition, if boxes 2B or 2C are checked, then Notice of Exclusion or Certificate of Insurance must be submitted within 21 days of the contract award and prior to the issuance of the timber sale contract.
- All information must be typed or printed except for written signatures.

Please Check Appropriate Categories:

1. My business is organized as (you **must** check one of the boxes below):
  - A.  Sole Proprietorship (individual)
  - B.  Partnership
  - C.  Corporation
2. You **must** check one of the boxes below:
  - A.  I certify that my business is a sole proprietorship and it has no employees but the sole proprietor. I am not subject to the Worker's Compensation Laws.
  - B.  I certify that my business has satisfied its obligation to the Worker's Compensation Act through the use of an approved Notice of Exclusion (BWC-337, Rev. 5/96). I will provide a copy of the Notice of Exclusion within 21 days of the contract award. (For questions or a copy of the BWC-337, please call the Worker's Compensation Bureau at 517-322-1195).
  - C.  I certify that my business has a Worker's Compensation Policy. I will provide an original Certificate of Insurance within 21 days of the contract award.
3. If you have checked item 2(A) or 2(B), you **must** indicate the number of **both** full and part time employees other than yourself including family members and active partners (if none, you must enter "0").

\_\_\_\_\_ Full Time Employees

\_\_\_\_\_ Part Time Employees

Name of Business		Federal ID (or) Social Security No.	
Address		Telephone No. (       )	
City	State	Zip + 4	

I hereby certify that the above information is true and correct. I agree to notify the DNR of any changes that occur in factors affecting my coverage during any of my present and future operations.

\_\_\_\_\_  
Signature of Owner or Authorized Representative

\_\_\_\_\_  
Title

\_\_\_\_\_  
Date