



DEPARTMENT OF NATURAL RESOURCES AND ENVIRONMENT
STATE OF MICHIGAN

TIMBER SALE PROSPECTUS

SALE TIME, DATE AND LOCATION
9:00 a.m. on January 20, 2011
VANDERBILT

Notice is hereby given that bids will be received by the Unit Manager, PIGEON RIVER MANAGEMENT UNIT, for certain timber on the following described lands. The bidder is advised to inspect the sale area and review the location, estimated volumes, operating costs, and sale contract terms of the proposed sale.

SEVEN STAND MIX / T31N, R01W, SEC. 04, S1/2SE.

T31N, R01W, SEC. 09, W1/2NE, SENE, NWSE, E1/2SE.

OTSEGO COUNTY (Appr. \$10,647.60)

SALE ACRES: 33

No designated recreation site such as a trail, pathway, or campground is within the sale area or the vicinity.

Access may be through state forest land.

CREEKSIDЕ SOFTWOOD / T34N, R01W, SEC. 24, W1/2 OF SW1/4, NE/SW.

T34N, R01W, SEC. 25, NW/NW.

CHEBOYGAN COUNTY (Appr. \$15,235.65)

SALE ACRES: 27

No designated recreation site such as a trail, pathway, or campground is within the sale area or the vicinity.

Access may be through state forest land.

TAXIDEA MIX / T32N, R01W, SEC. 22, E1/2SW, NWNE, S1/2NE.

OTSEGO COUNTY (Appr. \$19,428.75)

SALE ACRES: 37

A recreation site such as a trail, pathway, or campground is within the sale area or the vicinity. Certain restrictions/specifications may be applicable including time restrictions.

Access may be through state forest land.

Please be aware that some landowners may request 60 days or more notice for forest harvesting access across their land.

NOTICE OF CHANGE IN GENERAL CONDITIONS AND REQUIREMENTS COMMON TO ALL STATE FOREST TIMBER SALE CONTRACTS

In May 2010, the Woody Biomass Harvesting Guidance was approved by the Chief of Forest Management Division. The purpose of the Woody Biomass Harvesting Guidance is to provide a broad context for harvesting woody biomass from forest land within a sustainable forest management framework, as well as specific technical recommendations. The Woody Biomass Harvesting Guidance will be applied to State Forest System management activities. It is recommended that this guidance be applied to all forest land in Michigan.

General Condition and Requirement 2.2 - Utilization, has been updated to implement The Woody Biomass Harvesting Guidance and the revised specification will be included with the contracts advertised with this prospectus. The wording has been changed so that unless otherwise specified in the contract, approximately 1/6 to 1/3 of tree tops and limbs less than four inches in diameter from designated trees not meeting utilized standards will be retained on site. The new specification is as follows with changes in **bold**:

2.2 - Utilization

Unless otherwise indicated in this contract, the DNRE product standards are based on utilization of a 100" piece to a top diameter inside bark of 8 inches for sawlogs in the northern Lower Peninsula, 10 inches for sawlogs in the Upper Peninsula and 4 inches for pulpwood. **Wood from designated trees not meeting these standards may be utilized, except retain approximately 1/6 to 1/3 of tree tops and limbs less than four inches in diameter, unless otherwise specified in this contract.**

If not otherwise specified, the maximum stump height shall not exceed 24 inches for sawlogs or 12 inches for pulpwood. Higher stumps resulting from multiple stemmed trees may be left if authorized by the Unit Manager or his/her representative. The Purchaser shall not cut stumps lower than the DNRE paint markings that indicate individual products to be cut. **Avoid removal of the forest litter layer, forest floor or below-ground biomass, including stumps and roots.**

BID INSTRUCTIONS (Ver. 06/23/2008):

1. Bid Location, Date, and Time: Bids must be received by the Unit Manager, Pigeon River Country Management Unit, 9966 Twin Lakes Road, Vanderbilt, Michigan 49795, no later than 9:00 a.m., on January 20, 2011. For further information concerning this sale, contact the Unit Manager at 989-983-4101.
2. Bidder's Qualifications: Purchaser shall obtain workers compensation insurance to cover claims under Michigan's Worker's Disability Compensation Act of 1969 or similar employee benefit act of any other state applicable to an employee. If all or part of a timber sale was prepared by a private contractor, that contractor and that contractor's company are not permitted to bid on the timber sale contract. Bids will not be accepted from individuals or companies appearing on the DNR/FMFM No-Bid List. This list contains the names of purchasers who previously failed to execute a contract within 21-days or who have a history of poor performance.
3. Preparation of Sealed Bids: Bids shall be manually signed in ink; bid prices must be entered for each species and product in the Bid Price column for all material subject to bidding; and all fill-in blanks must be completed. If erasures or other changes appear on the forms, each erasure or change must be initialed by the person signing the bid.
4. Submission of Sealed Bids: Bid forms may be obtained from the Unit Manager. All bids must be submitted on the bid form and in an envelope clearly identified as described in this section. NOTE: Only one bid form per bid envelope. Sealed bids must be submitted to the Unit office designated in the prospectus and must be submitted at or prior to the time established in the prospectus. The envelope should show on the outside (a) that it is a "Bid for Timber," and (b) the sale name or number, and (c) the date and time of bid opening as shown in the prospectus. Bids received after the time specified in the sale prospectus are late bids and will be rejected.
5. Public Opening of Sealed Bids: If conditions permit, the sealed bids will be publicly opened and posted at the time and place set in the prospectus.
6. Award of Contract: Award of the contract will be made to the Bidder whose bid, conforming to the prospectus, is most advantageous to the State of Michigan on the basis of total value at rates bid for the estimated quantities. The State reserves the right to reject any bid or waive any minor irregularity in bids received. A written award mailed (or otherwise furnished) to the successful Bidder shall be deemed to result in a binding contract without further action by either party.
7. Down Payment: The Bidder to whom award is made must make a down payment within 21 days of the sale award. The amount of the down payment will be calculated as shown in the Bond and Payment Schedule of this prospectus. Only cash may be used to meet this requirement.
8. Performance Security: As guarantee of faithful performance, a cash bond, certificate of deposit, surety bond or irrevocable letter of credit (LOC) is required within 21 days of the sale award. The amount of the performance security is shown in the Bond and Payment Schedule of this prospectus. If an LOC or surety is used, the coverage must extend for at least 6 months beyond the contract expiration.
9. Timber Sale Contract: Additional conditions and requirements common to all timber sales are listed on the timber sale contract (R4031) and are available on line at www.michigan.gov/dnr. Contact the Unit Manager for additional information or a sample contract. Within 21 days of the date of the award letter, the bidder must sign the contract and provide the required down payment, performance security, and verification of worker's disability compensation. The down payment and performance security shall be in accordance with the provisions of the timber sale contract, in the sums stated in this prospectus. If these actions are not taken, then the Bidder, the Bidder's corporation, and the corporation's principals may not be permitted to bid on State timber sales for a period of 1 year. In addition, the Bidder certifies that if awarded this contract, the Bidder will complete the timber sale contract in accordance with its terms and any modifications thereof including requirements to purchase, cut, and remove the included timber by the termination date.

10. Disclaimer of Estimates and Bidder's Warranty of Inspection: Before submitting this bid, the Bidder is advised and cautioned to inspect the sale area, review the requirements of the sale contract, and take other steps as may be reasonably necessary to ascertain the location, estimated volumes, construction estimates, and operating costs of the proposed sale. Failure to do so will not relieve the Bidder from responsibility for completing the contract.

The Bidder warrants that this bid is submitted solely on the basis of the Bidder's examination and inspection of the quality and quantity of the timber offered for sale and the Bidder's opinion of the value thereof and the costs of recovery. No reliance should be placed on the State of Michigan's estimates of timber quality, quantity or costs of recovery. Bidder further acknowledges that the State of Michigan: (i) expressly disclaims any warranty of fitness of timber for any purpose; (ii) offers this timber as is without any warranty of quality (merchantability) or quantity and (iii) expressly disclaims any warranty as to the quantity or quality of timber sold.

11. Certification and Chain-of-Custody: Unless otherwise indicated in the contract under section 7 - Other Conditions of the Sale Specific Conditions & Requirements, the area encompassed by this timber sale is certified to the standards of the Forest Stewardship Council (FSC) - Certificate #SCS-FM/COC-090N and the Sustainable Forestry Initiative (SFI) - Certificate # NSF-SFIS-5Y031-S1. Forest products from this sale may be delivered to the mill as "FSC and / or SFI certified" as long as the contractor hauling the forest products is chain-of-custody (COC) certified or covered under a COC certificate from the destination mill. The purchaser is responsible for maintaining COC after leaving the sale area.

REBECCA A. HUMPHRIES
Director

SEVEN STAND MIX (006-10-01)

A timber sale contract for this LUMP SUM SEALED timber sale will be awarded the responsible bidder offering the highest sealed bid price. Bids must be at or above the following appraised price for each species:

<u>SPECIES</u>	<u>ESTIMATED VOLUME*</u>	<u>APPRAISED PRICE</u>
SAWLOGS		
B.T. ASPEN	22.00 MBF	\$ 88.00/MBF
PULPWOOD		
MIX ASPEN	291.00 CORDS	\$ 21.10/CORD

In addition, the successful bidder agrees to purchase the following species at the indicated appraised price:

<u>SPECIES</u>	<u>ESTIMATED VOLUME*</u>	<u>APPRAISED PRICE</u>
SAWLOGS		
WHITE PINE	4.00 MBF	\$ 49.00/MBF
RED PINE	7.00 MBF	\$ 116.00/MBF
PULPWOOD		
P. BIRCH	4.00 CORDS	\$ 9.40/CORD
BALSAM FIR	3.00 CORDS	\$ 4.15/CORD
B. SPRUCE	48.00 CORDS	\$ 5.70/CORD
WHITE PINE	26.00 CORDS	\$ 8.70/CORD
RED PINE	23.00 CORDS	\$ 29.95/CORD
MIX HARDWD	32.00 CORDS	\$ 10.15/CORD

*The volumes are statistically estimated within plus (+) or minus (-) 23.07 percent. These estimated volumes are final and not subject to adjustment. Prospective bidders are urged to examine this timber and to make their own estimates of quantity and quality.

BOND AND PAYMENT SCHEDULE:

1. A bond in the amount of \$500.00 to insure faithful performance of the conditions of the contract, will be deposited by the successful bidder within 21 days of the sale award.
2. Cutting in any sale or unit without the required advance payment would be considered a trespass.
3. Total payment may be paid in advance or according to the following schedule:
 - (a) Ten percent (10%) of the sale value must be paid within 21 days of the sale award.
 - (b) The 10% down payment will be credited towards the first unit cut.
 - (c) Payment for each of the following units must be made before cutting begins in that unit:

<u>PAYMENT UNIT NUMBER</u>	<u>PERCENT OF TOTAL SALE VALUE</u>
1	20%
2	40%
3	40%

4. If no cutting takes place, the 10% down payment will not be refunded.
5. Operations on the contract issued will terminate on December 31, 2013.



Michigan Department of Natural Resources - Forest, Mineral & Fire Management

TIMBER SALE MAP

This information provided by authority of Part 525 of Act 451, PA 1994, as amended.

Sale Number	Year
53-006-10-01	10

Forest Management Unit Pigeon River	County Otsego	Mapped By Zach Crow	Date 4/27/10	Page of
Township 31N	Range 01W	Cruised By Zach Crow	Section(s) and Subdivision(s) 4+9 - S 1/2 SE + W 1/2 NE, SE/NE, NW/SE, E 1/2 SE	

1" = 1/4 mile

Cover Type				Density	
A = Aspen	G = Grass	O = Oak	U = Upland Brush	0 = Non Stocked	5 = Pole Timber Medium
B = Paper Birch	H = Hemlock	P = Lowland Poplar	V = Bog or Marsh	1 = Seedling Sapling Poor	6 = Pole Timber Well
C = Cedar	J = Jack Pine	Q = Mixed Swamp Cnfr	W = White Pine	2 = Seedling Sapling Medium	7 = Saw Timber Poor
D = Tréed Bog	L = Lowland Brush	R = Red Pine	X = Non Stocked	3 = Seedling Sapling Well	8 = Saw Timber Medium
E = Swamp Hdwoods	M = Mpl, Bch, Brch	S = Black Spruce	Z = Water	4 = Pole Timber Poor	9 = Saw Timber Well
F = Spruce Fir	N = Marsh	T = Tamarack			

Seven Standi Mix
Otsego County
33 Sale Acres
32 Cut Acres

Unit 1: 6 acres
Unit 2: 13 acres
Unit 3: 14 acres

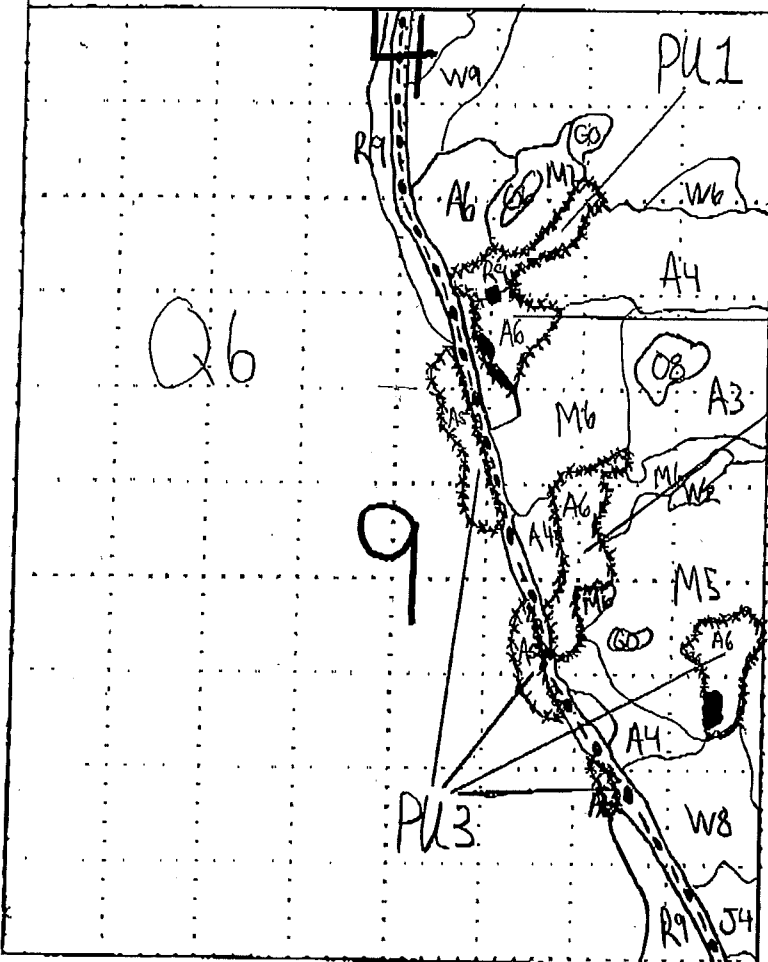
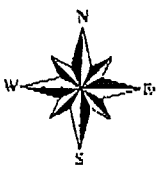

Legend

- = Red Line
- = Yellow Line
- PU = Payment Unit
- = Last Cabin Trail
- = Pipeline
- = Retention (Red x)

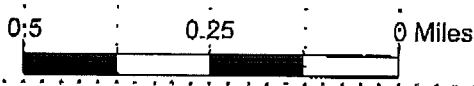

Sale Specific Conditions & Requirements

Sale Name: Seven Stand Mix Sale Number: 53-006-10-01

1 - Sale Area

1.2 - Boundaries

1.2.1 - Painted boundaries (12/08)

The sale boundary and Payment Unit boundaries are marked and identified by red and yellow paint. Exterior sale boundary lines against state are marked with red paint. Interior Payment Unit boundaries are marked with yellow paint. Do not cut painted boundary line trees unless also marked with orange paint. Yellow painted trees designating an interior Payment Unit boundary are only to be cut when all surrounding Payment Units have been paid.

2 - Timber Specifications

2.1 - Included Timber

2.1.1 - Clearcut unit(s) with unmerchantable trees (4/09)

Within Payment Unit(s) 2 and 3, cut all trees that are two (2) inches or more in diameter measured at a point four and one-half (4-1/2) feet above ground level regardless of merchantability except Oak and hawthorn, which must be protected.

2.1.3 - Cut tree marked unit(s) (12/08)

Within Payment Unit(s) 1, all trees are designated for cutting when marked with orange paint above and below stump height, regardless of merchantability.

3 - Payments

3.6 - Payment Unit Cutting Schedule

3.6.2 - One active unit (12/08)

Each Payment Unit must be completed to the satisfaction of the Unit Manager or his/her representative before the next unit may be opened. The Purchaser must give a one week notice before finishing a unit to allow for inspection.

4 - Transportation

4.1 - Construction

4.1.3 - Slash and earthen piles (8/04)

Piles or windrows of earth along roads and landings that have been widened or constructed shall be leveled. Slash from road maintenance or construction, including stumps, shall be dispersed throughout the sale.

4.1.12 - No new roads (12/08)

No new roads will be permitted in any Payment Unit. All operations are limited to existing roads.

4.2 - Maintenance

4.2.5 - Two wheel drive condition (2/04)

All existing trail roads on and adjacent to the sale area must be passable by two-wheel drive traffic for the duration of the sale.

5 - Operations

5.1 - Notification

5.1.1 - Pre-sale conference (12/08)

A pre-sale conference on site between the Purchaser and sale administrator is required prior to beginning any operations to determine landing and road locations. The Unit Manager or his/her representative must be contacted at least 10 days in advance to schedule the conference.

5.1.3 - Well heads and natural gas pipelines (7/07)

The Purchaser is responsible for contacting the gas or pipeline company prior to operating equipment in the vicinity of well heads or natural gas pipelines. Written permission is required before harvest operations begin and must be submitted to the Unit Manager.

5.2 - Conduct of Operations

5.2.1 - Slash

5.2.1.2 - Slash Removal

5.2.1.2.1 - Slash removal, right-of-way (12/04)

All slash must be removed at least 25 feet from the cleared right-of-way of forest roads.

5.2.1.9 - No Slash:pipe/powerline, oil/gas sites (2/04)

All pipelines, power lines, oil or gas storage sites and related access roads are to remain free of slash at all times.

5.2.2 - Hazard Trees/Snags

5.2.2.1 - Den trees (2/04)

Obvious hollow and/or den trees shall be protected and left standing unless they are a safety hazard.

5.2.38 - No decking against live trees (2/04)

Cut products may not be decked against unmarked or designated leave trees.

5.4 - Soil Protection

5.4.1 - Rutting restriction, general (1/09)

Operations are to cease immediately if equipment and weather conditions result in rutting of roads and skid trails which is 12 inches or greater in depth and 50 feet in length. The Unit Manager or his/her representative may restrict hauling and/or skidding if ruts exceed the specified depth. With the Unit Manager or his/her representative's approval, the Purchaser may return to the area when the risk of rutting has decreased.

5.4.2 - Skid trails (2/04)

Skid trails up and down slopes should be avoided. If however this is unavoidable, these trails will be left in a non-erodible condition using water bars, logs, and slash. Placing of slash on these skid trails while logging is ongoing may alleviate need for any further action. At the direction of the sale administrator, seed, fertilizer, and mulch may also be required.

5.4.4 - Slope protection (2/04)

Skid trails and roads on slopes shall be water barred with slash, stumps, and/or hay bales as soon as use is complete to prevent erosion.

5.4.5 - Soil caution (11/04)

Care must be taken on the west side of Lost Cabin Trail to minimize damage due to the organic soils in the area of the timber sale.

5.8 - Protection of Endangered Species

5.8.5 - Protection of raptor nests (4/09)

All trees with raptor nests will be protected if found during harvesting operations. Notification will be made to the Unit Manager or his/her representative who will notify the Wildlife Biologist so an on-site evaluation and recommendation can be made, if necessary.

6 - Safety and Fire Prevention

6.2 - Signing

6.2.1 - Road posting (9/09)

The purchaser is responsible for posting and maintaining caution signs on Lost Cabin Trail prior to beginning operations. The road must be posted at appropriate distances from the sale area to warn of logging activity and truck traffic. Signs must be removed when harvest operations are suspended or completed. The Purchaser will provide these signs.

CREEKSIDE SOFTWOOD (016-10-01)

A timber sale contract for this LUMP SUM SEALED timber sale will be awarded the responsible bidder offering the highest sealed bid price. Bids must be at or above the following appraised price for each species:

<u>SPECIES</u>	<u>ESTIMATED VOLUME*</u>	<u>APPRAISED PRICE</u>
SAWLOGS		
RED PINE	89.00 MBF	\$ 109.00/MBF
PULPWOOD		
B. SPRUCE	334.00 CORDS	\$ 7.00/CORD
RED PINE	66.00 CORDS	\$ 29.70/CORD

In addition, the successful bidder agrees to purchase the following species at the indicated appraised price:

<u>SPECIES</u>	<u>ESTIMATED VOLUME*</u>	<u>APPRAISED PRICE</u>
SAWLOGS		
WHITE PINE	1.00 MBF	\$ 47.00/MBF
PULPWOOD		
RED MAPLE	27.00 CORDS	\$ 10.10/CORD
BALSAM FIR	8.00 CORDS	\$ 7.00/CORD
WHITE PINE	5.00 CORDS	\$ 8.15/CORD
JACK PINE	82.00 CORDS	\$ 10.00/CORD

*The volumes are statistically estimated within plus (+) or minus (-) 18.7 percent. These estimated volumes are final and not subject to adjustment. Prospective bidders are urged to examine this timber and to make their own estimates of quantity and quality.

BOND AND PAYMENT SCHEDULE:

1. A bond in the amount of \$1,000.00 to insure faithful performance of the conditions of the contract, will be deposited by the successful bidder within 21 days of the sale award.
2. Cutting in any sale or unit without the required advance payment would be considered a trespass.
3. Total payment may be paid in advance or according to the following schedule:
 - (a) Ten percent (10%) of the sale value must be paid within 21 days of the sale award.
 - (b) The 10% down payment will be credited towards the first unit cut.
 - (c) Payment for each of the following units must be made before cutting begins in that unit:

<u>PAYMENT UNIT NUMBER</u>	<u>PERCENT OF TOTAL SALE VALUE</u>
1	20%
2	50%
3	30%

4. If no cutting takes place, the 10% down payment will not be refunded.
5. Operations on the contract issued will terminate on June 30, 2013.



Sale Number	Year
53-016-10-01	2010

Forest Management Unit	County	Mapped By	Date	Page	of
Pigeon River Country FMU	Cheboygan	Rick McDonald	08/17/2010		
Township	Range	Section(s) and Subdivision(s)	Scale		
34N	01W	(24) W $\frac{1}{2}$ of SW $\frac{1}{4}$, NE/SW (25) NW/NW	1" = 4" ... 1" = 1 mile		

Cover Type				Density	
A = Aspen	H = Hemlock	P = Lowland Poplar	V = Bog or Marsh	0 = Non Stocked	5 = Pole Timber Medium
B = Paper Birch	J = Jack Pine	Q = Mixed Swamp Cnfr	W = White Pine	1 = Seedling Sapling Poor	6 = Pole Timber Well
C = Cedar	L = Lowland Brush	R = Red Pine	X = Non Stocked	2 = Seedling Sapling Medium	7 = Saw Timber Poor
E = Swamp Hdwoods	M = Mpl, Bch, Brch	S = Black Spruce	Z = Water	3 = Seedling Sapling Well	8 = Saw Timber Medium
F = Spruce Fir	N = Marsh	T = Tamarack		4 = Pole Timber Poor	9 = Saw Timber Well
G = Grass	O = Oak	U = Upland Brush			

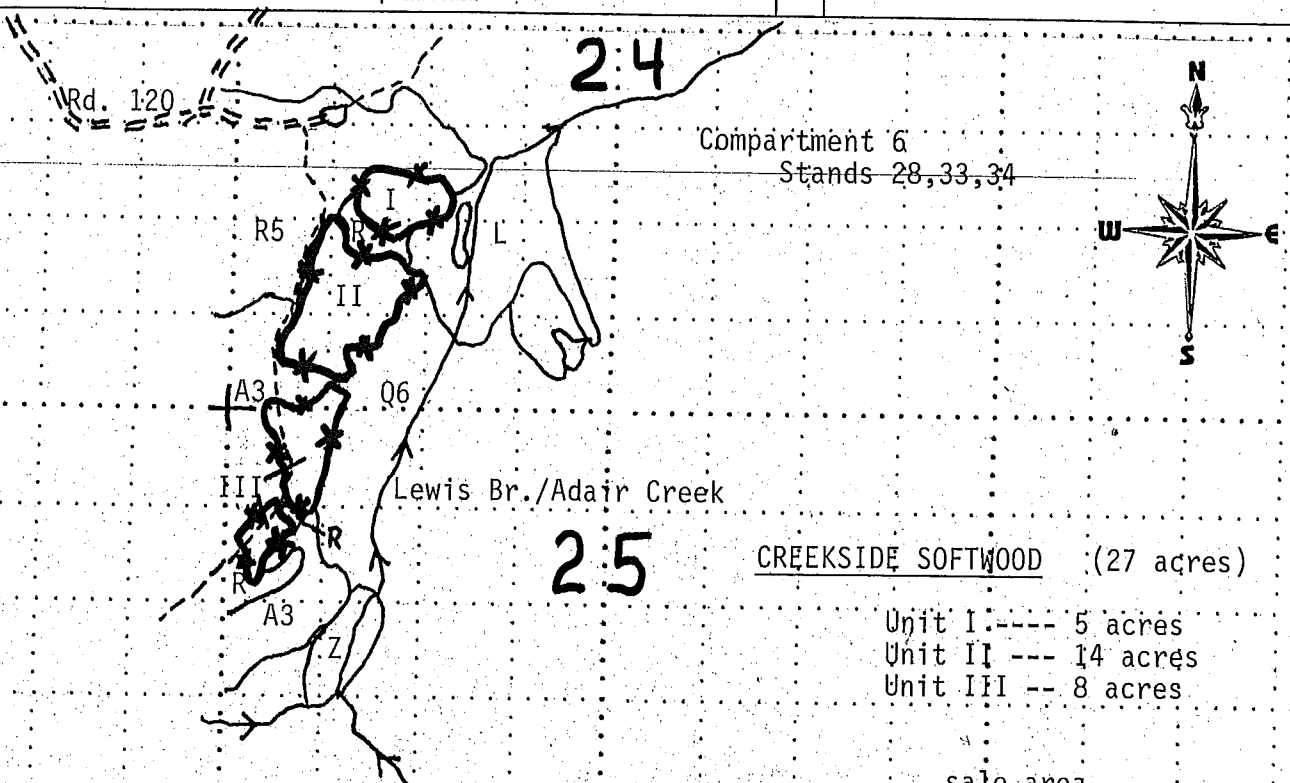

- OPEN FOREST ROAD
- STREAM/CREEK
- CLOSED ROAD
- SALE AREA BOUNDARY
- RETENTION AREA

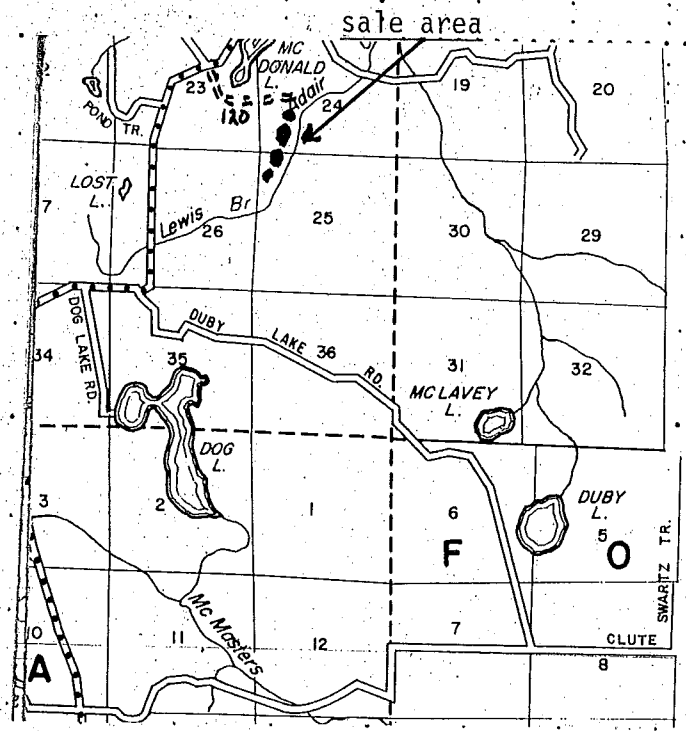

Sale Specific Conditions & Requirements

Sale Name: Creekside Softwood Sale Number: 53-016-10-01

1 - Sale Area

1.2 - Boundaries

1.2.1 - Painted boundaries (12/08)

The sale boundary is marked and identified by red paint.

2 - Timber Specifications

2.1 - Included Timber

2.1.1 - Clearcut unit(s) with unmerchantable trees (4/09)

Within Payment Unit(s) II and III, cut all trees that are four (4) inches or more in diameter measured at a point four and one-half (4-1/2) feet above ground level regardless of merchantability except do not cut any trees marked with green paint. Do not cut any Oak throughout the sale.

2.1.3 - Cut tree marked unit(s) (12/08)

Within Payment Unit(s) I, all trees are designated for cutting when marked with orange paint above and below stump height, regardless of merchantability.

2.2 - Utilization

2.2.6 - Roundwood operation required (5/07)

The skidding of whole trees or tree segments with limbs attached is prohibited within Payment Units I. All products must be produced as roundwood and forwarded to existing roads or landing areas in final product length.

3 - Payments

3.4 - Damaged Timber

3.4.1 - Damaged timber (6/05)

General Condition and Requirement 3.4 Damaged Timber, defines liquidated damages for undesignated live merchantable trees which are cut or injured. Damage to residual trees (defined as breaking of the cambium layer, broken tops or bending of trees from their natural position) is not acceptable.

4 - Transportation

4.1 - Construction

4.1.3 - Slash and earthen piles (8/04)

Piles or windrows of earth along roads and landings that have been widened or constructed shall be leveled. Slash from road maintenance or construction, including stumps, shall be dispersed throughout the sale.

4.1.6 - Road construction (1/09)

Construction of new roads or improvements of existing roads shall be done in such a way as to minimize the environmental and visual impacts. Merchantable trees shall be cut and utilized unless otherwise directed. Non-merchantable trees shall be severed and laid flat on the ground. Slash shall be scattered, and not left in windrows and kept a minimum of 10 feet back from the road edge. Stumps shall be set upright, not left on edge, and be moved at least 10 feet away from the road edge. Disturbed soil shall be feathered into the woods and not left in berms or windrows.

4.1.7 - Road closure (4/07)

All new roads built into the sale must be blocked to vehicle traffic upon completion of the sale. Overgrown roads that are reopened shall be considered new roads. In general, this will require constructing a four (4') foot high berm constructed of stumps and logs covered with earth. Temporary berms may be required if no sale activity occurs for 30 or more consecutive days.

4.2 - Maintenance

4.2.5 - Two wheel drive condition (2/04)

All existing trail roads on and adjacent to the sale area must be passable by two-wheel drive traffic for the duration of the sale.

5 - Operations

5.1 - Notification

5.1.1 - Pre-sale conference (12/08)

A pre-sale conference on site between the Purchaser and sale administrator is required prior to beginning any operations to determine landing and road locations.

5.2 - Conduct of Operations

5.2.2 - Hazard Trees/Snags

5.2.2.1 - Den trees (2/04)

Obvious hollow and/or den trees shall be protected and left standing unless they are a safety hazard.

5.2.3 - Operating Restrictions

5.2.3.3 - Bark slippage restriction (3/09)

Within Payment Unit(s) I, cutting and skidding are not permitted during the period of May 1 to July 1. This restriction is because of bark slippage.

5.2.3.6 - Bark beetle restriction (12/08)

In the event drought creates a high risk of pine bark beetle infestation, pine is not to be cut during the period March 1 through July 1, unless all portions of trees greater than two inches in diameter are removed from the sale area, reduced to chips, or treated to the satisfaction of the Unit Manager or his/her representative, within fifteen days of being severed from the stump. Pine log decks, pulpwood piles and treetops that are piled for chipping in the fall or winter within a 1/4 mile of susceptible sites must be removed before March 15. Residual

slash must not be placed in piles or rows and must be spread over the site for quick drying. The Department of Natural Resources will exercise this specification if the risk of damage warrants.

5.4 - Soil Protection

5.4.1 - Rutting restriction, general (1/09)

Operations are to cease immediately if equipment and weather conditions result in rutting of roads and skid trails which is 12 inches or greater in depth and 50 feet in length. The Unit Manager or his/her representative may restrict hauling and/or skidding if ruts exceed the specified depth. With the Unit Manager or his/her representative's approval, the Purchaser may return to the area when the risk of rutting has decreased.

5.8 - Protection of Endangered Species

5.8.3 - Red shoulder hawk (1) (3/07)

In the event that an active red shoulder hawk nest is found, the contract may be amended to protect the nest site. The harvesting time may be altered or reduced. Harvest operations may be limited to September 1 to March 1. This limitation may be selectively imposed on a specific portion of the sale, or it could apply to the entire sale. In addition, an area surrounding the nest tree could be designated as a "no-cut" zone with appropriate adjustments made to the timber sale value.

TAXIDEA MIX (024-10-01)

A timber sale contract for this LUMP SUM SEALED timber sale will be awarded the responsible bidder offering the highest sealed bid price. Bids must be at or above the following appraised price for each species:

<u>SPECIES</u>	<u>ESTIMATED VOLUME*</u>	<u>APPRAISED PRICE</u>
SAWLOGS		
SUG. MAPLE	10.00 MBF	\$ 269.00/MBF
BASSWOOD	27.00 MBF	\$ 56.00/MBF
RED PINE	14.00 MBF	\$ 128.00/MBF
PULPWOOD		
RED MAPLE	167.00 CORDS	\$ 11.40/CORD
MIX ASPEN	393.00 CORDS	\$ 16.90/CORD

In addition, the successful bidder agrees to purchase the following species at the indicated appraised price:

<u>SPECIES</u>	<u>ESTIMATED VOLUME*</u>	<u>APPRAISED PRICE</u>
SAWLOGS		
RED MAPLE	7.00 MBF	\$ 83.00/MBF
WHITE PINE	17.00 MBF	\$ 49.00/MBF
MIX ASPEN	8.00 MBF	\$ 52.00/MBF
MIX HARDWD	9.00 MBF	\$ 78.00/MBF
PULPWOOD		
SUG. MAPLE	79.00 CORDS	\$ 5.60/CORD
BASSWOOD	34.00 CORDS	\$ 6.05/CORD
P. BIRCH	140.00 CORDS	\$ 5.30/CORD
WHITE PINE	55.00 CORDS	\$ 9.20/CORD
MIX SOFTWD	13.00 CORDS	\$ 9.75/CORD
MIX HARDWD	38.00 CORDS	\$ 8.80/CORD

*The volumes are statistically estimated within plus (+) or minus (-) 10.12 percent. These estimated volumes are final and not subject to adjustment. Prospective bidders are urged to examine this timber and to make their own estimates of quantity and quality.

BOND AND PAYMENT SCHEDULE:

1. A bond in the amount of \$1,000.00 to insure faithful performance of the conditions of the contract, will be deposited by the successful bidder within 21 days of the sale award.
2. Cutting in any sale or unit without the required advance payment would be considered a trespass.
3. Total payment may be paid in advance or according to the following schedule:
 - (a) Ten percent (10%) of the sale value must be paid within 21 days of the sale award.
 - (b) The 10% down payment will be credited towards the first unit cut.
 - (c) Payment for each of the following units must be made before cutting begins in that unit:

<u>PAYMENT UNIT NUMBER</u>	<u>PERCENT OF TOTAL SALE VALUE</u>
1	60%
2	40%

4. If no cutting takes place, the 10% down payment will not be refunded.
5. Operations on the contract issued will terminate on December 31, 2013.



TIMBER SALE MAP

This information provided under authority of Part 525, Act 451 of 1994, as amended.

Sale No.	Year	Sale Type
024	10	

State Forest and Forest Management Unit: PIGEON RIVER COUNTRY MGT. UNIT		Mapped by: Don Mittlestat Cruised by: Don Mittlestat		Date: SEPT. 16, 2010
Township T32N	Range R1W	SECTION 22 E1/2SW; NWNE; S1/2NE		Scale: 1 inch = 1/4 MILE

Cover Type				Density	
A = Aspen	H = Hemlock	P = Lowland Poplar	V = Bog or Marsh	1 = Non Stocked	7 = Saw Timber
B = Paper Birch	J = Jack Pine	Q = Mixed Swamp Cnfr	W = White Pine	2 = Seedling Sapling Poor	Poor
C = Cedar	L = Lowland Brush	R = Red Pine	X = Non Stocked	3 = Seedling Sapling Well	8 = Saw Timber
E = Swamp Hdwoods	M = Mpl, Bch, Brch	S = Black Spruce	Z = Water	4 = Pole Timber Poor	Medium
F = Spruce Fir	N = Marsh	T = Tamarack		5 = Pole Timber Medium	9 = Saw Timber
G = Grass	O = Oak	U = Upland Brush		6 = Pole Timber Well	Well

TAXIDEA MIX
 COMPARTMENT 39
 STANDS 18, 25 & 32
 37 ACRES

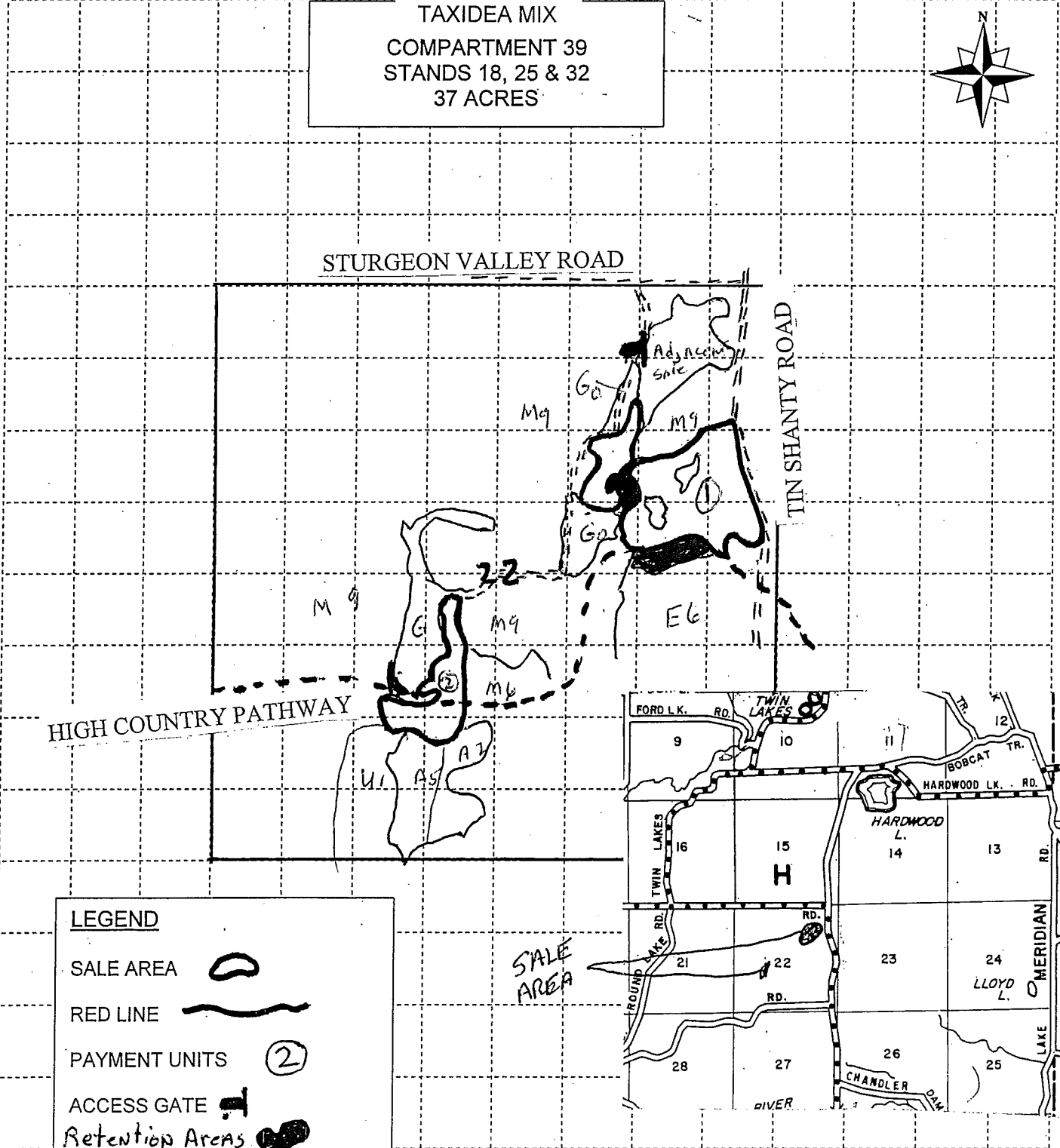

LEGEND

SALE AREA	
RED LINE	
PAYMENT UNITS	
ACCESS GATE	
Retention Areas	

Sale Specific Conditions & Requirements

Sale Name: Taxidea Mix Sale Number: 53-024-10-01

1 - Sale Area

1.2 - Boundaries

1.2.1 - Painted boundaries (12/08)

The sale boundary and Payment Unit boundaries are marked and identified by red paint.

2 - Timber Specifications

2.1 - Included Timber

2.1.1 - Clearcut unit(s) with unmerchantable trees (4/09)

Within Payment Unit(s) 1 and 2, cut all trees that are two (2) inches or more in diameter measured at a point four and one-half (4-1/2) feet above ground level regardless of merchantability except DO NOT cut Oak, Hemlock, Cherry and Green marked trees.

2.2 - Utilization

2.2.1 - Utilization (2/04)

All listed board foot volumes of sawlog size products in this contract have been determined using a top diameter inside bark of 8 inches.

3 - Payments

3.6 - Payment Unit Cutting Schedule

3.6.2 - One active unit (12/08)

Each Payment Unit must be completed to the satisfaction of the Unit Manager or his/her representative before the next unit may be opened. The Purchaser must give a one week notice before finishing a unit to allow for inspection.

4 - Transportation

4.1 - Construction

4.1.6 - Road construction (1/09)

Construction of new roads or improvements of existing roads shall be done in such a way as to minimize the environmental and visual impacts. Merchantable trees shall be cut and utilized unless otherwise directed. Non-merchantable trees shall be severed and laid flat on the ground. Slash shall be scattered, and not left in windrows and kept a minimum of 10 feet back from the road edge. Stumps shall be set upright, not left on edge, and be moved at least 10 feet away from the road edge. Disturbed soil shall be feathered into the woods and not left in berms or windrows.

4.1.7 - Road closure (4/07)

All new roads built into the sale must be blocked to vehicle traffic within 30 days of completion of hauling. Overgrown roads that are reopened shall be considered new roads. In general, this will require constructing a four (4') foot high berm constructed of stumps and logs covered with earth. Temporary berms may be required if no sale activity occurs for 30 or more consecutive days. Contact the sale administrator for specific details of design and placement.

4.1.12 - No new roads (6/10)

No new roads will be permitted in any Payment Unit. All operations are limited to existing roads.

4.2 - Maintenance

4.2.5 - Two wheel drive condition (2/04)

All existing trail roads on and adjacent to the sale area must be passable by two-wheel drive traffic for the duration of the sale.

4.4 - Access

4.4.3 - Access gate (12/08)

The access gate must be locked at all times. This is to prevent someone other than the purchaser from going through the gate and being locked in. The producer will provide a lock to be put on the gate.

5 - Operations

5.1 - Notification

5.1.1 - Pre-sale conference (12/08)

A pre-sale conference on site between the Purchaser and sale administrator is required prior to beginning any operations to determine landing and road locations. The Unit Manager or his/her representative must be contacted at least 10 days in advance to schedule the conference.

5.1.4 - Post-sale conference (9/09)

A post-sale conference on site between the Purchaser and sale administrator is required 5 days prior to the completion of active logging operations to determine clean-up and repair of landings, road edges, and the fulfillment of other contract specifications.

5.2 - Conduct of Operations

5.2.1 - Slash

5.2.1.8 - Slash height (12/08)

No slash or tree tops may exceed 24 inches in height.

5.2.1.10 - No slash in openings (5/10)

No brush or logging debris is to be left in the maintained wildlife opening which is indicated by G0 on the Timber Sale Map. Any damage to the opening shall be repaired according to specifications of the Unit Manager or his/her representative.

5.2.2 - Hazard Trees/Snags

5.2.2.1 - Den trees (2/04)

Obvious hollow and/or den trees shall be protected and left standing unless they are a safety hazard.

5.2.3 - Operating Restrictions

5.2.3.1 - Operating restrictions (12/08)

Within Payment Unit(s) 1 and 2, unless changed by written agreement, cutting and skidding are not permitted during the period of May 1 to June 30. This restriction is meant to minimize damage from overbrowsing by Deer and Elk.

5.2.30 - Landing/road top soil protection (1/09)

Top soil at landings and new roads must be stockpiled and saved. Upon completion of the timber sale, soil must be evenly distributed over the area to be re-vegetated.

5.2.40 - Pathway protection (6/09)

The High Country Pathway is shown on the Timber Sale Map. Do not cut trees or damage posts with blue pathway markers. Maintain a 20-foot wide slash, debris, and rut free zone daily, using the pathway as the centerline. Do not run equipment down the pathway. Skidding across the trail may only occur in locations approved by the sale administrator.

5.2.43 - Opening protection (12/08)

No activities are permitted in openings marked on the timber sale map with the letter "G". Any damage to the openings shall be repaired according to specifications of the Unit Manager or his/her representative.

5.4 - Soil Protection

5.4.1 - Rutting restriction, general (1/09)

Operations are to cease immediately if equipment and weather conditions result in rutting of roads and skid trails which is 12 inches or greater in depth and 50 feet in length. The Unit Manager or his/her representative may restrict hauling and/or skidding if ruts exceed the specified depth. With the Unit Manager or his/her representative's approval, the Purchaser may return to the area when the risk of rutting has decreased.

5.8 - Protection of Endangered Species

5.8.3 - Red shoulder hawk (1) (3/07)

In the event that an active red shoulder hawk nest is found, the contract may be amended to protect the nest site. The harvesting time may be altered or reduced. Harvest operations may be limited to September 1 to March 1. This limitation may be selectively imposed on a specific portion of the sale, or it could apply to the entire sale. In addition, an area surrounding the nest tree could be designated as a "no-cut" zone with appropriate adjustments made to the timber sale value.

SEVEN STAND MIX (006-10-01)
T31N, R01W, SEC. 04, S1/2SE.
T31N, R01W, SEC. 09, W1/2NE, SENE, NWSE, E1/2SE.
OTSEGO COUNTY

In response to the notice of sale to be held 9:00 a.m. on January 20, 2011, I am hereby submitting my sealed bid (firm offer) for the following forest products to be cut. Bids for individual species and total bid value must be at or above the appraised price. All non-responsive bid forms may be rejected.

<u>SPECIES</u>	<u>APPRAISED PRICE</u>	<u>BID PRICE</u>	<u>ESTIMATED VOLUME*</u>	<u>= VALUE</u>
SAWLOGS				
B.T. ASPEN	\$ 88.00/MBF	\$ _____ X	22.00 MBF	= \$ _____
PULPWOOD				
MIX ASPEN	\$ 21.10/CORD	\$ _____ X	291.00 CORDS	= \$ _____
SUBTOTAL 1				\$ _____

In addition, the successful bidder agrees to purchase the following species at the appraised price:

<u>SPECIES</u>	<u>APPRAISED PRICE</u>	<u>ESTIMATED VOLUME*</u>	<u>VALUE</u>
SAWLOGS			
WHITE PINE	\$ 49.00/MBF	4.00 MBF	= \$ 196.00
RED PINE	\$ 116.00/MBF	7.00 MBF	= \$ 812.00
PULPWOOD			
P. BIRCH	\$ 9.40/CORD	4.00 CORDS	= \$ 37.60
BALSAM FIR	\$ 4.15/CORD	3.00 CORDS	= \$ 12.45
B. SPRUCE	\$ 5.70/CORD	48.00 CORDS	= \$ 273.60
WHITE PINE	\$ 8.70/CORD	26.00 CORDS	= \$ 226.20
RED PINE	\$ 29.95/CORD	23.00 CORDS	= \$ 688.85
MIX HARDWD	\$ 10.15/CORD	32.00 CORDS	= \$ 324.80
SUBTOTAL 2			\$ <u>2,571.50</u>

SUBTOTAL 1 + SUBTOTAL 2 = TOTAL BID VALUE \$ _____

*These volumes are statistically estimated within plus (+) or minus (-) 23.07%. These estimated volumes are final and not subject to adjustment. Prospective bidders are urged to examine this timber and to make their own estimates of quantity and quality.

I understand that any or all bids may be rejected, and that the individual unit bid price will be the basis to determine total bid value. All bids must be signed and all bid items must be bid or the bid form may be rejected. I also understand that consideration and awarding a contract will be based upon my past performance and ability to complete the contract based upon equipment and manpower subject to my control.

(bidder's printed name)

(bidder's signature)

Address/Telephone _____

THE WINNING BIDDER MUST COMPLETE THE FORM ON THE REVERSE SIDE
WITHIN 21 DAYS OF SALE AWARD



TIMBER SALE VERIFICATION OF WORKER'S DISABILITY COMPENSATION ACT COMPLIANCE

As required by Act 317, P.A. 1969 (Worker's Compensation) and
Part 525 of Act 451 of 1994, as amended.

FOR DEPARTMENT USE ONLY

Sale Number (XX - XXX - XX - XX)

Forest Management Unit:

VERIFICATION OF WORKER'S DISABILITY COMPENSATION ACT COMPLIANCE

- This verification must be completed and submitted within 21 days of contract award and prior to the issuance of the timber sale contract.
- In addition, if boxes 2B or 2C are checked, then Notice of Exclusion or Certificate of Insurance must be submitted within 21 days of the contract award and prior to the issuance of the timber sale contract.
- All Information must be typed or printed except for written signatures.

Please Check Appropriate Categories:

1. My business is organized as (you **must** check one of the boxes below):

- A. Sole Proprietorship (individual)
 B. Partnership
 C. Corporation

2. You **must** check one of the boxes below:

- A. I certify that my business is a sole proprietorship and it has no employees but the sole proprietor. I am not subject to the Worker's Compensation Laws.
 B. I certify that my business has satisfied its obligation to the Worker's Compensation Act through the use of an approved Notice of Exclusion (BWC-337, Rev. 5/96). I will provide a copy of the Notice of Exclusion within 21 days of the contract award. (For questions or a copy of the BWC-337, please call the Worker's Compensation Bureau at 517-322-1195).
 C. I certify that my business has a Worker's Compensation Policy. I will provide an original Certificate of Insurance within 21 days of the contract award.

3. If you have checked item 2(A) or 2(B), you **must** indicate the number of **both** full-time and part-time employees, other than yourself, including family members and active partners (if none, you must enter "0").

_____ Full-time Employees

_____ Part-time Employees

Name of Business		Federal ID (or) Social Security No.
Address		Telephone ()
City	State	ZIP

I hereby certify that the above information is true and correct. I agree to notify the Michigan DNRE of any changes that occur in factors affecting my coverage during any of my present and future operations.

Signature of Owner or Authorized Representative

Title

Date

CREEKSIDE SOFTWOOD (016-10-01)
 T34N, R01W, SEC. 24, W1/2 OF SW1/4, NE/SW.
 T34N, R01W, SEC. 25, NW/NW.
 CHEBOYGAN COUNTY

In response to the notice of sale to be held 9:00 a.m. on January 20, 2011, I am hereby submitting my sealed bid (firm offer) for the following forest products to be cut. Bids for individual species and total bid value must be at or above the appraised price. All non-responsive bid forms may be rejected.

<u>SPECIES</u>	<u>APPRAISED PRICE</u>	<u>BID PRICE</u>	<u>ESTIMATED VOLUME* = VALUE</u>
<u>SAWLOGS</u>			
RED PINE	\$ 109.00/MBF	\$ _____ X	89.00 MBF = \$ _____
<u>PULPWOOD</u>			
B. SPRUCE	\$ 7.00/CORD	\$ _____ X	334.00 CORDS = \$ _____
RED PINE	\$ 29.70/CORD	\$ _____ X	66.00 CORDS = \$ _____
SUBTOTAL 1			\$ _____

In addition, the successful bidder agrees to purchase the following species at the appraised price:

<u>SPECIES</u>	<u>APPRAISED PRICE</u>	<u>ESTIMATED VOLUME*</u>	<u>VALUE</u>
<u>SAWLOGS</u>			
WHITE PINE	\$ 47.00/MBF	1.00 MBF	= \$ 47.00
<u>PULPWOOD</u>			
RED MAPLE	\$ 10.10/CORD	27.00 CORDS	= \$ 272.70
BALSAM FIR	\$ 7.00/CORD	8.00 CORDS	= \$ 56.00
WHITE PINE	\$ 8.15/CORD	5.00 CORDS	= \$ 40.75
JACK PINE	\$ 10.00/CORD	82.00 CORDS	= \$ 820.00
SUBTOTAL 2			\$ <u>1,236.45</u>

SUBTOTAL 1 + SUBTOTAL 2 = TOTAL BID VALUE \$ _____

*These volumes are statistically estimated within plus (+) or minus (-) 18.70%. These estimated volumes are final and not subject to adjustment. Prospective bidders are urged to examine this timber and to make their own estimates of quantity and quality.

I understand that any or all bids may be rejected, and that the individual unit bid price will be the basis to determine total bid value. All bids must be signed and all bid items must be bid or the bid form may be rejected. I also understand that consideration and awarding a contract will be based upon my past performance and ability to complete the contract based upon equipment and manpower subject to my control.

 (bidder's printed name)

 (bidder's signature)

Address/Telephone _____

THE WINNING BIDDER MUST COMPLETE THE FORM ON THE REVERSE SIDE
 WITHIN 21 DAYS OF SALE AWARD



TIMBER SALE

VERIFICATION OF WORKER'S DISABILITY COMPENSATION ACT COMPLIANCE

As required by Act 317, P.A. 1969 (Worker's Compensation) and
Part 525 of Act 451 of 1994, as amended.

FOR DEPARTMENT USE ONLY

Sale Number (XX - XXX - XX - XX)

Forest Management Unit:

VERIFICATION OF WORKER'S DISABILITY COMPENSATION ACT COMPLIANCE

- This verification must be completed and submitted within 21 days of contract award and prior to the issuance of the timber sale contract.
- In addition, if boxes 2B or 2C are checked, then Notice of Exclusion or Certificate of Insurance must be submitted within 21 days of the contract award and prior to the issuance of the timber sale contract.
- All Information must be typed or printed except for written signatures.

Please Check Appropriate Categories:

1. My business is organized as (you **must** check one of the boxes below):
 - A. Sole Proprietorship (individual)
 - B. Partnership
 - C. Corporation
2. You **must** check one of the boxes below:
 - A. I certify that my business is a sole proprietorship and it has no employees but the sole proprietor. I am not subject to the Worker's Compensation Laws.
 - B. I certify that my business has satisfied its obligation to the Worker's Compensation Act through the use of an approved Notice of Exclusion (BWC-337, Rev. 5/96). I will provide a copy of the Notice of Exclusion within 21 days of the contract award. (For questions or a copy of the BWC-337, please call the Worker's Compensation Bureau at 517-322-1195).
 - C. I certify that my business has a Worker's Compensation Policy. I will provide an original Certificate of Insurance within 21 days of the contract award.
3. If you have checked item 2(A) or 2(B), you **must** indicate the number of **both** full-time and part-time employees, other than yourself, including family members and active partners (if none, you must enter "0").

_____ Full-time Employees

_____ Part-time Employees

Name of Business		Federal ID (or) Social Security No.
Address		Telephone ()
City	State	ZIP

I hereby certify that the above information is true and correct. I agree to notify the Michigan DNRE of any changes that occur in factors affecting my coverage during any of my present and future operations.

Signature of Owner or Authorized Representative

Title

Date

TAXIDEA MIX (024-10-01)
T32N, R01W, SEC. 22, E1/2SW, NWNE, S1/2NE.
OTSEGO COUNTY

In response to the notice of sale to be held 9:00 a.m. on January 20, 2011, I am hereby submitting my sealed bid (firm offer) for the following forest products to be cut. Bids for individual species and total bid value must be at or above the appraised price. All non-responsive bid forms may be rejected.

<u>SPECIES</u>	<u>APPRAISED PRICE</u>	<u>BID PRICE</u>	<u>ESTIMATED VOLUME*</u>	<u>= VALUE</u>
SAWLOGS				
SUG. MAPLE	\$ 269.00/MBF	\$ _____ X	10.00 MBF	= \$ _____
BASSWOOD	\$ 56.00/MBF	\$ _____ X	27.00 MBF	= \$ _____
RED PINE	\$ 128.00/MBF	\$ _____ X	14.00 MBF	= \$ _____
PULPWOOD				
RED MAPLE	\$ 11.40/CORD	\$ _____ X	167.00 CORDS	= \$ _____
MIX ASPEN	\$ 16.90/CORD	\$ _____ X	393.00 CORDS	= \$ _____
SUBTOTAL 1				\$ _____

In addition, the successful bidder agrees to purchase the following species at the appraised price:

<u>SPECIES</u>	<u>APPRAISED PRICE</u>	<u>ESTIMATED VOLUME*</u>	<u>VALUE</u>
SAWLOGS			
RED MAPLE	\$ 83.00/MBF	7.00 MBF	= \$ 581.00
WHITE PINE	\$ 49.00/MBF	17.00 MBF	= \$ 833.00
MIX ASPEN	\$ 52.00/MBF	8.00 MBF	= \$ 416.00
MIX HARDWD	\$ 78.00/MBF	9.00 MBF	= \$ 702.00
PULPWOOD			
SUG. MAPLE	\$ 5.60/CORD	79.00 CORDS	= \$ 442.40
BASSWOOD	\$ 6.05/CORD	34.00 CORDS	= \$ 205.70
P. BIRCH	\$ 5.30/CORD	140.00 CORDS	= \$ 742.00
WHITE PINE	\$ 9.20/CORD	55.00 CORDS	= \$ 506.00
MIX SOFTWD	\$ 9.75/CORD	13.00 CORDS	= \$ 126.75
MIX HARDWD	\$ 8.80/CORD	38.00 CORDS	= \$ 334.40
SUBTOTAL 2			\$ <u>4,889.25</u>

SUBTOTAL 1 + SUBTOTAL 2 = TOTAL BID VALUE \$ _____

*These volumes are statistically estimated within plus (+) or minus (-) 10.12%. These estimated volumes are final and not subject to adjustment. Prospective bidders are urged to examine this timber and to make their own estimates of quantity and quality.

I understand that any or all bids may be rejected, and that the individual unit bid price will be the basis to determine total bid value. All bids must be signed and all bid items must be bid or the bid form may be rejected. I also understand that consideration and awarding a contract will be based upon my past performance and ability to complete the contract based upon equipment and manpower subject to my control.

(bidder's printed name)

(bidder's signature)

Address/Telephone _____

THE WINNING BIDDER MUST COMPLETE THE FORM ON THE REVERSE SIDE
WITHIN 21 DAYS OF SALE AWARD



TIMBER SALE VERIFICATION OF WORKER'S DISABILITY COMPENSATION ACT COMPLIANCE

As required by Act 317, P.A. 1969 (Worker's Compensation) and
Part 525 of Act 451 of 1994, as amended.

FOR DEPARTMENT USE ONLY	
Sale Number (XX - XXX - XX - XX)	
Forest Management Unit:	

VERIFICATION OF WORKER'S DISABILITY COMPENSATION ACT COMPLIANCE

- This verification must be completed and submitted within 21 days of contract award and prior to the issuance of the timber sale contract.
- In addition, if boxes 2B or 2C are checked, then Notice of Exclusion or Certificate of Insurance must be submitted within 21 days of the contract award and prior to the issuance of the timber sale contract.
- All information must be typed or printed except for written signatures.

Please Check Appropriate Categories:

1. My business is organized as (you **must** check one of the boxes below):
 - A. Sole Proprietorship (individual)
 - B. Partnership
 - C. Corporation
2. You **must** check one of the boxes below:
 - A. I certify that my business is a sole proprietorship and it has no employees but the sole proprietor. I am not subject to the Worker's Compensation Laws.
 - B. I certify that my business has satisfied its obligation to the Worker's Compensation Act through the use of an approved Notice of Exclusion (BWC-337, Rev. 5/96). I will provide a copy of the Notice of Exclusion within 21 days of the contract award. (For questions or a copy of the BWC-337, please call the Worker's Compensation Bureau at 517-322-1195).
 - C. I certify that my business has a Worker's Compensation Policy. I will provide an original Certificate of Insurance within 21 days of the contract award.
3. If you have checked item 2(A) or 2(B), you **must** indicate the number of **both** full-time and part-time employees, other than yourself, including family members and active partners (if none, you must enter "0").

_____ Full-time Employees

_____ Part-time Employees

Name of Business		Federal ID (or) Social Security No.	
Address		Telephone ()	
City	State	ZIP	

I hereby certify that the above information is true and correct. I agree to notify the Michigan DNRE of any changes that occur in factors affecting my coverage during any of my present and future operations.

Signature of Owner or Authorized Representative

Title

Date