



**DEPARTMENT OF NATURAL RESOURCES  
STATE OF MICHIGAN**

**TIMBER SALE PROSPECTUS #4732**

SCHEDULED SALE DATE AND TIME: 11:00 a.m. (local time) on October 23, 2012.

LOCATION: ROSCOMMON MGMT UNIT, PO BOX 218, ROSCOMMON, MI 48653.

PROSPECTUS NOTE: The bidder is advised to inspect the sale area and review the location, estimated volumes, operating costs and contract terms of proposed sales. Please be aware that some landowners may request 60 days or more notice for access across their land.

Notice is hereby given that bids will be received by the Unit Manager, ROSCOMMON MANAGEMENT UNIT, for certain timber on the following described lands:

JAYBIRD HARVEST (71-015-12-01) / T21N, R03W, SEC. 09, W1/2NE;E1/2NW;N1/2SW;SWNW;SESW.  
T21N, R03W, SEC. 16, E1/2NW;SWNW;NWSW.

Roscommon County, Advertised Price \$43,677.50, 103.0 Acres

SALE NOTE: Note: Oak Wilt restriction with no cutting from 04/15-07/15 & Coppice Regeneration protection.

No designated recreation site such as a trail, pathway, or campground is within the sale area or the vicinity. Access may be through state forest land.

STRONG SIGNAL SELECTION (71-018-12-01) / T22N, R03W, SEC. 35, NESW NWSE NESE.

Roscommon County, Advertised Price \$7,310.50, 42.0 Acres

SALE NOTE: Oak Wilt restriction considerations with no cutting between 04/15 thru 07/15.

No designated recreation site such as a trail, pathway, or campground is within the sale area or the vicinity. Access may be through state forest land.

BARRED HARDWOODS (71-019-12-01) / T23N, R02W, SEC. 10, E1/2NW;W1/2NE;NESW.

Roscommon County, Advertised Price \$9,066.05, 48.0 Acres

SALE NOTE: Consider for Bark Slippage restriction within PU#1 for no cutting between 04/15-07/15 & ORV Trail route protection.

A recreation site such as a trail, pathway, or campground is within the sale area or the vicinity. Certain restrictions/specifications may be applicable including time restrictions. Access may be through state forest land.

## BID INSTRUCTIONS (VER. 02/13/2012):

### 1. Scheduled Bid Location, Date, and Time (2/11)

Bids must be received by the Unit Manager, ROSCOMMON OFFICE, PO BOX 218, ROSCOMMON, MI 48653, no later than 11:00 a.m. (local time) on October 23, 2012. For further information concerning this sale, contact Steve Anderson at 989-275-4622 extension 2740.

### 2. Bidder's Qualifications (2/12)

Purchaser shall obtain workers compensation insurance to cover claims under Michigan's Worker's Disability Compensation Act of 1969 or similar employee benefit act of any other state applicable to an employee. If all or part of a timber sale was prepared by a private contractor, that contractor and that contractor's company are not permitted to bid on the timber sale contract. Bids will not be accepted from individuals or companies appearing on the DNR/FRD No-Bid List. This list contains the names of purchasers who previously failed to execute a contract within 21-days or who have a history of poor performance.

### 3. Preparation of Sealed Bids (1/11)

Bids shall be manually signed in ink; bid prices must be entered for each species and product in the Bid Price column for all material subject to bidding; and all fill-in blanks must be completed. If erasures or other changes appear on the forms, each erasure or change must be initialed by the person signing the bid.

### 4. Submission of Sealed Bids (6/11)

Bid forms may be obtained from the Unit Manager. All bids must be submitted on the bid form and in an envelope clearly identified as described in this section. NOTE: Only one bid form per bid envelope. Sealed bids must be submitted to the Unit office designated in the prospectus and must be submitted at or prior to the time established in the prospectus. The envelope should show on the outside (a) the sale name or number and (b) the date and time of bid opening as shown in the prospectus. Bids received after the time specified in the sale prospectus are late bids and will be rejected.

### 5. Public Opening of Sealed Bids (1/11)

If conditions permit, the sealed bids will be publicly opened and posted at the time and place set in the prospectus.

### 6. Award of Contract (1/11)

Award of the contract will be made to the Bidder whose bid, conforming to the prospectus, is most advantageous to the State of Michigan on the basis of total value at rates bid for the estimated quantities. The State reserves the right to reject any bid or waive any minor irregularity in bids received. A written award mailed (or otherwise furnished) to the successful Bidder shall be deemed to result in a binding contract without further action by either party.

### 7. Down Payment (1/11)

The Bidder to whom award is made must make a down payment within 21 days of the sale award. The amount of the down payment will be calculated as shown in the Bond and Payment Schedule of this prospectus. Only cash may be used to meet this requirement.

### 8. Performance Security (1/11)

As guarantee of faithful performance, a cash bond, certificate of deposit, surety bond or irrevocable letter of credit (LOC) is required within 21 days of the sale award. The amount of the performance security is shown in the Bond and Payment Schedule of this prospectus. If an LOC or surety is used, the coverage must extend for at least 6 months beyond the contract expiration.

### 9. Timber Sale Contract (1/11)

Additional conditions and requirements common to all timber sales are listed on the timber sale contract (R4031) and are available on line at [www.michigan.gov/dnr](http://www.michigan.gov/dnr). Contact the Unit Manager for additional information or a sample contract. Within 21 days of the date of the award letter, the bidder must sign the contract and provide the required down payment, performance security, and verification of worker's disability compensation. The down payment and performance security shall be in accordance with the provisions of the timber sale contract, in the sums stated in this prospectus. If these actions are not taken, then the Bidder, the Bidder's corporation, and the corporation's principals may not be permitted to bid on State timber sales for a period of 1 year. In addition, the Bidder certifies that if awarded this contract, the Bidder will complete the timber sale contract in accordance with its terms and any modifications thereof including requirements to purchase, cut, and remove

the included timber by the termination date.

10. Disclaimer of Estimates and Bidder's Warranty of Inspection (1/11)

Before submitting this bid, the Bidder is advised and cautioned to inspect the sale area, review the requirements of the sale contract, and take other steps as may be reasonably necessary to ascertain the location, estimated volumes, construction estimates, and operating costs of the proposed sale. Failure to do so will not relieve the Bidder from responsibility for completing the contract.

The Bidder warrants that this bid is submitted solely on the basis of the Bidder's examination and inspection of the quality and quantity of the timber offered for sale and the Bidder's opinion of the value thereof and the costs of recovery. No reliance should be placed on the State of Michigan's estimates of timber quality, quantity or costs of recovery. Bidder further acknowledges that the State of Michigan: (i) expressly disclaims any warranty of fitness of timber for any purpose; (ii) offers this timber as is without any warranty of quality (merchantability) or quantity and (iii) expressly disclaims any warranty as to the quantity or quality of timber sold.

11. Certification and Chain-of-Custody (10/11)

Unless otherwise indicated in the contract under section 7 – Other Conditions of the Sale Specific Conditions & Requirements, the area encompassed by this timber sale is certified to the standards of the Forest Stewardship Council (FSC) - Certificate #SCS-FM/COC-00090N and the Sustainable Forestry Initiative (SFI) - Certificate # NSF-SFIS-5Y031-S1. Forest products from this sale may be delivered to the mill as "FSC Pure and / or SFI certified" as long as the contractor hauling the forest products is chain-of-custody (COC) certified or covered under a COC certificate from the destination mill. The purchaser is responsible for maintaining COC after leaving the sale area.

KEITH CREAGH  
Director



## TIMBER SALE INFORMATION

### JAYBIRD HARVEST (71-015-12-01)

T21N, R03W, SEC. 09; T21N, R03W, SEC. 16.

Roscommon County (Advertised Price \$43,677.50)

SALE NOTE: Note: Oak Wilt restriction with no cutting from 04/15-07/15 & Coppice Regeneration protection.

No designated recreation site such as a trail, pathway, or campground is within the sale area or the vicinity. Access may be through state forest land.

A timber sale contract for this lump sum, sealed bid timber sale will be awarded to the responsible bidder offering the highest sealed bid price. Bids must be at or above the following advertised price for each species:

| <u>PRODUCTS &amp; SPECIES</u> | <u>ESTIMATED UNITS*</u> | <u>ADVERTISED PRICE</u> |
|-------------------------------|-------------------------|-------------------------|
| Sawlogs                       |                         |                         |
| Mixed Aspen                   | 127.90 MBF              | \$ 54.00 / MBF          |
| Red Maple                     | 46.30 MBF               | \$ 80.00 / MBF          |
| Pulpwood                      |                         |                         |
| B. T. Aspen                   | 829.00 Cords            | \$ 23.65 / Cord         |
| Q. Aspen                      | 393.00 Cords            | \$ 24.60 / Cord         |

In addition, the successful bidder agrees to purchase the following species at the indicated advertised price for a total value of \$3,793.25:

| <u>PRODUCTS &amp; SPECIES</u> | <u>ESTIMATED UNITS*</u> | <u>ADVERTISED PRICE</u> |
|-------------------------------|-------------------------|-------------------------|
| Pulpwood                      |                         |                         |
| Balsam Fir                    | 35.00 Cords             | \$ 8.20 / Cord          |
| Jack Pine                     | 46.00 Cords             | \$ 18.25 / Cord         |
| Mixed Hardwood                | 17.00 Cords             | \$ 18.85 / Cord         |
| Red Maple                     | 237.00 Cords            | \$ 9.90 / Cord          |

\* The total volume is statistically estimated within plus (+) or minus (-) 12.76 percent. The estimated units are final and not subject to adjustment. Prospective bidders are urged to examine this timber and to make their own estimates of quantity and quality.

### **BOND AND PAYMENT SCHEDULE:**

1. A bond in the amount of **\$2,200.00** to insure faithful performance of the conditions of the contract will be deposited by the successful bidder within 21 days of the sale award.
2. Cutting in any sale or unit without the required advance payment would be considered a trespass.
3. Total payment must be paid in advance or according to the following schedule:
  - (a) Ten percent (10%) of the sale value must be paid within 21 days of the sale award.
  - (b) The 10% down payment will be credited towards the first unit cut.
  - (c) Payment for each of the following units must be made before cutting begins in that unit:
 

| <u>PAYMENT UNIT NUMBER</u> | <u>PERCENT OF TOTAL SALE VALUE</u> |
|----------------------------|------------------------------------|
| 01                         | 36%                                |
| 02                         | 27%                                |
| 03                         | 16%                                |
| 04                         | 21%                                |
4. If no cutting takes place, the 10% down payment will not be refunded.
5. Operations on the contract issued will terminate on 12/31/2014.

## Sale Specific Conditions & Requirements

Sale Name: Jaybird Harvest Sale Number: 71-015-12-01

### 1 - Sale Area

#### 1.2 - Boundaries

##### 1.2.1 - Painted boundaries (12/08)

The sale boundary and Payment Unit boundaries are marked and identified by red and yellow paint. Exterior sale boundary lines against state are marked with red paint. Interior Payment Unit boundaries are marked with yellow paint. Yellow painted trees designating an interior Payment Unit boundary are only to be cut when all surrounding Payment Units have been paid.

### 2 - Timber Specifications

#### 2.1 - Included Timber

##### 2.1.1 - Clearcut unit(s) with unmerchantable trees (8/11)

Within Payment Unit(s) 1 - 4, cut all trees that are two (2) inches or more in diameter measured at a point four and one-half (4-1/2) feet above ground level regardless of merchantability EXCEPT DO NOT CUT OR DAMAGE any red pine, white pine, or oak trees. In addition, DO NOT CUT OR DAMAGE any red pine, white pine, or oak regeneration.

### 3 - Payments

#### 3.3 - Pre-measured Sales

##### 3.3.4 - Dividing payment units (12/08)

Payment unit(s) 1 may be divided at the request of the purchaser and upon approval of the Unit Manager. Dividing payment units is a contract modification which requires a Timber Sale Contract Supplement.

#### 3.4 - Damaged Timber

##### 3.4.1 - Damaged timber (6/05)

General Condition and Requirement 3.4 Damaged Timber, defines liquidated damages for undesignated live merchantable trees which are cut or injured. In addition, extreme care should be taken to avoid damage to tree seedlings and saplings. Damage to residual trees (defined as breaking of the cambium layer, broken tops or bending of trees from their natural position) is not acceptable.

Within the sale area, if more than 10% of the residual tree seedlings or saplings (1/4" to 4.5" DBH) within a specified portion of the sale area are damaged, liquidated damages will be assessed at \$300.00 per acre for all acreage within that specified portion of the sale area that was damaged.

No damage is acceptable to merchantable residual trees. Within the sale area, if more than 10% of trees (> 4.5" DBH) within a specified area of the sale are damaged, liquidated damages will be assessed for all trees damaged. Rates will be in accordance with General Condition and Requirement 3.4 Damaged Timber..

#### 3.6 - Payment Unit Cutting Schedule

##### 3.6.2 - One active unit (12/08)

Each Payment Unit must be completed to the satisfaction of the Unit Manager or his/her representative before the next unit may be opened.

### 4 - Transportation

#### 4.1 - Construction

##### 4.1.6 - Road construction (1/09)

Construction of new roads or improvements of existing roads shall be done in such a way as to minimize the environmental and visual impacts. Merchantable trees shall be cut and utilized unless otherwise directed. Non-merchantable trees shall be severed and laid flat on the ground. Slash shall be scattered, and not left in windrows and kept a minimum of 10 feet back from the road edge or be chipped, utilized or otherwise removed from the sale. Stumps shall be set upright, not left on edge, and be moved at least 10 feet away from the road edge. Disturbed soil shall be feathered into the woods and not left in berms or windrows.

##### 4.1.7 - Road closure (10/11)

All new roads built into the sale must be blocked to vehicle traffic within 30 days of completion of hauling. Overgrown roads that are reopened shall be considered new roads. In general, this will require constructing a four (4') foot high berm of stumps and logs covered with earth. Stumps and brush must be placed along the remainder of the trail. These roads must be rendered impassable to cars and trucks. Contact the sale administrator for specific details of design and placement.

#### 4.2 - Maintenance

##### 4.2.1 - Hauling restriction (12/08)

Hauling may be restricted on forest roads by the Unit Manager or his/her representative. The restriction may occur during spring breakup or during wet weather conditions.

### 5 - Operations

#### 5.1 - Notification

##### 5.1.1 - Pre-sale conference (10/11)

A pre-sale conference on site between the Purchaser and sale administrator is required prior to beginning any operations to determine landing and road locations.

##### 5.1.4 - Post-sale conference (6/11)

A post-sale conference on site between the Purchaser and sale administrator is required prior to the completion of active logging operations to determine clean-up and repair of landings, road edges, and the fulfillment of other contract specifications.

#### 5.2 - Conduct of Operations

##### 5.2.1 - Slash

###### 5.2.1.8 - Slash height (12/08)

No slash or tree tops may exceed 24 inches in height.

##### 5.2.2 - Hazard Trees/Snags

###### 5.2.2.1 - Den trees (2/04)

Obvious hollow and/or den trees shall be protected and left standing unless they are a safety hazard.

##### 5.2.3 - Operating Restrictions

###### 5.2.3.4 - Oak wilt restriction (6/10)

Within Payment Unit(s) 1 - 4, unless changed by written agreement, cutting and skidding are not permitted during the period of April 15 to July 15. This is necessary to reduce the spread of oak wilt. For more information, contact the Unit Manager or his/her representative.

###### 5.2.3.11 - Coppice regeneration protection (4/10)

Any post harvest operations, such as chipping, must be completed before sprouting of regeneration occurs. If it is anticipated that chipping will be delayed, then tops shall be carried to one central location or left unchipped. The Unit Manager or his/her representative may cease such operations if sprouting occurs before the operation is complete.

##### 5.2.4 - Dead and Down Creation

###### 5.2.4.3 - Dead and down creation, dead trees (6/07)

Except as provided for in General Condition and Requirement 5.2.2, no dead trees, standing or down, are to be cut, skidded, or processed.

##### 5.2.29 - Shrub protection (9/07)

Do not cut or damage hawthorn, witch-hazel, dogwood or juneberry. These woody-shrub plants are highly beneficial to various wildlife species.

##### 5.2.38 - No decking against live trees (2/04)

Cut products may not be decked against unmarked or designated leave trees.

#### 5.4 - Soil Protection

##### 5.4.1 - Rutting restriction, general (1/09)

Operations are to cease immediately if equipment and weather conditions result in rutting of roads and skid trails which is 12 inches or greater in depth and 50 feet in length. The Unit Manager or his/her representative may restrict hauling and/or skidding if ruts exceed the specified depth. With the Unit Manager or his/her representative's approval, the Purchaser may return to the area when the risk of rutting has decreased.

5.4.3 - Erosion control (12/08)

Skid trails or haul roads may require erosion control structures or berms per direction of the Unit Manager or his/her representative.





# TIMBER SALE MAP

71-015

2012

*This information provided by authority of Part 525, 1994 PA 451, as amended.*

|  |                     |   |                     |                  |           |         |
|--|---------------------|---|---------------------|------------------|-----------|---------|
| Forest Management Unit<br><b>Roscommon</b> |                     | County<br><b>Roscommon</b>  | Mapped By<br>Ekdorn | Date<br>5/3/2012 | Page<br>1 | of<br>1 |
| Township<br><b>21N</b>                     | Range<br><b>03W</b> | Section(s) and Subdivision(s) <b>9 - W1/2NE;E1/2NW;N1/2SW;SWNW;SESW</b> |                     |                  | 1:15,840  |         |
| 16- E1/2NW;SWNW;NWSW                       |                     |   |                     |                  |           |         |

| Cover Type        |                    |                      |                  | Density                     |                        |  |
|-------------------|--------------------|----------------------|------------------|-----------------------------|------------------------|--|
| A = Aspen         | G = Grass          | O = Oak              | U = Upland Brush | 0 = Non Stocked             | 5 = Pole Timber Medium |  |
| B = Paper Birch   | H = Hemlock        | P = Lowland Poplar   | V = Bog or Marsh | 1 = Seedling Sapling Poor   | 6 = Pole Timber Well   |  |
| C = Cedar         | J = Jack Pine      | Q = Mixed Swamp Cnfr | W = White Pine   | 2 = Seedling Sapling Medium | 7 = Saw Timber Poor    |  |
| D = Tread Bog     | L = Lowland Brush  | R = Red Pine         | X = Non Stocked  | 3 = Seedling Sapling Well   | 8 = Saw Timber Medium  |  |
| E = Swamp Hdwoods | M = Mpl, Bch, Brch | S = Black Spruce     | Z = Water        | 4 = Pole Timber Poor        | 9 = Saw Timber Well    |  |
| F = Spruce Fir    | N = Marsh          | T = Tamarack         |                  |                             |                        |  |

## Jay Bird Harvest 103 Acres Roscommon County

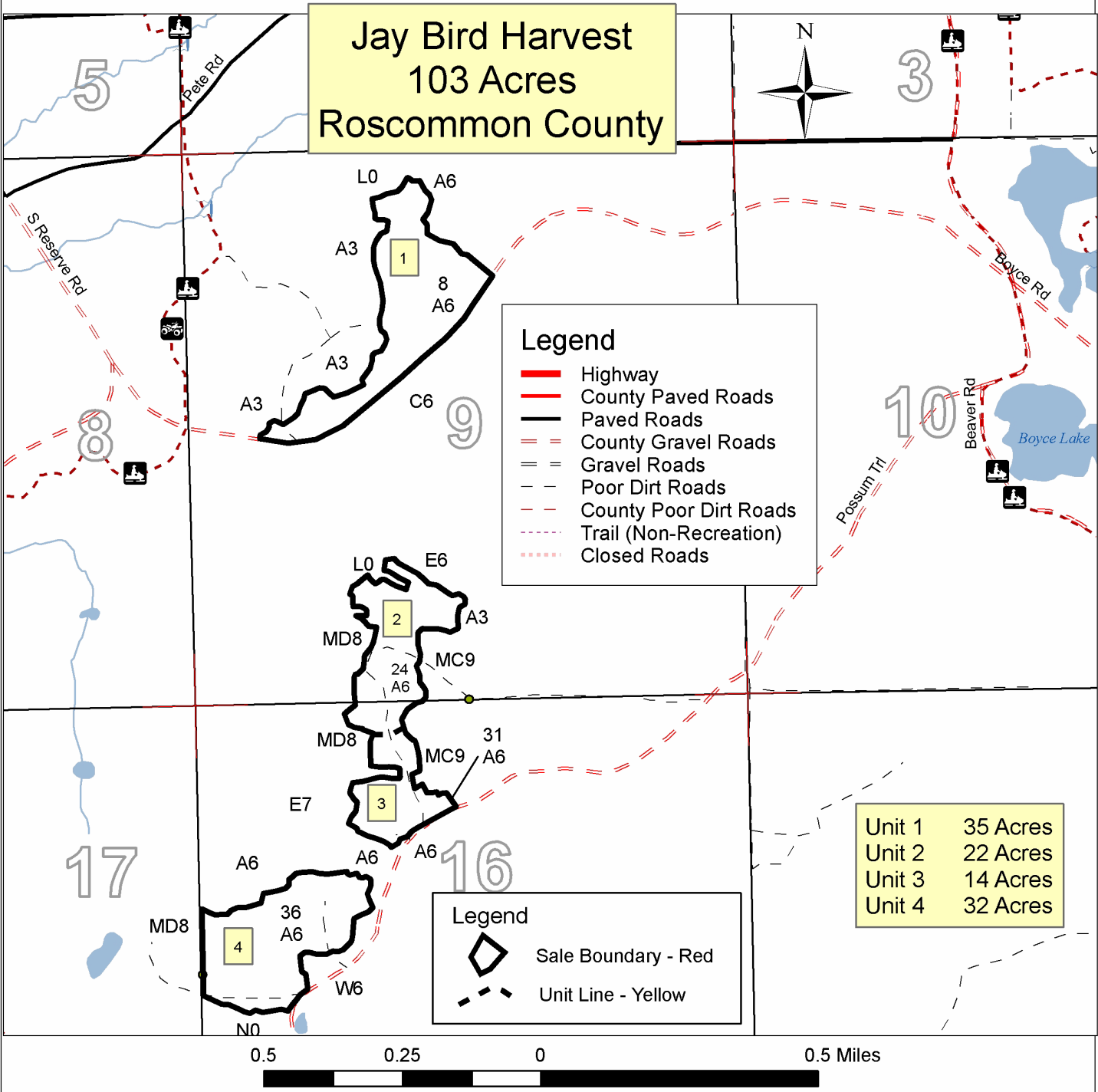

### Legend

- Highway
- County Paved Roads
- Paved Roads
- - - County Gravel Roads
- - - Gravel Roads
- . . . Poor Dirt Roads
- . . . County Poor Dirt Roads
- - - Trail (Non-Recreation)
- . . . Closed Roads

### Legend

- ▣ Sale Boundary - Red
- - - Unit Line - Yellow

|        |          |
|--------|----------|
| Unit 1 | 35 Acres |
| Unit 2 | 22 Acres |
| Unit 3 | 14 Acres |
| Unit 4 | 32 Acres |



# TIMBER SALE INFORMATION

## STRONG SIGNAL SELECTION (71-018-12-01)

T22N, R03W, SEC. 35.

Roscommon County (Advertised Price \$7,310.50)

SALE NOTE: Oak Wilt restriction considerations with no cutting between 04/15 thru 07/15.

No designated recreation site such as a trail, pathway, or campground is within the sale area or the vicinity. Access may be through state forest land.

A timber sale contract for this lump sum, sealed bid timber sale will be awarded to the responsible bidder offering the highest sealed bid price. Bids must be at or above the following advertised price for each species:

| <u>PRODUCTS &amp; SPECIES</u> | <u>ESTIMATED UNITS*</u> | <u>ADVERTISED PRICE</u> |
|-------------------------------|-------------------------|-------------------------|
| Sawlogs                       |                         |                         |
| Red Pine                      | 10.70 MBF               | \$ 154.00 / MBF         |
| Pulpwood                      |                         |                         |
| Jack Pine                     | 34.00 Cords             | \$ 21.25 / Cord         |
| Mixed Oak                     | 144.00 Cords            | \$ 15.60 / Cord         |
| Red Pine                      | 53.00 Cords             | \$ 43.40 / Cord         |

In addition, the successful bidder agrees to purchase the following species at the indicated advertised price for a total value of \$393.60:

| <u>PRODUCTS &amp; SPECIES</u> | <u>ESTIMATED UNITS*</u> | <u>ADVERTISED PRICE</u> |
|-------------------------------|-------------------------|-------------------------|
| Pulpwood                      |                         |                         |
| B. T. Aspen                   | 16.00 Cords             | \$ 24.60 / Cord         |

\* The total volume is statistically estimated within plus (+) or minus (-) 25.92 percent. The estimated units are final and not subject to adjustment. Prospective bidders are urged to examine this timber and to make their own estimates of quantity and quality.

### **BOND AND PAYMENT SCHEDULE:**

1. A bond in the amount of **\$500.00** to insure faithful performance of the conditions of the contract will be deposited by the successful bidder within 21 days of the sale award.
2. Cutting in any sale or unit without the required advance payment would be considered a trespass.
3. Total payment must be paid in advance or according to the following schedule:
  - (a) Ten percent (10%) of the sale value must be paid within 21 days of the sale award.
  - (b) The remainder is due before cutting begins.
4. If no cutting takes place, the 10% down payment will not be refunded.
5. Operations on the contract issued will terminate on 09/30/2014.

## Sale Specific Conditions & Requirements

Sale Name: Strong Signal Selection Sale Number: 71-018-12-01

### 1 - Sale Area

#### 1.2 - Boundaries

##### 1.2.1 - Painted boundaries (12/08)

The sale boundary is marked and identified by red paint. Exterior sale boundary lines against state are marked with red paint. Do not cut painted boundary line trees unless also marked with orange paint.

### 2 - Timber Specifications

#### 2.1 - Included Timber

##### 2.1.3 - Cut tree marked unit(s) (12/08)

Within Payment Unit(s) #1, all trees are designated for cutting when marked with orange paint above and below stump height, regardless of merchantability.

#### 2.2 - Utilization

##### 2.2.3 - Stump heights (4/07)

Stump heights within the Sale Area shall not exceed 12 inches for trees greater than 10 inches DBH and 4 inches for trees smaller than 10 inches DBH.

##### 2.2.5 - Limbed tree skidding (1/09)

The skidding of whole trees or tree segments with limbs attached is prohibited

### 3 - Payments

#### 3.3 - Pre-measured Sales

##### 3.3.4 - Dividing payment units (12/08)

Payment unit(s) may be divided at the request of the purchaser and upon approval of the Unit Manager. Dividing payment units is a contract modification which requires a Timber Sale Contract Supplement.

### 4 - Transportation

#### 4.1 - Construction

##### 4.1.6 - Road construction (1/09)

Construction of new roads or improvements of existing roads shall be done in such a way as to minimize the environmental and visual impacts. Merchantable trees shall be cut and utilized unless otherwise directed. Non-merchantable trees shall be severed and laid flat on the ground. Slash shall be scattered, and not left in windrows and kept a minimum of 10 feet back from the road edge. Stumps shall be set upright, not left on edge, and be moved at least 10 feet away from the road edge. Disturbed soil shall be feathered into the woods and not left in berms or windrows.

##### 4.1.7 - Road closure (10/11)

All new roads built into the sale must be blocked to vehicle traffic upon completion of the sale. These roads must be rendered impassable to cars and trucks. All stumps from road building and landing construction must be reserved to block any newly constructed roads upon completion of the sale. These stumps must be scattered along the road system to prohibit vehicular movement. Contact the sale administrator for specific details of design and placement.

### 5 - Operations

#### 5.1 - Notification

##### 5.1.1 - Pre-sale conference (10/11)

A pre-sale conference on site between the Purchaser and sale administrator is required prior to beginning any operations to determine landing and road locations.

##### 5.1.4 - Post-sale conference (6/11)

A post-sale conference on site between the Purchaser and sale administrator is required prior to the completion of active logging operations to determine clean-up and repair of landings, road edges, and the fulfillment of other contract specifications.

#### 5.2 - Conduct of Operations

## 5.2.1 - Slash

### 5.2.1.8 - Slash height (12/08)

No slash or tree tops may exceed 24 inches in height.

## 5.2.2 - Hazard Trees/Snags

### 5.2.2.1 - Den trees (2/04)

Obvious hollow and/or den trees shall be protected and left standing unless they are a safety hazard.

## 5.2.3 - Operating Restrictions

### 5.2.3.4 - Oak wilt restriction (6/10)

Within Payment Unit(s) # 1 unless changed by written agreement, cutting, skidding, and hauling are not permitted during the period of April 15 to July 15. This is necessary to reduce the spread of oak wilt. For more information, contact the Unit Manager or his/her representative.

### 5.2.32 - Decking/landing restoration (9/11)

All decking and landing areas must have the surface area restored to a condition equal to or better than before. This is to ensure the proper regeneration of the stand.

### 5.2.38 - No decking against live trees (2/04)

Cut products may not be decked against unmarked or designated leave trees.

## 5.4 - Soil Protection

### 5.4.1 - Rutting restriction, general (1/09)

Operations are to cease immediately if equipment and weather conditions result in rutting of roads and skid trails which is 12 inches or greater in depth and 50 feet in length. The Unit Manager or his/her representative may restrict hauling and/or skidding if ruts exceed the specified depth. With the Unit Manager or his/her representative's approval, the Purchaser may return to the area when the risk of rutting has decreased.

## 7 - Other Conditions

### 7.3 - Contract Modifications

#### 7.3.2 - Modification for oak wilt (2/05)

Within the sale area, there may be patches of oak wilt. If oak wilt is identified within the sale area, this contract may be modified. The following modifications could occur: time of cutting, species to cut, volume to harvest, or various others dealing with the treatment of oak wilt. If a species is not specified in this contract, it shall be paid for at the average price received for that species and product.



### TIMBER SALE MAP

*This information provided by authority of Part 525, 1994 PA 451, as amended.*

|                                     |                     |  |                   |           |          |
|-------------------------------------|---------------------|--|-------------------|-----------|----------|
| Forest Management Unit<br>Roscommon | County<br>Roscommon | Mapped By<br>Wiese                                   | Date<br>7/03/2012 | Page<br>1 | of<br>1  |
| Township<br>T22N                    | Range<br>R03W       | Section(s) and Subdivision(s)<br>S.35 NESW NWSE NESE |                   |           | 1:15,840 |

| Cover Type        |                    |                      |                  | Density                     |                        |
|-------------------|--------------------|----------------------|------------------|-----------------------------|------------------------|
| A = Aspen         | G = Grass          | O = Oak              | U = Upland Brush | 0 = Non Stocked             | 5 = Pole Timber Medium |
| B = Paper Birch   | H = Hemlock        | P = Lowland Poplar   | V = Bog or Marsh | 1 = Seedling Sapling Poor   | 6 = Pole Timber Well   |
| C = Cedar         | J = Jack Pine      | Q = Mixed Swamp Cnfr | W = White Pine   | 2 = Seedling Sapling Medium | 7 = Saw Timber Poor    |
| D = Treed Bog     | L = Lowland Brush  | R = Red Pine         | X = Non Stocked  | 3 = Seedling Sapling Well   | 8 = Saw Timber Medium  |
| E = Swamp Hdwoods | M = Mpl, Bch, Brch | S = Black Spruce     | Z = Water        | 4 = Pole Timber Poor        | 9 = Saw Timber Well    |
| F = Spruce Fir    | N = Marsh          | T = Tamarack         |                  |                             |                        |

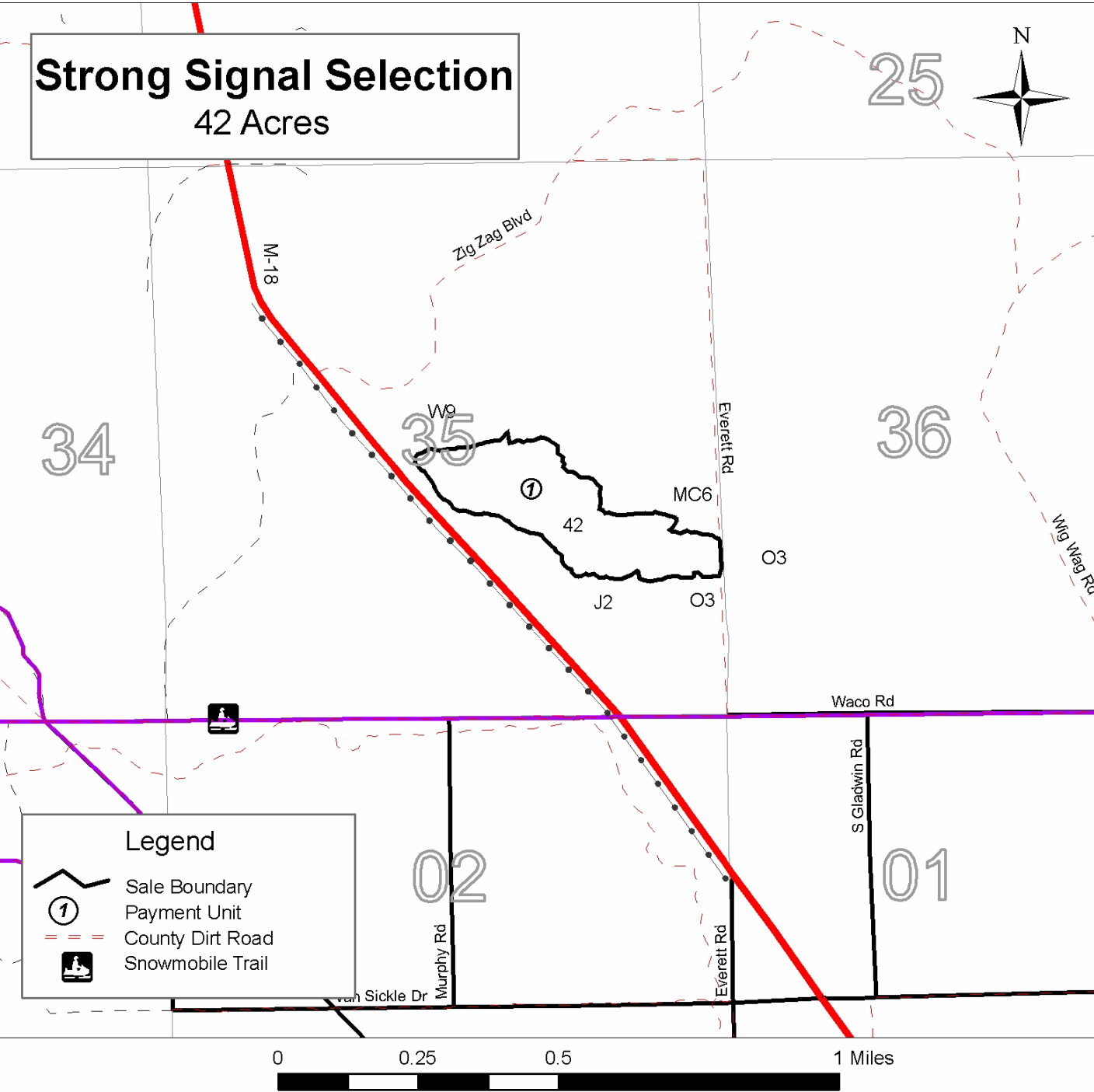

**Legend**

- Sale Boundary
- Payment Unit
- County Dirt Road
- Snowmobile Trail

# TIMBER SALE INFORMATION

## BARRED HARDWOODS (71-019-12-01)

T23N, R02W, SEC. 10.

Roscommon County (Advertised Price \$9,066.05)

SALE NOTE: Consider for Bark Slippage restriction within PU#1 for no cutting between 04/15-07/15 & ORV Trail route protection.

A recreation site such as a trail, pathway, or campground is within the sale area or the vicinity. Certain restrictions/specifications may be applicable including time restrictions. Access may be through state forest land.

A timber sale contract for this lump sum, sealed bid timber sale will be awarded to the responsible bidder offering the highest sealed bid price. Bids must be at or above the following advertised price for each species:

| <u>PRODUCTS &amp; SPECIES</u> | <u>ESTIMATED UNITS*</u> | <u>ADVERTISED PRICE</u> |
|-------------------------------|-------------------------|-------------------------|
| Sawlogs                       |                         |                         |
| Red Maple                     | 26.40 MBF               | \$ 79.00 / MBF          |
| Red Oak                       | 12.10 MBF               | \$ 226.00 / MBF         |
| Sugar Maple                   | 2.10 MBF                | \$ 315.00 / MBF         |
| Pulpwood                      |                         |                         |
| B. T. Aspen                   | 31.00 Cords             | \$ 22.10 / Cord         |
| Paper Birch                   | 33.00 Cords             | \$ 15.00 / Cord         |
| Red Maple                     | 124.00 Cords            | \$ 10.15 / Cord         |

In addition, the successful bidder agrees to purchase the following species at the indicated advertised price for a total value of \$1,145.65:

| <u>PRODUCTS &amp; SPECIES</u> | <u>ESTIMATED UNITS*</u> | <u>ADVERTISED PRICE</u> |
|-------------------------------|-------------------------|-------------------------|
| Sawlogs                       |                         |                         |
| B. T. Aspen                   | 16.20 MBF               | \$ 26.00 / MBF          |
| Paper Birch                   | 2.90 MBF                | \$ 65.00 / MBF          |
| Pulpwood                      |                         |                         |
| Beech                         | 26.00 Cords             | \$ 14.70 / Cord         |
| Red Oak                       | 15.00 Cords             | \$ 10.25 / Cord         |

\* The total volume is statistically estimated within plus (+) or minus (-) 22.89 percent. The estimated units are final and not subject to adjustment. Prospective bidders are urged to examine this timber and to make their own estimates of quantity and quality.

### **BOND AND PAYMENT SCHEDULE:**

1. A bond in the amount of **\$500.00** to insure faithful performance of the conditions of the contract will be deposited by the successful bidder within 21 days of the sale award.
2. Cutting in any sale or unit without the required advance payment would be considered a trespass.
3. Total payment must be paid in advance or according to the following schedule:
  - (a) Ten percent (10%) of the sale value must be paid within 21 days of the sale award.
  - (b) The remainder is due before cutting begins.
4. If no cutting takes place, the 10% down payment will not be refunded.
5. Operations on the contract issued will terminate on 09/30/2014.

## Sale Specific Conditions & Requirements

Sale Name: Barred Hardwoods Sale Number: 71-019-12-01

### 1 - Sale Area

#### 1.2 - Boundaries

##### 1.2.1 - Painted boundaries (12/08)

The sale boundary is marked and identified by red paint. Do not cut painted boundary line trees.

### 2 - Timber Specifications

#### 2.1 - Included Timber

##### 2.1.3 - Cut tree marked unit(s) (12/08)

Within Payment Unit(s) # 1, all trees are designated for cutting when marked with orange paint above and below stump height, regardless of merchantability.

#### 2.2 - Utilization

##### 2.2.3 - Stump heights (4/07)

Stump heights within the Sale Area shall not exceed 12 inches for trees greater than 10 inches DBH and 4 inches for trees smaller than 10 inches DBH.

##### 2.2.4 - Skidding length (2/11)

Skidding of unlimbed tops or lengths over 17 feet is not permissible

##### 2.2.6 - Roundwood operation required (5/07)

The skidding of whole trees or tree segments with limbs attached is prohibited. All products must be produced as roundwood and forwarded to existing roads or landing areas in final product length.

##### 2.2.9 - No chipping permitted (12/08)

Within Payment Unit(s) # 1, all wood must be removed by tree segment, or roundwood. No chipping is permitted. Tops may not be chipped.

### 3 - Payments

#### 3.3 - Pre-measured Sales

##### 3.3.4 - Dividing payment units (12/08)

Payment unit(s) may be divided at the request of the purchaser and upon approval of the Unit Manager. Dividing payment units is a contract modification which requires a Timber Sale Contract Supplement.

#### 3.4 - Damaged Timber

##### 3.4.1 - Damaged timber (6/05)

General Condition and Requirement 3.4 Damaged Timber, defines liquidated damages for undesigned live merchantable trees which are cut or injured. In addition, extreme care should be taken to avoid damage to tree seedlings and saplings. Damage to residual trees (defined as breaking of the cambium layer, broken tops or bending of trees from their natural position) is not acceptable.

Within the sale area, if more than percent 10% of the tree seedlings or saplings (1/4" to 4.5" DBH) within a specified portion of the sale area are damaged, liquidated damages will be assessed at \$300 per acre for all acreage within that specified portion of the sale area that was damaged.

No damage is acceptable to merchantable trees. Within the sale area, if more than 5% of trees (> 4.5" DBH) within a specified area of the sale are damaged, liquidated damages will be assessed for all trees damaged. Rates will be in accordance with General Condition and Requirement 3.4 Damaged Timber.

### 4 - Transportation

#### 4.1 - Construction

##### 4.1.3 - Slash and earthen piles (8/04)

Piles or windrows of earth along roads and landings that have been widened or constructed shall be leveled. Slash from road



maintenance or construction, including stumps, shall be dispersed throughout the sale.

#### 4.1.6 - Road construction (1/09)

Construction of new roads or improvements of existing roads shall be done in such a way as to minimize the environmental and visual impacts. Merchantable trees shall be cut and utilized unless otherwise directed. Non-merchantable trees shall be severed and laid flat on the ground. Slash shall be scattered, and not left in windrows and kept a minimum of 10 feet back from the road edge. Stumps shall be set upright, not left on edge, and be moved at least 10 feet away from the road edge. Disturbed soil shall be feathered into the woods and not left in berms or windrows.

#### 4.1.7 - Road closure (10/11)

All new roads built into the sale must be blocked to vehicle traffic upon completion of the sale. In general, this will require constructing a four (4') foot high berm of stumps and logs covered with earth. Stumps and brush must be placed along the remainder of the trail. These roads must be rendered impassable to cars and trucks.

### 4.2 - Maintenance

#### 4.2.1 - Hauling restriction (12/08)

Hauling may be restricted on forest roads by the Unit Manager or his/her representative. The restriction may occur during wet weather conditions.

#### 4.2.5 - Two wheel drive condition (2/04)

All existing trail roads on and adjacent to the sale area must be passable by two-wheel drive traffic for the duration of the sale.

## 5 - Operations

### 5.1 - Notification

#### 5.1.1 - Pre-sale conference (10/11)

A pre-sale conference between the Purchaser and sale administrator is required prior to beginning any operations to determine landing and road locations.

#### 5.1.4 - Post-sale conference (6/11)

A post-sale conference on site between the Purchaser and sale administrator is required prior to the completion of active logging operations to determine clean-up and repair of landings, road edges, and the fulfillment of other contract specifications.

### 5.2 - Conduct of Operations

#### 5.2.1 - Slash

##### 5.2.1.8 - Slash height (12/08)

No slash or tree tops may exceed 24 inches in height.

#### 5.2.2 - Hazard Trees/Snags

##### 5.2.2.1 - Den trees (2/04)

Obvious hollow and/or den trees shall be protected and left standing unless they are a safety hazard.

#### 5.2.3 - Operating Restrictions

##### 5.2.3.3 - Bark slippage restriction (3/09)

Within Payment Unit(s) # 1, unless changed by written agreement, cutting and skidding are not permitted during the period of April 15 to July 15. This restriction is because of bark slippage.

#### 5.2.4 - Dead and Down Creation

##### 5.2.4.3 - Dead and down creation, dead trees (6/07)

Except as provided for in General Condition and Requirement 5.2.2, no dead trees, standing or down, are to be cut, skidded, or processed.

#### 5.2.29 - Shrub protection (9/07)

Do not cut or damage hawthorn, witch-hazel, dogwood or juneberry. These woody-shrub plants are highly beneficial to various wildlife species.

#### 5.2.39 - ORV trail/route protection (1/09)

The ORV trail is shown on the Timber Sale Map. Do not cut trees or damage posts with orange ORV markers. Maintain a 20 foot wide slash, debris, and rut free zone daily using the ORV trail or route as the centerline. Do not run equipment down

the ORV trail or route.

## **6 - Safety and Fire Prevention**

### 6.2 - Signing

#### 6.2.3 - Recreational trail posting (2/10)

The Purchaser is responsible for posting and maintaining caution signs on the ORV trail prior to beginning operations. The trail must be posted at appropriate distances from the sale area to warn of logging activity and truck traffic at both ends of the trail. Signs must be removed when harvest operations are suspended or completed.



Michigan Department of Natural Resources – Forest, Mineral & Fire Management  
**TIMBER SALE MAP**

This information is provided by authority of Part 525 of Act 451, PA 1994, as amended.

|             |         |
|-------------|---------|
| SALE NUMBER | YEAR    |
| 019         | 12      |
| DATE        | PAGE OF |
| 7/6/2012    | 1 1     |

|                        |           |                               |         |
|------------------------|-----------|-------------------------------|---------|
| FOREST MANAGEMENT UNIT | COUNTY    | MAPPED BY                     | LEWICKI |
| Roscommon              | Roscommon | CRUISED BY                    | LEWICKI |
| TOWNSHIP               | RANGE     | SECTION(S) AND SUBDIVISION(S) |         |
| 23N                    | 02W       | S.10 E1/2NW; W1/2NE; NESW     |         |

| Cover Type        |                    |                      |                  | Density                     |                        |
|-------------------|--------------------|----------------------|------------------|-----------------------------|------------------------|
| A = Aspen         | H = Hemlock        | P = Lowland Poplar   | V = Bog or Marsh | 0 = Non Stocked             | 5 = Pole Timber Medium |
| B = Paper Birch   | J = Jack Pine      | Q = Mixed Swamp Cnfr | W = White Pine   | 1 = Seedling Sapling Poor   | 6 = Pole Timber Well   |
| C = Cedar         | L = Lowland Brush  | R = Red Pine         | X = Non Stocked  | 2 = Seedling Sapling Medium | 7 = Saw Timber Poor    |
| E = Swamp Hdwoods | M = Mpl, Bch, Brch | S = Black Spruce     | Z = Water        | 3 = Seedling Sapling Well   | 8 = Saw Timber Medium  |
| F = Spruce Fir    | N = Marsh          | T = Tamarack         |                  | 4 = Pole Timber Poor        | 9 = Saw Timber Well    |
| G = Grass         | O = Oak            | U = Upland Brush     |                  |                             |                        |

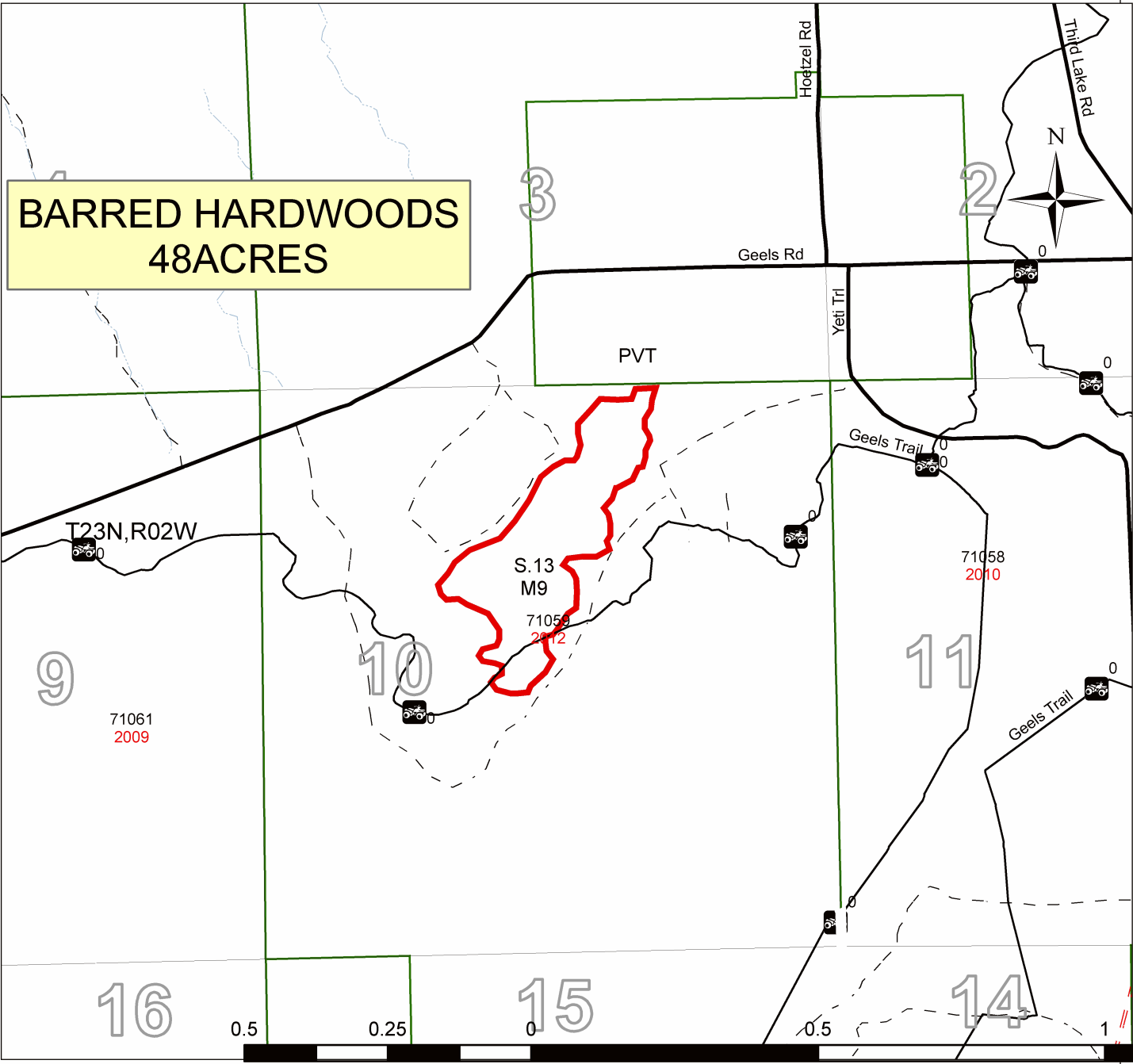



JAYBIRD HARVEST (71-015-12-01)

T21N, R03W, SEC. 09; T21N, R03W, SEC. 16, Roscommon County

In response to the notice of sale to be held 11:00 a.m. (local time) on October 23, 2012, I am hereby submitting my sealed bid (firm offer) for the following forest products to be cut. Bids for individual species must be at or above the advertised price. All non-responsive bid forms may be rejected.

| <u>PRODUCTS &amp; SPECIES</u> | <u>ESTIMATED UNITS*</u> | <u>ADVERTISED PRICE</u> | <u>BID PRICE</u> |
|-------------------------------|-------------------------|-------------------------|------------------|
| <b>Sawlogs</b>                |                         |                         |                  |
| Mixed Aspen                   | 127.90 MBF              | \$ 54.00 / MBF          | \$ _____ / MBF   |
| Red Maple                     | 46.30 MBF               | \$ 80.00 / MBF          | \$ _____ / MBF   |
| <b>Pulpwood</b>               |                         |                         |                  |
| B. T. Aspen                   | 829.00 Cords            | \$ 23.65 / Cord         | \$ _____ / Cord  |
| Q. Aspen                      | 393.00 Cords            | \$ 24.60 / Cord         | \$ _____ / Cord  |

In addition, the successful bidder agrees to purchase the following species at the indicated advertised price for a total value of \$3,793.25 :

| <u>PRODUCTS &amp; SPECIES</u> | <u>ESTIMATED UNITS*</u> | <u>ADVERTISED PRICE</u> |
|-------------------------------|-------------------------|-------------------------|
| <b>Pulpwood</b>               |                         |                         |
| Balsam Fir                    | 35.00 Cords             | \$ 8.20 / Cord          |
| Jack Pine                     | 46.00 Cords             | \$ 18.25 / Cord         |
| Mixed Hardwood                | 17.00 Cords             | \$ 18.85 / Cord         |
| Red Maple                     | 237.00 Cords            | \$ 9.90 / Cord          |

\* The total volume is statistically estimated within plus (+) or minus (-) 12.76 percent. The estimated units are final and not subject to adjustment. Prospective bidders are urged to examine this timber and to make their own estimates of quantity and quality.

I understand that any or all bids may be rejected. All bids must be signed and all bid items must be bid or the bid form may be rejected. I also understand that consideration and awarding a contract will be based upon my past performance and ability to complete the contract based upon equipment and staffing subject to my control.

FEDERAL ID: \_\_\_\_\_ - \_\_\_\_\_ or SOCIAL SECURITY NUMBER: \_\_\_\_\_ - \_\_\_\_\_ - \_\_\_\_\_

Company or individual bidding: \_\_\_\_\_

Company representative's name: \_\_\_\_\_

Address: \_\_\_\_\_

City: \_\_\_\_\_ State: \_\_\_\_\_ Zip: \_\_\_\_\_

IF AVAILABLE, PLEASE PLACE THE PERSONALIZED LABEL FROM YOUR PROSPECTUS IN THE ABOVE BOX.

Individual or company representative's signature: \_\_\_\_\_ Date: \_\_\_\_\_

Phone number : \_\_\_\_\_ Email (optional): \_\_\_\_\_



# TIMBER SALE

## VERIFICATION OF WORKER'S DISABILITY COMPENSATION ACT COMPLIANCE

As required by Act 317, P.A. 1969 (Worker's Compensation) and  
Part 525 of Act 451 of 1994, as amended.

| FOR DEPARTMENT USE ONLY          |  |
|----------------------------------|--|
| Sale Number (XX - XXX - XX - XX) |  |
| Forest Management Unit:          |  |

### VERIFICATION OF WORKER'S DISABILITY COMPENSATION ACT COMPLIANCE

- This verification must be completed and submitted within 21 days of contract award and prior to the issuance of the timber sale contract.
- In addition, if boxes 2B or 2C are checked, then Notice of Exclusion or Certificate of Insurance must be submitted within 21 days of the contract award and prior to the issuance of the timber sale contract.
- All Information must be typed or printed except for written signatures.

Please Check Appropriate Categories:

1. My business is organized as (you **must** check one of the boxes below):
  - A.  Sole Proprietorship (individual)
  - B.  Partnership
  - C.  Corporation
2. You **must** check one of the boxes below:
  - A.  I certify that my business is a sole proprietorship and it has no employees but the sole proprietor. I am not subject to the Worker's Compensation Laws.
  - B.  I certify that my business has satisfied its obligation to the Worker's Compensation Act through the use of an approved Notice of Exclusion (BWC-337, Rev. 5/96). I will provide a copy of the Notice of Exclusion within 21 days of the contract award. (For questions or a copy of the BWC-337, please call the Worker's Compensation Bureau at 517-322-1195).
  - C.  I certify that my business has a Worker's Compensation Policy. I will provide an original Certificate of Insurance within 21 days of the contract award.
3. If you have checked item 2(A) or 2(B), you **must** indicate the number of **both** full-time and part-time employees, other than yourself, including family members and active partners (if none, you must enter "0").

\_\_\_\_\_ Full-time Employees

\_\_\_\_\_ Part-time Employees

|                  |       |                                     |
|------------------|-------|-------------------------------------|
| Name of Business |       | Federal ID (or) Social Security No. |
| Address          |       | Telephone<br>(      )               |
| City             | State | ZIP                                 |

I hereby certify that the above information is true and correct. I agree to notify the Michigan DNRE of any changes that occur in factors affecting my coverage during any of my present and future operations.

\_\_\_\_\_  
Signature of Owner or Authorized Representative

\_\_\_\_\_  
Title

\_\_\_\_\_  
Date

STRONG SIGNAL SELECTION (71-018-12-01)  
T22N, R03W, SEC. 35, Roscommon County

In response to the notice of sale to be held 11:00 a.m. (local time) on October 23, 2012, I am hereby submitting my sealed bid (firm offer) for the following forest products to be cut. Bids for individual species must be at or above the advertised price. All non-responsive bid forms may be rejected.

| <u>PRODUCTS &amp; SPECIES</u> | <u>ESTIMATED UNITS*</u> | <u>ADVERTISED PRICE</u> | <u>BID PRICE</u> |
|-------------------------------|-------------------------|-------------------------|------------------|
| Sawlogs                       |                         |                         |                  |
| Red Pine                      | 10.70 MBF               | \$ 154.00 / MBF         | \$ _____ / MBF   |
| Pulpwood                      |                         |                         |                  |
| Jack Pine                     | 34.00 Cords             | \$ 21.25 / Cord         | \$ _____ / Cord  |
| Mixed Oak                     | 144.00 Cords            | \$ 15.60 / Cord         | \$ _____ / Cord  |
| Red Pine                      | 53.00 Cords             | \$ 43.40 / Cord         | \$ _____ / Cord  |

In addition, the successful bidder agrees to purchase the following species at the indicated advertised price for a total value of \$393.60 :

| <u>PRODUCTS &amp; SPECIES</u> | <u>ESTIMATED UNITS*</u> | <u>ADVERTISED PRICE</u> |
|-------------------------------|-------------------------|-------------------------|
| Pulpwood                      |                         |                         |
| B. T. Aspen                   | 16.00 Cords             | \$ 24.60 / Cord         |

\* The total volume is statistically estimated within plus (+) or minus (-) 25.92 percent. The estimated units are final and not subject to adjustment. Prospective bidders are urged to examine this timber and to make their own estimates of quantity and quality.

I understand that any or all bids may be rejected. All bids must be signed and all bid items must be bid or the bid form may be rejected. I also understand that consideration and awarding a contract will be based upon my past performance and ability to complete the contract based upon equipment and staffing subject to my control.

FEDERAL ID: \_\_\_ - \_\_\_ - \_\_\_ or SOCIAL SECURITY NUMBER: \_\_\_ - \_\_\_ - \_\_\_

Company or individual bidding: \_\_\_\_\_

Company representative's name: \_\_\_\_\_

Address: \_\_\_\_\_

City: \_\_\_\_\_ State: \_\_\_\_\_ Zip: \_\_\_\_\_

IF AVAILABLE, PLEASE PLACE THE PERSONALIZED LABEL FROM YOUR PROSPECTUS IN THE ABOVE BOX.

Individual or company representative's signature: \_\_\_\_\_ Date: \_\_\_\_\_

Phone number : \_\_\_\_\_ Email (optional): \_\_\_\_\_



# TIMBER SALE

## VERIFICATION OF WORKER'S DISABILITY COMPENSATION ACT COMPLIANCE

As required by Act 317, P.A. 1969 (Worker's Compensation) and  
Part 525 of Act 451 of 1994, as amended.

| FOR DEPARTMENT USE ONLY          |  |
|----------------------------------|--|
| Sale Number (XX - XXX - XX - XX) |  |
| Forest Management Unit:          |  |

### VERIFICATION OF WORKER'S DISABILITY COMPENSATION ACT COMPLIANCE

- This verification must be completed and submitted within 21 days of contract award and prior to the issuance of the timber sale contract.
- In addition, if boxes 2B or 2C are checked, then Notice of Exclusion or Certificate of Insurance must be submitted within 21 days of the contract award and prior to the issuance of the timber sale contract.
- All Information must be typed or printed except for written signatures.

Please Check Appropriate Categories:

1. My business is organized as (you **must** check one of the boxes below):
  - A.  Sole Proprietorship (individual)
  - B.  Partnership
  - C.  Corporation
2. You **must** check one of the boxes below:
  - A.  I certify that my business is a sole proprietorship and it has no employees but the sole proprietor. I am not subject to the Worker's Compensation Laws.
  - B.  I certify that my business has satisfied its obligation to the Worker's Compensation Act through the use of an approved Notice of Exclusion (BWC-337, Rev. 5/96). I will provide a copy of the Notice of Exclusion within 21 days of the contract award. (For questions or a copy of the BWC-337, please call the Worker's Compensation Bureau at 517-322-1195).
  - C.  I certify that my business has a Worker's Compensation Policy. I will provide an original Certificate of Insurance within 21 days of the contract award.
3. If you have checked item 2(A) or 2(B), you **must** indicate the number of **both** full-time and part-time employees, other than yourself, including family members and active partners (if none, you must enter "0").

\_\_\_\_\_ Full-time Employees

\_\_\_\_\_ Part-time Employees

|                  |       |                                     |
|------------------|-------|-------------------------------------|
| Name of Business |       | Federal ID (or) Social Security No. |
| Address          |       | Telephone<br>(      )               |
| City             | State | ZIP                                 |

I hereby certify that the above information is true and correct. I agree to notify the Michigan DNRE of any changes that occur in factors affecting my coverage during any of my present and future operations.

\_\_\_\_\_  
Signature of Owner or Authorized Representative

\_\_\_\_\_  
Title

\_\_\_\_\_  
Date



BARRED HARDWOODS (71-019-12-01)  
T23N, R02W, SEC. 10, Roscommon County

In response to the notice of sale to be held 11:00 a.m. (local time) on October 23, 2012, I am hereby submitting my sealed bid (firm offer) for the following forest products to be cut. Bids for individual species must be at or above the advertised price. All non-responsive bid forms may be rejected.

| <u>PRODUCTS &amp; SPECIES</u> | <u>ESTIMATED UNITS*</u> | <u>ADVERTISED PRICE</u> | <u>BID PRICE</u> |
|-------------------------------|-------------------------|-------------------------|------------------|
| <u>Sawlogs</u>                |                         |                         |                  |
| Red Maple                     | 26.40 MBF               | \$ 79.00 / MBF          | \$ _____ / MBF   |
| Red Oak                       | 12.10 MBF               | \$ 226.00 / MBF         | \$ _____ / MBF   |
| Sugar Maple                   | 2.10 MBF                | \$ 315.00 / MBF         | \$ _____ / MBF   |
| <u>Pulpwood</u>               |                         |                         |                  |
| B. T. Aspen                   | 31.00 Cords             | \$ 22.10 / Cord         | \$ _____ / Cord  |
| Paper Birch                   | 33.00 Cords             | \$ 15.00 / Cord         | \$ _____ / Cord  |
| Red Maple                     | 124.00 Cords            | \$ 10.15 / Cord         | \$ _____ / Cord  |

In addition, the successful bidder agrees to purchase the following species at the indicated advertised price for a total value of \$1,145.65 :

| <u>PRODUCTS &amp; SPECIES</u> | <u>ESTIMATED UNITS*</u> | <u>ADVERTISED PRICE</u> |
|-------------------------------|-------------------------|-------------------------|
| <u>Sawlogs</u>                |                         |                         |
| B. T. Aspen                   | 16.20 MBF               | \$ 26.00 / MBF          |
| Paper Birch                   | 2.90 MBF                | \$ 65.00 / MBF          |
| <u>Pulpwood</u>               |                         |                         |
| Beech                         | 26.00 Cords             | \$ 14.70 / Cord         |
| Red Oak                       | 15.00 Cords             | \$ 10.25 / Cord         |

\* The total volume is statistically estimated within plus (+) or minus (-) 22.89 percent. The estimated units are final and not subject to adjustment. Prospective bidders are urged to examine this timber and to make their own estimates of quantity and quality.

I understand that any or all bids may be rejected. All bids must be signed and all bid items must be bid or the bid form may be rejected. I also understand that consideration and awarding a contract will be based upon my past performance and ability to complete the contract based upon equipment and staffing subject to my control.

FEDERAL ID: \_\_\_\_\_ or SOCIAL SECURITY NUMBER: \_\_\_\_\_

Company or individual bidding: \_\_\_\_\_

Company representative's name: \_\_\_\_\_

Address: \_\_\_\_\_

City: \_\_\_\_\_ State: \_\_\_\_\_ Zip: \_\_\_\_\_

IF AVAILABLE, PLEASE PLACE THE PERSONALIZED LABEL FROM YOUR PROSPECTUS IN THE ABOVE BOX.

Individual or company representative's signature: \_\_\_\_\_ Date: \_\_\_\_\_

Phone number : \_\_\_\_\_ Email (optional): \_\_\_\_\_



# TIMBER SALE

## VERIFICATION OF WORKER'S DISABILITY COMPENSATION ACT COMPLIANCE

As required by Act 317, P.A. 1969 (Worker's Compensation) and  
Part 525 of Act 451 of 1994, as amended.

| FOR DEPARTMENT USE ONLY          |  |
|----------------------------------|--|
| Sale Number (XX - XXX - XX - XX) |  |
| Forest Management Unit:          |  |

### VERIFICATION OF WORKER'S DISABILITY COMPENSATION ACT COMPLIANCE

- This verification must be completed and submitted within 21 days of contract award and prior to the issuance of the timber sale contract.
- In addition, if boxes 2B or 2C are checked, then Notice of Exclusion or Certificate of Insurance must be submitted within 21 days of the contract award and prior to the issuance of the timber sale contract.
- All Information must be typed or printed except for written signatures.

Please Check Appropriate Categories:

1. My business is organized as (you **must** check one of the boxes below):
  - A.  Sole Proprietorship (individual)
  - B.  Partnership
  - C.  Corporation
2. You **must** check one of the boxes below:
  - A.  I certify that my business is a sole proprietorship and it has no employees but the sole proprietor. I am not subject to the Worker's Compensation Laws.
  - B.  I certify that my business has satisfied its obligation to the Worker's Compensation Act through the use of an approved Notice of Exclusion (BWC-337, Rev. 5/96). I will provide a copy of the Notice of Exclusion within 21 days of the contract award. (For questions or a copy of the BWC-337, please call the Worker's Compensation Bureau at 517-322-1195).
  - C.  I certify that my business has a Worker's Compensation Policy. I will provide an original Certificate of Insurance within 21 days of the contract award.
3. If you have checked item 2(A) or 2(B), you **must** indicate the number of **both** full-time and part-time employees, other than yourself, including family members and active partners (if none, you must enter "0").

\_\_\_\_\_ Full-time Employees

\_\_\_\_\_ Part-time Employees

|                  |       |                                     |
|------------------|-------|-------------------------------------|
| Name of Business |       | Federal ID (or) Social Security No. |
| Address          |       | Telephone<br>(      )               |
| City             | State | ZIP                                 |

I hereby certify that the above information is true and correct. I agree to notify the Michigan DNRE of any changes that occur in factors affecting my coverage during any of my present and future operations.

\_\_\_\_\_  
Signature of Owner or Authorized Representative

\_\_\_\_\_  
Title

\_\_\_\_\_  
Date