



**DEPARTMENT OF NATURAL RESOURCES
STATE OF MICHIGAN**

TIMBER SALE PROSPECTUS #4860

SCHEDULED SALE DATE AND TIME: 2:00 p.m. (local time) on February 21, 2013.

LOCATION: TRAVERSE CITY MGMT UNIT, 970 EMERSON, TRAVERSE CITY, MI 49696.

PROSPECTUS NOTE: The bidder is advised to inspect the sale area and review the location, estimated volumes, operating costs and contract terms of proposed sales. Please be aware that some landowners may request 60 days or more notice for access across their land.

Notice is hereby given that bids will be received by the Unit Manager, TRAVERSE CITY MANAGEMENT UNIT, for certain timber on the following described lands:

BUCK POLE PINE (61-025-12-01) / T25N, R13W, SEC. 14, N1/2NW1/4,NW1/4NE1/4.

Benzie County, Advertised Price \$7,420.55, 38.0 Acres

SALE NOTE: No designated recreation site such as a trail, pathway, or campground is within the sale area or the vicinity. Access may be through state forest land.

BARRENS MIX (61-043-12-01) / T26N, R09W, SEC. 15, NE1/4 E1/2NW NWSE.

Grand Traverse County, Advertised Price \$11,674.70, 71.0 Acres

SALE NOTE: A recreation site such as a trail, pathway, or campground is within the sale area or the vicinity. Certain restrictions/specifications may be applicable including time restrictions. Access may be through state forest land.

INDIANHEAD HARDWOOD (61-059-12-01) / T25N, R13W, SEC. 03, W1/2NW.

T25N, R13W, SEC. 04, E1/2E1/2NE.

Benzie County, Advertised Price \$23,390.93, 65.5 Acres

SALE NOTE: No designated recreation site such as a trail, pathway, or campground is within the sale area or the vicinity. Access may be through state forest land.

CLARY GRADE ASPEN (61-089-12-01) / T25N, R13W, SEC. 03, N1/2.

T25N, R13W, SEC. 04, SENE.

Benzie County, Advertised Price \$21,366.98, 59.0 Acres

SALE NOTE: A recreation site such as a trail, pathway, or campground is within the sale area or the vicinity. Certain restrictions/specifications may be applicable including time restrictions. Access may be through state forest land.

HUNT CAMP PINE (61-095-12-01) / T25N, R14W, SEC. 05, NESW.

T25N, R14W, SEC. 08, NWNW, SENW, SWNW.

Benzie County, Advertised Price \$27,959.35, 84.0 Acres

SALE NOTE: A recreation site such as a trail, pathway, or campground is within the sale area or the vicinity. Certain restrictions/specifications may be applicable including time restrictions. Access may be through state forest land.

SOUTH 21 ASPEN (61-096-12-01) / T25N, R13W, SEC. 15, NE, N1/2SE, NESW.

Benzie County, Advertised Price \$15,874.39, 70.7 Acres

SALE NOTE: A recreation site such as a trail, pathway, or campground is within the sale area or the

vicinity. Certain restrictions/specifications may be applicable including time restrictions. Access may be through state forest land.

BID INSTRUCTIONS (VER. 10/18/2012):

1. Scheduled Bid Location, Date, and Time (2/11)

Bids must be received by the Unit Manager, TRAVERSE CITY OFFICE, 970 EMERSON, TRAVERSE CITY, MI 49696, no later than 2:00 p.m. (local time) on February 21, 2013. For further information concerning this sale, contact David Lemmien at 231-922-5280 extension 6840.

2. Bidder's Qualifications (2/12)

Purchaser shall obtain workers compensation insurance to cover claims under Michigan's Worker's Disability Compensation Act of 1969 or similar employee benefit act of any other state applicable to an employee. If all or part of a timber sale was prepared by a private contractor, that contractor and that contractor's company are not permitted to bid on the timber sale contract. Bids will not be accepted from individuals or companies appearing on the DNR/FRD No-Bid List. This list contains the names of purchasers who previously failed to execute a contract within 21-days or who have a history of poor performance.

3. Preparation of Sealed Bids (1/11)

Bids shall be manually signed in ink; bid prices must be entered for each species and product in the Bid Price column for all material subject to bidding; and all fill-in blanks must be completed. If erasures or other changes appear on the forms, each erasure or change must be initialed by the person signing the bid.

4. Submission of Sealed Bids (6/11)

Bid forms may be obtained from the Unit Manager. All bids must be submitted on the bid form and in an envelope clearly identified as described in this section. NOTE: Only one bid form per bid envelope. Sealed bids must be submitted to the Unit office designated in the prospectus and must be submitted at or prior to the time established in the prospectus. The envelope should show on the outside (a) the sale name or number and (b) the date and time of bid opening as shown in the prospectus. Bids received after the time specified in the sale prospectus are late bids and will be rejected.

5. Public Opening of Sealed Bids (1/11)

If conditions permit, the sealed bids will be publicly opened and posted at the time and place set in the prospectus.

6. Award of Contract (1/11)

Award of the contract will be made to the Bidder whose bid, conforming to the prospectus, is most advantageous to the State of Michigan on the basis of total value at rates bid for the estimated quantities. The State reserves the right to reject any bid or waive any minor irregularity in bids received. A written award mailed (or otherwise furnished) to the successful Bidder shall be deemed to result in a binding contract without further action by either party.

7. Down Payment (1/11)

The Bidder to whom award is made must make a down payment within 21 days of the sale award. The amount of the down payment will be calculated as shown in the Bond and Payment Schedule of this prospectus. Only cash may be used to meet this requirement.

8. Performance Security (1/11)

As guarantee of faithful performance, a cash bond, certificate of deposit, surety bond or irrevocable letter of credit (LOC) is required within 21 days of the sale award. The amount of the performance security is shown in the Bond and Payment Schedule of this prospectus. If an LOC or surety is used, the coverage must extend for at least 6 months beyond the contract expiration.

9. Timber Sale Contract (10/12)

Additional conditions and requirements common to all timber sales are listed on the timber sale contract (R4031) and are available on line at www.michigan.gov/timber. Contact the Unit Manager for additional information or a sample contract. Within 21 days of the date of the award letter, the bidder must sign the contract and provide the required down payment, performance security, and verification of worker's disability compensation. The down payment and performance security shall be in accordance with the provisions of the timber sale contract, in the sums stated in this prospectus. If these actions are not taken, then the Bidder, the Bidder's corporation, and the corporation's principals may not be permitted to bid on State timber sales for a period of 1 year. In addition, the Bidder certifies that if awarded this contract, the Bidder will complete the timber sale contract in accordance with its terms and any modifications thereof including requirements to purchase, cut, and remove

the included timber by the termination date.

10. Disclaimer of Estimates and Bidder's Warranty of Inspection (1/11)

Before submitting this bid, the Bidder is advised and cautioned to inspect the sale area, review the requirements of the sale contract, and take other steps as may be reasonably necessary to ascertain the location, estimated volumes, construction estimates, and operating costs of the proposed sale. Failure to do so will not relieve the Bidder from responsibility for completing the contract.

The Bidder warrants that this bid is submitted solely on the basis of the Bidder's examination and inspection of the quality and quantity of the timber offered for sale and the Bidder's opinion of the value thereof and the costs of recovery. No reliance should be placed on the State of Michigan's estimates of timber quality, quantity or costs of recovery. Bidder further acknowledges that the State of Michigan: (i) expressly disclaims any warranty of fitness of timber for any purpose; (ii) offers this timber as is without any warranty of quality (merchantability) or quantity and (iii) expressly disclaims any warranty as to the quantity or quality of timber sold.

11. Certification and Chain-of-Custody (10/11)

Unless otherwise indicated in the contract under section 7 – Other Conditions of the Sale Specific Conditions & Requirements, the area encompassed by this timber sale is certified to the standards of the Forest Stewardship Council (FSC) - Certificate #SCS-FM/COC-00090N and the Sustainable Forestry Initiative (SFI) - Certificate # NSF-SFIS-5Y031-S1. Forest products from this sale may be delivered to the mill as "FSC Pure and / or SFI certified" as long as the contractor hauling the forest products is chain-of-custody (COC) certified or covered under a COC certificate from the destination mill. The purchaser is responsible for maintaining COC after leaving the sale area.

KEITH CREAGH

Director

TIMBER SALE INFORMATION

BUCK POLE PINE (61-025-12-01)

T25N, R13W, SEC. 14.

Benzie County (Advertised Price \$7,420.55)

SALE NOTE: No designated recreation site such as a trail, pathway, or campground is within the sale area or the vicinity. Access may be through state forest land.

A timber sale contract for this lump sum, sealed bid timber sale will be awarded to the responsible bidder offering the highest sealed bid price. Bids must be at or above the following advertised price for each species:

<u>PRODUCTS & SPECIES</u>	<u>ESTIMATED UNITS*</u>	<u>ADVERTISED PRICE</u>
Sawlogs		
White Pine	35.50 MBF	\$ 52.00 / MBF
Pulpwood		
Q. Aspen	121.00 Cords	\$ 13.10 / Cord
Red Maple	46.00 Cords	\$ 15.50 / Cord
White Pine	549.00 Cords	\$ 5.85 / Cord

In addition, the successful bidder agrees to purchase the following species at the indicated advertised price for a total value of \$64.80:

<u>PRODUCTS & SPECIES</u>	<u>ESTIMATED UNITS*</u>	<u>ADVERTISED PRICE</u>
Sawlogs		
Red Maple	0.80 MBF	\$ 81.00 / MBF

* The total volume is statistically estimated within plus (+) or minus (-) 11.06 percent. The estimated units are final and not subject to adjustment. Prospective bidders are urged to examine this timber and to make their own estimates of quantity and quality.

BOND AND PAYMENT SCHEDULE:

1. A bond in the amount of **\$400.00** to insure faithful performance of the conditions of the contract will be deposited by the successful bidder within 21 days of the sale award.
2. Cutting in any sale or unit without the required advance payment would be considered a trespass.
3. Total payment must be paid in advance or according to the following schedule:
 - (a) Ten percent (10%) of the sale value must be paid within 21 days of the sale award.
 - (b) The 10% down payment will be credited towards the first unit cut.
 - (c) Payment for each of the following units must be made before cutting begins in that unit:

<u>PAYMENT UNIT NUMBER</u>	<u>PERCENT OF TOTAL SALE VALUE</u>
01	36%
02	64%
4. If no cutting takes place, the 10% down payment will not be refunded.
5. Operations on the contract issued will terminate on 03/31/2015.

Sale Specific Conditions & Requirements

Sale Name: Buck Pole Pine Sale Number: 61-025-12-01

1 - Sale Area

1.2 - Boundaries

1.2.1 - Painted boundaries (12/08)

The sale boundary and Payment Unit boundaries are marked and identified by red paint. Do not cut painted boundary line trees.

2 - Timber Specifications

2.1 - Included Timber

2.1.7 - Leave tree marked unit(s) (8/11)

Within Payment Unit(s) 1 and 2, cut all White Pine, Apen, and Red Maple trees that are two (2) inches or more in diameter measured at a point four and one-half (4-1/2) feet above ground level regardless of merchantability except Oak, Cherry and trees marked with green paint above and below stump height.

4 - Transportation

4.1 - Construction

4.1.12 - No new roads (1/12)

No new roads will be permitted in any Payment Unit. All operations are limited to existing roads. Skid trails only will be allowed.

5 - Operations

5.1 - Notification

5.1.1 - Pre-sale conference (10/11)

A pre-sale conference on site between the Purchaser and sale administrator is required prior to beginning any operations to determine landing and road locations. The Unit Manager or his/her representative must be contacted at least 5 days in advance to schedule the conference.

5.2 - Conduct of Operations

5.2.1 - Slash

5.2.1.8 - Slash height (12/08)

No slash or tree tops may exceed 24 inches in height.

5.2.2 - Hazard Trees/Snags

5.2.2.1 - Den trees (2/04)

Obvious hollow and/or den trees shall be protected and left standing unless they are a safety hazard.

5.2.3 - Operating Restrictions

5.2.3.6 - Bark beetle restriction (12/08)

In the event drought creates a high risk of pine bark beetle infestation, pine is not to be cut during the period March 1 through July 1, unless all portions of trees greater than two inches in diameter are removed from the sale area, reduced to chips, or treated to the satisfaction of the Unit Manager or his/her representative, within fifteen days of being severed from the stump. Pine log decks, pulpwood piles and treetops that are piled for chipping in the fall or winter within a 1/4 mile of susceptible sites must be removed before March 15. Residual slash must not be placed in piles or rows and must be spread over the site for quick drying. The Department of Natural Resources will exercise this specification if the risk of damage warrants.

5.2.38 - No decking against live trees (2/04)

Cut products may not be decked against unmarked or designated leave trees.

5.4 - Soil Protection

5.4.1 - Rutting restriction, general (1/09)

Operations are to cease immediately if equipment and weather conditions result in rutting of roads and skid trails which is 12

inches or greater in depth and 50 feet in length. The Unit Manager or his/her representative may restrict hauling and/or skidding if ruts exceed the specified depth. With the Unit Manager or his/her representative's approval, the Purchaser may return to the area when the risk of rutting has decreased.



TIMBER SALE MAP

61-025

2012

This information provided by authority of Part 525, 1994 PA 451, as amended.

Forest Management Unit Traverse City		County Benzie	Mapped By Derek Cross	Date 2/13/2012	Page 1	of 1
Township T25N	Range R13W	Section(s) and Subdivision(s) Sec. 14 N1/2NW,NWNE			1:15,840	
Cruised By Derek Cross						

Cover Type				Density		
A = Aspen	G = Grass	O = Oak	U = Upland Brush	0 = Non Stocked	5 = Pole Timber Medium	
B = Paper Birch	H = Hemlock	P = Lowland Poplar	V = Bog or Marsh	1 = Seedling Sapling Poor	6 = Pole Timber Well	
C = Cedar	J = Jack Pine	Q = Mixed Swamp Cnfr	W = White Pine	2 = Seedling Sapling Medium	7 = Saw Timber Poor	
D = Treed Bog	L = Lowland Brush	R = Red Pine	X = Non Stocked	3 = Seedling Sapling Well	8 = Saw Timber Medium	
E = Swamp Hdwoods	M = Mpl, Bch, Brch	S = Black Spruce	Z = Water	4 = Pole Timber Poor	9 = Saw Timber Well	
F = Spruce Fir	N = Marsh	T = Tamarack				

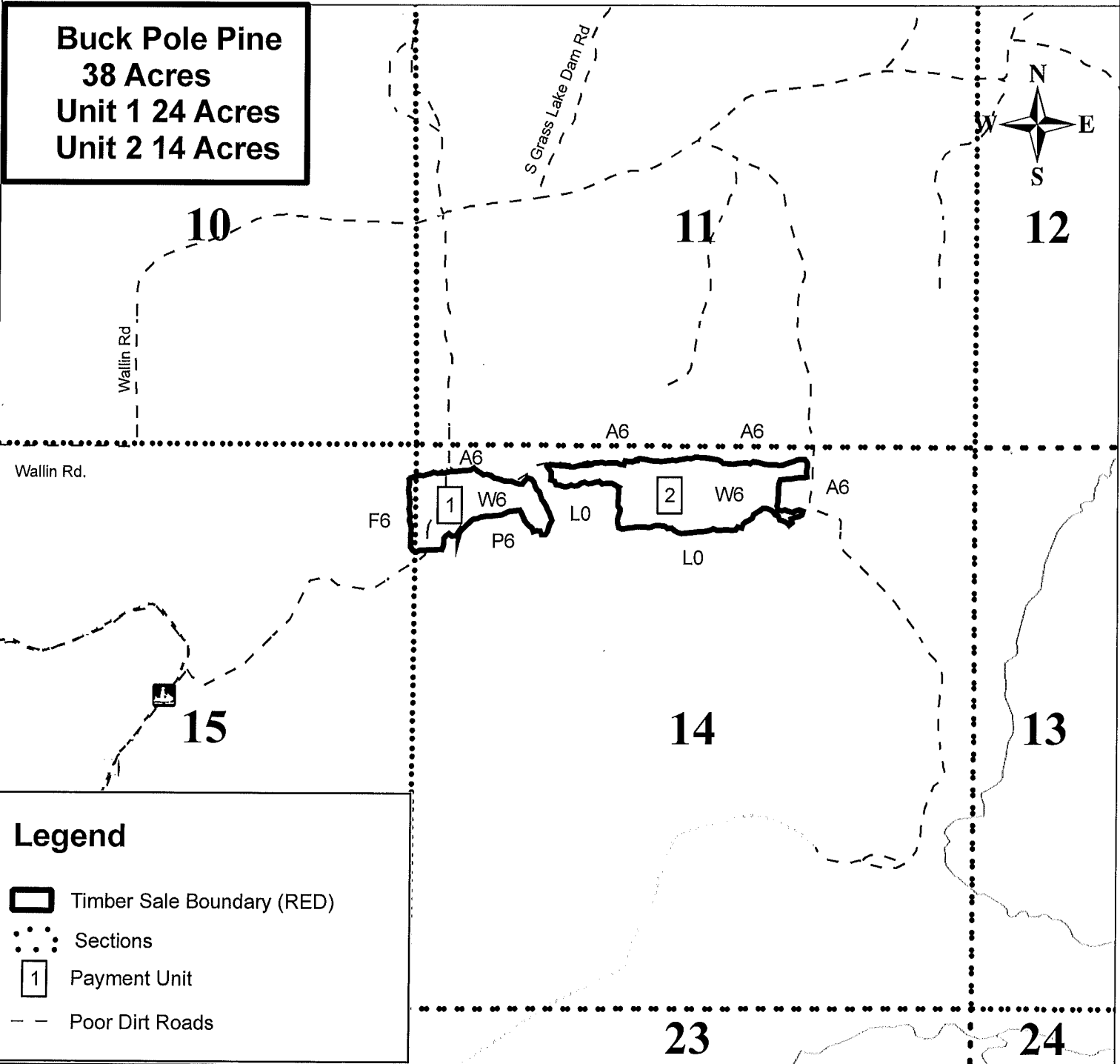

TIMBER SALE INFORMATION

BARRENS MIX (61-043-12-01)

T26N, R09W, SEC. 15.

Grand Traverse County (Advertised Price \$11,674.70)

SALE NOTE: A recreation site such as a trail, pathway, or campground is within the sale area or the vicinity. Certain restrictions/specifications may be applicable including time restrictions. Access may be through state forest land.

A timber sale contract for this lump sum, sealed bid timber sale will be awarded to the responsible bidder offering the highest sealed bid price. Bids must be at or above the following advertised price for each species:

<u>PRODUCTS & SPECIES</u>	<u>ESTIMATED UNITS*</u>	<u>ADVERTISED PRICE</u>
Pulpwood		
Jack Pine	276.00 Cords	\$ 17.50 / Cord
Mixed Aspen	87.00 Cords	\$ 22.75 / Cord
Red Maple	52.70 Cords	\$ 20.35 / Cord
Red Pine	19.00 Cords	\$ 61.70 / Cord

In addition, the successful bidder agrees to purchase the following species at the indicated advertised price for a total value of \$2,620.70:

<u>PRODUCTS & SPECIES</u>	<u>ESTIMATED UNITS*</u>	<u>ADVERTISED PRICE</u>
Sawlogs		
Mixed Oak	3.20 MBF	\$ 138.00 / MBF
Red Maple	1.80 MBF	\$ 144.00 / MBF
Red Pine	1.30 MBF	\$ 143.00 / MBF
White Pine	3.20 MBF	\$ 75.00 / MBF
Pulpwood		
Black Cherry	18.00 Cords	\$ 28.00 / Cord
Mixed Oak	28.00 Cords	\$ 11.40 / Cord
White Pine	52.00 Cords	\$ 12.90 / Cord

* The total volume is statistically estimated within plus (+) or minus (-) 19.12 percent. The estimated units are final and not subject to adjustment. Prospective bidders are urged to examine this timber and to make their own estimates of quantity and quality.

BOND AND PAYMENT SCHEDULE:

1. A bond in the amount of **\$500.00** to insure faithful performance of the conditions of the contract will be deposited by the successful bidder within 21 days of the sale award.
2. Cutting in any sale or unit without the required advance payment would be considered a trespass.
3. Total payment must be paid in advance or according to the following schedule:
 - (a) Ten percent (10%) of the sale value must be paid within 21 days of the sale award.
 - (b) The 10% down payment will be credited towards the first unit cut.
 - (c) Payment for each of the following units must be made before cutting begins in that unit:

<u>PAYMENT UNIT NUMBER</u>	<u>PERCENT OF TOTAL SALE VALUE</u>
01	30%
02	22%
03	15%
04	33%
4. If no cutting takes place, the 10% down payment will not be refunded.
5. Operations on the contract issued will terminate on 03/31/2015.

Sale Specific Conditions & Requirements

Sale Name: Barrens Mix Sale Number: 61-043-12-01

1 - Sale Area

1.2 - Boundaries

1.2.1 - Painted boundaries (12/08)

The sale boundary and Payment Unit boundaries are marked and identified by red and yellow paint. Exterior sale boundary lines against state are marked with red paint. Interior Payment Unit boundaries are marked with yellow paint. Do not cut painted boundary line trees unless they are jack pine or aspen. Cut all jack pine and aspen trees that have red boundary tree marks. Yellow painted trees designating an interior Payment Unit boundary are only to be cut when all surrounding Payment Units have been paid; unless also marked with green paint.

2 - Timber Specifications

2.1 - Included Timber

2.1.2 - Clearcut unit(s) w/o unmerchantable trees (8/11)

Within Payment Unit(s), cut all trees which meet minimum piece specifications in 2.2 Utilization except trees marked with green paint. Special protection trees identified in accordance with condition 3.4.2, within clearcutting unit boundaries, are not Included Timber and are to be protected.

2.1.11 - Description of timber note (2/04)

Note that mixed oak is red, pin and white oak

2.2 - Utilization

2.2.2 - Chipping required (1/11)

This area must be chip harvested to facilitate future silvicultural activities. The purchaser has the option to produce sawlogs or pulpwood bolts, but the remaining portion of the trees must be chipped and hauled. The requirement to retain approximately 1/6 to 1/3 of tree tops and limbs less than four inches in diameter does not apply (G. C. & R. 2.2). This is because of planned prescribed burning activities.

3 - Payments

3.4 - Damaged Timber

3.4.2 - Special Protection Trees (8/11)

The Purchaser shall not cut live or dead special protection trees within cutting units or clearings. Special protection trees are marked with green paint. The Purchaser shall protect special protection trees from damage by the Purchaser's operations. If the Purchaser's operations have cut or damaged special protection trees through carelessness, the Purchaser shall pay \$15 as fixed, agreed and liquidated damages for each special protection tree cut or damaged. Such payment does not constitute ownership of the undesignated timber.

4 - Transportation

4.1 - Construction

4.1.12 - No new roads (1/12)

No new roads will be permitted in any Payment Unit. Skidding operations must remain within the limits of the sale area to protect the managed barrens area that surrounds the harvest units. All operations are limited to existing roads. Skid trails only will be allowed.

4.2 - Maintenance

4.2.4 - Grading (12/08)

Roads must be graded after the sale is completed. In general, this will require a road grader or bull dozer to shape up the roads after forest products have been hauled off site. The grading equipment to be used must be approved by the Unit Manager or his/her representative.

5 - Operations

5.1 - Notification

5.1.1 - Pre-sale conference (10/11)

A pre-sale conference on site between the Purchaser and sale administrator is required prior to beginning any operations to determine landing and road locations. The Unit Manager or his/her representative must be contacted at least 3 days in advance to schedule the conference.

5.1.4 - Post-sale conference (6/11)

A post-sale conference on site between the Purchaser and sale administrator is required prior to the completion of active logging operations to determine clean-up and repair of landings, road edges, and the fulfillment of other contract specifications.

5.2 - Conduct of Operations

5.2.2 - Hazard Trees/Snags

5.2.2.1 - Den trees (2/04)

Obvious hollow and/or den trees shall be protected and left standing unless they are a safety hazard.

5.2.29 - Shrub protection (9/07)

Do not cut or damage hawthorn, witch-hazel, dogwood or juneberry. These woody-shrub plants are highly beneficial to various wildlife species.

5.2.32 - Decking/landing restoration (9/11)

All decking and landing areas must have the surface area restored to a condition equal to or better than before. This is to ensure the proper regeneration of the stand. Slash from chipping operation should not accumulate at landing area but should be scattered out back in harvest unit.

5.2.40 - Pathway protection (10/10)

The Grand Traverse Motorcycle is shown on the Timber Sale Map. Do not cut trees or damage posts with orange pathway markers and cut only aspen and jack pine within 20 feet of either side of the trail. Leave all other species found within this buffer strip. If trees are harvested that directly abutt the trail they must be cut six feet high. If this is not possible due to equipment limitations they must be cut flush with the ground. All trees cut within 5 feet of the trail should be cut as flush with the ground as possible. Maintain a 20-foot wide slash, debris, and rut free zone daily, using the pathway as the centerline. Do not run equipment down the pathway. Skidding across the trail may only occur in locations approved by the sale administrator.

5.4 - Soil Protection

5.4.1 - Rutting restriction, general (1/09)

Operations are to cease immediately if equipment and weather conditions result in rutting of roads and skid trails which is 12 inches or greater in depth and 50 feet in length. The Unit Manager or his/her representative may restrict hauling and/or skidding if ruts exceed the specified depth. With the Unit Manager or his/her representative's approval, the Purchaser may return to the area when the risk of rutting has decreased.

6 - Safety and Fire Prevention

6.2 - Signing

6.2.1 - Road posting (9/09)

The purchaser is responsible for posting and maintaining caution signs on Jack Pine Road prior to beginning operations. The road must be posted at appropriate distances from the sale area to warn of logging activity and truck traffic. Signs must be removed when harvest operations are suspended or completed. The Purchaser will provide these signs.

6.2.3 - Recreational trail posting (2/10)

The Purchaser is responsible for posting and maintaining caution signs on the Grand Traverse Motorcycle Trail prior to beginning operations. The trail must be posted at appropriate distances from the sale area to warn of logging activity and truck traffic at both ends of the trail. Signs must be removed when harvest operations are suspended or completed. The Purchaser will provide these signs.

Sale No.	Year	Sale Type
043	12	01

This information provided under authority of Part 525, Act 451 of 1994, as amended.

State Forest and Forest Management Unit: Pere Marquette - Traverse City		Mapped By: Patrick Ruppen		Date: 9/19/12
Township 26N	Range 9W	Section(s) 15	Subdivision NE1/4 E1/2NW NWSE	Scale: 1:15,840

Cover Type

Density

- | | | | | | |
|-----------------|------------------|--------------------|----------------|-------------------------|---------------------|
| A=Aspen | H=Hemlock | P=Lowland Poplar | V=Bog or Marsh | 1=Non Stocked | 7=Saw Timber Poor |
| B=Paper Birch | J=Jack Pine | Q=Mixed Swamp Cnfr | W=White Pine | 2=Seedling Sapling Poor | 8=Saw Timber Medium |
| C=Cedar | L=Lowland Brush | R=Red Pine | X=Non Stocked | 3=Seedling Sapling Well | 9=Saw Timber Well |
| E=Swamp Hdwoods | M=Mpl, Bch, Brch | S=Black Spruce | Z=Water | 4=Pde Timber Poor | |
| F=Spruce Fir | N=Marsh | T=Tamarack | | 5=Pde Timber Medium | |
| G=Grass | O=Oak | U=Upland Brush | | 6=Pde Timber Well | |



Barrens Mix

Sale Area: 71 acres

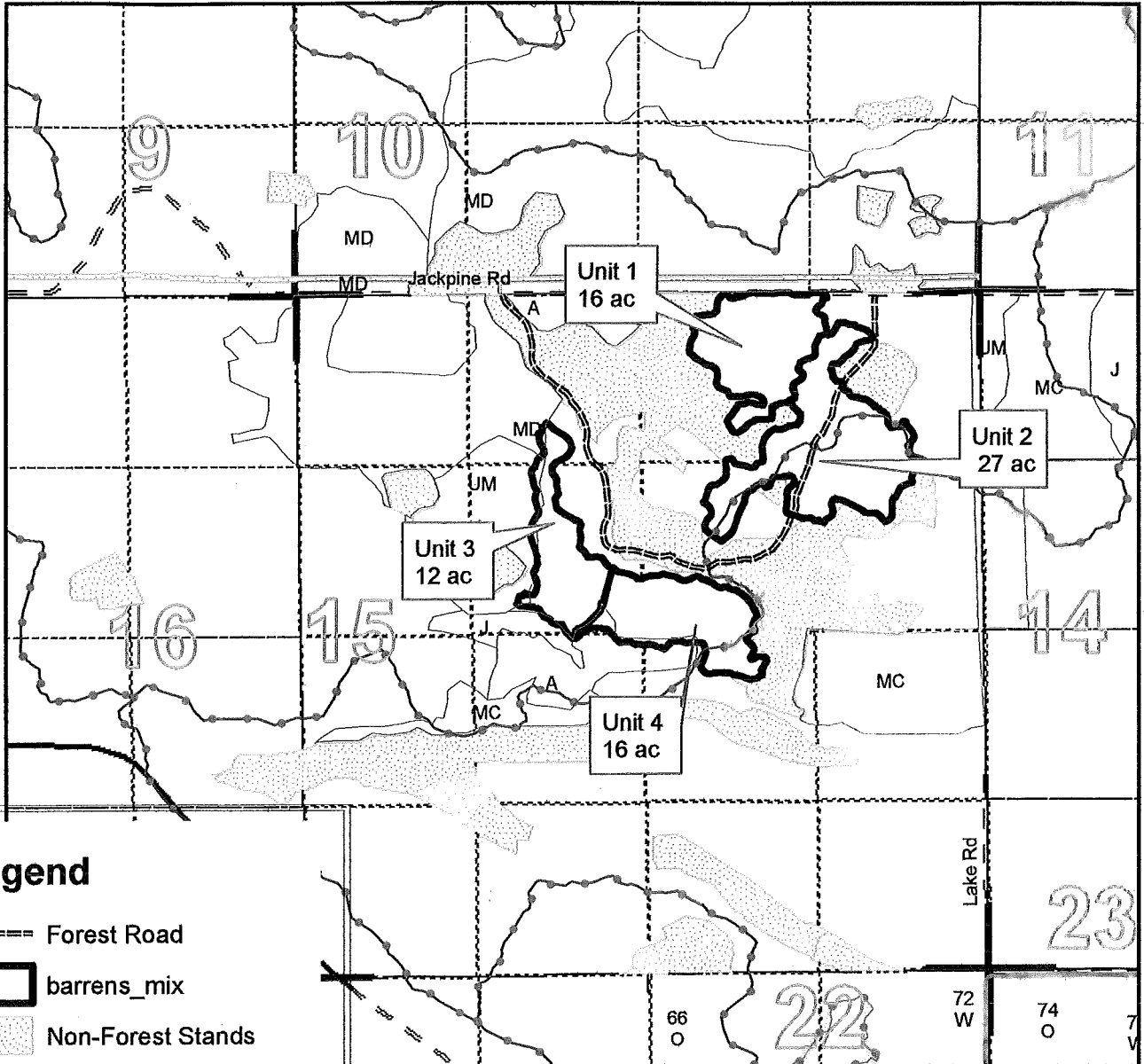

Legend

- ==== Forest Road
- barrens_mix
- Non-Forest Stands
- Paved Roads
- == == Gravel Roads
- Motorcycle-DNR Sticker

TIMBER SALE INFORMATION

INDIANHEAD HARDWOOD (61-059-12-01)
 T25N, R13W, SEC. 03; T25N, R13W, SEC. 04.
 Benzie County (Advertised Price \$23,390.93)

SALE NOTE: No designated recreation site such as a trail, pathway, or campground is within the sale area or the vicinity. Access may be through state forest land.

A timber sale contract for this lump sum, sealed bid timber sale will be awarded to the responsible bidder offering the highest sealed bid price. Bids must be at or above the following advertised price for each species:

<u>PRODUCTS & SPECIES</u>	<u>ESTIMATED UNITS*</u>	<u>ADVERTISED PRICE</u>
Sawlogs		
Basswood	44.30 MBF	\$ 124.00 / MBF
Beech	18.90 MBF	\$ 131.00 / MBF
Sugar Maple	15.20 MBF	\$ 341.00 / MBF
White Ash	17.90 MBF	\$ 107.00 / MBF
Pulpwood		
Beech	215.90 Cords	\$ 9.40 / Cord
Mixed Hardwood	105.10 Cords	\$ 14.70 / Cord
Sugar Maple	220.40 Cords	\$ 9.70 / Cord

In addition, the successful bidder agrees to purchase the following species at the indicated advertised price for a total value of \$2,611.02:

<u>PRODUCTS & SPECIES</u>	<u>ESTIMATED UNITS*</u>	<u>ADVERTISED PRICE</u>
Sawlogs		
Mixed Hardwood	8.10 MBF	\$ 106.00 / MBF
Pulpwood		
Basswood	108.60 Cords	\$ 6.80 / Cord
White Ash	117.90 Cords	\$ 8.60 / Cord

* The total volume is statistically estimated within plus (+) or minus (-) 17.09 percent. The estimated units are final and not subject to adjustment. Prospective bidders are urged to examine this timber and to make their own estimates of quantity and quality.

BOND AND PAYMENT SCHEDULE:

1. A bond in the amount of **\$1,170.00** to insure faithful performance of the conditions of the contract will be deposited by the successful bidder within 21 days of the sale award.
2. Cutting in any sale or unit without the required advance payment would be considered a trespass.
3. Total payment must be paid in advance or according to the following schedule:
 - (a) Ten percent (10%) of the sale value must be paid within 21 days of the sale award.
 - (b) The 10% down payment will be credited towards the first unit cut.
 - (c) Payment for each of the following units must be made before cutting begins in that unit:

<u>PAYMENT UNIT NUMBER</u>	<u>PERCENT OF TOTAL SALE VALUE</u>
01	80%
02	20%
4. If no cutting takes place, the 10% down payment will not be refunded.
5. Operations on the contract issued will terminate on 12/31/2015.

Sale Specific Conditions & Requirements

Sale Name: Indianhead Hardwood Sale Number: 61-059-12-01

1 - Sale Area

1.2 - Boundaries

1.2.1 - Painted boundaries (12/08)

The sale boundary and Payment Unit boundaries are marked and identified by blue and red paint. Exterior sale boundary lines against private property are marked with blue paint. Exterior sale boundary lines against state are marked with red paint. Do not cut painted boundary line trees unless also marked with orange paint.

2 - Timber Specifications

2.1 - Included Timber

2.1.3 - Cut tree marked unit(s) (12/08)

Within Payment Unit(s) 1 and 2, all trees are designated for cutting when marked with orange paint above and below stump height, regardless of merchantability. Also in unit 1 cut all ash, beech and aspen trees unless they are marked with green paint.

4 - Transportation

4.1 - Construction

4.1.3 - Slash and earthen piles (8/04)

Piles or windrows of earth along roads and landings that have been widened or constructed shall be leveled. Slash from road maintenance or construction, including stumps, shall be dispersed throughout the sale.

4.1.12 - No new roads (1/12)

No new roads will be permitted in any Payment Unit. All operations are limited to existing roads. Skid trails only will be allowed.

4.2 - Maintenance

4.2.4 - Grading (12/08)

Roads must be graded after the sale is completed. In general, this will require a road grader or bull dozer to shape up the roads after forest products have been hauled off site. The grading equipment to be used must be approved by the Unit Manager or his/her representative.

4.2.5 - Two wheel drive condition (2/04)

All existing trail roads on and adjacent to the sale area must be passable by two-wheel drive traffic for the duration of the sale.

5 - Operations

5.1 - Notification

5.1.1 - Pre-sale conference (10/11)

A pre-sale conference on site between the Purchaser and sale administrator is required prior to beginning any operations to determine landing locations. The Unit Manager or his/her representative must be contacted at least 5 days in advance to schedule the conference.

5.1.4 - Post-sale conference (6/11)

A post-sale conference on site between the Purchaser and sale administrator is required 5 days prior to the completion of active logging operations to determine clean-up and repair of landings, road edges, and the fulfillment of other contract specifications.

5.2 - Conduct of Operations

5.2.1 - Slash

5.2.1.8 - Slash height (12/08)

No slash or tree tops may exceed 24 inches in height.

5.2.2 - Hazard Trees/Snags

5.2.2.1 - Den trees (2/04)

Obvious hollow and/or den trees shall be protected and left standing unless they are a safety hazard.

5.2.3 - Operating Restrictions

5.2.3.3 - Bark slippage restriction (3/09)

Within Payment Unit(s) 1, unless changed by written agreement, cutting and skidding are not permitted during the period of April 15 to July 15. This restriction is because of bark slippage.

5.2.3.9 - Beech hauling restriction (3/11)

American beech wood products with bark still attached, other than chips, are not to be transported from stands infested with beech scale to the lower peninsula or to Wisconsin from July 15 to November 15. Beech scale is mobile at this time of year and can move from infested wood to live beech. (See Map of current beech scale distribution on the DNR Forest Health Website, www.michigan.gov/dnr.)

5.2.4 - Dead and Down Creation

5.2.4.1 - Dead and down creation, marked trees (12/08)

All trees marked with a orange painted X in Unit two ONLY, must be cut, felled and left on the ground for wildlife and course woody debris puposes. These trees have been taken off the timber tally.

5.2.38 - No decking against live trees (2/04)

Cut products may not be decked against unmarked or designated leave trees.

5.4 - Soil Protection

5.4.4 - Slope protection (2/04)

Skid trails and roads on slopes shall be water barred with slash, stumps, and/or hay bales as soon as use is complete to prevent erosion.

5.8 - Protection of Endangered Species

5.8.5 - Protection of raptor nests (4/09)

All trees with raptor nests will be protected if found during harvesting operations. Notification will be made to the Unit Manager or his/her representative who will notify the Wildlife Biologist so an on-site evaluation and recommendation can be made, if necessary.

7 - Other Conditions

7.5 - Loss

7.5.1 - Deteriorating timber (7/09)

The sale area has received damage from emerald ash borer and beech scale. The purchaser should harvest the wood as soon as possible. The Department of Natural Resources is held free of responsibility of any further damage or deterioration due to delay in harvesting.



Sale Number	Year
059	2012

TIMBER SALE MAP

This information provided by authority of Part 525, 1994 PA 451, as amended.

Forest Management Unit Traverse City	County Benzie	Mapped By Cross, Tweedale, Allen	Date 10/1/2012	Page 1	of 1
		Cruised By Cross, Tweedale, Allen			

Township 25N	Range 13W	Section(s) and Subdivision(s) Sec. 3, W1/2NW Sec. 4, E1/2E1/2NE	Scale 1:15,840
-----------------	--------------	---	-------------------

Cover Type				Density	
A = Aspen	G = Grass	O = Oak	U = Upland Brush	0 = Non Stocked	5 = Pole Timber Medium
B = Paper Birch	H = Hemlock	P = Lowland Poplar	V = Bog or Marsh	1 = Seedling Sapling Poor	6 = Pole Timber Well
C = Cedar	J = Jack Pine	Q = Mixed Swamp Cnfr	W = White Pine	2 = Seedling Sapling Medium	7 = Saw Timber Poor
D = Tread Bog	L = Lowland Brush	R = Red Pine	X = Non Stocked	3 = Seedling Sapling Well	8 = Saw Timber Medium
E = Swamp Hdwoods	M = Mpl, Bch, Brch	S = Black Spruce	Z = Water	4 = Pole Timber Poor	9 = Saw Timber Well
F = Spruce Fir	N = Marsh	T = Tamarack			

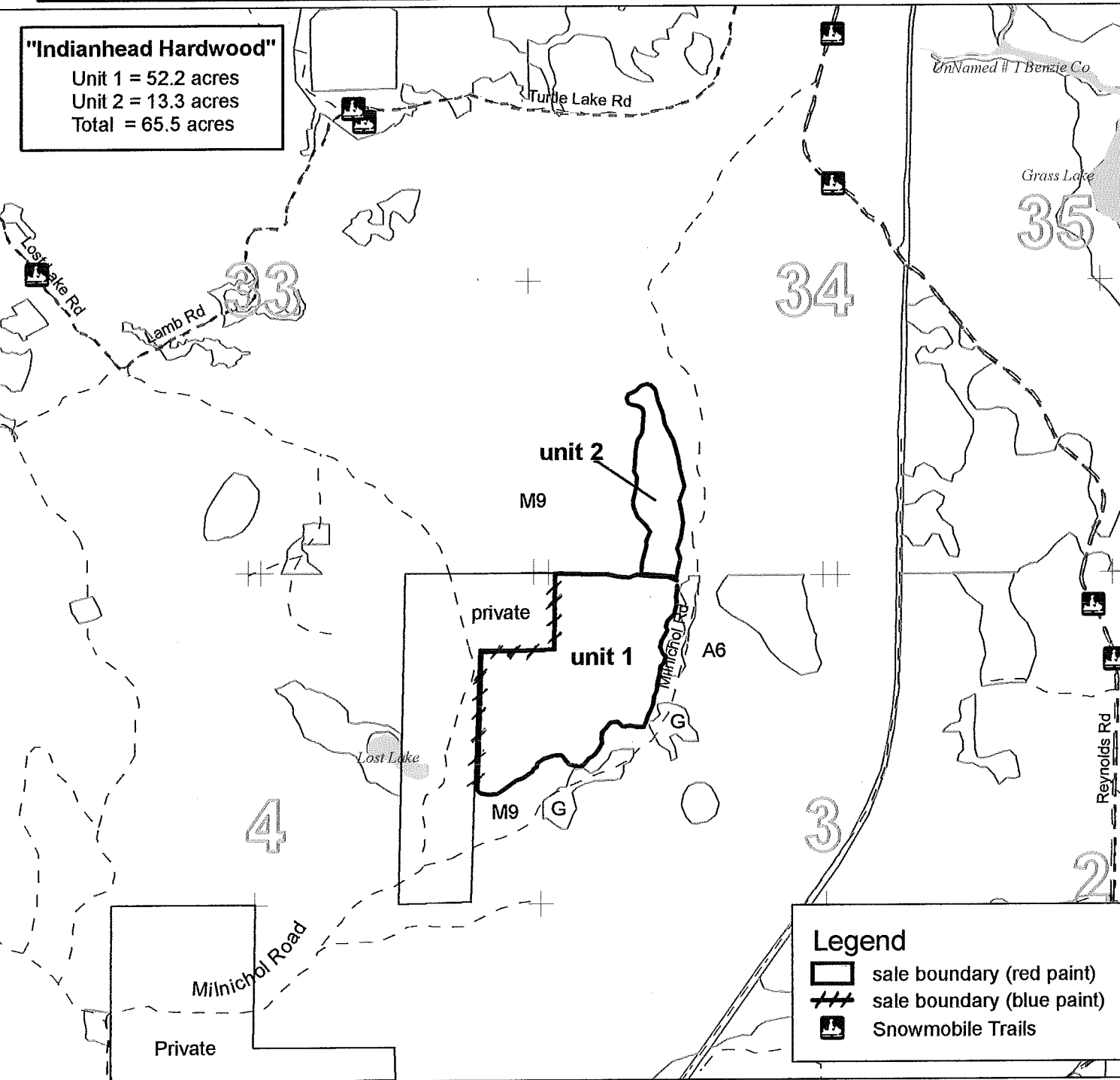

TIMBER SALE INFORMATION

CLARY GRADE ASPEN (61-089-12-01)
 T25N, R13W, SEC. 03; T25N, R13W, SEC. 04.
 Benzie County (Advertised Price \$21,366.98)

SALE NOTE: A recreation site such as a trail, pathway, or campground is within the sale area or the vicinity. Certain restrictions/specifications may be applicable including time restrictions. Access may be through state forest land.

A timber sale contract for this lump sum, sealed bid timber sale will be awarded to the responsible bidder offering the highest sealed bid price. Bids must be at or above the following advertised price for each species:

<u>PRODUCTS & SPECIES</u>	<u>ESTIMATED UNITS*</u>	<u>ADVERTISED PRICE</u>
Sawlogs		
B. T. Aspen	63.60 MBF	\$ 71.00 / MBF
Pulpwood		
B. T. Aspen	681.30 Cords	\$ 17.50 / Cord
Red Maple	107.50 Cords	\$ 17.55 / Cord

In addition, the successful bidder agrees to purchase the following species at the indicated advertised price for a total value of \$3,042.00:

<u>PRODUCTS & SPECIES</u>	<u>ESTIMATED UNITS*</u>	<u>ADVERTISED PRICE</u>
Sawlogs		
Black Cherry	4.00 MBF	\$ 334.00 / MBF
Red Maple	5.90 MBF	\$ 124.00 / MBF
Pulpwood		
Black Cherry	40.60 Cords	\$ 24.00 / Cord

* The total volume is statistically estimated within plus (+) or minus (-) 16.82 percent. The estimated units are final and not subject to adjustment. Prospective bidders are urged to examine this timber and to make their own estimates of quantity and quality.

BOND AND PAYMENT SCHEDULE:

1. A bond in the amount of **\$1,068.00** to insure faithful performance of the conditions of the contract will be deposited by the successful bidder within 21 days of the sale award.
2. Cutting in any sale or unit without the required advance payment would be considered a trespass.
3. Total payment must be paid in advance or according to the following schedule:
 - (a) Ten percent (10%) of the sale value must be paid within 21 days of the sale award.
 - (b) The 10% down payment will be credited towards the first unit cut.
 - (c) Payment for each of the following units must be made before cutting begins in that unit:

PAYMENT UNIT NUMBER	PERCENT OF TOTAL SALE VALUE
01	14%
02	55%
03	31%
4. If no cutting takes place, the 10% down payment will not be refunded.
5. Operations on the contract issued will terminate on 12/31/2015.

Sale Specific Conditions & Requirements

Sale Name: Clary Grade Aspen Sale Number: 61-089-12-01

1 - Sale Area

1.2 - Boundaries

1.2.1 - Painted boundaries (12/08)

The sale boundary and Payment Unit boundaries are marked and identified by red paint. Exterior sale boundary lines against state are marked with red paint. Do not cut painted boundary line trees.

2 - Timber Specifications

2.1 - Included Timber

2.1.7 - Leave tree marked unit(s) (8/11)

Within Payment Unit(s) 1, 2, and 3, cut all aspen, red maple and cherry trees regardless of merchantability. Do not cut any other species. Do not cut any trees marked with green paint above and below stump height. Do not cut any conifers. Special protection trees identified in accordance with condition 3.4.2, within clearcutting unit boundaries, are not Included Timber and are to be protected. Special protection areas identified in accordance with condition 3.4.3, within clearcutting unit boundaries, are not Included Timber and are to be protected.

2.2 - Utilization

2.2.3 - Stump heights (4/07)

Stump heights within the Sale Areas shall not exceed 12 inches for trees greater than 10 inches DBH and 4 inches for trees smaller than 10 inches DBH.

3 - Payments

3.4 - Damaged Timber

3.4.2 - Special Protection Trees (8/11)

The Purchaser shall not cut live or dead special protection trees within cutting units or clearings. Special protection trees are marked with green paint or designated species, size, etc. The Purchaser shall protect special protection trees from damage by the Purchaser's operations. If the Purchaser's operations have cut or damaged special protection trees through carelessness, the Purchaser shall pay \$25 as fixed, agreed and liquidated damages for each special protection tree cut or damaged. Such payment does not constitute ownership of the undesignated timber.

3.4.3 - Special Protection Areas (8/11)

The Purchaser shall protect special protection areas from damage by the Purchaser's operations. Special protection areas are marked with a blue boundary line in unit 2 and a red boundary line in unit 3. The Purchaser shall not cut live or dead trees or operate any machinery within special protection areas.

4 - Transportation

4.1 - Construction

4.1.3 - Slash and earthen piles (8/04)

Piles or windrows of earth along roads and landings that have been widened or constructed shall be leveled. Slash from road maintenance or construction, including stumps, shall be chipped, utilized or dispersed throughout the sale.

4.1.12 - No new roads (1/12)

No new roads will be permitted in any Payment Unit. All operations are limited to use of existing roads and establishing landings near these roads. Landing locations must be discussed and authorized by sale administrator.

5 - Operations

5.1 - Notification

5.1.1 - Pre-sale conference (10/11)

A pre-sale conference on site between the Purchaser and sale administrator is required prior to beginning any operations to determine landing and road locations.

5.2 - Conduct of Operations

5.2.1 - Slash

5.2.1.8 - Slash height (12/08)

No slash or tree tops may exceed 24 inches in height.

5.2.2 - Hazard Trees/Snags

5.2.2.1 - Den trees (2/04)

Obvious hollow and/or den trees shall be protected and left standing unless they are a safety hazard.

5.2.3 - Operating Restrictions

5.2.3.11 - Coppice regeneration protection (4/10)

To promote aspen regeneration, harvesting is limited to December 1st through March 31st. Timber harvesting in any Payment Unit must be completed before significant aspen sprouting occurs in that Payment Unit so as to minimize damage to the new regeneration. Any post harvest operations, such as chipping, must be completed before sprouting of regeneration occurs. If it is anticipated that chipping will be delayed, then tops shall be carried to one central location or left unchipped. The Unit Manager or his/her representative may cease such operations if sprouting occurs before the operation is complete.

5.2.4 - Dead and Down Creation

5.2.4.3 - Dead and down creation, dead trees (6/07)

Except as provided for in General Condition and Requirement 5.2.2, no dead trees, standing or down, are to be cut, skidded, or processed.

5.2.4.4 - Dead and down creation, grouse (9/09)

To encourage grouse and other wildlife, in Payment Unit(s) 1, 2, and 3 leave one, 12" diameter or larger log-length (8 foot minimum) piece on the ground for every 2 acres. The trees must be cut 4 feet above the ground level leaving a 4 foot snag. These will be evenly scattered throughout the cut unit. This can be an unmerchantable piece or a full tree and it must be placed within 3 feet of the snag.

6 - Safety and Fire Prevention

6.2 - Signing

6.2.2 - Snowmobile trail posting (8/09)

The Purchaser is responsible for posting and maintaining caution signs on Betsie River Snowmobile Trail prior to beginning operations during the snowmobile season (approximately December 1 to March 31). The trail must be posted at appropriate distances from the sale area to warn of logging activity and truck traffic. Signs must be removed when harvest operations are suspended or completed. The Purchaser will provide these signs.



TIMBER SALE MAP

089

2012

This information provided by authority of Part 525, 1994 PA 451, as amended.

Forest Management Unit Traverse City	County Benzie	Mapped By Craig Allen	Date 9/18/2012	Page 1	of 1
		Cruised By Craig Allen			

Township 25N	Range 13W	Section(s) and Subdivision(s) Sec. 3, N1/2 Sec. 4, SENE	1:15,840
-----------------	--------------	---	----------

Cover Type				Density	
A = Aspen	G = Grass	O = Oak	U = Upland Brush	0 = Non Stocked	5 = Pole Timber Medium
B = Paper Birch	H = Hemlock	P = Lowland Poplar	V = Bog or Marsh	1 = Seedling Sapling Poor	6 = Pole Timber Well
C = Cedar	J = Jack Pine	Q = Mixed Swamp Cnfr	W = White Pine	2 = Seedling Sapling Medium	7 = Saw Timber Poor
D = Treed Bog	L = Lowland Brush	R = Red Pine	X = Non Stocked	3 = Seedling Sapling Well	8 = Saw Timber Medium
E = Swamp Hdwoods	M = Mpl, Bch, Brch	S = Black Spruce	Z = Water	4 = Pole Timber Poor	9 = Saw Timber Well
F = Spruce Fir	N = Marsh	T = Tamarack			

"Clary Grade Aspen"

Unit 1 = 8.7 acres
 Unit 2 = 32.3 acres
 Unit 3 = 18 acres
 Total = 59 acres

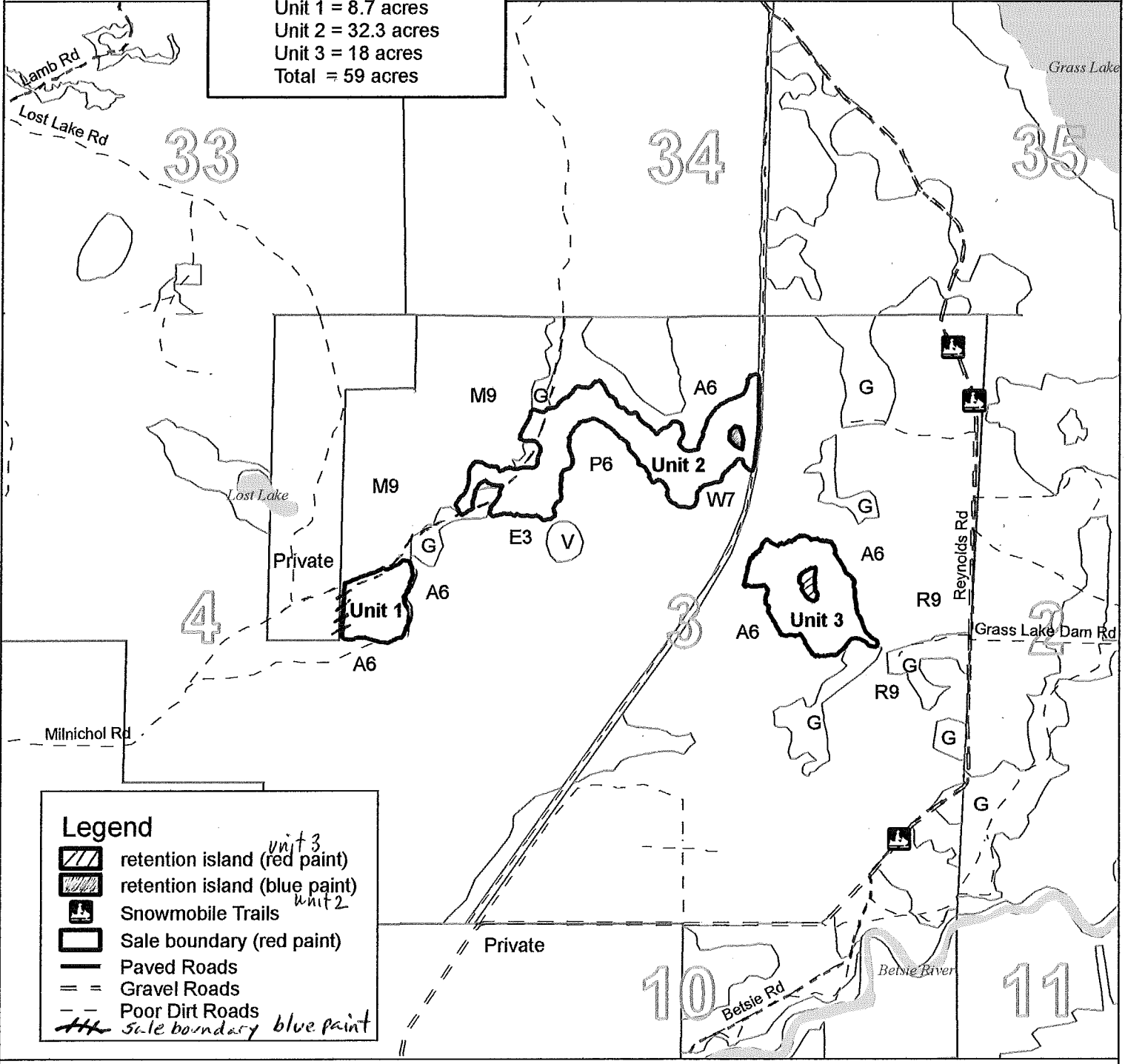

Legend

- retention island (red paint) *unit 3*
- retention island (blue paint) *unit 2*
- Snowmobile Trails
- Sale boundary (red paint)
- Paved Roads
- Gravel Roads
- Poor Dirt Roads
- Sale boundary blue paint



TIMBER SALE INFORMATION

HUNT CAMP PINE (61-095-12-01)

T25N, R14W, SEC. 05; T25N, R14W, SEC. 08.

Benzie County (Advertised Price \$27,959.35)

SALE NOTE: A recreation site such as a trail, pathway, or campground is within the sale area or the vicinity. Certain restrictions/specifications may be applicable including time restrictions. Access may be through state forest land.

A timber sale contract for this lump sum, sealed bid timber sale will be awarded to the responsible bidder offering the highest sealed bid price. Bids must be at or above the following advertised price for each species:

<u>PRODUCTS & SPECIES</u>	<u>ESTIMATED UNITS*</u>	<u>ADVERTISED PRICE</u>
Sawlogs		
White Pine	54.90 MBF	\$ 61.50 / MBF
Pulpwood		
Jack Pine	186.00 Cords	\$ 14.35 / Cord
Mixed Aspen	165.00 Cords	\$ 21.00 / Cord
Mixed Hardwood	249.00 Cords	\$ 14.75 / Cord
White Pine	1,499.00 Cords	\$ 9.65 / Cord

In addition, the successful bidder agrees to purchase the following species at the indicated advertised price for a total value of \$310.80:

<u>PRODUCTS & SPECIES</u>	<u>ESTIMATED UNITS*</u>	<u>ADVERTISED PRICE</u>
Sawlogs		
Mixed Hardwood	3.70 MBF	\$ 84.00 / MBF

* The total volume is statistically estimated within plus (+) or minus (-) 10.02 percent. The estimated units are final and not subject to adjustment. Prospective bidders are urged to examine this timber and to make their own estimates of quantity and quality.

BOND AND PAYMENT SCHEDULE:

1. A bond in the amount of **\$1,400.00** to insure faithful performance of the conditions of the contract will be deposited by the successful bidder within 21 days of the sale award.
2. Cutting in any sale or unit without the required advance payment would be considered a trespass.
3. Total payment must be paid in advance or according to the following schedule:
 - (a) Ten percent (10%) of the sale value must be paid within 21 days of the sale award.
 - (b) The 10% down payment will be credited towards the first unit cut.
 - (c) Payment for each of the following units must be made before cutting begins in that unit:

PAYMENT UNIT NUMBER	PERCENT OF TOTAL SALE VALUE
01	50%
02	50%
4. If no cutting takes place, the 10% down payment will not be refunded.
5. Operations on the contract issued will terminate on 12/31/2015.

Sale Specific Conditions & Requirements

Sale Name: Hunt Camp Pine Sale Number: 61-095-12-01

1 - Sale Area

1.2 - Boundaries

1.2.1 - Painted boundaries (12/08)

The sale boundary and Payment Unit boundaries are marked and identified by blue and red paint. Exterior sale boundary lines against private property are marked with blue paint. Exterior sale boundary lines against state are marked with red paint. Do not cut painted boundary line trees.

2 - Timber Specifications

2.1 - Included Timber

2.1.7 - Leave tree marked unit(s) (8/11)

Within Payment Unit(s) 1 and 2, cut all trees that are two (2) inches or more in diameter measured at a point four and one-half (4-1/2) feet above ground level regardless of merchantability except trees marked with green paint above and below stump height.

2.2 - Utilization

2.2.3 - Stump heights (4/07)

Stump heights within the jack pine area of unit two (northern most area on map) shall not exceed 6 inches for all trees. This is in order to facilitate planting operations.

4 - Transportation

4.1 - Construction

4.1.6 - Road construction (1/09)

Improvements of existing roads shall be done in such a way as to minimize the environmental and visual impacts.

Merchantable trees shall be cut and utilized unless otherwise directed. Non-merchantable trees shall be severed and laid flat on the ground. Slash shall be scattered, and not left in windrows and kept a minimum of 10 feet back from the road edge. Stumps shall be set upright, not left on edge, and be moved at least 10 feet away from the road edge. Disturbed soil shall be feathered into the woods and not left in berms or windrows.

4.1.12 - No new roads (1/12)

No new roads will be permitted in any Payment Unit. All operations are limited to existing roads. Skid trails only will be allowed.

4.2 - Maintenance

4.2.5 - Two wheel drive condition (2/04)

All existing trail roads on and adjacent to the sale area must be passable by two-wheel drive traffic for the duration of the sale.

5 - Operations

5.1 - Notification

5.1.1 - Pre-sale conference (10/11)

A pre-sale conference on site between the Purchaser and sale administrator is required prior to beginning any operations to determine landing and road locations. The Unit Manager or his/her representative must be contacted at least 5 days in advance to schedule the conference.

5.1.4 - Post-sale conference (6/11)

A post-sale conference on site between the Purchaser and sale administrator is required 5 days prior to the completion of active logging operations to determine clean-up and repair of landings, road edges, and the fulfillment of other contract specifications.

5.2 - Conduct of Operations

5.2.1 - Slash

5.2.1.8 - Slash height (12/08)

No slash or tree tops may exceed 24 inches in height.

5.2.2 - Hazard Trees/Snags

5.2.2.1 - Den trees (2/04)

Obvious hollow and/or den trees shall be protected and left standing unless they are a safety hazard.

5.2.3 - Operating Restrictions

5.2.3.6 - Bark beetle restriction (12/08)

In the event drought creates a high risk of pine bark beetle infestation, pine is not to be cut during the period March 1 through July 1, unless all portions of trees greater than two inches in diameter are removed from the sale area, reduced to chips, or treated to the satisfaction of the Unit Manager or his/her representative, within fifteen days of being severed from the stump. Pine log decks, pulpwood piles and treetops that are piled for chipping in the fall or winter within a 1/4 mile of susceptible sites must be removed before March 15. Residual slash must not be placed in piles or rows and must be spread over the site for quick drying. The Department of Natural Resources will exercise this specification if the risk of damage warrants.

5.2.38 - No decking against live trees (2/04)

Cut products may not be decked against unmarked or designated leave trees.

5.4 - Soil Protection

5.4.1 - Rutting restriction, general (1/09)

Operations are to cease immediately if equipment and weather conditions result in rutting of roads and skid trails which is 12 inches or greater in depth and 50 feet in length. The Unit Manager or his/her representative may restrict hauling and/or skidding if ruts exceed the specified depth. With the Unit Manager or his/her representative's approval, the Purchaser may return to the area when the risk of rutting has decreased.

6 - Safety and Fire Prevention

6.2 - Signing

6.2.1 - Road posting (9/09)

The purchaser is responsible for posting and maintaining caution signs on Begold road prior to beginning operations. The road must be posted 200 feet from the sale area to warn of logging activity and truck traffic. Signs must be removed when harvest operations are suspended or completed. The Purchaser will provide these signs.



TIMBER SALE MAP

61-095-12-01

2012

This information provided by authority of Part 525, 1994 PA 451, as amended.

Forest Management Unit Traverse City		County Benzie County	Mapped By Blair Tweedale	Date 9/28/2012	Page 1	of 1
Township T25N	Range R14W	Section(s) and Subdivision(s) Sec. 5 NESW ; Sec. 8 NWNW, SENW, SWNW			1:15,840	
Cover Type			Density			
A = Aspen	G = Grass	O = Oak	U = Upland Brush	0 = Non Stocked	5 = Pole Timber Medium	
B = Paper Birch	H = Hemlock	P = Lowland Poplar	V = Bog or Marsh	1 = Seedling Sapling Poor	6 = Pole Timber Well	
C = Cedar	J = Jack Pine	Q = Mixed Swamp Cnfr	W = White Pine	2 = Seedling Sapling Medium	7 = Saw Timber Poor	
D = Treed Bog	L = Lowland Brush	R = Red Pine	X = Non Stocked	3 = Seedling Sapling Well	8 = Saw Timber Medium	
E = Swamp Hdwoods	M = Mpl, Bch, Brch	S = Black Spruce	Z = Water	4 = Pole Timber Poor	9 = Saw Timber Well	
F = Spruce Fir	N = Marsh	T = Tamarack				

Hunt Camp Pine

Unit 1 43 acres
 Unit 2 41 acres
 Total 84 acres

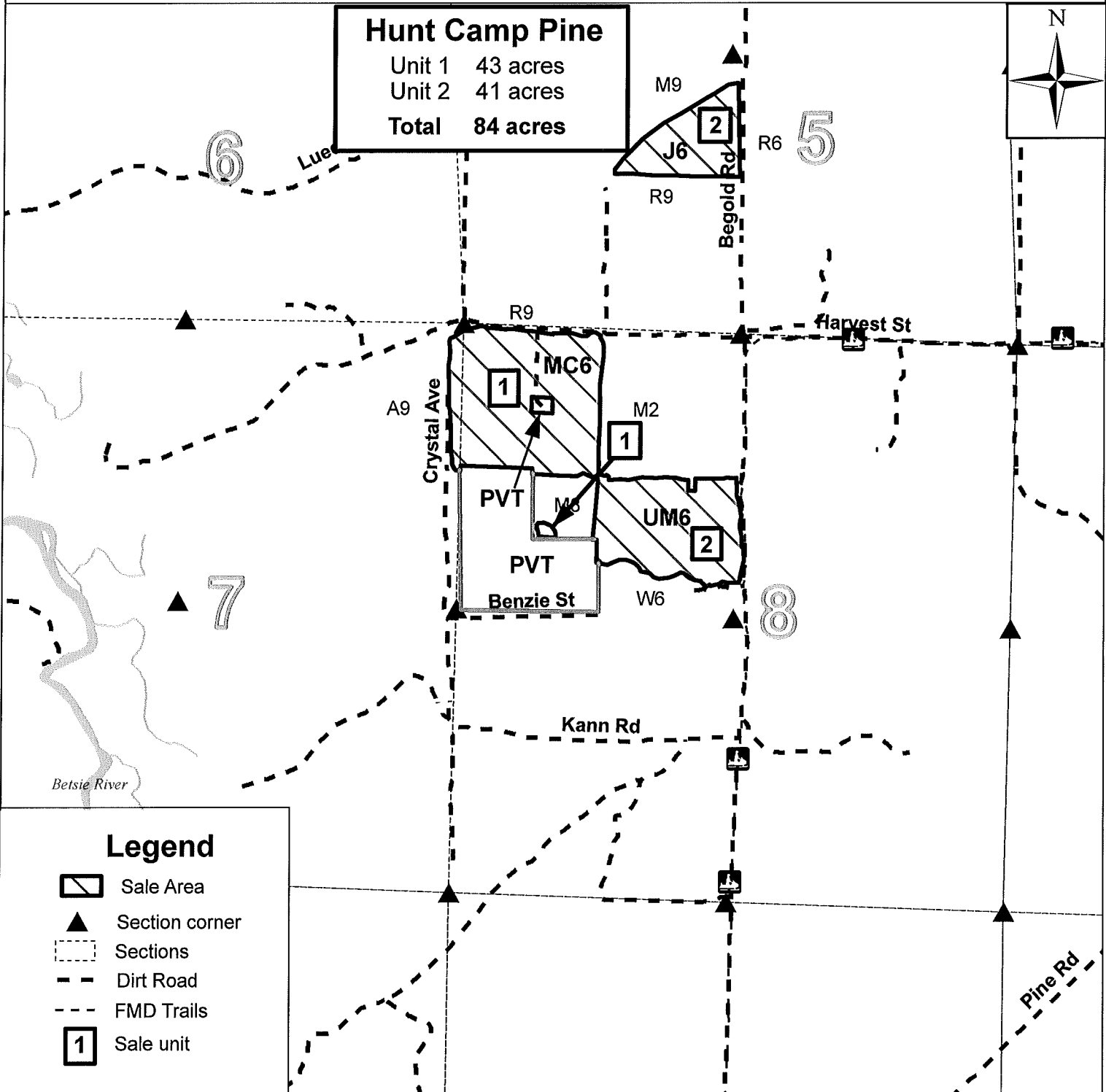

Legend

- Sale Area
- Section corner
- Sections
- Dirt Road
- FMD Trails
- Sale unit

0.5 0.25 0 0.5 Miles

TIMBER SALE INFORMATION

SOUTH 21 ASPEN (61-096-12-01)

T25N, R13W, SEC. 15.

Benzie County (Advertised Price \$15,874.39)

SALE NOTE: A recreation site such as a trail, pathway, or campground is within the sale area or the vicinity. Certain restrictions/specifications may be applicable including time restrictions. Access may be through state forest land.

A timber sale contract for this lump sum, sealed bid timber sale will be awarded to the responsible bidder offering the highest sealed bid price. Bids must be at or above the following advertised price for each species:

<u>PRODUCTS & SPECIES</u>	<u>ESTIMATED UNITS*</u>	<u>ADVERTISED PRICE</u>
Sawlogs		
Q. Aspen	19.00 MBF	\$ 73.00 / MBF
Red Maple	14.30 MBF	\$ 131.00 / MBF
Pulpwood		
Q. Aspen	595.40 Cords	\$ 17.95 / Cord
Red Maple	82.70 Cords	\$ 18.60 / Cord

In addition, the successful bidder agrees to purchase the following species at the indicated advertised price for a total value of \$388.44:

<u>PRODUCTS & SPECIES</u>	<u>ESTIMATED UNITS*</u>	<u>ADVERTISED PRICE</u>
Pulpwood		
Black Ash	11.30 Cords	\$ 9.20 / Cord
Black Cherry	11.20 Cords	\$ 25.40 / Cord

* The total volume is statistically estimated within plus (+) or minus (-) 14.78 percent. The estimated units are final and not subject to adjustment. Prospective bidders are urged to examine this timber and to make their own estimates of quantity and quality.

BOND AND PAYMENT SCHEDULE:

1. A bond in the amount of **\$794.00** to insure faithful performance of the conditions of the contract will be deposited by the successful bidder within 21 days of the sale award.
2. Cutting in any sale or unit without the required advance payment would be considered a trespass.
3. Total payment must be paid in advance or according to the following schedule:
 - (a) Ten percent (10%) of the sale value must be paid within 21 days of the sale award.
 - (b) The 10% down payment will be credited towards the first unit cut.
 - (c) Payment for each of the following units must be made before cutting begins in that unit:

<u>PAYMENT UNIT NUMBER</u>	<u>PERCENT OF TOTAL SALE VALUE</u>
01	47%
02	14%
03	29%
04	10%

4. If no cutting takes place, the 10% down payment will not be refunded.
5. Operations on the contract issued will terminate on 12/31/2015.

Sale Specific Conditions & Requirements

Sale Name: South 21 Aspen Sale Number: 61-096-12-01

1 - Sale Area

1.2 - Boundaries

1.2.1 - Painted boundaries (12/08)

The sale boundary and Payment Unit boundaries are marked and identified by red paint. Exterior sale boundary lines against state are marked with red paint. Do not cut painted boundary line trees.

2 - Timber Specifications

2.1 - Included Timber

2.1.7 - Leave tree marked unit(s) (8/11)

Within Payment Unit(s) 1, 2, 3, and 4, cut all aspen and red maple, ash, and cherry trees regardless of merchantability except any trees marked with green paint above and below stump height. Do not cut any conifers or oak trees. Special protection trees identified in accordance with condition 3.4.2, within clearcutting unit boundaries, are not Included Timber and are to be protected. Special protection areas identified in accordance with condition 3.4.3, within clearcutting unit boundaries, are not Included Timber and are to be protected.

2.2 - Utilization

2.2.3 - Stump heights (4/07)

Stump heights within the Sale Areas shall not exceed 12 inches for trees greater than 10 inches DBH and 4 inches for trees smaller than 10 inches DBH.

3 - Payments

3.4 - Damaged Timber

3.4.2 - Special Protection Trees (8/11)

The Purchaser shall not cut live or dead special protection trees within cutting units or clearings. Special protection trees are marked with green paint. The Purchaser shall protect special protection trees from damage by the Purchaser's operations. If the Purchaser's operations have cut or damaged special protection trees through carelessness, the Purchaser shall pay \$25 as fixed, agreed and liquidated damages for each special protection tree cut or damaged. Such payment does not constitute ownership of the undesignated timber.

3.4.3 - Special Protection Areas (8/11)

The Purchaser shall protect special protection areas from damage by the Purchaser's operations. Special protection areas are marked with a blue boundary line. There are 4 areas in unit 1, one area in unit 2, 2 areas in unit 3 and one area in unit 4. The Purchaser shall not cut live or dead trees within special protection areas. No harvesting activities or equipment are allowed within the boundaries of these areas.

4 - Transportation

4.1 - Construction

4.1.3 - Slash and earthen piles (8/04)

Piles or windrows of earth along roads and landings that have been widened or constructed shall be leveled. Slash from road maintenance or construction, including stumps, shall be chipped, utilized or dispersed throughout the sale.

4.1.12 - No new roads (1/12)

No new roads will be permitted in any Payment Unit. All operations are limited to existing roads. Skid trails only will be allowed as designated by sale administrator. Skid trails that access units 3 and 4 will need to be effectively closed at end of the sale as agreed with sale administrator.

5 - Operations

5.1 - Notification

5.1.1 - Pre-sale conference (10/11)

A pre-sale conference on site between the Purchaser and sale administrator is required prior to beginning any operations to determine landing and road locations.

5.2 - Conduct of Operations

5.2.1 - Slash

5.2.1.8 - Slash height (12/08)

No slash or tree tops may exceed 24 inches in height.

5.2.4 - Dead and Down Creation

5.2.4.4 - Dead and down creation, grouse (9/09)

To encourage grouse and other wildlife, in Payment Unit(s) 1, 2, 3, and 4 leave one, 10" diameter or larger log-length (8 foot minimum) piece on the ground for every 2 acres. The trees must be cut 4 feet above the ground level leaving a 4 foot snag. These will be evenly scattered throughout the cut unit. This can be an unmerchantable piece or a full tree and it must be placed within 3 feet of the snag.

5.2.17 - Crane Mats/Timber Mats (9/11)

Some roads or skid trails may require extra protection such as that afforded by Crane Mats/Timber Mats. If available, Crane Mats/Timber Mats may be borrowed from the DNR and are located at the Marquette OSC and the Grayling Field Office. Contact the sale administrator for specific details. A timber Sale Contract Supplement will be used to document the Purchaser's use of the DNR's Crane Mats/Timber Mats. It is the responsibility of the Purchaser to contact the sale administrator to schedule pick up and drop off. In addition, all mats must be cleaned prior to drop off. A charge of \$350.00 will be assessed for all damaged or non-returned mats. Damage is defined as misuse resulting in three or more broken cants.

5.2.41 - Snowmobile trail protection (9/11)

The Betsie River Trail is a snowmobile trail and is shown on the Timber Sale Map. Do not cut or damage posts with orange trail markers or traffic control signs. If the trail is used, it must be maintained and restored to a condition equal to or better than before the sale. The road maintenance/restoration must be done prior to December 1. If the trail is used for hauling, it must be graded to the satisfaction of the Unit Manager or his/her representative prior to December 1st. If the trail road is to be used for hauling during the snowmobile season, then a snow covered base must be left on the trail. Maintain a 20 foot wide slash, debris, and rut free zone daily using the snowmobile trail as the centerline. No decking of forest products will be permitted along the snowmobile trail. All stumps within 20 feet of the snowmobile trail must be cut at ground level. In addition, any trees cut within 5 feet of the trail must have the stumps removed and be disposed of according to the direction of the Unit Manager or his/her representative.

6 - Safety and Fire Prevention

6.2 - Signing

6.2.2 - Snowmobile trail posting (8/09)

The Purchaser is responsible for posting and maintaining caution signs on the Betsie River snowmobile trail prior to beginning operations during the snowmobile season (approximately December 1 to March 31). The trail must be posted at appropriate distances from the sale area to warn of logging activity and truck traffic. Signs must be removed when harvest operations are suspended or completed. The Purchaser will provide these signs.



TIMBER SALE MAP

096

2012

This information provided by authority of Part 525, 1994 PA 451, as amended.

Forest Management Unit Traverse City	County Benzie	Mapped By Craig Allen	Date 9/18/2012	Page 1	of 1
Township T25N	Range R13W	Section(s) and Subdivision(s) Sec. 15, NE, N1/2SE, NESW	Scale 1:15,840		

Cover Type				Density	
A = Aspen	G = Grass	O = Oak	U = Upland Brush	0 = Non Stocked	5 = Pole Timber Medium
B = Paper Birch	H = Hemlock	P = Lowland Poplar	V = Bog or Marsh	1 = Seedling Sapling Poor	6 = Pole Timber Well
C = Cedar	J = Jack Pine	Q = Mixed Swamp Cnfr	W = White Pine	2 = Seedling Sapling Medium	7 = Saw Timber Poor
D = Treed Bog	L = Lowland Brush	R = Red Pine	X = Non Stocked	3 = Seedling Sapling Well	8 = Saw Timber Medium
E = Swamp Hdwoods	M = Mpl, Bch, Brch	S = Black Spruce	Z = Water	4 = Pole Timber Poor	9 = Saw Timber Well
F = Spruce Fir	N = Marsh	T = Tamarack			

"South 21 Aspen"
 Unit 1 = 33 acres
 Unit 2 = 10.2 acres
 Unit 3 = 20.5 acres
 Unit 4 = 7 acres
 Total = 70.7 acres

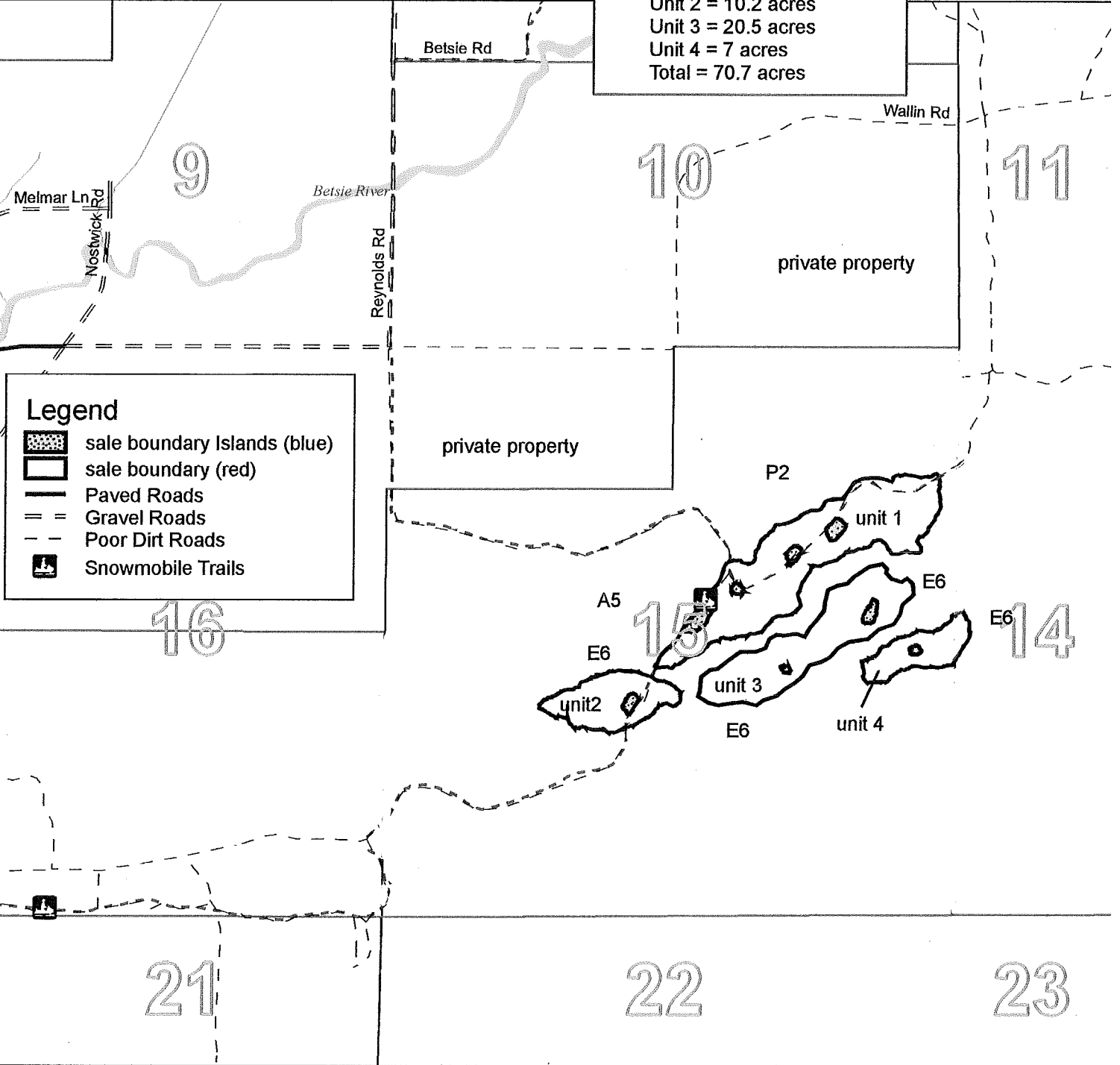

BUCK POLE PINE (61-025-12-01)
T25N, R13W, SEC. 14, Benzie County

In response to the notice of sale to be held 2:00 p.m. (local time) on February 21, 2013, I am hereby submitting my sealed bid (firm offer) for the following forest products to be cut. Bids for individual species must be at or above the advertised price. All non-responsive bid forms may be rejected.

<u>PRODUCTS & SPECIES</u>	<u>ESTIMATED UNITS*</u>	<u>ADVERTISED PRICE</u>	<u>BID PRICE</u>
Sawlogs			
White Pine	35.50 MBF	\$ 52.00 / MBF	\$ _____ / MBF
Pulpwood			
Q. Aspen	121.00 Cords	\$ 13.10 / Cord	\$ _____ / Cord
Red Maple	46.00 Cords	\$ 15.50 / Cord	\$ _____ / Cord
White Pine	549.00 Cords	\$ 5.85 / Cord	\$ _____ / Cord

In addition, the successful bidder agrees to purchase the following species at the indicated advertised price for a total value of \$64.80 :

<u>PRODUCTS & SPECIES</u>	<u>ESTIMATED UNITS*</u>	<u>ADVERTISED PRICE</u>
Sawlogs		
Red Maple	0.80 MBF	\$ 81.00 / MBF

* The total volume is statistically estimated within plus (+) or minus (-) 11.06 percent. The estimated units are final and not subject to adjustment. Prospective bidders are urged to examine this timber and to make their own estimates of quantity and quality.

I understand that any or all bids may be rejected. All bids must be signed and all bid items must be bid or the bid form may be rejected. I also understand that consideration and awarding a contract will be based upon my past performance and ability to complete the contract based upon equipment and staffing subject to my control.

FEDERAL ID: ___ - ___ - ___ or SOCIAL SECURITY NUMBER: ___ - ___ - ___

Company or individual bidding: _____

Company representative's name: _____

Address: _____

City: _____ State: _____ Zip: _____

IF AVAILABLE, PLEASE PLACE THE PERSONALIZED LABEL FROM YOUR PROSPECTUS IN THE ABOVE BOX.

Individual or company representative's signature: _____ Date: _____

Phone number : _____ Email (optional): _____



TIMBER SALE

VERIFICATION OF WORKER'S DISABILITY COMPENSATION ACT COMPLIANCE

As required by Act 317, P.A. 1969 (Worker's Compensation) and
Part 525 of Act 451 of 1994, as amended.

FOR DEPARTMENT USE ONLY	
Sale Number (XX - XXX - XX - XX)	
Forest Management Unit:	

VERIFICATION OF WORKER'S DISABILITY COMPENSATION ACT COMPLIANCE

- This verification must be completed and submitted within 21 days of contract award and prior to the issuance of the timber sale contract.
- In addition, if boxes 2B or 2C are checked, then Notice of Exclusion or Certificate of Insurance must be submitted within 21 days of the contract award and prior to the issuance of the timber sale contract.
- All Information must be typed or printed except for written signatures.

Please Check Appropriate Categories:

1. My business is organized as (you **must** check one of the boxes below):
 - A. Sole Proprietorship (individual)
 - B. Partnership
 - C. Corporation
2. You **must** check one of the boxes below:
 - A. I certify that my business is a sole proprietorship and it has no employees but the sole proprietor. I am not subject to the Worker's Compensation Laws.
 - B. I certify that my business has satisfied its obligation to the Worker's Compensation Act through the use of an approved Notice of Exclusion (BWC-337, Rev. 5/96). I will provide a copy of the Notice of Exclusion within 21 days of the contract award. (For questions or a copy of the BWC-337, please call the Worker's Compensation Bureau at 517-322-1195).
 - C. I certify that my business has a Worker's Compensation Policy. I will provide an original Certificate of Insurance within 21 days of the contract award.
3. If you have checked item 2(A) or 2(B), you **must** indicate the number of **both** full-time and part-time employees, other than yourself, including family members and active partners (if none, you must enter "0").

_____ Full-time Employees

_____ Part-time Employees

Name of Business		Federal ID (or) Social Security No.
Address		Telephone ()
City	State	ZIP

I hereby certify that the above information is true and correct. I agree to notify the Michigan DNRE of any changes that occur in factors affecting my coverage during any of my present and future operations.

Signature of Owner or Authorized Representative

Title

Date

BARRENS MIX (61-043-12-01)
T26N, R09W, SEC. 15, Grand Traverse County

In response to the notice of sale to be held 2:00 p.m. (local time) on February 21, 2013, I am hereby submitting my sealed bid (firm offer) for the following forest products to be cut. Bids for individual species must be at or above the advertised price. All non-responsive bid forms may be rejected.

<u>PRODUCTS & SPECIES</u>	<u>ESTIMATED UNITS*</u>	<u>ADVERTISED PRICE</u>	<u>BID PRICE</u>
Pulpwood			
Jack Pine	276.00 Cords	\$ 17.50 / Cord	\$ _____ / Cord
Mixed Aspen	87.00 Cords	\$ 22.75 / Cord	\$ _____ / Cord
Red Maple	52.70 Cords	\$ 20.35 / Cord	\$ _____ / Cord
Red Pine	19.00 Cords	\$ 61.70 / Cord	\$ _____ / Cord

In addition, the successful bidder agrees to purchase the following species at the indicated advertised price for a total value of \$2,620.70 :

<u>PRODUCTS & SPECIES</u>	<u>ESTIMATED UNITS*</u>	<u>ADVERTISED PRICE</u>
Sawlogs		
Mixed Oak	3.20 MBF	\$ 138.00 / MBF
Red Maple	1.80 MBF	\$ 144.00 / MBF
Red Pine	1.30 MBF	\$ 143.00 / MBF
White Pine	3.20 MBF	\$ 75.00 / MBF
Pulpwood		
Black Cherry	18.00 Cords	\$ 28.00 / Cord
Mixed Oak	28.00 Cords	\$ 11.40 / Cord
White Pine	52.00 Cords	\$ 12.90 / Cord

* The total volume is statistically estimated within plus (+) or minus (-) 19.12 percent. The estimated units are final and not subject to adjustment. Prospective bidders are urged to examine this timber and to make their own estimates of quantity and quality.

I understand that any or all bids may be rejected. All bids must be signed and all bid items must be bid or the bid form may be rejected. I also understand that consideration and awarding a contract will be based upon my past performance and ability to complete the contract based upon equipment and staffing subject to my control.

FEDERAL ID: _____ or SOCIAL SECURITY NUMBER: _____

Company or individual bidding: _____

Company representative's name: _____

Address: _____

City: _____ State: _____ Zip: _____

IF AVAILABLE, PLEASE PLACE THE PERSONALIZED LABEL FROM YOUR PROSPECTUS IN THE ABOVE BOX.

Individual or company representative's signature: _____ Date: _____

Phone number : _____ Email (optional): _____



TIMBER SALE

VERIFICATION OF WORKER'S DISABILITY COMPENSATION ACT COMPLIANCE

As required by Act 317, P.A. 1969 (Worker's Compensation) and
Part 525 of Act 451 of 1994, as amended.

FOR DEPARTMENT USE ONLY	
Sale Number (XX - XXX - XX - XX)	
Forest Management Unit:	

VERIFICATION OF WORKER'S DISABILITY COMPENSATION ACT COMPLIANCE

- This verification must be completed and submitted within 21 days of contract award and prior to the issuance of the timber sale contract.
- In addition, if boxes 2B or 2C are checked, then Notice of Exclusion or Certificate of Insurance must be submitted within 21 days of the contract award and prior to the issuance of the timber sale contract.
- All Information must be typed or printed except for written signatures.

Please Check Appropriate Categories:

1. My business is organized as (you **must** check one of the boxes below):
 - A. Sole Proprietorship (individual)
 - B. Partnership
 - C. Corporation
2. You **must** check one of the boxes below:
 - A. I certify that my business is a sole proprietorship and it has no employees but the sole proprietor. I am not subject to the Worker's Compensation Laws.
 - B. I certify that my business has satisfied its obligation to the Worker's Compensation Act through the use of an approved Notice of Exclusion (BWC-337, Rev. 5/96). I will provide a copy of the Notice of Exclusion within 21 days of the contract award. (For questions or a copy of the BWC-337, please call the Worker's Compensation Bureau at 517-322-1195).
 - C. I certify that my business has a Worker's Compensation Policy. I will provide an original Certificate of Insurance within 21 days of the contract award.
3. If you have checked item 2(A) or 2(B), you **must** indicate the number of **both** full-time and part-time employees, other than yourself, including family members and active partners (if none, you must enter "0").

_____ Full-time Employees

_____ Part-time Employees

Name of Business		Federal ID (or) Social Security No.
Address		Telephone ()
City	State	ZIP

I hereby certify that the above information is true and correct. I agree to notify the Michigan DNRE of any changes that occur in factors affecting my coverage during any of my present and future operations.

Signature of Owner or Authorized Representative

Title

Date

INDIANHEAD HARDWOOD (61-059-12-01)
T25N, R13W, SEC. 03; T25N, R13W, SEC. 04, Benzie County

In response to the notice of sale to be held 2:00 p.m. (local time) on February 21, 2013, I am hereby submitting my sealed bid (firm offer) for the following forest products to be cut. Bids for individual species must be at or above the advertised price. All non-responsive bid forms may be rejected.

<u>PRODUCTS & SPECIES</u>	<u>ESTIMATED UNITS*</u>	<u>ADVERTISED PRICE</u>	<u>BID PRICE</u>
Sawlogs			
Basswood	44.30 MBF	\$ 124.00 / MBF	\$ _____ / MBF
Beech	18.90 MBF	\$ 131.00 / MBF	\$ _____ / MBF
Sugar Maple	15.20 MBF	\$ 341.00 / MBF	\$ _____ / MBF
White Ash	17.90 MBF	\$ 107.00 / MBF	\$ _____ / MBF
Pulpwood			
Beech	215.90 Cords	\$ 9.40 / Cord	\$ _____ / Cord
Mixed Hardwood	105.10 Cords	\$ 14.70 / Cord	\$ _____ / Cord
Sugar Maple	220.40 Cords	\$ 9.70 / Cord	\$ _____ / Cord

In addition, the successful bidder agrees to purchase the following species at the indicated advertised price for a total value of \$2,611.02 :

<u>PRODUCTS & SPECIES</u>	<u>ESTIMATED UNITS*</u>	<u>ADVERTISED PRICE</u>
Sawlogs		
Mixed Hardwood	8.10 MBF	\$ 106.00 / MBF
Pulpwood		
Basswood	108.60 Cords	\$ 6.80 / Cord
White Ash	117.90 Cords	\$ 8.60 / Cord

* The total volume is statistically estimated within plus (+) or minus (-) 17.09 percent. The estimated units are final and not subject to adjustment. Prospective bidders are urged to examine this timber and to make their own estimates of quantity and quality.

I understand that any or all bids may be rejected. All bids must be signed and all bid items must be bid or the bid form may be rejected. I also understand that consideration and awarding a contract will be based upon my past performance and ability to complete the contract based upon equipment and staffing subject to my control.

FEDERAL ID: _____ or SOCIAL SECURITY NUMBER: _____

Company or individual bidding: _____

Company representative's name: _____

Address: _____

City: _____ State: _____ Zip: _____

IF AVAILABLE, PLEASE PLACE THE PERSONALIZED LABEL FROM YOUR PROSPECTUS IN THE ABOVE BOX.

Individual or company representative's signature: _____ Date: _____

Phone number : _____ Email (optional): _____

THE WINNING BIDDER MUST COMPLETE THE VERIFICATION OF WORKER'S DISABILITY COMPENSATION ACT COMPLIANCE (ON REVERSE SIDE IF DOUBLE SIDED) WITHIN 21 DAYS OF SALE AWARD DATE



TIMBER SALE

VERIFICATION OF WORKER'S DISABILITY COMPENSATION ACT COMPLIANCE

As required by Act 317, P.A. 1969 (Worker's Compensation) and
Part 525 of Act 451 of 1994, as amended.

FOR DEPARTMENT USE ONLY	
Sale Number (XX - XXX - XX - XX)	
Forest Management Unit:	

VERIFICATION OF WORKER'S DISABILITY COMPENSATION ACT COMPLIANCE

- This verification must be completed and submitted within 21 days of contract award and prior to the issuance of the timber sale contract.
- In addition, if boxes 2B or 2C are checked, then Notice of Exclusion or Certificate of Insurance must be submitted within 21 days of the contract award and prior to the issuance of the timber sale contract.
- All Information must be typed or printed except for written signatures.

Please Check Appropriate Categories:

1. My business is organized as (you **must** check one of the boxes below):
 - A. Sole Proprietorship (individual)
 - B. Partnership
 - C. Corporation
2. You **must** check one of the boxes below:
 - A. I certify that my business is a sole proprietorship and it has no employees but the sole proprietor. I am not subject to the Worker's Compensation Laws.
 - B. I certify that my business has satisfied its obligation to the Worker's Compensation Act through the use of an approved Notice of Exclusion (BWC-337, Rev. 5/96). I will provide a copy of the Notice of Exclusion within 21 days of the contract award. (For questions or a copy of the BWC-337, please call the Worker's Compensation Bureau at 517-322-1195).
 - C. I certify that my business has a Worker's Compensation Policy. I will provide an original Certificate of Insurance within 21 days of the contract award.
3. If you have checked item 2(A) or 2(B), you **must** indicate the number of **both** full-time and part-time employees, other than yourself, including family members and active partners (if none, you must enter "0").

_____ Full-time Employees

_____ Part-time Employees

Name of Business		Federal ID (or) Social Security No.
Address		Telephone ()
City	State	ZIP

I hereby certify that the above information is true and correct. I agree to notify the Michigan DNRE of any changes that occur in factors affecting my coverage during any of my present and future operations.

Signature of Owner or Authorized Representative

Title

Date

CLARY GRADE ASPEN (61-089-12-01)
T25N, R13W, SEC. 03; T25N, R13W, SEC. 04, Benzie County

In response to the notice of sale to be held 2:00 p.m. (local time) on February 21, 2013, I am hereby submitting my sealed bid (firm offer) for the following forest products to be cut. Bids for individual species must be at or above the advertised price. All non-responsive bid forms may be rejected.

<u>PRODUCTS & SPECIES</u>	<u>ESTIMATED UNITS*</u>	<u>ADVERTISED PRICE</u>	<u>BID PRICE</u>
Sawlogs			
B. T. Aspen	63.60 MBF	\$ 71.00 / MBF	\$ _____ / MBF
Pulpwood			
B. T. Aspen	681.30 Cords	\$ 17.50 / Cord	\$ _____ / Cord
Red Maple	107.50 Cords	\$ 17.55 / Cord	\$ _____ / Cord

In addition, the successful bidder agrees to purchase the following species at the indicated advertised price for a total value of \$3,042.00 :

<u>PRODUCTS & SPECIES</u>	<u>ESTIMATED UNITS*</u>	<u>ADVERTISED PRICE</u>
Sawlogs		
Black Cherry	4.00 MBF	\$ 334.00 / MBF
Red Maple	5.90 MBF	\$ 124.00 / MBF
Pulpwood		
Black Cherry	40.60 Cords	\$ 24.00 / Cord

* The total volume is statistically estimated within plus (+) or minus (-) 16.82 percent. The estimated units are final and not subject to adjustment. Prospective bidders are urged to examine this timber and to make their own estimates of quantity and quality.

I understand that any or all bids may be rejected. All bids must be signed and all bid items must be bid or the bid form may be rejected. I also understand that consideration and awarding a contract will be based upon my past performance and ability to complete the contract based upon equipment and staffing subject to my control.

FEDERAL ID: _____ - _____ or SOCIAL SECURITY NUMBER: _____ - _____ - _____

Company or individual bidding: _____

Company representative's name: _____

Address: _____

City: _____ State: _____ Zip: _____

IF AVAILABLE, PLEASE PLACE THE PERSONALIZED LABEL FROM YOUR PROSPECTUS IN THE ABOVE BOX.

Individual or company representative's signature: _____ Date: _____

Phone number : _____ Email (optional): _____



TIMBER SALE

VERIFICATION OF WORKER'S DISABILITY COMPENSATION ACT COMPLIANCE

As required by Act 317, P.A. 1969 (Worker's Compensation) and
Part 525 of Act 451 of 1994, as amended.

FOR DEPARTMENT USE ONLY	
Sale Number (XX - XXX - XX - XX)	
Forest Management Unit:	

VERIFICATION OF WORKER'S DISABILITY COMPENSATION ACT COMPLIANCE

- This verification must be completed and submitted within 21 days of contract award and prior to the issuance of the timber sale contract.
- In addition, if boxes 2B or 2C are checked, then Notice of Exclusion or Certificate of Insurance must be submitted within 21 days of the contract award and prior to the issuance of the timber sale contract.
- All Information must be typed or printed except for written signatures.

Please Check Appropriate Categories:

1. My business is organized as (you **must** check one of the boxes below):
 - A. Sole Proprietorship (individual)
 - B. Partnership
 - C. Corporation
2. You **must** check one of the boxes below:
 - A. I certify that my business is a sole proprietorship and it has no employees but the sole proprietor. I am not subject to the Worker's Compensation Laws.
 - B. I certify that my business has satisfied its obligation to the Worker's Compensation Act through the use of an approved Notice of Exclusion (BWC-337, Rev. 5/96). I will provide a copy of the Notice of Exclusion within 21 days of the contract award. (For questions or a copy of the BWC-337, please call the Worker's Compensation Bureau at 517-322-1195).
 - C. I certify that my business has a Worker's Compensation Policy. I will provide an original Certificate of Insurance within 21 days of the contract award.
3. If you have checked item 2(A) or 2(B), you **must** indicate the number of **both** full-time and part-time employees, other than yourself, including family members and active partners (if none, you must enter "0").

_____ Full-time Employees

_____ Part-time Employees

Name of Business		Federal ID (or) Social Security No.
Address		Telephone ()
City	State	ZIP

I hereby certify that the above information is true and correct. I agree to notify the Michigan DNRE of any changes that occur in factors affecting my coverage during any of my present and future operations.

Signature of Owner or Authorized Representative

Title

Date

HUNT CAMP PINE (61-095-12-01)
T25N, R14W, SEC. 05; T25N, R14W, SEC. 08, Benzie County

In response to the notice of sale to be held 2:00 p.m. (local time) on February 21, 2013, I am hereby submitting my sealed bid (firm offer) for the following forest products to be cut. Bids for individual species must be at or above the advertised price. All non-responsive bid forms may be rejected.

<u>PRODUCTS & SPECIES</u>	<u>ESTIMATED UNITS*</u>	<u>ADVERTISED PRICE</u>	<u>BID PRICE</u>
Sawlogs			
White Pine	54.90 MBF	\$ 61.50 / MBF	\$ _____ / MBF
Pulpwood			
Jack Pine	186.00 Cords	\$ 14.35 / Cord	\$ _____ / Cord
Mixed Aspen	165.00 Cords	\$ 21.00 / Cord	\$ _____ / Cord
Mixed Hardwood	249.00 Cords	\$ 14.75 / Cord	\$ _____ / Cord
White Pine	1,499.00 Cords	\$ 9.65 / Cord	\$ _____ / Cord

In addition, the successful bidder agrees to purchase the following species at the indicated advertised price for a total value of \$310.80 :

<u>PRODUCTS & SPECIES</u>	<u>ESTIMATED UNITS*</u>	<u>ADVERTISED PRICE</u>
Sawlogs		
Mixed Hardwood	3.70 MBF	\$ 84.00 / MBF

* The total volume is statistically estimated within plus (+) or minus (-) 10.02 percent. The estimated units are final and not subject to adjustment. Prospective bidders are urged to examine this timber and to make their own estimates of quantity and quality.

I understand that any or all bids may be rejected. All bids must be signed and all bid items must be bid or the bid form may be rejected. I also understand that consideration and awarding a contract will be based upon my past performance and ability to complete the contract based upon equipment and staffing subject to my control.

FEDERAL ID: ____ - ____ - ____ or SOCIAL SECURITY NUMBER: ____ - ____ - ____

Company or individual bidding: _____

Company representative's name: _____

Address: _____

City: _____ State: _____ Zip: _____

IF AVAILABLE, PLEASE PLACE THE PERSONALIZED LABEL FROM YOUR PROSPECTUS IN THE ABOVE BOX.

Individual or company representative's signature: _____ Date: _____

Phone number : _____ Email (optional): _____



TIMBER SALE
VERIFICATION OF WORKER'S DISABILITY
COMPENSATION ACT COMPLIANCE

*As required by Act 317, P.A. 1969 (Worker's Compensation) and
Part 525 of Act 451 of 1994, as amended.*

FOR DEPARTMENT USE ONLY	
Sale Number (XX - XXX - XX - XX)	
Forest Management Unit:	

VERIFICATION OF WORKER'S DISABILITY COMPENSATION ACT COMPLIANCE

- This verification must be completed and submitted within 21 days of contract award and prior to the issuance of the timber sale contract.
- In addition, if boxes 2B or 2C are checked, then Notice of Exclusion or Certificate of Insurance must be submitted within 21 days of the contract award and prior to the issuance of the timber sale contract.
- All Information must be typed or printed except for written signatures.

Please Check Appropriate Categories:

1. My business is organized as (you **must** check one of the boxes below):
 - A. Sole Proprietorship (individual)
 - B. Partnership
 - C. Corporation
2. You **must** check one of the boxes below:
 - A. I certify that my business is a sole proprietorship and it has no employees but the sole proprietor. I am not subject to the Worker's Compensation Laws.
 - B. I certify that my business has satisfied its obligation to the Worker's Compensation Act through the use of an approved Notice of Exclusion (BWC-337, Rev. 5/96). I will provide a copy of the Notice of Exclusion within 21 days of the contract award. (For questions or a copy of the BWC-337, please call the Worker's Compensation Bureau at 517-322-1195).
 - C. I certify that my business has a Worker's Compensation Policy. I will provide an original Certificate of Insurance within 21 days of the contract award.
3. If you have checked item 2(A) or 2(B), you **must** indicate the number of **both** full-time and part-time employees, other than yourself, including family members and active partners (if none, you must enter "0").

_____ Full-time Employees

_____ Part-time Employees

Name of Business		Federal ID (or) Social Security No.	
Address		Telephone ()	
City	State	ZIP	

I hereby certify that the above information is true and correct. I agree to notify the Michigan DNRE of any changes that occur in factors affecting my coverage during any of my present and future operations.

Signature of Owner or Authorized Representative

Title

Date

SOUTH 21 ASPEN (61-096-12-01)
T25N, R13W, SEC. 15, Benzie County

In response to the notice of sale to be held 2:00 p.m. (local time) on February 21, 2013, I am hereby submitting my sealed bid (firm offer) for the following forest products to be cut. Bids for individual species must be at or above the advertised price. All non-responsive bid forms may be rejected.

<u>PRODUCTS & SPECIES</u>	<u>ESTIMATED UNITS*</u>	<u>ADVERTISED PRICE</u>	<u>BID PRICE</u>
Sawlogs			
Q. Aspen	19.00 MBF	\$ 73.00 / MBF	\$ _____ / MBF
Red Maple	14.30 MBF	\$ 131.00 / MBF	\$ _____ / MBF
Pulpwood			
Q. Aspen	595.40 Cords	\$ 17.95 / Cord	\$ _____ / Cord
Red Maple	82.70 Cords	\$ 18.60 / Cord	\$ _____ / Cord

In addition, the successful bidder agrees to purchase the following species at the indicated advertised price for a total value of \$388.44 :

<u>PRODUCTS & SPECIES</u>	<u>ESTIMATED UNITS*</u>	<u>ADVERTISED PRICE</u>
Pulpwood		
Black Ash	11.30 Cords	\$ 9.20 / Cord
Black Cherry	11.20 Cords	\$ 25.40 / Cord

* The total volume is statistically estimated within plus (+) or minus (-) 14.78 percent. The estimated units are final and not subject to adjustment. Prospective bidders are urged to examine this timber and to make their own estimates of quantity and quality.

I understand that any or all bids may be rejected. All bids must be signed and all bid items must be bid or the bid form may be rejected. I also understand that consideration and awarding a contract will be based upon my past performance and ability to complete the contract based upon equipment and staffing subject to my control.

FEDERAL ID: ____ - ____ - ____ or SOCIAL SECURITY NUMBER: ____ - ____ - ____

Company or individual bidding: _____

Company representative's name: _____

Address: _____

City: _____ State: _____ Zip: _____

IF AVAILABLE, PLEASE PLACE THE PERSONALIZED LABEL FROM YOUR PROSPECTUS IN THE ABOVE BOX.

Individual or company representative's signature: _____ Date: _____

Phone number : _____ Email (optional): _____



TIMBER SALE

VERIFICATION OF WORKER'S DISABILITY COMPENSATION ACT COMPLIANCE

As required by Act 317, P.A. 1969 (Worker's Compensation) and
Part 525 of Act 451 of 1994, as amended.

FOR DEPARTMENT USE ONLY	
Sale Number (XX - XXX - XX - XX)	
Forest Management Unit:	

VERIFICATION OF WORKER'S DISABILITY COMPENSATION ACT COMPLIANCE

- This verification must be completed and submitted within 21 days of contract award and prior to the issuance of the timber sale contract.
- In addition, if boxes 2B or 2C are checked, then Notice of Exclusion or Certificate of Insurance must be submitted within 21 days of the contract award and prior to the issuance of the timber sale contract.
- All Information must be typed or printed except for written signatures.

Please Check Appropriate Categories:

1. My business is organized as (you **must** check one of the boxes below):
 - A. Sole Proprietorship (individual)
 - B. Partnership
 - C. Corporation
2. You **must** check one of the boxes below:
 - A. I certify that my business is a sole proprietorship and it has no employees but the sole proprietor. I am not subject to the Worker's Compensation Laws.
 - B. I certify that my business has satisfied its obligation to the Worker's Compensation Act through the use of an approved Notice of Exclusion (BWC-337, Rev. 5/96). I will provide a copy of the Notice of Exclusion within 21 days of the contract award. (For questions or a copy of the BWC-337, please call the Worker's Compensation Bureau at 517-322-1195).
 - C. I certify that my business has a Worker's Compensation Policy. I will provide an original Certificate of Insurance within 21 days of the contract award.
3. If you have checked item 2(A) or 2(B), you **must** indicate the number of **both** full-time and part-time employees, other than yourself, including family members and active partners (if none, you must enter "0").

_____ Full-time Employees

_____ Part-time Employees

Name of Business		Federal ID (or) Social Security No.
Address		Telephone ()
City	State	ZIP

I hereby certify that the above information is true and correct. I agree to notify the Michigan DNRE of any changes that occur in factors affecting my coverage during any of my present and future operations.

Signature of Owner or Authorized Representative

Title

Date