



**DEPARTMENT OF NATURAL RESOURCES
STATE OF MICHIGAN**

TIMBER SALE PROSPECTUS #5253

SCHEDULED SALE DATE AND TIME: 11:00 a.m. (local time) on December 10, 2014.

LOCATION: GLADWIN MGMT UNIT, 801 N SILVERLEAF, GLADWIN, MI 48624.

PROSPECTUS NOTE: The bidder is advised to inspect the sale area and review the location, estimated volumes, operating costs and contract terms of proposed sales. Please be aware that some landowners may request 60 days or more notice for access across their land.

Notice is hereby given that bids will be received by the Unit Manager, GLADWIN MANAGEMENT UNIT, for certain timber on the following described lands:

ESTEY BLEND (73-001-14-01) / T17N, R02E, SEC. 10, W1/2NW.

T17N, R02E, SEC. 16, NWSE.

T17N, R02E, SEC. 19, NE1/4; NW1/4; SW1/4.

T17N, R02E, SEC. 30, NWNE; E1/2NW; N1/2SW.

Gladwin County, Advertised Price \$62,743.12, 290.0 Acres

SALE NOTE: A recreation site such as a trail, pathway, or campground is within the sale area or the vicinity. Certain restrictions/specifications may be applicable including time restrictions.

C 111 ASPEN (73-020-13-01) / T15N, R02W, SEC. 01, NW, N1/2SW.

T15N, R02W, SEC. 02, S1/2NW, S1/2NE, N1/2SE, E1/2SW.

T15N, R02W, SEC. 03, E1/2NE, SE.

Midland County, Advertised Price \$16,249.90, 236.0 Acres

BID INSTRUCTIONS (VER. 10/01/2014):

1. Scheduled Bid Location, Date, and Time (2/11)

Bids must be received by the Unit Manager, GLADWIN OFFICE, 801 N SILVERLEAF, GLADWIN, MI 48624, no later than 11:00 a.m. (local time) on December 10, 2014. For further information concerning this sale, contact Jason Hartman at 989-426-9205 extension 7640.

2. Bidder's Qualifications (2/12)

Purchaser shall obtain workers compensation insurance to cover claims under Michigan's Worker's Disability Compensation Act of 1969 or similar employee benefit act of any other state applicable to an employee. If all or part of a timber sale was prepared by a private contractor, that contractor and that contractor's company are not permitted to bid on the timber sale contract. Bids will not be accepted from individuals or companies appearing on the DNR/FRD No-Bid List. This list contains the names of purchasers who previously failed to execute a contract within 21-days or who have a history of poor performance.

3. Preparation of Sealed Bids (1/11)

Bids shall be manually signed in ink; bid prices must be entered for each species and product in the Bid Price column for all material subject to bidding; and all fill-in blanks must be completed. If erasures or other changes appear on the forms, each erasure or change must be initialed by the person signing the bid.

4. Submission of Sealed Bids (6/11)

Bid forms may be obtained from the Unit Manager. All bids must be submitted on the bid form and in an envelope clearly identified as described in this section. NOTE: Only one bid form per bid envelope. Sealed bids must be submitted to the Unit office designated in the prospectus and must be submitted at or prior to the time established in the prospectus. The envelope should show on the outside (a) the sale name or number and (b) the date and time of bid opening as shown in the prospectus. Bids received after the time specified in the sale prospectus are late bids and will be rejected.

5. Public Opening of Sealed Bids (6/13)

If conditions permit, the sealed bids will be publicly opened and posted at the time and place set in the prospectus.

If a bidder, present at a bid opening, has submitted bids on more than one sale, that bidder may withdraw their unopened bid envelopes after being declared the successful bidder on one sale.

6. Award of Contract (1/11)

Award of the contract will be made to the Bidder whose bid, conforming to the prospectus, is most advantageous to the State of Michigan on the basis of total value at rates bid for the estimated quantities. The State reserves the right to reject any bid or waive any minor irregularity in bids received. A written award mailed (or otherwise furnished) to the successful Bidder shall be deemed to result in a binding contract without further action by either party.

7. Down Payment (1/11)

The Bidder to whom award is made must make a down payment within 21 days of the sale award. The amount of the down payment will be calculated as shown in the Bond and Payment Schedule of this prospectus. Only cash may be used to meet this requirement.

8. Performance Security (1/11)

As guarantee of faithful performance, a cash bond, certificate of deposit, surety bond or irrevocable letter of credit (LOC) is required within 21 days of the sale award. The amount of the performance security is shown in the Bond and Payment Schedule of this prospectus. If an LOC or surety is used, the coverage must extend for at least 6 months beyond the contract expiration.

9. Timber Sale Contract (9/14)

Additional conditions and requirements common to all timber sales are listed on the timber sale contract (R4031) and are available on line at www.michigan.gov/timber. Contact the Unit Manager for additional information or a sample contract. Within 21 days of the date of the award letter, the bidder must sign the contract and provide the required down payment, performance security, and verification of worker's disability compensation. The down payment and performance security shall be in accordance with the provisions of the timber sale contract, in the sums stated in this prospectus. If these actions are not

taken, then the Bidder, the Bidder's corporation, and the corporation's principals may not be permitted to bid on State timber sales for a period of 1 year. In addition, the Bidder certifies that if awarded this contract, the Bidder will complete the timber sale contract in accordance with its terms and any modifications thereof including requirements to purchase, cut, and remove the included timber by the expiration date.

10. Disclaimer of Estimates and Bidder's Warranty of Inspection (1/11)

Before submitting this bid, the Bidder is advised and cautioned to inspect the sale area, review the requirements of the sale contract, and take other steps as may be reasonably necessary to ascertain the location, estimated volumes, construction estimates, and operating costs of the proposed sale. Failure to do so will not relieve the Bidder from responsibility for completing the contract.

The Bidder warrants that this bid is submitted solely on the basis of the Bidder's examination and inspection of the quality and quantity of the timber offered for sale and the Bidder's opinion of the value thereof and the costs of recovery. No reliance should be placed on the State of Michigan's estimates of timber quality, quantity or costs of recovery. Bidder further acknowledges that the State of Michigan: (i) expressly disclaims any warranty of fitness of timber for any purpose; (ii) offers this timber as is without any warranty of quality (merchantability) or quantity and (iii) expressly disclaims any warranty as to the quantity or quality of timber sold.

11. Certification and Chain-of-Custody (10/14)

Unless otherwise indicated in the contract under section 7 – Other Conditions of the Sale Specific Conditions & Requirements, the area encompassed by this timber sale is certified to the standards of the Forest Stewardship Council (FSC) - Certificate #SCS-FM/COC-00090N and the Sustainable Forestry Initiative (SFI) - Certificate # NSF-SFIS-5Y031-SF5. Forest products from this sale may be delivered to the mill as "FSC 100% and / or SFI certified" as long as the contractor hauling the forest products is chain-of-custody (COC) certified or covered under a COC certificate from the destination mill. The purchaser is responsible for maintaining COC after leaving the sale area.

KEITH CREAGH

Director

TIMBER SALE INFORMATION

ESTEY BLEND (73-001-14-01)

T17N, R02E, SEC. 10; T17N, R02E, SEC. 16; T17N, R02E, SEC. 19; T17N, R02E,
SEC. 30.

SALE NOTE: A recreation site such as a trail, pathway, or campground is within the sale area or the vicinity. Certain restrictions/specifications may be applicable including time restrictions.

A timber sale contract for this lump sum, sealed bid timber sale will be awarded to the responsible bidder offering the highest sealed bid price. Bids must be at or above the following advertised price for each species:

<u>PRODUCTS & SPECIES</u>	<u>ESTIMATED UNITS*</u>	<u>ADVERTISED PRICE</u>
Sawlogs		
Mixed Aspen	303.20 MBF	\$ 41.00 / MBF
Mixed Oak	25.20 MBF	\$ 126.00 / MBF
Red Maple	105.10 MBF	\$ 54.00 / MBF
Pulpwood		
Mixed Aspen	1,802.00 Cords	\$ 14.36 / Cord
Red Maple	814.00 Cords	\$ 8.50 / Cord

In addition, the successful bidder agrees to purchase the following species at the indicated advertised price for a total value of \$8,665.60:

<u>PRODUCTS & SPECIES</u>	<u>ESTIMATED UNITS*</u>	<u>ADVERTISED PRICE</u>
Sawlogs		
White Ash	37.60 MBF	\$ 45.00 / MBF
Pulpwood		
Mixed Hardwood	47.00 Cords	\$ 11.50 / Cord
Mixed Oak	110.00 Cords	\$ 7.90 / Cord
Other C. Sp.	58.00 Cords	\$ 5.70 / Cord
Paper Birch	109.00 Cords	\$ 7.15 / Cord
White Ash	304.00 Cords	\$ 13.85 / Cord
White Pine	13.00 Cords	\$ 18.75 / Cord

* The total volume is statistically estimated within plus (+) or minus (-) 8.81 percent. The estimated units are final and not subject to adjustment. Prospective bidders are urged to examine this timber and to make their own estimates of quantity and quality.

BOND AND PAYMENT SCHEDULE:

1. A bond in the amount of **\$3,500.00** to insure faithful performance of the conditions of the contract will be deposited by the successful bidder within 21 days of the sale award.
2. Cutting in any sale or unit without the required advance payment would be considered a trespass.
3. Total payment must be paid in advance or according to the following schedule:
 - (a) Ten percent (10%) of the sale value must be paid within 21 days of the sale award.
 - (b) The 10% down payment will be credited towards the first unit cut.
 - (c) Payment for each of the following units must be made before cutting begins in that unit:

<u>PAYMENT UNIT NUMBER</u>	<u>PERCENT OF TOTAL SALE VALUE</u>
01	10%
02	5%
03	13%
04	11%
05	13%
06	5%
07	13%
08	14%
09	12%
10	4%

4. If no cutting takes place, the 10% down payment will not be refunded.
5. Operations on the contract issued will terminate on 12/31/2017.

Sale Specific Conditions & Requirements

Sale Name: Estey Blend Sale Number: 73-001-14-01

1 - Sale Area

1.2 - Boundaries

1.2.1 - Painted boundaries (1/14)

The sale boundary and Payment Unit boundaries are marked and identified by blue, red and/or yellow paint. Exterior sale boundary lines against private property are marked with blue paint. Exterior sale boundary lines against state are marked with red paint. Interior Payment Unit boundaries are marked with yellow paint.

2 - Timber Specifications

2.1 - Included Timber

2.1.1 - Clearcut unit(s) with unmerchantable trees (6/14)

Within Payment Unit(s) 1, 3, 4, 7, 8, and 9, cut all trees that are two (2) inches or more at DBH except for trees marked with green paint. Within Unit 1, do not cut oaks less than or equal to 4 inches DBH. In addition, within Unit(s) 4, 7, and 8, do not cut any conifers.

2.1.3 - Cut tree marked unit(s) (12/08)

Within Payment Unit(s) 2, 5, 6, and 10, all trees are designated for cutting when marked with orange paint above and below stump height, regardless of merchantability. In addition, cut all aspen and ash that are two (2) inches or more at DBH.

2.2 - Utilization

2.2.3 - Stump heights (4/07)

Stump heights within the Sale Area shall be cut as low to the ground as possible. Unless approved by the Unit Manager or his/her representative, stump heights shall not exceed 6 inches for trees greater than 10 inches DBH and 4 inches for trees smaller than 10 inches DBH.

2.2.6 - Roundwood operation required (5/07)

The skidding of whole trees or tree segments with limbs attached is prohibited within Payment Unit(s) 2, 5, 6 and 10. All products must be produced as roundwood and forwarded to existing roads or landing areas in final product length.

2.2.11 - Chipping restriction (9/13)

If chipping occurs on this sale, then 1 out of every 6 piles of tops must be left in locations as directed by the sale administrator. This specification contributes toward the requirements for biomass retention.

3 - Payments

3.3 - Pre-measured Sales

3.3.4 - Dividing payment units (7/14)

Payment Unit(s) may be divided at the request of the Purchaser and upon approval of the Unit Manager. Dividing Payment Units is a contract modification which requires a Timber Sale Contract Supplement.

3.4 - Damaged Timber

3.4.1 - Damaged timber (6/14)

General Condition and Requirement 3.4 Damaged Timber, defines liquidated damages for undesignated live merchantable trees which are cut or injured. In addition, extreme care should be taken to avoid damage to tree seedlings and saplings.

Within Units 1, 2, 5, 6, and 10, if more than 25% of the tree seedlings or saplings (1/4" to 4.5" DBH) within a specified portion of the sale area are damaged, liquidated damages will be assessed at \$300 per acre for all acreage within that specified portion of the sale area that was damaged.

No damage is acceptable to merchantable trees. Within the sale area, if more than 5% of trees (> 4.5" DBH) within a specified area of the sale are damaged, liquidated damages will be assessed for all trees damaged. Rates will be in accordance with General Condition and Requirement 3.4 Damaged.

4 - Transportation

4.1 - Construction

4.1.7 - Road closure (10/11)

All new roads built into the sale must be blocked to vehicle traffic upon completion of the sale. Overgrown roads that are reopened shall be considered new roads. In general, this will require the placement of stumps and slash into the road, throughout the length of routes to be closed. Contact the sale administrator for specific details of design and placement.

4.2 - Maintenance

4.2.3 - Road maintenance (8/13)

The following road maintenance is required: Within 60 days of completion of hauling, or if no hauling occurs for 60 days, the road must be maintained and graded. This includes cleaning of drainage areas, grading, crowning and filling with gravel, if necessary. Damages will be assessed if grading/repair does not occur.

4.2.6 - Water diversion ditches (8/13)

Water diversions must be constructed along haul routes prior to hauling. There are 6 diversions required. Trees to be removed are marked with green X's. Stumps from these trees must be removed to facilitate drainage. The diversion ditches must be excavated to an elevation approximately 1 foot lower than the center of the road. These drainage areas will be a minimum of 10 ft x 10 ft in area. Soil cannot be piled. Topsoil should be pushed into the woods. Sand can be pushed into the road. The sides of the diversion ditch will be feathered. Topsoil and stumps can be spread back into the drainage area.

5 - Operations

5.1 - Notification

5.1.4 - Post-sale conference (6/11)

A post-sale conference on site between the Purchaser and sale administrator is required prior to the completion of active logging operations to determine clean-up and repair of landings, road edges, and the fulfillment of other contract specifications. The conference can occur on site or over the phone.

5.2 - Conduct of Operations

5.2.2 - Hazard Trees/Snags

5.2.2.1 - Den trees (2/04)

Obvious hollow and/or den trees shall be protected and left standing unless they are a safety hazard.

5.2.3 - Operating Restrictions

5.2.3.1 - Operating restrictions (9/11)

Within Payment Unit(s) 3, 5, 6, and 10, unless approved by the Unit Manager or his/her representative, cutting and skidding are limited to the period of 07/15 to 09/30 and to the period of 01/01 to 03/15. This restriction is because of seasonal wet soil conditions.

5.2.40 - Pathway protection (10/10)

The Midland to Mackinaw Boy Scout Hiking trail is shown on the Timber Sale Map. Do not cut trees or damage posts or trees with blue pathway markers or blue paint. Maintain a 20-foot wide slash, debris, and rut free zone daily, using the pathway as the centerline. Do not run equipment down the pathway. Skidding across the trail may only occur in locations approved by the sale administrator.

5.4 - Soil Protection

5.4.1 - Rutting restriction, general (1/09)

Operations are to cease immediately if equipment and weather conditions result in rutting of roads and skid trails which is 12 inches or greater in depth and 50 feet in length. The Unit Manager or his/her representative may restrict hauling and/or skidding if ruts exceed the specified depth. With the Unit Manager or his/her representative's approval, the Purchaser may return to the area when the risk of rutting has decreased.



TIMBER SALE MAP

This information provided by authority of Part 525, 1994 PA 451, as amended.

Forest Management Unit Gladwin Management Unit		County Gladwin	Mapped By Steven Nyhoff	Date 05/29/2014	Page 1	of 4
Township 17N	Range 02E	Section(s) and Subdivision(s) Various		Scale 1:15,840		

Cover Type				Density	
A = Aspen	H = Hemlock	N = Marsh	U = Upland Brush	0 = Non Stocked	5 = Pole Timber Medium
B = Paper Birch	J = Jack Pine	O = Oak	UM = Upland Mixed	1 = Seedling Sapling Poor	6 = Pole Timber Well
C = Cedar	L = Lowland Brush	P = Lowland Poplar	V = Bog or Marsh	2 = Seedling Sapling Medium	7 = Saw Timber Poor
D = Treed Bog	LM = Lowland Mixed	Q = Mixed Swamp Conifer	W = White Pine	3 = Seedling Sapling Well	8 = Saw Timber Medium
E = Swamp Hdwoods	M = Mpl, Bch, Brch	R = Red Pine	X = Non Stocked	4 = Pole Timber Poor	9 = Saw Timber Well
F = Spruce Fir	MC = Mixed Conifer	S = Black Spruce	Z = Water		
G = Grass	MD = Mixed Deciduous	T = Tamarack			

PU	Acres	PU	Acres	PU	Acres
1	21	5	68	9	20
2	29	6	24	10	30
3	17	7	30		
4	17	8	34		

Estey Blend
Compartment 83 & 84
290 Acres
 Lead Insp. Rick Myrick

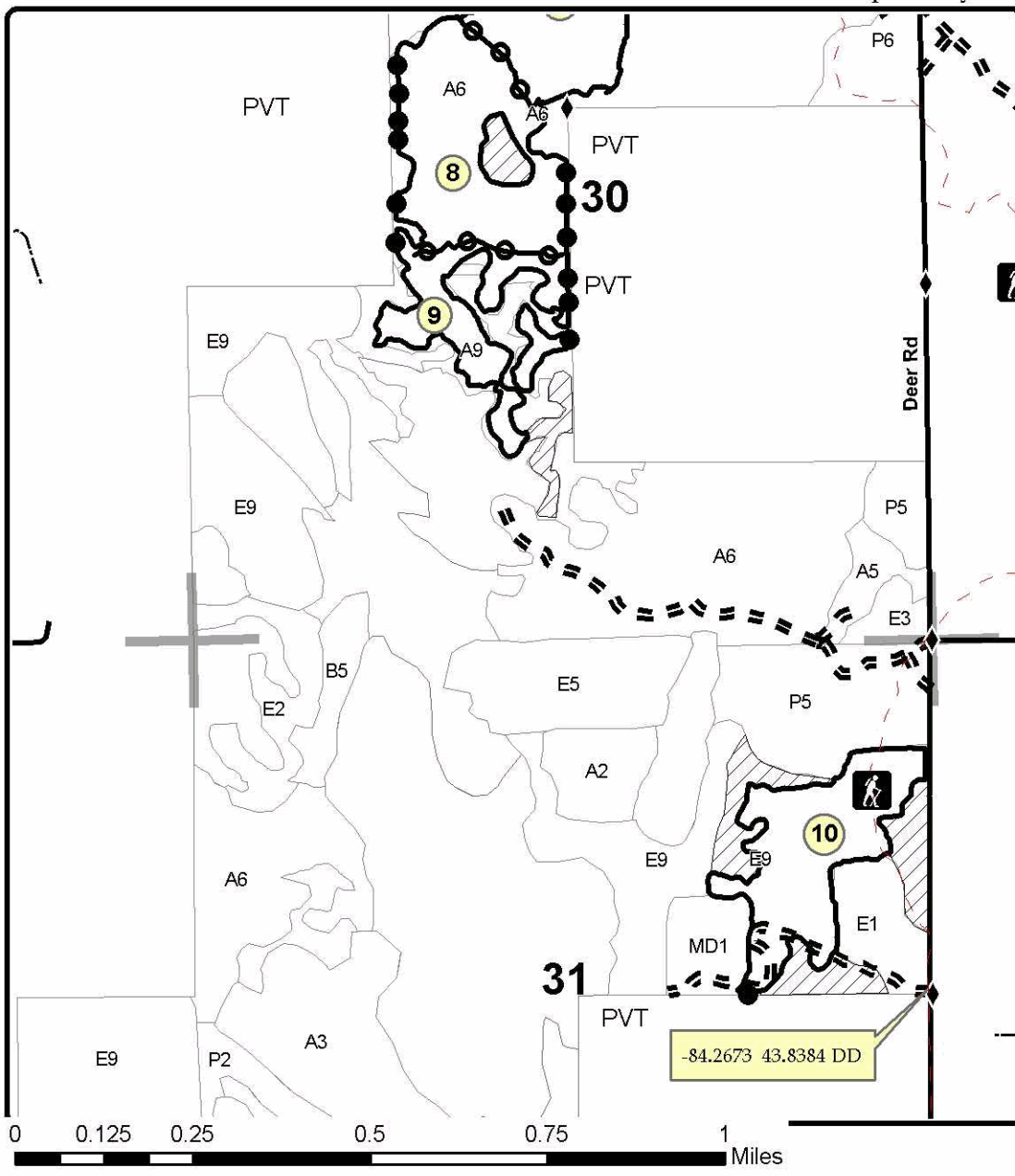
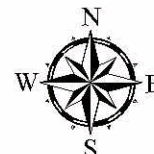

Legend

Sale Boundary

- Against State (Red)
- Payment Unit (Yellow)
- Private Line (Blue)

Adj Stand Boundaries

- Highway
- Gravel
- Paved
- Poor Dirt
- ▨ Lakes
- Trail
- Section Corners
- ▨ Retention Area

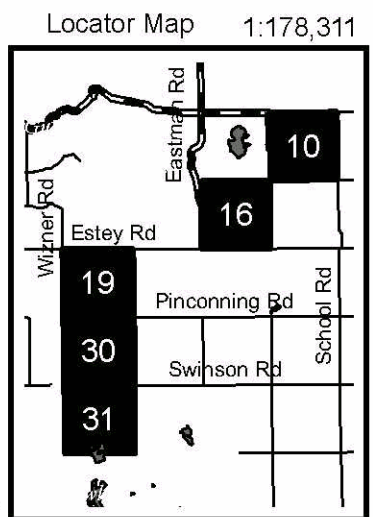



TIMBER SALE MAP

This information provided by authority of Part 525, 1994 PA 451, as amended.

Forest Management Unit Gladwin Management Unit	County Gladwin	Mapped By Steven Nyhoff	Date 05/29/2014	Page 2	of 4
Township 17N	Range 02E	Section(s) and Subdivision(s) Various	Scale 1:15,840		

Township 17N	Range 02E	Section(s) and Subdivision(s) Various	Scale 1:15,840
-----------------	--------------	------------------------------------------	-------------------

Cover Type

A = Aspen	H = Hemlock	N = Marsh	U = Upland Brush
B = Paper Birch	J = Jack Pine	O = Oak	UM = Upland Mixed
C = Cedar	L = Lowland Brush	P = Lowland Poplar	V = Bog or Marsh
D = Tread Bog	LM = Lowland Mixed	Q = Mixed Swamp Conifer	W = White Pine
E = Swamp Hdwoods	M = Mpl, Bch, Brch	R = Red Pine	X = Non Stocked
F = Spruce Fir	MC = Mixed Conifer	S = Black Spruce	Z = Water
G = Grass	MD = Mixed Deciduous	T = Tamarack	

Density

0 = Non Stocked	5 = Pole Timber Medium
1 = Seedling Sapling Poor	6 = Pole Timber Well
2 = Seedling Sapling Medium	7 = Saw Timber Poor
3 = Seedling Sapling Well	8 = Saw Timber Medium
4 = Pole Timber Poor	9 = Saw Timber Well

PU	Acres	PU	Acres	PU	Acres
1	21	5	68	9	20
2	29	6	24	10	30
3	17	7	30		
4	17	8	34		

Estey Blend
Compartment 83 & 84
290 Acres
 Lead Insp. Rick Myrick

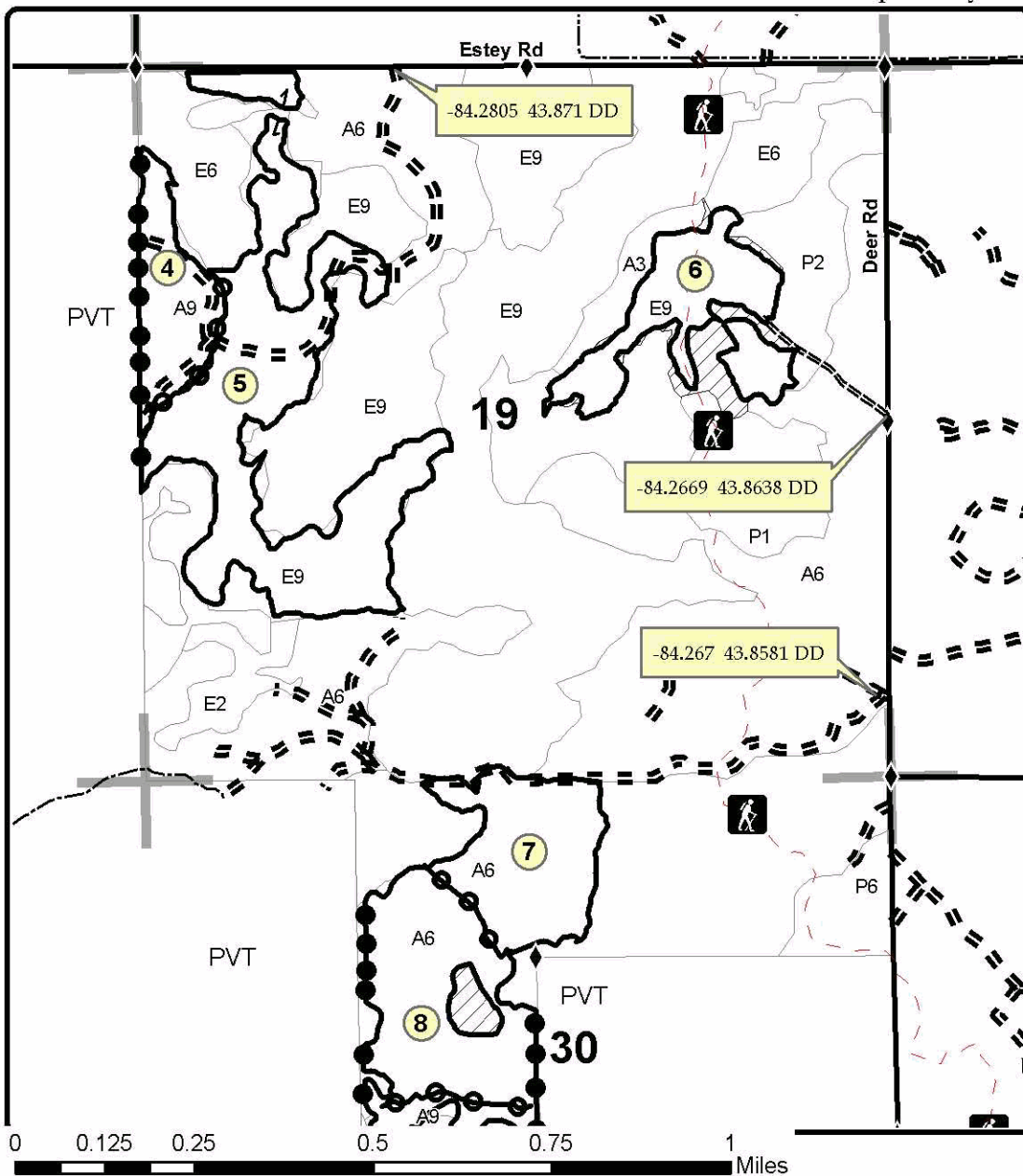
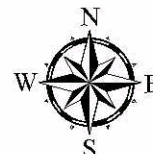

Legend

Sale Boundary

- Against State (Red)
- Payment Unit (Yellow)
- Private Line (Blue)

Adj Stand Boundaries

- Highway
- Gravel
- Paved
- - - Poor Dirt
- ▨ Lakes
- Trail
- Section Corners
- ▨ Retention Area

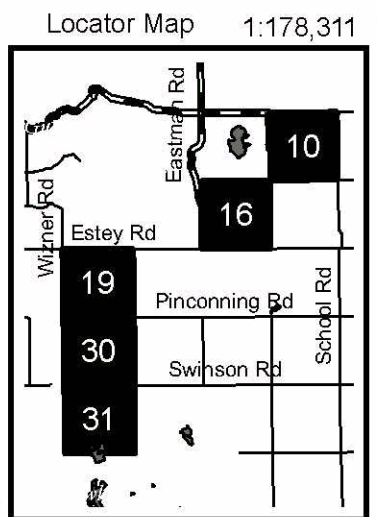



TIMBER SALE MAP

This information provided by authority of Part 525, 1994 PA 451, as amended.

Sale Number	Year
73 - 001	14

Forest Management Unit	County	Mapped By	Date	Page	of
Gladwin Management Unit	Gladwin	Steven Nyhoff	05/29/2014	3	4
Township		Cruised By		Scale	
17N		Metcalfe Forestry/Nyhoff		1:15,840	

Range	Section(s) and Subdivision(s)	Scale
02E	Various	1:15,840

Cover Type

A = Aspen	H = Hemlock	N = Marsh	U = Upland Brush
B = Paper Birch	J = Jack Pine	O = Oak	UM = Upland Mixed
C = Cedar	L = Lowland Brush	P = Lowland Poplar	V = Bog or Marsh
D = Treed Bog	LM = Lowland Mixed	Q = Mixed Swamp Conifer	W = White Pine
E = Swamp Hdwoods	M = Mpl, Bch, Brch	R = Red Pine	X = Non Stocked
F = Spruce Fir	MC = Mixed Conifer	S = Black Spruce	Z = Water
G = Grass	MD = Mixed Deciduous	T = Tamarack	

Density

0 = Non Stocked	5 = Pole Timber Medium
1 = Seedling Sapling Poor	6 = Pole Timber Well
2 = Seedling Sapling Medium	7 = Saw Timber Poor
3 = Seedling Sapling Well	8 = Saw Timber Medium
4 = Pole Timber Poor	9 = Saw Timber Well

PU	Acres	PU	Acres	PU	Acres
1	21	5	68	9	20
2	29	6	24	10	30
3	17	7	30		
4	17	8	34		

Estey Blend
Compartment 83 & 84
290 Acres
 Lead Insp. Rick Myrick

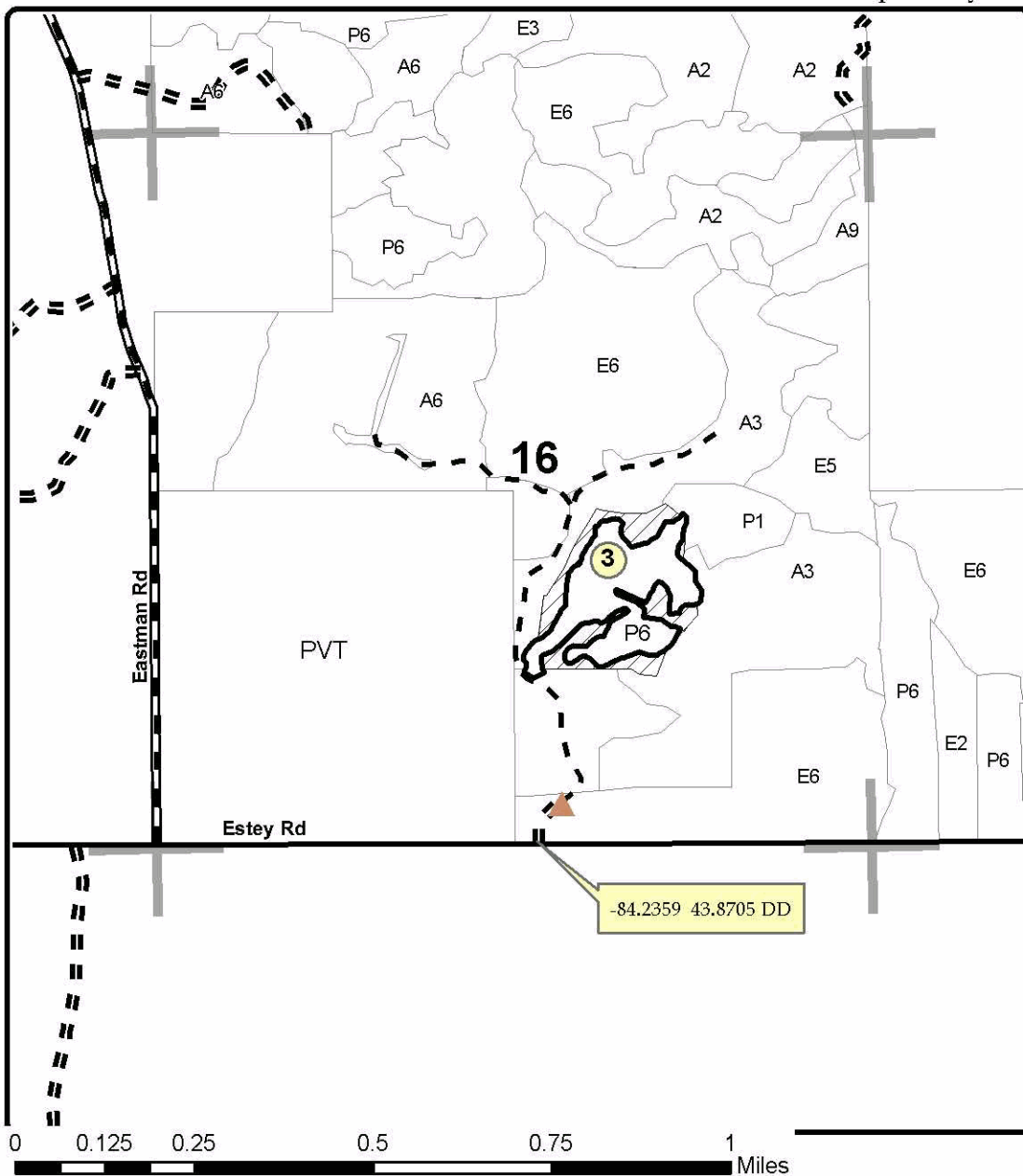
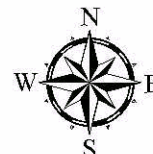

Legend

Sale Boundary

- Against State (Red)
- Payment Unit (Yellow)
- Private Line (Blue)
- Adj Stand Boundaries
- Highway
- Gravel
- Paved
- Poor Dirt
- Lakes
- Trail
- Section Corners
- Retention Area

Locator Map 1:178,311

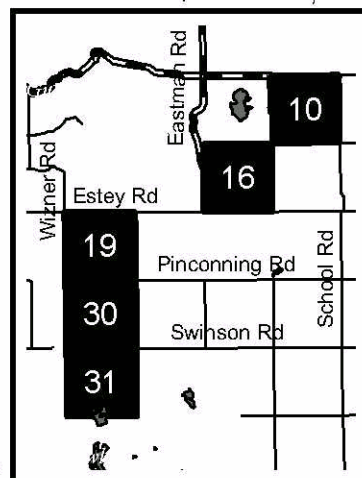



TIMBER SALE MAP

This information provided by authority of Part 525, 1994 PA 451, as amended.

Forest Management Unit Gladwin Management Unit		County Gladwin	Mapped By Steven Nyhoff	Date 05/29/2014	Page 4	of 4
Township 17N	Range 02E	Section(s) and Subdivision(s) Various		Scale 1:15,840		

Cover Type				Density	
A = Aspen	H = Hemlock	N = Marsh	U = Upland Brush	0 = Non Stocked	5 = Pole Timber Medium
B = Paper Birch	J = Jack Pine	O = Oak	UM = Upland Mixed	1 = Seedling Sapling Poor	6 = Pole Timber Well
C = Cedar	L = Lowland Brush	P = Lowland Poplar	V = Bog or Marsh	2 = Seedling Sapling Medium	7 = Saw Timber Poor
D = Treed Bog	LM = Lowland Mixed	Q = Mixed Swamp Conifer	W = White Pine	3 = Seedling Sapling Well	8 = Saw Timber Medium
E = Swamp Hdwoods	M = Mpl, Bch, Brch	R = Red Pine	X = Non Stocked	4 = Pole Timber Poor	9 = Saw Timber Well
F = Spruce Fir	MC = Mixed Conifer	S = Black Spruce	Z = Water		
G = Grass	MD = Mixed Deciduous	T = Tamarack			

PU	Acres	PU	Acres	PU	Acres
1	21	5	68	9	20
2	29	6	24	10	30
3	17	7	30		
4	17	8	34		

Estey Blend
Compartment 83 & 84
290 Acres
 Lead Insp. Rick Myrick

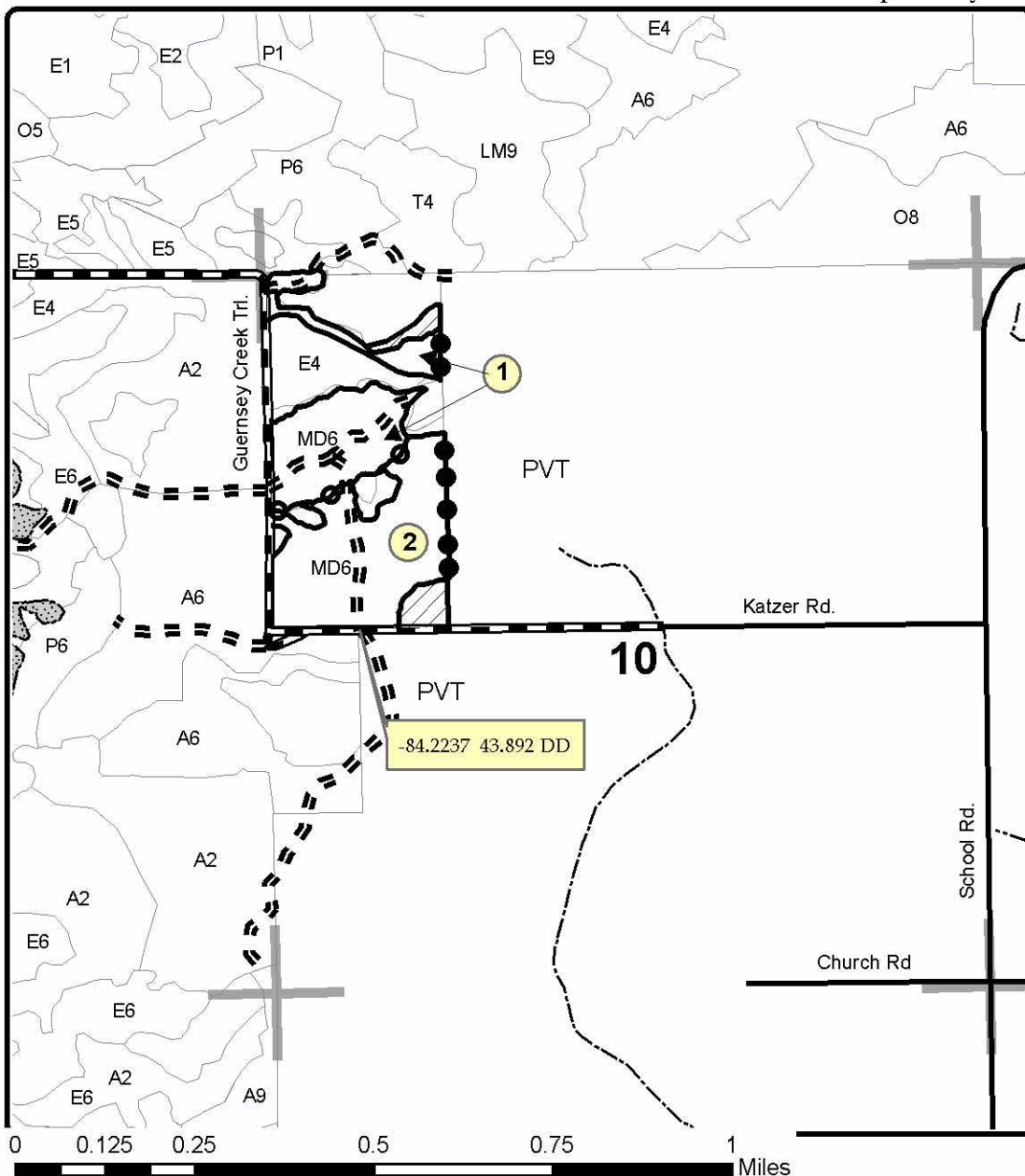
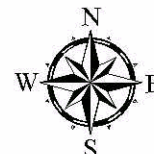

Legend

Sale Boundary

- Against State (Red)
- Payment Unit (Yellow)
- Private Line (Blue)
- Adj Stand Boundaries
- Highway
- Gravel
- Paved
- Poor Dirt
- ▨ Lakes
- Trail
- Section Corners
- ▨ Retention Area

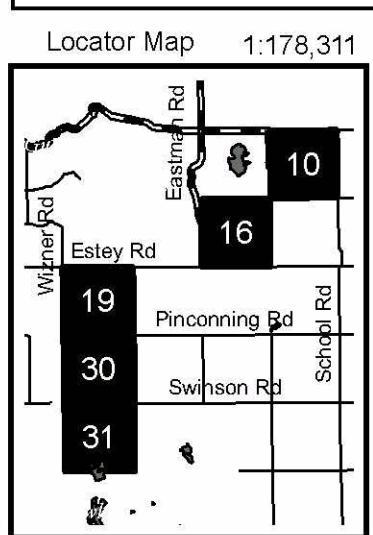

TIMBER SALE INFORMATION

C 111 ASPEN (73-020-13-01)

T15N, R02W, SEC. 01; T15N, R02W, SEC. 02; T15N, R02W, SEC. 03.
Midland County (Advertised Price \$16,249.90)

A timber sale contract for this lump sum, sealed bid timber sale will be awarded to the responsible bidder offering the highest sealed bid price. Bids must be at or above the following advertised price for each species:

<u>PRODUCTS & SPECIES</u>	<u>ESTIMATED UNITS*</u>	<u>ADVERTISED PRICE</u>
Sawlogs		
Mixed Aspen	106.90 MBF	\$ 20.00 / MBF
Mixed Oak	23.20 MBF	\$ 76.00 / MBF
Red Maple	79.70 MBF	\$ 32.00 / MBF
Red Oak	13.00 MBF	\$ 112.00 / MBF
Pulpwood		
Mixed Aspen	596.00 Cords	\$ 8.40 / Cord
Red Maple	363.00 Cords	\$ 4.00 / Cord

In addition, the successful bidder agrees to purchase the following species at the indicated advertised price for a total value of \$1,883.90:

<u>PRODUCTS & SPECIES</u>	<u>ESTIMATED UNITS*</u>	<u>ADVERTISED PRICE</u>
Sawlogs		
Black Ash	2.50 MBF	\$ 15.00 / MBF
White Ash	16.30 MBF	\$ 45.00 / MBF
Pulpwood		
Black Ash	21.00 Cords	\$ 3.50 / Cord
Mixed Oak	70.00 Cords	\$ 4.70 / Cord
White Ash	74.00 Cords	\$ 9.60 / Cord

* The total volume is statistically estimated within plus (+) or minus (-) 9.91 percent. The estimated units are final and not subject to adjustment. Prospective bidders are urged to examine this timber and to make their own estimates of quantity and quality.

BOND AND PAYMENT SCHEDULE:

1. A bond in the amount of **\$1,700.00** to insure faithful performance of the conditions of the contract will be deposited by the successful bidder within 21 days of the sale award.
2. Cutting in any sale or unit without the required advance payment would be considered a trespass.
3. Total payment must be paid in advance or according to the following schedule:
 - (a) Ten percent (10%) of the sale value must be paid within 21 days of the sale award.
 - (b) The 10% down payment will be credited towards the first unit cut.
 - (c) Payment for each of the following units must be made before cutting begins in that unit:

<u>PAYMENT UNIT NUMBER</u>	<u>PERCENT OF TOTAL SALE VALUE</u>
01	14%
02	7%
03	36%
04	6%
05	9%
06	9%
07	19%

4. If no cutting takes place, the 10% down payment will not be refunded.
5. Operations on the contract issued will terminate on 12/31/2017.

Sale Specific Conditions & Requirements

Sale Name: C 111 Aspen Sale Number: 73-020-13-01

1 - Sale Area

1.2 - Boundaries

1.2.1 - Painted boundaries (1/14)

The sale boundary and Payment Unit boundaries are marked and identified by blue, red and yellow paint. Exterior sale boundary lines against private property are marked with blue paint. Exterior sale boundary lines against state are marked with red paint. Interior Payment Unit boundaries are marked with yellow paint. The painted boundary line trees are not Included Timber and are to be protected. Yellow painted trees designating an interior Payment Unit boundary shall not be cut.

2 - Timber Specifications

2.1 - Included Timber

2.1.1 - Clearcut unit(s) with unmerchantable trees (8/11)

Within Payment Unit(s) 3, cut all trees that are two (2) inches or more in diameter measured at a point four and one-half (4-1/2) feet above ground level regardless of merchantability. EXCEPTION: Do not cut any trees marked with green paint.

EXCEPTION: Do not cut any white oak or black tupelo trees.

2.1.4 - Species designation unit(s) (12/08)

Within Payment Unit(s) 1, 2, 4, 5, 6, and 7, all aspen and ash trees are designated for cutting.

IN ADDITION: In Units 4, 5, 6, and 7, cut all trees marked with orange paint.

IN ADDITION: Do not cut any trees marked with green paint above and below stump height.

2.2 - Utilization

2.2.3 - Stump heights (4/07)

Stump heights within the Sale Area shall not exceed 6 inches for trees greater than 10 inches DBH and 4 inches for trees smaller than 10 inches DBH.

2.2.5 - Limbed tree skidding (1/09)

The skidding of whole trees or tree segments with limbs attached is prohibited unless approved by the Unit Manager or his/her representative. This applies to all Payment Units except 1 and 3.

3 - Payments

3.4 - Damaged Timber

3.4.1 - Damaged timber (6/05)

General Condition and Requirement 3.4 Damaged Timber, defines liquidated damages for undesignated live merchantable trees which are cut or injured. In addition, extreme care should be taken to avoid damage to tree seedlings and saplings. Damage to residual trees (defined as breaking of the cambium layer, broken tops or bending of trees from their natural position) is not acceptable.

Within the sale area, if more than 33% of the tree seedlings or saplings (1/4" to 4.5" DBH) within a specified portion of the sale area are damaged, liquidated damages will be assessed at \$300 per acre for all acreage within that specified portion of the sale area that was damaged.

No damage is acceptable to merchantable trees. Within the sale area, if more than 5% of trees (> 4.5" DBH) within a specified area of the sale are damaged, liquidated damages will be assessed for all trees damaged. Rates will be in accordance with General Condition and Requirement 3.4 Damaged Timber.

4 - Transportation

4.1 - Construction

4.1.3 - Slash and earthen piles (8/04)

Piles or windrows of earth along roads and landings that have been widened or constructed shall be leveled. Slash from road maintenance or construction, including stumps, shall be reserved for road closure, chipped, or dispersed throughout the cutting

units. Unmerchantable trees shall be cut, not pushed over.

4.1.7 - Road closure (10/11)

Some existing roads may also need to be closed. See the Timber Sale Map for locations. Stumps from road construction must be placed along the length of the trail. These roads must be rendered impassable to cars and trucks. Contact the sale administrator for specific details of design and placement.

4.1.8 - Road work (1) (8/07)

The following road work is required:

NOTE: All timber from road clearing is included in this contract.

NOTE: The DNR shall provide all culverts required below.

1) On the state forest road just East of the intersection of Geneva and Olson Roads: Installation of two (2) equalization culverts. Cut all timber to 33 feet North of center line of same road.

2) Installation of culvert on McGrudder Rd. just south of Payment Units 5 and 6.

3) Clearing timber to 33 ft. from the centerline on both sides of McGrudder Rd. between Payment Units 6 & 7.

4) Building a twenty foot (20') wide road between the landings for Payment Units 3 and 5, including installation of one (1) culvert.

Within 60 days of completion of hauling, or if no hauling occurs for 60 days, the roads must be maintained and graded. This includes cleaning of drainage areas, grading, crowning and filling with gravel, if necessary. Damages will be assessed if grading/repair does not occur.

5 - Operations

5.1 - Notification

5.1.1 - Pre-sale conference (10/11)

A pre-sale conference on site, to determine landing and road locations, between the Purchaser and sale administrator is required prior to beginning any operations in each Payment Unit. The Unit Manager or his/her representative must be contacted at least 2 days in advance to schedule the conference. At the Sale Administrator's discretion, all Payment Units may be addressed in one or multiple pre-sale conferences. At the Sale Administrator's discretion, pre-sale conference(s) may occur over the telephone. The Sale Administrator shall be contacted each time operations cease temporarily and/or resume in each Payment Unit.

5.1.4 - Post-sale conference (6/11)

A post-sale conference on site between the Purchaser and sale administrator is required 2 days prior to the completion of active logging operations to determine clean-up and repair of landings, road edges, and the fulfillment of other contract specifications. The purchaser is responsible for contacting the Sale Administrator to arrange this conference.

5.2 - Conduct of Operations

5.2.1 - Slash

5.2.1.8 - Slash height (12/08)

No slash may exceed 24 inches in height. Slash must be kept ten (10) feet back from blue paint lines.

5.2.2 - Hazard Trees/Snags

5.2.2.1 - Den trees (2/04)

Obvious hollow and/or den trees shall be protected and left standing unless they are a safety hazard.

5.2.3 - Operating Restrictions

5.2.3.2 - Operating restrictions (9/11)

Within Payment Unit(s) 3, 5, 6, and 7, unless changed by written agreement, cutting, skidding, and hauling are limited to the periods of 7-15 to 9-30 and 1-1 to 3-15.

Within Payment Units 1, 2 and 4, unless changed by written agreement, cutting, skidding, and hauling are limited to the periods of 1-1 to 3-15.

This restriction is because of seasonally flooded areas, wet soils and old aspen. Conditions permitting, this period may be extended with written permission from the Unit Manager or His/Her representative.

5.2.3.11 - Coppice regeneration protection (4/10)

Any timber harvesting or post harvest operations, such as felling, skidding, or chipping, in any Payment Unit, must be completed before sprouting of regeneration occurs in that Payment Unit, so as to avoid damage to the new regeneration. If it is anticipated that chipping will be delayed, then tops shall be carried to one central location or left unchipped. The Unit Manager or his/her representative may cease operations if sprouting occurs before the operation is complete.

5.2.4 - Dead and Down Creation

5.2.4.3 - Dead and down creation, dead trees (6/07)

Except as provided for in General Condition and Requirement 5.2.2, no dead trees, standing or down, are to be cut, skidded, or processed. Exception: All dead trees within 50' of private property line will be cut and left on the ground.

5.4 - Soil Protection

5.4.1 - Rutting restriction, general (1/09)

Operations are to cease immediately if equipment and weather conditions result in rutting of roads and skid trails which is 12 inches or greater in depth and 50 feet in length. The Unit Manager or his/her representative may restrict hauling and/or skidding if ruts exceed the specified depth. With the Unit Manager or his/her representative's approval, the Purchaser may return to the area when the risk of rutting has decreased.

7 - Other Conditions

7.5 - Loss

7.5.1 - Deteriorating timber (7/09)

The sale area has received damage from Emerald Ash Borer. Only live ash trees were cruised. In addition, the aspen in the sale is old and dying. The Purchaser should harvest the wood as soon as possible. The Department of Natural Resources is held free of responsibility of any further damage or deterioration due to delay in harvesting.



Michigan Department of Natural Resources - Forest Management Division

TIMBER SALE MAP

This information provided by authority of Part 525, 1994 PA 451, as amended.

Sale Number	Year
20	13

Forest Management Unit Gladwin Management Unit	County MIDLAND	Mapped By M Reichel	Date 8/2/2013	Page 1	of 1
Township 14N	Range 02W	Section(s) and Subdivision(s) S1: NW, N1/2SW. S2: S1/2NW, S1/2NE, N1/2SE, E1/2SW. S3: E1/2NE, SE.	Scale 1:15,840		

Cover Type				Density	
A = Aspen	G = Grass	N = Marsh	U = Upland Brush	0 = Non Stocked	5 = Pole Timber Medium
B = Paper Birch	H = Hemlock	O = Oak	UM = Upland Mixed	1 = Seedling Sapling Poor	6 = Pole Timber Well
C = Cedar	J = Jack Pine	P = Lowland Poplar	V = Bog or Marsh	2 = Seedling Sapling Medium	7 = Saw Timber Poor
D = Tread Bog	L = Lowland Brush	Q = Mixed Swamp Cnfr	W = White Pine	3 = Seedling Sapling Well	8 = Saw Timber Medium
E = Swamp Hdwoods	M = Mpl, Bch, Brch	R = Red Pine	X = Non Stocked	4 = Pole Timber Poor	9 = Saw Timber Well
F = Spruce Fir	MC = Mixed Conifer	S = Black Spruce	Z = Water		
	MD = Mixed Deciduous	T = Tamarack			

C 111 Aspen

Midland County
Compartment 111
236 Acres

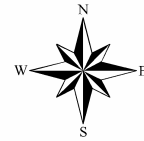

Lead Inspector: S. Nyhoff

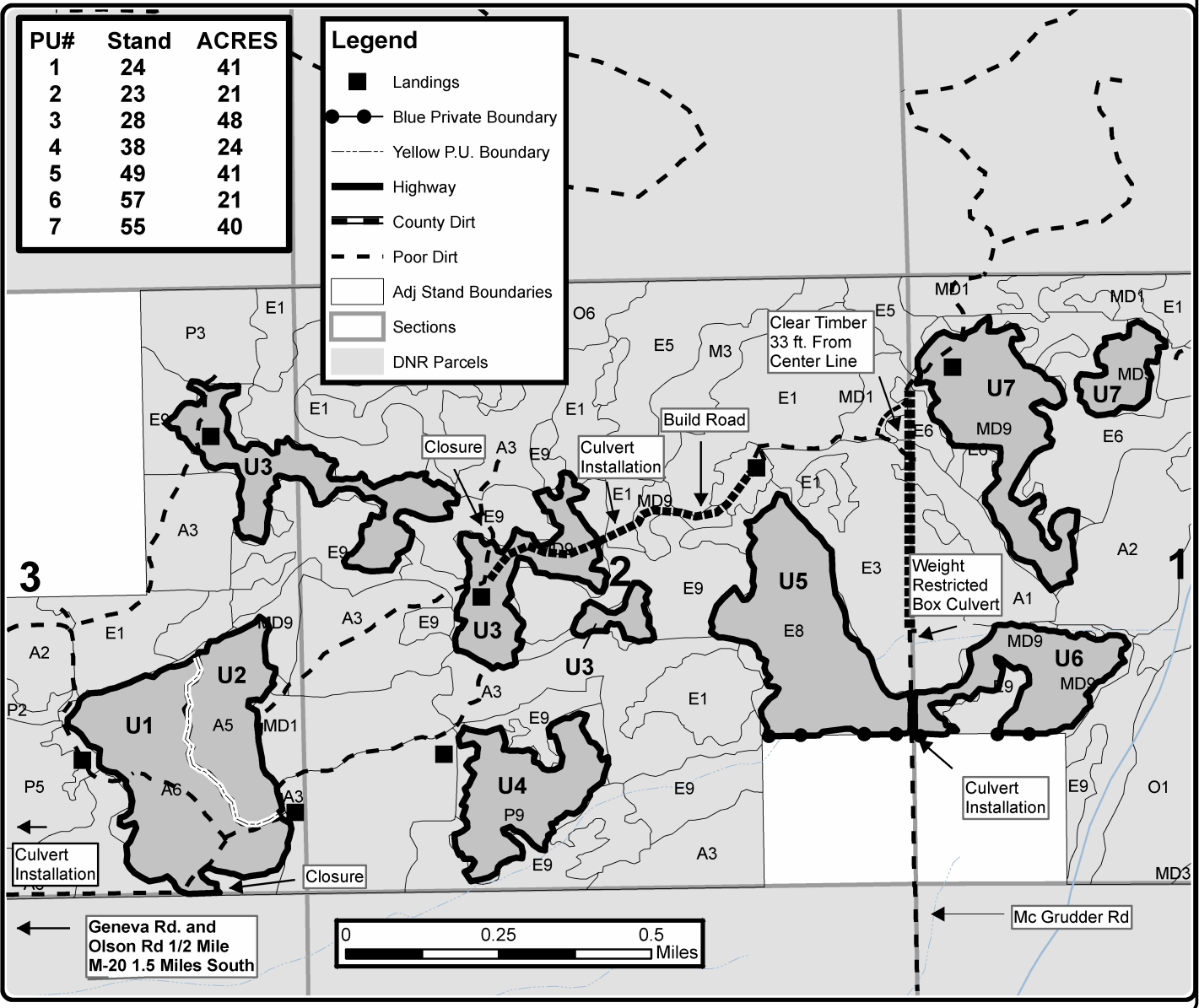

ESTEY BLEND (73-001-14-01)

T17N, R02E, SEC. 10; T17N, R02E, SEC. 16; T17N, R02E, SEC. 19; T17N, R02E, SEC. 30, Gladwin
County

In response to the notice of sale to be held 11:00 a.m. (local time) on December 10, 2014, I am hereby submitting my sealed bid (firm offer) for the following forest products to be cut. Bids for individual species must be at or above the advertised price. All non-responsive bid forms may be rejected.

<u>PRODUCTS & SPECIES</u>	<u>ESTIMATED UNITS*</u>	<u>ADVERTISED PRICE</u>	<u>BID PRICE</u>
Sawlogs			
Mixed Aspen	303.20 MBF	\$ 41.00 / MBF	\$ _____ / MBF
Mixed Oak	25.20 MBF	\$ 126.00 / MBF	\$ _____ / MBF
Red Maple	105.10 MBF	\$ 54.00 / MBF	\$ _____ / MBF
Pulpwood			
Mixed Aspen	1,802.00 Cords	\$ 14.36 / Cord	\$ _____ / Cord
Red Maple	814.00 Cords	\$ 8.50 / Cord	\$ _____ / Cord

In addition, the successful bidder agrees to purchase the following species at the indicated advertised price for a total value of \$8,665.60 :

<u>PRODUCTS & SPECIES</u>	<u>ESTIMATED UNITS*</u>	<u>ADVERTISED PRICE</u>
Sawlogs		
White Ash	37.60 MBF	\$ 45.00 / MBF
Pulpwood		
Mixed Hardwood	47.00 Cords	\$ 11.50 / Cord
Mixed Oak	110.00 Cords	\$ 7.90 / Cord
Other C. Sp.	58.00 Cords	\$ 5.70 / Cord
Paper Birch	109.00 Cords	\$ 7.15 / Cord
White Ash	304.00 Cords	\$ 13.85 / Cord
White Pine	13.00 Cords	\$ 18.75 / Cord

* The total volume is statistically estimated within plus (+) or minus (-) 8.81 percent. The estimated units are final and not subject to adjustment. Prospective bidders are urged to examine this timber and to make their own estimates of quantity and quality.

I understand that any or all bids may be rejected. All bids must be signed and all bid items must be bid or the bid form may be rejected. I also understand that consideration and awarding a contract will be based upon my past performance and ability to complete the contract based upon equipment and staffing subject to my control.

FEDERAL ID: ___ - ___ - ___ or SOCIAL SECURITY NUMBER: ___ - ___ - ___

Company or individual bidding: _____

Company representative's name: _____

Address: _____

City: _____ State: _____ Zip: _____

IF AVAILABLE, PLEASE PLACE THE PERSONALIZED LABEL FROM YOUR PROSPECTUS IN THE ABOVE BOX.

Individual or company representative's signature: _____ Date: _____

Phone number : _____ Email (optional): _____



TIMBER SALE

VERIFICATION OF WORKER'S DISABILITY COMPENSATION ACT COMPLIANCE

As required by Act 317, P.A. 1969 (Worker's Compensation) and
Part 525 of Act 451 of 1994, as amended.

FOR DEPARTMENT USE ONLY	
Sale Number (XX - XXX - XX - XX)	
Forest Management Unit:	

VERIFICATION OF WORKER'S DISABILITY COMPENSATION ACT COMPLIANCE

- This verification must be completed and submitted within 21 days of contract award and prior to the issuance of the timber sale contract.
- In addition, if boxes 2B or 2C are checked, then Notice of Exclusion or Certificate of Insurance must be submitted within 21 days of the contract award and prior to the issuance of the timber sale contract.
- All Information must be typed or printed except for written signatures.

Please Check Appropriate Categories:

1. My business is organized as (you **must** check one of the boxes below):
 - A. Sole Proprietorship (individual)
 - B. Partnership
 - C. Corporation
2. You **must** check one of the boxes below:
 - A. I certify that my business is a sole proprietorship and it has no employees but the sole proprietor. I am not subject to the Worker's Compensation Laws.
 - B. I certify that my business has satisfied its obligation to the Worker's Compensation Act through the use of an approved Notice of Exclusion (BWC-337, Rev. 5/96). I will provide a copy of the Notice of Exclusion within 21 days of the contract award. (For questions or a copy of the BWC-337, please call the Worker's Compensation Bureau at 517-322-1195).
 - C. I certify that my business has a Worker's Compensation Policy. I will provide an original Certificate of Insurance within 21 days of the contract award.
3. If you have checked item 2(A) or 2(B), you **must** indicate the number of **both** full-time and part-time employees, other than yourself, including family members and active partners (if none, you must enter "0").

_____ Full-time Employees

_____ Part-time Employees

Name of Business		Federal ID (or) Social Security No.
Address		Telephone ()
City	State	ZIP

I hereby certify that the above information is true and correct. I agree to notify the Michigan DNRE of any changes that occur in factors affecting my coverage during any of my present and future operations.

Signature of Owner or Authorized Representative

Title

Date

C 111 ASPEN (73-020-13-01)

T15N, R02W, SEC. 01; T15N, R02W, SEC. 02; T15N, R02W, SEC. 03, Midland County

In response to the notice of sale to be held 11:00 a.m. (local time) on December 10, 2014, I am hereby submitting my sealed bid (firm offer) for the following forest products to be cut. Bids for individual species must be at or above the advertised price. All non-responsive bid forms may be rejected.

<u>PRODUCTS & SPECIES</u>	<u>ESTIMATED UNITS*</u>	<u>ADVERTISED PRICE</u>	<u>BID PRICE</u>
Sawlogs			
Mixed Aspen	106.90 MBF	\$ 20.00 / MBF	\$ _____ / MBF
Mixed Oak	23.20 MBF	\$ 76.00 / MBF	\$ _____ / MBF
Red Maple	79.70 MBF	\$ 32.00 / MBF	\$ _____ / MBF
Red Oak	13.00 MBF	\$ 112.00 / MBF	\$ _____ / MBF
Pulpwood			
Mixed Aspen	596.00 Cords	\$ 8.40 / Cord	\$ _____ / Cord
Red Maple	363.00 Cords	\$ 4.00 / Cord	\$ _____ / Cord

In addition, the successful bidder agrees to purchase the following species at the indicated advertised price for a total value of \$1,883.90 :

<u>PRODUCTS & SPECIES</u>	<u>ESTIMATED UNITS*</u>	<u>ADVERTISED PRICE</u>
Sawlogs		
Black Ash	2.50 MBF	\$ 15.00 / MBF
White Ash	16.30 MBF	\$ 45.00 / MBF
Pulpwood		
Black Ash	21.00 Cords	\$ 3.50 / Cord
Mixed Oak	70.00 Cords	\$ 4.70 / Cord
White Ash	74.00 Cords	\$ 9.60 / Cord

* The total volume is statistically estimated within plus (+) or minus (-) 9.91 percent. The estimated units are final and not subject to adjustment. Prospective bidders are urged to examine this timber and to make their own estimates of quantity and quality.

I understand that any or all bids may be rejected. All bids must be signed and all bid items must be bid or the bid form may be rejected. I also understand that consideration and awarding a contract will be based upon my past performance and ability to complete the contract based upon equipment and staffing subject to my control.

FEDERAL ID: _____ or SOCIAL SECURITY NUMBER: _____

Company or individual bidding: _____

Company representative's name: _____

Address: _____

City: _____ State: _____ Zip: _____

IF AVAILABLE, PLEASE PLACE THE PERSONALIZED LABEL FROM YOUR PROSPECTUS IN THE ABOVE BOX.

Individual or company representative's signature: _____ Date: _____

Phone number : _____ Email (optional): _____



TIMBER SALE
VERIFICATION OF WORKER'S DISABILITY
COMPENSATION ACT COMPLIANCE

*As required by Act 317, P.A. 1969 (Worker's Compensation) and
Part 525 of Act 451 of 1994, as amended.*

FOR DEPARTMENT USE ONLY	
Sale Number (XX - XXX - XX - XX)	
Forest Management Unit:	

VERIFICATION OF WORKER'S DISABILITY COMPENSATION ACT COMPLIANCE

- This verification must be completed and submitted within 21 days of contract award and prior to the issuance of the timber sale contract.
- In addition, if boxes 2B or 2C are checked, then Notice of Exclusion or Certificate of Insurance must be submitted within 21 days of the contract award and prior to the issuance of the timber sale contract.
- All Information must be typed or printed except for written signatures.

Please Check Appropriate Categories:

- My business is organized as (you **must** check one of the boxes below):
 - Sole Proprietorship (individual)
 - Partnership
 - Corporation
- You **must** check one of the boxes below:
 - I certify that my business is a sole proprietorship and it has no employees but the sole proprietor. I am not subject to the Worker's Compensation Laws.
 - I certify that my business has satisfied its obligation to the Worker's Compensation Act through the use of an approved Notice of Exclusion (BWC-337, Rev. 5/96). I will provide a copy of the Notice of Exclusion within 21 days of the contract award. (For questions or a copy of the BWC-337, please call the Worker's Compensation Bureau at 517-322-1195).
 - I certify that my business has a Worker's Compensation Policy. I will provide an original Certificate of Insurance within 21 days of the contract award.
- If you have checked item 2(A) or 2(B), you **must** indicate the number of **both** full-time and part-time employees, other than yourself, including family members and active partners (if none, you must enter "0").

_____ Full-time Employees

_____ Part-time Employees

Name of Business		Federal ID (or) Social Security No.	
Address		Telephone ()	
City	State	ZIP	

I hereby certify that the above information is true and correct. I agree to notify the Michigan DNRE of any changes that occur in factors affecting my coverage during any of my present and future operations.

Signature of Owner or Authorized Representative

Title

Date