



**DEPARTMENT OF NATURAL RESOURCES  
STATE OF MICHIGAN**

**TIMBER SALE PROSPECTUS #5686**

SCHEDULED SALE DATE AND TIME: 3:00 p.m. (local time) on August 9, 2016.

LOCATION: ESCANABA OFFICE, 6833 HWY 2, 41 & M-35, GLADSTONE, MI 49837.

PROSPECTUS NOTE: The bidder is advised to inspect the sale area and review the location, estimated volumes, operating costs and contract terms of proposed sales. Please be aware that some landowners may request 60 days or more notice for access across their land.

Notice is hereby given that bids will be received by the Unit Manager, ESCANABA MANAGEMENT UNIT, for certain timber on the following described lands:

NORTH 107 SBW (33-003-16) / T41N, R22W, SEC. 26, SWSW.

T41N, R22W, SEC. 34, SENE, NESE.

T41N, R22W, SEC. 35, NWNW, SWNW.

Delta County, Advertised Price \$27,034.40, 56.5 Acres, Red Pine, Spruce/Fir/Tamarack.

SALE NOTE: A recreation site such as a trail, pathway, or campground is within the sale area or the vicinity. Certain restrictions/specifications may be applicable including time restrictions.

Water and Ice SBW (33-026-16)

Menominee County, Advertised Price \$138,398.90, 142.6 Acres, Hardwood, Spruce/Fir/Tamarack.

SALE NOTE: A portion of the Elwood Creek Road is used by the Forest Island ORV Trail. This segment of road/trail must be level and free of debris at all times. The road/trail will be posted with signs warning of logging activity.

A recreation site such as a trail, pathway, or campground is within the sale area or the vicinity. Certain restrictions/specifications may be applicable including time restrictions.

Flowing Elwood (33-027-16)

Menominee County, Advertised Price \$204,021.95, 142.1 Acres, Hardwood, Spruce/Fir/Tamarack.

SALE NOTE: The Camp "O" Road is an ORV Route which needs to be free of debris and ruts at all times. The sale contains advanced regeneration throughout which needs to be protected.

A recreation site such as a trail, pathway, or campground is within the sale area or the vicinity. Certain restrictions/specifications may be applicable including time restrictions.

## BID INSTRUCTIONS (VER. 05/04/2016):

### 1. Scheduled Bid Location, Date, and Time (2/11)

Bids must be received by the Unit Manager, ESCANABA OFFICE, 6833 HWY 2, 41 & M-35, GLADSTONE, MI 49837, no later than 3:00 p.m. (local time) on August 9, 2016. For further information concerning this sale, contact Eric Thompson at 906-786-2354.

### 2. Bidder's Qualifications (5/16)

Purchaser shall obtain workers compensation insurance to cover claims under Michigan's Worker's Disability Compensation Act of 1969 or similar employee benefit act of any other state applicable to an employee. If all or part of a timber sale was prepared by a private contractor, the contractor and that contractor's company are not permitted to bid on the timber sale contract. Bids will not be accepted from individuals or companies appearing on the DNR/FRD No-Bid List. This list contains the names of purchasers who previously failed to execute a contract within 21-days or who have a history of poor performance.

### 3. Preparation of Sealed Bids (5/16)

Bid Forms may be completed online thru Michigan DNR Timber Sale Online Bidding (OLB) at [www.michigan.gov/timberbidding](http://www.michigan.gov/timberbidding) or by completing the hardcopy Bid Form found in the Timber Sale Prospectus. Hardcopy Bid Forms shall be manually signed in ink. Registration in OLB is considered your 'signature' for all bids submitted thru that system. Bid prices must be entered for each species and product in the Bid Price column for all material subject to bidding and all fill-in blanks must be completed. If erasures or other changes appear on the hardcopy Bid Form, each erasure or change must be initialed by the person signing the bid.

### 4. Submission of Sealed Bids (5/16)

Bid forms may be obtained from the Unit Manager or thru OLB. Bids may be submitted hardcopy or thru OLB. All hardcopy bids must be submitted on the bid form and in an envelope clearly identified as described in this section. NOTE: Only one bid form per bid envelope. Sealed bids must be submitted to the Unit office designated in the prospectus and must be submitted at or prior to the time established in the prospectus. The envelope should show on the outside (a) the sale name or number and (b) the date and time of bid opening, as shown in the prospectus. Bids received after the time specified in the sale prospectus are late bids and will be rejected.

It is possible for a bidder to submit multiple bids on a single sale. For example, a bid may be submitted hardcopy and a bid may be submitted thru OLB. Or, two bidders from the same company could both submit bids on the same sale. If this were to happen, the State would accept all bids received and award the contract accordingly. All bidding and contractual requirements would apply to all bids received.

### 5. Public Opening of Sealed Bids (5/16)

If conditions permit, the sealed bids will be publicly opened and posted at the time and place set in the prospectus.

If a bidder, present at a bid opening, has submitted bids on more than one sale, that bidder may withdraw their unopened bid envelopes or announce the withdraw of their online bid after being declared the successful bidder on one sale.

### 6. Award of Contract (1/11)

Award of the contract will be made to the Bidder whose bid, conforming to the prospectus, is most advantageous to the State of Michigan on the basis of total value at rates bid for the estimated quantities. The State reserves the right to reject any bid or waive any minor irregularity in bids received. A written award mailed (or otherwise furnished) to the successful Bidder shall be deemed to result in a binding contract without further action by either party.

### 7. Down Payment (1/11)

The Bidder to whom award is made must make a down payment within 21 days of the sale award. The amount of the down payment will be calculated as shown in the Bond and Payment Schedule of this prospectus. Only cash may be used to meet this requirement.

### 8. Performance Security (1/11)

As guarantee of faithful performance, a cash bond, certificate of deposit, surety bond or irrevocable letter of credit (LOC) is required within 21 days of the sale award. The amount of the performance security is shown in the Bond and

Payment Schedule of this prospectus. If an LOC or surety is used, the coverage must extend for at least 6 months beyond the contract expiration.

#### 9. Timber Sale Contract (9/14)

Additional conditions and requirements common to all timber sales are listed on the timber sale contract (R4031) and are available on line at [www.michigan.gov/timber](http://www.michigan.gov/timber). Contact the Unit Manager for additional information or a sample contract. Within 21 days of the date of the award letter, the bidder must sign the contract and provide the required down payment, performance security, and verification of worker's disability compensation. The down payment and performance security shall be in accordance with the provisions of the timber sale contract, in the sums stated in this prospectus. If these actions are not taken, then the Bidder, the Bidder's corporation, and the corporation's principals may not be permitted to bid on State timber sales for a period of 1 year. In addition, the Bidder certifies that if awarded this contract, the Bidder will complete the timber sale contract in accordance with its terms and any modifications thereof including requirements to purchase, cut, and remove the included timber by the expiration date.

#### 10. Disclaimer of Estimates and Bidder's Warranty of Inspection (1/11)

Before submitting this bid, the Bidder is advised and cautioned to inspect the sale area, review the requirements of the sale contract, and take other steps as may be reasonably necessary to ascertain the location, estimated volumes, construction estimates, and operating costs of the proposed sale. Failure to do so will not relieve the Bidder from responsibility for completing the contract.

The Bidder warrants that this bid is submitted solely on the basis of the Bidder's examination and inspection of the quality and quantity of the timber offered for sale and the Bidder's opinion of the value thereof and the costs of recovery. No reliance should be placed on the State of Michigan's estimates of timber quality, quantity or costs of recovery. Bidder further acknowledges that the State of Michigan: (i) expressly disclaims any warranty of fitness of timber for any purpose; (ii) offers this timber as is without any warranty of quality (merchantability) or quantity and (iii) expressly disclaims any warranty as to the quantity or quality of timber sold.

#### 11. Certification and Chain-of-Custody (10/14)

Unless otherwise indicated in the contract under section 7 – Other Conditions of the Sale Specific Conditions & Requirements, the area encompassed by this timber sale is certified to the standards of the Forest Stewardship Council (FSC) - Certificate #SCS-FM/COC-00090N and the Sustainable Forestry Initiative (SFI) - Certificate #NSF-SFIS-5Y031-SF5. Forest products from this sale may be delivered to the mill as "FSC 100% and / or SFI certified" as long as the contractor hauling the forest products is chain-of-custody (COC) certified or covered under a COC certificate from the destination mill. The purchaser is responsible for maintaining COC after leaving the sale area.

DR. WILLIAM MORITZ  
Director



# TIMBER SALE INFORMATION

NORTH 107 SBW (33-003-16)  
T41N, R22W, SEC. 26; T41N, R22W, SEC. 34; T41N, R22W, SEC. 35.  
Delta County (Advertised Price \$27,034.40)

SALE NOTE: A recreation site such as a trail, pathway, or campground is within the sale area or the vicinity. Certain restrictions/specifications may be applicable including time restrictions.

A timber sale contract for this lump sum, sealed bid timber sale will be awarded to the responsible bidder offering the highest sealed bid price. Bids must be at or above the following advertised price for each species:

<u>PRODUCTS &amp; SPECIES</u>	<u>ESTIMATED UNITS*</u>	<u>ADVERTISED PRICE</u>
Pulpwood		
Black Spruce	431.00 Cords	\$ 23.55 / Cord
N. White Cedar	75.00 Cords	\$ 20.75 / Cord
Red Pine	236.00 Cords	\$ 43.25 / Cord
Tamarack	110.00 Cords	\$ 17.60 / Cord

In addition, the successful bidder agrees to purchase the following species at the indicated advertised price for a total value of \$3,185.10:

<u>PRODUCTS &amp; SPECIES</u>	<u>ESTIMATED UNITS*</u>	<u>ADVERTISED PRICE</u>
Sawtimber		
Paper Birch	0.40 MBF	\$ 97.00 / MBF
Pulpwood		
Mixed Hardwood	28.00 Cords	\$ 29.75 / Cord
Mixed Softwood	30.00 Cords	\$ 24.20 / Cord
Paper Birch	14.00 Cords	\$ 37.20 / Cord
Quaking Aspen	10.00 Cords	\$ 33.45 / Cord
White Pine	40.00 Cords	\$ 18.30 / Cord

\* The estimated units are final and not subject to adjustment. Prospective bidders are urged to examine this timber and to make their own estimates of quantity and quality.

## **BOND AND PAYMENT SCHEDULE:**

1. A bond in the amount of \$1,500.00 to insure faithful performance of the conditions of the contract will be deposited by the successful bidder within 21 days of the sale award.
2. Cutting in any sale or unit without the required advance payment would be considered a trespass.
3. Total payment must be paid in advance or according to the following schedule:
  - (a) Ten percent (10%) of the sale value must be paid within 21 days of the sale award.
  - (b) The 10% down payment will be credited towards the first unit cut.
4. If no cutting takes place, the 10% down payment will not be refunded.
5. Operations on the contract issued will terminate on 03/31/2019.

## Sale Specific Conditions & Requirements

Sale Name: NORTH 107 SBW

Sale Number: 33-003-16 Seq#: 1

### 1 - Sale Area

#### 1.2 - Boundaries

##### 1.2.1 - Painted boundaries (1/14)

The sale boundary and Payment Unit boundaries are marked and identified by blue and red paint. Exterior sale boundary lines against private property are marked with blue paint. Exterior sale boundary lines against state are marked with red paint. Interior retention areas are marked and identified with red painted X marks.

### 2 - Timber Specifications

#### 2.1 - Included Timber

##### 2.1.1 - Clearcut unit(s) with unmerchantable trees (6/14)

Within Payment Unit(s) 1, 2, and 4, cut all trees that are three (3) inches or more at DBH with the following exceptions:

Payment Unit 1 - Do not cut any cedar and pine.

Payment Unit 2 - Do not cut any trees marked with green paint.

Payment Unit 4 - Do not cut any cedar or trees marked with green paint.

##### 2.1.7 - Leave tree marked unit(s) (6/14)

Within Payment Unit(s) 3, all pine trees, which meet minimum piece specifications in 2.2 Utilization, are designated for cutting except any pine trees marked with orange x marks.

### 3 - Payments

#### 3.4 - Damaged Timber

##### 3.4.1 - Damaged timber (6/14)

General Condition and Requirement 3.4 Damaged Timber, defines liquidated damages for undesigned live merchantable trees which are cut or injured. In addition, extreme care should be taken to avoid damage to tree seedlings and saplings.

Within Payment Unit 3, if more than 25% of the tree seedlings or saplings (1/4" to 4.5" DBH) within a specified portion of the sale area are damaged, liquidated damages will be assessed at 100\$ dollars per acre for all acreage within that specified portion of the sale area that was damaged.

### 4 - Transportation

#### 4.1 - Construction

##### 4.1.6 - Road construction (1/09)

Construction of new roads or improvements of existing roads shall be done in such a way as to minimize the environmental and visual impacts. Merchantable trees shall be cut and utilized unless otherwise directed. Non-merchantable trees shall be severed and laid flat on the ground. Slash shall be scattered, and not left in windrows and kept a minimum of 10 feet back from the road edge. Stumps shall be set upright, not left on edge, and be moved at least 10 feet away from the road edge. Disturbed soil shall be feathered into the woods and not left in berms or windrows.

##### 4.1.7 - Road closure (10/11)

All new roads built into the sale must be blocked to vehicle traffic upon completion of the sale. In general, this will require constructing slash berms at a minimum of four (4) locations spaced at not over 50 feet apart. These slash berms will be a minimum of four (4') high. These roads must be rendered impassable to cars and trucks. Contact the sale administrator for specific details of design and placement.

#### 4.4 - Access

#### 4.4.2 - Alternate route on private property (2/04)

It is the Purchaser's responsibility to obtain access across private land for any routes other than the route shown on the sale map.

### 5 - Operations

#### 5.1 - Notification

##### 5.1.1 - Pre-sale conference (10/11)

A pre-sale conference on site between the Purchaser and sale administrator is required prior to beginning any operations to determine landing and road locations. The Unit Manager or his/her representative must be contacted at least 10 days in advance to schedule the conference.

##### 5.1.4 - Post-sale conference (6/11)

A post-sale conference on site between the Purchaser and sale administrator is required 5 days prior to the completion of active logging operations to determine clean-up and repair of landings, road edges, and the fulfillment of other contract specifications.

#### 5.2 - Conduct of Operations

##### 5.2.1 - Slash

###### 5.2.1.1 - Slash within sale area (2/04)

No trees are to be felled outside the sale area and all slash is to be kept at least 10 feet back from the blue paint line.

##### 5.2.3 - Operating Restrictions

###### 5.2.3.6 - Bark beetle restriction (12/08)

In the event drought creates a high risk of pine bark beetle infestation, pine is not to be cut during the period March 1 through July 1, unless all portions of trees greater than two inches in diameter are removed from the sale area, reduced to chips, or treated to the satisfaction of the Unit Manager or his/her representative, within fifteen days of being severed from the stump. Pine log decks, pulpwood piles and treetops that are piled for chipping in the fall or winter within a 1/4 mile of susceptible sites must be removed before March 15. Residual slash must not be placed in piles or rows and must be spread over the site for quick drying. The Department of Natural Resources will exercise this specification if the risk of damage warrants.

##### 5.2.22 - Operating Caution

###### 5.2.22.1 - Operating caution (6/11)

It is recommended, but not required, that within Payment Unit(s) 1, 2, and 4, cutting, skidding, and hauling occur during frozen winter conditions. The reason for the recommendation is because operations within the units are low ground and a greater potential for excessive rutting exists.

##### 5.2.31 - Landing locations (9/13)

Recommended landing areas are marked on the timber sale map with the letter "L". Landings must be confined to these designated sites unless otherwise authorized by the Unit Manager or his/her representative.

##### 5.2.40 - Pathway protection (10/10)

The Days River pathway is a bike, hiking, and ski trail and is shown on the Timber Sale Map. Do not cut trees or damage posts with blue pathway markers. Maintain a 25-foot wide slash, debris, and rut free zone daily, using the pathway as the centerline. Do not run equipment down the pathway and do not leave berms when crossing the pathway. Skidding across the trail may only occur in locations approved by the sale administrator.

##### 5.2.41 - Snowmobile trail protection (9/11)

The Brampton trail is a snowmobile trail and is shown on the Timber Sale Map. Do not cut or damage posts with orange trail markers or traffic control signs. If the trail is used, it must be maintained and restored to a condition equal to or better than before the sale. If the trail is used for hauling, it must be graded to the satisfaction of the Unit Manager or his/her representative. The Sno-flyers club will be notified (906-786-3945) before any operations during the snowmobile season. If the trail road is to be used for hauling during the snowmobile season, then a snow covered base must be left on the trail. Maintain a 20 foot wide slash, debris, and rut free zone daily using the snowmobile trail as the centerline. No decking of forest products will be permitted along the snowmobile trail.

## 5.4 - Soil Protection

### 5.4.1 - Rutting restriction, general (1/09)

Operations are to cease immediately if equipment and weather conditions result in rutting of roads and skid trails which is 12 inches or greater in depth and 50 feet in length. The Unit Manager or his/her representative may restrict hauling and/or skidding if ruts exceed the specified depth. With the Unit Manager or his/her representative's approval, the Purchaser may return to the area when the risk of rutting has decreased.

## 6 - Safety and Fire Prevention

### 6.2 - Signing

#### 6.2.2 - Snowmobile trail posting (8/09)

The Purchaser is responsible for posting and maintaining caution signs on the Brampton snowmobile trail prior to beginning operations during the snowmobile season (approximately December 1 to March 31). The trail must be posted at appropriate distances from the sale area to warn of logging activity and truck traffic. Signs must be removed when harvest operations are suspended or completed. The Purchaser will provide these signs.

#### 6.2.3 - Recreational trail posting (2/10)

The Purchaser is responsible for posting and maintaining caution signs on the Days River pathway prior to beginning operations. The trail must be posted at appropriate distances from the sale area to warn of logging activity and truck traffic at both ends of the trail. Signs must be removed when harvest operations are suspended or completed. The Purchaser will provide these signs.

## 7 - Other Conditions

### 7.3 - Contract Modifications

#### 7.3.1 - Emerald Ash Borer

##### 7.3.1.2 - Emerald ash borer, ash or firewood on sale (2/05)

There is ash and/or "firewood" in this sale and it is located within an emerald ash borer quarantined area. The Director of the Michigan Department of Agriculture (MDA) by the authority of Act No. 72 of the Public Acts of 1945, as amended, and Quarantine Regulation No. 620, has promulgated this quarantine to prevent the further spread of this pest and sets forth: definitions, regulated articles, regulated areas, conditions of movement, violations and penalties, and special exemptions. The Purchaser must comply with this quarantine. Contact the MDA for further information.





# TIMBER SALE MAP

This information provided by authority of Part 525, 1994 PA 451, as amended.

Sale Number	Year
33-003-16-01	16

Forest Management Unit Escanaba	County Delta	Mapped By Racine	Date 1/12/2016	Page 1	of 1
Township 41N	Range 22W	Section(s) and Subdivision(s) 26) SWSW 35) NWNW,SWNW 34) SENE,NESE	Scale 1:15,840		

Cover Type				Density				
A = Aspen	H = Hemlock	N = Marsh	U = Upland Brush	0 = Non Stocked	5 = Pole Timber Medium			
B = Paper Birch	J = Jack Pine	O = Oak	UM = Upland Mixed	1 = Seedling Sapling Poor	6 = Pole Timber Well			
C = Cedar	L = Lowland Brush	P = Lowland Poplar	V = Bog or Marsh	2 = Seedling Sapling Medium	7 = Saw Timber Poor			
D = Tread Bog	LM = Lowland Mixed	Q = Mixed Swamp Conifer	W = White Pine	3 = Seedling Sapling Well	8 = Saw Timber Medium			
E = Swamp Hdwoods	M = Mpl, Bch, Brch	R = Red Pine	X = Non Stocked	4 = Pole Timber Poor	9 = Saw Timber Well			
F = Spruce Fir	MC = Mixed Conifer	S = Black Spruce	Z = Water					
G = Grass	MD = Mixed Deciduous	T = Tamarack						

PU	Acres	PU	Acres
1	8	4	1.5
2	29		
3	18		

## North 107 SBW

### Compartment 107 and 106

56.5 Acres

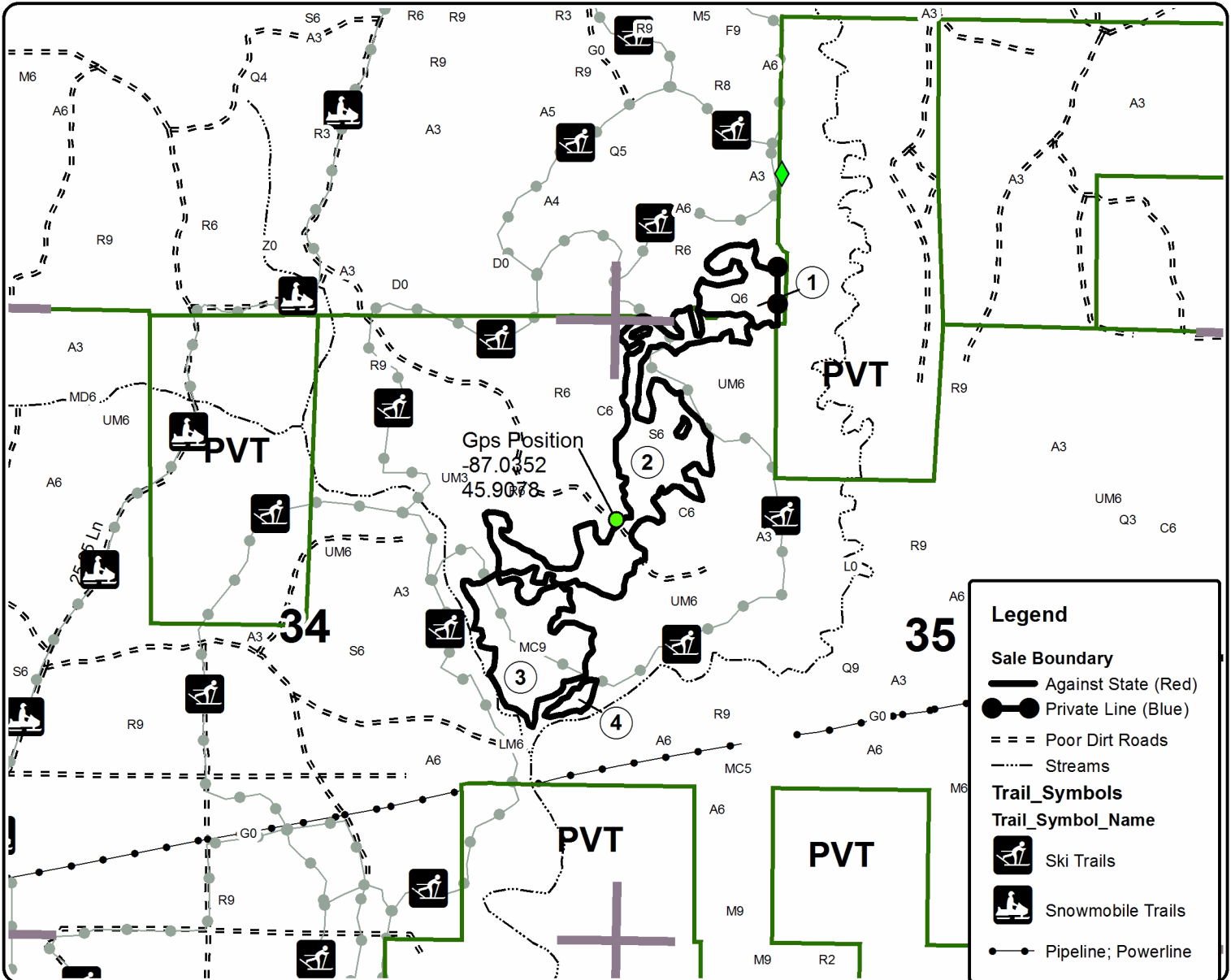
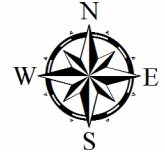

**Legend**

**Sale Boundary**

- Against State (Red)
- Private Line (Blue)
- - - Poor Dirt Roads
- Streams

**Trail\_Symbols**

**Trail\_Symbol\_Name**

- Ski Trails
- Snowmobile Trails
- Pipeline; Powerline

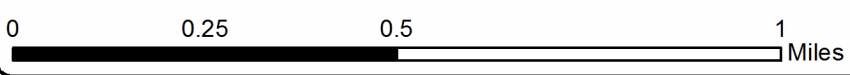



# TIMBER SALE INFORMATION

## Water and Ice SBW (33-026-16)

Menominee County (Advertised Price \$138,398.90)

SALE NOTE: A portion of the Elwood Creek Road is used by the Forest Island ORV Trail. This segment of road/trail must be level and free of debris at all times. The road/trail will be posted with signs warning of logging activity.

A recreation site such as a trail, pathway, or campground is within the sale area or the vicinity. Certain restrictions/specifications may be applicable including time restrictions.

A timber sale contract for this lump sum, sealed bid timber sale will be awarded to the responsible bidder offering the highest sealed bid price. Bids must be at or above the following advertised price for each species:

<u>PRODUCTS &amp; SPECIES</u>	<u>ESTIMATED UNITS*</u>	<u>ADVERTISED PRICE</u>
Sawtimber		
Green Ash	2.20 MBF	\$ 75.00 / MBF
Paper Birch	3.80 MBF	\$ 113.00 / MBF
Red Maple	26.80 MBF	\$ 241.00 / MBF
White Pine	18.70 MBF	\$ 75.00 / MBF
Pulpwood		
Balsam Fir	344.00 Cords	\$ 29.80 / Cord
Hemlock	4.00 Cords	\$ 15.00 / Cord
Mixed Aspen	779.00 Cords	\$ 38.90 / Cord
Mixed Hardwood	1,148.00 Cords	\$ 37.25 / Cord
Mixed Spruce	377.00 Cords	\$ 28.70 / Cord
N. White Cedar	410.00 Cords	\$ 24.80 / Cord
Red Pine	292.00 Cords	\$ 57.25 / Cord
Tamarack	113.00 Cords	\$ 17.20 / Cord
White Pine	244.00 Cords	\$ 28.35 / Cord

\* The total volume is statistically estimated within plus (+) or minus (-) 8.50 percent. The estimated units are final and not subject to adjustment. Prospective bidders are urged to examine this timber and to make their own estimates of quantity and quality.

### **BOND AND PAYMENT SCHEDULE:**

1. A bond in the amount of \$8,250.00 to insure faithful performance of the conditions of the contract will be deposited by the successful bidder within 21 days of the sale award.
2. Cutting in any sale or unit without the required advance payment would be considered a trespass.
3. Total payment must be paid in advance or according to the following schedule:
  - (a) Ten percent (10%) of the sale value must be paid within 21 days of the sale award.
  - (b) The 10% down payment will be credited towards the first unit cut.
4. If no cutting takes place, the 10% down payment will not be refunded.
5. Operations on the contract issued will terminate on 09/30/2019.

**Description of Timber by Payment Unit (PU)**

PU	MARKET GROUP	PRODUCT	QUANTITY	UNIT	ACRES	ADVERTISE PRICE
1	Red Maple	Sawtimber	17.3	MBF	21.4	\$29,096.15
	Balsam Fir	Pulpwood	133.0	Cords		
	Mixed Aspen		256.0	Cords		
	<i>B. T. Aspen</i>		80.0	<i>Cords</i>		
	<i>Quaking Aspen</i>		176.0	<i>Cords</i>		
	Mixed Hardwood		243.0	Cords		
	<i>Green Ash</i>		21.0	<i>Cords</i>		
	<i>Paper Birch</i>		16.0	<i>Cords</i>		
	<i>Red Maple</i>		206.0	<i>Cords</i>		
	Mixed Spruce		43.0	Cords		
	<i>White Spruce</i>		43.0	<i>Cords</i>		
	N. White Cedar		29.0	Cords		
	2	Paper Birch	Sawtimber	3.8		
Red Maple			8.0	MBF		
Balsam Fir		Pulpwood	128.0	Cords		
Mixed Aspen			406.0	Cords		
<i>B. T. Aspen</i>			52.0	<i>Cords</i>		
<i>Quaking Aspen</i>			354.0	<i>Cords</i>		
Mixed Hardwood			200.0	Cords		
<i>Green Ash</i>			15.0	<i>Cords</i>		
<i>Paper Birch</i>			39.0	<i>Cords</i>		
<i>Red Maple</i>			146.0	<i>Cords</i>		
Mixed Spruce			40.0	Cords		
<i>White Spruce</i>			40.0	<i>Cords</i>		
N. White Cedar			131.0	Cords		
3	Mixed Hardwood	Pulpwood	35.0	Cords	4.2	\$1,676.10
	<i>Paper Birch</i>		3.0	<i>Cords</i>		
	<i>Red Maple</i>		32.0	<i>Cords</i>		
	Mixed Spruce		3.0	Cords		
	<i>Black Spruce</i>		3.0	<i>Cords</i>		
	Red Pine		5.0	Cords		
	4	White Pine	Sawtimber	15.8		
Balsam Fir		Pulpwood	2.0	Cords		
Hemlock			4.0	Cords		
Mixed Aspen			107.0	Cords		
<i>B. T. Aspen</i>			107.0	<i>Cords</i>		
Mixed Hardwood			140.0	Cords		
<i>Paper Birch</i>			12.0	<i>Cords</i>		
<i>Red Maple</i>			128.0	<i>Cords</i>		
Mixed Spruce			33.0	Cords		
<i>Black Spruce</i>			33.0	<i>Cords</i>		
Red Pine			231.0	Cords		
Tamarack		10.0	Cords			
White Pine		194.0	Cords			
5	Mixed Hardwood	Pulpwood	4.0	Cords	23.0	\$12,714.15
	<i>Paper Birch</i>		2.0	<i>Cords</i>		
	<i>Red Maple</i>		2.0	<i>Cords</i>		
	Mixed Spruce		231.0	Cords		
	<i>Black Spruce</i>		231.0	<i>Cords</i>		
	Red Pine		56.0	Cords		
	Tamarack		101.0	Cords		
	White Pine		35.0	Cords		
6	Balsam Fir	Pulpwood	26.0	Cords	12.4	\$5,724.50
	Mixed Aspen		2.0	Cords		
	<i>Quaking Aspen</i>		2.0	<i>Cords</i>		
	Mixed Hardwood		113.0	Cords		

**Description of Timber by Payment Unit (PU), con't**

PU	MARKET GROUP	PRODUCT	QUANTITY	UNIT	ACRES	ADVERTISE PRICE				
6 con't	<i>Black Ash</i>	<i>Pulpwood</i>	11.0	<i>Cords</i>						
	<i>Green Ash</i>		3.0	<i>Cords</i>						
	<i>Paper Birch</i>		27.0	<i>Cords</i>						
	<i>Red Maple</i>		72.0	<i>Cords</i>						
	Mixed Spruce		13.0	Cords						
	<i>Black Spruce</i>		13.0	<i>Cords</i>						
	Tamarack		2.0	Cords						
	White Pine		9.0	Cords						
7	Green Ash	Sawtimber	2.2	MBF	27.0	\$24,850.35				
	Red Maple		1.5	MBF						
	White Pine		2.9	MBF						
	Balsam Fir	<i>Pulpwood</i>	55.0	Cords						
	Mixed Aspen		8.0	Cords						
	<i>Quaking Aspen</i>		8.0	<i>Cords</i>						
	Mixed Hardwood		413.0	Cords						
	<i>Balsam Poplar</i>		22.0	<i>Cords</i>						
	<i>Black Ash</i>		74.0	<i>Cords</i>						
	<i>Green Ash</i>		60.0	<i>Cords</i>						
	<i>Paper Birch</i>		35.0	<i>Cords</i>						
	<i>Red Maple</i>		208.0	<i>Cords</i>						
	<i>Yellow Birch</i>		14.0	<i>Cords</i>						
	Mixed Spruce		14.0	Cords						
	<i>Black Spruce</i>		14.0	<i>Cords</i>						
	N. White Cedar		250.0	Cords						
	White Pine		6.0	Cords						
	TOTAL:			51.5			MBF			
	TOTAL:			6,015.0			Cords			

## Sale Specific Conditions & Requirements

**Sale Name: Water and Ice SBW**

**Sale Number: 33-026-16 Seq#: 1**

### 1 - Sale Area

#### 1.2 - Boundaries

##### 1.2.1 - Painted boundaries (1/14)

The sale boundary and Payment Unit boundaries are marked and identified by red and yellow paint. Exterior sale boundary lines against state are marked with red paint. Interior Payment Unit boundaries are marked with yellow paint. Yellow painted trees designating an interior Payment Unit boundary are only to be cut when all surrounding Payment Units have been paid for.

### 2 - Timber Specifications

#### 2.1 - Included Timber

##### 2.1.1 - Clearcut unit(s) with unmerchantable trees (6/14)

Within Payment Unit(s) 1 and 2, cut all trees that are three (3) inches or more at DBH; except white pine. Also, there is a retention patch in each unit. These patches are bounded by a red paint line and need to be protected. No harvesting activities may occur within these areas.

Within Payment Unit 3, cut all trees greater than four (4) inches at DBH; except white pine, hemlock, and cedar.

Within Payment Unit 6, cut all trees greater than three (3) inches at DBH; except hemlock and cedar.

Within Payment Unit 7, cut all trees greater than four (4) inches at DBH; except hemlock and seed trees marked with green paint. Also, there are two retention patch's within the unit. These patches are bounded by a red paint line and need to be protected. No harvesting activities may occur within these areas.

##### 2.1.7 - Leave tree marked unit(s) (6/14)

Within Payment Unit(s) 4, cut all merchantable trees except; trees marked with green paint above and below stump height.

Within Payment Unit 5, cut all trees greater than three (3) inches at DBH; except trees marked with green paint.

#### 2.2 - Utilization

##### 2.2.4 - Skidding length (2/14)

Skidding of unlimbed tops or lengths over 17 feet is not permissible within units 3 and 4. This is to protect the advanced regeneration within each unit.

### 3 - Payments

#### 3.3 - Pre-measured Sales

##### 3.3.4 - Dividing payment units (7/14)

Payment Unit(s) \$18,000 in value or greater may be divided at the request of the Purchaser and upon approval of the Unit Manager. Dividing Payment Units is a contract modification which requires a Timber Sale Contract Supplement. There will be only one division per Payment Unit.

### 4 - Transportation

#### 4.2 - Maintenance

##### 4.2.1 - Hauling restriction (12/08)

Hauling may be restricted on forest roads by the Unit Manager or his/her representative. The restriction may occur during spring breakup or during other wet weather conditions.

#### 4.2.4 - Grading (12/14)

For completion of the sale, state forest roads must be graded. In general, this will require a road grader or bull dozer to shape up the roads after forest products have been hauled off site. This includes cleaning of drainage areas, grading, crowning and filling with gravel, if necessary. The grading equipment to be used must be approved by the Unit Manager or his/her representative.

### 5 - Operations

#### 5.2 - Conduct of Operations

##### 5.2.3 - Operating Restrictions

###### 5.2.3.1 - Operating restrictions (9/11)

Within Payment Unit(s) 3, 5, 6, and 7 cutting and skidding are limited to the period of December 1st to March 31st, unless there is an extended dry or frozen period and the sale administrator approves of harvesting during that time period. This restriction is because of low wet ground throughout the units.

##### 5.2.22 - Operating Caution

###### 5.2.22.1 - Operating caution (6/11)

It is recommended, but not required, that within Payment Unit(s) 4, cutting and skidding occur during dry summer or frozen winter conditions. The reason for the recommendation is because of some wet drains running through parts of the unit.

##### 5.2.39 - ORV trail/route protection (12/12)

The Forest Island Trail is an ORV trail or route and is shown on the Timber Sale Map. Do not cut trees or damage posts with orange ORV markers. The ORV trail runs on the first half mile of the Elwood Creek Road, off of the Westman Dam Road. This stretch of trail/road will be kept free of ruts and debris on a daily basis.

#### 5.4 - Soil Protection

##### 5.4.1 - Rutting restriction, general (1/09)

Operations are to cease immediately if equipment and weather conditions result in rutting of roads and skid trails which is 12 inches or greater in depth and 50 feet in length. The Unit Manager or his/her representative may restrict hauling and/or skidding if ruts exceed the specified depth. With the Unit Manager or his/her representative's approval, the Purchaser may return to the area when the risk of rutting has decreased.

### 6 - Safety and Fire Prevention

#### 6.2 - Signing

##### 6.2.1 - Road posting (9/09)

The Purchaser is responsible for posting and maintaining caution signs on the Elwood Creek Road/Forest Island ORV Trail prior to beginning operations. The road must be posted at appropriate distances from the sale area to warn of logging activity and truck traffic. Signs must be removed when harvest operations are suspended or completed. The Purchaser will provide these signs.



# TIMBER SALE MAP

This information provided by authority of Part 525, 1994 PA 451, as amended.

Sale Number	Year
33 - 026	16

Forest Management Unit		County	Mapped By	Date	Page	of
Escanaba		Menominee	Salter	04/25/2016	1	1
Township	Range	Section(s) and Subdivision(s)		Scale		
35N	25W	5 - SENE, E1/2SE 9 - N1/2NW		1:15,840		

Cover Type				Density	
A = Aspen	H = Hemlock	N = Marsh	U = Upland Brush	0 = Non Stocked	5 = Pole Timber Medium
R = Paper Birch	J = Jack Pine	O = Oak	UM = Upland Mixed	1 = Seedling Sapling Poor	6 = Pole Timber Well
C = Cedar	L = Lowland Brush	P = Lowland Poplar	V = Bog or Marsh	2 = Seedling Sapling Medium	7 = Saw Timber Poor
D = Tread Bog	LM = Lowland Mixed	Q = Mixed Swamp Conifer	W = White Pine	3 = Seedling Sapling Well	8 = Saw Timber Medium
E = Swamp Hdwoods	M = Mpl. Bch, Birch	R = Red Pine	X = Non Stocked	4 = Pole Timber Poor	9 = Saw Timber Well
F = Spruce Fir	MC = Mixed Conifer	S = Black Spruce	Z = Water		
G = Grass	MD = Mixed Deciduous	T = Tamarack			

PU	Acres	PU	Acres
1	21.4	5	23
2	28.3	6	12.4
3	4.2	7	27
4	26.3		

## Water And Ice SBW Compartment 51 142.6 Acres

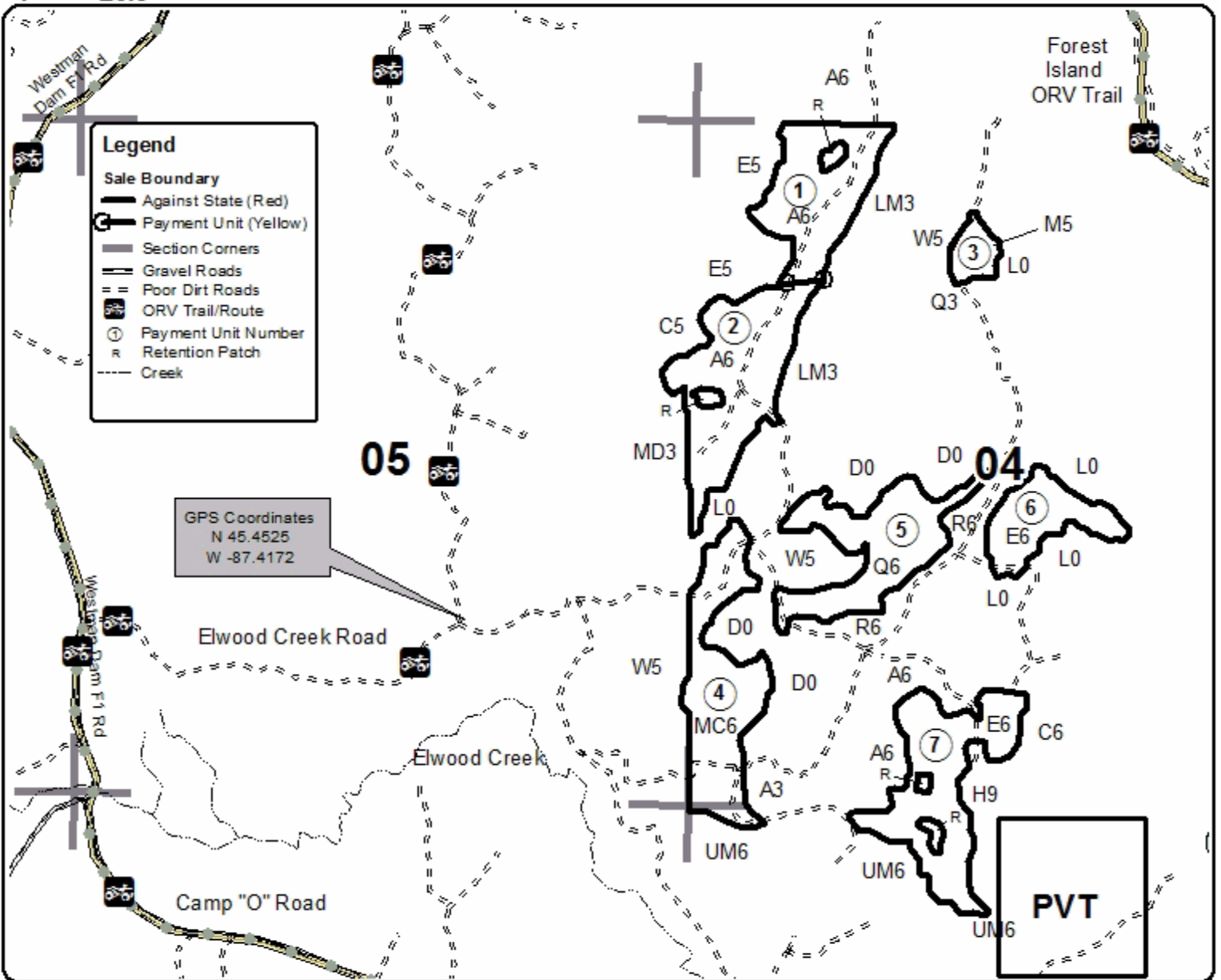



# TIMBER SALE INFORMATION

## Flowing Elwood (33-027-16)

Menominee County (Advertised Price \$204,021.95)

SALE NOTE: The Camp "O" Road is an ORV Route which needs to be free of debris and ruts at all times. The sale contains advanced regeneration throughout which needs to be protected.

A recreation site such as a trail, pathway, or campground is within the sale area or the vicinity. Certain restrictions/specifications may be applicable including time restrictions.

A timber sale contract for this lump sum, sealed bid timber sale will be awarded to the responsible bidder offering the highest sealed bid price. Bids must be at or above the following advertised price for each species:

<u>PRODUCTS &amp; SPECIES</u>	<u>ESTIMATED UNITS*</u>	<u>ADVERTISED PRICE</u>
Sawtimber		
Black Ash	1.20 MBF	\$ 96.00 / MBF
Green Ash	26.90 MBF	\$ 96.00 / MBF
Paper Birch	0.90 MBF	\$ 96.00 / MBF
Red Maple	265.50 MBF	\$ 257.00 / MBF
White Pine	17.20 MBF	\$ 80.00 / MBF
Yellow Birch	23.40 MBF	\$ 96.00 / MBF
Pulpwood		
Balsam Fir	126.00 Cords	\$ 31.75 / Cord
Mixed Hardwood	3,026.00 Cords	\$ 39.75 / Cord
Red Pine	4.00 Cords	\$ 61.10 / Cord
White Pine	121.00 Cords	\$ 30.25 / Cord
White Spruce	39.00 Cords	\$ 30.60 / Cord

\* The total volume is statistically estimated within plus (+) or minus (-) 8.19 percent. The estimated units are final and not subject to adjustment. Prospective bidders are urged to examine this timber and to make their own estimates of quantity and quality.

### **BOND AND PAYMENT SCHEDULE:**

1. A bond in the amount of \$10,500.00 to insure faithful performance of the conditions of the contract will be deposited by the successful bidder within 21 days of the sale award.
2. Cutting in any sale or unit without the required advance payment would be considered a trespass.
3. Total payment must be paid in advance or according to the following schedule:
  - (a) Ten percent (10%) of the sale value must be paid within 21 days of the sale award.
  - (b) The 10% down payment will be credited towards the first unit cut.
4. If no cutting takes place, the 10% down payment will not be refunded.
5. Operations on the contract issued will terminate on 09/30/2019.

**Description of Timber by Payment Unit (PU)**

PU	MARKET GROUP	PRODUCT	QUANTITY	UNIT	ACRES	ADVERTISE PRICE				
1		Green Ash	2.3	MBF	24.7	\$36,171.95				
		Red Maple	33.3	MBF						
		White Pine	5.6	MBF						
		Yellow Birch	18.1	MBF						
		Balsam Fir	55.0	Cords						
		Mixed Hardwood	562.0	Cords						
		<i>Balsam Poplar</i>	3.0	<i>Cords</i>						
		<i>Beech</i>	11.0	<i>Cords</i>						
		<i>Black Ash</i>	31.0	<i>Cords</i>						
		<i>Green Ash</i>	36.0	<i>Cords</i>						
		<i>Ironwood</i>	11.0	<i>Cords</i>						
		<i>Red Maple</i>	320.0	<i>Cords</i>						
		<i>Yellow Birch</i>	150.0	<i>Cords</i>						
		White Pine	30.0	Cords						
		White Spruce	7.0	Cords						
2		Green Ash	6.8	MBF	33.9	\$47,195.05				
		Red Maple	59.4	MBF						
		White Pine	2.0	MBF						
		Yellow Birch	5.3	MBF						
		Balsam Fir	10.0	Cords						
		Mixed Hardwood	746.0	Cords						
		<i>Balsam Poplar</i>	4.0	<i>Cords</i>						
		<i>Beech</i>	36.0	<i>Cords</i>						
		<i>Black Ash</i>	15.0	<i>Cords</i>						
		<i>Green Ash</i>	52.0	<i>Cords</i>						
		<i>Paper Birch</i>	4.0	<i>Cords</i>						
		<i>Red Maple</i>	597.0	<i>Cords</i>						
		<i>Yellow Birch</i>	38.0	<i>Cords</i>						
		White Pine	17.0	Cords						
		White Spruce	4.0	Cords						
3		Green Ash	7.5	MBF	12.6	\$20,954.80				
		Red Maple	32.1	MBF						
		White Pine	1.9	MBF						
		Balsam Fir	19.0	Cords						
		Mixed Hardwood	271.0	Cords						
		<i>Black Ash</i>	29.0	<i>Cords</i>						
		<i>Green Ash</i>	18.0	<i>Cords</i>						
		<i>Red Maple</i>	216.0	<i>Cords</i>						
		<i>Yellow Birch</i>	8.0	<i>Cords</i>						
		White Pine	4.0	Cords						
		White Spruce	11.0	Cords						
		4		Red Maple			29.7	MBF	22.0	\$24,750.50
				White Pine			7.7	MBF		
Balsam Fir	10.0			Cords						
Mixed Hardwood	366.0			Cords						
<i>Red Maple</i>	356.0			<i>Cords</i>						
<i>Yellow Birch</i>	10.0			<i>Cords</i>						
White Pine	48.0			Cords						
White Spruce	6.0			Cords						
5		Green Ash	5.2	MBF	30.7	\$53,905.30				
		Red Maple	86.6	MBF						
		Balsam Fir	20.0	Cords						
		Mixed Hardwood	744.0	Cords						
		<i>Black Ash</i>	10.0	<i>Cords</i>						
		<i>Green Ash</i>	59.0	<i>Cords</i>						
		<i>Paper Birch</i>	2.0	<i>Cords</i>						

**Description of Timber by Payment Unit (PU), con't**

PU	MARKET GROUP	PRODUCT	QUANTITY	UNIT	ACRES	ADVERTISE PRICE		
5 con't	<i>Red Maple</i>	<i>Pulpwood</i>	668.0	<i>Cords</i>				
	<i>Yellow Birch</i>		5.0	<i>Cords</i>				
	White Pine		22.0	Cords				
	White Spruce		9.0	Cords				
6	Black Ash	Sawtimber	1.2	MBF	18.2	\$21,044.35		
	Green Ash		5.1	MBF				
	Paper Birch		0.9	MBF				
	Red Maple		24.4	MBF				
	Balsam Fir	Pulpwood	12.0	Cords				
	Mixed Hardwood		337.0	Cords				
	<i>Black Ash</i>		14.0	<i>Cords</i>				
	<i>Green Ash</i>		19.0	<i>Cords</i>				
	<i>Paper Birch</i>		13.0	<i>Cords</i>				
	<i>Quaking Aspen</i>		3.0	<i>Cords</i>				
	<i>Red Maple</i>		279.0	<i>Cords</i>				
	<i>Yellow Birch</i>		9.0	<i>Cords</i>				
	Red Pine		4.0	Cords				
	White Spruce		2.0	Cords				
	TOTAL:			335.1	MBF			
	TOTAL:			6,342.0	Cords			

# Sale Specific Conditions & Requirements

**Sale Name: Flowing Elwood**

**Sale Number: 33-027-16 Seq#: 1**

## 1 - Sale Area

### 1.2 - Boundaries

#### 1.2.1 - Painted boundaries (1/14)

The sale boundary and Payment Unit boundaries are marked and identified by blue, red and yellow paint. Exterior sale boundary lines against private property are marked with blue paint. Exterior sale boundary lines against state are marked with red paint. Interior Payment Unit boundaries are marked with yellow paint. The painted boundary line trees are not Included Timber and are to be protected. Yellow painted trees designating an interior Payment Unit boundary are only to be cut when all surrounding Payment Units have been paid for.

## 2 - Timber Specifications

### 2.1 - Included Timber

#### 2.1.1 - Clearcut unit(s) with unmerchantable trees (6/14)

Within Payment Unit(s) 6, cut all trees that are four (4) inches or more at DBH; except white pine, hemlock, and cedar.

#### 2.1.2 - Clearcut unit(s) w/o unmerchantable trees (8/11)

Within Payment Unit(s) 1 - 5, cut all trees which meet minimum piece specifications in 2.2 Utilization; except hemlock, cedar, and white pine marked with green paint.

There are also two retention patches within Payment Units 1 and 2. These patches are bounded by a red paint line and need to be protected. No harvesting activities may occur within these areas.

#### 2.1.16 - Timber along county or forest roads (6/14)

Cut and remove all standing trees 3" DBH or greater within 20 feet of the edge of the Camp "O" Road. There will be approximately 1.5 miles cut, starting from the Town Road intersection. The areas to be harvested will be identified at the pre-sale meeting. All wood harvested will be sorted by species and product and the sale administrator will scale the wood and the contractor will pay for the wood at the contract rates. Cedar will be paid for at \$35.00 per cord and hemlock will be paid for at \$20.00 per cord.

### 2.2 - Utilization

#### 2.2.4 - Skidding length (2/14)

Skidding of unlimbed tops or lengths over 17 feet is not permissible within any of the payment units.

## 3 - Payments

### 3.3 - Pre-measured Sales

#### 3.3.4 - Dividing payment units (7/14)

Payment Unit(s) \$18,000 in value or greater may be divided at the request of the Purchaser and upon approval of the Unit Manager. Dividing Payment Units is a contract modification which requires a Timber Sale Contract Supplement. There will be only one division per Payment Unit.

## 4 - Transportation

### 4.2 - Maintenance

#### 4.2.1 - Hauling restriction (12/08)

Hauling may be restricted on forest roads by the Unit Manager or his/her representative. The restriction may occur during spring breakup or during other wet weather conditions.

#### 4.2.2 - Fill material (4/07)

To maintain roads, fill material may be needed in areas where "holes" exist or may be expected to develop. This fill material should be placed before trucking begins. The access roads within the sale area will need to be improved (gravel hauled and spread) in order to haul the wood out during non-frozen conditions. Pit run gravel is available from a state pit approximately 6

miles from the sale.

#### 4.2.4 - Grading (12/14)

For completion of the sale, state forest roads must be graded. In general, this will require a road grader or bull dozer to shape up the roads after forest products have been hauled off site. This includes cleaning of drainage areas, grading, crowning and filling with gravel, if necessary. The grading equipment to be used must be approved by the Unit Manager or his/her representative.

### 5 - Operations

#### 5.2 - Conduct of Operations

##### 5.2.22 - Operating Caution

###### 5.2.22.1 - Operating caution (6/11)

It is recommended, but not required, that within Payment Unit(s) 1 - 6, cutting and skidding occur during dry summer or frozen winter conditions. The reason for the recommendation is because of some areas of low wet ground within each of the units and along the access roads.

##### 5.2.39 - ORV trail/route protection (12/12)

The Camp "O" Road is an ORV route and is shown on the Timber Sale Map. Trees with orange ORV markers shall be cut off above the markers and at least 5 feet above ground. All stumps within 5 feet of the trail must be cut flush with the ground. Maintain a 20 foot wide slash, debris, and rut free zone daily using the ORV trail or route as the centerline.

#### 5.4 - Soil Protection

##### 5.4.1 - Rutting restriction, general (1/09)

Operations are to cease immediately if equipment and weather conditions result in rutting of roads and skid trails which is 12 inches or greater in depth and 50 feet in length. The Unit Manager or his/her representative may restrict hauling and/or skidding if ruts exceed the specified depth. With the Unit Manager or his/her representative's approval, the Purchaser may return to the area when the risk of rutting has decreased.

### 6 - Safety and Fire Prevention

#### 6.2 - Signing

##### 6.2.1 - Road posting (9/09)

The Purchaser is responsible for posting and maintaining caution signs on the Camp "O" Road/ORV Route prior to beginning operations. The road must be posted at appropriate distances from the sale area to warn of logging activity and truck traffic. Signs must be removed when harvest operations are suspended or completed. The Purchaser will provide these signs.



# TIMBER SALE MAP

This information provided by authority of Part 525, 1994 PA 451, as amended.

Sale Number	Year
33-027	16

Forest Management Unit		County	Mapped By	Date	Page	of
Escanaba Management Unit		Menominee County	Beaudou	5/19/2016	1	1
Township	Range	Section(s) and Subdivision(s)		Scale		
35N	25W	Sec 8 - NESE & SENE, Sec 9 - NESW, NWSE, NWSW, SESW, SWNW, SWSE & SWSW; Sec 16 - NENW, NWNW & NWNW		1:15,840		

Cover Type				Density			
A = Aspen	H = Hemlock	N = Marsh	U = Upland Brush	0 = Non Stocked	5 = Pole Timber Medium		
R = Paper Birch	J = Jack Pine	O = Oak	UM = Upland Mixed	1 = Seedling Sapling Poor	6 = Pole Timber Well		
C = Cedar	L = Lowland Brush	P = Lowland Poplar	V = Bog or Marsh	2 = Seedling Sapling Medium	7 = Saw Timber Poor		
D = Tread Bog	LM = Lowland Mixed	Q = Mixed Swamp Conifer	W = White Pine	3 = Seedling Sapling Well	8 = Saw Timber Medium		
E = Swamp Hdwoods	M = Mpl. Bch, Birch	R = Red Pine	X = Non Stocked	4 = Pole Timber Poor	9 = Saw Timber Well		
F = Spruce Fir	MC = Mixed Conifer	S = Black Spruce	Z = Water				
G = Grass	MD = Mixed Deciduous	T = Tamarack					

### Legend

- Sale Boundary
  - Against State (Red)
  - Payment Unit (Yellow)
  - Private Line (Blue)
- State Property Line
- Section Corner
- 8 Section Number
- County Gravel Road
- County Dirt Road
- State Forest Road
- Two Track Road
- Forest Island ORV Route
- Payment Unit
- Retention Patch
- PVT Private Property

## Flowing Elwood Compartment 51 142.1 Acres

PU	Acres	PU	Acres
1	24.7	4	22.0
2	33.9	5	30.7
3	12.6	6	18.2

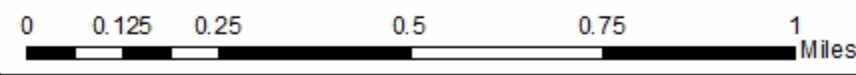
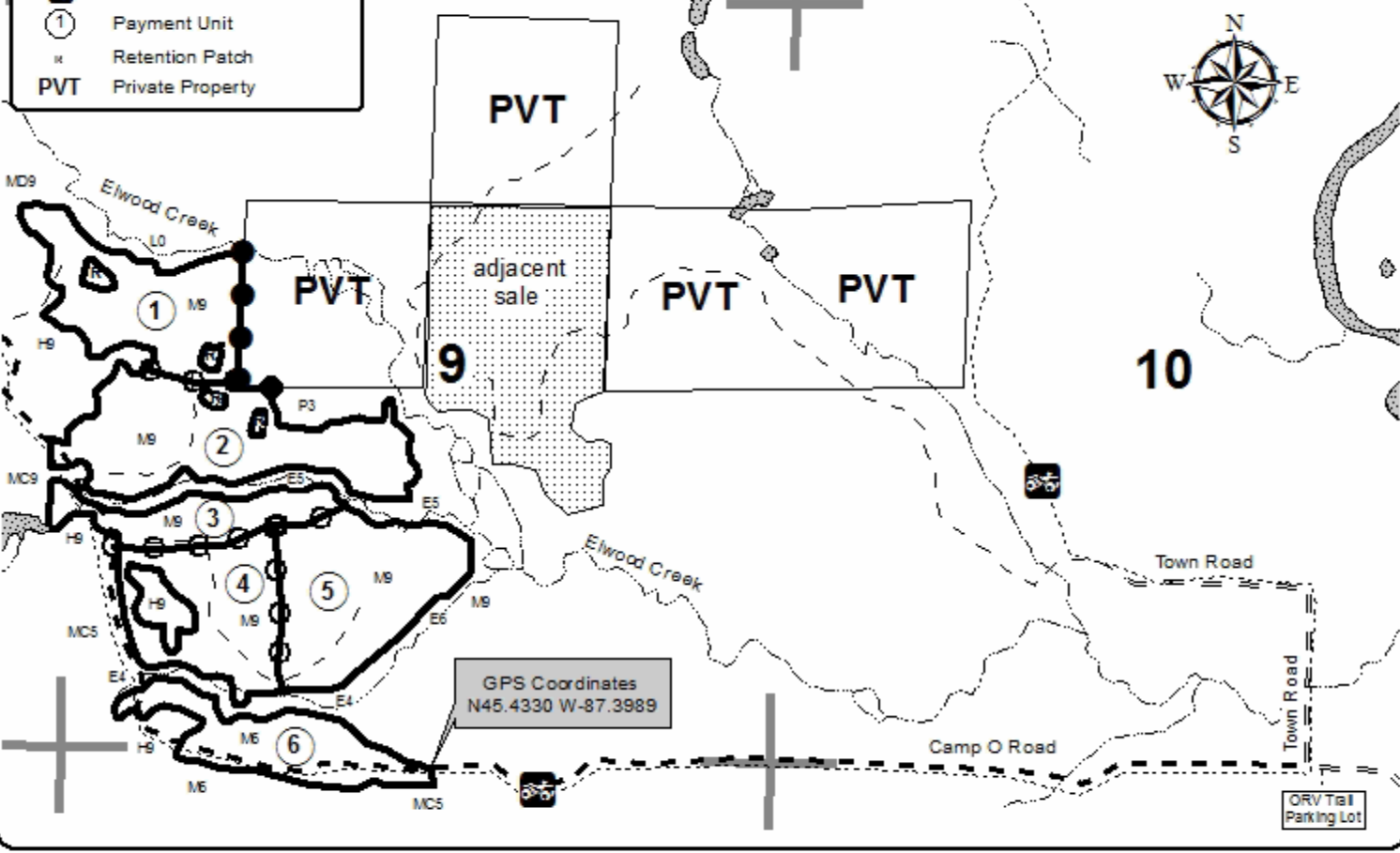
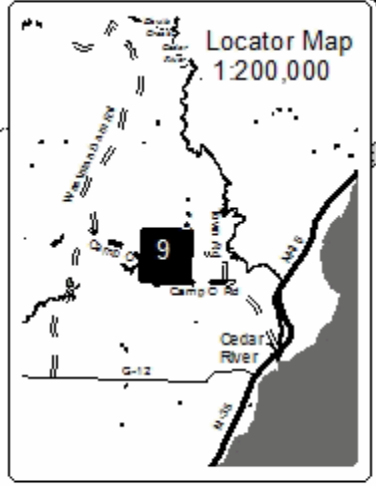

FORM

NORTH 107 SBW (33-003-16)

T41N, R22W, SEC. 26; T41N, R22W, SEC. 34; T41N, R22W, SEC. 35; Delta

In response to the notice of sale to be held 3:00 p.m. (local time) on August 9, 2016, I am hereby submitting my sealed bid (firm offer) for the following forest products to be cut. Bids for individual species must be at or above the advertised price. All non-responsive bid forms may be rejected.

<u>PRODUCTS &amp; SPECIES</u>	<u>ESTIMATED VOLUME*</u>	<u>ADVERTISED PRICE</u>	<u>BID PRICE</u>
Pulpwood			
Black Spruce	431.00 Cords	\$ 23.55/Cord	\$ _____
N. White Cedar	75.00 Cords	\$ 20.75/Cord	\$ _____
Red Pine	236.00 Cords	\$ 43.25/Cord	\$ _____
Tamarack	110.00 Cords	\$ 17.60/Cord	\$ _____

In addition, the successful bidder agrees to purchase the following species at the indicated advertised price for a total value of \$3,185.10 :

<u>PRODUCTS &amp; SPECIES</u>	<u>ESTIMATED VOLUME*</u>	<u>ADVERTISED PRICE</u>
Sawtimber		
Paper Birch	0.40 MBF	\$ 97.00/MBF
Pulpwood		
Mixed Hardwood	28.00 Cords	\$ 29.75/Cord
Mixed Softwood	30.00 Cords	\$ 24.20/Cord
Paper Birch	14.00 Cords	\$ 37.20/Cord
Quaking Aspen	10.00 Cords	\$ 33.45/Cord
White Pine	40.00 Cords	\$ 18.30/Cord

\*These estimated volumes are final and not subject to adjustment. Prospective bidders are urged to examine this timber and to make their own estimates of quantity and quality.

I understand that any or all bids may be rejected. All bids must be signed and all bid items must be bid or the bid form may be rejected. I also understand that consideration and awarding a contract will be based upon my past performance and ability to complete the contract based upon equipment and staffing subject to my control.

FEDERAL ID: \_\_\_\_ - \_\_\_\_ - \_\_\_\_ or SOCIAL SECURITY NUMBER: \_\_\_\_ - \_\_\_\_ - \_\_\_\_

Company or individual bidding: \_\_\_\_\_

Company representative's name: \_\_\_\_\_

Address: \_\_\_\_\_

City: \_\_\_\_\_ State: \_\_\_\_\_ Zip: \_\_\_\_\_

IF AVAILABLE, PLEASE PLACE THE PERSONALIZED LABEL FROM YOUR PROSPECTUS IN THE ABOVE BOX.

Individual or company representative's signature: \_\_\_\_\_ Date: \_\_\_\_\_

Phone number : \_\_\_\_\_ Email (optional): \_\_\_\_\_

**THE WINNING BIDDER MUST COMPLETE THE VERIFICATION OF WORKER'S DISABILITY COMPENSATION ACT COMPLIANCE (ON REVERSE SIDE IF DOUBLE SIDED) WITHIN 21 DAYS OF SALE AWARD DATE**



<b>FOR DEPARTMENT USE ONLY</b>
Sale Number (XX - XXX - XX - XX)
Forest Management Unit:

## TIMBER SALE VERIFICATION OF WORKER'S DISABILITY COMPENSATION ACT COMPLIANCE

*As required by Act 317, P.A. 1969 (Worker's Compensation) and  
Part 5 of Act 451 of 1994, as amended.*

### VERIFICATION OF WORKER'S DISABILITY COMPENSATION ACT COMPLIANCE

- This verification must be completed and submitted within 21 days of contract award and prior to the issuance of the timber sale contract.
- In addition, if boxes 2B or 2C are checked, then Notice of Exclusion or Certificate of Insurance must be submitted within twenty-one (21) days of the contract award and prior to the issuance of the timber sale contract.
- All information must be typed or printed except for written signatures.

Please Check Appropriate Categories:

1. My business is organized as (you **must** check one of the boxes below):
  - A.  Sole Proprietorship (individual)
  - B.  Partnership
  - C.  Corporation
  
2. You **must** check one of the boxes below:
  - A.  I certify my business is a sole proprietorship and it has no employees but the sole proprietor. I am not subject to the Worker's Compensation Laws.
  - B.  I certify my business has satisfied its obligation to the Worker's Compensation Act through the use of an approved Notice of Exclusion (BWC-337, Rev. 5/96). I will provide a copy of the Notice of Exclusion within 21 days of the contract award. (For questions or a copy of the BWC-337, please call the Worker's Compensation Bureau at 517-322-1195).
  - C.  I certify my business has a Worker's Compensation Policy. I will provide an original Certificate of Insurance within twenty-one (21) days of the contract award.
  
3. If you have checked item 2(A) or 2(B), you **must** indicate the number of **both** full-time and part-time employees, other than yourself, including family members and active partners (if none, you must enter "0").

\_\_\_\_\_ Full-time Employees

\_\_\_\_\_ Part-time Employees

Name of Business		Federal ID (or) Social Security No.	
Address		Telephone (       )	
City	State	ZIP	

*I hereby certify that the above information is true and correct. I agree to notify the Michigan DNR of any changes that occur in factors affecting my coverage during any of my present and future operations.*

\_\_\_\_\_  
Signature of Owner or Authorized Representative

\_\_\_\_\_  
Title

\_\_\_\_\_  
Date

**Please complete the "SEALED BID" information on the next page**



FORM

Water and Ice SBW (33-026-16)  
; Menominee COUNTY

In response to the notice of sale to be held 3:00 p.m. (local time) on August 9, 2016, I am hereby submitting my sealed bid (firm offer) for the following forest products to be cut. Bids for individual species must be at or above the advertised price. All non-responsive bid forms may be rejected.

<u>PRODUCTS &amp; SPECIES</u>	<u>ESTIMATED VOLUME*</u>	<u>ADVERTISED PRICE</u>	<u>BID PRICE</u>
<b>Sawtimber</b>			
Green Ash	2.20 MBF	\$ 75.00/MBF	\$ _____
Paper Birch	3.80 MBF	\$ 113.00/MBF	\$ _____
Red Maple	26.80 MBF	\$ 241.00/MBF	\$ _____
White Pine	18.70 MBF	\$ 75.00/MBF	\$ _____
<b>Pulpwood</b>			
Balsam Fir	344.00 Cords	\$ 29.80/Cord	\$ _____
Hemlock	4.00 Cords	\$ 15.00/Cord	\$ _____
Mixed Aspen	779.00 Cords	\$ 38.90/Cord	\$ _____
Mixed Hardwood	1,148.00 Cords	\$ 37.25/Cord	\$ _____
Mixed Spruce	377.00 Cords	\$ 28.70/Cord	\$ _____
N. White Cedar	410.00 Cords	\$ 24.80/Cord	\$ _____
Red Pine	292.00 Cords	\$ 57.25/Cord	\$ _____
Tamarack	113.00 Cords	\$ 17.20/Cord	\$ _____
White Pine	244.00 Cords	\$ 28.35/Cord	\$ _____

\*The volumes are statistically estimated within plus (+) or minus (-) 8.50 percent. These estimated volumes are final and not subject to adjustment. Prospective bidders are urged to examine this timber and to make their own estimates of quantity and quality.

I understand that any or all bids may be rejected. All bids must be signed and all bid items must be bid or the bid form may be rejected. I also understand that consideration and awarding a contract will be based upon my past performance and ability to complete the contract based upon equipment and staffing subject to my control.

FEDERAL ID: \_\_\_\_\_ or SOCIAL SECURITY NUMBER: \_\_\_\_\_

Company or individual bidding: \_\_\_\_\_

Company representative's name: \_\_\_\_\_

Address: \_\_\_\_\_

City: \_\_\_\_\_ State: \_\_\_\_\_ Zip: \_\_\_\_\_

IF AVAILABLE, PLEASE PLACE THE PERSONALIZED LABEL FROM YOUR PROSPECTUS IN THE ABOVE BOX.

Individual or company representative's signature: \_\_\_\_\_ Date: \_\_\_\_\_

Phone number : \_\_\_\_\_ Email (optional): \_\_\_\_\_

**THE WINNING BIDDER MUST COMPLETE THE VERIFICATION OF WORKER'S DISABILITY COMPENSATION ACT COMPLIANCE (ON REVERSE SIDE IF DOUBLE SIDED) WITHIN 21 DAYS OF SALE AWARD DATE**



<b>FOR DEPARTMENT USE ONLY</b>
Sale Number (XX - XXX - XX - XX)
Forest Management Unit:

## TIMBER SALE VERIFICATION OF WORKER'S DISABILITY COMPENSATION ACT COMPLIANCE

*As required by Act 317, P.A. 1969 (Worker's Compensation) and  
Part 5 of Act 451 of 1994, as amended.*

### VERIFICATION OF WORKER'S DISABILITY COMPENSATION ACT COMPLIANCE

- This verification must be completed and submitted within 21 days of contract award and prior to the issuance of the timber sale contract.
- In addition, if boxes 2B or 2C are checked, then Notice of Exclusion or Certificate of Insurance must be submitted within twenty-one (21) days of the contract award and prior to the issuance of the timber sale contract.
- All information must be typed or printed except for written signatures.

Please Check Appropriate Categories:

1. My business is organized as (you **must** check one of the boxes below):
  - A.  Sole Proprietorship (individual)
  - B.  Partnership
  - C.  Corporation
2. You **must** check one of the boxes below:
  - A.  I certify my business is a sole proprietorship and it has no employees but the sole proprietor. I am not subject to the Worker's Compensation Laws.
  - B.  I certify my business has satisfied its obligation to the Worker's Compensation Act through the use of an approved Notice of Exclusion (BWC-337, Rev. 5/96). I will provide a copy of the Notice of Exclusion within 21 days of the contract award. (For questions or a copy of the BWC-337, please call the Worker's Compensation Bureau at 517-322-1195).
  - C.  I certify my business has a Worker's Compensation Policy. I will provide an original Certificate of Insurance within twenty-one (21) days of the contract award.
3. If you have checked item 2(A) or 2(B), you **must** indicate the number of **both** full-time and part-time employees, other than yourself, including family members and active partners (if none, you must enter "0").

\_\_\_\_\_ Full-time Employees

\_\_\_\_\_ Part-time Employees

Name of Business		Federal ID (or) Social Security No.	
Address		Telephone (       )	
City	State	ZIP	

*I hereby certify that the above information is true and correct. I agree to notify the Michigan DNR of any changes that occur in factors affecting my coverage during any of my present and future operations.*

\_\_\_\_\_  
Signature of Owner or Authorized Representative

\_\_\_\_\_  
Title

\_\_\_\_\_  
Date

**Please complete the "SEALED BID" information on the next page**

Flowing Elwood (33-027-16)  
 ; Menominee COUNTY

In response to the notice of sale to be held 3:00 p.m. (local time) on August 9, 2016, I am hereby submitting my sealed bid (firm offer) for the following forest products to be cut. Bids for individual species must be at or above the advertised price. All non-responsive bid forms may be rejected.

<u>PRODUCTS &amp; SPECIES</u>	<u>ESTIMATED VOLUME*</u>	<u>ADVERTISED PRICE</u>	<u>BID PRICE</u>
<b>Sawtimber</b>			
Black Ash	1.20 MBF	\$ 96.00/MBF	\$ _____
Green Ash	26.90 MBF	\$ 96.00/MBF	\$ _____
Paper Birch	0.90 MBF	\$ 96.00/MBF	\$ _____
Red Maple	265.50 MBF	\$ 257.00/MBF	\$ _____
White Pine	17.20 MBF	\$ 80.00/MBF	\$ _____
Yellow Birch	23.40 MBF	\$ 96.00/MBF	\$ _____
<b>Pulpwood</b>			
Balsam Fir	126.00 Cords	\$ 31.75/Cord	\$ _____
Mixed Hardwood	3,026.00 Cords	\$ 39.75/Cord	\$ _____
Red Pine	4.00 Cords	\$ 61.10/Cord	\$ _____
White Pine	121.00 Cords	\$ 30.25/Cord	\$ _____
White Spruce	39.00 Cords	\$ 30.60/Cord	\$ _____

\*The volumes are statistically estimated within plus (+) or minus (-) 8.19 percent. These estimated volumes are final and not subject to adjustment. Prospective bidders are urged to examine this timber and to make their own estimates of quantity and quality.

I understand that any or all bids may be rejected. All bids must be signed and all bid items must be bid or the bid form may be rejected. I also understand that consideration and awarding a contract will be based upon my past performance and ability to complete the contract based upon equipment and staffing subject to my control.

FEDERAL ID: \_\_\_\_\_ or SOCIAL SECURITY NUMBER: \_\_\_\_\_

Company or individual bidding: \_\_\_\_\_

Company representative's name: \_\_\_\_\_

Address: \_\_\_\_\_

City: \_\_\_\_\_ State: \_\_\_\_\_ Zip: \_\_\_\_\_

IF AVAILABLE, PLEASE PLACE THE PERSONALIZED LABEL FROM YOUR PROSPECTUS IN THE ABOVE BOX.

Individual or company representative's signature: \_\_\_\_\_ Date: \_\_\_\_\_

Phone number : \_\_\_\_\_ Email (optional): \_\_\_\_\_

**THE WINNING BIDDER MUST COMPLETE THE VERIFICATION OF WORKER'S DISABILITY COMPENSATION ACT COMPLIANCE (ON REVERSE SIDE IF DOUBLE SIDED) WITHIN 21 DAYS OF SALE AWARD DATE**



FOR DEPARTMENT USE ONLY	
Sale Number (XX - XXX - XX - XX)	
Forest Management Unit:	

## TIMBER SALE VERIFICATION OF WORKER'S DISABILITY COMPENSATION ACT COMPLIANCE

As required by Act 317, P.A. 1969 (Worker's Compensation) and  
Part 5 of Act 451 of 1994, as amended.

### VERIFICATION OF WORKER'S DISABILITY COMPENSATION ACT COMPLIANCE

- This verification must be completed and submitted within 21 days of contract award and prior to the issuance of the timber sale contract.
- In addition, if boxes 2B or 2C are checked, then Notice of Exclusion or Certificate of Insurance must be submitted within twenty-one (21) days of the contract award and prior to the issuance of the timber sale contract.
- All information must be typed or printed except for written signatures.

Please Check Appropriate Categories:

1. My business is organized as (you **must** check one of the boxes below):
  - A.  Sole Proprietorship (individual)
  - B.  Partnership
  - C.  Corporation
2. You **must** check one of the boxes below:
  - A.  I certify my business is a sole proprietorship and it has no employees but the sole proprietor. I am not subject to the Worker's Compensation Laws.
  - B.  I certify my business has satisfied its obligation to the Worker's Compensation Act through the use of an approved Notice of Exclusion (BWC-337, Rev. 5/96). I will provide a copy of the Notice of Exclusion within 21 days of the contract award. (For questions or a copy of the BWC-337, please call the Worker's Compensation Bureau at 517-322-1195).
  - C.  I certify my business has a Worker's Compensation Policy. I will provide an original Certificate of Insurance within twenty-one (21) days of the contract award.
3. If you have checked item 2(A) or 2(B), you **must** indicate the number of **both** full-time and part-time employees, other than yourself, including family members and active partners (if none, you must enter "0").

\_\_\_\_\_ Full-time Employees

\_\_\_\_\_ Part-time Employees

Name of Business		Federal ID (or) Social Security No.	
Address		Telephone (       )	
City	State	ZIP	

*I hereby certify that the above information is true and correct. I agree to notify the Michigan DNR of any changes that occur in factors affecting my coverage during any of my present and future operations.*

\_\_\_\_\_  
Signature of Owner or Authorized Representative

\_\_\_\_\_  
Title

\_\_\_\_\_  
Date

Please complete the "SEALED BID" information on the next page