



**DEPARTMENT OF NATURAL RESOURCES
STATE OF MICHIGAN**

TIMBER SALE PROSPECTUS #5488

REVISION NOTICE #1 - October 6, 2015

SCHEDULED SALE DATE AND TIME: 3:30 p.m. (local time) on Monday, October 19, 2015

LOCATION: KALKASKA FIELD OFFICE, 2089 N BIRCH ST, KALKASKA, MI 49646

This prospectus has been modified with the following changes.

The sale map for the CLAUSTROPHOBIC ASPEN timber sale (61-144-15-01) has been updated. Please use the attached sale map when bidding on this sale and disregard the original sale map sent with the prospectus.

The sale map for the 8 WIDE HARDWOODS timber sale (61-133-15-01) has been updated. Please use the attached sale map when bidding on this sale and disregard the original sale map sent with the prospectus.

We apologize for any inconvenience this may have caused. If you need assistance, please contact David Lemmien at 231-922-5280 ext. 6840.



TIMBER SALE MAP

This information provided by authority of Part 525, 1994 PA 451, as amended.

Sale Number	Year
61-133	2015

Forest Management Unit Traverse City	County Kalkaska	Mapped By Modlin	Date 06/12/2015	Page 1	of 1
Township 27N	Range 08W	Section(s) and Subdivision(s) Sec 4: W1/2NW, SENW Sec 5: NE1/4, W1/2SE, NESE, E1/2SW, NW1/4 Sec 6: SENE	Scale 1:15,840		

Cover Type				Density	
A = Aspen	H = Hemlock	N = Marsh	U = Upland Brush	0 = Non Stocked	5 = Pole Timber Medium
B = Paper Birch	J = Jack Pine	O = Oak	UM = Upland Mixed	1 = Seedling Sapling Poor	6 = Pole Timber Well
C = Cedar	L = Lowland Brush	P = Lowland Poplar	V = Bog or Marsh	2 = Seedling Sapling Medium	7 = Saw Timber Poor
D = Treed Bog	LM = Lowland Mixed	Q = Mixed Swamp Conifer	W = White Pine	3 = Seedling Sapling Well	8 = Saw Timber Medium
E = Swamp Hdwoods	M = Mpl, Bch, Brch	R = Red Pine	X = Non Stocked	4 = Pole Timber Poor	9 = Saw Timber Well
F = Spruce Fir	MC = Mixed Conifer	S = Black Spruce	Z = Water		
G = Grass	MD = Mixed Deciduous	T = Tamarack			

PU	Acres	PU	Acres	PU	Acres
1	45.3	4	46.3	7a	22.9
2	42.5	5	24.9	7b	13.8
3	21.9	6	58.6		

8 Wide Hardwoods Compartment 166 276.2 Acres

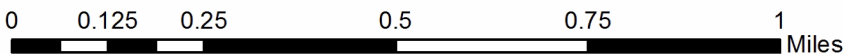
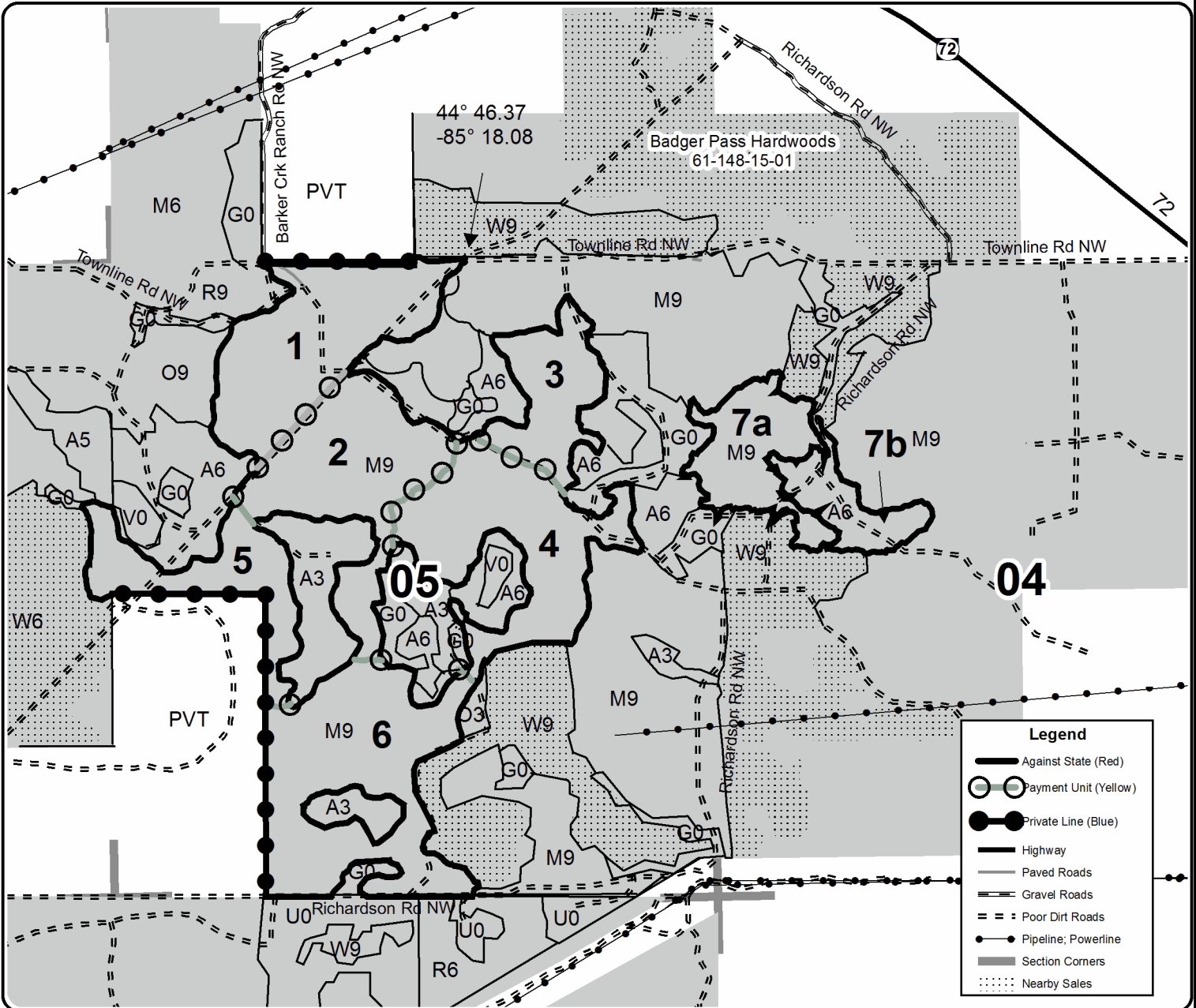



TIMBER SALE MAP

This information provided by authority of Part 525, 1994 PA 451, as amended.

Sale Number	Year
61 - 144	15

Forest Management Unit	County	Mapped By	Date	Page	of
Traverse City	Kalkaska	Crugier	07/31/2015	1	1
		Cruised By			
		Armstrong, Crugier			

Township	Range	Section(s) and Subdivision(s)	Scale
28N	6W	Sec 23: SWSE, E1/2SW, SENW. Sec 26: NE1/4	1:15,840

Cover Type				Density	
A = Aspen	H = Hemlock	N = Marsh	U = Upland Brush	0 = Non Stocked	5 = Pole Timber Medium
B = Paper Birch	J = Jack Pine	O = Oak	UM = Upland Mixed	1 = Seedling Sapling Poor	6 = Pole Timber Well
C = Cedar	L = Lowland Brush	P = Lowland Poplar	V = Bog or Marsh	2 = Seedling Sapling Medium	7 = Saw Timber Poor
D = Treed Bog	LM = Lowland Mixed	Q = Mixed Swamp Conifer	W = White Pine	3 = Seedling Sapling Well	8 = Saw Timber Medium
E = Swamp Hdwoods	M = Mpl, Bch, Brch	R = Red Pine	X = Non Stocked	4 = Pole Timber Poor	9 = Saw Timber Well
F = Spruce Fir	MC = Mixed Conifer	S = Black Spruce	Z = Water		
G = Grass	MD = Mixed Deciduous	T = Tamarack			

PU	Acres
1	26.8
2	16.6
3	18.6

Claustrophobic Aspen

Compartment 103

62 Acres

